

SURVEY CONTROL SHEET

FINAL

DATUM DESCRIPTION

THE LOCALIZED COORDINATE SYSTEM DEVELOPED FOR THIS PROJECT IS BASED ON THE STATE PLANE COORDINATES ESTABLISHED BY NCDOT FOR MONUMENT "B5136-1" WITH NAD 83/NSRS 2007 STATE PLANE GRID COORDINATES OF NORTHING: 616878.704(FT) EASTING: 1522429.806(FT) ELEVATION: 699.225(FT) THE AVERAGE COMBINED GRID FACTOR USED ON THIS PROJECT (GROUND TO GRID) IS: 0.9998500 THE N.C. LAMBERT GRID BEARING AND LOCALIZED HORIZONTAL GROUND DISTANCE FROM "B5136-1" TO -L- STATION 12+75.00 IS S47°14'01.8"W 2429.961' ALL LINEAR DIMENSIONS ARE LOCALIZED HORIZONTAL DISTANCES VERTICAL DATUM USED IS NAVD 88

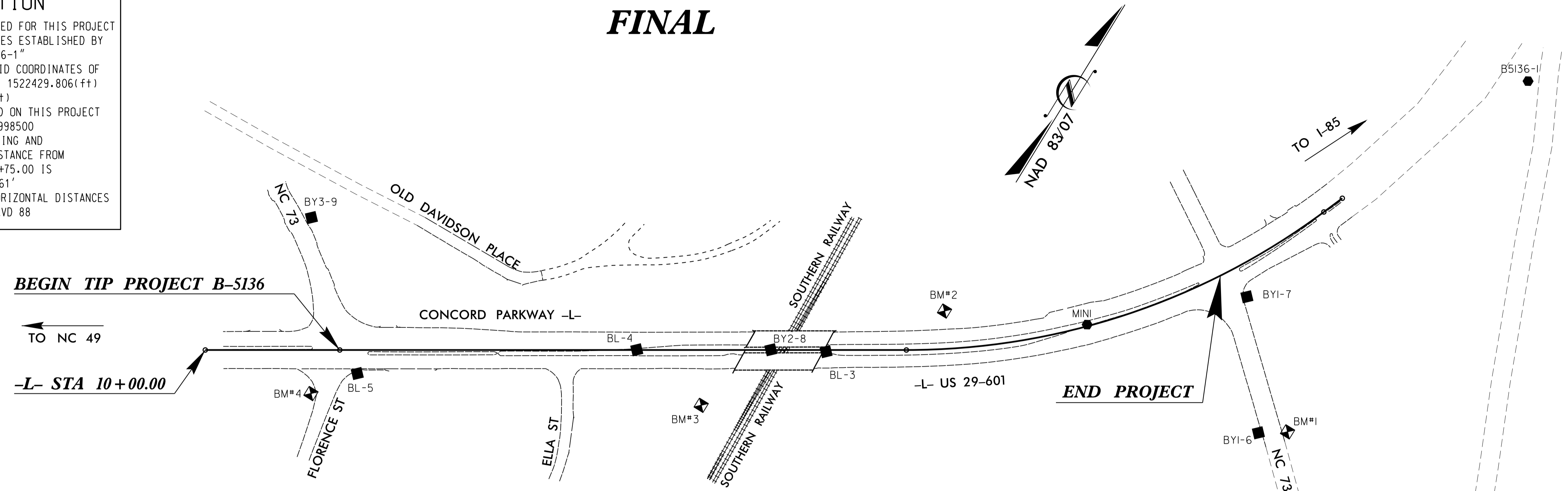

BL POINT	DESC.	NORTH	EAST	ELEVATION	L STATION	OFFSET
5	BL-5	615116.4370	1520701.5030	666.67	13+10.73	48.09 RT
4	BL-4	615456.7900	1521163.3990	693.17	18+82.42	0.40 LT
8	BY2-8	615600.3010	1521397.0550	672.75	21+56.63	0.50 LT
3	BL-3	615656.0830	1521495.3620	701.01	22+69.60	3.37 RT
2	MINI	615982.5140	1521921.6490	699.54	28+08.76	3.23 LT
7	BY1-7	616201.8960	1522170.2600	700.15	31+27.68	63.19 RT
1	B5136-1	616878.7040	1522429.8060	699.23	OUTSIDE PROJECT LIMITS	

BY1 POINT	DESC.	NORTH	EAST	ELEVATION	L STATION	OFFSET
17	BY1-7	616201.8960	1522170.2600	700.15	31+27.68	63.19 RT
6	BY1-6	615977.0820	1522335.8410	698.00	30+38.96	323.73 RT

BY3 POINT	DESC.	NORTH	EAST	ELEVATION	L STATION	OFFSET
9	BY3-9	615339.2490	1520454.7870	656.44	12+16.99	270.85 LT
15	BL-5	615116.4370	1520701.5030	666.67	13+10.73	48.09 RT

EY3_SB			
TYPE	STATION	NORTH	EAST
POT	10+00.00	614994.9042	1520411.5119
PC	24+33.95	615744.9226	1521633.6754
PT	33+48.75	616432.1645	1522213.7668
POT	33+95.73	616475.7588	1522231.2661

EY4			
TYPE	STATION	NORTH	EAST
POT	10+00.00	616060.1627	1521773.1432
PC	10+43.86	616036.5593	1521810.1130
PT	10+75.79	616016.6551	1521834.9986
POT	11+64.94	615953.8982	1521898.3105

EY5			
TYPE	STATION	NORTH	EAST
POT	10+00.00	616341.6340	1521912.3135
POT	12+29.92	616219.3220	1522107.0018

EY6			
TYPE	STATION	NORTH	EAST
POT	10+00.00	616220.1345	1522107.4975
POT	13+70.45	615971.3918	1522382.0149

PERMANENT EASEMENT				
ALIGN	STATION	OFFSET	NORTH	EAST
L	13+15.04	-89.23	615235.7353	1520633.3532
L	13+86.00	68.00	615138.8423	1520776.0689
L	13+86.00	84.00	615125.2854	1520784.4376
L	15+25.00	-100.00	615354.7328	1520806.6681
L	16+02.50	85.00	615237.5921	1520959.4849
L	16+20.00	87.00	615245.0407	1520985.4463
L	16+44.80	-172.88	615479.5056	1520870.6569
L	16+50.00	76.00	615270.1074	1521005.2620
L	16+57.00	-197.07	615506.5090	1520868.3999
L	16+91.00	-105.00	615445.8196	1520945.5356
L	16+96.00	-116.00	615457.8101	1520944.0437
L	17+01.00	113.00	615265.2473	1521068.8822
L	17+01.00	76.00	615296.7826	1521048.7296
L	17+14.00	-107.00	615459.5542	1520964.0926
L	17+15.81	113.00	615272.9914	1521088.7013
L	17+31.00	-162.00	615515.3227	1520949.6144
L	17+44.25	262.00	615160.8790	1521182.8839
L	17+58.00	256.00	615173.1811	1521191.4589
L	17+61.00	-112.00	615488.3988	1521001.5357
L	17+69.00	270.00	615167.0023	1521208.1569
L	17+72.00	260.50	615176.6683	1521205.7449
L	17+90.00	101.00	615322.0259	1521137.6609
L	18+10.00	96.00	615336.7483	1521152.0918
L	18+10.00	68.00	615360.6129	1521137.4466
L	18+45.00	-121.00	615540.0052	1521068.4220
L	18+79.00	-124.00	615560.3456	1521095.8313
L	21+38.00	-200.00	615760.5892	1521276.8271
L	21+74.14	-191.34	615772.1140	1521312.1580
L	23+75.90	-143.00	615836.4781	1521509.4755
L	24+39.00	-128.00	615856.4302	1521595.8414
L	24+57.00	-118.00	615896.7825	1521589.8941
L	25+46.00	68.00	615752.2035	1521766.7755
L	25+49.00	98.00	615729.8262	1521787.0075
L	25+69.00	98.00	615742.5481	1521804.1758
L	25+69.00	68.00	615766.5265	1521786.1470
L	25+85.00	-115.00	615921.7035	1521687.8835
L	25+88.00	101.00	615752.4811	1521822.1543
L	25+88.00	68.00	615778.5919	1521801.9745
L	26+06.00	115.00	615753.3910	1521846.0260
L	26+18.00	99.00	615773.9411	1521846.1017
L	26+18.00	78.00	615790.2845	1521832.9149
L	26+66.00	94.00	615810.6126	1521882.2243
L	26+74.00	68.00	615825.7842	1521851.2553
L	28+71.00	-93.00	616887.3682	1521895.6104
L	28+71.00	-58.62	616864.8195	1521921.5668

NOTES:

- THE CONTROL DATA FOR THIS PROJECT CAN BE FOUND ELECTRONICALLY BY SELECTING PROJECT CONTROL DATA AT: [HTTP://WWW.NCDOT.ORG/DOH/PRECONSTRUCT/HIGHWAY/LOCATION/PROJECT/](http://www.ncdot.org/DOH/PRECONSTRUCT/HIGHWAY/LOCATION/PROJECT/) THE FILES TO BE FOUND ARE AS FOLLOWS:
B5136_LS_CONTROL.TXT
B5136_LS_LOCAL.TXT
- SITE CALIBRATION INFORMATION HAS NOT BEEN PROVIDED FOR THIS PROJECT. IF FURTHER INFORMATION IS NEEDED, PLEASE CONTACT THE LOCATION AND SURVEYS UNIT.
- PROJECT CONTROL ESTABLISHED USING GLOBAL POSITIONING SYSTEM, UTILIZING THE NCGS RTN SYSTEM (VRS).
MONUMENTS USED OR SET FOR PROJECT CONTROL BY THE NCDOT LOCATION AND SURVEYS UNIT:
● INDICATES GEODETIC CONTROL MONUMENTS FOR HORIZONTAL CONTROL
■ INDICATES BASELINE MONUMENTS FOR HORIZONTAL PROJECT CONTROL
▲ INDICATES BENCHMARKS FOR VERTICAL CONTROL

.....
 BM1 ELEVATION = 699.89
 N 616010 E 1522386
 L STATION 30+83 347 RIGHT
 EXISTING RR SPIKE IN BASE OF POWER POLE

 BM2 ELEVATION = 690.62
 N 615854 E 1521659
 L STATION 25+17 77 LEFT
 EXISTING RR SPIKE IN BASE OF POWER POLE

 BM3 ELEVATION = 687.72
 N 615429 E 1521335
 L STATION 20+14 113 RIGHT
 RR SPIKE IN BASE OF 24" OAK

 BM4 ELEVATION = 663.26
 N 615032 E 1520642
 L STATION 12+16 89 RIGHT
 RR SPIKE IN BASE OF 24" OAK

 JAS54 ELEVATION = 714.48
 N 615456 E 1522993
 L STATION 30+06 1161 RIGHT
 54 JAS 1966

ROW MARKER IRON PIN AND CAP				
ALIGN	STATION	OFFSET	NORTH	EAST
L	12+68.00	84.38	615063.1626	1520684.0641
L	13+00.00	62.00	615098.9744	1520699.6324
L	13+15.00	-94.94	615232.0571	1520635.5614
L	13+75.00	68.00	615133.0888	1520766.6936
L	13+75.00	62.00	615138.2026	1520763.5553
L	13+95.00	-70.00	615261.1679	1520711.5596
L	16+02.00	68.00	615251.8198	1520960.1670
L	16+02.00	76.00	615245.0013	1520964.3513
L	16+12.00	68.00	615257.0502	1520968.6900
L	17+00.00	68.00	615303.0780	1521043.6529
L	17+15.78	75.00	615384.5124	1521061.3253
L	17+57.00	68.00	615324.7764	1521095.1696
L	17+75.00	68.00	615342.3853	1521107.6159
L	18+00.00	-70.00	615473.0006	1521056.7435
L	19+10.00	-105.50	615560.7923	1521131.9291
L	19+10.00	-70.00	615530.5354	1521150.4971
L	20+30.55	68.00	615475.9703	1521325.4228
L	21+06.96	-70.00	615633.5524	1521318.3644
L	22+59.16	68.00	615595.5427	1521520.2675
L	23+34.46	-68.00	615750.8411	1521513.3114
L	24+33.95	68.00	615686.9658	1521669.2423
L	24+33.95	-68.00	615802.8794	1521598.1084
L	27+00.00	-68.00	615959.8021	1521806.2185
L	27+30.00	-90.00	615990.0675	1521886.4496
L	27+57.00	68.00	615894.8453	1521935.3384
L	27+57.00	97.00	615874.1464	1521955.6499
L	28+00.00	-90.00	616036.2708	1521853.0112
L	28+30.00	-58.98	616035.7511	1521895.0927
L	28+37.00	94.00	615937.6639	1522012.6978
L	28+42.00	68.00	615959.0535	1521997.0008
L	29+73.32	68.00	616065.1343	1522084.4935
L	30+55.01	167.55	616079.8792	1522216.7791
L	30+82.54	-56.05	616225.8513	1522045.0099

NOTE: DRAWING NOT TO SCALE

9/21/12
12-JAN-2015 09:55 A5136-1s-1c.dgn