

09/08/99

See Sheet 1-A For Index of Sheets

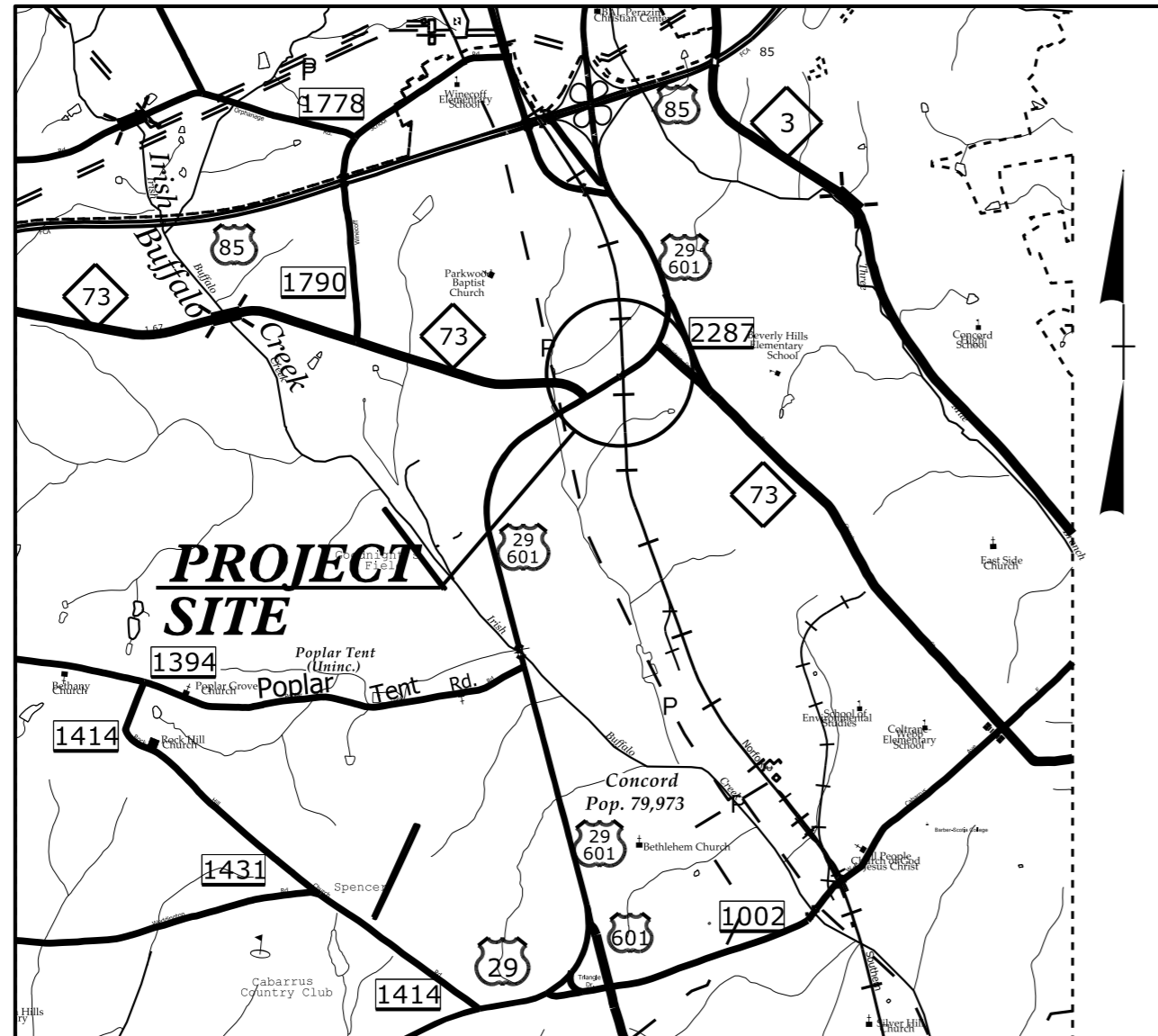

VICINITY MAP

STATE OF NORTH CAROLINA  
DIVISION OF HIGHWAYS

**CABARRUS COUNTY**

LOCATION: BRIDGES 66 AND 69 OVER NORFOLK SOUTHERN RAILROAD ON US 29/US 601

TYPE OF WORK: GRADING, DRAINAGE, PAVING, STRUCTURES, SIGNALS, LIGHTING AND RETAINING WALLS

| STATE           | STATE PROJECT REFERENCE NO. | SHEET NO.   | TOTAL SHEETS |
|-----------------|-----------------------------|-------------|--------------|
| N.C.            | B-5136                      | 1           |              |
| STATE PROJ. NO. | F.A. PROJ. NO.              | DESCRIPTION |              |
| 42295.1.1       | BRSTP-0029(43)              | PE          |              |
| 42295.2.1       | BRSTP-0029(43)              | RW & UTIL   |              |
| 42295.3.FR1     | BRSTP-0029(43)              | CONST.      |              |

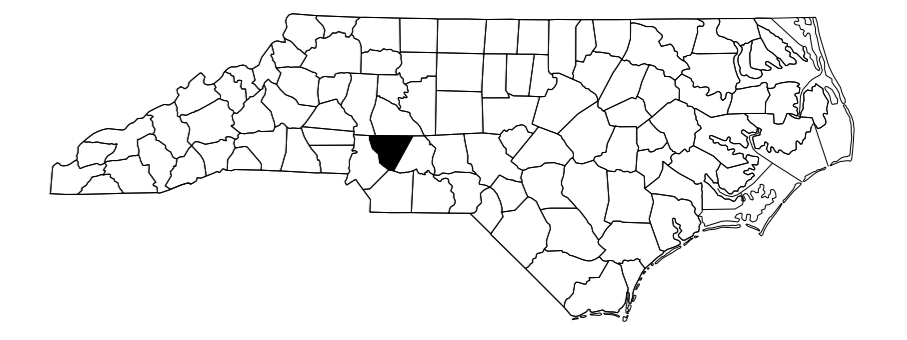

TIP PROJECT: B-5136

CONTRACT: C203565

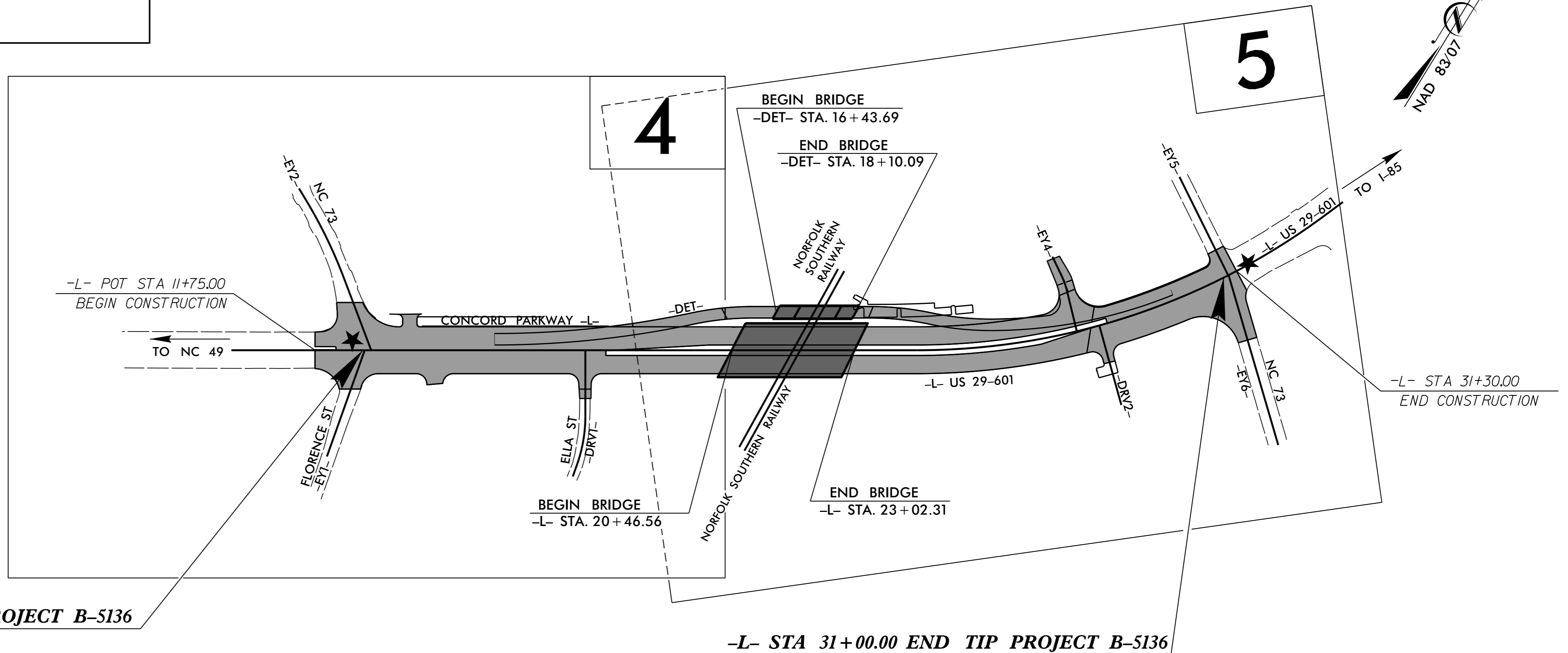

★ TRAFFIC SIGNAL

GRAPHIC SCALES

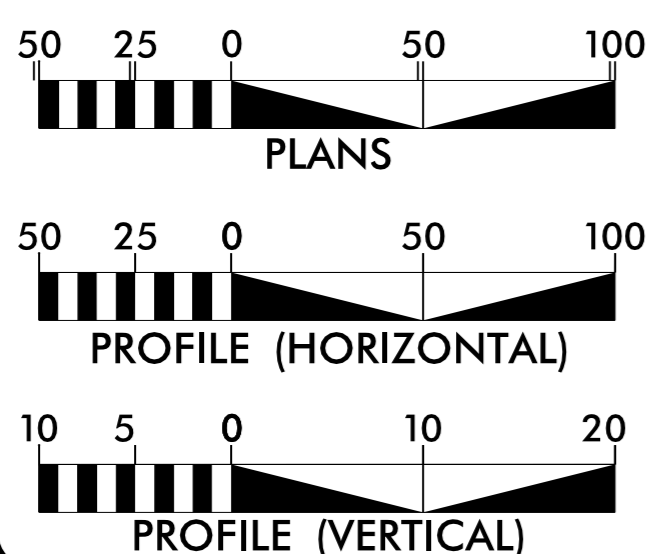

DESIGN DATA

ADT 2015 = 33,400  
ADT 2035 = 54,800  
K = 10 %  
D = 55 %  
T = 6 % \*  
V = 50 MPH  
\* TTST = 2% DUAL 4%  
FUNC CLASS = PRINCIPAL ARTERIAL REGIONAL TIER

PROJECT LENGTH

LENGTH ROADWAY TIP PROJECT B-5136 = 0.297 MILES  
LENGTH STRUCTURE TIP PROJECT B-5136 = 0.049 MILES  
TOTAL LENGTH TIP PROJECT B-5136 = 0.346 MILES

Prepared in the Office of:  
**DIVISION OF HIGHWAYS**  
1000 Birch Ridge Dr., Raleigh NC, 27610

2012 STANDARD SPECIFICATIONS

RIGHT OF WAY DATE:  
APRIL 23, 2013

LETTING DATE:  
AUGUST 18, 2015

G. E. BREW, P.E.  
PROJECT ENGINEER

I. T. YOUNIS  
PROJECT DESIGN ENGINEER

HYDRAULICS ENGINEER

DocuSigned by:  
Karen Hejner  
5/7/2015 P.E.

ROADWAY DESIGN ENGINEER

DocuSigned by:  
Gregory Brew  
5/7/2015 P.E.

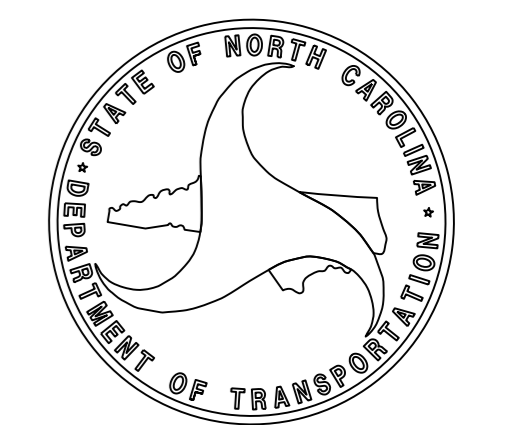
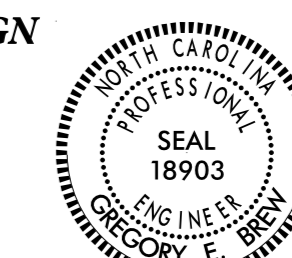

06-MAY-2015 08:50 R:\Roadway\Proj\B5136\_Rdy\_Tsh.dgn \$\$\$USERNAME\$\$\$