

-L-		
PI Sta 68+65.96	PI Sta 71+51.45	PI Sta 75+57.55
$\Delta = 33^{\circ} 17' 38.1''$ (LT)	$\Delta = 19^{\circ} 33' 27.9''$ (LT)	$\Delta = 5^{\circ} 21' 30.0''$ (RT)
D = 16' 51' 06.1"	D = 5' 12' 31.3"	D = 3' 10' 59.2"
L = 197.57'	L = 375.48'	L = 168.34'
T = 101.66'	T = 189.59'	T = 84.23'
R = 340.00'	R = 1,000.00'	R = 1,800.00'

-DR4- PC Sta. 10+30.32  
 CLASS 'B' RIP RAP  
 8 TONS RR  
 10 S.Y.F.F.

-DR4- PT Sta. 10+65.74  
 87'X63' CSPA WHW

END CONSTRUCTION  
 -DR4- Sta. 10+62.50

-DR4-  
 PI Sta 10+51.74  
 $\Delta = 81^{\circ} 09' 37.6''$  (RT)  
 D = 229' 10" 59.2"  
 L = 35.41'  
 T = 21.41'  
 R = 25.00'

STA 67+46-L(LT)  
 REMOVE EX 12' CMP  
 AND CONCRETE  
 HEADWALLS.

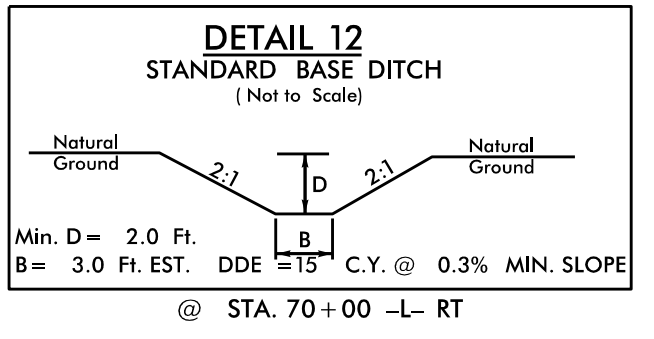

Z CLAIM DETAILS FOR PARCELS 54, AND 56

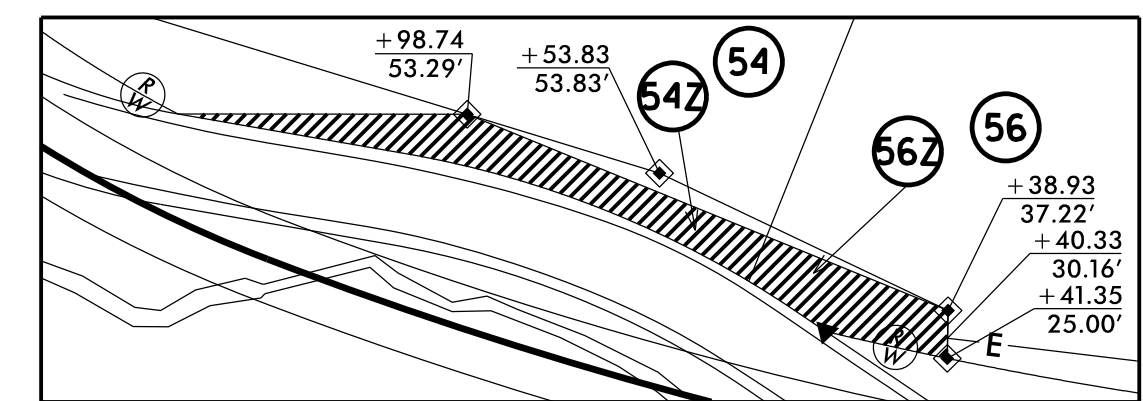

PARCELS 54 AND 56

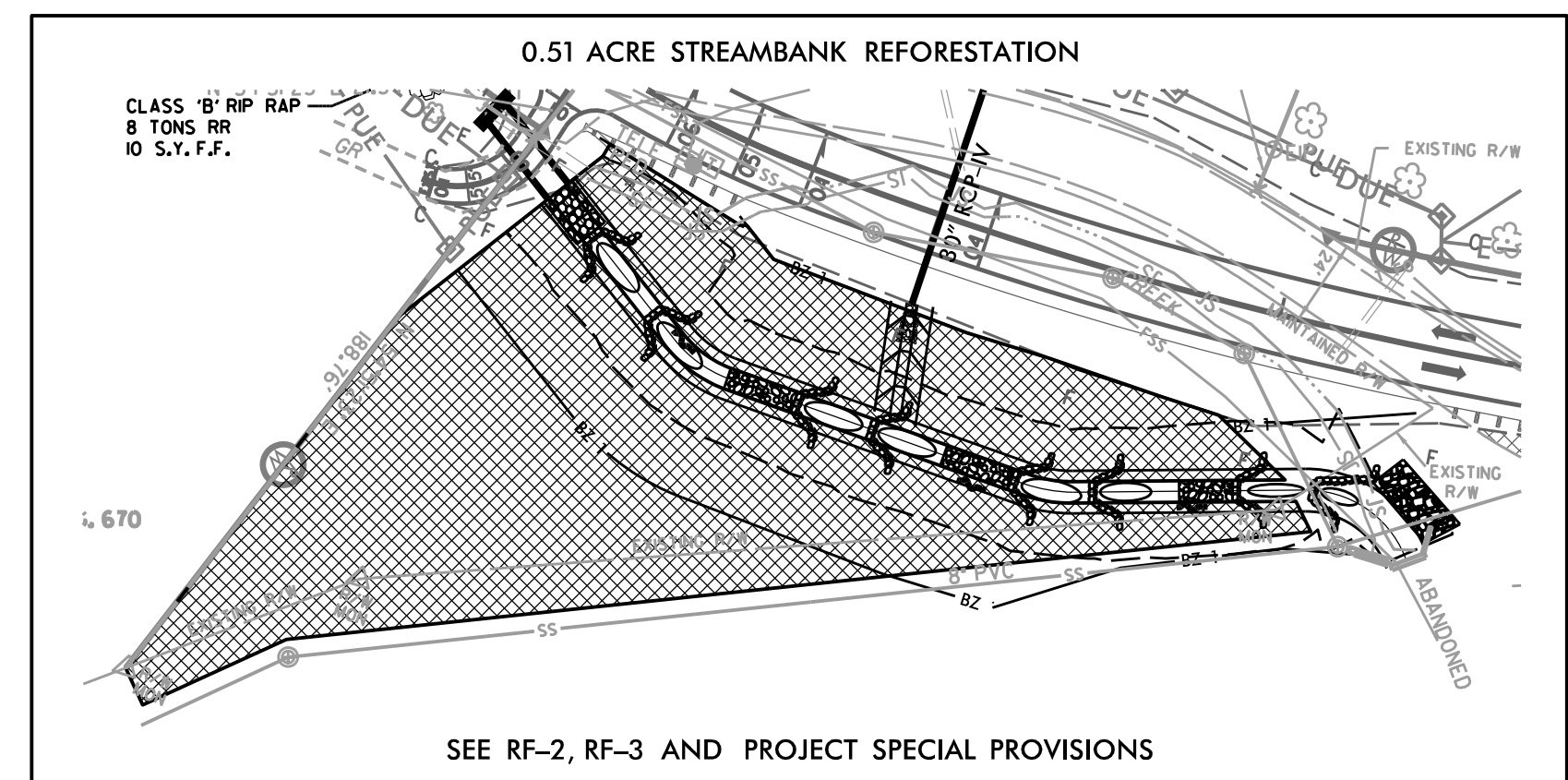

SEE SHEETS UTL-1 THROUGH UTL-2 FOR UTILITY DESIGN PLANS.

SEE SHEETS OSM-1 THROUGH OSM-11 FOR STREAM RELOCATION PLANS.

RADIUS AT DRIVEWAYS ARE 10' UNLESS SHOWN OTHERWISE

REMOVAL OF EXISTING ASPHALT PAVEMENT

NOTE: SEE PLAN SHEET 11 FOR -L- PROFILE  
 NOTE: SEE PLAN SHEET 12 FOR -DR4- PROFILE