

**This electronic collection of documents is provided  
for the convenience of the user  
and is Not a Certified Document –**

**The documents contained herein were originally issued  
and sealed by the individuals whose names and license  
numbers appear on each page, on the dates appearing  
with their signature on that page.**

**This file or an individual page  
shall not be considered a certified document.**

# DUPLIN COUNTY

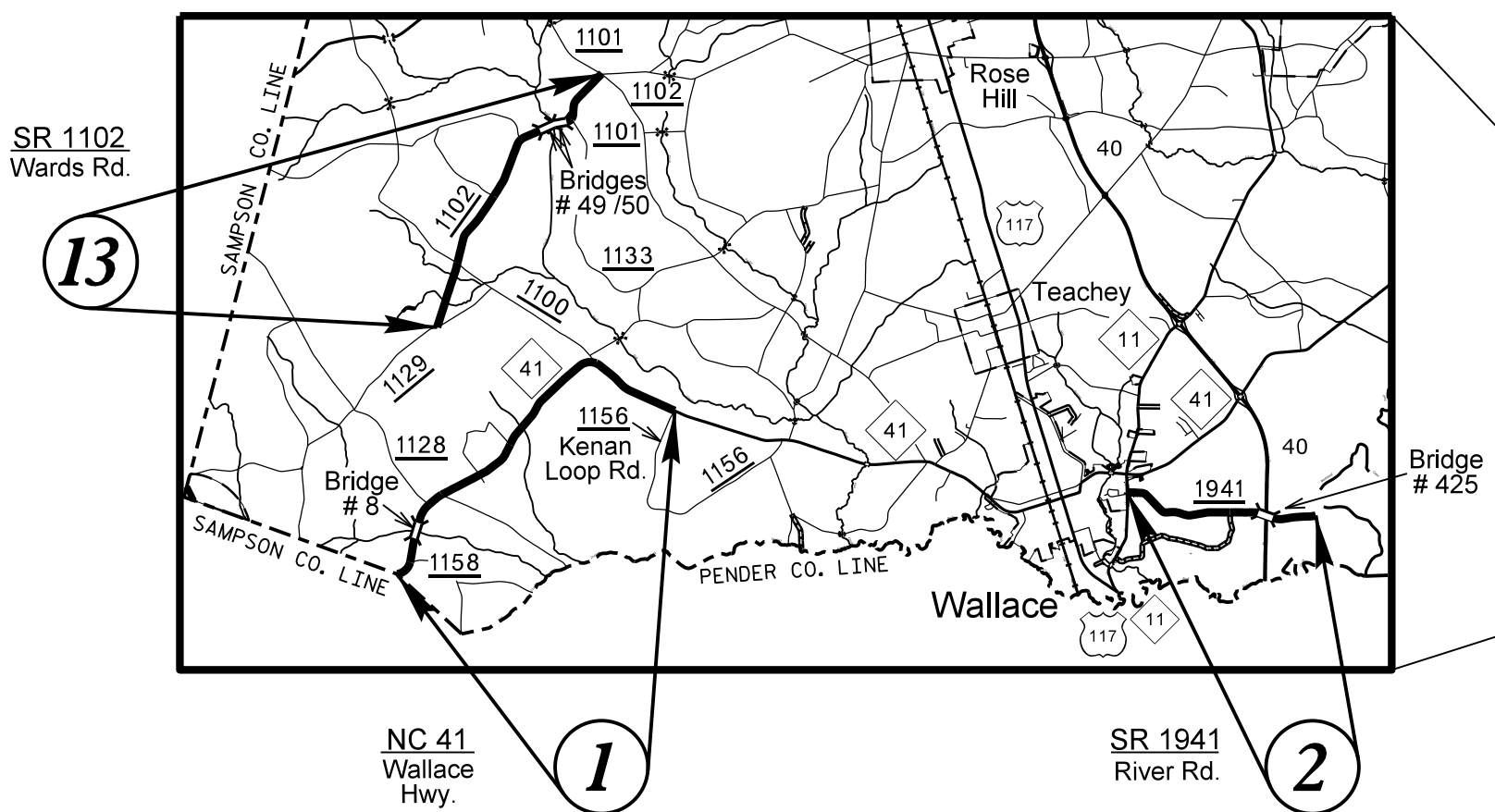
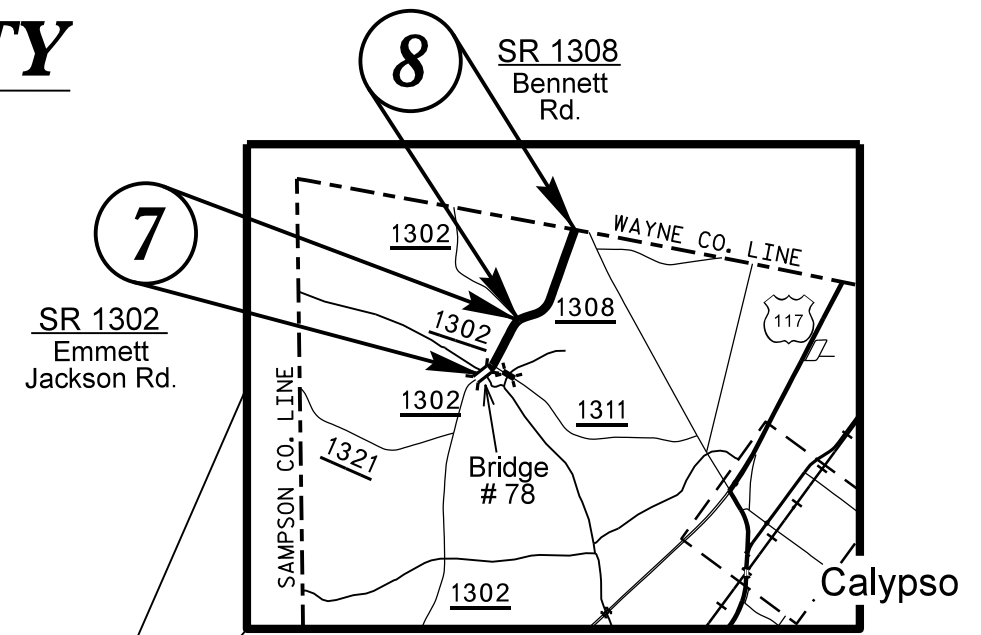
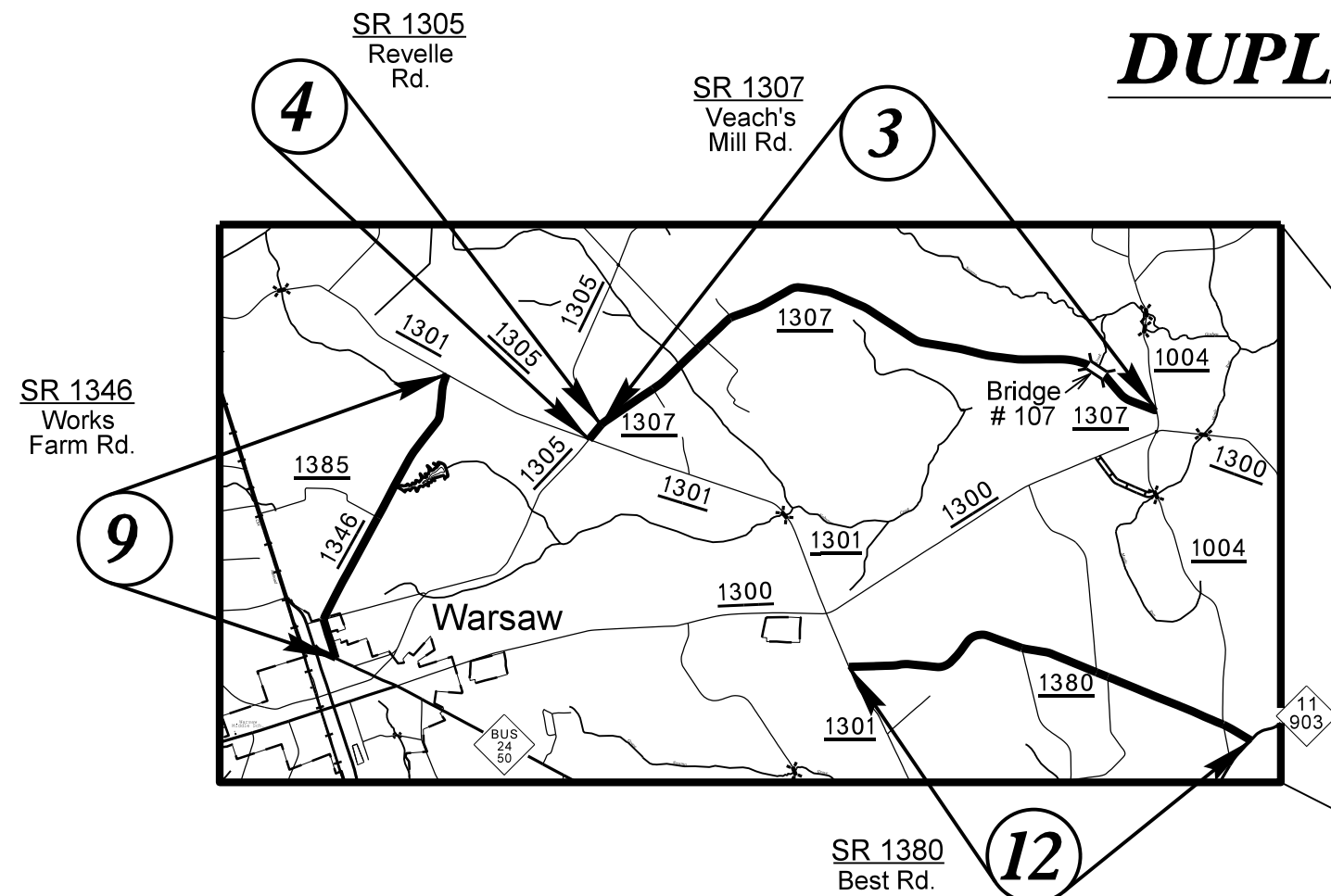

MAPS N.T.S.

C:\JUN-2015\1441 Data\2016 Resurfacing\Duplin & Sampson County\3CR\10311.176, Etc...Duplin\_Sampson\RALEIGH REVISIONS\_NEW\_WBS\_NDS\_060115\2016CPT.03.01.10311.1.Etc...Rdy\_TSH.dgn  
 8/17/99  
 REVISIONS

# DUPLIN COUNTY - CONT.

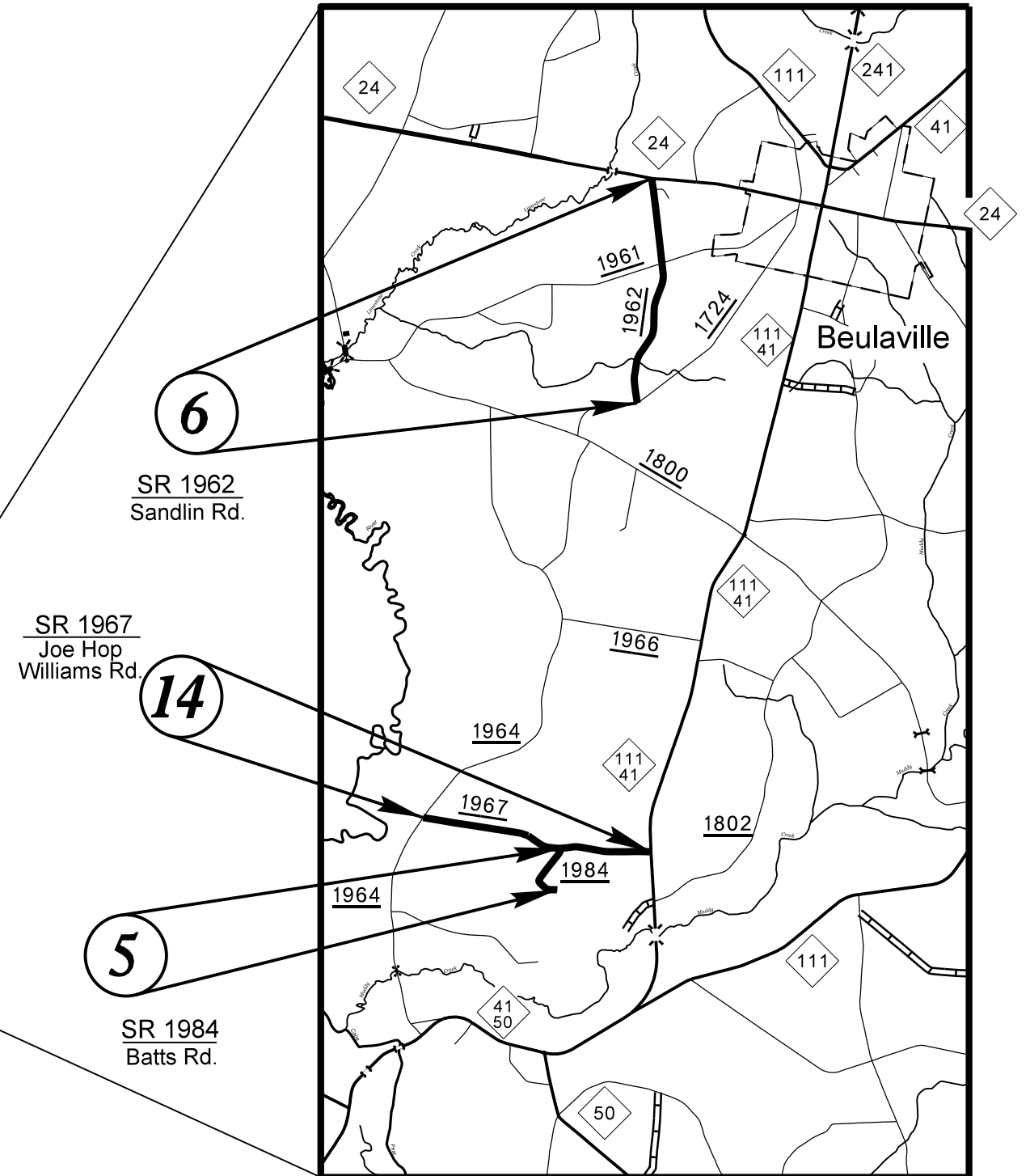
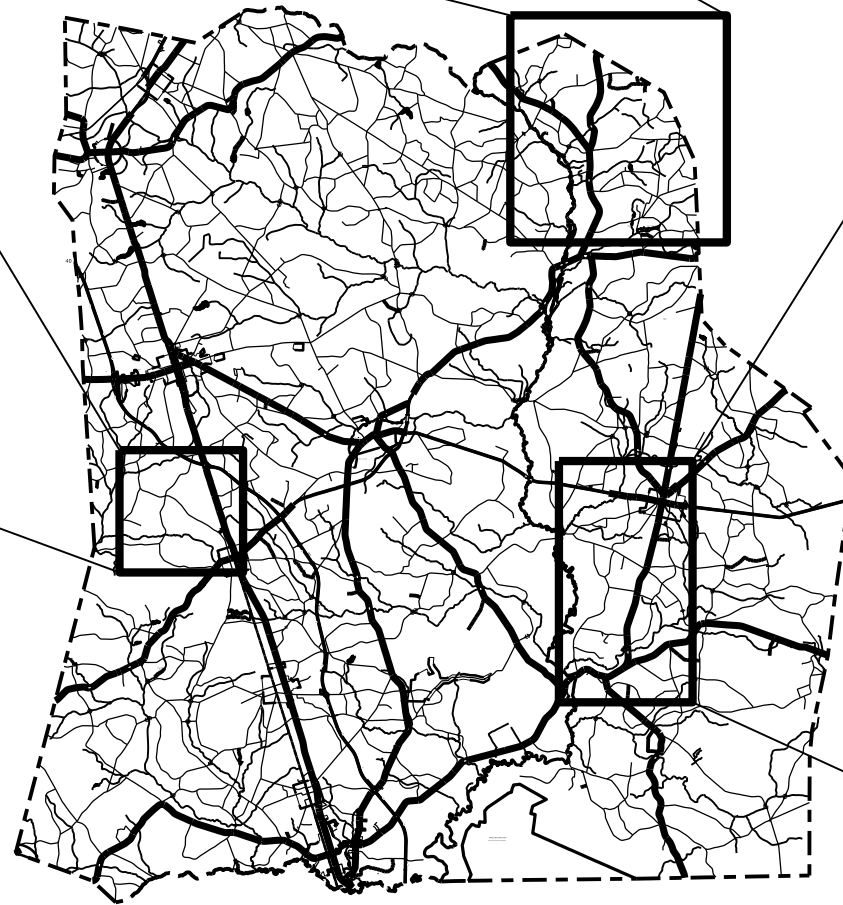
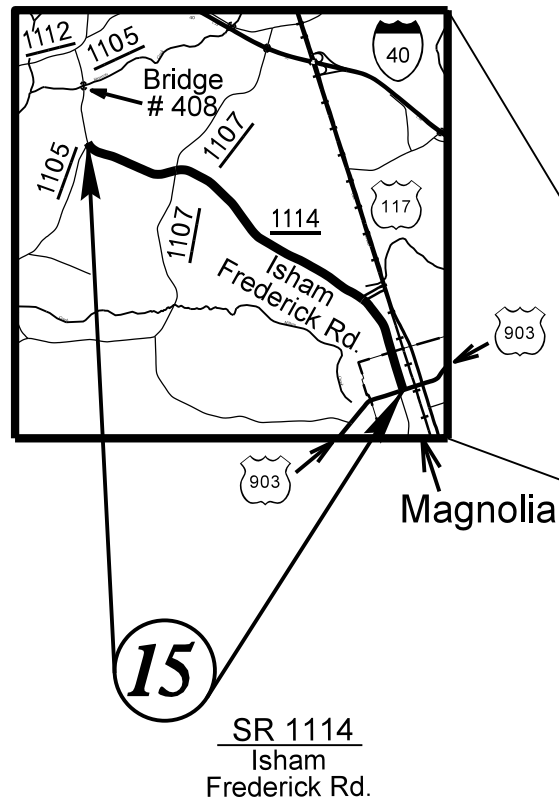
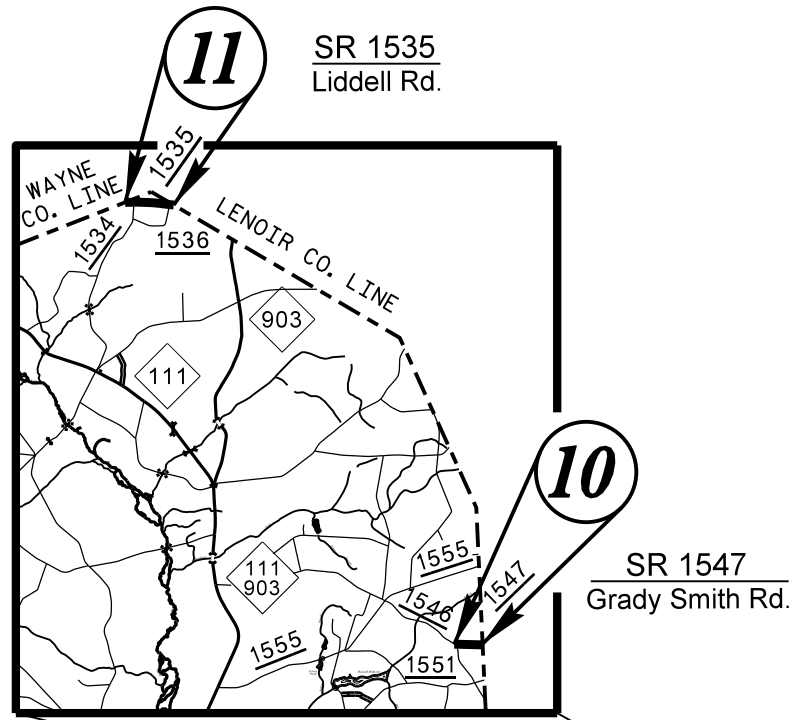

MAPS N.T.S.

REVISIONS

01-JUN-2016 14:43 C:\Resurfacing\Duplin & Simpson County\3CR\10311.176, Etc...Duplin\_Simpson\RALEIGH REVISIONS\_NEW\_WBS\_NDS\_060115\2016CPT.03.01.10311.1.Etc...Rdy\_TSH.dgn 8/17/99

# SAMPSON COUNTY

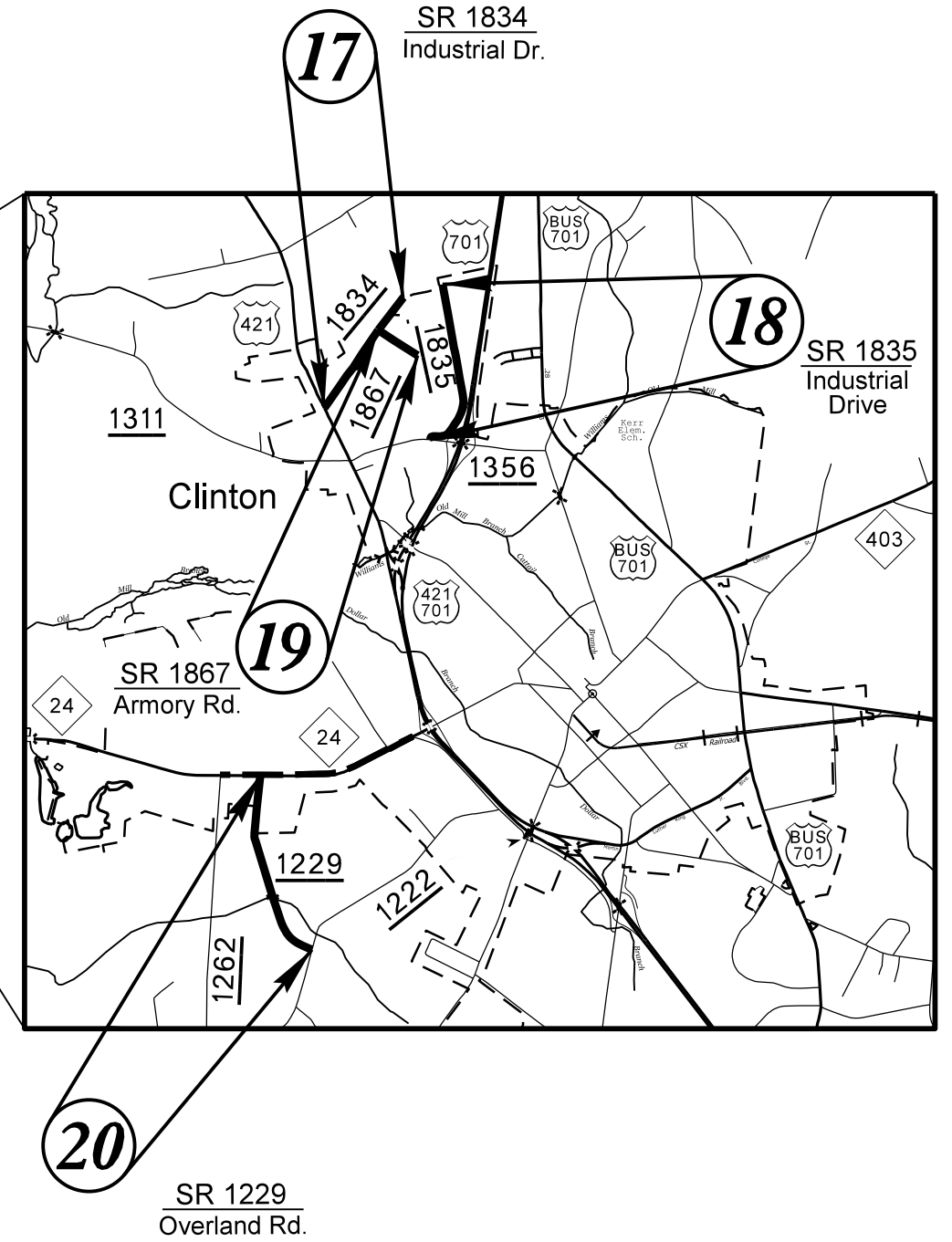
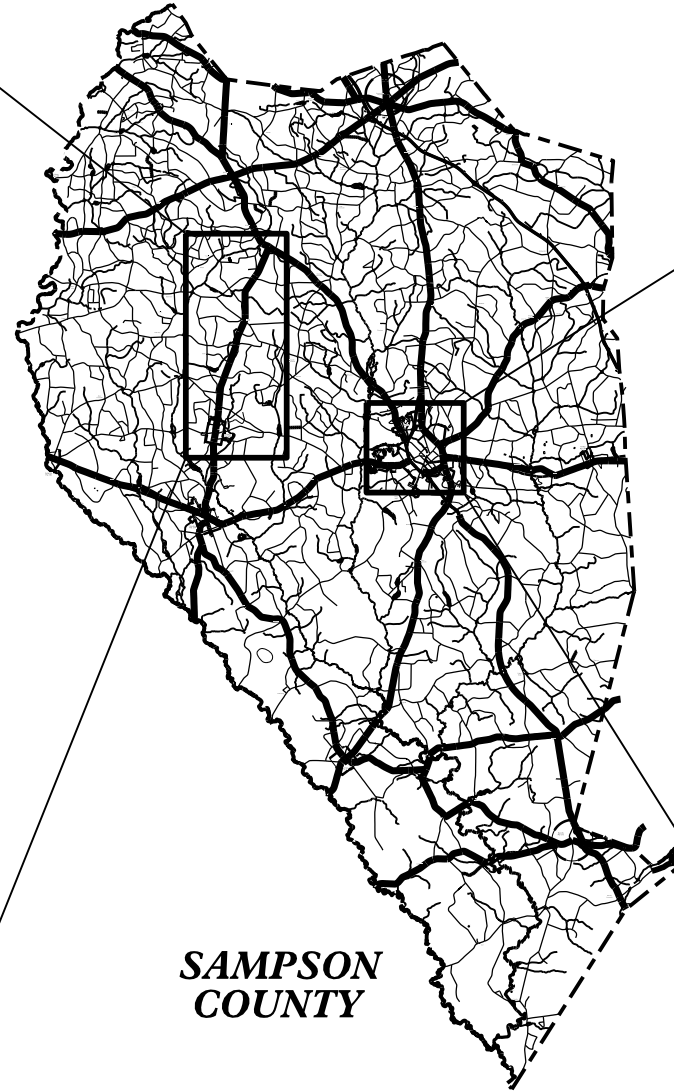
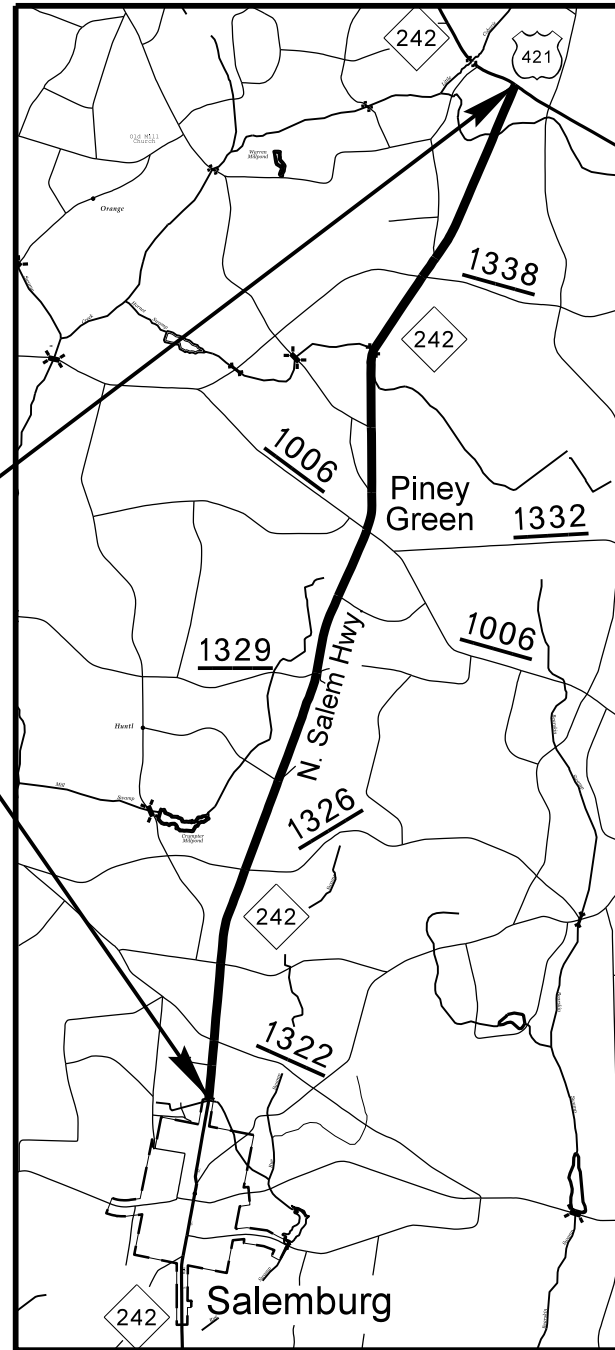

REVISIONS  
 C:\JUN-2015\_1443\_Data\2016\_Resurfacing\Dupl.in 8 Sampson County\3CR.10311.176, Etc., Dupl.in Sampson\RALEIGH REVISIONS\_NEW\_WBS\_NDS\_060115\2016CPT.03.01.10311.1, Etc., Rdy\_TSH.dgn  
 \$\$\$SUSPENSE\$\$\$

MAPS N.T.S.

# SAMPSON COUNTY - CONT.

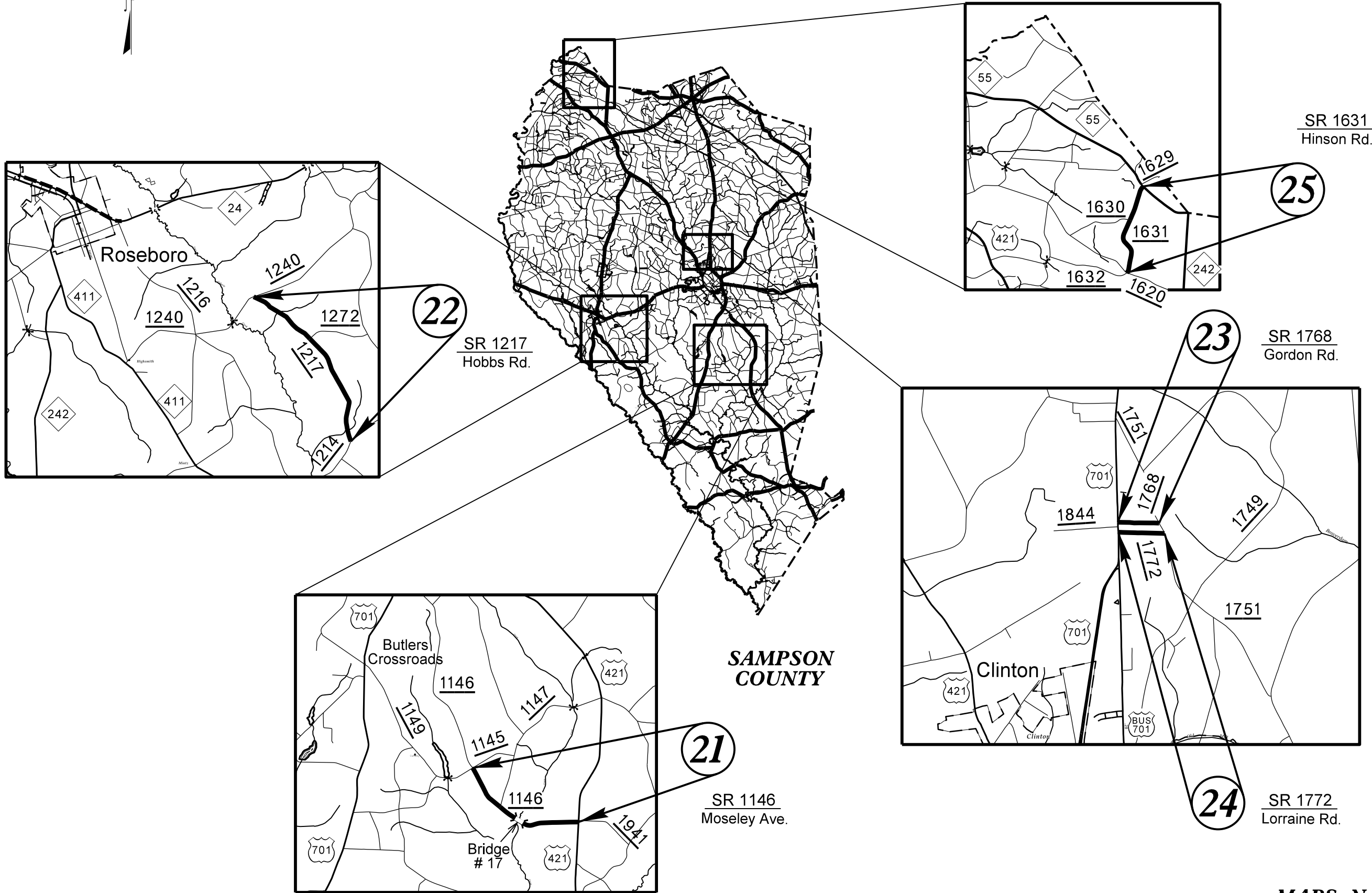

REVISIONS  
 01-JUN-2016 14:44 Data\2016 Resurfacing\Dupl.in & Sampson County\3CR.10311.176, Etc., Dupl.in Sampson\RALEIGH REVISIONS\_NEW\_WBS\_NDS\_060115\2016CPT.03.01.10311.1.Etc., Rdy., TSH.dgn  
 \$\$\$SUSERRNGM\$\$\$

**MAPS N.T.S.**

8/17/99  
 REVISIONS  
 C:\JUN-2015\14504 Data\2016 Resurfacing\Duplin & Sampson County\3CR\10311.176, Etc...Duplin\_Sampson\RALEIGH REVISIONS\_NEW\_WBS\_NDS\_060115\2016CPT.03.01.10311.1, Etc..Rdy...TYP.dgn  
 \$\$\$BLSERNAME\$\$\$

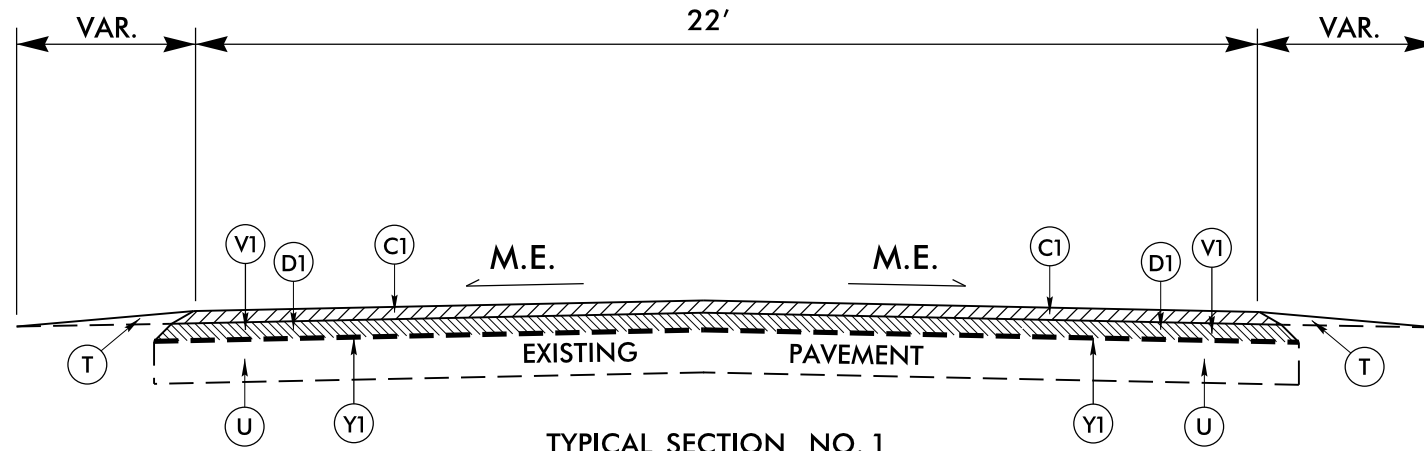

**TYPICAL SECTION NO. 1**  
 MAP NO. 1  
 NC 41 (WALLACE HWY.)  
 MP 0.00 – MP 5.42  
 (NO WORK BRIDGE #8  
 MP 0.70 – MP 0.72

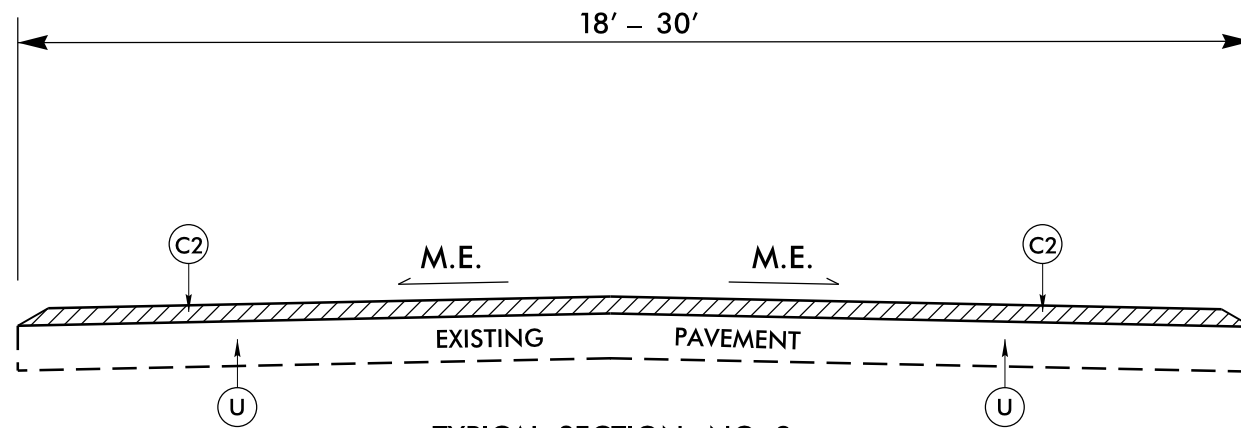

**TYPICAL SECTION NO. 2**

PAVEMENT SCHEDULE	
C1	PROP. APPROX. 1½" DEPTH ASPHALT CONCRETE SURFACE COURSE, TYPE S9.5B, AT AN AVERAGE RATE OF 168 LBS. PER SQ.YD.
C2	PROP. APPROX. 1½" DEPTH ASPHALT CONCRETE SURFACE COURSE, TYPE SF9.5A, AT AN AVERAGE RATE OF 165 LBS. PER SQ.YD.
C3	PROP. APPROX. 1" DEPTH ASPHALT CONCRETE SURFACE COURSE, TYPE SF9.5A, AT AN AVERAGE RATE OF 110 LBS. PER SQ.YD.
D1	PROP. APPROX. 2½" DEPTH ASPHALT CONC.INTERMEDIATE COURSE TYPE I19.0B, AT AN AVERAGE RATE OF 285 LBS.PER SQ.YD.
E1	PROP. APPROX. 4" DEPTH ASPHALT CONCRETE SURFACE COURSE, TYPE B25.0B, AT AN AVERAGE RATE OF 456 LBS. PER SQ.YD.
E2	PROP. APPROX. 5½" DEPTH ASPHALT CONCRETE SURFACE COURSE, TYPE B25.0B, AT AN AVERAGE RATE OF 627 LBS. PER SQ.YD.
R1	EXISTING CONCRETE BRIDGE RAIL
T	EARTH MATERIAL (SHOULDER RECONSTRUCTION)
U	EXISTING PAVEMENT
V1	MILLING BITUMINOUS PAVEMENT 2" DEPTH
V2	MILLING BITUMINOUS PAVEMENT 1" DEPTH
Y1	PAVEMENT INTERLAYER

NOTE: PLACE PAVEMENT INTERLAYER PRIOR TO RESURFACING. SEE PROJECT SPECIAL PROVISIONS

PAVEMENT EDGE SLOPES ARE 1:1, EXCEPT FINAL SURFACE COURSE. SEE SHOULDER WEDGE DETAIL.

SEE STD. DRAWING 1205.01, SHEET 2 OF 2, TABLE 1 FOR EDGE LINE OFFSETS.

M.E. = MATCH EXISTING

**DUPLIN CO.**

MAP NO. 2  
 SR 1491 (RIVER RD.)  
 MP 0.00 – MP 2.68  
 (NO WORK BRIDGE #425  
 MP 1.94 – MP 1.99)

MAP NO. 3  
 SR 1307 (VEACH'S MILL RD.)  
 MP 0.00 – MP 4.39

MAP NO. 4  
 SR 1305 (REVELLE RD.)  
 MP 3.52 – MP 3.71

MAP NO. 5  
 SR 1984 (BATTS RD.)  
 MP 0.00 – MP 0.47

MAP NO. 6  
 SR 1962 (SANDLIN RD.)  
 MP 0.00 – MP 1.79

MAP NO. 7  
 SR 1302 (EMMETT JACKSON RD.)  
 MP 2.69 – MP 3.20  
 (NO WORK BRIDGE #78  
 MP 2.66 – MP 2.69)

MAP NO. 8  
 SR 1308 (BENNETT RD.)  
 MP 0.00 – MP 0.78

MAP NO. 10  
 SR 1547 (GRADY SMITH RD.)  
 MP 0.00 – MP 0.41

MAP NO. 11  
 SR 1535 (LIDDELL RD.)  
 MP 0.00 – MP 0.72

MAP NO. 12  
 SR 1380 (BEST RD.)  
 MP 0.00 – MP 4.39

MAP NO. 13  
 SR 1102 (WARDS RD.)  
 MP 10.23 – MP 11.07  
 MP 11.13 – MP 11.20  
 MP 11.22 – MP 11.28  
 MP 11.29 – MP 11.63  
 MP 11.85 – MP 12.44  
 MP 12.57 – MP 14.53

MAP NO. 14  
 SR 1967  
 (JOE HOP WILLIAMS RD.)  
 MP 0.00 – MP 1.80

MAP NO. 15  
 SR 1114 (ISHAM FREDERICK RD.)  
 MP 0.00 – MP 4.56

**SAMPSON CO.**

MAP NO. 17  
 SR 1834 (INDUSTRIAL DR.)  
 MP 0.00 – MP 0.10

MAP NO. 18  
 SR 1835 (INDUSTRIAL DR.)  
 MP 0.00 – MP 0.93

MAP NO. 19  
 SR 1867 (ARMORY RD.)  
 MP 0.12 – MP 0.24

MAP NO. 20  
 SR 1229 (OVERLAND RD.)  
 MP 0.00 – MP 0.95

MAP NO. 21  
 SR 1146 (MOSELEY AVE.)  
 MP 0.60 – MP 1.45  
 (NO WORK BRIDGE #17  
 MP 1.13 – MP 1.14)

MAP NO. 22  
 SR 1217 (HOBBS RD.)  
 MP 0.00 – MP 0.27  
 MP 0.82 – MP 3.00

MAP NO. 23  
 SR 1768 (GORDON RD.)  
 MP 0.00 – MP 0.34

MAP NO. 24  
 SR 1772 (LORRAINE RD.)  
 MP 0.00 – MP 0.38

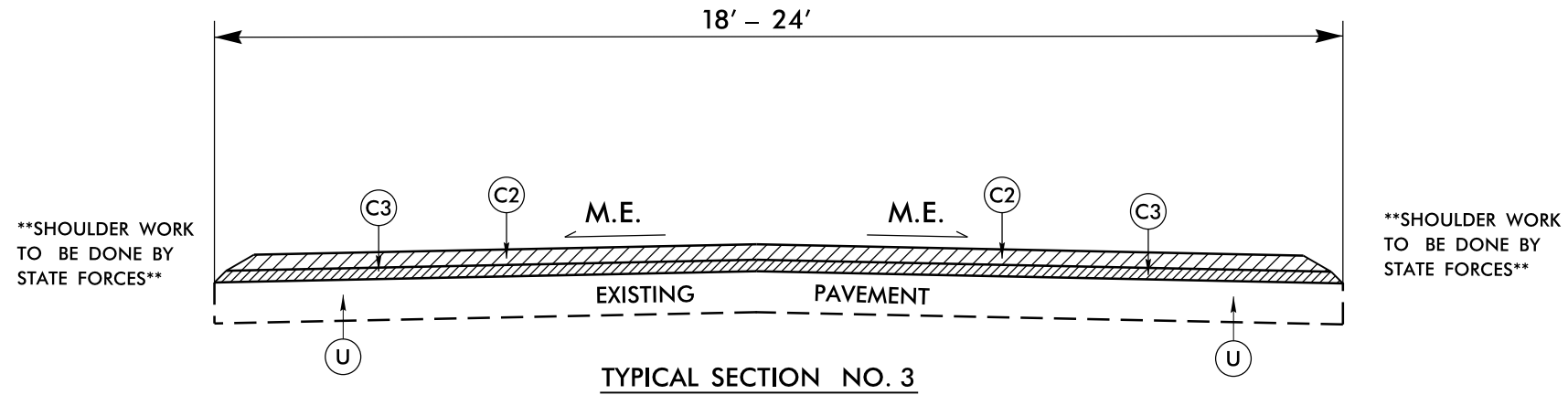

DUPLIN CO.

MAP NO. 3  
 SR 1307 (VEACH'S MILL RD.)  
 MP 4.39 – MP 6.39  
 (NO WORK BRIDGE #107  
 MP 5.66 – MP 5.68)

MAP NO. 9  
 SR 1346 (WORKS FARM RD.)  
 MP 0.00 – MP 3.20

SAMPSON CO.

MAP NO. 17  
 SR 1834 (INDUSTRIAL DR.)  
 MP 0.10 – MP 0.47

MAP NO. 19  
 SR 1867 (ARMORY RD.)  
 MP 0.00 – MP 0.12

MAP NO. 21  
 SR 1146 (MOSELEY AVE.)  
 MP 0.00 – MP 0.60  
 MP 1.45 – MP 2.45

MAP NO. 22  
 SR 1217 (HOBBS RD.)  
 MP 0.27 – MP 0.82

MAP NO. 25  
 SR 1631 (HINSON RD.)  
 MP 0.00 – MP 1.75

PAVEMENT SCHEDULE	
C2	1½" SF9.5A
C3	1" SF9.5A
E1	4" B25.0B
U	EXISTING PAVEMENT

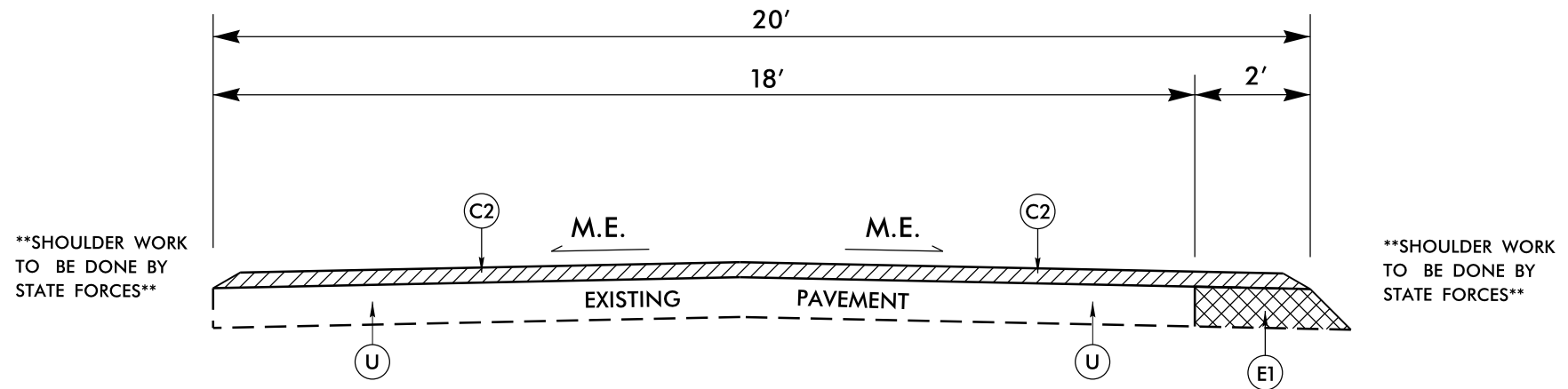

TYPICAL SECTION NO. 4

MAP NO. 13  
 SR 1102 (WARDS RD.)  
 MP 11.07 – MP 11.13  
 MP 12.44 – MP 12.57

NOTE: PAVEMENT EDGE SLOPES ARE 1:1, EXCEPT FINAL SURFACE COURSE. SEE SHOULDER WEDGE DETAIL.

SEE STD. DRAWING 1205.01, SHEET 2 OF 2, TABLE 1 FOR EDGE LINE OFFSETS.

M.E. = MATCH EXISTING

REVISIONS

8/17/99  
 O:\JUN-2015\1496 Data\2016 Resurfacing\Duplin & Sampson County\3CR\10311.176.Etc.\Duplin\_Sampson\RALEIGH REVISIONS\_NEW\_WBS\_NDS\_060115\2016CPT.03.01.10311.1.Etc.Rdy\_TYP.dgn  
 \$\$\$BLSRNGM\$\$\$







STATE OF NORTH CAROLINA  
 DEPT. OF TRANSPORTATION  
 DIVISION OF HIGHWAYS  
 RALEIGH, N.C.

ENGLISH DETAIL DRAWING FOR  
**MANHOLE AND VALVE BOX ADJUSTMENTS**

SHEET 1 OF 1  
**840D55**

**GENERAL NOTES:**

1. USE RAPID SET GROUT, MORTAR, OR CONCRETE WITH A MINIMUM COMPRESSIVE STRENGTH OF 4000 PSI.
2. REMOVE ALL FAULTY EXISTING BRICKWORK AND REPLACE WITH NEW BRICK MASONRY.
3. SHEER CUT EXCAVATION FOR THE ADJUSTMENT ON ALL SIDES.
4. FILL AREA BELOW 8" DEPTH WITH 78M OR NO. 57 CLEAN STONE.
5. MIX MORTAR TO NCDOT SPECIFICATIONS.
6. MORTAR JOINTS 1/2" +/- 1/8"

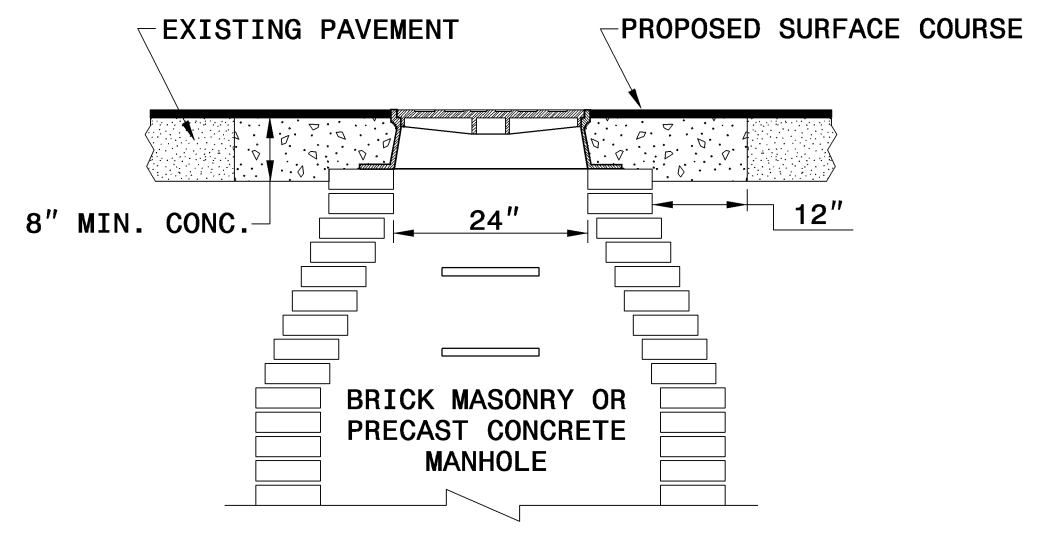

**MANHOLE CONCRETE ENCASEMENT**

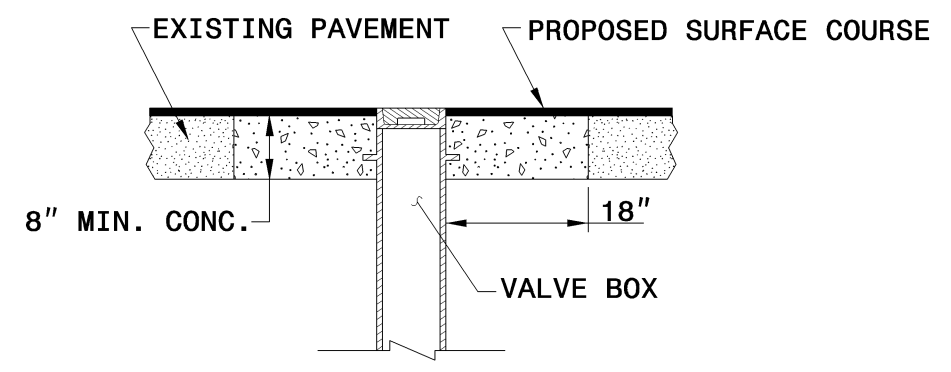

**VALVE BOX CONCRETE ENCASEMENT**

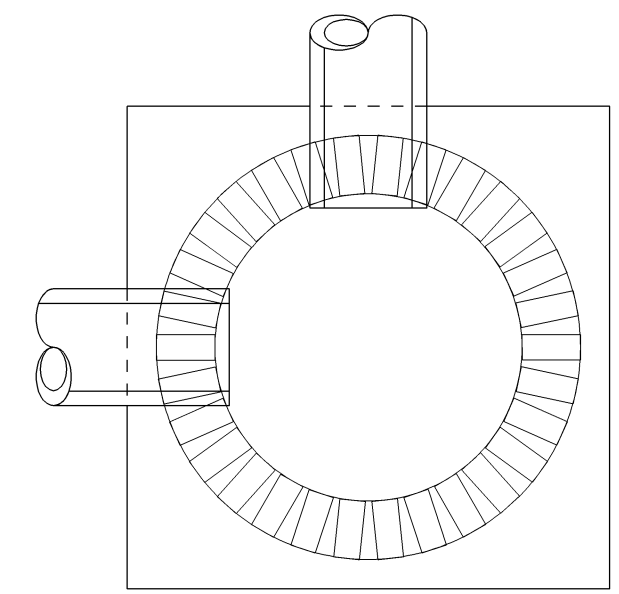

**ELEVATION VIEW**

PLACE BRICK ACCORDING TO ELEVATION VIEW

STATE OF NORTH CAROLINA  
 DEPT. OF TRANSPORTATION  
 DIVISION OF HIGHWAYS  
 RALEIGH, N.C.

ENGLISH DETAIL DRAWING FOR  
**MANHOLE AND VALVE BOX ADJUSTMENTS**

SHEET 1 OF 1  
**840D55**

**PROJECT SERVICES UNIT**  
**STANDARDS AND SPECIAL DESIGN**  
 Office 919-250-4128 FAX 919-250-4119

**SEE PLATE FOR TITLE**

ORIGINAL BY: \_\_\_\_\_ DATE: \_\_\_\_\_  
 MODIFIED BY: E.E. WARD DATE: \_\_\_\_\_  
 CHECKED BY: \_\_\_\_\_ DATE: \_\_\_\_\_  
 FILE SPEC.: /usr/details/stand/840d55.dgn

07-DEC-2005 14:25  
 S:\Contracts\2005\Standards\stand\840d55.dgn  
 ericward

- NOTES:  
 1) DETAIL DOES NOT APPLY TO OGAFc AND ULTRA-THIN BONDED WEARING COURSE.  
 2) BACKFILL SHOULDER WITH APPROVED MATERIAL.  
 3) THE SHOULDER WEDGE DEVICE MAY BE DISENGAGED AT PAVED DRIVEWAYS AND SIDE STREETS.

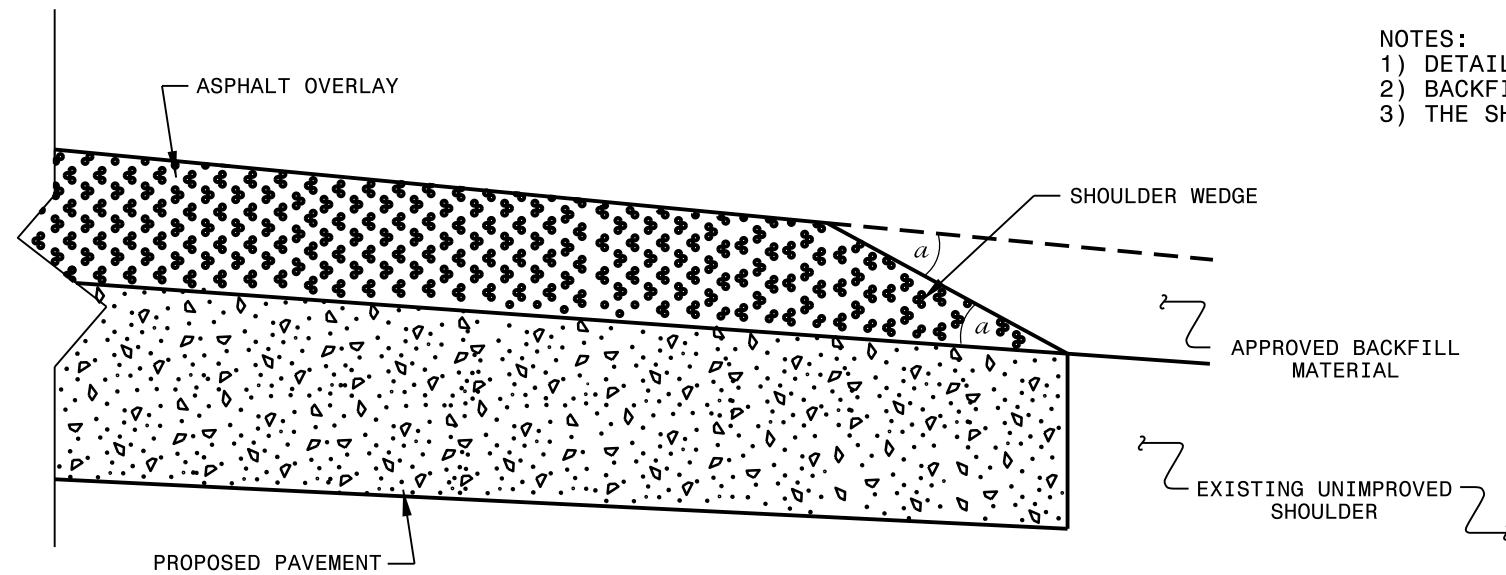

**SHOULDER WEDGE DETAIL**  
 (Resurfacing Projects w/ Widening or  
 with Existing Paved Shoulder having no dropoffs)

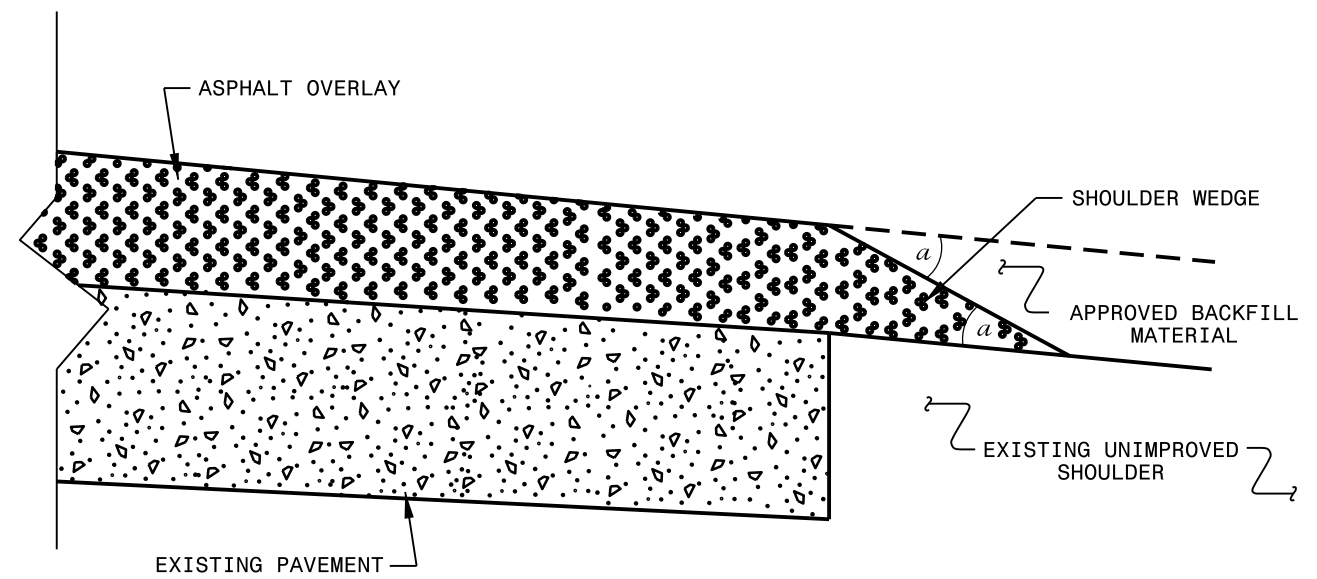

**SHOULDER WEDGE DETAIL**  
 (Resurfacing Projects w/ NO Widening)

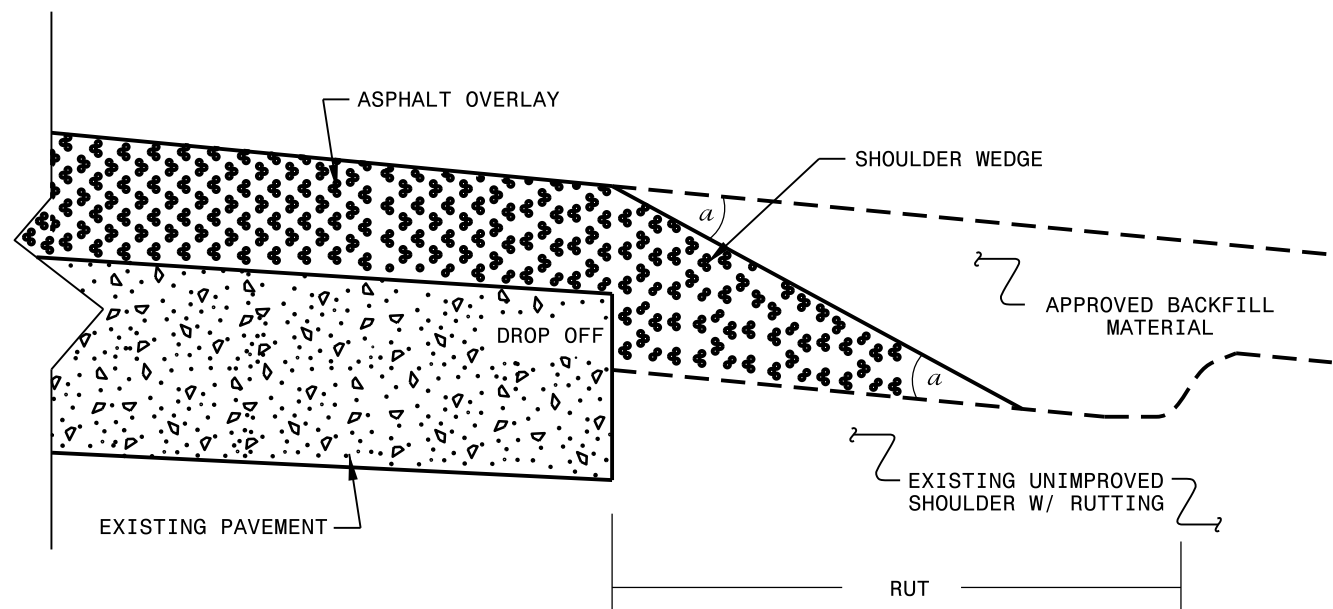

**SHOULDER WEDGE DETAIL**  
 (Resurfacing Adjacent to  
 Rutted Shoulder)

- SHOULDER WEDGE ANGLE = 30°

<b>CONTRACT STANDARDS AND DEVELOPMENT UNIT</b>			
Office 919-707-6950		FAX 919-250-4119	
<b>SHOULDER WEDGE DETAILS</b>			
ORIGINAL BY: T.SPELL	DATE: 7-19-11		
MODIFIED BY:	DATE: 10/16/12		
CHECKED BY:	DATE:		
FILE SPEC.: susr/details/stand/shoulderwedgedetail.dgn			

SYSTEMS DESIGN  
 USER NAME

PROJECT NO.	SHEET NO.	TOTAL NO.
2016CPT.03.01.10311.1, Etc.	11	

## SUMMARY OF QUANTITIES

PROJECT NO	COUNTY	MAP NO	ROUTE	DESCRIPTION	TYP	LANES	LANE TYPE	FINAL SURFACE TESTING REQUIRED	WARM MIX ASPHALT REQUIRED	LENGTH MI	WIDTH FT	BORROW EXCAVATION CY	INC. STONE BASE TONS	SHOULDER RECONST. SMI	2" MILLING SY	1" MILLING SY	INC. MILLING SY	BASE COURSE, B25.0B TONS	INT. COURSE, I19.0B TONS	SURFACE COURSE, S9.5B TONS	SURFACE COURSE, SF9.5A TONS	LEVELING COURSE, SF9.5A TONS	ASPHALT BINDER FOR PLANT MIX TON	PATCHING EXISTING PAVEMENT (MILL) TON	PATCHING EXISTING PAVEMENT (FULL DEPTH) TON	PAVEMENT INTERLAYER SY	6" CONCRETE DRIVEWAY SY
2016CPT.03.01.10311.1	Duplin	1	NC 41 (WALLACE HWY.)	FROM SAMPSON COUNTY LINE TO SR 1156 (KENAN LOOP RD.) MP. 0.00 TO MP 5.42, NO WORK BRIDGE MP 0.70 TO MP 0.72	1	2	2WU	YES	NO	5.42	22	994	50	10.84	71,354		2,557		10,566	6,500			897	1,000	150	69,955	
<b>TOTAL FOR MAP NO. 1</b>										<b>5.42</b>		<b>994</b>	<b>50</b>	<b>10.84</b>	<b>71,354</b>		<b>2,557</b>		<b>10,566</b>	<b>6,500</b>			<b>897</b>	<b>1,000</b>	<b>150</b>	<b>69,955</b>	
<b>TOTAL FOR PROJ NO. 2016CPT.03.01.10311.1</b>										<b>5.42</b>		<b>994</b>	<b>50</b>	<b>10.84</b>	<b>71,354</b>		<b>2,557</b>		<b>10,566</b>	<b>6,500</b>			<b>897</b>	<b>1,000</b>	<b>150</b>	<b>69,955</b>	
2016CPT.03.01.20311.1	Duplin	2	SR 1941 (RIVER RD.)	FROM NC 11 TO DEAD END- NO WORK BRIDGE MP 1.94 - MP 1.99	2	2	2WU	NO	NO	2.68	18						700				2,586	20	174	40			
<b>TOTAL FOR MAP NO. 2</b>										<b>2.68</b>							<b>700</b>				<b>2,586</b>	<b>20</b>	<b>174</b>	<b>40</b>			
2016CPT.03.01.20311.1	Duplin	3	SR 1307 (VEACH'S MILL RD.)	FROM SR 1004 TO SR 1305 - NO WORK BRIDGE MP 5.66 - MP 5.68	2,3	2	2WU	NO	NO	6.39	18.5						625				7,649	20	514	40			
<b>TOTAL FOR MAP NO. 3</b>										<b>6.39</b>							<b>625</b>				<b>7,649</b>	<b>20</b>	<b>514</b>	<b>40</b>			
2016CPT.03.01.20311.1	Duplin	4	SR 1305 (REVELLE RD.)	FROM SR 1305 TO SR 1301	2	2	2WU	NO	NO	0.19	18.5										188		13				
<b>TOTAL FOR MAP NO. 4</b>										<b>0.19</b>											<b>188</b>		<b>13</b>				
2016CPT.03.01.20311.1	Duplin	5	SR 1984 (BATTS RD.)	FROM SR 1967 TO DEAD END	2	2	2WU	NO	NO	0.47	20										504		34				
<b>TOTAL FOR MAP NO. 5</b>										<b>0.47</b>											<b>504</b>		<b>34</b>				
2016CPT.03.01.20311.1	Duplin	6	SR 1962 (SANDLIN RD.)	FROM NC 24 TO SR 1724	2	2	2WU	NO	NO	1.79	20										1,918		129				
<b>TOTAL FOR MAP NO. 6</b>										<b>1.79</b>											<b>1,918</b>		<b>129</b>				
2016CPT.03.01.20311.1	Duplin	7	SR 1302 (EMMETT JACKSON RD.)	FROM MP 2.69 (BRIDGE 78) TO SR 1308 (NO WORK BRIDGE)	2	2	2WU	NO	NO	0.40	18						333				386	20	27				
<b>TOTAL FOR MAP NO. 7</b>										<b>0.40</b>							<b>333</b>				<b>386</b>	<b>20</b>	<b>27</b>				
2016CPT.03.01.20311.1	Duplin	8	SR 1308 (BENNETT RD.)	FROM SR 1302 TO WAYNE COUNTY LINE	2	2	2WU	NO	NO	0.78	18										753		50				
<b>TOTAL FOR MAP NO. 8</b>										<b>0.78</b>											<b>753</b>		<b>50</b>				
2016CPT.03.01.20311.1	Duplin	9	SR 1346 (WORKS FARM RD.)	FROM SR 1301 TO NC 50	3	2	2WU	NO	NO	3.20	20										5,738	20	386				
<b>TOTAL FOR MAP NO. 9</b>										<b>3.20</b>											<b>5,738</b>	<b>20</b>	<b>386</b>				
2016CPT.03.01.20311.1	Duplin	10	SR 1547 (GRADY SMITH RD.)	FROM SR 1546 TO LENOIR COUNTY LINE	2	2	2WU	NO	NO	0.41	19										417		28				
<b>TOTAL FOR MAP NO. 10</b>										<b>0.41</b>											<b>417</b>		<b>28</b>				
2016CPT.03.01.20311.1	Duplin	11	SR 1535 (LIDDELL RD.)	FROM WAYNE COUNTY LINE TO LENOIR COUNTY LINE	2	2	2WU	NO	NO	0.72	18										695		47				
<b>TOTAL FOR MAP NO. 11</b>										<b>0.72</b>											<b>695</b>		<b>47</b>				
2016CPT.03.01.20311.1	Duplin	12	SR 1380 (BEST RD.)	FROM NC 11 TO SR 1301	2	2	2WU	NO	NO	4.40	20										4,714	20	317				
<b>TOTAL FOR MAP NO. 12</b>										<b>4.40</b>											<b>4,714</b>	<b>20</b>	<b>317</b>				
2016CPT.03.01.20311.1	Duplin	13	SR 1102 (WARDS RD.)	FROM SR 1101 TO SR 1129 (1" MILL & FILL ON BRIDGES)	2,4,5,6	2	2WU	NO	NO	4.30	18 - 30						528	700	100		4,378	20	299				
<b>TOTAL FOR MAP NO. 13</b>										<b>4.30</b>							<b>528</b>	<b>700</b>	<b>100</b>		<b>4,378</b>	<b>20</b>	<b>299</b>				
2016CPT.03.01.20311.1	Duplin	14	SR 1967 (JOE HOP WILIAMS RD.)	FROM SR 1964 TO NC 41	2	2	2WU	NO	NO	1.80	19										1,833		123				
<b>TOTAL FOR MAP NO. 14</b>										<b>1.80</b>											<b>1,833</b>		<b>123</b>				
2016CPT.03.01.20311.1	Duplin	15	SR 1114 (ISHAM FREDERICK RD.)	FROM NC 903 TO SR 1105	2	2	2WU	NO	NO	4.56	18.5										4,522	40	305				
<b>TOTAL FOR MAP NO. 15</b>										<b>4.56</b>											<b>4,522</b>	<b>40</b>	<b>305</b>				
<b>TOTAL FOR PROJ NO. 2016CPT.03.01.20311.1</b>										<b>32.09</b>							<b>528</b>	<b>2,358</b>	<b>100</b>		<b>36,281</b>	<b>160</b>	<b>2,446</b>	<b>80</b>			
2016CPT.03.01.10821.1	Sampson	16	NC 242 (SALEMBURG HWY.)	FROM MP 10.43 TO MP 19.15 (SALEMBURG CITY LIMITS TO US 421)	7	2-3	2WU	YES	NO	8.72	24 - 36	1,599	176	17.44			1,482	7,508		23,237			1,732	1,000	200	122,779	32
<b>TOTAL FOR MAP NO. 16</b>										<b>8.72</b>		<b>1,599</b>	<b>176</b>	<b>17.44</b>			<b>1,482</b>	<b>7,508</b>		<b>23,237</b>			<b>1,732</b>	<b>1,000</b>	<b>200</b>	<b>122,779</b>	<b>32</b>
<b>TOTAL FOR PROJ NO. 2016CPT.03.01.10821.1</b>										<b>8.72</b>		<b>1,599</b>	<b>176</b>	<b>17.44</b>			<b>1,482</b>	<b>7,508</b>		<b>23,237</b>			<b>1,732</b>	<b>1,000</b>	<b>200</b>	<b>122,779</b>	<b>32</b>
2016CPT.03.01.20821.1	Sampson	17	SR 1834 (INDUSTRIAL DRIVE)	FROM US 421 TO SR 1835	2,3	2	2WU	NO	NO	0.89	20										1,522	20	103				
<b>TOTAL FOR MAP NO. 17</b>										<b>0.89</b>											<b>1,522</b>	<b>20</b>	<b>103</b>				
2016CPT.03.01.20821.1	Sampson	18	SR 1835 (INDUSTRIAL DRIVE)	FROM SR 1356 TO DEAD END	2	2	2WU	NO	NO	0.93	24										1,195	20	81				
<b>TOTAL FOR MAP NO. 18</b>										<b>0.93</b>											<b>1,195</b>	<b>20</b>	<b>81</b>				
2016CPT.03.01.20821.1	Sampson	19	SR 1867 (ARMORY RD.)	FROM SR 1834 TO DEAD END	2,3	2	2WU	NO	NO	0.24	24										418	20	29				
<b>TOTAL FOR MAP NO. 19</b>										<b>0.24</b>											<b>418</b>	<b>20</b>	<b>29</b>				
2016CPT.03.01.20821.1	Sampson	20	SR 1229 (OVERLAND RD.)	FROM NC 24 TO SR 1222	2	2-3	2WU	NO	NO	0.95	20 - 30										1,114	20	76				
<b>TOTAL FOR MAP NO. 20</b>										<b>0.95</b>											<b>1,114</b>	<b>20</b>	<b>76</b>				
2016CPT.03.01.20821.1	Sampson	21	SR 1146 (MOSELEY AVENUE)	FROM US 421 TO SR 1145- NO WORK BRIDGE MP 1.13 - MP 1.14	2,3	2	2WU	NO	NO	2.45	20						667				3,760	20	253				
<b>TOTAL FOR MAP NO. 21</b>										<b>2.45</b>							<b>667</b>				<b>3,760</b>	<b>20</b>	<b>253</b>				
2016CPT.03.01.20821.1	Sampson	22	SR 1217 (HOBBS RD.)	FROM SR 1240 TO SR 1214	2,3	2	2WU	NO	NO	3.00	18										3,247	20	219				
<b>TOTAL FOR MAP NO. 22</b>										<b>3.00</b>											<b>3,247</b>	<b>20</b>	<b>219</b>				
2016CPT.03.01.20821.1	Sampson	23	SR 1768 (GORDON RD.)	FROM US 701 TO SR 1751	2	2	2WU	NO	NO	0.34	20										364	20	26				
<b>TOTAL FOR MAP NO. 23</b>										<b>0.34</b>											<b>364</b>	<b>20</b>	<b>26</b>				
2016CPT.03.01.20821.1	Sampson	24	SR 1772 (LORRAINE RD.)	FROM US 701 TO SR 1751	2	2	2WU	NO	NO	0.38	19										407	20	27				
<b>TOTAL FOR MAP NO. 24</b>										<b>0.38</b>											<b>407</b>	<b>20</b>	<b>27</b>				
2016CPT.03.01.20821.1	Sampson	25	SR 1631 (HINSON RD.)	FROM NC 55 TO SR 1620	3	2	2WU	NO	NO	1.75	18										2,827	20	191				
<b>TOTAL FOR MAP NO. 25</b>										<b>1.75</b>											<b>2,827</b>	<b>20</b>	<b>191</b>				
<b>TOTAL FOR PROJ NO. 2016CPT.03.01.20821.1</b>										<b>10.93</b>							<b>667</b>				<b>14,854</b>	<b>160</b>	<b>1,005</b>				
<b>GRAND TOTAL</b>										<b>57.16</b>		<b>2,593</b>	<b>226</b>	<b>28.28</b>	<b>71,354</b>	<b>528</b>	<b>7,064</b>	<b>7,608</b>	<b>10,566</b>								

PROJECT NO.	SHEET NO.	TOTAL NO.
2016CPT.03.01.10311.1, Etc.	12	

## SUMMARY OF QUANTITIES

PROJECT NO	COUNTY	MAP NO	ROUTE	DESCRIPTION	TYP	LANES	LANE TYPE	FINAL SURFACE TESTING REQUIRED	ADJ. OF MANHOLES EA	ADJ. OF METER OR VALVE BOX EA	GR ANCHOR UNITS, TYPE 350 EA	REMOVE & REPLACE EXISTING GR LF	TEMP. SILT FENCE LF	STONE FOR EC CLASS B TON	SEDIMENT CONTROL STONE TON	TEMP. MULCHING ACR	SAFETY FENCE LF	MATTING FOR EROSION CONTROL SY	1/4" HARDWARE CLOTH LF	WATTLE LF	SEED & MULCHING AC	SEED FOR REPAIR SEEDING LB	FERTILIZER FOR REPAIR SEEDING TON
2016CPT.03.01.10311.1	Duplin	1	NC 41 (WALLACE HWY.)	FROM SAMPSON COUNTY LINE TO SR 1156 (KENAN LOOP RD.) MP. 0.00 TO MP 5.42, NO WORK BRIDGE MP 0.70 TO MP 0.72	1	2	2WU	YES			4	800	542	136	136	5.42	200	40	271	90	5.00	270	1.40
<b>TOTAL FOR MAP NO. 1</b>											4	800	542	136	136	5.42	200	40	271	90	5.00	270	1.40
<b>TOTAL FOR PROJ NO. 2016CPT.03.01.10311.1</b>											4	800	542	136	136	5.42	200	40	271	90	5.00	270	1.40
2016CPT.03.01.20311.1	Duplin	2	SR 1941 (RIVER RD.)	FROM NC 11 TO DEAD END- NO WORK BRIDGE MP 1.94 - MP 1.99	2	2	2WU	NO															
<b>TOTAL FOR MAP NO. 2</b>																							
2016CPT.03.01.20311.1	Duplin	3	SR 1307 (VEACH'S MILL RD.)	FROM SR 1004 TO SR 1305 - NO WORK BRIDGE MP 5.66 - MP 5.68	2,3	2	2WU	NO															
<b>TOTAL FOR MAP NO. 3</b>																							
2016CPT.03.01.20311.1	Duplin	4	SR 1305 (REVELLE RD.)	FROM SR 1305 TO SR 1301	2	2	2WU	NO															
<b>TOTAL FOR MAP NO. 4</b>																							
2016CPT.03.01.20311.1	Duplin	5	SR 1984 (BATTS RD.)	FROM SR 1967 TO DEAD END	2	2	2WU	NO															
<b>TOTAL FOR MAP NO. 5</b>																							
2016CPT.03.01.20311.1	Duplin	6	SR 1962 (SANDLIN RD.)	FROM NC 24 TO SR 1724	2	2	2WU	NO															
<b>TOTAL FOR MAP NO. 6</b>																							
2016CPT.03.01.20311.1	Duplin	7	SR 1302 (EMMETT JACKSON RD.)	FROM MP 2.69 (BRIDGE 78) TO SR 1308 (NO WORK BRIDGE)	2	2	2WU	NO															
<b>TOTAL FOR MAP NO. 7</b>																							
2016CPT.03.01.20311.1	Duplin	8	SR 1308 (BENNETT RD.)	FROM SR 1302 TO WAYNE COUNTY LINE	2	2	2WU	NO															
<b>TOTAL FOR MAP NO. 8</b>																							
2016CPT.03.01.20311.1	Duplin	9	SR 1346 (WORKS FARM RD.)	FROM SR 1301 TO NC 50	3	2	2WU	NO	2	1													
<b>TOTAL FOR MAP NO. 9</b>									2	1													
2016CPT.03.01.20311.1	Duplin	10	SR 1547 (GRADY SMITH RD.)	FROM SR 1546 TO LENOIR COUNTY LINE	2	2	2WU	NO															
<b>TOTAL FOR MAP NO. 10</b>																							
2016CPT.03.01.20311.1	Duplin	11	SR 1535 (LIDDELL RD.)	FROM WAYNE COUNTY LINE TO LENOIR COUNTY LINE	2	2	2WU	NO															
<b>TOTAL FOR MAP NO. 11</b>																							
2016CPT.03.01.20311.1	Duplin	12	SR 1380 (BEST RD.)	FROM NC 11 TO SR 1301	2	2	2WU	NO															
<b>TOTAL FOR MAP NO. 12</b>																							
2016CPT.03.01.20311.1	Duplin	13	SR 1102 (WARDS RD.)	FROM SR 1101 TO SR 1129 (1" MILL & FILL ON BRIDGES)	2,4,5,6	2	2WU	NO															
<b>TOTAL FOR MAP NO. 13</b>																							
2016CPT.03.01.20311.1	Duplin	14	SR 1967 (JOE HOP WILIAMS RD.)	FROM SR 1964 TO NC 41	2	2	2WU	NO															
<b>TOTAL FOR MAP NO. 14</b>																							
2016CPT.03.01.20311.1	Duplin	15	SR 1114 (ISHAM FREDERICK RD.)	FROM NC 903 TO SR 1105	2	2	2WU	NO	2														
<b>TOTAL FOR MAP NO. 15</b>									2														
<b>TOTAL FOR PROJ NO. 2016CPT.03.01.20311.1</b>									4	1													
2016CPT.03.01.10821.1	Sampson	16	NC 242 (SALEMBURG HWY.)	FROM MP 10.43 TO MP 19.15 (SALEMBURG CITY LIMITS TO US 421)	7	2-3	2WU	YES					868	217	217	8.68		60	868	140	10.00	434	2.17
<b>TOTAL FOR MAP NO. 16</b>													868	217	217	8.68		60	868	140	10.00	434	2.17
<b>TOTAL FOR PROJ NO. 2016CPT.03.01.10821.1</b>													868	217	217	8.68		60	868	140	10.00	434	2.17
2016CPT.03.01.20821.1	Sampson	17	SR 1834 (INDUSTRIAL DRIVE)	FROM US 421 TO SR 1835	2,3	2	2WU	NO															
<b>TOTAL FOR MAP NO. 17</b>																							
2016CPT.03.01.20821.1	Sampson	18	SR 1835 (INDUSTRIAL DRIVE)	FROM SR 1356 TO DEAD END	2	2	2WU	NO															
<b>TOTAL FOR MAP NO. 18</b>																							
2016CPT.03.01.20821.1	Sampson	19	SR 1867 (ARMORY RD.)	FROM SR 1834 TO DEAD END	2,3	2	2WU	NO		2													
<b>TOTAL FOR MAP NO. 19</b>										2													
2016CPT.03.01.20821.1	Sampson	20	SR 1229 (OVERLAND RD.)	FROM NC 24 TO SR 1222	2	2-3	2WU	NO															
<b>TOTAL FOR MAP NO. 20</b>																							
2016CPT.03.01.20821.1	Sampson	21	SR 1146 (MOSELEY AVENUE)	FROM US 421 TO SR 1145- NO WORK BRIDGE MP 1.13 - MP 1.14	2,3	2	2WU	NO															
<b>TOTAL FOR MAP NO. 21</b>																							
2016CPT.03.01.20821.1	Sampson	22	SR 1217 (HOBBS RD.)	FROM SR 1240 TO SR 1214	2,3	2	2WU	NO															
<b>TOTAL FOR MAP NO. 22</b>																							
2016CPT.03.01.20821.1	Sampson	23	SR 1768 (GORDON RD.)	FROM US 701 TO SR 1751	2	2	2WU	NO		1													
<b>TOTAL FOR MAP NO. 23</b>										1													
2016CPT.03.01.20821.1	Sampson	24	SR 1772 (LORRAINE RD.)	FROM US 701 TO SR 1751	2	2	2WU	NO															
<b>TOTAL FOR MAP NO. 24</b>																							
2016CPT.03.01.20821.1	Sampson	25	SR 1631 (HINSON RD.)	FROM NC 55 TO SR 1620	3	2	2WU	NO															
<b>TOTAL FOR MAP NO. 25</b>																							
<b>TOTAL FOR PROJ NO. 2016CPT.03.01.20821.1</b>																							
<b>GRAND TOTAL</b>									4	4	4	800	1,410	353	353	14.10	200	100	1,139	230	15.00	704	3.57

PROJECT NO.	SHEET NO.	TOTAL NO.
2016CPT.03.01.10311.1, Etc.	13	

**THERMOPLASTIC AND PAINT QUANTITIES**

PROJECT NO	COUNTY	MAP NO	ROUTE	DESCRIPTION	TYP NO	LANES	LANE TYPE	LENGTH	WIDTH	4413000000-E	4457000000-N	4685000000-E		4686000000-E		4695000000-E	4700000000-E	4725000000-E			4810000000-E		4825000000-E	4845000000-N		4900000000-N	4905000000-N		
										WORK ZONE ADVANCE/ GENERAL WARNING SIGNING SF	TEMPORARY TRAFFIC CONTROL LS	4" X 90 M WHITE THERMO LF	4" X 90 M YELLOW THERMO LF	4" X 120 M YELLOW THERMO LF	4" X 120 M WHITE THERMO LF	8" X 90 M YELLOW THERMO LF	12" X 90 M YELLOW THERMO LF	THERMO STR & RT ARROW 90 M EA	THERMO LT ARROW 90 M EA	THERMO RT ARROW 90 M EA	4" WHITE PAINT LF	4" YELLOW PAINT LF	12" YELLOW PAINT LF	PAINT STR & RT ARROW EA	PAINT LT ARROW EA	YELLOW & YELLOW MARKERS EA	SNOW PLOWABLE MARKERS (Y/Y) EA	SNOW PLOWABLE MARKERS (C/R) EA	
2016CPT.03.01.10311.1	Duplin	1	NC 41 (WALLACE HWY.)	FROM SAMPSON COUNTY LINE TO SR 1156 (KENAN LOOP RD.) MP. 0.00 TO MP 5.42, NO WORK BRIDGE MP 0.70 TO MP 0.72	1	2	2WU	5.42	22	608	0.10	57,100		44,000							57,100	44,000						399	
<b>TOTAL FOR MAP NO. 1</b>										608	0.10	57,100		44,000							57,100	44,000					399		
<b>TOTAL FOR PROJ NO. 2016CPT.03.01.10311.1</b>										608	0.10	57,100		44,000							57,100	44,000					399		
												57,100		44,000							101,100						399		
2016CPT.03.01.20311.1	Duplin	2	SR 1941 (RIVER RD.)	FROM NC 11 TO DEAD END- NO WORK BRIDGE MP 1.94 - MP 1.99	2	2	2WU	2.68	18	192	0.04	28,301		17,688														177	
<b>TOTAL FOR MAP NO. 2</b>										192	0.04	28,301		17,688														177	
2016CPT.03.01.20311.1	Duplin	3	SR 1307 (VEACH'S MILL RD.)	FROM SR 1004 TO SR 1305 - NO WORK BRIDGE MP 5.66 - MP 5.68	2,3	2	2WU	6.39	18.5	384	0.10	67,479		42,174														422	
<b>TOTAL FOR MAP NO. 3</b>										384	0.10	67,479		42,174													422		
2016CPT.03.01.20311.1	Duplin	4	SR 1305 (REVELLE RD.)	FROM SR 1305 TO SR 1301	2	2	2WU	0.19	18.5	96	0.01	2,007		1,254														13	
<b>TOTAL FOR MAP NO. 4</b>										96	0.01	2,007		1,254													13		
2016CPT.03.01.20311.1	Duplin	5	SR 1984 (BATTS RD.)	FROM SR 1967 TO DEAD END	2	2	2WU	0.47	20	96	0.01	4,963		3,102														31	
<b>TOTAL FOR MAP NO. 5</b>										96	0.01	4,963		3,102													31		
2016CPT.03.01.20311.1	Duplin	6	SR 1962 (SANDLIN RD.)	FROM NC 24 TO SR 1724	2	2	2WU	1.79	20	192	0.04	18,903		11,814														118	
<b>TOTAL FOR MAP NO. 6</b>										192	0.04	18,903		11,814													118		
2016CPT.03.01.20311.1	Duplin	7	SR 1302 (EMMETT JACKSON RD.)	FROM MP 2.69 (BRIDGE 78) TO SR 1308 (NO WORK BRIDGE)	2	2	2WU	0.4	18	96	0.01	4,224		2,640														26	
<b>TOTAL FOR MAP NO. 7</b>										96	0.01	4,224		2,640													26		
2016CPT.03.01.20311.1	Duplin	8	SR 1308 (BENNETT RD.)	FROM SR 1302 TO WAYNE COUNTY LINE	2	2	2WU	0.78	18	96	0.01	8,237		5,148														51	
<b>TOTAL FOR MAP NO. 8</b>										96	0.01	8,237		5,148													51		
2016CPT.03.01.20311.1	Duplin	9	SR 1346 (WORKS FARM RD.)	FROM SR 1301 TO NC 50	3	2	2WU	3.20	20	224	0.06	33,792		21,120														211	
<b>TOTAL FOR MAP NO. 9</b>										224	0.06	33,792		21,120													211		
2016CPT.03.01.20311.1	Duplin	10	SR 1547 (GRADY SMITH RD.)	FROM SR 1546 TO LENOIR COUNTY LINE	2	2	2WU	0.41	19	96	0.01	4,330		2,706														27	
<b>TOTAL FOR MAP NO. 10</b>										96	0.01	4,330		2,706													27		
2016CPT.03.01.20311.1	Duplin	11	SR 1535 (LIDDELL RD.)	FROM WAYNE COUNTY LINE TO LENOIR COUNTY LINE	2	2	2WU	0.72	18	160	0.01	7,603		4,752														48	
<b>TOTAL FOR MAP NO. 11</b>										160	0.01	7,603		4,752													48		
2016CPT.03.01.20311.1	Duplin	12	SR 1380 (BEST RD.)	FROM NC 11 TO SR 1301	2	2	2WU	4.40	20	320	0.08	46,464		29,040														290	
<b>TOTAL FOR MAP NO. 12</b>										320	0.08	46,464		29,040													290		
2016CPT.03.01.20311.1	Duplin	13	SR 1102 (WARDS RD.)	FROM SR 1101 TO SR 1129 (1" MILL & FILL ON BRIDGES)	2,4,5,6	2	2WU	4.30	18 - 30	368	0.07	45,408		28,380														344	
<b>TOTAL FOR MAP NO. 13</b>										368	0.07	45,408		28,380													344		
2016CPT.03.01.20311.1	Duplin	14	SR 1967 (JOE HOP WILLIAMS RD.)	FROM SR 1964 TO NC 41	2	2	2WU	1.80	19	192	0.03	19,008		11,880														119	
<b>TOTAL FOR MAP NO. 14</b>										192	0.03	19,008		11,880													119		
2016CPT.03.01.20311.1	Duplin	15	SR 1114 (ISHAM FREDERICK RD.)	FROM NC 903 TO SR 1105	2	2	2WU	4.56	18.5	192	0.08	49,066		30,096														301	
<b>TOTAL FOR MAP NO. 15</b>										192	0.08	49,066		30,096													301		
<b>TOTAL FOR PROJ NO. 2016CPT.03.01.20311.1</b>										2,704	0.56	339,785		211,794														2,178	
												339,785		211,794															
2016CPT.03.01.10821.1	Sampson	16	NC 242 (SALEMBURG HWY.)	FROM MP 10.43 TO MP 19.15 (SALEMBURG CITY LIMITS TO US 421)	7	2-3	2WU	8.72	24 - 36	992	0.15	93,000	600	37,200			120	4	4		93,000	38,000	120	4	4	20	615	8	
<b>TOTAL FOR MAP NO. 16</b>										992	0.15	93,000	600	37,200			120	4	4		93,000	38,000	120	4	4	20	615	8	
<b>TOTAL FOR PROJ NO. 2016CPT.03.01.10821.1</b>										992	0.15	93,000	600	37,200			120	4	4		93,000	38,000	120	4	4	20	615	8	
												93,600		37,200				8				131,000			8			623	
2016CPT.03.01.20821.1	Sampson	17	SR 1834 (INDUSTRIAL DRIVE)	FROM US 421 TO SR 1835	2,3	2	2WU	0.89	20	96	0.01	9,576		5,874						3	3							59	
<b>TOTAL FOR MAP NO. 17</b>										96	0.01	9,576		5,874					3	3								59	
2016CPT.03.01.20821.1	Sampson	18	SR 1835 (INDUSTRIAL DRIVE)	FROM SR 1356 TO DEAD END	2	2	2WU	0.93	24	96	0.02	10,007		6,138														61	
<b>TOTAL FOR MAP NO. 18</b>										96	0.02	10,007		6,138													61		
2016CPT.03.01.20821.1	Sampson	19	SR 1867 (ARMORY RD.)	FROM SR 1834 TO DEAD END	2,3	2	2WU	0.24	24	96	0.01	2,582		1,584														16	
<b>TOTAL FOR MAP NO. 19</b>										96	0.01	2,582		1,584													16		
2016CPT.03.01.20821.1	Sampson	20	SR 1229 (OVERLAND RD.)	FROM NC 24 TO SR 1222	2	2-3	2WU	0.95	20 - 30	96	0.02	10,132		6,588	42	80				5	1							63	
<b>TOTAL FOR MAP NO. 20</b>										96	0.02	10,132		6,588	42	80			5	1						63			
2016CPT.03.01.20821.1	Sampson	21	SR 1146 (MOSELEY AVENUE)	FROM US 421 TO SR 1145- NO WORK BRIDGE MP 1.13 - MP 1.14	2,3	2	2WU	2.45	20	192	0.04	26,362		16,170														162	
<b>TOTAL FOR MAP NO. 21</b>										192	0.04	26,362		16,170													162		
2016CPT.03.01.20821.1	Sampson	22	SR 1217 (HOBBS RD.)	FROM SR 1240 TO SR 1214	2,3	2	2WU	3.00	18	192	0.04	32,280		19,800														198	
<b>TOTAL FOR MAP NO. 22</b>										192	0.04	32,280		19,800													198		
2016CPT.03.01.20821.1	Sampson	23	SR 1768 (GORDON RD.)	FROM US 701 TO SR 1751	2	2	2WU	0.34	20	96	0.01	3,658		2,244														22	
<b>TOTAL FOR MAP NO. 23</b>										96	0.01	3,658		2,244													22		
2016CPT.03.01.20821.1	Sampson	24	SR 1772 (LORRAINE RD.)	FROM US 701 TO SR 1751	2	2	2WU	0.38	19	96	0.01	4,089		2,508														25	
<b>TOTAL FOR MAP NO. 24</b>										96	0.01	4,089		2,508													25		
2016CPT.03.01.20821.1	Sampson	25	SR 1631 (HINSON RD.)	FROM NC 55 TO SR 1620	3	2	2WU	1.75	18	160	0.03	18,830		11,550														116	
<b>TOTAL FOR MAP NO. 25</b>										160	0.03	18,830		11,550													116		
<b>TOTAL FOR PROJ NO. 2016CPT.03.01.20821.1</b>										1,120	0.19	117,516		72,456	42	80			8	4								722	
												117,516																	

# SIGNING FOR RESURFACING PROJECTS

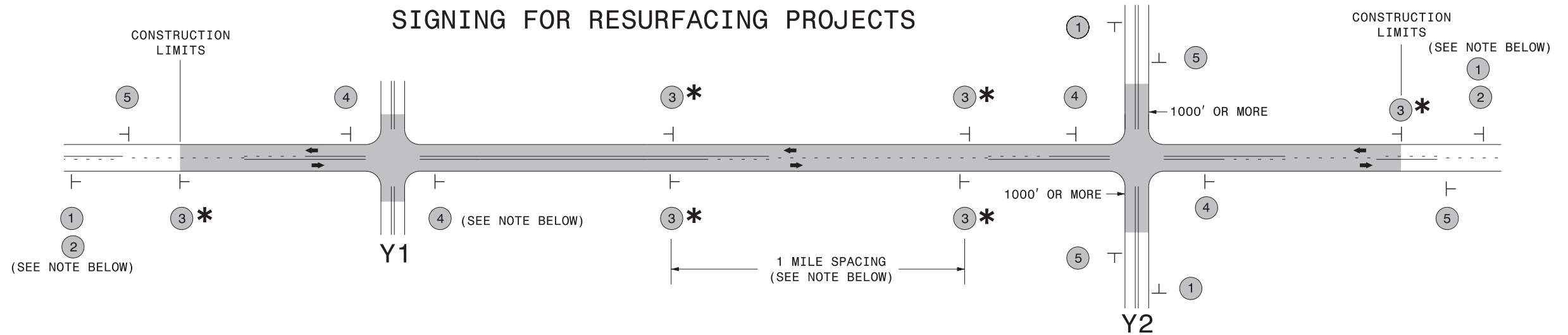

LEGEND	
┆	STATIONARY SIGN
←	DIRECTION OF TRAFFIC FLOW

## MAINLINE (-L-) SIGNING

## -Y- LINE SIGNING

SIGNING NOTES AND PLACEMENT PER DIRECTION	MAINLINE (-L-) SIGNING		-Y- LINE SIGNING	
	1	 W20-1 48" X 48"	PLACE 1000' PRIOR TO BEGINNING OF CONSTRUCTION LIMITS. ONLY USED ON -Y- LINES IF RESURFACING LIMITS EXTEND 1000' ALONG -Y- LINE.	<p>NO REQUIRED STATIONARY SIGNING FOR THE FOLLOWING -Y- LINE CONDITIONS:</p> <ol style="list-style-type: none"> <li>1) LESS THAN 1000' OF RESURFACING ALONG -Y- LINE</li> <li>2) SUBDIVISION ROADS</li> <li>3) DEAD END ROADS</li> </ol> <p>WHEN PAVING/CONSTRUCTION ACTIVITIES PROCEED ACROSS AN UNSIGNED -Y- LINE, ADVANCE WARNING PORTABLE SIGNS SHALL BE USED ALONG THE -Y- LINE AS SHOWN BELOW. REMOVE UPON COMPLETION OF WORK.</p> <div style="display: flex; justify-content: space-around;"> <div style="text-align: center;">             W20-1            48" X 48"         </div> <div style="text-align: center;">             W20-7 A            48" X 48"         </div> </div> <p>PLACED 500' IN ADVANCE OF FLAGGER. PLACED 250' IN ADVANCE OF FLAGGER.</p>
	2	 W7-3aP 24" X 18"	#2 SIGN ONLY USED WHEN RESURFACING LIMITS ARE 2 OR MORE MILES IN LENGTH. ROUND UP TO NEXT WHOLE NUMBER. (NO FRACTIONAL OR DECIMAL NUMBERS)	
	3 *	 SP 13107 48" X 48"	PLACE INITIALLY AT THE CONSTRUCTION LIMITS AND SPACED 1 MILE APART THEREAFTER. IF NO -Y- LINES EXIST, PLACE 2ND SET 1/2 MILE FROM THE CONSTRUCTION LIMITS AND THEN SPACE 1 MILE THEREAFTER.	
4	 SP 13106 48" X 48"	THESE ARE FOR -Y- LINES THAT ARE "THROUGH" ROADWAYS. DEAD END AND SUBDIVISION ROADS ARE NOT "THROUGH" ROADWAYS. INSTALL 500' +/- FROM EACH -Y- LINE APPROACH AS SHOWN ABOVE. FOR MULTIPLE -Y- LINES THAT ARE SEPARATED BY 0.25 MILES OR LESS, TREAT AS A SINGLE UNIT AND INSTALL WITHIN 500' OF EACH APPROACH. A MAXIMUM OF 2 SIGN SETS PER MILE. DO NOT INSTALL WHEN -Y- LINES ARE WITHIN 0.5 MILES FROM "END ROAD WORK" SIGN.		
5	 G20-2 A 48" X 24"	PLACE 500' FOLLOWING THE END OF CONSTRUCTION LIMITS.		

### \* SIGNING FOR ASPHALT SURFACE TREATMENTS (ONLY)

SUBSTITUTE LOW/SOFT SHOULDER SIGNS BY ALTERNATING THE FOLLOWING TWO SIGNS: STARTING WITH "UNMARKED PAVEMENT AHEAD" (SP 06026) FOLLOWED BY "LOOSE GRAVEL" (W8-7).

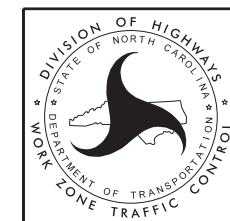

RESURFACING  
ADVANCE WARNING SIGNS  
FOR  
RURAL AND SUBURBAN  
2 LANE ROADWAYS

NOTES: Less than 5' - 10' undisturbed buffer from ROW, ditchline, water feature, or drainage inlet, add BMP.

BMP Options: Wattle or Silt Fence

# EROSION CONTROL DETAIL

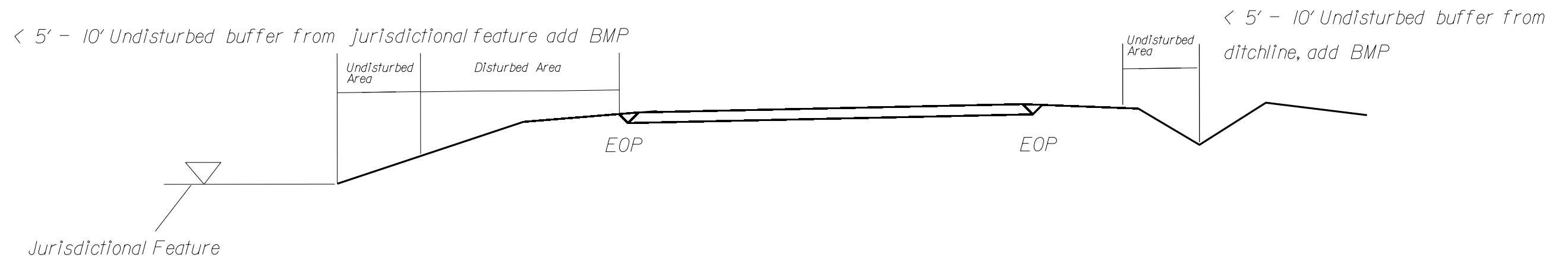
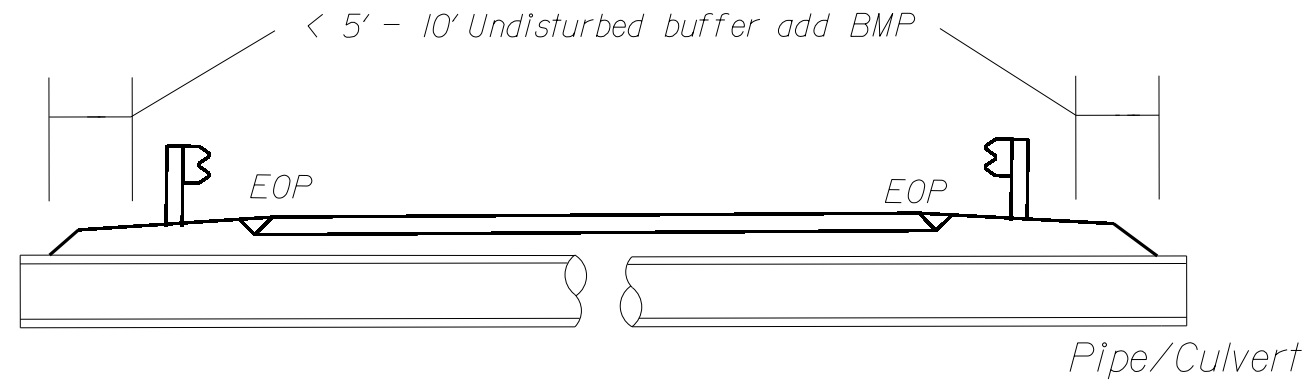

Use BMP's if shoulders and/or frontslopes and/or ditchline and/or backslopes are disturbed

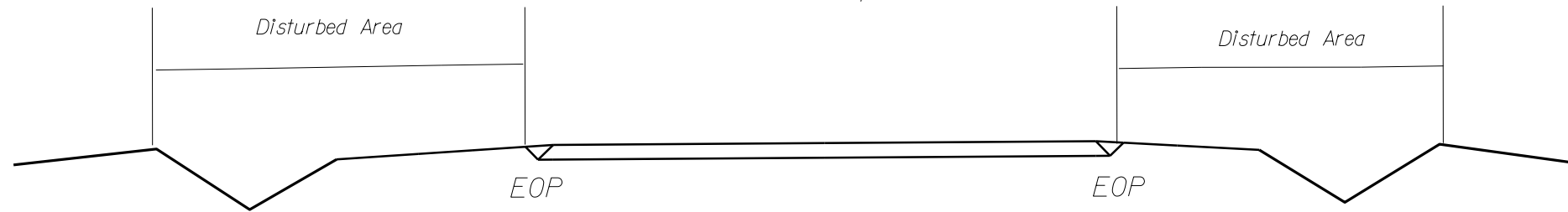

< 5' - 10' Undisturbed buffer from inlet, add wattle

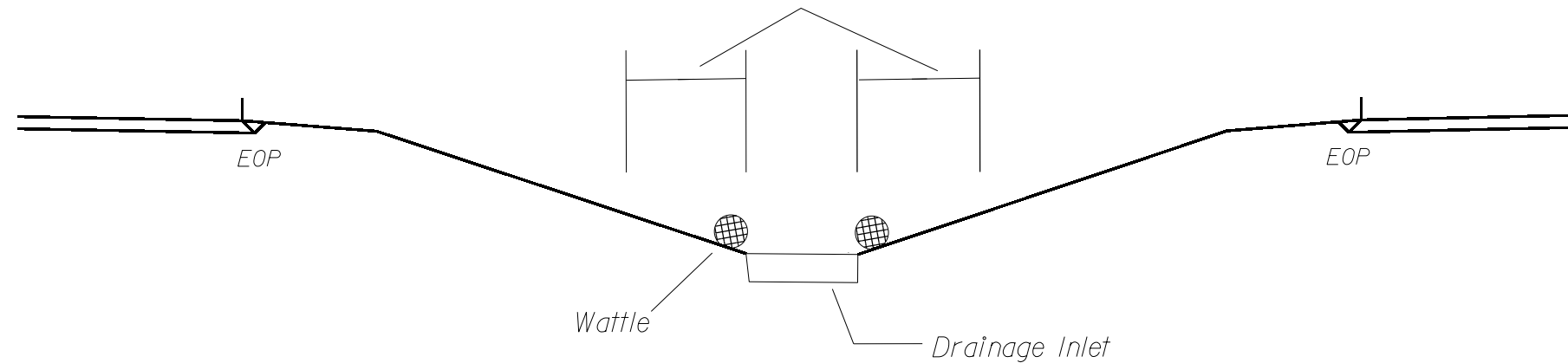

NOT TO SCALE



DIVISION OF HIGHWAYS  
STATE OF NORTH CAROLINA

---



---

## ***SOIL STABILIZATION TIMEFRAMES***

<i>SITE DESCRIPTION</i>	<i>STABILIZATION TIME</i>	<i>TIMEFRAME EXCEPTIONS</i>
PERIMETER DIKES, SWALES, DITCHES AND SLOPES	7 DAYS	NONE
HIGH QUALITY WATER (HQW) ZONES	7 DAYS	NONE
SLOPES STEEPER THAN 3:1	7 DAYS	IF SLOPES ARE 10' OR LESS IN LENGTH AND ARE NOT STEEPER THAN 2:1, 14 DAYS ARE ALLOWED.
SLOPES 3:1 OR FLATTER	14 DAYS	7 DAYS FOR SLOPES GREATER THAN 50' IN LENGTH.
ALL OTHER AREAS WITH SLOPES FLATTER THAN 4:1	14 DAYS	NONE, EXCEPT FOR PERIMETERS AND HQW ZONES.

# WATTLE DETAIL

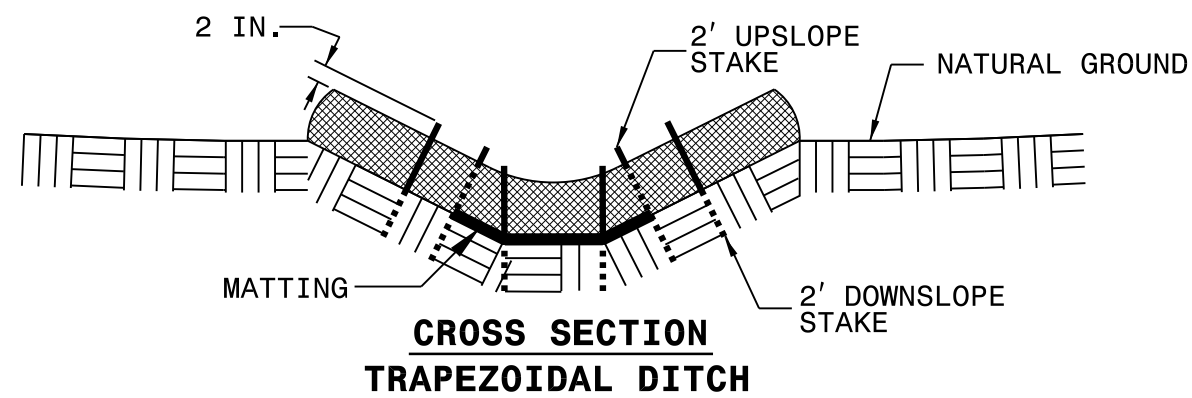
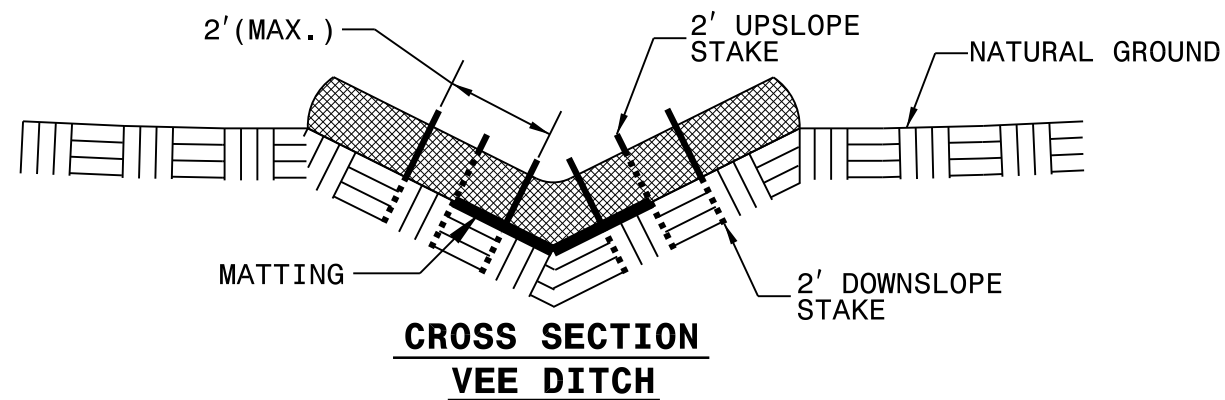
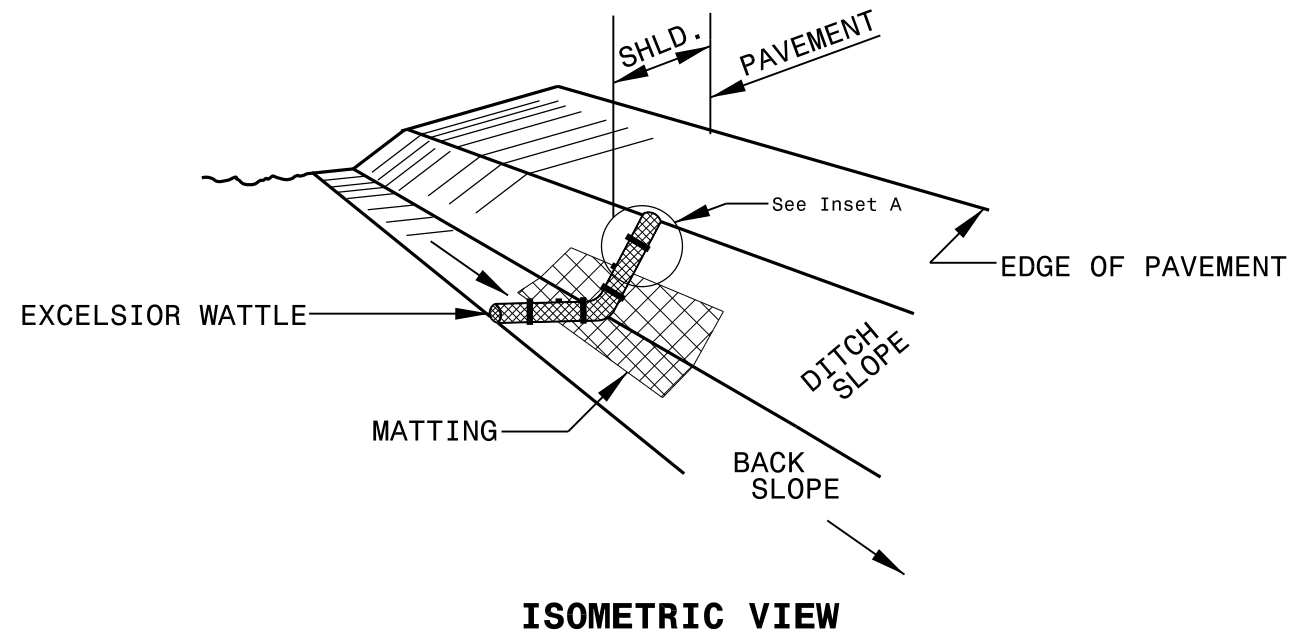

**NOTES:**

USE MINIMUM 12 IN. DIAMETER EXCELSIOR WATTLE.

USE 2 FT. WOODEN STAKES WITH A 2 IN. BY 2 IN. NOMINAL CROSS SECTION.

ONLY INSTALL WATTLE(S) TO A HEIGHT IN DITCH SO FLOW WILL NOT WASH AROUND WATTLE AND SCOUR DITCH SLOPES AND AS DIRECTED.

INSTALL A MINIMUM OF 2 UPSLOPE STAKES AND 4 DOWNSLOPE STAKES AT AN ANGLE TO WEDGE WATTLE TO BOTTOM OF DITCH.

PROVIDE STAPLES MADE OF 0.125 IN. DIAMETER STEEL WIRE FORMED INTO A U SHAPE NOT LESS THAN 12" IN LENGTH.

INSTALL STAPLES APPROXIMATELY EVERY 1 LINEAR FOOT ON BOTH SIDES OF WATTLE AND AT EACH END TO SECURE IT TO THE SOIL.

INSTALL MATTING IN ACCORDANCE WITH SECTION 1631 OF THE STANDARD SPECIFICATIONS.

