

STATE OF NORTH CAROLINA  
DIVISION OF HIGHWAYS

**TRANSPORTATION MANAGEMENT PLAN**

**CUMBERLAND COUNTY**

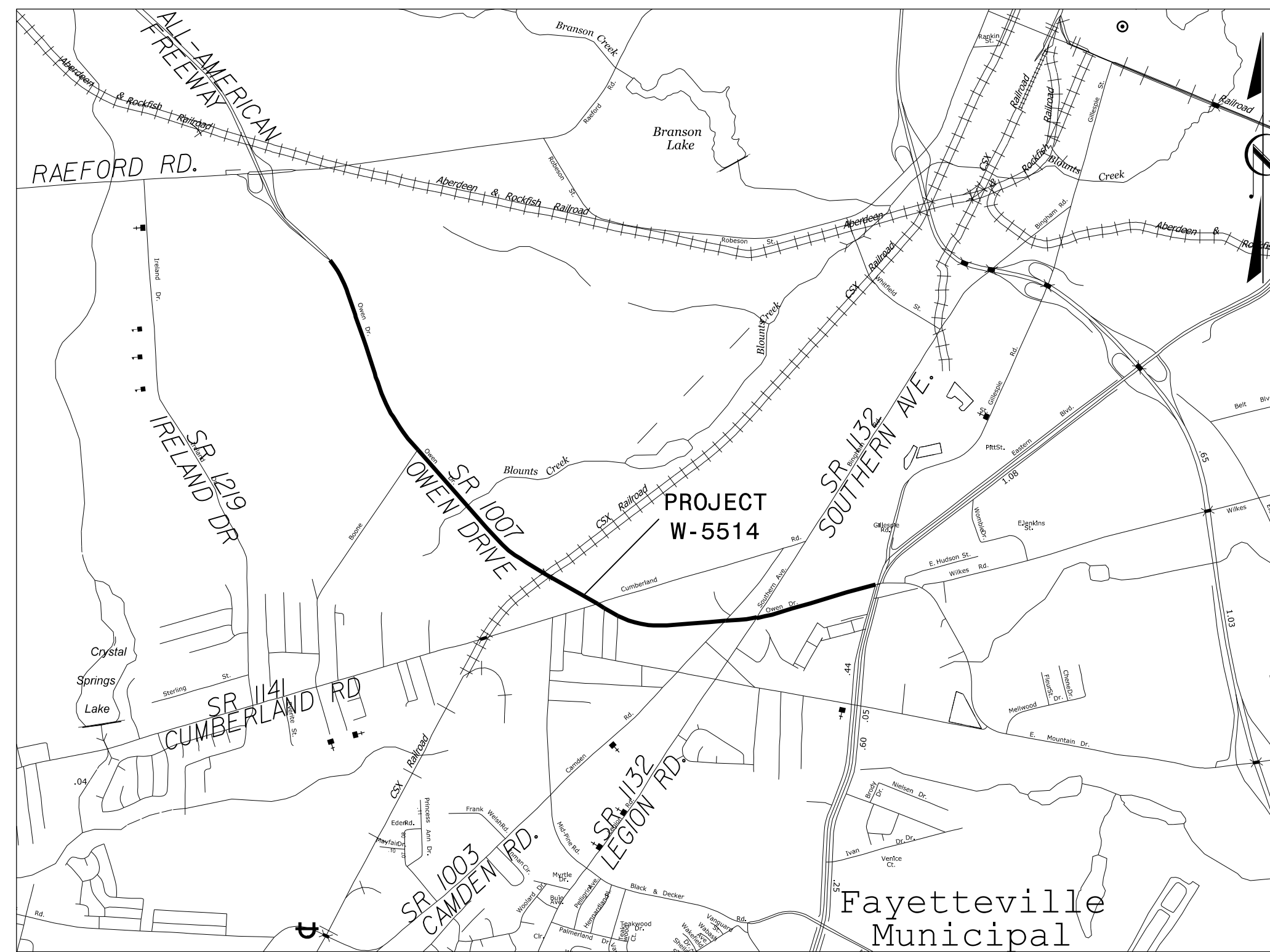
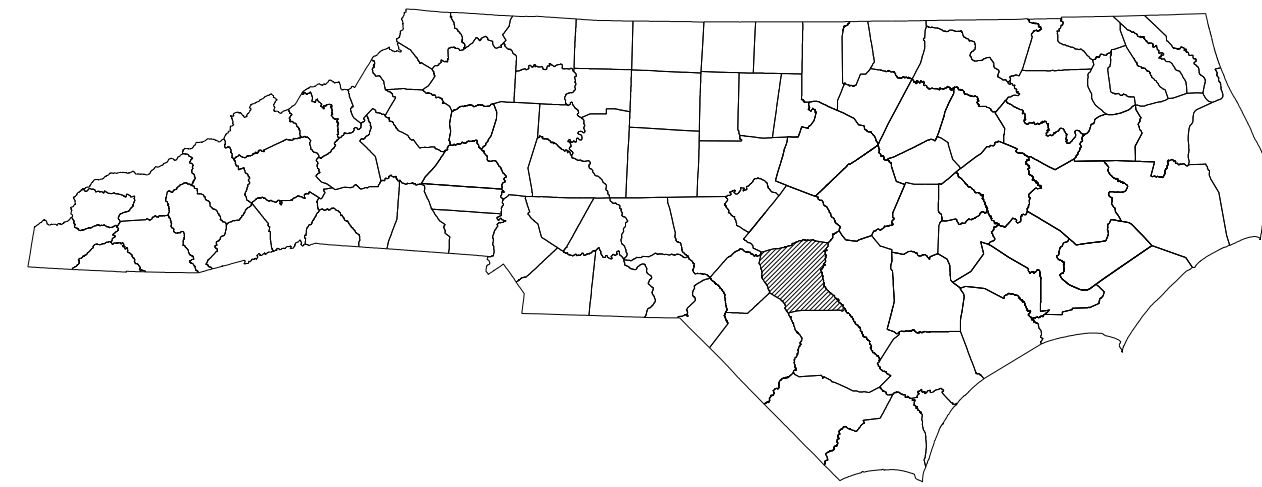

**VICINITY MAP**

**INDEX OF SHEETS**

SHEET NO.	TITLE
TMP-1	TITLE SHEET, VICINITY MAP AND INDEX OF SHEETS
TMP-1A	LIST OF APPLICABLE ROADWAY STANDARD DRAWINGS AND LEGEND
TMP-2A THRU TMP-2B	TRANSPORTATION OPERATIONS PLAN: (GENERAL NOTES)
TMP-3A THRU TMP-3B	TEMPORARY TRAFFIC CONTROL PHASING
TMP-4 THRU TMP-11	TEMPORARY TRAFFIC CONTROL PHASE I DETAILS
TMP-12 THRU TMP-28	TEMPORARY TRAFFIC CONTROL PHASE II DETAILS

SHEET NO.  
TMP-1

**W-5514**



4000 WestChase Boulevard, Suite 530 Raleigh, NC 27607  
NC License No. C-3705



**N.C.D.O.T. WORK ZONE TRAFFIC CONTROL**  
1561 MAIL SERVICE CENTER (MSC) RALEIGH, NC 27699-1561  
750 N. GREENFIELD PARKWAY, GARNER, NC 27529 (DELIVERY)  
PHONE: (919) 773-2800 FAX: (919) 771-2745

J. STEWART BOURNE, P.E. STATE TRAFFIC MANAGEMENT ENGINEER  
STEVE KITE, P.E. TRAFFIC CONTROL PROJECT ENGINEER  
DON PARKER TRAFFIC CONTROL PROJECT DESIGN ENGINEER  
SHEENA GREEN TRAFFIC CONTROL DESIGN ENGINEER

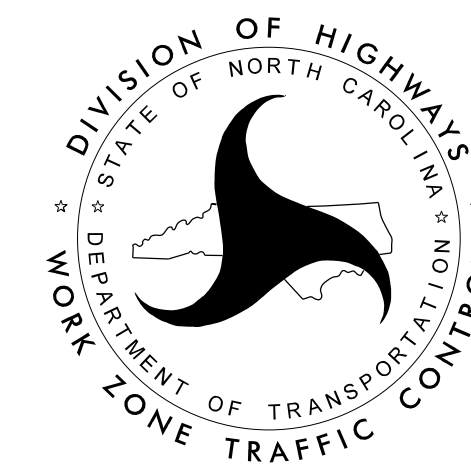

JOSEPH LEWIS, PE  
TRAFFIC CONTROL  
PROJECT ENGINEER

A. MATTHEW THIGPEN, PE  
TRAFFIC CONTROL  
PROJECT DESIGN ENGINEER

APPROVED: \_\_\_\_\_  
DATE: \_\_\_\_\_

SEAL



4/7/2015  
W5514\_TC\_TMP\_01.dgn  
mthigpen

**TIP PROJECT:**