

PROJECT REFERENCE NO.		SHEET NO.	
W-5514		13	
RW SHEET NO.			
ROADWAY DESIGN ENGINEER		HYDRAULICS ENGINEER	
		4/23/2015	

5/14/99

4/23/2015

4_rdy_psh_13.dgn

MATCHLINE SHEET 12
-L- STA 221+00.00

MATCHLINE SHEET 14
-L- STA 234+00.00

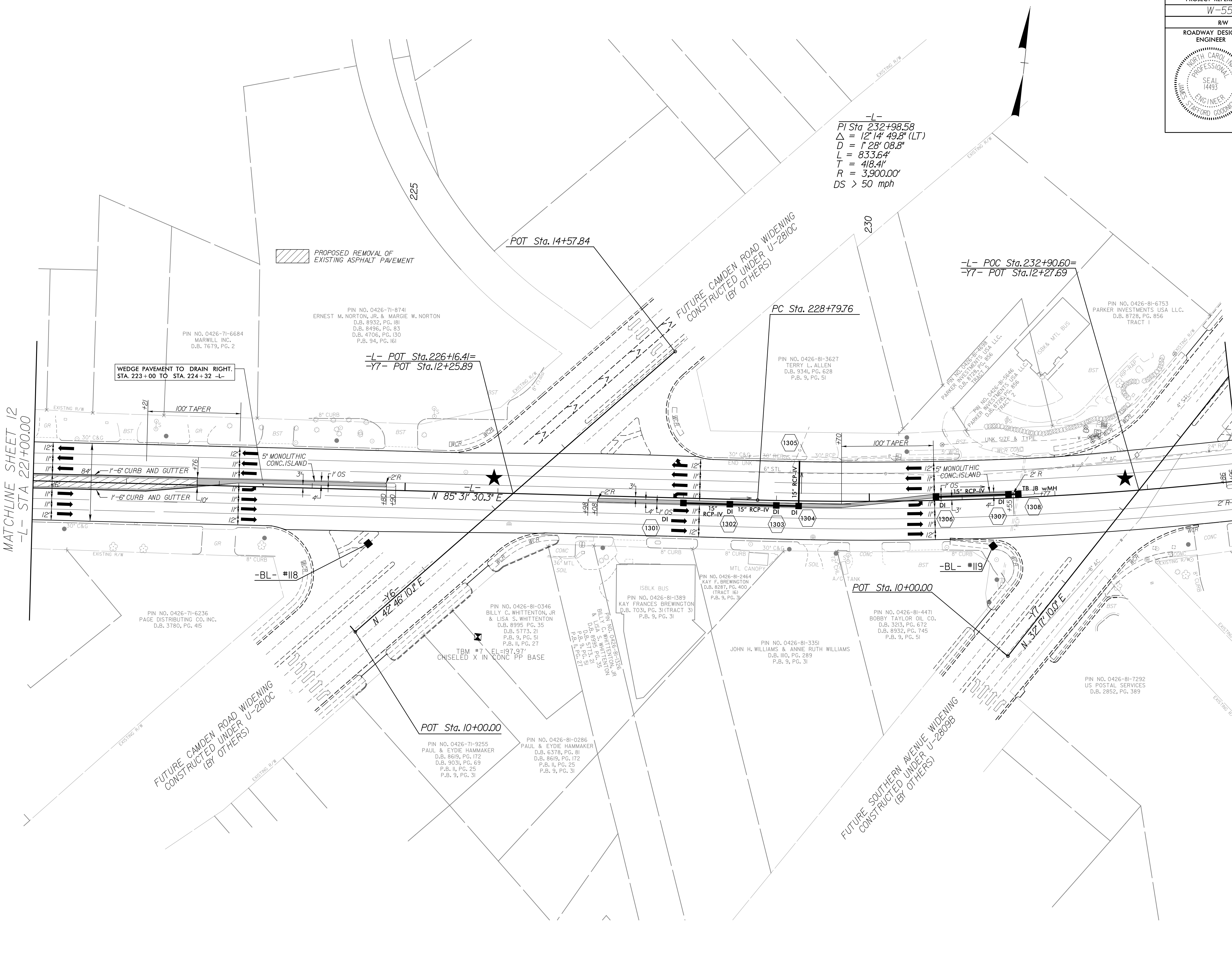

-L-
 PI Sta 232+98.58
 $\Delta = 12' 14'' 49.8'' (LT)$
 $D = 1' 28'' 08.8''$
 $L = 833.64'$
 $T = 418.4'$
 $R = 3,900.00'$
 $DS > 50 \text{ mph}$

PROPOSED REMOVAL OF EXISTING ASPHALT PAVEMENT

WEDGE PAVEMENT TO DRAIN RIGHT.
 STA. 223+00 TO STA. 224+32 -L-

-L- POT Sta. 226+16.41=
 -Y7- POT Sta. 12+25.89

PC Sta. 228+79.76

-L- POC Sta. 232+90.60=
 -Y7- POT Sta. 12+27.69

POT Sta. 10+00.00

POT Sta. 10+00.00

FUTURE CAMDEN ROAD WIDENING
 CONSTRUCTED UNDER U-2810C
 (BY OTHERS)

FUTURE SOUTHERN AVENUE WIDENING
 CONSTRUCTED UNDER U-2809B
 (BY OTHERS)

PIN NO. 0426-71-6236
 PAGE DISTRIBUTING CO. INC.
 D.B. 3780, PG. 415

PIN NO. 0426-81-0346
 BILLY C. WHITTENTON, JR
 & LISA S. WHITTENTON
 D.B. 8995 PG. 35
 D.B. 5773. 21
 P.B. 9, PG. 51
 P.B. 11, PG. 27

PIN NO. 0426-81-1389
 KAY FRANCES BREWINGTON
 D.B. 7031, PG. 31 (TRACT 3)
 P.B. 9, PG. 31

PIN NO. 0426-81-4471
 BOBBY TAYLOR OIL CO.
 D.B. 3213, PG. 672
 D.B. 8932, PG. 745
 P.B. 9, PG. 51

PIN NO. 0426-71-9255
 PAUL & EYDIE HAMMAKER
 D.B. 8619, PG. 172
 D.B. 9031, PG. 69
 P.B. 11, PG. 25
 P.B. 9, PG. 31

PIN NO. 0426-81-0286
 PAUL & EYDIE HAMMAKER
 D.B. 6378, PG. 81
 D.B. 8619, PG. 172
 P.B. 11, PG. 25
 P.B. 9, PG. 31

PIN NO. 0426-81-3351
 JOHN H. WILLIAMS & ANNIE RUTH WILLIAMS
 D.B. 110, PG. 289
 P.B. 9, PG. 31

PIN NO. 0426-81-7292
 US POSTAL SERVICES
 D.B. 2852, PG. 369

PIN NO. 0426-71-6684
 MARWILL INC.
 D.B. 7679, PG. 2

PIN NO. 0426-71-8741
 ERNEST M. NORTON, JR. & MARGIE W. NORTON
 D.B. 8932, PG. 181
 D.B. 8496, PG. 83
 D.B. 4706, PG. 130
 P.B. 94, PG. 161

PIN NO. 0426-81-3627
 TERRY L. ALLEN
 D.B. 9341, PG. 628
 P.B. 9, PG. 51

PIN NO. 0426-81-6753
 PARKER INVESTMENTS USA LLC.
 D.B. 8728, PG. 856
 TRACT 1

PIN NO. 0426-81-5846
 PARKER INVESTMENTS USA LLC.
 D.B. 8728, PG. 856
 TRACT 2

PIN NO. 0426-81-5846
 PARKER INVESTMENTS USA LLC.
 D.B. 8728, PG. 856
 TRACT 3

PIN NO. 0426-81-1389
 BILLY C. WHITTENTON, JR
 & LISA S. WHITTENTON
 D.B. 8995 PG. 35
 D.B. 5773. 21
 P.B. 9, PG. 51
 P.B. 11, PG. 27

TBM #7 EL=197.97'
 CHISELED X IN CONC PP BASE

-BL- #118

-BL- #119

N 85° 31' 30.3" E

N 42° 46' 10.1" E

N 32° 17' 10.0" E