

**This electronic collection of documents is provided
for the convenience of the user
and is Not a Certified Document –**

**The documents contained herein were originally issued
and sealed by the individuals whose names and license
numbers appear on each page, on the dates appearing
with their signature on that page.**

**This file or an individual page
shall not be considered a certified document.**

T.I.P.: R-2413CA

**STATE OF NORTH CAROLINA
DEPARTMENT OF TRANSPORTATION**

**PAVEMENT MARKING PLAN
ROCKINGHAM COUNTY**

**LOCATION: US 220 /FUTURE I-73 FROM NORTH OF NC 65 TO
NORTH OF SR 2338 (NEWNAM RD) INCLUDING NC 68
INTERCHANGE**

TIP NO. R-2413CA	SHEET NO. PMP-1
APPROVED: <small>000013EA3304AFB...</small>	
DATE: 2/11/2015	

ROADWAY STANDARD DRAWINGS

THE FOLLOWING ROADWAY STANDARDS AS APPEAR IN "ROADWAY STANDARD DRAWINGS" - PROJECT SERVICES UNIT - N.C. DEPARTMENT OF TRANSPORTATION - RALEIGH, N.C., DATED JANUARY 2012 ARE APPLICABLE TO THIS PROJECT AND BY REFERENCE HEREBY ARE CONSIDERED A PART OF THESE PLANS:

STD. NO.	TITLE
1205.01	PAVEMENT MARKINGS - LINE TYPES AND OFFSETS
1205.02	PAVEMENT MARKINGS - TWO-LANE AND MULTILANE ROADWAYS
1205.03	PAVEMENT MARKINGS - EXIT AND ENTRANCE RAMPS
1205.04	PAVEMENT MARKINGS - INTERSECTIONS
1205.05	PAVEMENT MARKINGS - TURN LANES
1205.08	PAVEMENT MARKINGS - SYMBOLS AND WORD MESSAGES
1205.09	PAVEMENT MARKINGS - PAINTED ISLANDS
1205.12	PAVEMENT MARKINGS - BRIDGES
1250.01	RAISED PAVEMENT MARKERS - INSTALLATION SPACING
1251.01	RAISED PAVEMENT MARKERS - PERMANENT AND TEMPORARY
1261.01	GUARDRAIL AND BARRIER DELINEATORS - INSTALLATION SPACING
1261.02	GUARDRAIL AND BARRIER DELINEATORS - TYPES AND MOUNTING
1262.01	GUARDRAIL END DELINEATION

GENERAL NOTES

THE FOLLOWING GENERAL NOTES APPLY AT ALL TIMES FOR THE DURATION OF THE CONSTRUCTION PROJECT, EXCEPT WHEN OTHERWISE NOTED IN THE PLAN, OR DIRECTED BY THE ENGINEER.

- A) INSTALL PAVEMENT MARKINGS AND PAVEMENT MARKERS ON THE FINAL SURFACE AS FOLLOWS:
- | ROAD NAME | MARKING | MARKER |
|---------------------------|---------------------------------|---------------|
| -L-, RAMPS & ALL -Y-LINES | THERMOPLASTIC | SNOW PLOWABLE |
| BRIDGE DECKS | COLD APPLIED PLASTIC
TYPE II | RAISED |
- B) TIE PROPOSED PAVEMENT MARKING LINES TO EXISTING PAVEMENT MARKING LINES.
- C) REMOVE/REPLACE ANY CONFLICTING/DAMAGED PAVEMENT MARKINGS AND MARKERS.
- D) PASSING ZONES WILL BE DETERMINED IN THE FIELD AND MUST BE APPROVED BY THE ENGINEER.
- E) STOP BAR LOCATION AT NON-SIGNALIZED INTERSECTIONS MAY BE ADJUSTED AS DIRECTED BY THE ENGINEER.
- F) REMOVE ALL RESIDUE AND SURFACE LAITANCE BY ACCEPTABLE METHODS ON CONCRETE BRIDGE DECKS PRIOR TO PLACING COLD APPLIED PLASTIC MARKING.
- G) UNLESS OTHERWISE SPECIFIED, HEATED-IN-PLACE THERMOPLASTIC MAY BE USED IN LIEU OF EXTRUDED THERMOPLASTIC FOR STOP BARS, SYMBOLS, CHARACTERS AND DIAGONALS. IF HEATED-IN-PLACE IS USED, IT SHALL BE PAID FOR USING THE EXTRUDED THERMOPLASTIC PAY ITEM.
- H) CONTRACTOR MAY ELECT TO USE COLD APPLIED PLASTIC, TYPE III ON CONCRETE SURFACES AT NO ADDITIONAL COST TO THE DEPARTMENT.

INDEX

SHEET NO.	DESCRIPTION
PMP-1	PAVEMENT MARKING PLAN COVER SHEET
PMP-1A	FINAL PAVEMENT MARKING SCHEDULE AND LEGEND
PMP-2 THRU PMP-10	PAVEMENT MARKING DETAILS

PLAN REVIEWED BY: N.C.D.O.T. SIGNING AND DELINEATION UNIT

<u>Renee Roach, PE</u>	SIGNING & DELINEATION REGIONAL ENGINEER
<u>Sam Coleman</u>	SIGNING & DELINEATION PROJECT DESIGN ENGINEER

PLAN PREPARED BY: HNTB NORTH CAROLINA, P.C.

<u>R. B. Early, PE</u>	PROJECT ENGINEER
<u>J. Phillips</u>	PROJECT DESIGNER

HNTB HNTB NORTH CAROLINA, P.C.
343 E. Six Forks Road, Suite 200
Raleigh, North Carolina 27609
C-1554

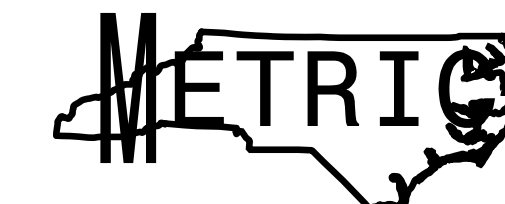

FINAL PAVEMENT MARKING SCHEDULE

MATERIAL	SYMBOL	DESCRIPTION
PAVEMENT MARKING		
<u>COLD APPLIED PLASTIC, TYPE II (6")</u>		
	C6	WHITE EDGELINE
	C7	YELLOW EDGELINE
	CJ	10' WHITE SKIP
<u>THERMOPLASTIC (4", 90 MILS)</u>		
	TA	WHITE EDGELINE
	TB	YELLOW EDGELINE
<u>THERMOPLASTIC (4", 120 MILS)</u>		
	TI	YELLOW DOUBLE CENTER
<u>THERMOPLASTIC (6", 90 MILS)</u>		
	T6	WHITE EDGELINE
	T7	YELLOW EDGELINE
<u>THERMOPLASTIC (6", 120 MILS)</u>		
	T11	WHITE MINISKIPS (2'/8')
	T12	YELLOW MINISKIPS (2'/8')
	TJ	10' WHITE SKIPS
	TK	WHITE MINISKIPS (3'/9')
	TL	WHITE LANE LINE
<u>THERMOPLASTIC (12", 90 MILS)</u>		
	TS	WHITE GORELINE
	TU	WHITE DIAGONAL
<u>THERMOPLASTIC (24", 120 MILS)</u>		
	T2	WHITE STOP BAR
<u>THERMOPLASTIC SYMBOL (90 MILS)</u>		
	UA	LEFT TURN ARROW
	UB	RIGHT TURN ARROW
	UN	24" YIELD LINE
	UP	MERGE ARROW
	UT	U-TURN ARROW
<u>PERMANENT RAISED PAVEMENT MARKERS</u>		
	MB	CRYSTAL & RED
<u>SNOWPLOWABLE PAVEMENT MARKERS</u>		
	ME	YELLOW & YELLOW
	MF	CRYSTAL & RED

LEGEND

GENERAL

- DIRECTION OF TRAFFIC FLOW
- NORTH ARROW
- PROPOSED PVMT. EXIST. PVMT.

PAVEMENT MARKINGS

- PAVEMENT MARKING SYMBOLS

PAVEMENT MARKING SYMBOLS

	UA
	UB
	UN
	UP
	UT

SEAL

APPROVED:

DocuSigned by:
 Rhonda B. Early
000013EA339A4F8

DATE: 5/8/2015

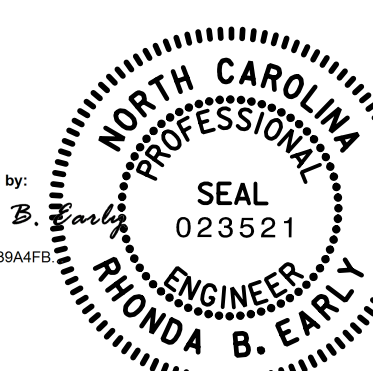

FINAL PAVEMENT MARKING PLAN

8/17/99

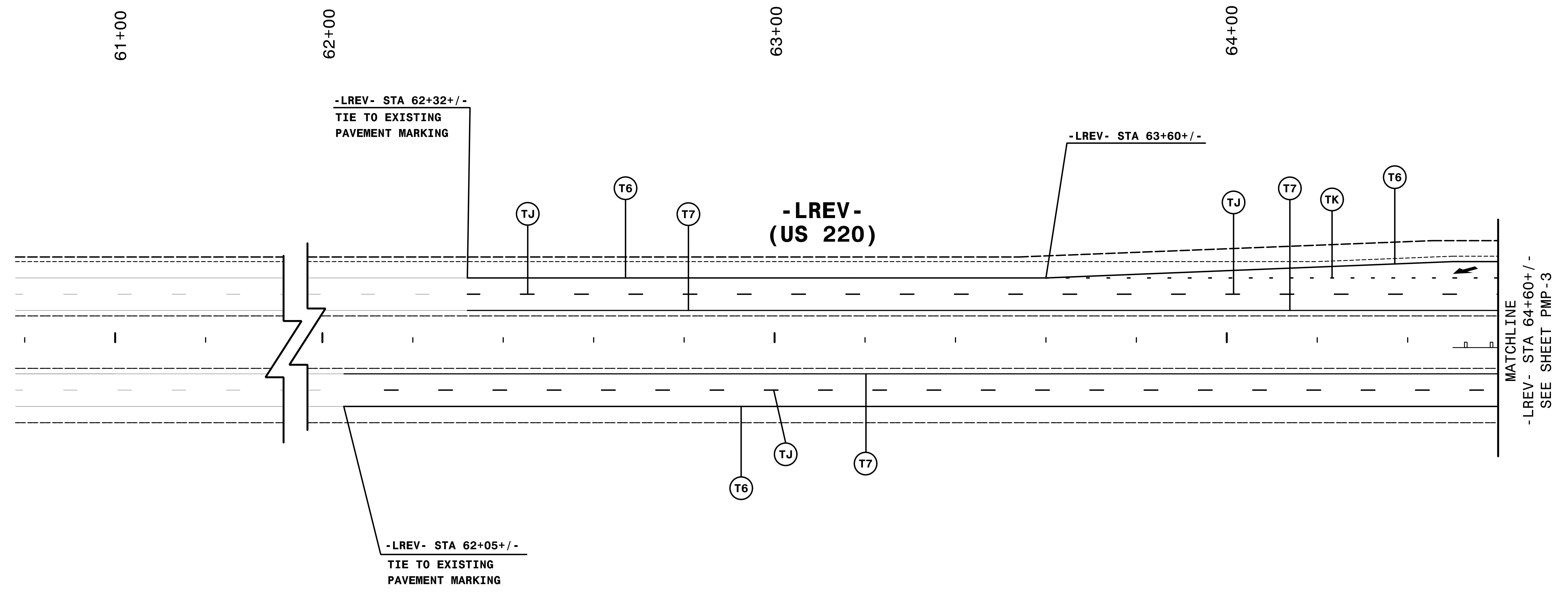
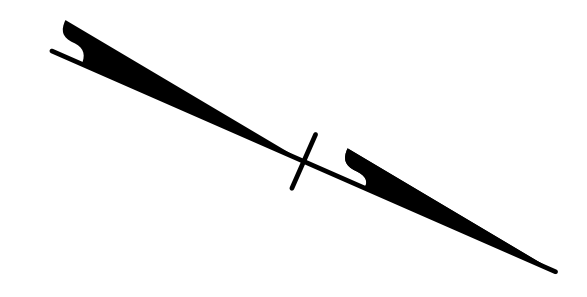

SEE SHEET PMP-1A FOR PAVEMENT MARKING SCHEDULE.

ALL LANE WIDTHS ARE 3.6m UNLESS OTHERWISE SHOWN.

SEAL APPROVED:  <small>DocuSigned by: Rhonda Early 6EEF13EA3394AFD...</small> DATE: 2/11/2015		<p>FINAL PAVEMENT MARKING PLAN</p>
---	---	---

9:55:01 AM 2/11/2015 pmp02.dgn
\$\$\$\$\$USERNAME\$\$\$\$\$

8/17/99

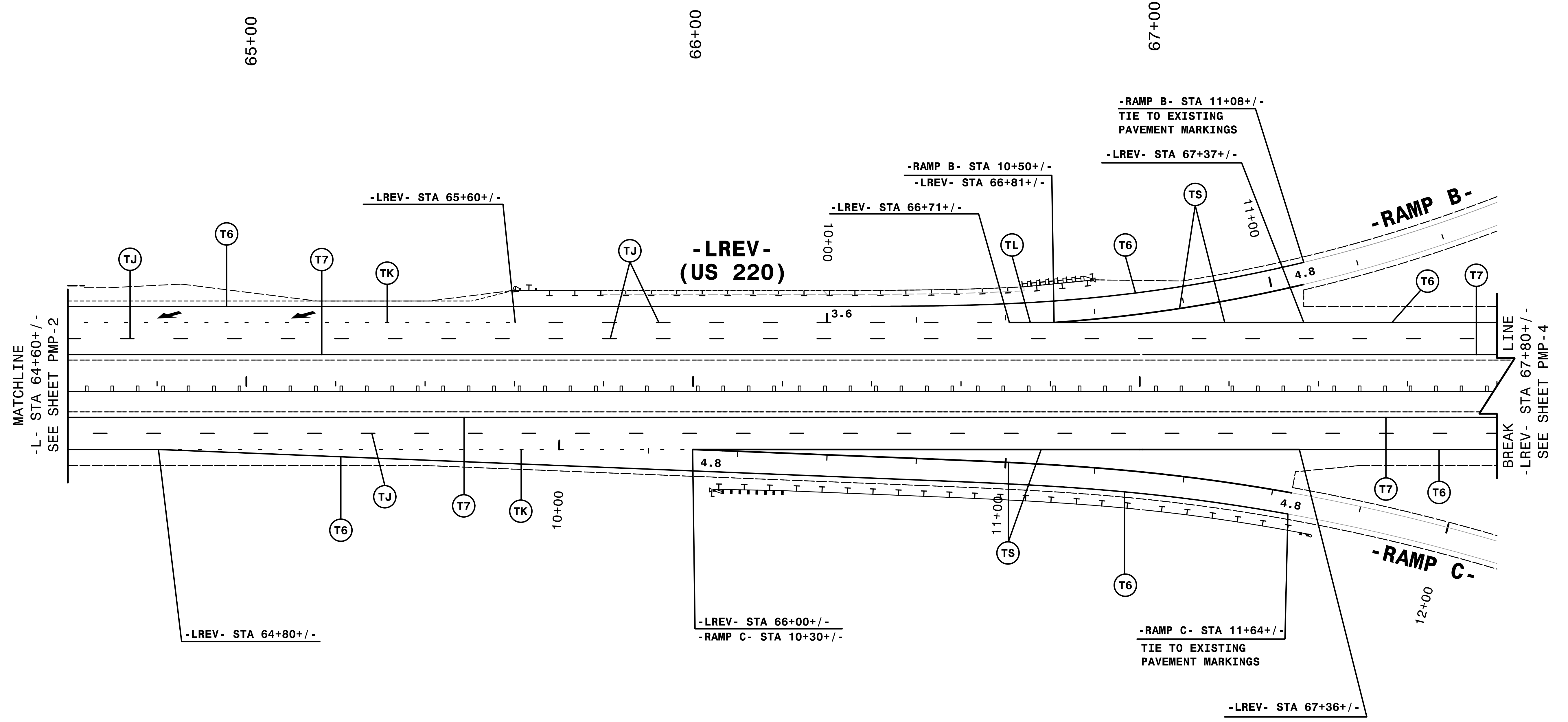
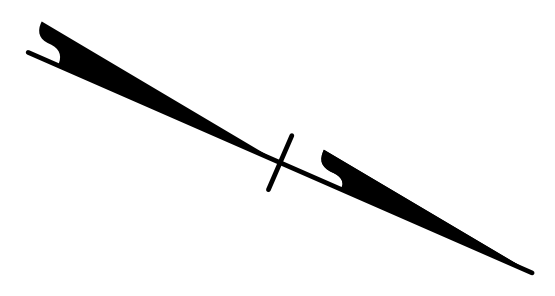

SEE SHEET PMP-1A FOR PAVEMENT MARKING SCHEDULE.

ALL LANE WIDTHS ARE 3.6m UNLESS OTHERWISE SHOWN.

SEAL APPROVED: <small>DocuSigned by:</small> <i>Rhonda Early</i> <small>66EE13EA339A4FB</small> DATE: 2/11/2015		<p>FINAL PAVEMENT MARKING PLAN</p>
---	--	---

9:55:20 AM 4/13/2015 pmp03.dgn
\$\$\$\$\$USERNAME\$\$\$\$\$

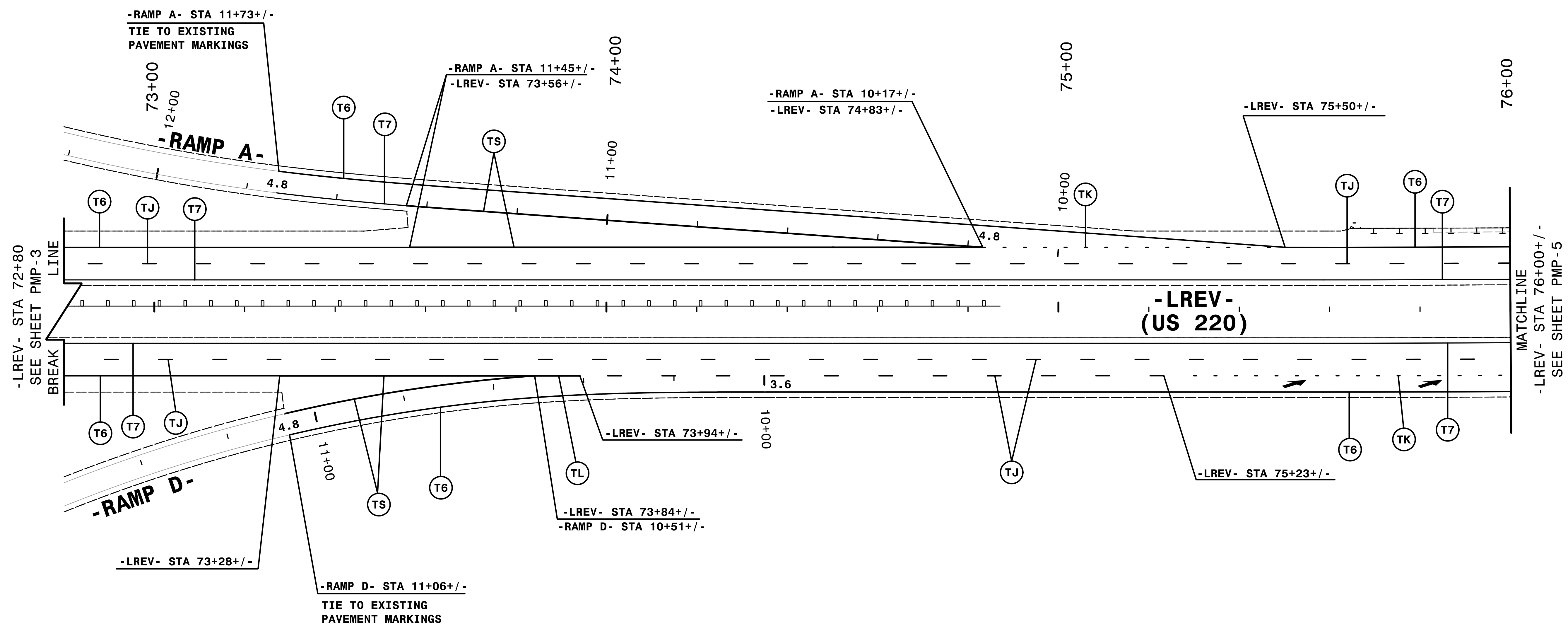
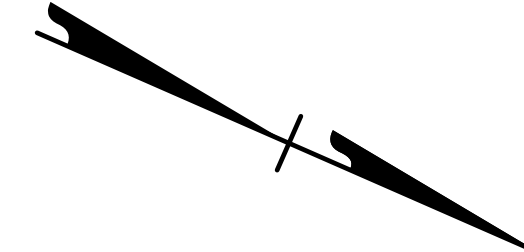

SEE SHEET PMP-1A FOR PAVEMENT MARKING SCHEDULE.

ALL LANE WIDTHS ARE 3.6m UNLESS OTHERWISE SHOWN.

SEAL		<h2>FINAL PAVEMENT MARKING PLAN</h2>
APPROVED:		
DocuSigned by: <i>Rhonda Early</i> E00013EA3394F8		
DATE: 2/11/2015		

8/17/99

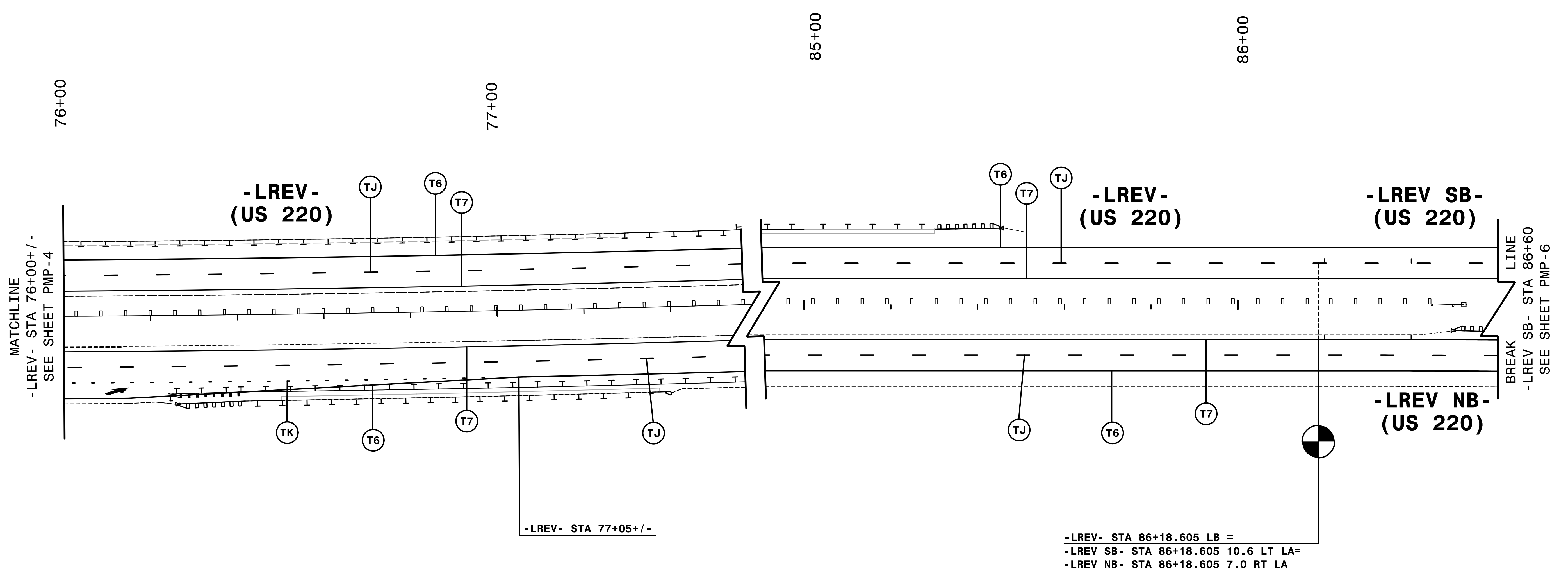
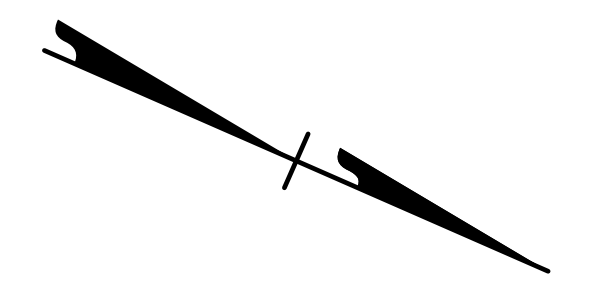

SEE SHEET PMP-1A FOR PAVEMENT MARKING SCHEDULE.

ALL LANE WIDTHS ARE 3.6m UNLESS OTHERWISE SHOWN.

SEAL		<h2>FINAL PAVEMENT MARKING PLAN</h2>
APPROVED:		
DATE: 2/11/2015		

9:55:58 AM 4/13/2015 pmp05.dgn
 \$\$\$USERNAME\$\$\$

8/17/99



HNTB NORTH CAROLINA, P.C.
343 E. Six Forks Road, Suite 200
Raleigh, North Carolina 27609
C-1554

PROJ. REFERENCE NO.	SHEET NO.
R-2413CA	PMP-7

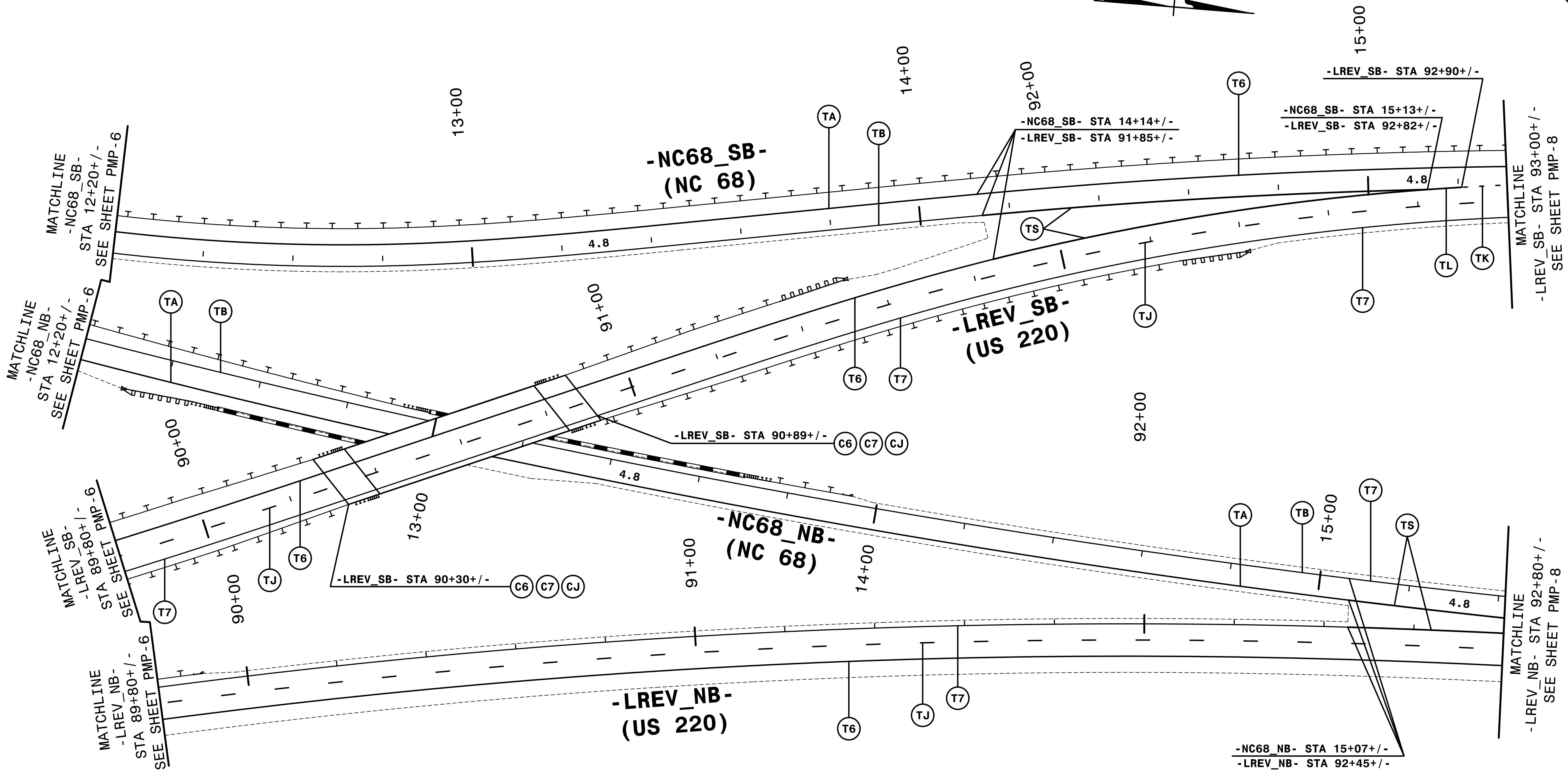

SEE SHEET PMP-1A FOR PAVEMENT MARKING SCHEDULE.

ALL LANE WIDTHS ARE 3.6m UNLESS OTHERWISE SHOWN.

SEAL		<p>FINAL PAVEMENT MARKING PLAN</p>
APPROVED:		
<p>DocuSigned by: Rhonda Early 6E6E13EA339A4FB</p>		
<p>DATE: 2/11/2015</p>		

9:56:35 AM 4/13/2015 pmp07.dgn

8/17/99

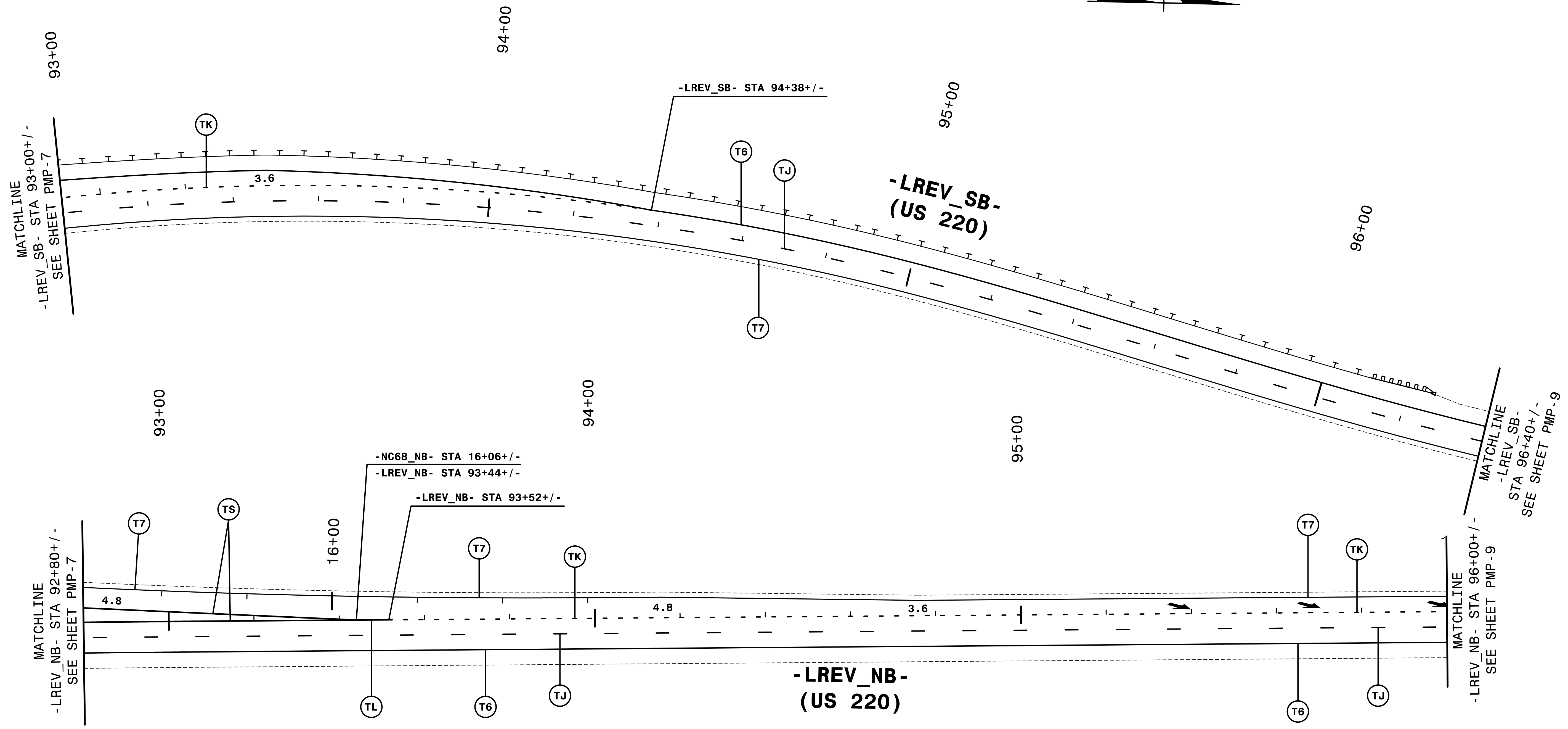

SEE SHEET PMP-1A FOR PAVEMENT MARKING SCHEDULE.
 ALL LANE WIDTHS ARE 3.6m UNLESS OTHERWISE SHOWN.

SEAL		<h2>FINAL PAVEMENT MARKING PLAN</h2>
APPROVED:		
<small>DocuSigned by:</small> <i>Rhonda Early</i> <small>6EE13EA339A4FB...</small>		
DATE: 2/11/2015		

9:56:55 AM 4/13/2015 pmp08.dgn
 \$\$\$USERNAME\$\$\$

8/17/99

PROJ. REFERENCE NO.	SHEET NO.
R-2413CA	PMP-9

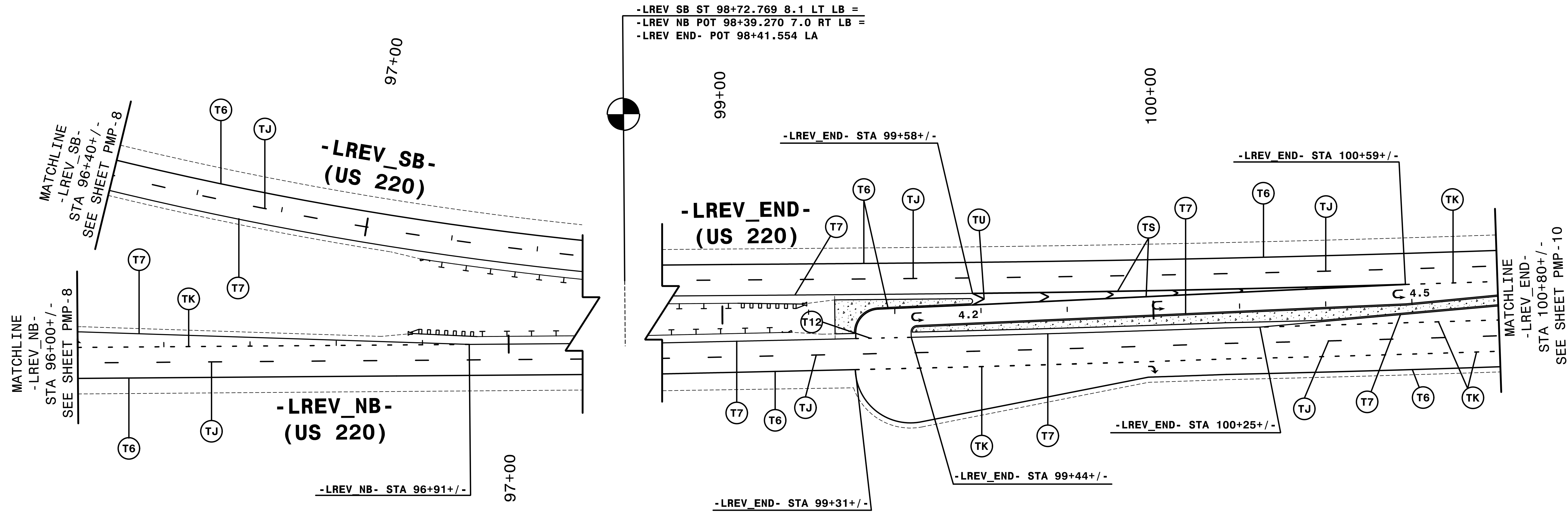
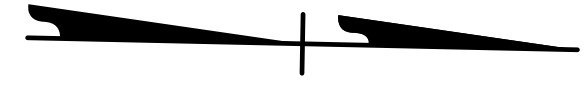

SEE SHEET PMP-1A FOR PAVEMENT MARKING SCHEDULE.

ALL LANE WIDTHS ARE 3.6m UNLESS OTHERWISE SHOWN.

SEAL		<h2>FINAL PAVEMENT MARKING PLAN</h2>
APPROVED:		
DocuSigned by: <i>Rhonda Early</i> E6E13EA339A4FD...		
DATE: 2/11/2015		

9:57:15 AM 2/11/2015 4132... pmp09.dgn
\$\$\$\$\$USERNAME\$\$\$\$\$

8/17/99

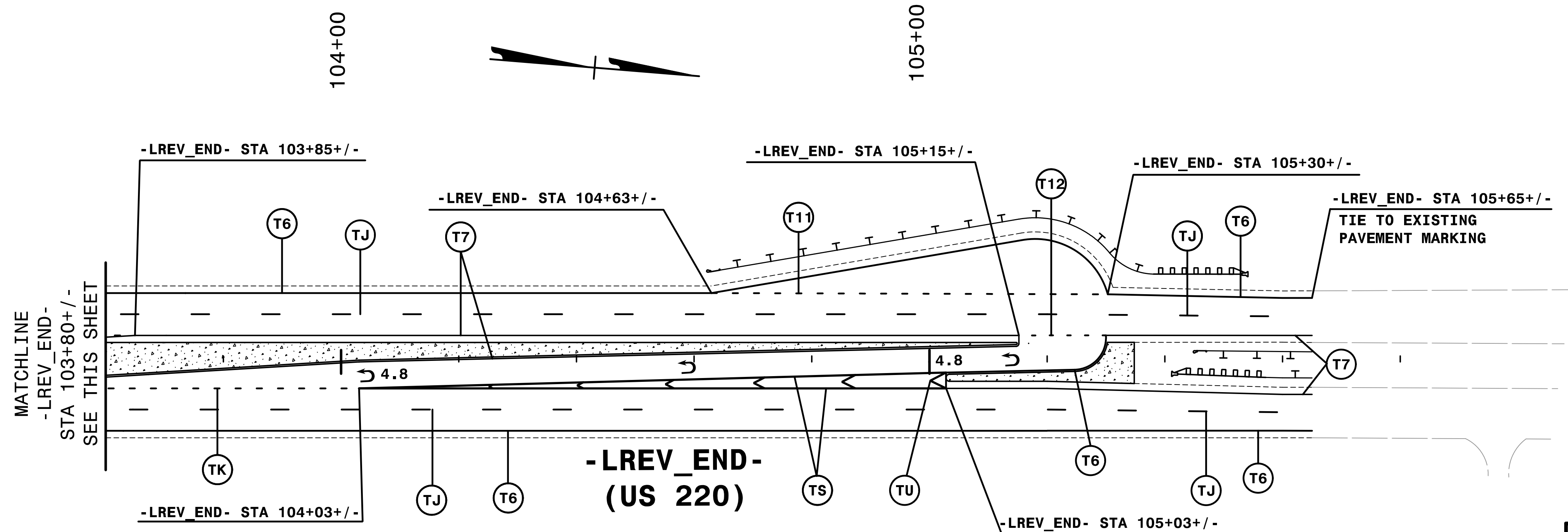
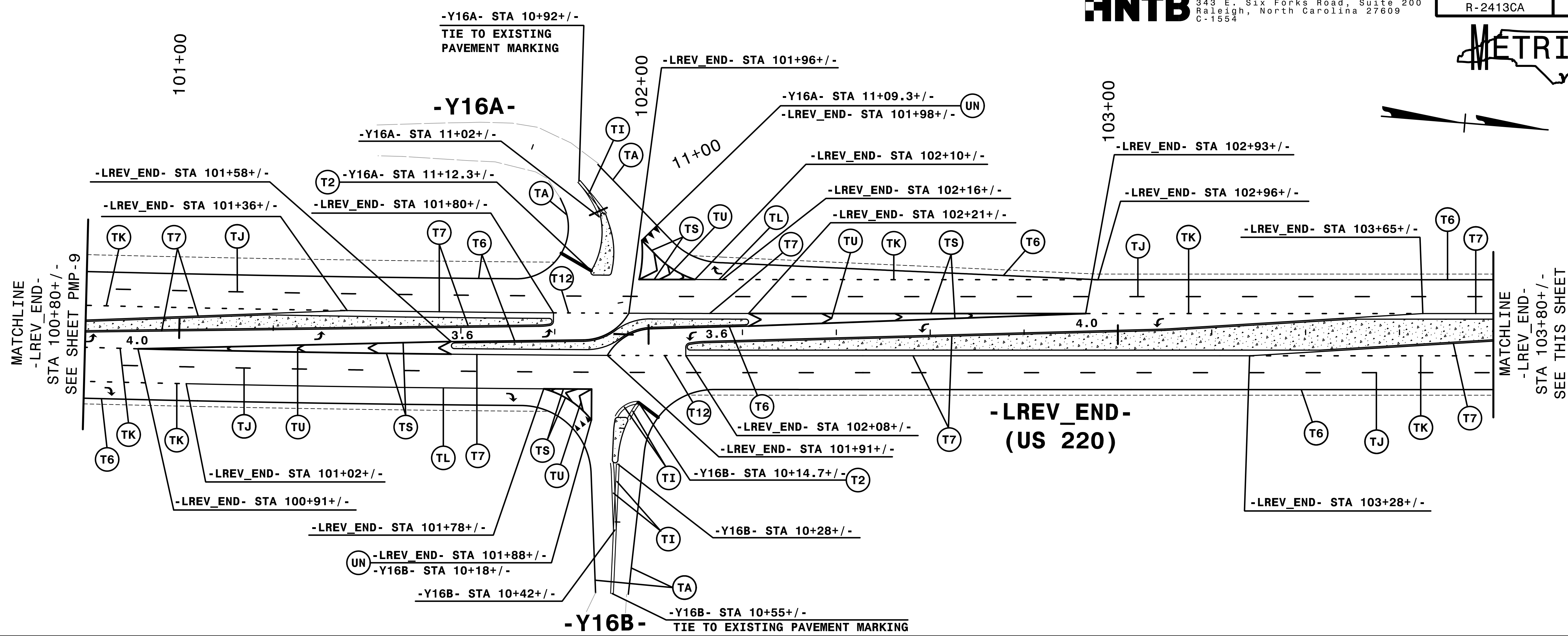

SEE SHEET PMP-1A FOR PAVEMENT MARKING SCHEDULE.

ALL LANE WIDTHS ARE 3.6m UNLESS OTHERWISE SHOWN.

SEAL		FINAL PAVEMENT MARKING PLAN
APPROVED:		
DocuSigned by: Rhonda Early #E6E19E3A339A4FD...		
DATE: 2/11/2015		

9:15 AM, 2/11/2015, AY4132..._pmp10.dgn
\$\$\$\$\$USER\$NAME\$\$\$\$\$