

09/08/99

See Sheet 1-A For Index of Sheets
See Sheet 1-B For Conventional Symbols

STATE OF NORTH CAROLINA
DIVISION OF HIGHWAYS

RANDOLPH COUNTY

**LOCATION: BRIDGE 136 OVER US 29-70A-85 BUSINESS ON
SR 1619 (PROSPECT STREET) IN HIGH POINT**

TYPE OF WORK: GRADING, DRAINAGE, PAVING, STRUCTURE AND SIGNALS

STATE	STATE PROJECT REFERENCE NO.	SHEET NO.	TOTAL SHEETS
N.C.	B-5114	1	
STATE PROJ. NO.	F.A. PROJ. NO.	DESCRIPTION	
42252.1.1	BRZ-1619(5)	PE	
42252.2.FR1	BRZ-1619(5)	ROW	
42252.2.FRUI	BRZ-1619(5)	UTL	
42252.3.FR1	BRZ-1619(5)	CONST.	

TIP PROJECT: B-5114

CONTRACT: C203589

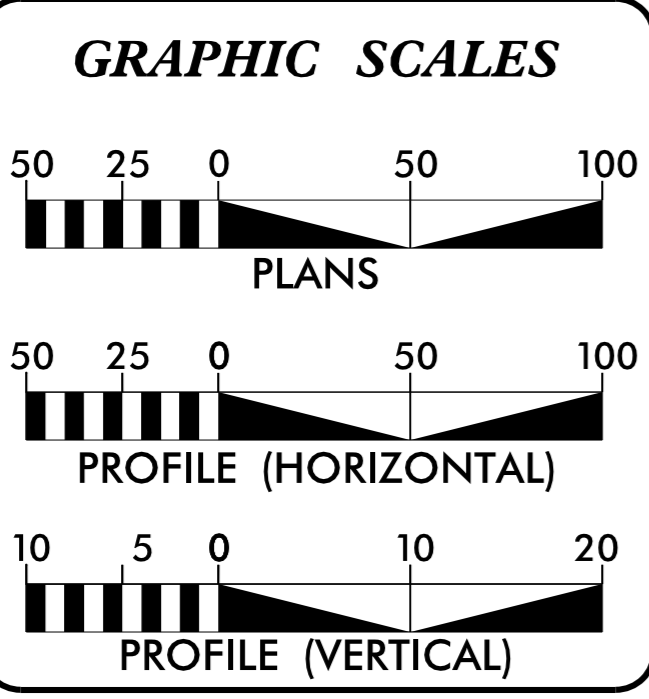
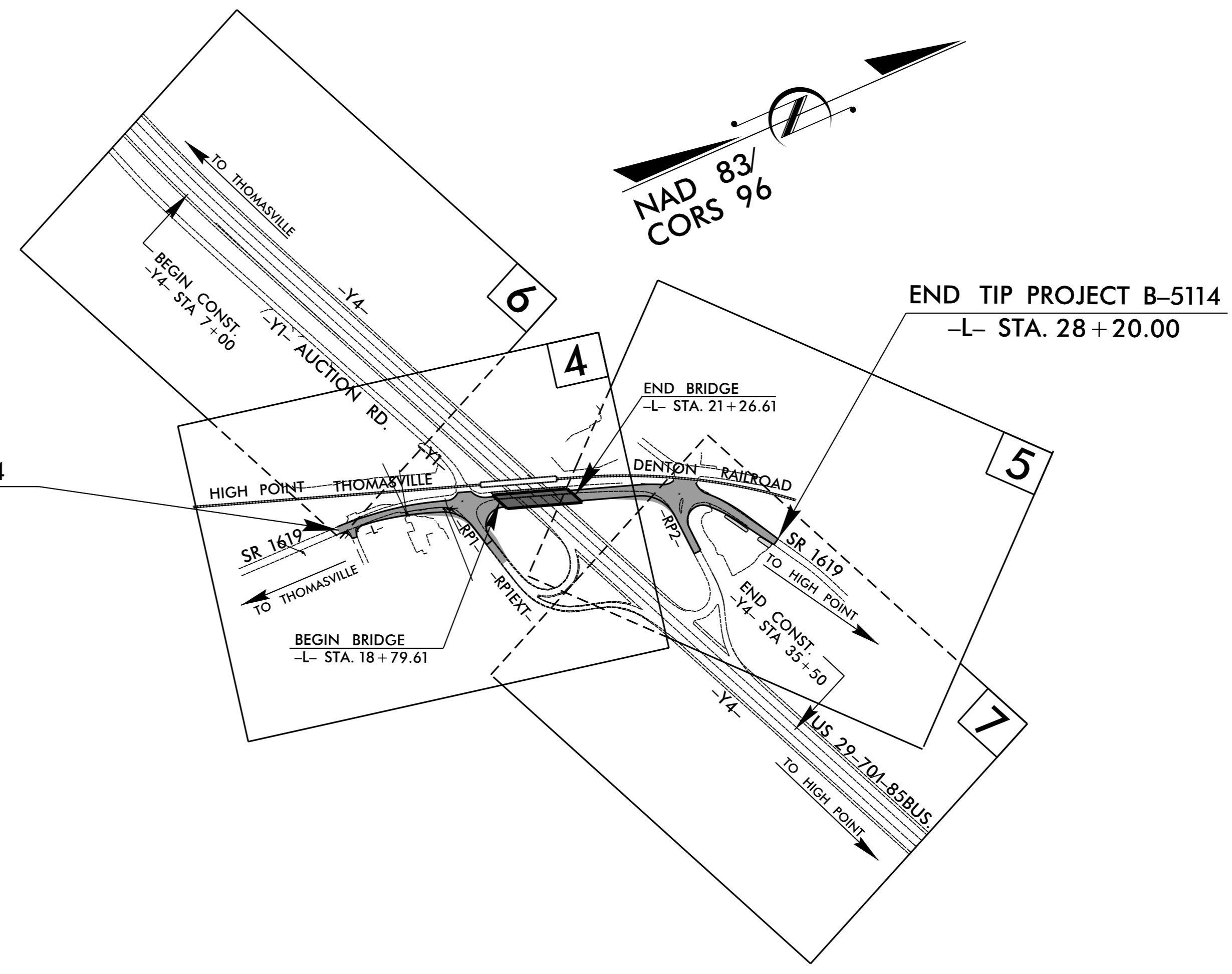
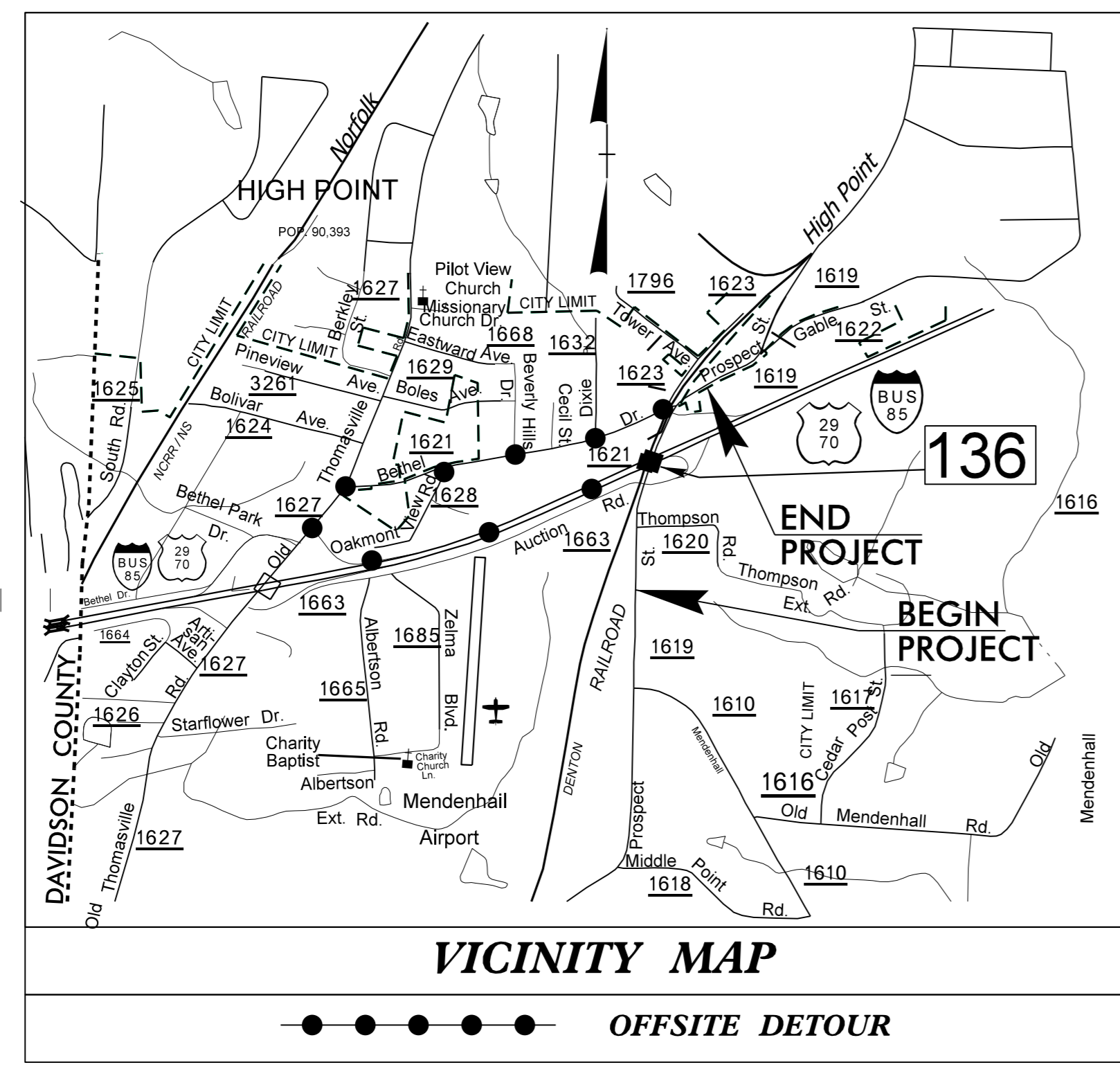

DESIGN DATA

ADT 2015 =	8,300
ADT 2035 =	12,300
K =	11 %
D =	70 %
T =	8 % *
V =	40 MPH
* TTST 3%	DUAL 5%
FUNC CLASS = MINOR ARTERIAL	
STATEWIDE TIER	

PROJECT LENGTH

LENGTH ROADWAY TIP PROJECT B-5114 =	0.234 MI
LENGTH STRUCTURE TIP PROJECT B-5114 =	0.047 MI
TOTAL LENGTH OF TIP PROJECT B-5114 =	0.281 MI

Prepared in the Office of:
DIVISION OF HIGHWAYS
1000 Birch Ridge Dr., Raleigh NC, 27610

2012 STANDARD SPECIFICATIONS

RIGHT OF WAY DATE:
APRIL 16, 2014

LETTING DATE:
JUNE 16, 2015

JAMES A. SPEER, PE
PROJECT ENGINEER

ALLISON K. WHITE
PROJECT DESIGN ENGINEER

HYDRAULICS ENGINEER

DocuSigned by:
Ray D. Lovinggood
4/6/2015

ROADWAY DESIGN ENGINEER

DocuSigned by:
James A. Speer
4/6/2015

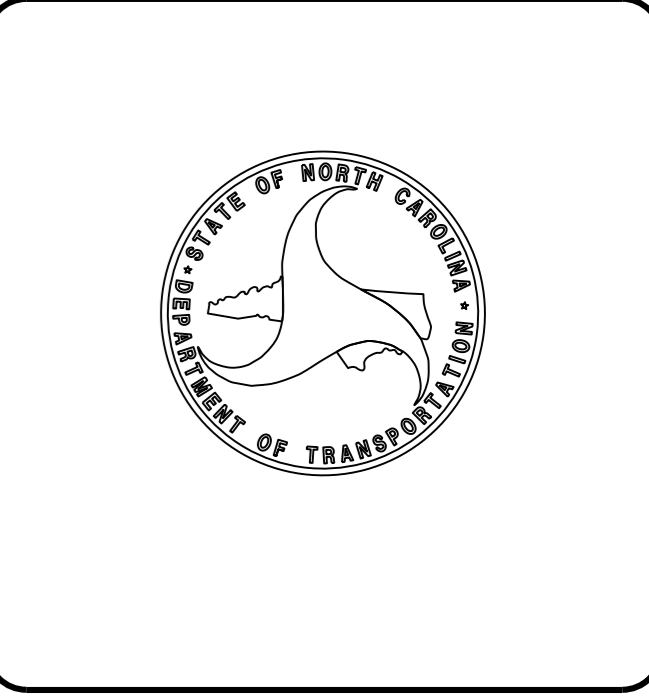

02-APR-2015 12:00
R:\Roadway\Proj\B5114_Rdy_tsh.dgn
\$\$\$\$\$USERNAME\$\$\$\$\$