

UTILITIES BY OTHERS

NOTE:
 ALL PROPOSED UTILITY WORK SHOWN ON THIS SHEET WILL BE DONE BY OTHERS. NO PAYMENT WILL BE MADE TO THE CONTRACTOR FOR PROPOSED UTILITY WORK SHOWN ON THIS SHEET.

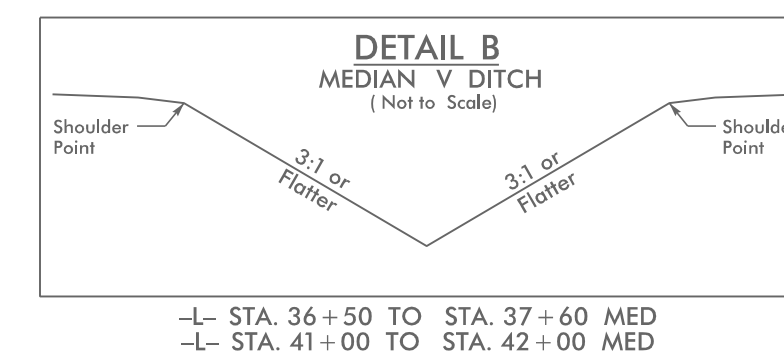
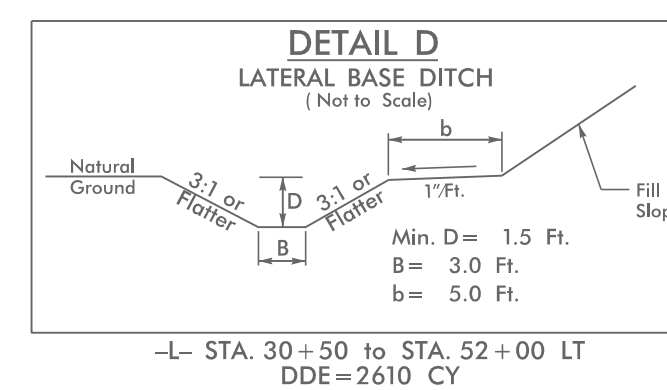
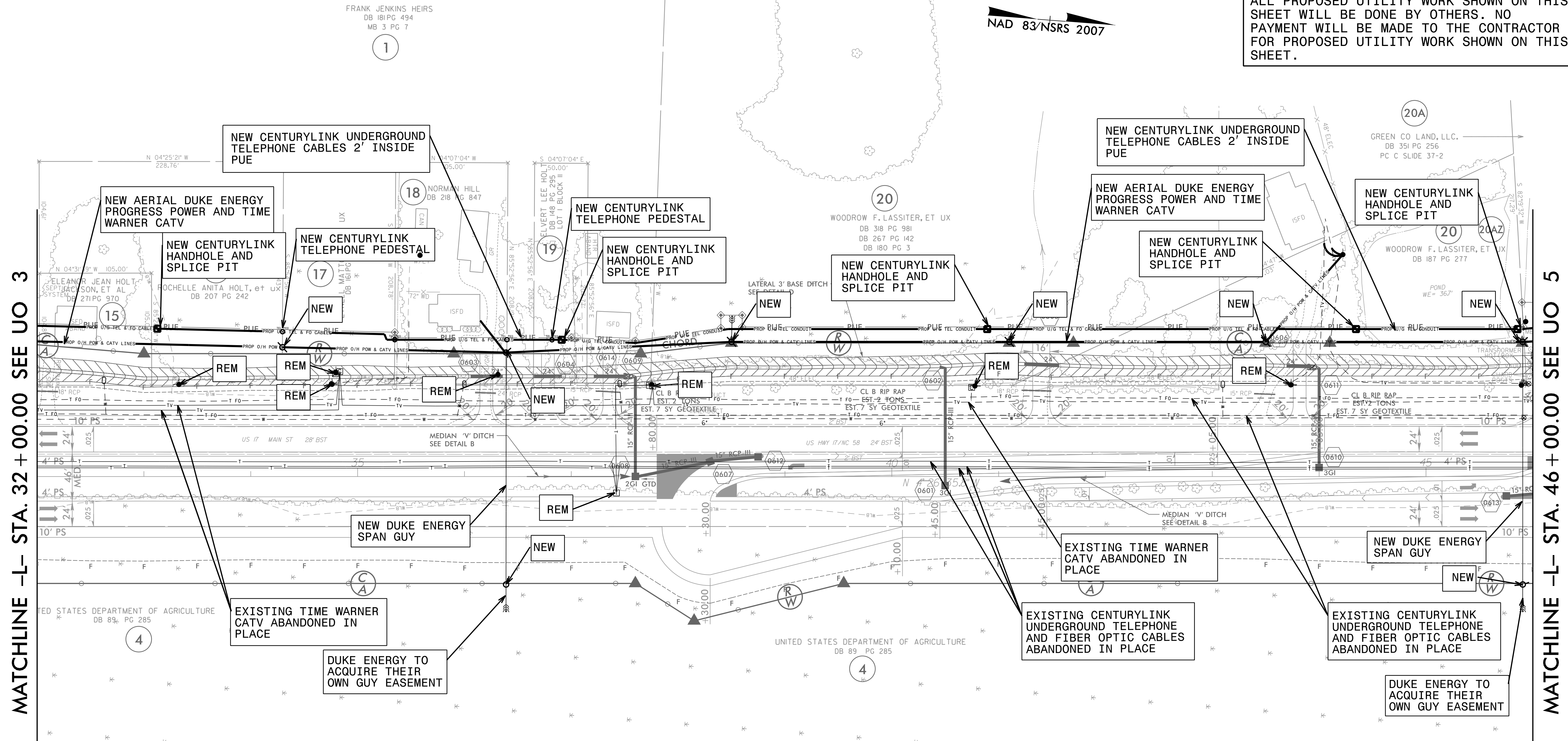

NOTES:

1. ALL CENTURYLINK UNDERGROUND TELEPHONE AND FIBER OPTIC IS TO BE ABANDONED IN PLACE. ALL PEDESTALS AND OTHER HARDWARE TO BE REMOVED. ALL CENTURYLINK RELOCATIONS ARE 2' INSIDE RW AND/OR PUE UNLESS OTHERWISE NOTED. ALL BORES TO BE 15' UNDER WETLANDS AS WELL AS UNDER -L- LINE AND PERPENDICULAR TO -L- LINE. BURIED CABLES AND BORES TO CLEAR UNDERCUT AREAS AND DITCH'S BY A MINIMUM OF 3'
2. ALL TIME WARNER CATV IS TO BE ABANDONED IN PLACE. ALL PEDESTALS AND OTHER HARDWARE TO BE REMOVED.

<p>UTILITY OWNERS ON THIS SHEET</p>	<p>PLANS PREPARED BY :</p>
<p>DUKE PROGRESS ENERGY - POWER TIME WARNER - CATV CENTURYLINK - TELEPHONE AND FIBER OPTIC</p>	<p>RK&K RUMMEL, KLEPPER & KAHL, LLP 900 RIDGEFIELD DRIVE SUITE 350 RALEIGH, NORTH CAROLINA 27609-3960 NC LICENSE NO. F-0112 • (919) 878-9560</p>