

UTILITIES BY OTHERS

NOTE:
ALL PROPOSED UTILITY WORK SHOWN ON THIS SHEET WILL BE DONE BY OTHERS. NO PAYMENT WILL BE MADE TO THE CONTRACTOR FOR PROPOSED UTILITY WORK SHOWN ON THIS SHEET.

MATCHLINE -L- STA. 19+00.00 SEE UO 2

MATCHLINE -L- STA. 32+00.00 SEE UO 4

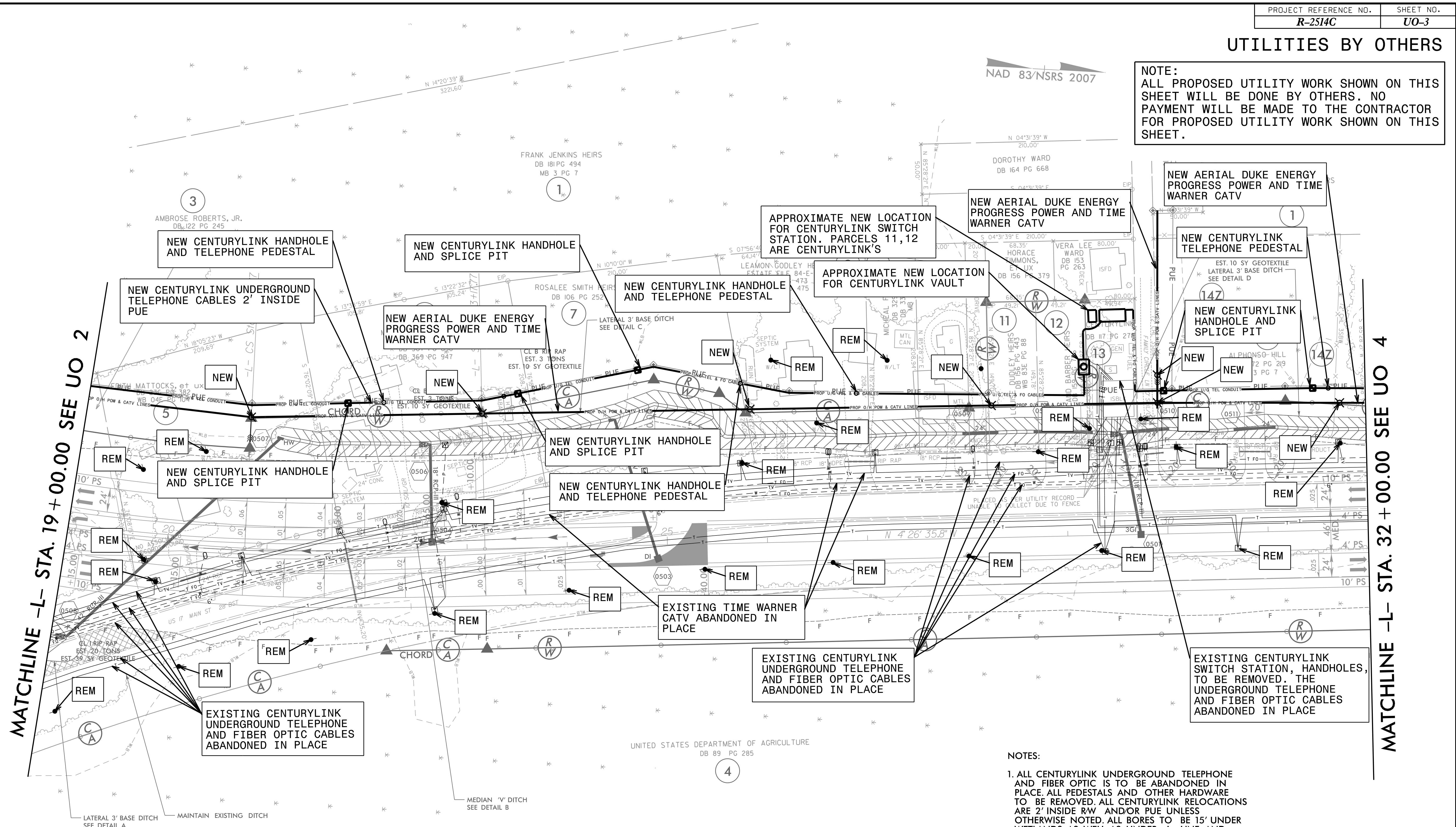

-L-

PI Sta 16+95.31	Pls Sta 21+57.81
$\Delta = 27^{\circ}14'57.6"$ (LT)	$\Theta_s = 4^{\circ}11'32.5"$
D = 3' 29" 37.1"	Ls = 240.00'
L = 779.97'	LT = 160.04'
T = 397.51'	ST = 80.04'
R = 1,640.00'	
SE = .06	
RO = 240'	

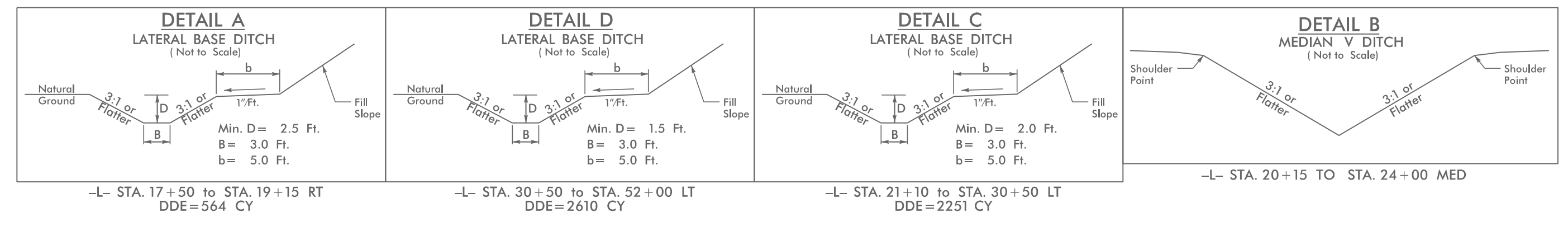

NOTES:

- ALL CENTURYLINK UNDERGROUND TELEPHONE AND FIBER OPTIC IS TO BE ABANDONED IN PLACE. ALL PEDESTALS AND OTHER HARDWARE TO BE REMOVED. ALL CENTURYLINK RELOCATIONS ARE 2' INSIDE RW AND/OR PUE UNLESS OTHERWISE NOTED. ALL BORES TO BE 15' UNDER WETLANDS AS WELL AS UNDER -L- LINE AND PERPENDICULAR TO -L- LINE. BURIED CABLES AND BORES TO CLEAR UNDERCUT AREAS AND DITCH'S BY A MINIMUM OF 3'. EXISTING CENTURYLINK SWITCH STATION TO BE DEMOLISHED BY CONTRACTOR.
- ALL TIME WARNER CATV IS TO BE ABANDONED IN PLACE. ALL PEDESTALS AND OTHER HARDWARE TO BE REMOVED. TIME WARNER WILL BE IN JOINT USE WITH DUKE ENERGY PROGRESS TIME WARNER TO COORDINATE WITH DUKE ENERGY PROGRESS FOR RELOCATION PROCEDURE

UTILITY OWNERS ON THIS SHEET

DUKE PROGRESS ENERGY - POWER
TIME WARNER - CATV
CENTURYLINK - TELEPHONE AND FIBER OPTIC

PLANS PREPARED BY :

RK&K
RUMMEL, KLEPPER & KAHL, LLP
900 RIDGEFIELD DRIVE SUITE 350
RALEIGH, NORTH CAROLINA 27609-3960
NC LICENSE NO. F-0112 • (919) 878-9560