

UTILITIES BY OTHERS

NOTE:
ALL PROPOSED UTILITY WORK SHOWN ON THIS SHEET WILL BE DONE BY OTHERS. NO PAYMENT WILL BE MADE TO THE CONTRACTOR FOR PROPOSED UTILITY WORK SHOWN ON THIS SHEET.

MATCHLINE -Y1- STA. 21+00.00 SEE UO 18

MATCHLINE -Y- STA. 32+00.00 SEE UO 18

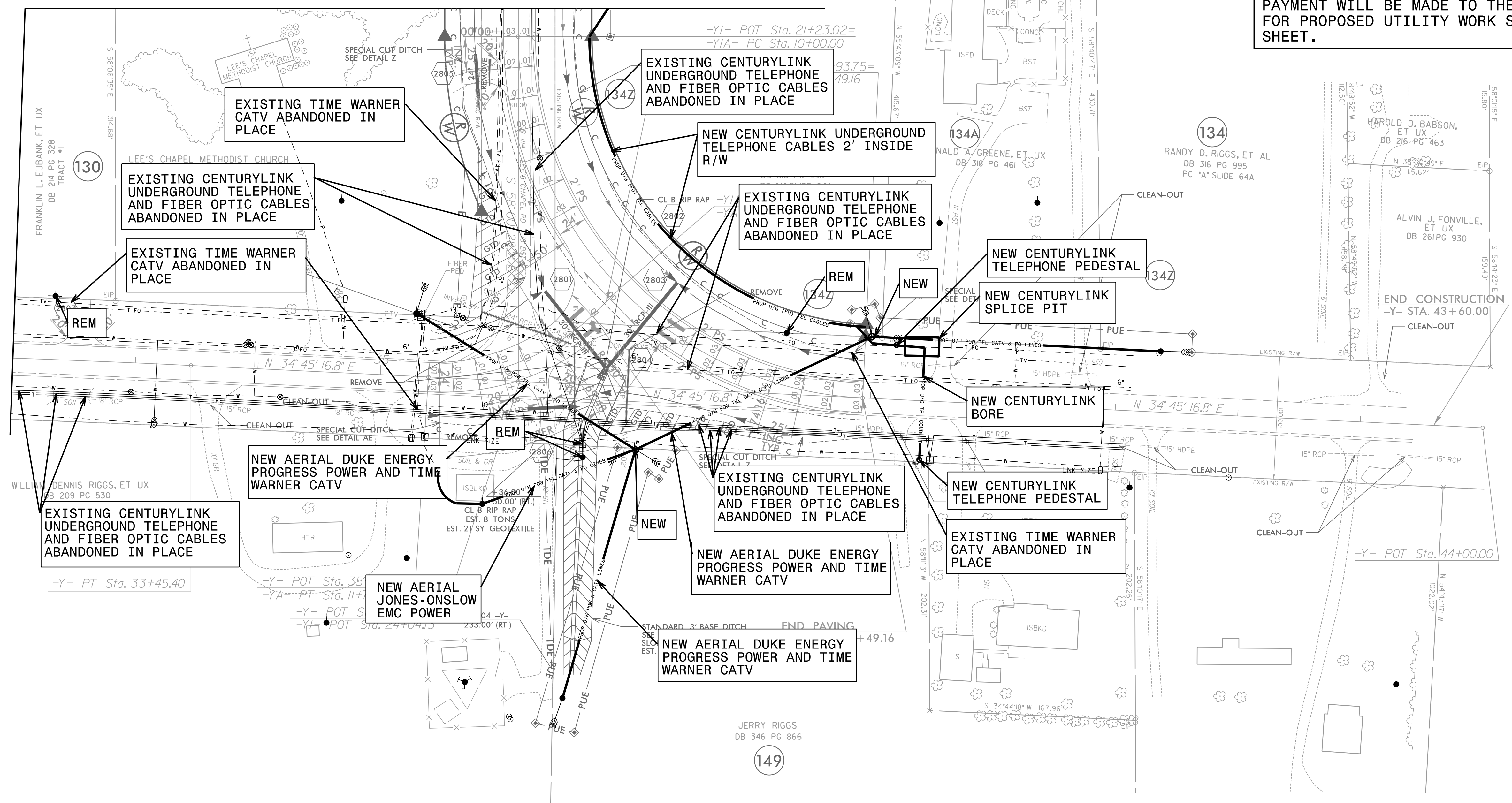

-Y-	-YA-	-Y1A-
PI Sta 32+43.19	PI Sta 11+09.43	PI Sta 12+81.11
$\Delta = 1^{\circ} 03' 35.2''$ (RT)	$\Delta = 46^{\circ} 48' 13.2''$ (RT)	$\Delta = 87^{\circ} 14' 15.0''$ (LT)
D = 0' 31' 06.4"	D = 31' 49' 51.6"	D = 19' 25' 20.3"
L = 204.41'	L = 147.04'	L = 449.16'
T = 102.21'	T = 77.90'	T = 281.11'
R = 11,051.47'	R = 180.00'	R = 295.00'
	SE = SEE PLANS	SE = SEE PLANS

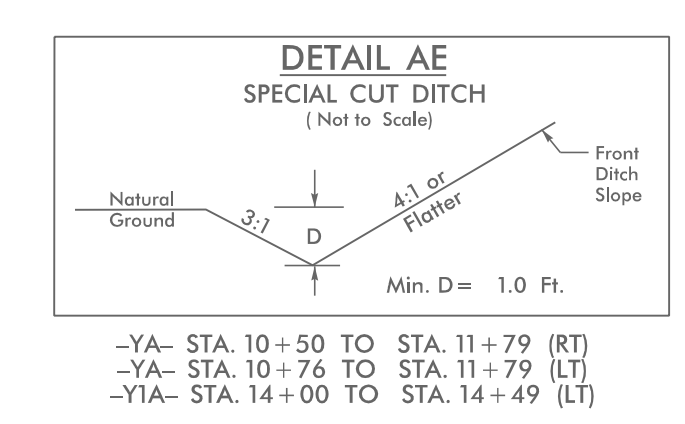
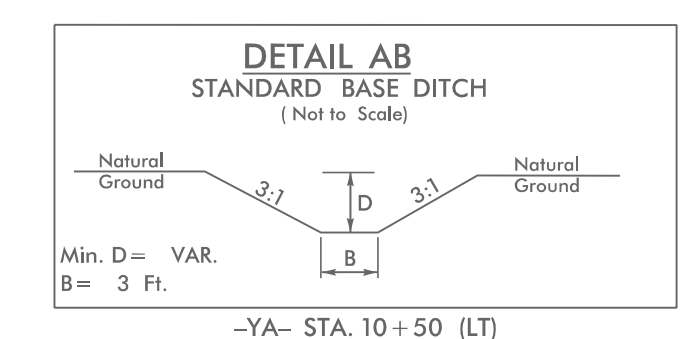

NOTES:

1. ALL CENTURYLINK UNDERGROUND TELEPHONE AND FIBER OPTIC IS TO BE ABANDONED IN PLACE. ALL PEDESTALS AND OTHER HARDWARE TO BE REMOVED. ALL CENTURYLINK RELOCATIONS ARE 2' INSIDE RW AND/OR PUE UNLESS OTHERWISE NOTED. ALL BORES TO BE 15' UNDER WETLANDS AS WELL AS UNDER -L- LINE AND PERPENDICULAR TO -L- LINE. BURIED CABLES AND BORES TO CLEAR UNDERCUT AREAS AND DITCH'S BY A MINIMUM OF 3'
2. ALL TIME WARNER CATV IS TO BE ABANDONED IN PLACE. ALL PEDESTALS AND OTHER HARDWARE TO BE REMOVED.

UTILITY OWNERS ON THIS SHEET

JONES-ONSLow EMC - POWER
CENTURYLINK - TELEPHONE/FIBER OPTIC
TIME WARNER - CATV

PLANS PREPARED BY :
RK&K
RUMMEL, KLEPPER & KAHL, LLP
900 RIDGEFIELD DRIVE SUITE 350
RALEIGH, NORTH CAROLINA 27609-3960
NC LICENSE NO. F-0112 • (919) 878-9560

S 571700.391' E
1083.54'