

**UTILITIES BY OTHERS**

**NOTE:**  
ALL PROPOSED UTILITY WORK SHOWN ON THIS SHEET WILL BE DONE BY OTHERS. NO PAYMENT WILL BE MADE TO THE CONTRACTOR FOR PROPOSED UTILITY WORK SHOWN ON THIS SHEET.

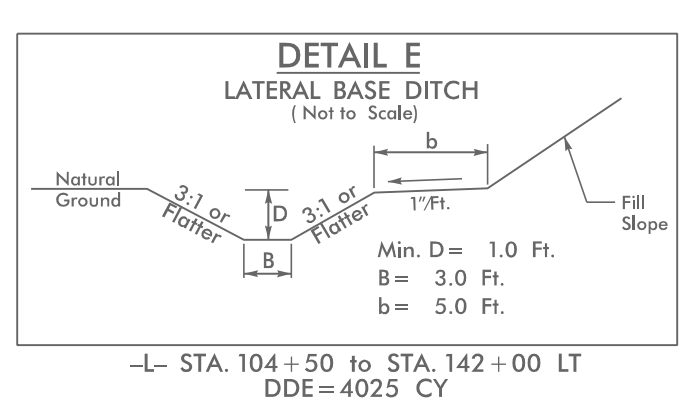
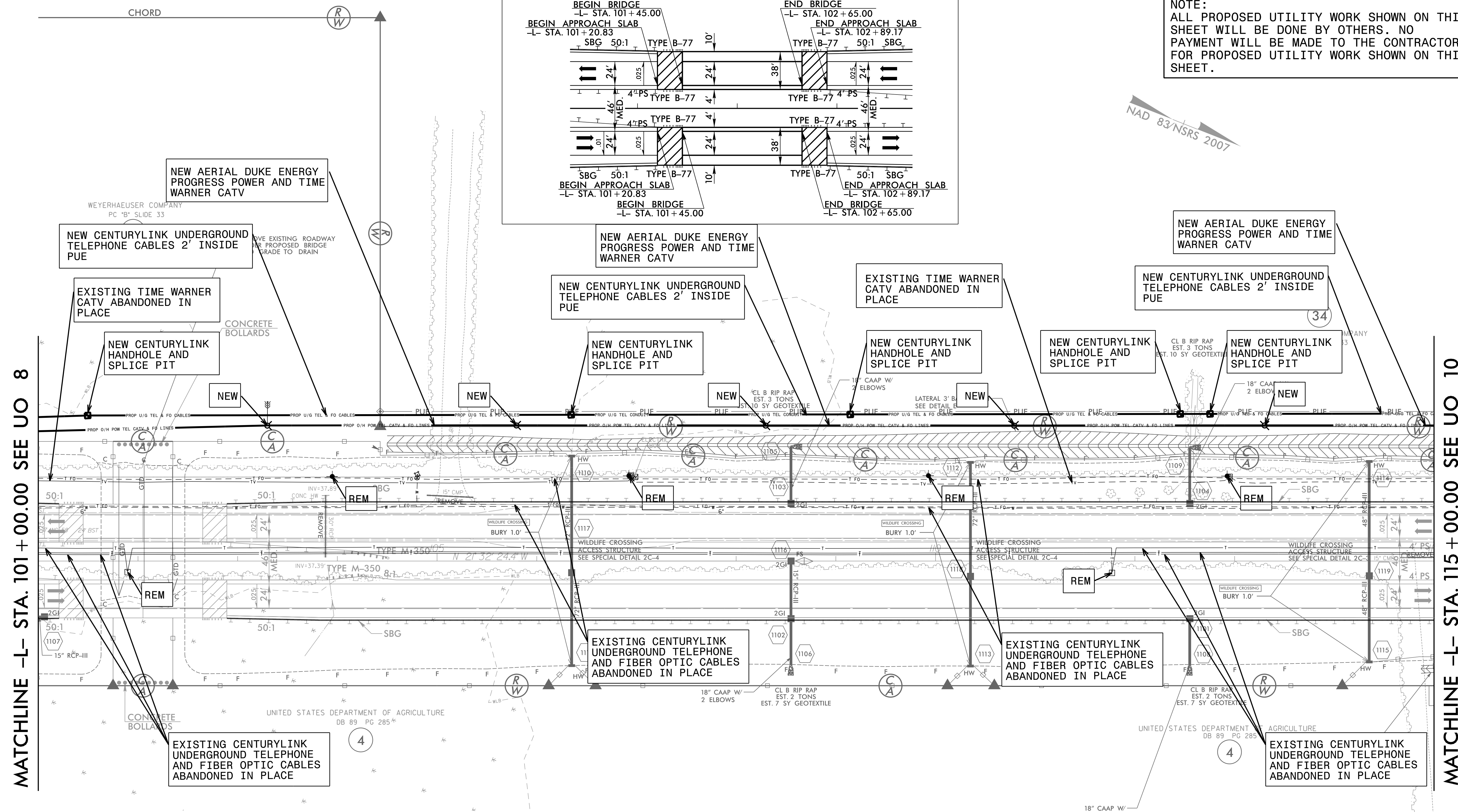
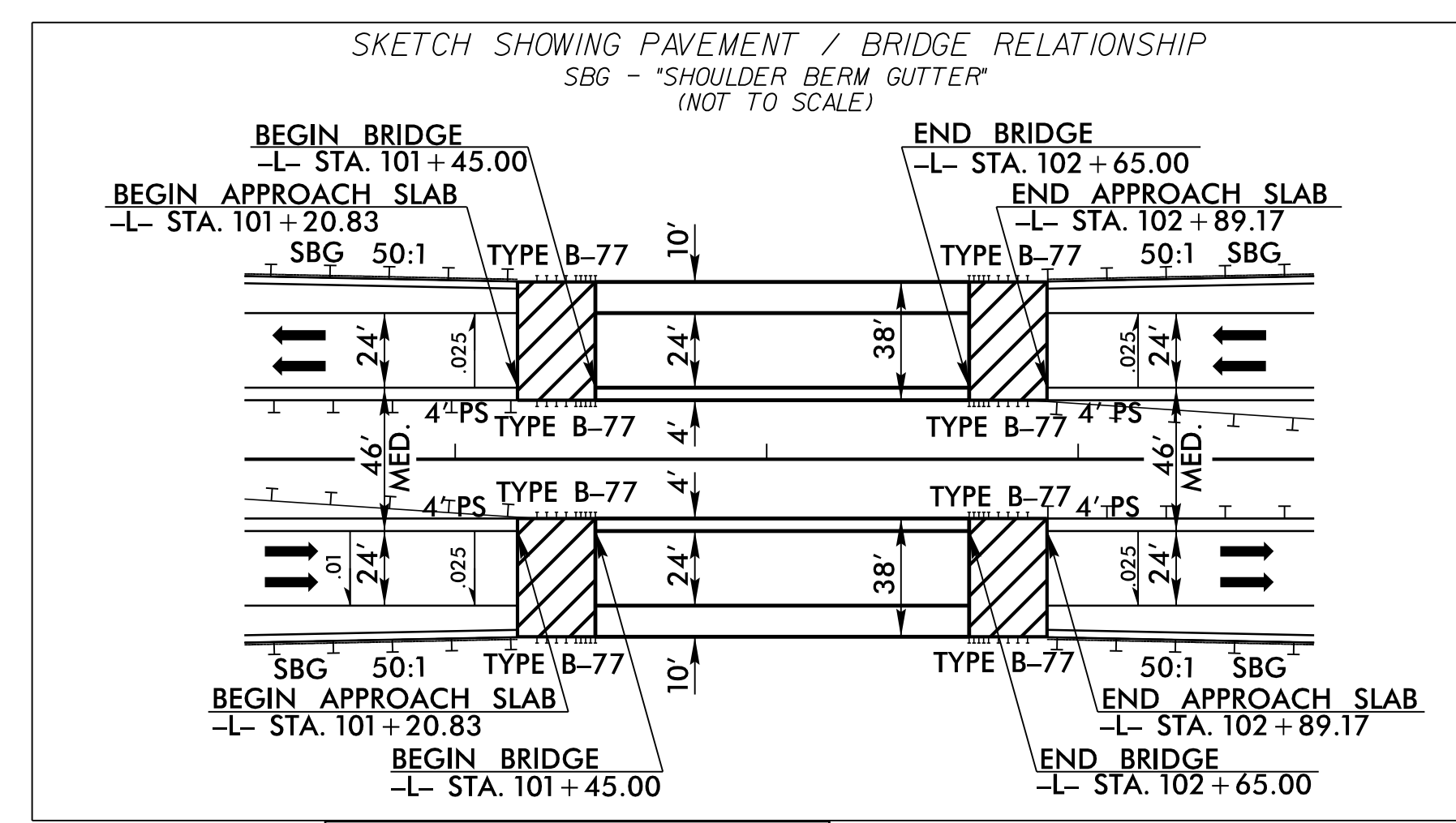
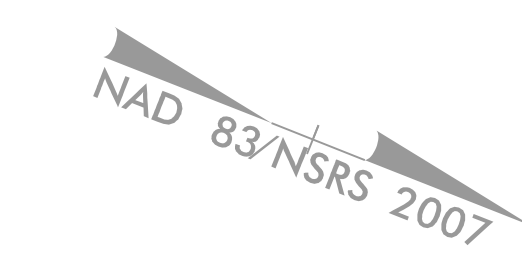

- NOTES:**
1. ALL CENTURYLINK UNDERGROUND TELEPHONE AND FIBER OPTIC IS TO BE ABANDONED IN PLACE. ALL PEDESTALS AND OTHER HARDWARE TO BE REMOVED. ALL CENTURYLINK RELOCATIONS ARE 2' INSIDE R/W AND/OR PUE UNLESS OTHERWISE NOTED. ALL BORES TO BE 15' UNDER WETLANDS AS WELL AS UNDER -L- LINE. AND PERPENDICULAR TO -L- LINE. BURIED CABLES AND BORES TO CLEAR UNDERCUT AREAS AND DITCH'S BY A MINIMUM OF 3'
  2. ALL TIME WARNER CATV IS TO BE ABANDONED IN PLACE. ALL PEDESTALS AND OTHER HARDWARE TO BE REMOVED.

<b>UTILITY OWNERS ON THIS SHEET</b>	<b>PLANS PREPARED BY :</b>
DUKE PROGRESS ENERGY - POWER TIME WARNER - CATV CENTURYLINK - TELEPHONE AND FIBER OPTIC	<b>RK&amp;K</b> RUMMEL, KLEPPER & KAHL, LLP 900 RIDGEFIELD DRIVE SUITE 350 RALEIGH, NORTH CAROLINA 27609-3960 NC LICENSE NO. F-0112 • (919) 878-9560