

TYPICAL #1: PORTABLE CONCRETE BARRIER SECTION

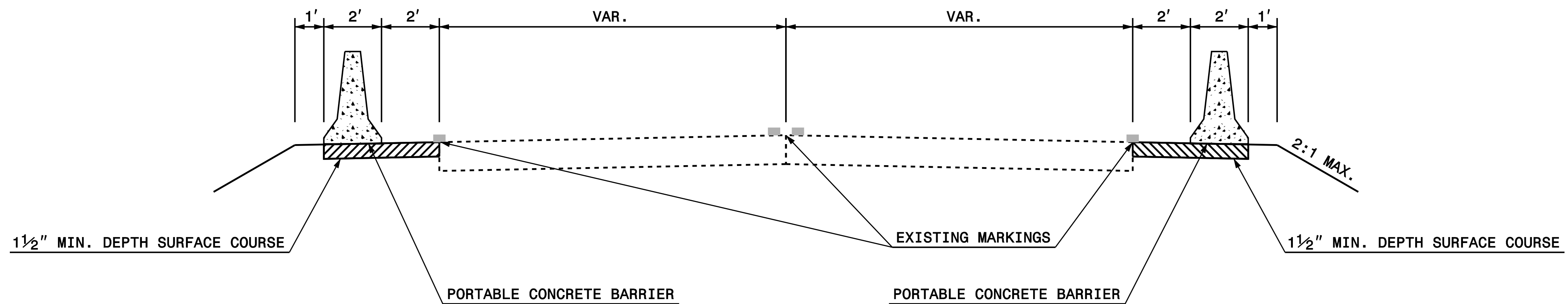

TYPICAL #2: LEADING EDGE LAYOUT FOR PORTABLE CONCRETE BARRIER

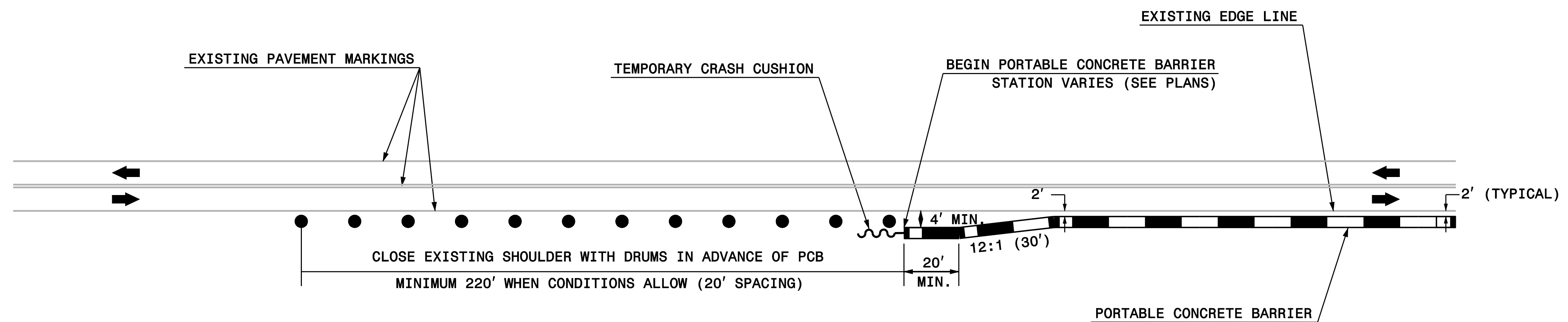

PLAN PREPARED IN THE OFFICE OF:
PROGRESSIVE
DESIGN GROUP, INC.
ENGINEERS • CONSULTANTS

APPROVED: *[Signature]* DATE: 4/15/2015
SEAL
NORTH CAROLINA PROFESSIONAL ENGINEER
TIM ARY

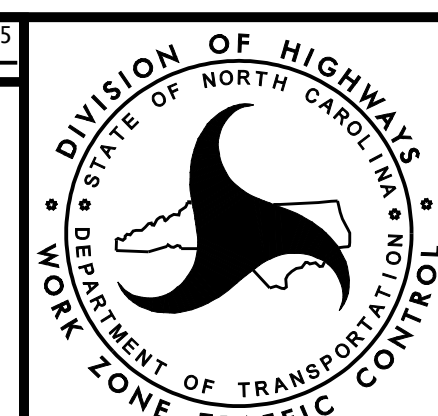

ROADWAY STANDARD
DRAWINGS & LEGEND
PCB TYPICALS