

SPLICE LENGTHS		
BAR	SIZE	LENGTH
A1	#4	2'-0"
A2	#4	1'-9"

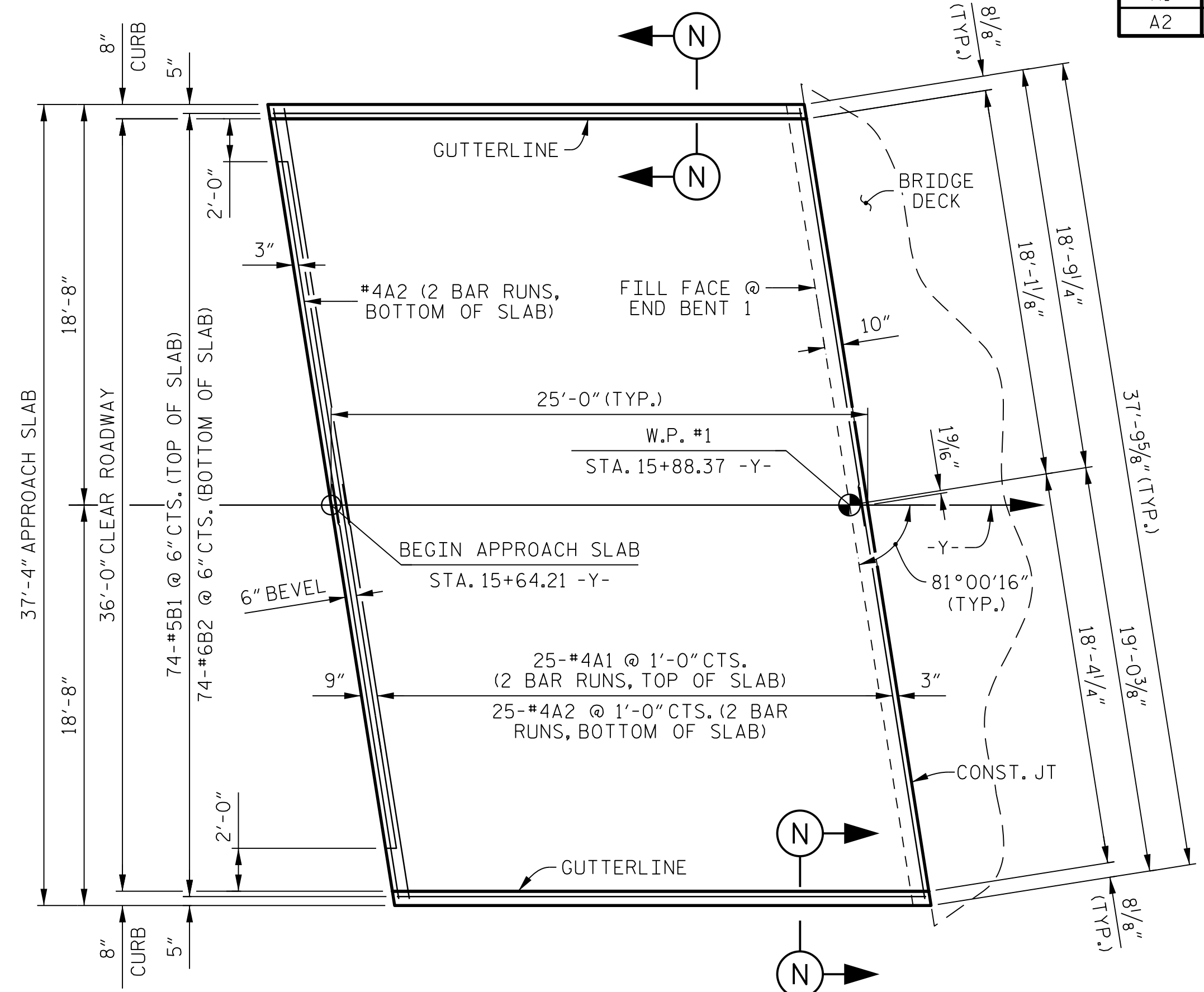

PLAN OF APPROACH SLAB AT END BENT 1

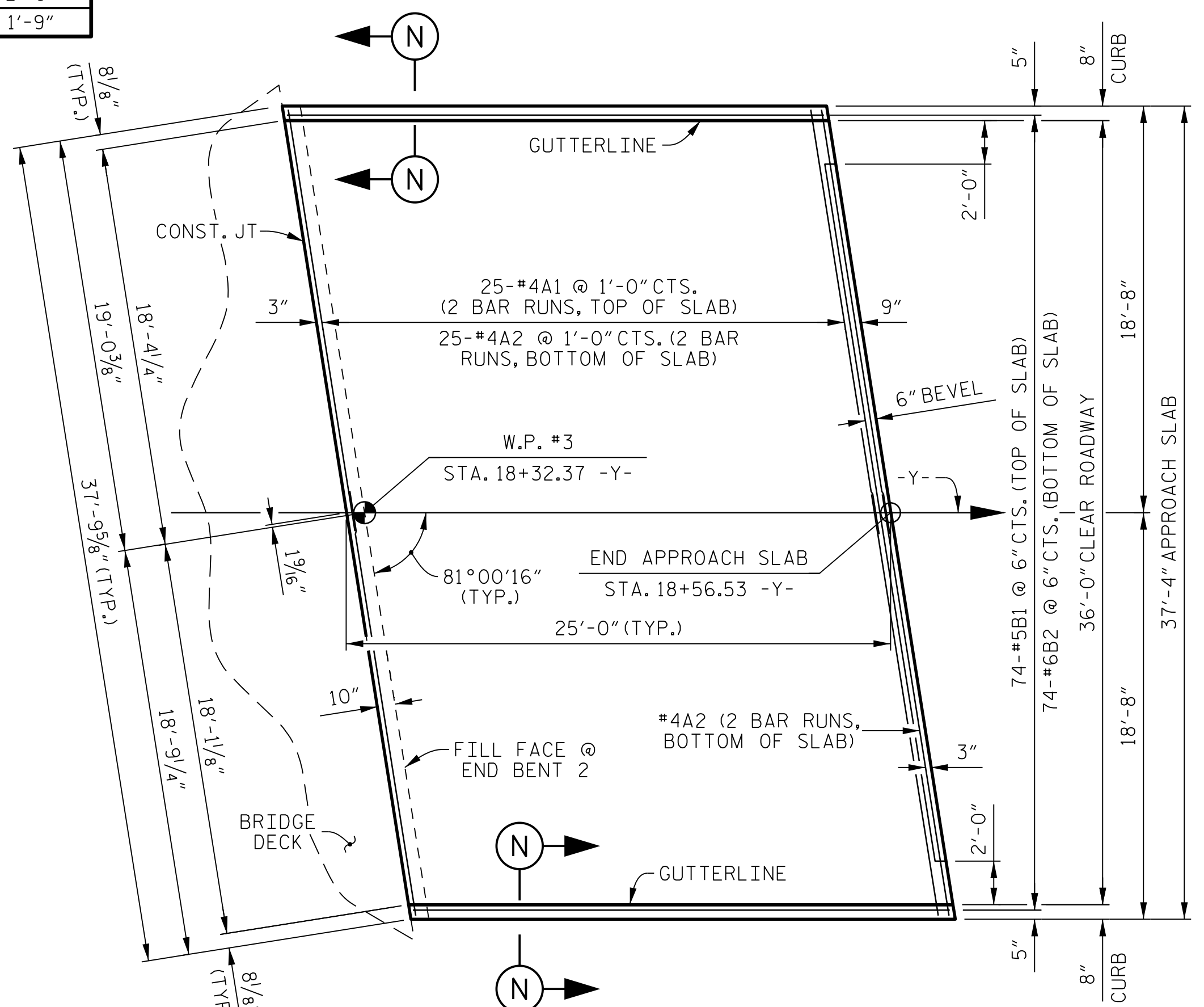

PLAN OF APPROACH SLAB AT END BENT 2

BILL OF MATERIAL					
APPROACH SLAB AT END BENT 1 OR END BENT 2					
BAR No.	SIZE	TYPE	LENGTH	WEIGHT	
*A1	50	#4	STR	19'-9"	660
A2	52	#4	STR	19'-8"	683
*B1	74	#5	STR	24'-2"	1,865
B2	74	#6	STR	24'-8"	2,742
REINFORCING STEEL					3,425 LBS.
*EPOXY COATED REINFORCING STEEL					2,525 LBS.
CLASS "AA" CONCRETE					40.4 CU. YDS.

NOTES

APPROACH SLAB SHALL NOT BE CONSTRUCTED PRIOR TO COMPLETION OF THE BRIDGE DECK.

FOR REINFORCED BRIDGE APPROACH FILL INCLUDING GEOTEXTILE, IMPERMEABLE GEOMEMBRANE, 4" Ø DRAINAGE PIPE, #78M STONE, AND SELECT MATERIAL, SEE ROADWAY PLANS.

AREA BETWEEN THE WINGWALL AND APPROACH SLAB SHALL BE GRADED TO DRAIN THE WATER AWAY FROM THE FILL FACE OF THE BRIDGE AND SHALL BE PAVED. SEE ROADWAY PLANS.

THE JOINT OPENING AT THE APPROACH SLAB/DECK INTERFACE SHALL BE SAWED NO MORE THAN 12 HOURS AFTER THE APPROACH SLAB IS CAST. THE JOINT SHALL BE CLEANED OF ALL DEBRIS BEFORE THE SEALANT IS APPLIED. THE JOINT SEALER MATERIAL SHALL CONFORM TO THE REQUIREMENTS OF SECTION 1028-3 OF THE STANDARD SPECIFICATIONS.

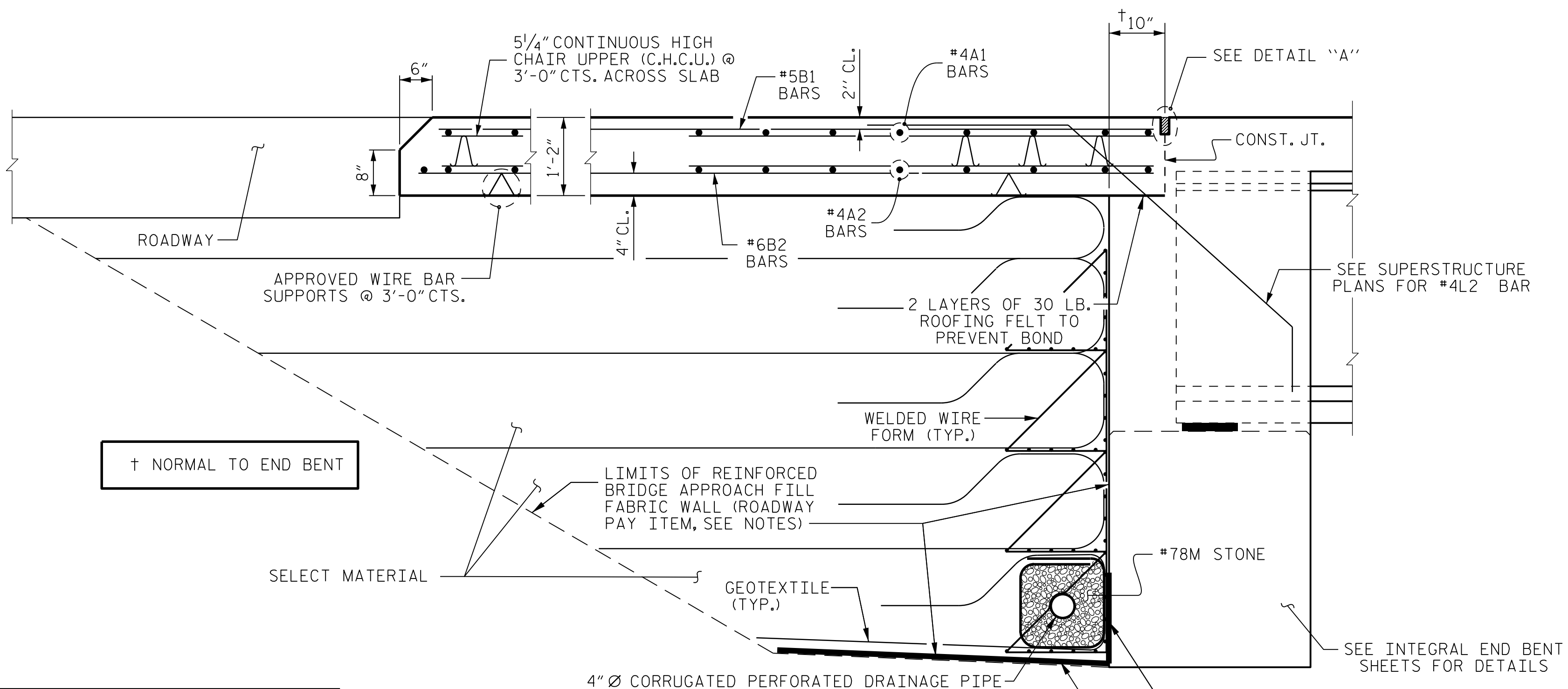

SECTION THRU SLAB

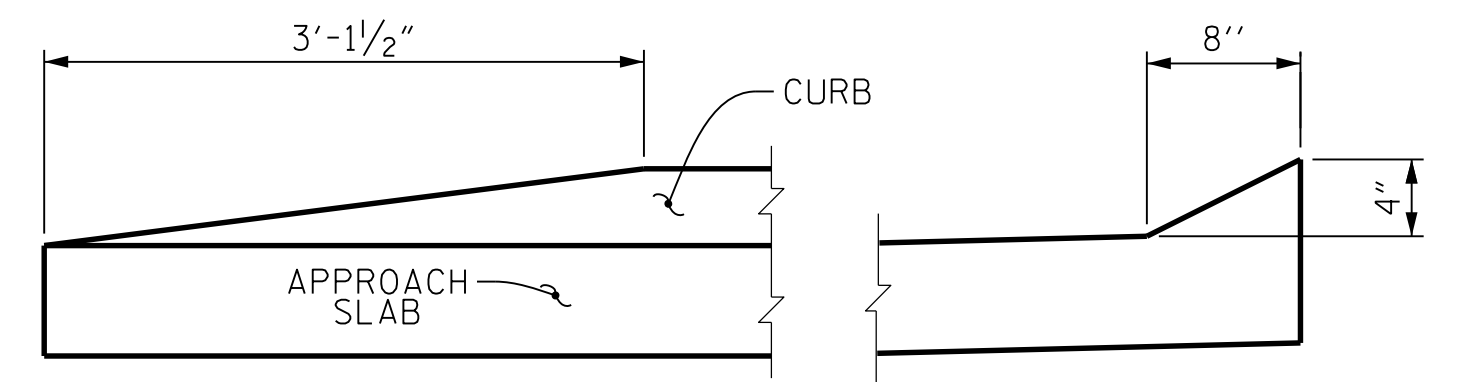

CURB DETAILS

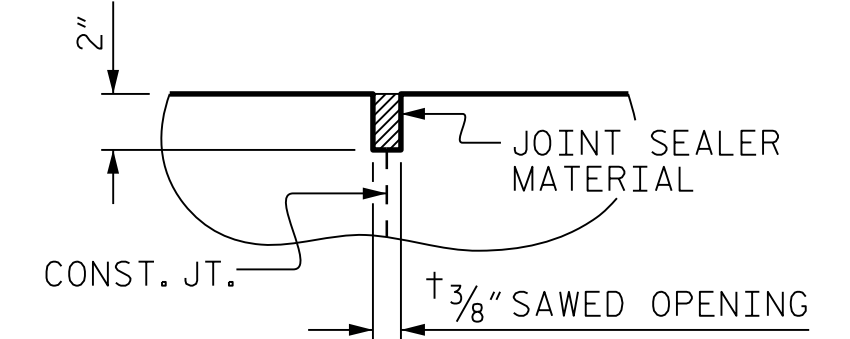

DETAIL "A"

PROJECT NO. **U-2524BC**
GUILFORD COUNTY
 STATION: **27 + 40.75 -L-**
 SHEET 1 OF 2

STATE OF NORTH CAROLINA
 DEPARTMENT OF TRANSPORTATION
 RALEIGH
 STANDARD
BRIDGE APPROACH SLAB FOR INTEGRAL ABUTMENT

REVISIONS					
No.	BY:	DATE:	No.	BY:	DATE:
1			3		
2			4		

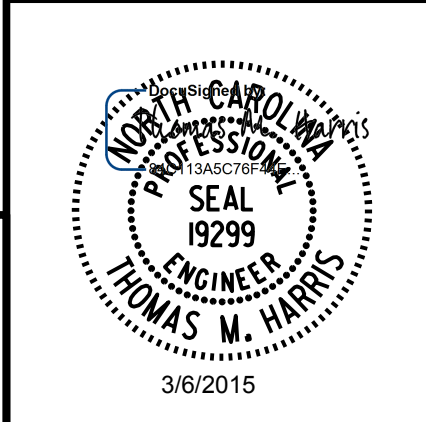

PLANS PREPARED BY:
PARSONS
 5540 CenterView Drive, Suite 217
 Raleigh, NC 27606-3386
 NC LICENSE No. F-0246
 FOR NORTH CAROLINA DEPARTMENT OF TRANSPORTATION

DRAWN BY: K. E. LOFTON DATE: 11-14
 CHECKED BY: T. M. HARRIS DATE: 1-15
 DESIGN ENGINEER: T. M. HARRIS DATE: 2-15

FILE: I:\2524BC\Drawings\Drawings\Final\U2524BC_S01.dgn
 DATE: 3/2/2015 9:42:59 AM

ASSEMBLED BY: K. E. LOFTON DATE: 11-14
 CHECKED BY: T. M. HARRIS DATE: 1-15
 DRAWN BY: TLA 10/05 REV. 10/1/11 MAA/GM
 CHECKED BY: GM 5/06 REV. 12/12/11 MAA/GM
 REV. 6/13 MAA/GM