

UTILITIES BY OTHERS

NOTE:  
ALL PROPOSED UTILITY WORK  
SHOWN ON THIS SHEET WILL  
BE DONE BY OTHERS

**V&M**  
Vaughn & Melton  
Consulting Engineers

Charlotte, North Carolina 704-357-0488  
Tri-Cities, Tennessee 423-467-8401  
Knoxville, Tennessee 606-748-6600  
Middlesboro, Kentucky 606-248-6600  
Asheville, North Carolina 828-253-2796  
Spartanburg, South Carolina 864-574-4775

Copyright © 1994 Vaughn & Melton, Inc. All Rights Reserved

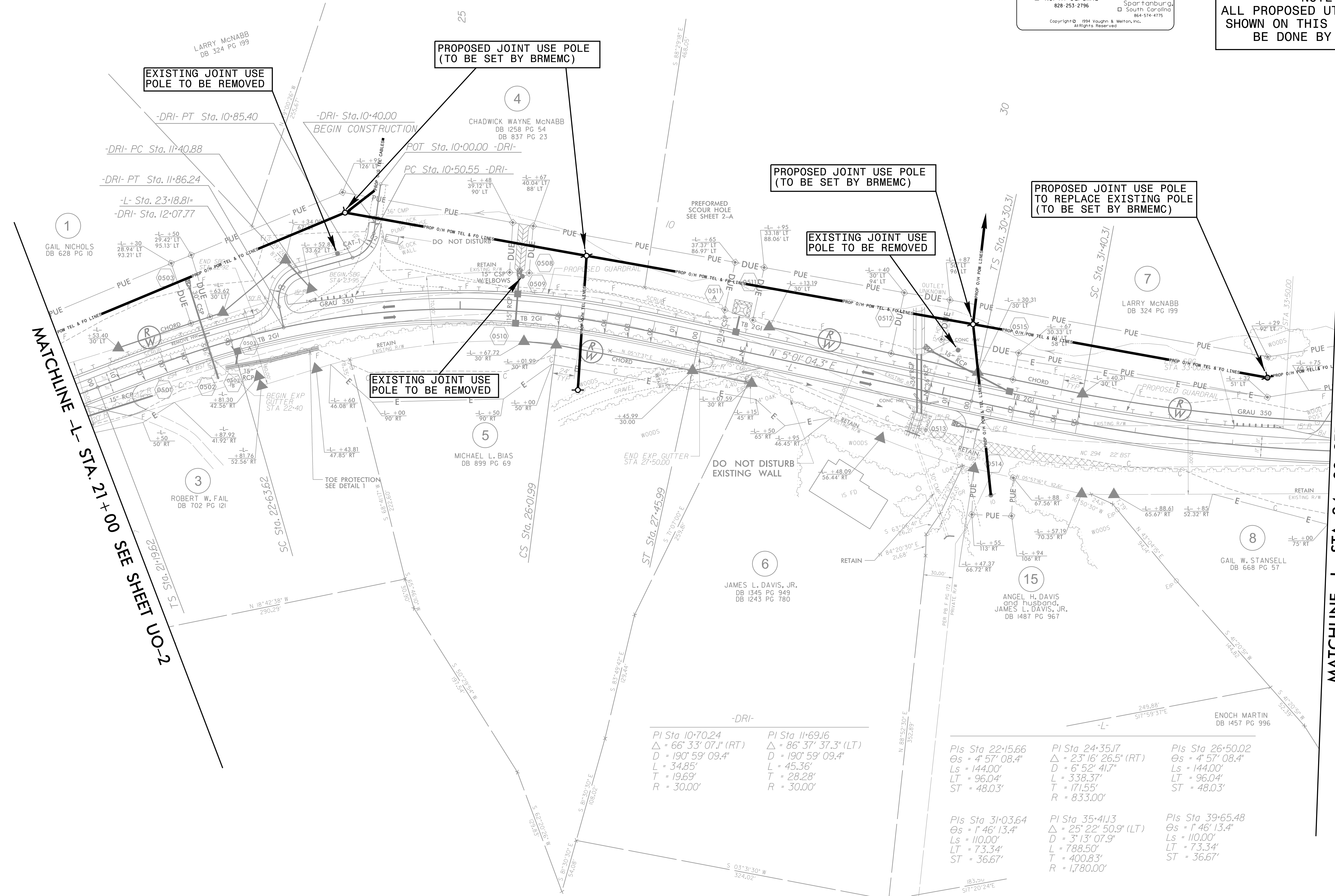

MATCHLINE -L- STA. 21+00 SEE SHEET UO-2

MATCHLINE -L- STA. 34+00 SEE SHEET UO-4

-DRI-

PI Sta 10+70.24	PI Sta 11+69.16
Δ = 66° 33' 07.1" (RT)	Δ = 86° 37' 37.3" (LT)
D = 190° 59' 09.4"	D = 190° 59' 09.4"
L = 34.85'	L = 45.36'
T = 19.69'	T = 28.28'
R = 30.00'	R = 30.00'

PIs Sta 22+15.66	PI Sta 24+35.17	PIs Sta 26+50.02
Δs = 4° 57' 08.4"	Δ = 23° 16' 26.5" (RT)	Δs = 4° 57' 08.4"
Ls = 144.00'	D = 6° 52' 41.7"	Ls = 144.00'
LT = 96.04'	T = 338.37'	LT = 96.04'
ST = 48.03'	T = 171.55'	ST = 48.03'
	R = 833.00'	
PIs Sta 31+03.64	PI Sta 35+41.13	PIs Sta 39+65.48
Δs = 1° 46' 13.4"	Δ = 25° 22' 50.9" (LT)	Δs = 1° 46' 13.4"
Ls = 110.00'	D = 3° 13' 07.9"	Ls = 110.00'
LT = 73.34'	L = 788.50'	LT = 73.34'
ST = 36.67'	T = 400.83'	ST = 36.67'
	R = 1,780.00'	

SEE SHEET 14 FOR -L- PROFILE  
SEE SHEET 22 FOR -DRI- PROFILE

REVISIONS

8/17/99

\$\$\$\$SYTIME\$\$\$\$  
\$\$\$\$SERNAME\$\$\$\$