

V&M
Vaughn & Melton
Consulting Engineers

Charlotte, North Carolina 104-351-0488
Tri-Cities, Tennessee 423-461-8401
Knoxville, Tennessee 865-546-5800
Middlesboro, Kentucky 606-248-6600
Spartanburg, South Carolina 864-574-4775

Asheville, North Carolina
828-253-2796

Copyright © 1994 Vaughn & Melton, Inc.
All Rights Reserved

PROJECT REFERENCE NO. R-3622B	SHEET NO. 11
ROADWAY DESIGN ENGINEER R. Schaefer	HYDRAULICS ENGINEER B. O. Bowen

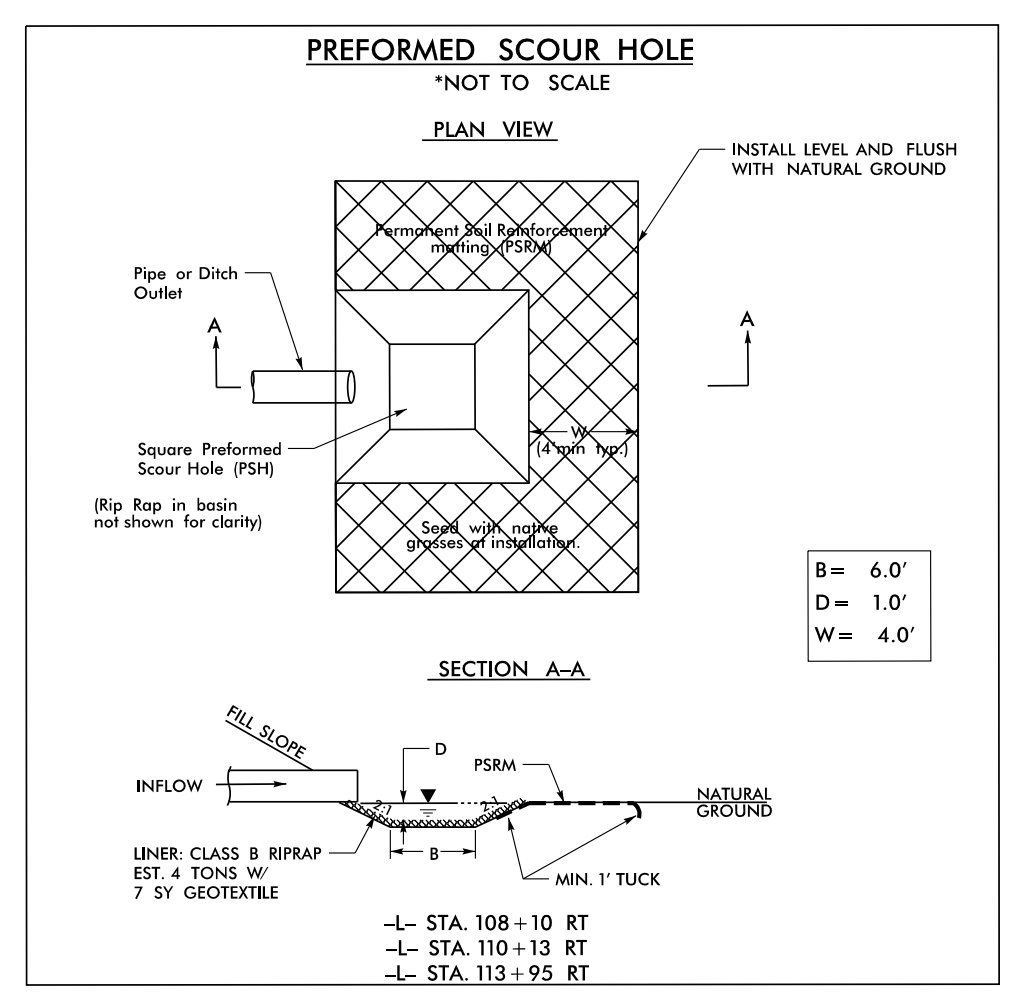
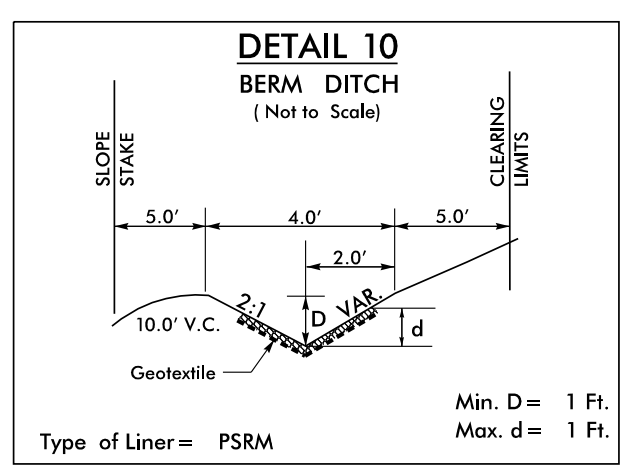
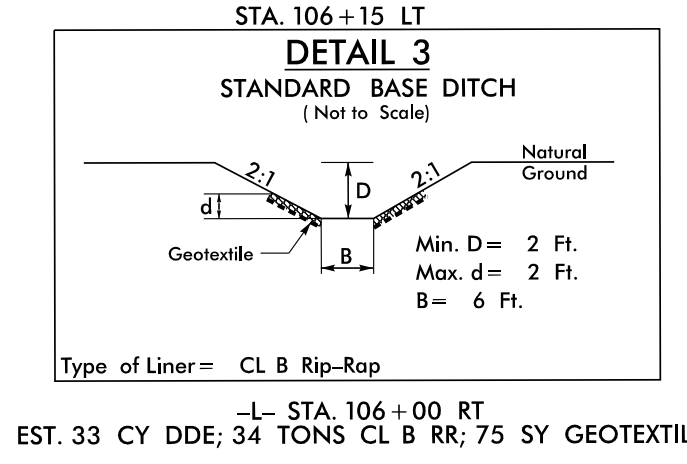
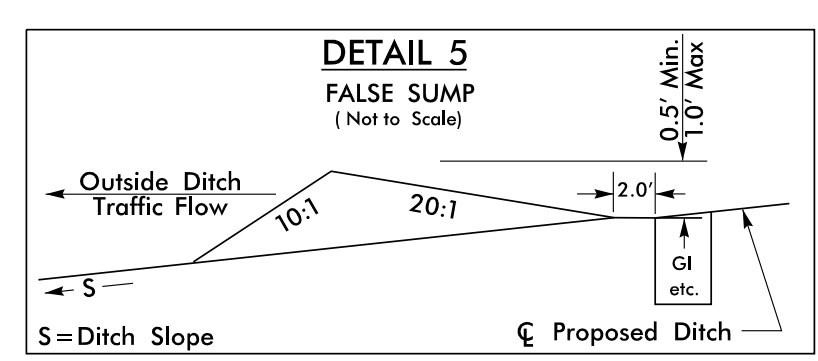
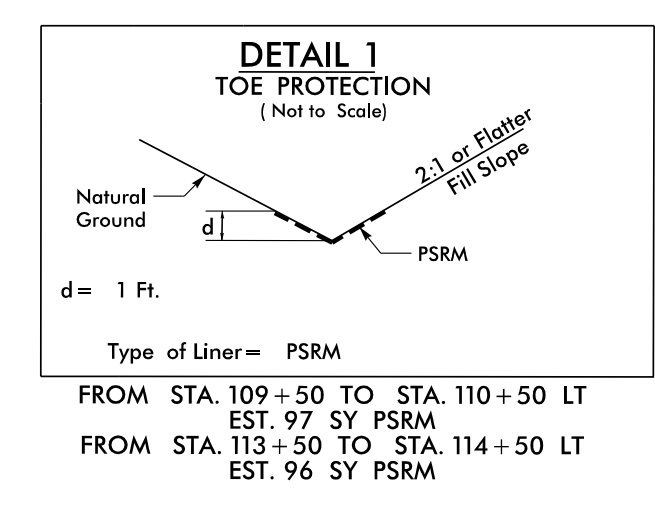
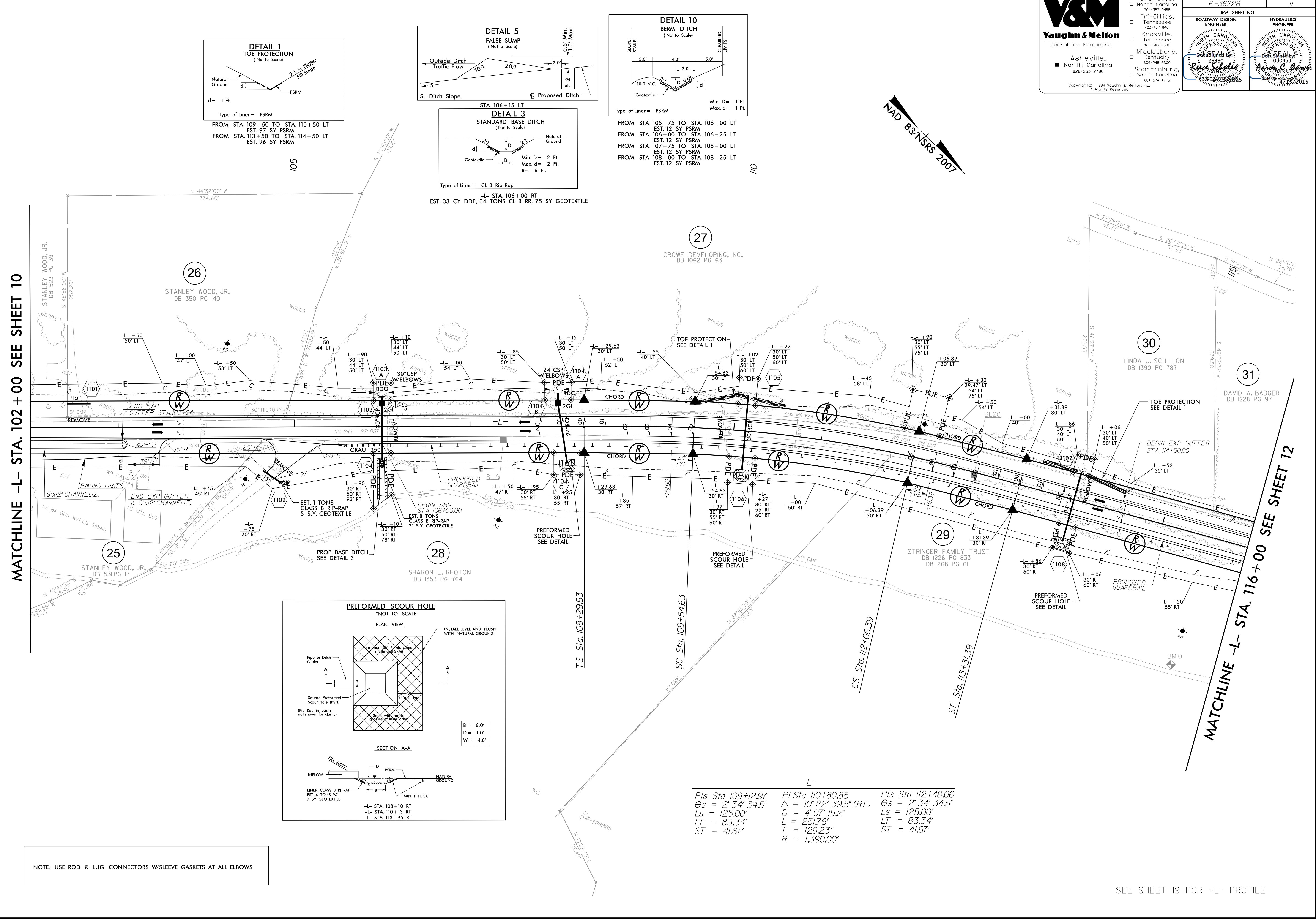

-L-

Pls Sta 109+12.97	Pl Sta 110+80.85	Pls Sta 112+48.06
Os = 2' 34' 34.5"	Δ = 10' 22' 39.5" (RT)	Os = 2' 34' 34.5"
Ls = 125.00'	D = 4' 07' 19.2"	Ls = 125.00'
LT = 83.34'	L = 251.76'	LT = 83.34'
ST = 41.67'	T = 126.23'	ST = 41.67'
	R = 1,390.00'	

MATCHLINE -L- STA. 102 + 00 SEE SHEET 10

MATCHLINE -L- STA. 116 + 00 SEE SHEET 12

NOTE: USE ROD & LUG CONNECTORS W/SLEEVE GASKETS AT ALL ELBOWS

SEE SHEET 19 FOR -L- PROFILE

REVISIONS

69
68
67
66
65
64
63
62
61
60
59
58
57
56
55
54
53
52
51
50
49
48
47
46
45
44
43
42
41
40
39
38
37
36
35
34
33
32
31
30
29
28
27
26
25
24
23
22
21
20
19
18
17
16
15
14
13
12
11
10
9
8
7
6
5
4
3
2
1