

PROJECT REFERENCE NO. U-3609A		SHEET NO. EC-6/CONST.5	
RW SHEET NO.			
ROADWAY DESIGN ENGINEER		HYDRAULICS ENGINEER	
Kimley-Horn and Associates, Inc. P.O. BOX 33068 RALEIGH, N.C. 27636-3068			

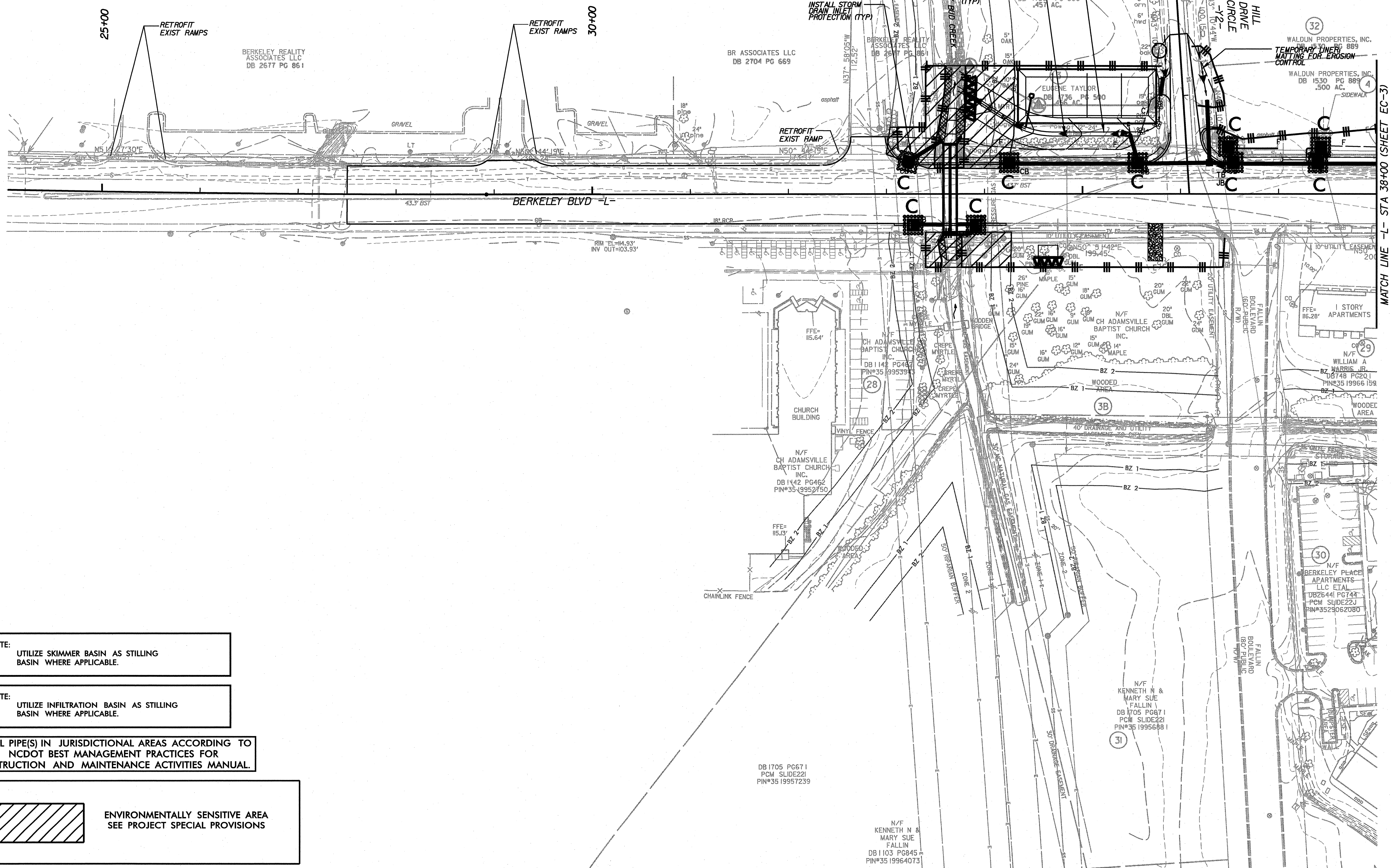

NOTE:
UTILIZE SKIMMER BASIN AS STILLING BASIN WHERE APPLICABLE.

NOTE:
UTILIZE INFILTRATION BASIN AS STILLING BASIN WHERE APPLICABLE.

INSTALL PIPE(S) IN JURISDICTIONAL AREAS ACCORDING TO NCDOT BEST MANAGEMENT PRACTICES FOR CONSTRUCTION AND MAINTENANCE ACTIVITIES MANUAL.

 ENVIRONMENTALLY SENSITIVE AREA
SEE PROJECT SPECIAL PROVISIONS

K:\RAL_Roadway\01746003 (Berkeley Blvd)\Plan\Erosion\01746003_ar006.dgn
1/26/2015

MATCH LINE -L- STA 38+00 (SHEET EC-3)