

**This electronic collection of documents is provided
for the convenience of the user
and is Not a Certified Document –**

**The documents contained herein were originally issued
and sealed by the individuals whose names and license
numbers appear on each page, on the dates appearing
with their signature on that page.**

**This file or an individual page
shall not be considered a certified document.**

STATE OF NORTH CAROLINA
DIVISION OF HIGHWAYS

TRANSPORTATION MANAGEMENT PLAN

RANDOLPH COUNTY

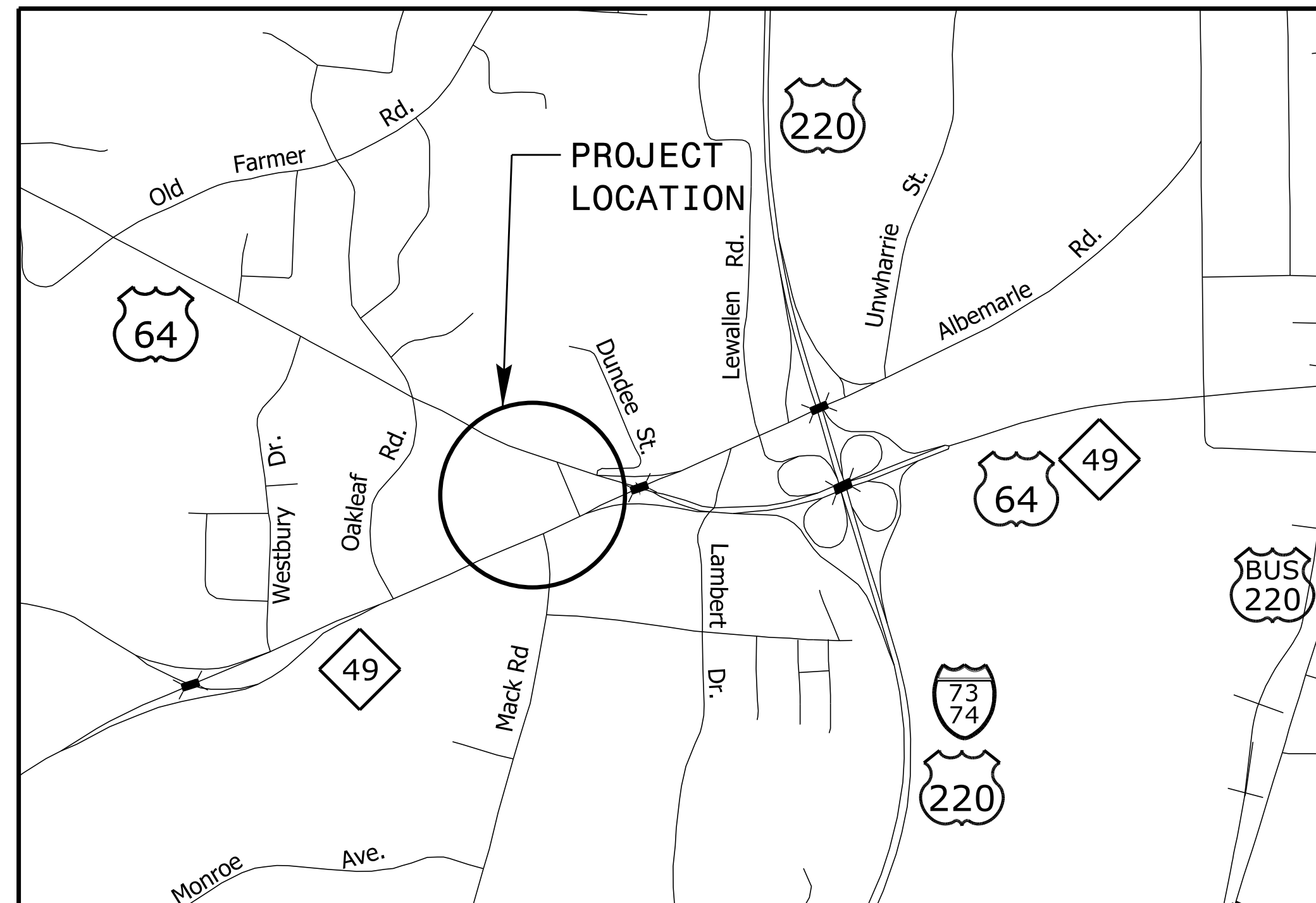
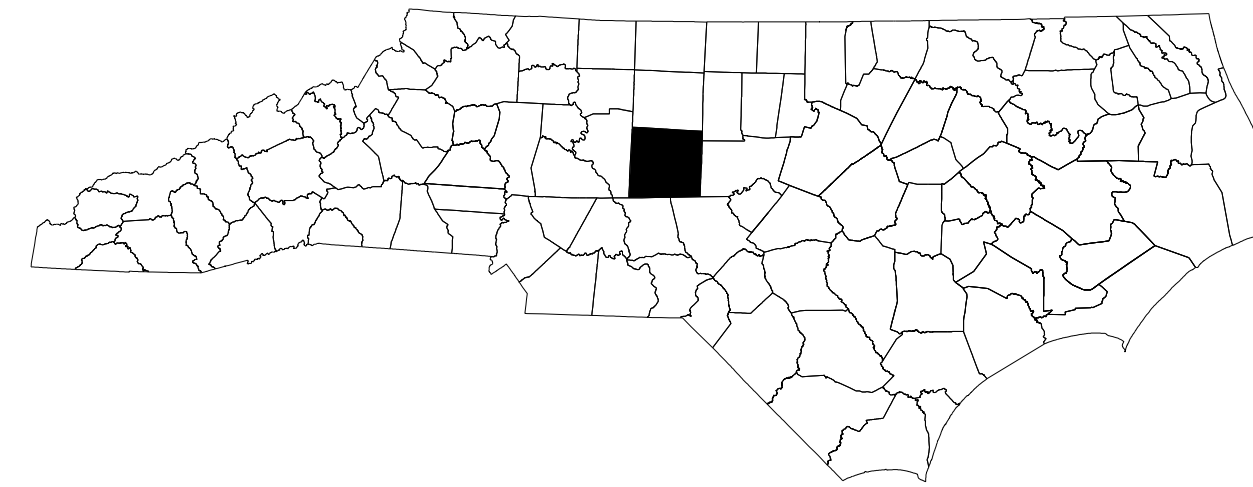

VICINITY MAP

INDEX OF SHEETS

<u>SHEET NO.</u>	<u>TITLE</u>
TMP-1	TITLE SHEET, VICINITY MAP AND INDEX OF SHEETS
TMP-1A	LIST OF APPLICABLE ROADWAY STANDARD DRAWINGS, AND LEGEND
TMP-1B	TRANSPORTATION OPERATIONS PLAN: (MANAGEMENT STRATEGIES, GENERAL NOTES AND LOCAL NOTES)
TMP-2	N/A
TMP-3	TEMPORARY TRAFFIC CONTROL PHASING
TMP-4 THRU TMP-6	TEMPORARY TRAFFIC CONTROL PHASE I DETAIL
TMP-7 THRU TMP-9	TEMPORARY TRAFFIC CONTROL PHASE II DETAIL
TMP-10 THRU TMP-11	TEMPORARY TRAFFIC CONTROL PHASE III DETAIL

SHEET NO.
TMP-1

U-5305

TIP PROJECT:



MATT WEST, P.E. **TRAFFIC CONTROL PROJECT ENGINEER**
DAVID SHINBARA, E.I. **TRAFFIC CONTROL PROJECT DESIGN ENGINEER**

APPROVED: _____
DATE: _____

DocuSigned by:
Matt West
ACT1A1D07968425
4/6/2015

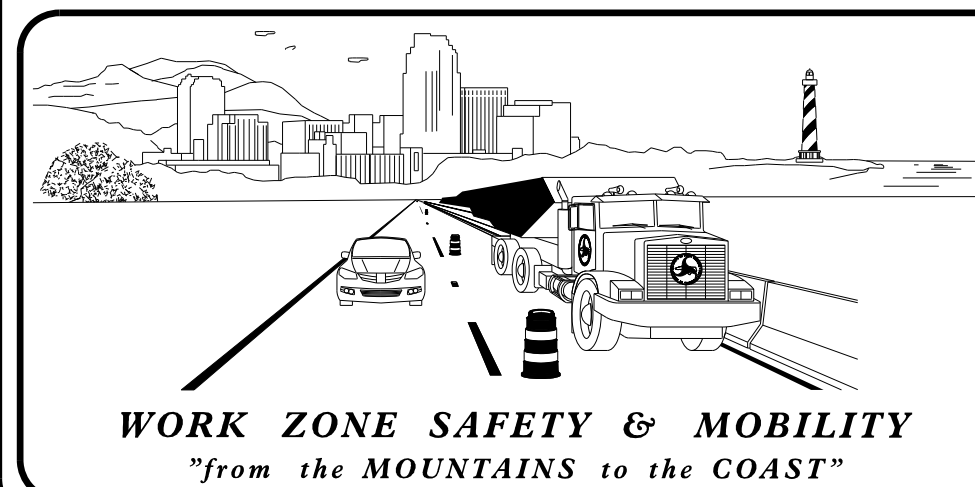
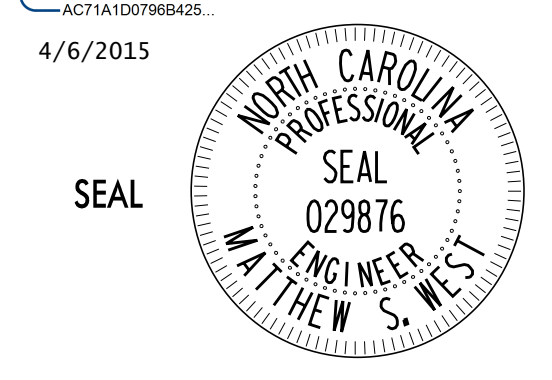

N.C.D.O.T. WORK ZONE TRAFFIC CONTROL
1561 MAIL SERVICE CENTER (MSC) RALEIGH, NC 27699-1561
750 N. GREENFIELD PARKWAY, GARNER, NC 27529 (DELIVERY)
PHONE: (919) 773-2800 FAX: (919) 771-2745

J. S. BOURNE, P.E. **STATE TRAFFIC MANAGEMENT ENGINEER**
JOSEPH ISHAK, P.E. **TRAFFIC CONTROL PROJECT ENGINEER**
HELEN SHYU **TRAFFIC CONTROL PROJECT DESIGN ENGINEER**
DON RICHARDSON **TRAFFIC CONTROL DESIGN ENGINEER**

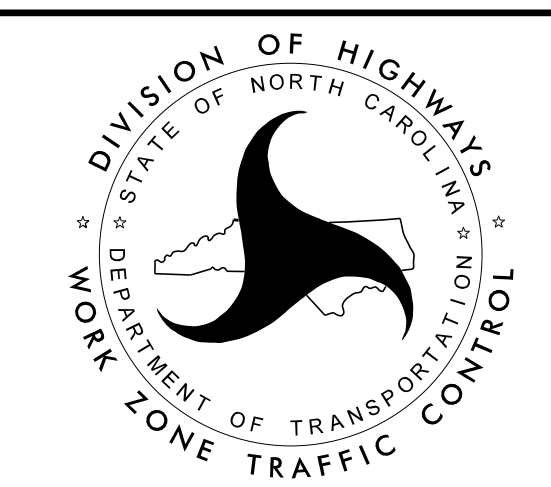

K:\RAL_Roadway\01036234 - U-5305 TMP\Plan\Plan Sheets\U-5305 TMP_1shdgn 3/24/2015

ROADWAY STANDARD DRAWINGS

THE FOLLOWING ROADWAY STANDARDS AS SHOWN IN "ROADWAY STANDARD DRAWINGS" - PROJECT SERVICES UNIT - N.C. DEPARTMENT OF TRANSPORTATION - RALEIGH, N.C., DATED JANUARY 2012 ARE APPLICABLE TO THIS PROJECT AND BY REFERENCE HEREBY ARE CONSIDERED A PART OF THESE PLANS:

STD. NO.	TITLE
1101.01	WORK ZONE WARNING SIGNS
1101.02	TEMPORARY LANE CLOSURES
1101.03	TEMPORARY ROAD CLOSURES
1101.04	TEMPORARY SHOULDER CLOSURES
1101.05	WORK ZONE VEHICLE ACCESSES
1101.11	TRAFFIC CONTROL DESIGN TABLES
1110.01	STATIONARY WORK ZONE SIGNS
1110.02	PORTABLE WORK ZONE SIGNS
1115.01	FLASHING ARROW BOARDS
1130.01	DRUMS
1135.01	CONES
1145.01	BARRICADES
1150.01	FLAGGING DEVICES
1180.01	SKINNY - DRUM
1205.01	PAVEMENT MARKINGS - LINE TYPES AND OFFSETS
1205.02	PAVEMENT MARKINGS - TWO LANE AND MULTILANE ROADWAYS
1205.09	PAVEMENT MARKINGS - PAINTED ISLANDS
1250.01	RAISED PAVEMENT MARKERS - INSTALLATION SPACING
1251.01	RAISED PAVEMENT MARKERS - (PERMANENT AND TEMPORARY)

LEGEND

GENERAL

- DIRECTION OF TRAFFIC FLOW
- DIRECTION OF PEDESTRIAN TRAFFIC FLOW

- NORTH ARROW

- WORK AREA

- REMOVAL

- WEDGING

SIGNALS

- EXISTING
- PROPOSED
- TEMPORARY

TRAFFIC CONTROL DEVICES

- BARRICADE (TYPE III)
- CONE
- DRUM SKINNY DRUM TUBULAR MARKER
- TEMPORARY CRASH CUSHION
- FLASHING ARROW BOARD
- FLAGGER
- LAW ENFORCEMENT
- TRUCK MOUNTED ATTENUATOR (TMA)
- CHANGEABLE MESSAGE SIGN

TEMPORARY SIGNING

- PORTABLE SIGN
- STATIONARY SIGN
- STATIONARY OR PORTABLE SIGN

PAVEMENT MARKERS

- CRYSTAL/CRYSTAL
- CRYSTAL/RED
- YELLOW/YELLOW

PAVEMENT MARKING SYMBOLS

- PAVEMENT MARKING SYMBOLS

TEMPORARY PAVEMENT MARKING

PAVEMENT MARKING LINES

- PA - PAINT (4" WHITE, 2X) EDGELINE
- PB - PAINT (4" YELLOW, 2X) EDGELINE
- PC - PAINT (4" WHITE, 2X) 4" X 10' SKIP
- PD - PAINT (4" WHITE, 2X) 4" x 2' MINISKIP
- PE - PAINT (4" WHITE, 2X) SOLID LANE LINE
- PF - PAINT (4" YELLOW, 2X) 4" X 10' SKIP
- PG - PAINT (4" YELLOW, 2X) 4" x 2' MINISKIP
- PH - PAINT (4" YELLOW, 2X) SINGLE CENTER LINE
- PI - PAINT (4" YELLOW, 2X) DOUBLE CENTER LINE
- PR - PAINT (8" WHITE, 2X) GORELINE
- PS - PAINT (8" WHITE, 2X) DIAGONAL
- PV - PAINT (8" YELLOW, 2X) DIAGONAL
- PX - PAINT (8" WHITE, 2X) CROSSWALK
- P2 - PAINT (24" WHITE, 2X) STOP BAR

PAVEMENT MARKING SYMBOLS

- QA - PAINT 2X (LEFT TURN ARROW)
- QB - PAINT 2X (RIGHT TURN ARROW)
- QC - PAINT 2X (STRAIGHT ARROW)
- QD - PAINT 2X (COMBINATION STRAIGHT & LEFT TURN ARROW)
- QE - PAINT 2X (COMBINATION STRAIGHT & RIGHT TURN ARROW)
- QG - PAINT 2X (COMBINATION STRAIGHT, RIGHT, & LEFT TURN ARROW)
- QI - PAINT 2X (ALPHANUMERIC CHARACTER)

3/24/2015 K:\RAL_Roadway\01036234 - U-5305 TMP\Plan\Plan Sheets\U-5305 TMP_1shdgn

DocuSigned by:
Matt West
4/6/2015

APPROVED: _____ DATE: _____			<p>ROADWAY STANDARD DRAWINGS & LEGEND</p>
SEAL			

MANAGEMENT STRATEGIES

THE MACK ROAD EXTENSION WILL BE CONSTRUCTED AWAY FROM TRAFFIC. CONSTRUCTION ALONG NC 49, EXISTING CONNECTOR ROAD, AND US 64 WILL BE CONSTRUCTED USING TEMPORARY TRAFFIC PATTERNS DESIGNATED BY TEMPORARY PAVEMENT MARKINGS, AND SIGNING. TEMPORARY LANE AND SHOULDER CLOSURES WILL BE USED AS NECESSARY TO COMPLETE CONSTRUCTION.

GENERAL NOTES

CHANGES MAY BE REQUIRED WHEN PHYSICAL DIMENSIONS IN THE DETAIL DRAWINGS, STANDARD DETAILS, AND ROADWAY DETAILS ARE NOT ATTAINABLE TO MEET FIELD CONDITIONS OR RESULT IN DUPLICATE OR UNDESIRED OVERLAPPING OF DEVICES. MODIFICATION MAY INCLUDE: MOVING, SUPPLEMENTING, COVERING, OR REMOVAL OF DEVICES AS DIRECTED BY THE ENGINEER.

THE FOLLOWING GENERAL NOTES APPLY AT ALL TIMES FOR THE DURATION OF THE CONSTRUCTION PROJECT EXCEPT WHEN OTHERWISE NOTED IN THE PLAN OR DIRECTED BY THE ENGINEER.

TIME RESTRICTIONS

A) DO NOT CLOSE OR NARROW TRAVEL LANES AS FOLLOWS:

ROAD NAME	DAY AND TIME RESTRICTIONS
NC 49/ALBEMARLE ROAD US 64 MACK ROAD CONNECTOR ROAD	MONDAY THRU FRIDAY 6:00 AM TO 9:00 AM 3:00 PM TO 7:00 PM

B) DO NOT CLOSE OR NARROW TRAVEL LANES DURING HOLIDAYS AND SPECIAL EVENTS AS FOLLOWS:

ROAD NAME

NC 49/ALBEMARLE ROAD
US 64
MACK ROAD
CONNECTOR ROAD

HOLIDAY

- FOR ANY UNEXPECTED OCCURRENCE THAT CREATES UNUSUALLY HIGH TRAFFIC VOLUMES, AS DIRECTED BY THE ENGINEER.
- FOR NEW YEAR'S, BETWEEN THE HOURS OF 6:00 A.M. DECEMBER 31st TO 7:00 P.M. JANUARY 2ND. IF NEW YEAR'S DAY IS ON A FRIDAY, SATURDAY, SUNDAY, OR MONDAY THEN UNTIL 7:00 P.M. THE FOLLOWING TUESDAY.
- FOR EASTER, BETWEEN THE HOURS OF 6:00 A.M. THURSDAY AND 7:00 P.M. MONDAY.
- FOR MEMORIAL DAY, BETWEEN THE HOURS OF 6:00 A.M. FRIDAY TO 7:00 P.M. TUESDAY.
- FOR INDEPENDENCE DAY, BETWEEN THE HOURS OF 6:00 A.M. THE DAY BEFORE INDEPENDENCE DAY AND 7:00 P.M. THE DAY AFTER INDEPENDENCE DAY.

IF INDEPENDENCE DAY IS ON A FRIDAY, SATURDAY, SUNDAY OR MONDAY THEN BETWEEN THE HOURS OF 6:00 A.M. THE THURSDAY BEFORE INDEPENDENCE DAY AND 7:00 P.M. THE TUESDAY AFTER INDEPENDENCE DAY.

- FOR LABOR DAY, BETWEEN THE HOURS OF 6:00 A.M. FRIDAY AND 7:00 P.M. TUESDAY.
- FOR THANKSGIVING DAY, BETWEEN THE HOURS OF 6:00 A.M. TUESDAY TO 7:00 P.M. MONDAY.
- FOR CHRISTMAS, BETWEEN THE HOURS OF 6:00 A.M. THE FRIDAY BEFORE THE WEEK OF CHRISTMAS DAY AND 7:00 P.M. THE FOLLOWING TUESDAY AFTER THE WEEK OF CHRISTMAS.

- C) DO NOT CONDUCT ANY HAULING OPERATIONS AGAINST THE FLOW OF TRAFFIC OF AN OPEN TRAVELWAY UNLESS THE HAULING OPERATION IS PROTECTED BY BARRIER OR GUARDRAIL OR AS DIRECTED BY THE ENGINEER.

LANE AND SHOULDER CLOSURE REQUIREMENTS

- D) REMOVE LANE CLOSURE DEVICES FROM THE LANE WHEN WORK IS NOT BEING PERFORMED BEHIND THE LANE CLOSURE OR WHEN A LANE CLOSURE IS NO LONGER NEEDED OR AS DIRECTED BY THE ENGINEER.

- E) WHEN PERSONNEL AND/OR EQUIPMENT ARE WORKING WITHIN 15 FT OF AN OPEN TRAVEL LANE, CLOSE THE NEAREST OPEN SHOULDER USING ROADWAY STANDARD DRAWING NO. 1101.04 UNLESS THE WORK AREA IS PROTECTED BY BARRIER OR GUARDRAIL OR A LANE CLOSURE IS INSTALLED.

- F) WHEN PERSONNEL AND/OR EQUIPMENT ARE WORKING ON THE SHOULDER ADJACENT TO AN UNDIVIDED FACILITY AND WITHIN 5 FT OF AN OPEN TRAVEL LANE, CLOSE THE NEAREST OPEN TRAVEL LANE USING ROADWAY STANDARD DRAWING NO. 1101.02 UNLESS THE WORK AREA IS PROTECTED BY BARRIER OR GUARDRAIL.

WHEN PERSONNEL AND/OR EQUIPMENT ARE WORKING ON THE SHOULDER ADJACENT TO A DIVIDED FACILITY AND WITHIN 10 FT OF AN OPEN TRAVEL LANE, CLOSE THE NEAREST OPEN TRAVEL LANE USING ROADWAY STANDARD DRAWING NO. 1101.02 UNLESS THE WORK AREA IS PROTECTED BY BARRIER OR GUARDRAIL.

- G) WHEN PERSONNEL AND/OR EQUIPMENT ARE WORKING WITHIN A LANE OF TRAVEL OF AN UNDIVIDED OR DIVIDED FACILITY, CLOSE THE LANE ACCORDING TO THE TRAFFIC CONTROL PLANS, ROADWAY STANDARD DRAWINGS, OR AS DIRECTED BY THE ENGINEER. CONDUCT THE WORK SO THAT ALL PERSONNEL AND/OR EQUIPMENT REMAIN WITHIN THE CLOSED TRAVEL LANE.

- H) DO NOT WORK SIMULTANEOUSLY WITHIN 15 FT ON BOTH SIDES OF AN OPEN TRAVELWAY, RAMP, OR LOOP WITHIN THE SAME LOCATION UNLESS PROTECTED WITH GUARDRAIL OR BARRIER.

PAVEMENT EDGE DROP OFF REQUIREMENTS

- I) BACKFILL AT A 6:1 SLOPE UP TO THE EDGE AND ELEVATION OF EXISTING PAVEMENT IN AREAS ADJACENT TO AN OPENED TRAVEL LANE THAT HAS AN EDGE OF PAVEMENT DROP-OFF AS FOLLOWS:

BACKFILL DROP-OFFS THAT EXCEED 2 INCHES ON ROADWAYS WITH POSTED SPEED LIMITS OF 45 MPH OR GREATER.

BACKFILL DROP-OFFS THAT EXCEED 3 INCHES ON ROADWAYS WITH POSTED SPEED LIMITS LESS THAN 45 MPH.

BACKFILL WITH SUITABLE COMPACTED MATERIAL, AS APPROVED BY THE ENGINEER, AT NO EXPENSE TO THE DEPARTMENT.

- J) DO NOT EXCEED A DIFFERENCE OF 2 INCHES IN ELEVATION BETWEEN OPEN LANES OF TRAFFIC FOR NOMINAL LIFTS OF 1.5 INCHES. INSTALL ADVANCE WARNING "UNEVEN LANES" SIGNS (W8-11) IN ADVANCE AND A MINIMUM OF EVERY HALF MILE THROUGHOUT THE UNEVEN AREA.

TRAFFIC PATTERN ALTERATIONS

- K) NOTIFY THE ENGINEER TWENTY ONE (21) CALENDAR DAYS PRIOR TO ANY TRAFFIC PATTERN ALTERATION.

SIGNING

- L) INSTALL ADVANCE WORK ZONE WARNING SIGNS WHEN WORK IS WITHIN 40 FT FROM THE EDGE OF TRAVEL LANE AND NO MORE THAN THREE (3) DAYS PRIOR TO THE BEGINNING OF CONSTRUCTION.

SIGNING (CONTINUED)

- M) ENSURE ALL NECESSARY SIGNING IS IN PLACE PRIOR TO ALTERING ANY TRAFFIC PATTERN.

- N) INSTALL BLACK ON ORANGE "DIP" SIGNS (W8-2) AND/OR "BUMP" SIGNS (W8-1) 500 FT IN ADVANCE OF THE UNEVEN AREA, OR AS DIRECTED BY THE ENGINEER.

TRAFFIC CONTROL DEVICES

- O) WHEN LANE CLOSURES ARE NOT IN EFFECT SPACE CHANNELIZING DEVICES IN WORK AREAS NO GREATER IN FEET THAN TWICE THE POSTED SPEED LIMIT (MPH) EXCEPT, 10 FT ON-CENTER IN RADIUS, AND 3 FT OFF THE EDGE OF AN OPEN TRAVELWAY. REFER TO STANDARD SPECIFICATIONS FOR ROADS AND STRUCTURES SECTIONS 1130 (DRUMS), 1135 (CONES) AND 1180 (SKINNY DRUMS) FOR ADDITIONAL REQUIREMENTS.

- P) PLACE TYPE III BARRICADES, WITH "ROAD CLOSED" SIGN R11-2 ATTACHED, OF SUFFICIENT LENGTH TO CLOSE ENTIRE ROADWAY.

- Q) PLACE ADDITIONAL SETS OF THREE CHANNELIZING DEVICES PERPENDICULAR TO THE EDGE OF TRAVELWAY ON 500 FT CENTERS WHEN UNOPENED LANES ARE CLOSED TO TRAFFIC.

PAVEMENT MARKINGS AND MARKERS

- R) INSTALL TEMPORARY PAVEMENT MARKINGS AND TEMPORARY PAVEMENT MARKERS ON INTERIM LAYERS OF PAVEMENT AS FOLLOWS:

ROAD NAME	MARKING PAINT	MARKER TEMPORARY RAISED
ALL		

- S) PLACE ONE APPLICATION OF PAINT FOR TEMPORARY TRAFFIC PATTERNS. PLACE A SECOND APPLICATION OF PAINT SIX (6) MONTHS AFTER THE INITIAL APPLICATION AND EVERY SIX MONTHS AS DIRECTED BY THE ENGINEER.

- T) TIE PROPOSED PAVEMENT MARKING LINES TO EXISTING PAVEMENT MARKING LINES.

- U) REMOVE/REPLACE ANY CONFLICTING/DAMAGED PAVEMENT MARKINGS AND MARKERS BY THE END OF EACH DAY'S OPERATION.

- V) TRACE THE PROPOSED MONOLITHIC ISLAND LOCATIONS WITH PROPER COLOR PAVEMENT MARKINGS PRIOR TO REMOVAL AND INSTALLATION. PLACE DRUMS TO DELINEATE ANY PROPOSED MONOLITHIC ISLANDS AFTER AFTER REMOVAL AND BEFORE INSTALLATION.

MISCELLANEOUS

- W) LAW ENFORCEMENT SHALL BE USED TO MAINTAIN TRAFFIC THROUGH THE WORK AREA AND/OR INTERSECTIONS AS DIRECTED BY THE ENGINEER.

- X) IN THE EVENT A DRIVEWAY TIE-IN CANNOT BE MADE IN ONE DAY'S TIME, BRING THE TIE-IN AREA TO AN APPROPRIATE ROADWAY ELEVATION AS DETERMINED BY THE ENGINEER. PLACE BLACK ON ORANGE "LOOSE GRAVEL" SIGNS (W8-7) AND BLACK ON ORANGE "PAVEMENT ENDS" SIGNS (W8-3) 500 FT AND 500 FT RESPECTIVELY IN ADVANCE OF THE UNEVEN AREAS. USE DRUMS TO DELINEATE THE EDGE OF ROADWAY ALONG UNPAVED AREAS.

K:\RAL_Roadway\01036234 - U-5305 TMP\Plan\Plan Sheets\U-5305 TMP_1shdgn 3/24/2015

DocuSigned by:
Matt West
AC71A1D079B425
4/6/2015

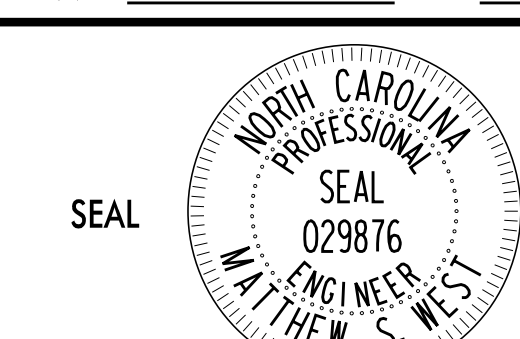
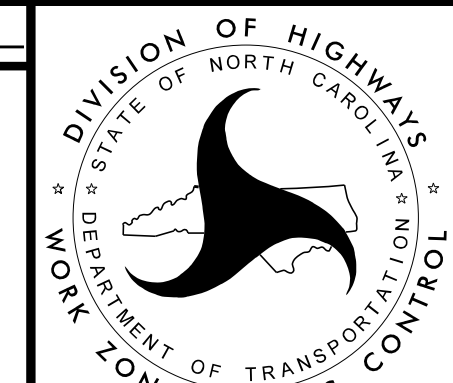
APPROVED: _____	DATE: _____			<h2 style="margin: 0;">TRANSPORTATION OPERATIONS PLAN</h2>
-----------------	-------------	---	---	--

CONSTRUCTION PHASING

PHASE I

STEP 1:

PRIOR TO BEGINNING ANY CONSTRUCTION ACTIVITY, THE CONTRACTOR SHALL INSTALL WORK ZONE ADVANCE WARNING SIGNS AS SHOWN IN THE NCDOT ROADWAY STANDARD DRAWING NO. 1101.01.

WHILE MAINTAINING EXISTING TRAFFIC ON NC 49/SHANA LANE/ALBEMARLE ROAD, US 64, CONNECTOR ROAD, MACK ROAD, FISHER CIRCLE AND ALL INTERSECTING ROADWAYS AND DRIVEWAYS, USING NCDOT ROADWAY STANDARD DRAWING NO. 1101.02 FOR TEMPORARY LANE CLOSURES AND PROVIDING WEDGING AS NECESSARY TO ENSURE POSITIVE DRAINAGE AND SMOOTH TRANSITIONS FROM NEW TO EXISTING PAVEMENT, THE CONTRACTOR SHALL:

INSTALL ALL TRAFFIC CONTROL DEVICES AS SHOWN ON SHEETS TMP-4 THRU TMP-6

PLACE TEMPORARY PAVEMENT MARKINGS ALONG NC 49 AS SHOWN ON SHEET TMP-4 AND PLACE TRAFFIC ONTO NEW PATTERN.

AWAY FROM TRAFFIC, BEGIN CONSTRUCTION OF THE MACK ROAD EXTENSION.

STEP 2:

CONSTRUCT PROPOSED IMPROVEMENTS UP TO BUT NOT INCLUDING THE FINAL LAYER OF ASPHALT ALONG THE SOUTH SIDE OF NC 49 FROM -Y1- STA. 10+40 TO STA. 27+35 AND ALONG THE EAST SIDE OF MACK ROAD FROM -L- STA. 9+00 TO STA. 14+12 AS SHOWN ON SHEETS TMP-4 THRU TMP-5. DO NOT WIDEN SIMULTANEOUSLY ON BOTH SIDES OF MACK ROAD AT THE INTERSECTION OF NC 49.

CONSTRUCT PROPOSED IMPROVEMENTS UP TO BUT NOT INCLUDING THE FINAL LAYER OF ASPHALT ALONG THE NORTH SIDE OF US 64 FROM -Y2- STA. 17+63 TO STA. 25+80 AS SHOWN ON SHEETS TMP-4 AND TMP-6.

COMPLETE THE NEW DRIVEWAY AT CONNECTOR ROAD AND ASSOCIATED DRAINAGE STRUCTURES ALONG CONNECTOR ROAD IN ORDER TO MAINTAIN ACCESS TO THE TANK & TUMMY GAS STATION DURING PHASE 2 CONSTRUCTION AS SHOWN ON SHEET TMP-4.

PHASE II

WHILE MAINTAINING EXISTING TRAFFIC ON NC 49/SHANA LANE/ALBEMARLE ROAD, US 64, CONNECTOR ROAD, MACK ROAD, FISHER CIRCLE, AND ALL INTERSECTING ROADWAYS AND DRIVEWAYS, USING NCDOT ROADWAY STANDARD DRAWING NO. 1101.02 FOR TEMPORARY LANE CLOSURES AND PROVIDING WEDGING AS NECESSARY TO ENSURE POSITIVE DRAINAGE AND SMOOTH TRANSITIONS FROM NEW TO EXISTING PAVEMENT, THE CONTRACTOR SHALL:

STEP 1:

REMOVE ALL CONFLICTING PAVEMENT MARKINGS AND PLACE TEMPORARY PAVEMENT MARKINGS AND MARKERS ALONG MACK ROAD AND NC 49 AS SHOWN ON SHEETS TMP-7 THRU TMP-8.

SHIFT TRAFFIC SIGNAL HEADS AT THE OAKLEAF RD AND NC 49 INTERSECTION AS SHOWN ON THE TEMPORARY SIGNAL PLANS.

INSTALL ALL TRAFFIC CONTROL DEVICES AS SHOWN ON SHEETS TMP-7 THRU TMP-9.

USING TEMPORARY LANE CLOSURES, FLAGGERS, AND LAW ENFORCEMENT TO DIRECT TRAFFIC AT INTERSECTIONS AS NEEDED, SHIFT TRAFFIC ONTO NEW PATTERN.

STEP 2:

AWAY FROM TRAFFIC, COMPLETE CONSTRUCTION OF PROPOSED MACK ROAD EXTENSION AS SHOWN ON SHEET TMP-7. PLACE FINAL PAVEMENT MARKINGS AND MARKERS. REFER TO PAVEMENT MARKING PLANS FOR LOCATIONS.

CONSTRUCT PROPOSED IMPROVEMENTS UP TO BUT NOT INCLUDING THE FINAL LAYER OF ASPHALT ALONG THE SOUTH SIDE OF US 64 FROM -Y2- STA. 17+44 TO STA. 20+00 AND STA. 23+50 TO STA. 27+09 AS SHOWN ON SHEETS TMP-7 AND TMP-9.

CONSTRUCT PROPOSED IMPROVEMENTS UP TO BUT NOT INCLUDING THE FINAL LAYER OF ASPHALT ALONG THE NORTH SIDE OF NC 49 FROM -Y1- STA. 10+57 TO STA. 25+82 AND ALONG THE WEST SIDE OF MACK ROAD FROM -L- STA. 9+00 TO STA. 13+30 AS SHOWN ON SHEETS TMP-7 THRU TMP-8.

PHASE III

WHILE MAINTAINING EXISTING TRAFFIC ON NC 49/SHANA LANE/ALBEMARLE ROAD, US 64, CONNECTOR ROAD, MACK ROAD, FISHER CIRCLE, AND ALL INTERSECTING ROADWAYS AND DRIVEWAYS, USING NCDOT ROADWAY STANDARD DRAWING NO. 1101.02 FOR TEMPORARY LANE CLOSURES, THE CONTRACTOR SHALL:

STEP 1:

INSTALL PROPOSED TRAFFIC SIGNALS AT THE MACK ROAD AND NC 49 AND THE MACK ROAD EXTENSION AND US 64 INTERSECTIONS.

REMOVE ALL CONFLICTING MARKINGS AND PLACE TEMPORARY PAVEMENT MARKINGS AND MARKERS IN THE FINAL PATTERN ALONG MACK ROAD, NC 49, AND US 64 AS SHOWN ON SHEETS TMP-10 AND TMP-11. REFER TO PAVEMENT MARKING PLANS FOR LOCATIONS. STOPBAR LOCATIONS ARE APPROXIMATE, REFER TO THE FINAL SIGNAL PLANS FOR ACTUAL STOPBAR LOCATIONS.

USING TEMPORARY LANE CLOSURES, FLAGGERS, AND LAW ENFORCEMENT TO DIRECT TRAFFIC AT INTERSECTIONS AS NEEDED, SHIFT TRAFFIC ONTO FINAL PATTERN.

ACTIVATE TRAFFIC SIGNALS, AND RESTORE EXISTING SIGNAL AT OAKLEAF DR / NC 49 INTERSECTION.

INSTALL TRAFFIC CONTROL DEVICES ASSOCIATED WITH STEP 2 AS SHOWN ON SHEET TMP-10.

STEP 2:

CLOSE EXISTING CONNECTOR ROAD TO THROUGH TRAFFIC AND CLOSE TANK & TUMMY DRIVEWAY OFF AT US 64. REMOVE EXISTING PAVEMENT AS SHOWN ON SHEET TMP-10

CONSTRUCT PROPOSED CURB AND GUTTER AND BUILD UP PAVEMENT WHERE NECESSARY AT THE DEMOLISHED DRIVEWAY LOCATIONS FROM -L- STA. 20+35 TO -Y2- STA. 23+50 AND AT THE INTERSECTION OF CONNECTOR ROAD AND NC 49 AS SHOWN ON SHEET TMP-10.

CONSTRUCT PROPOSED CURB AND GUTTER AND DRIVEWAY AT THE TANK AND TUMMY GAS STATION AS SHOWN ON SHEET TMP-10.

STEP 3:

REMOVE TRAFFIC CONTROL DEVICES ASSOCIATED WITH STEP 2 AND INSTALL TRAFFIC CONTROL DEVICES ASSOCIATED WITH MEDIAN WORK AS SHOWN ON SHEETS TMP-10 THRU TMP-11.

STEP 4:

CONSTRUCT PROPOSED MEDIAN ALONG NC 49 FROM -Y1- STA. 10+79 TO STA. 12+79 AND FROM -Y1- STA. 19+96 TO STA. 27+35.

CONSTRUCT PROPOSED MEDIAN ALONG MACK ROAD FROM -L- STA. 12+34 TO STA. 13+53

CONSTRUCT PROPOSED MEDIAN ALONG US 64 FROM -Y2- STA. 18+60 TO STA. 26+09.

CONSTRUCT PROPOSED ISLAND IN GORE AREA OF ALBEMARLE RD AND SHANA LANE.

STEP 5:

PLACE FINAL LAYER OF ASPHALT AND FINAL PAVEMENT MARKINGS AND MARKERS ON NC 49, US 64, AND MACK ROAD. REFER TO THE PAVEMENT MARKING PLANS FOR LOCATIONS.

STEP 6:

REMOVE ALL TRAFFIC CONTROL DEVICES, AND OPEN ALL LANES TO TRAFFIC.

K:\RAL_Roadway\01036234 - U-5305 TMP\Plan\Plan Sheets\U-5305 TMP-1shdgn 3/24/2015

Drawn By:
Matt West
ACT1A1007968425

4/6/2015

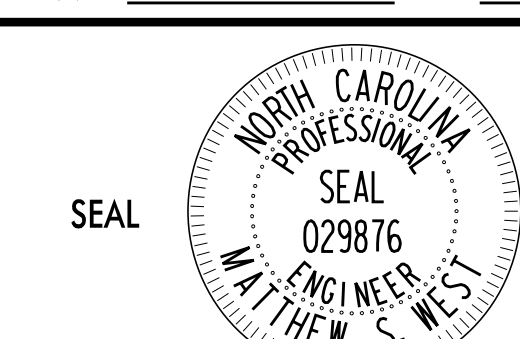
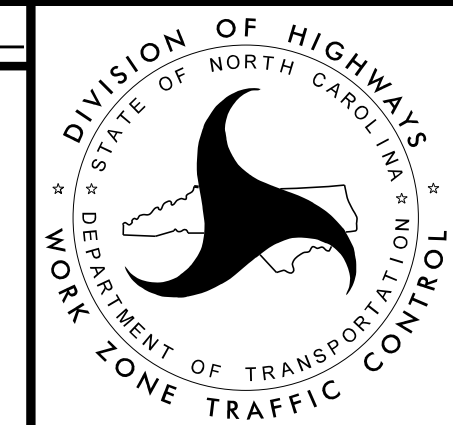
APPROVED: _____ DATE: _____			<h2 style="margin: 0;">TRANSPORTATION OPERATIONS PLAN</h2>
-----------------------------	---	---	--

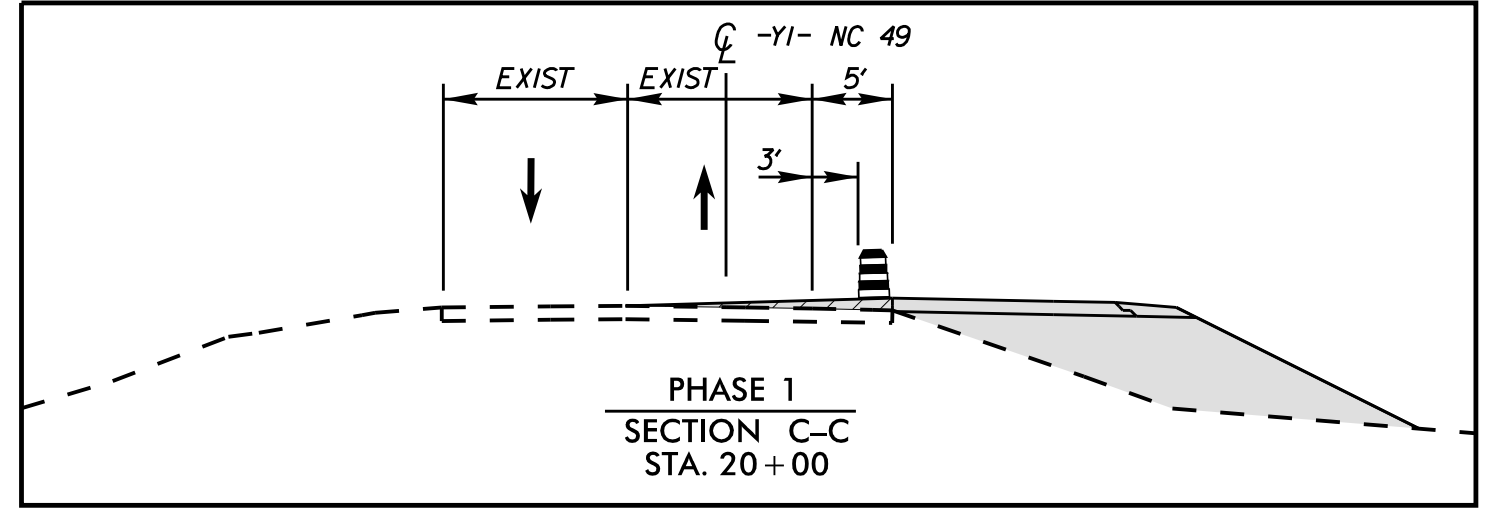

SEE SHEET TMP-5 -YI- STA 19+00.00

SEE INSET THIS SHEET -L- STA. 10+00.00

BEGIN CONSTRUCTION
-Y2- STA. 17+63

END CONSTRUCTION
-L- STA 22+69

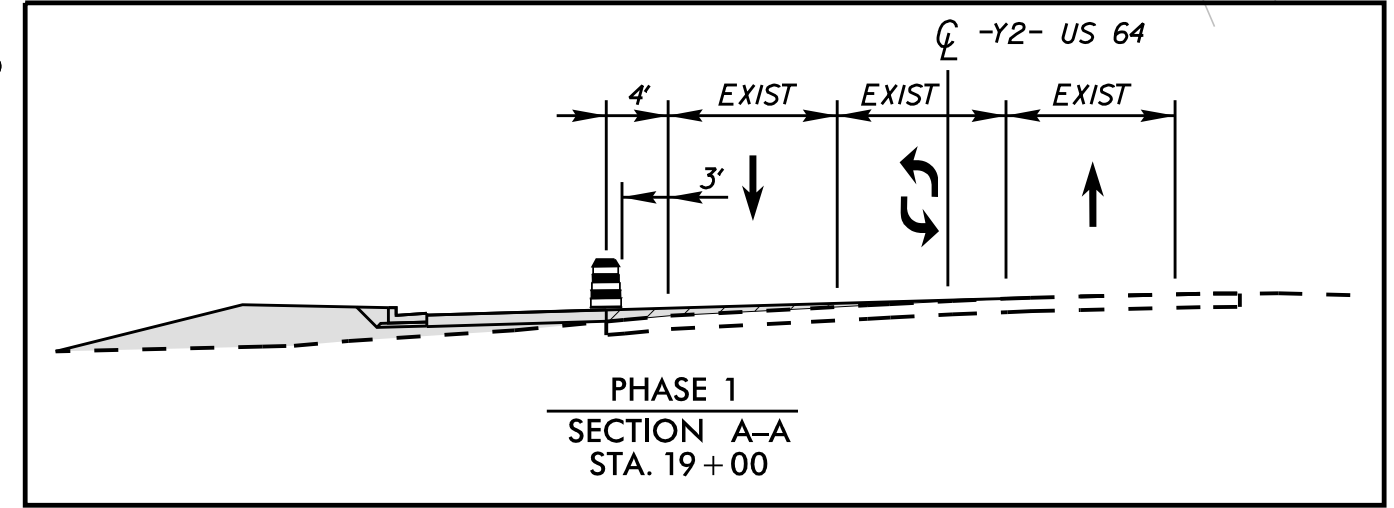
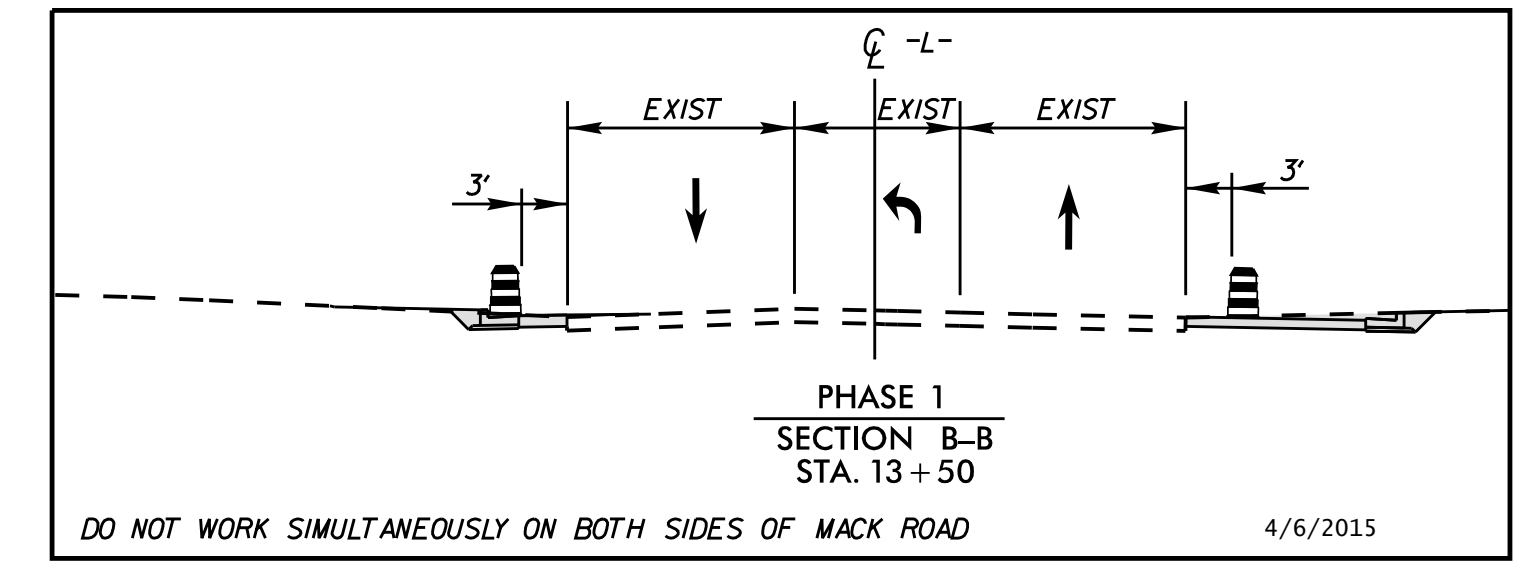

* EXISTING PAVEMENT MARKING AND ROADWAY LOCATIONS WITHIN THIS INSET ARE APPROXIMATE AND OUTSIDE OF SURVEYED PROJECT LIMITS. VERIFY ACTUAL LOCATIONS.

- WORK AREA
- PAVEMENT REMOVAL
- WEDGING

APPROVED: _____ DATE: _____

DocuSigned by:
Matt West
AC71A1D0798B425
4/6/2015

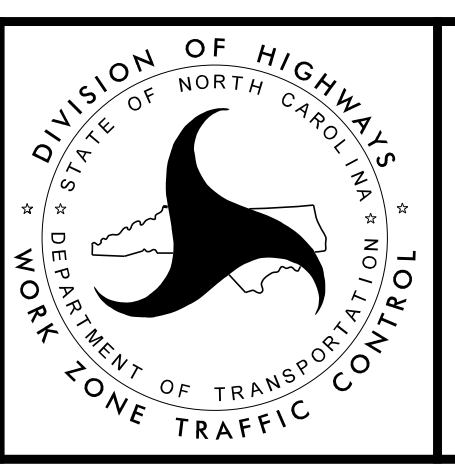

TRAFFIC CONTROL PHASE I

3/24/2015 K:\RAL_Roadway\01036234 - U-5305 TMP\Plan\Plan Sheets\U5305_TMP_PSH_04.dgn

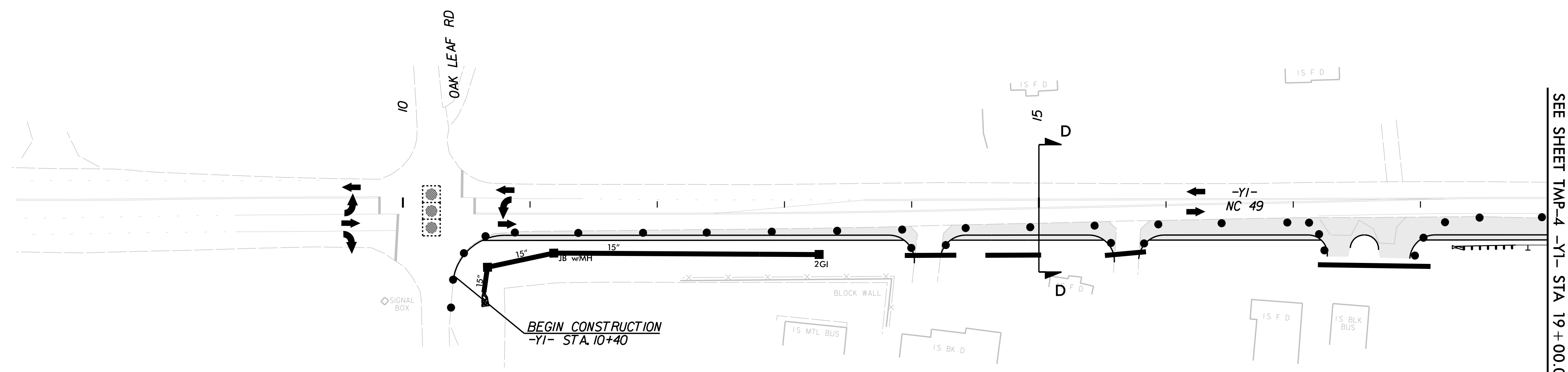
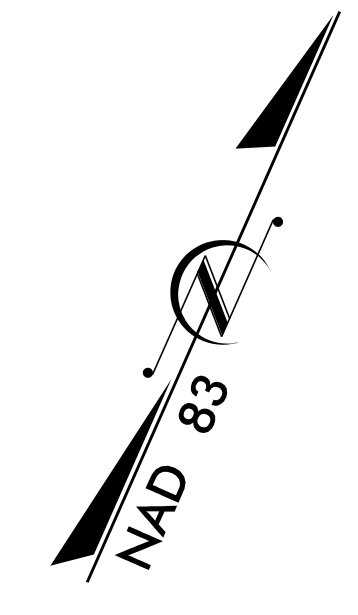
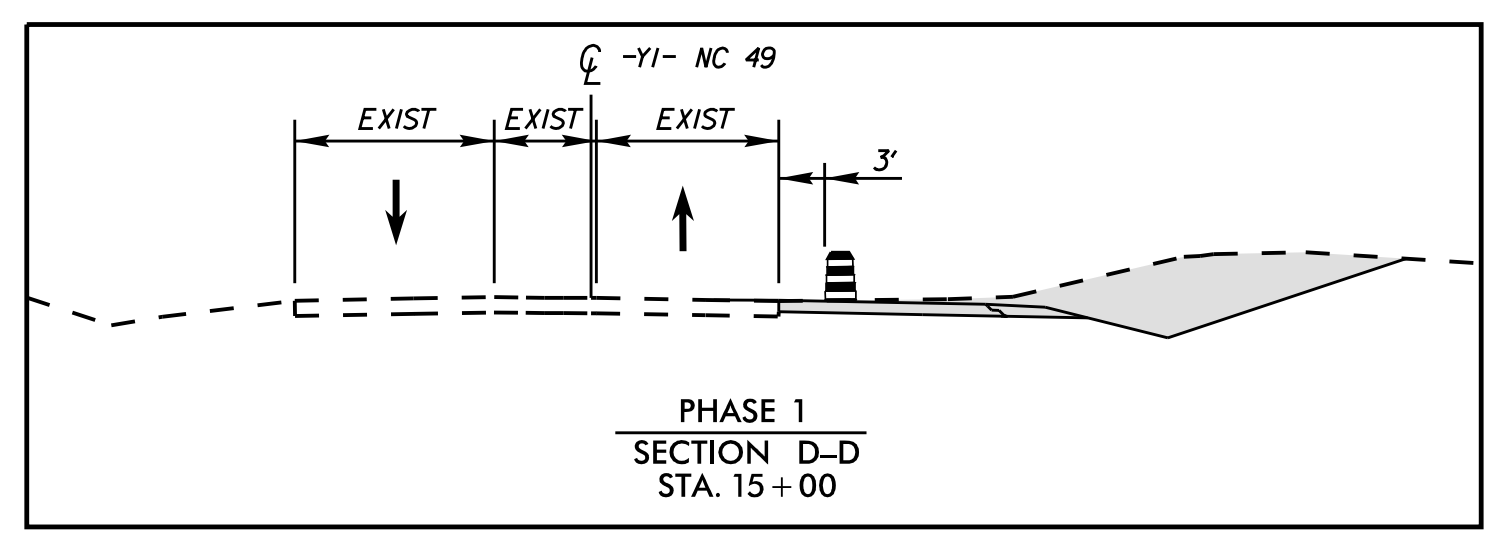

- WORK AREA
- PAVEMENT REMOVAL
- WEDGING

3/24/2015 K:\RAL_Roadway\01036234 - U-5305 TMP\Plan\Plan Sheets\U5305_TMP_PSH_05.dgn

DocuSigned by:
Matt West
ACT1A1D07998425
4/6/2015

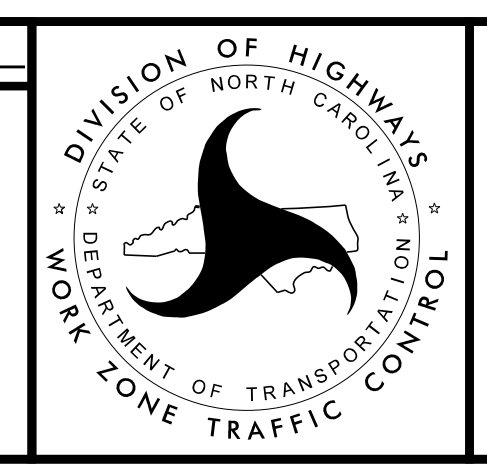

APPROVED: _____ DATE: _____

SEAL

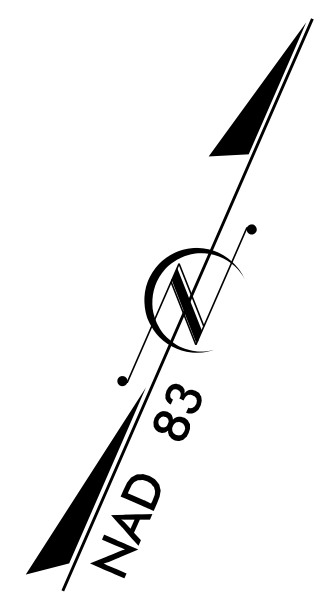
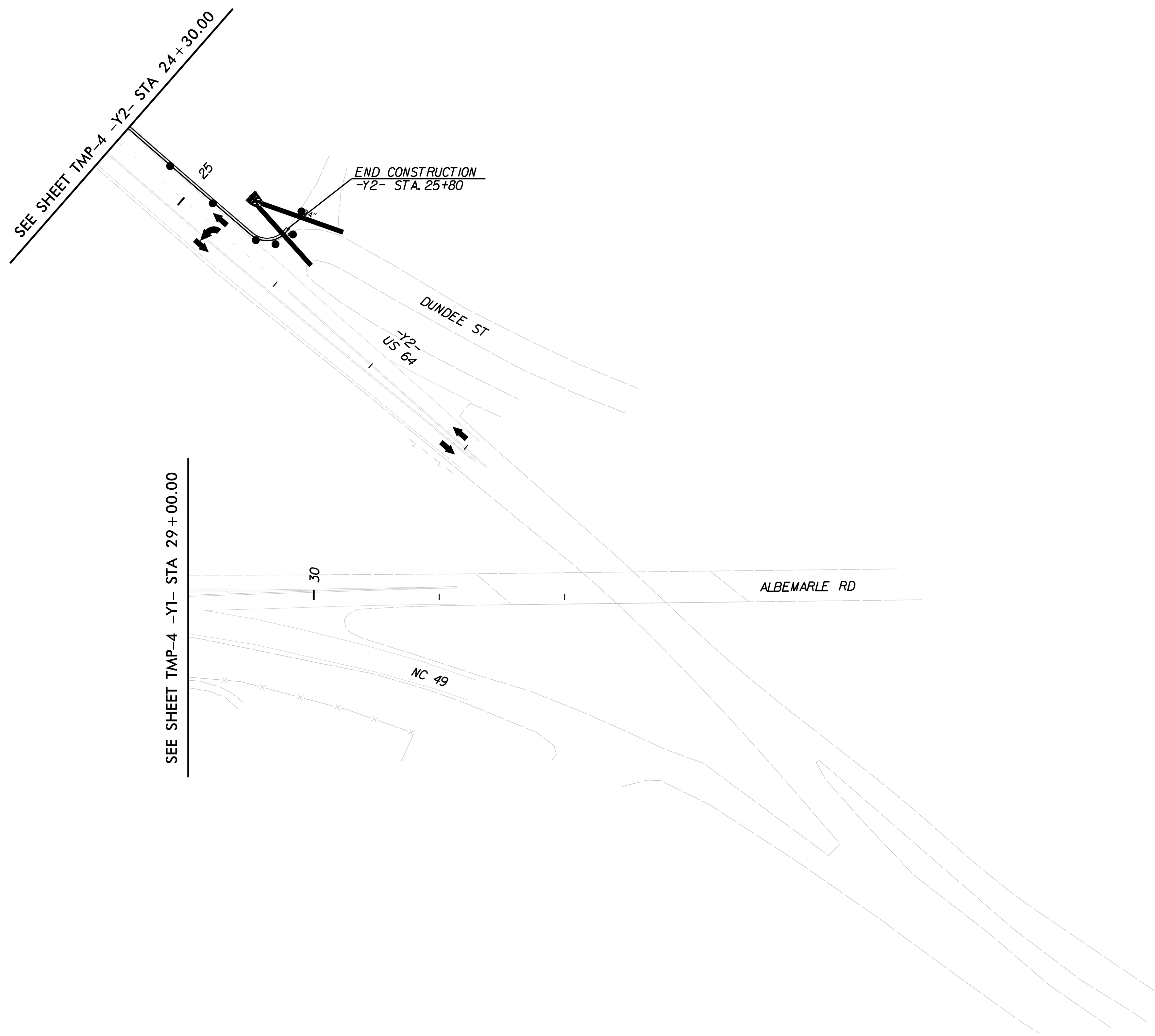

**TRAFFIC CONTROL
PHASE I**



-  WORK AREA
-  PAVEMENT REMOVAL
-  WEDGING

3/24/2015 K:\RAL_Roadway\01036234 - U-5305 TMP\Plan\Plan Sheets\U5305_TMP_PSH_06.dgn

DocuSigned by:
Matt West
4/6/2015

APPROVED: _____ DATE: _____

SEAL

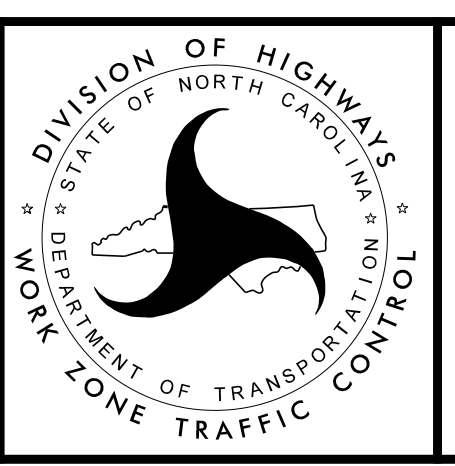
**TRAFFIC CONTROL
PHASE I**

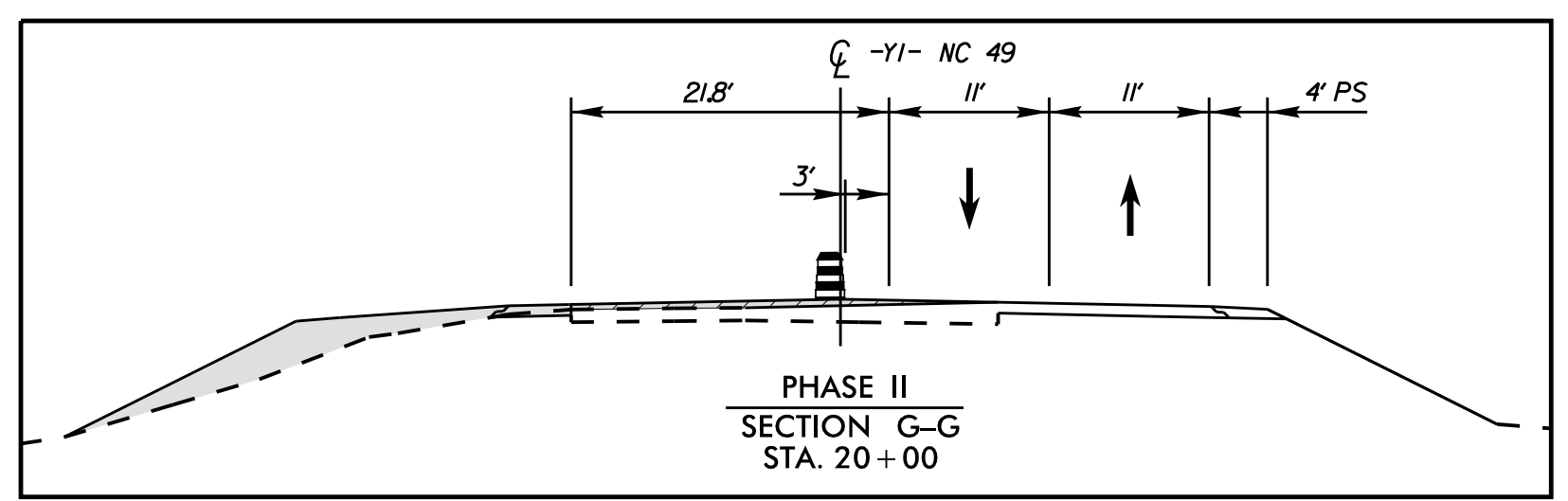

BEGIN CONSTRUCTION
-Y2- STA. 17+44

SEE SHEET TMP-8 -Y1- STA. 19+00.00

SEE INSET THIS SHEET -L- STA. 10+00.00

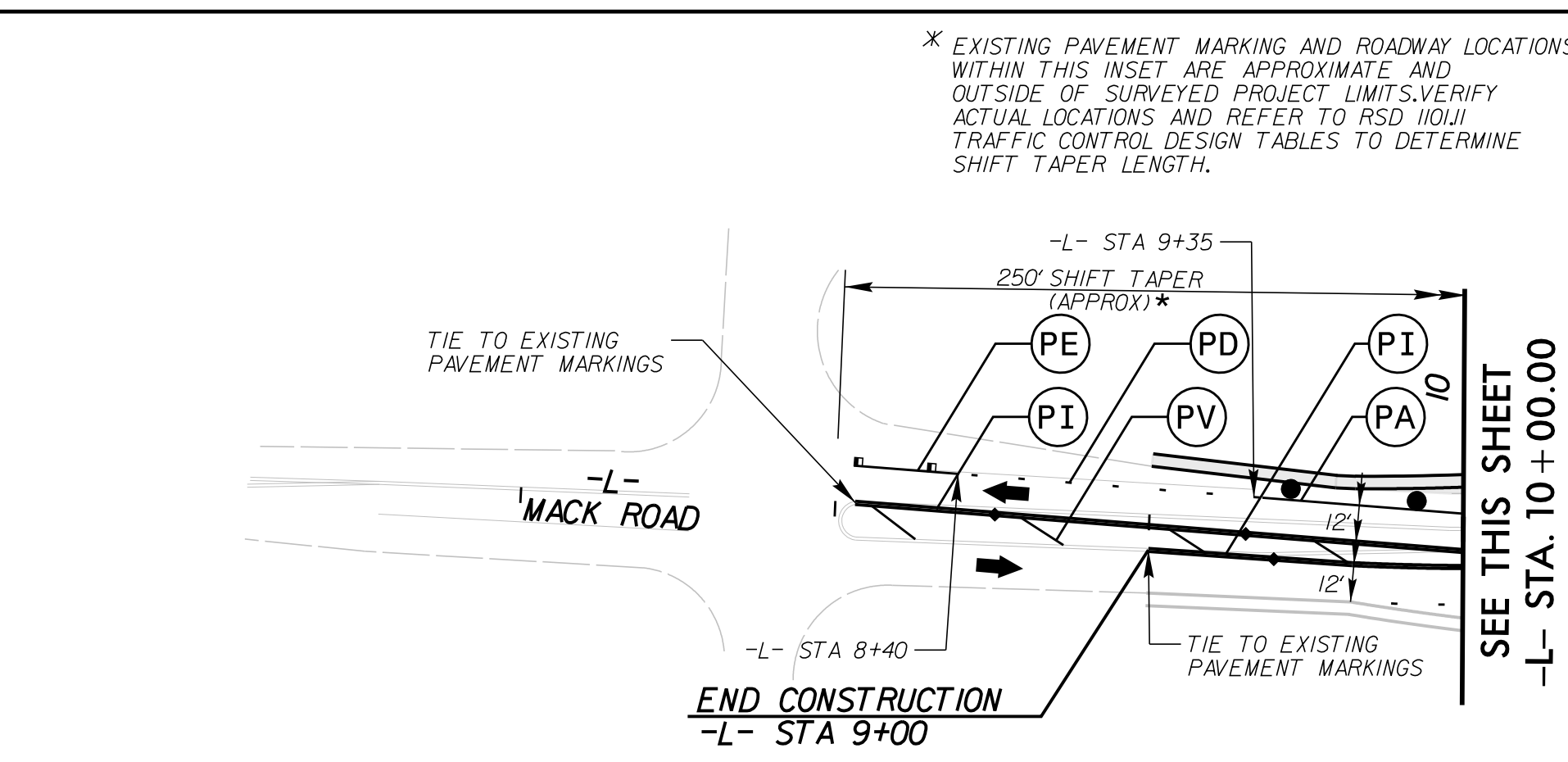
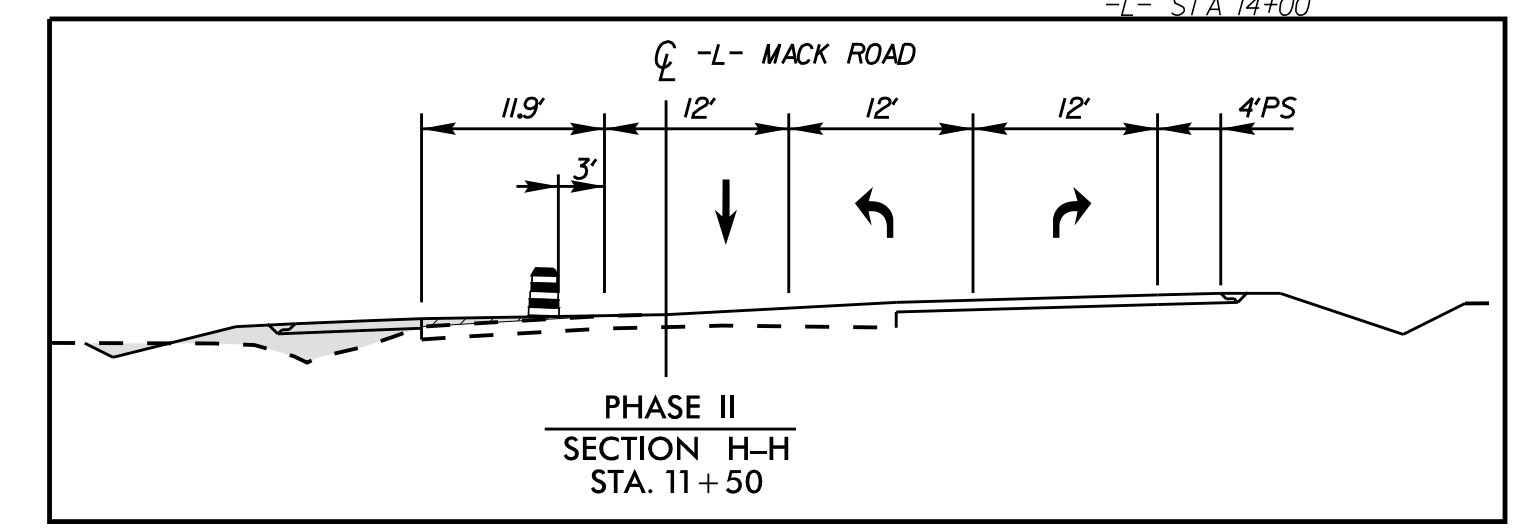

INSTALL DRAINAGE STRUCTURES WITHIN THE ROAD WHILE MAINTAINING TRAFFIC AND USING TEMPORARY LANE CLOSURES (TYP)

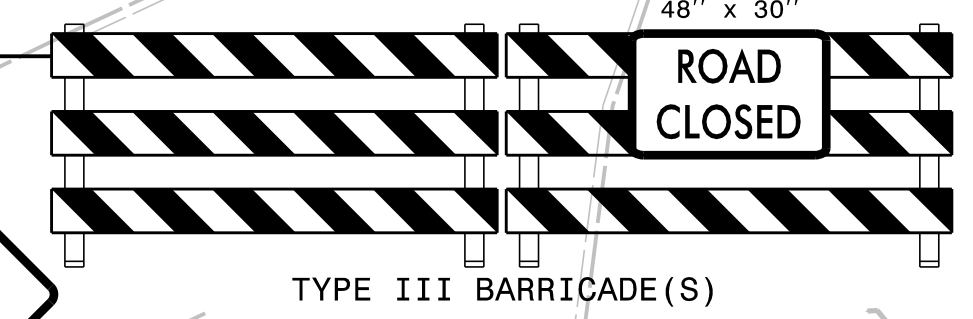
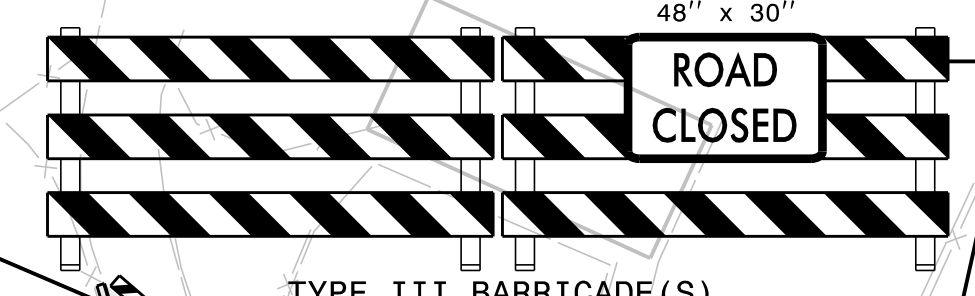
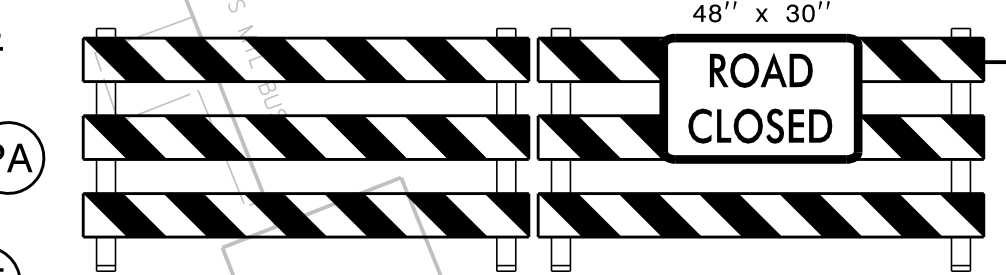

- WORK AREA
- PAVEMENT REMOVAL
- WEDGING

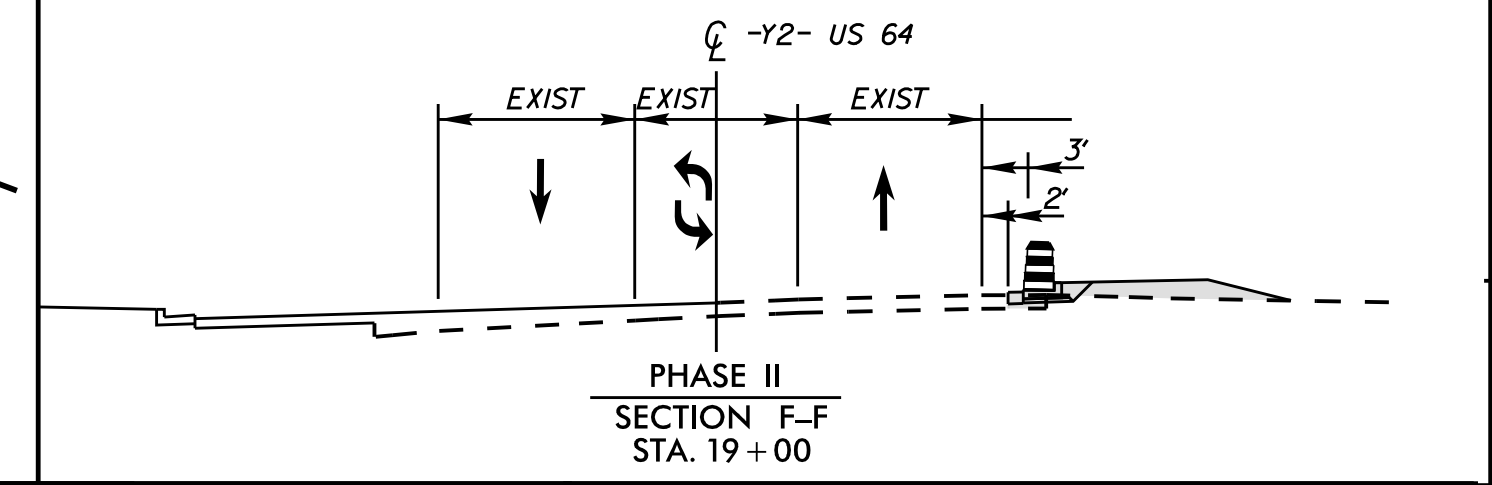
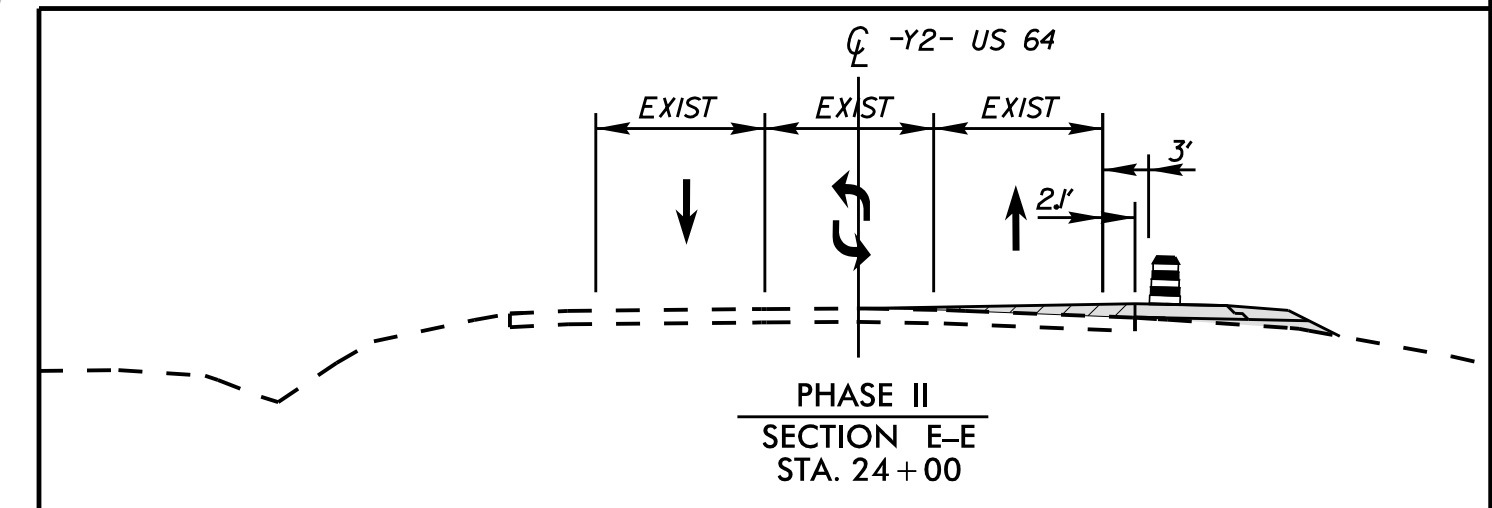

BEGIN CONSTRUCTION
-Y2- STA. 23+50

SEE SHEET TMP-9 -Y2- STA. 24+30.00

SEE SHEET TMP-9 -Y1- STA. 29+00.00

APPROVED: _____ DATE: _____

DocuSigned by:
Matt West
AC71A1D079E9A25
4/6/2015

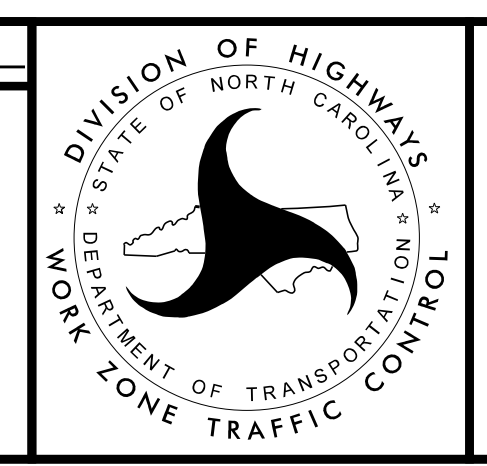

TRAFFIC CONTROL PHASE II

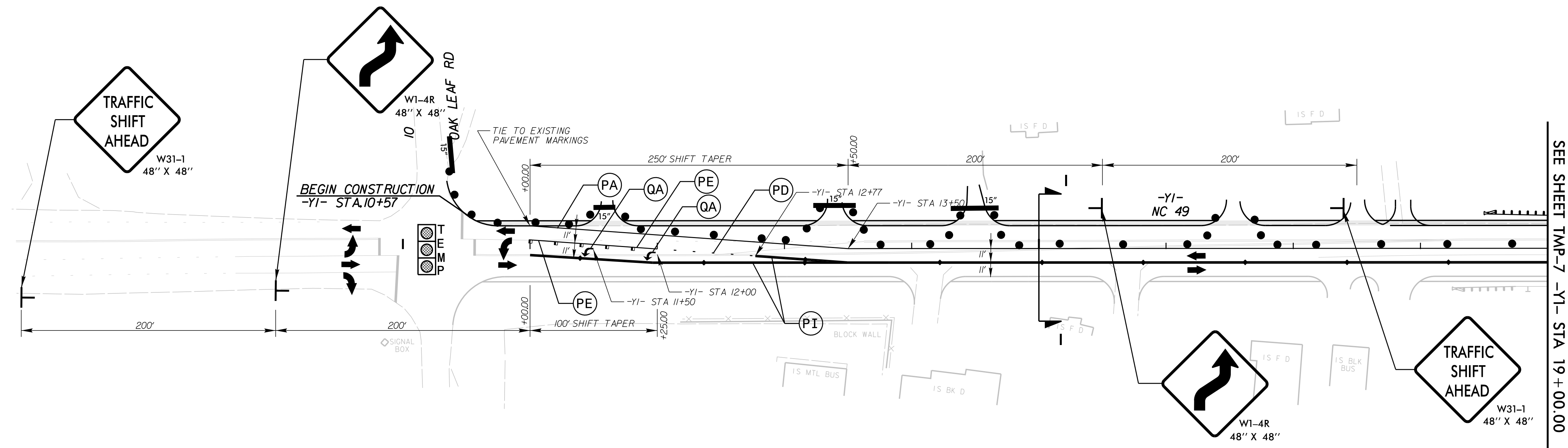
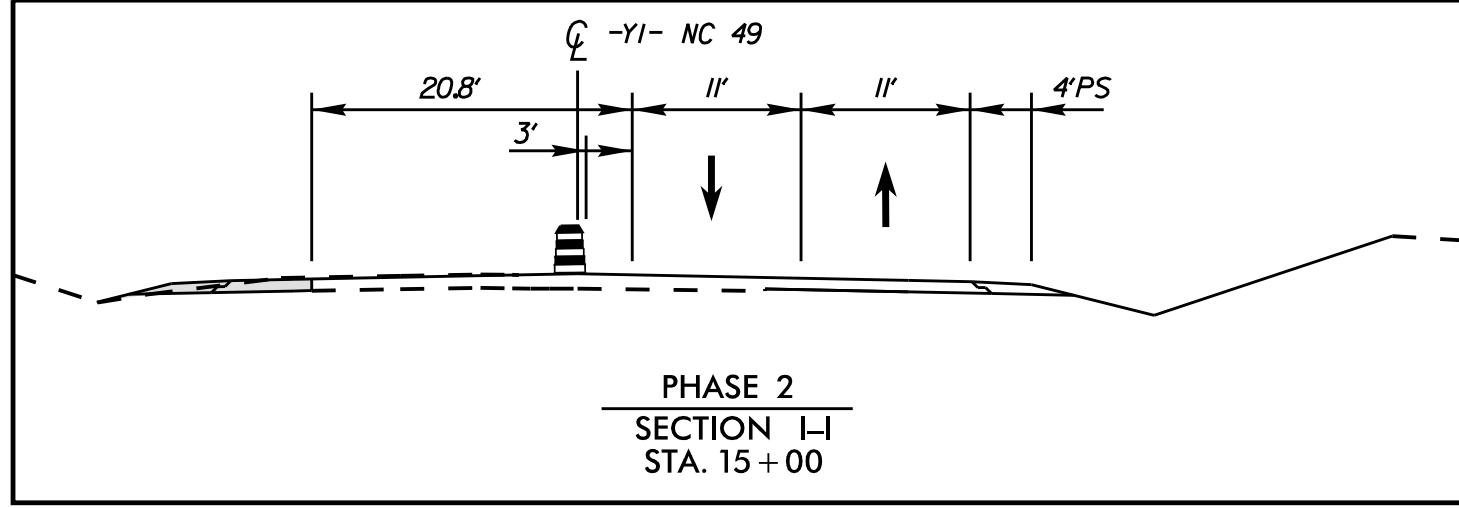

SEE SHEET TMP-7 -YI- STA. 19+00.00

- WORK AREA
- PAVEMENT REMOVAL
- WEDGING

3/24/2015 K:\RAL_Roadway\01036234 - U-5305 TMP\Plan\Plan Sheets\U5305 TMP_PSH_08.dgn



DocuSigned by:
Matt West
4/6/2015

APPROVED: _____ DATE: _____

SEAL

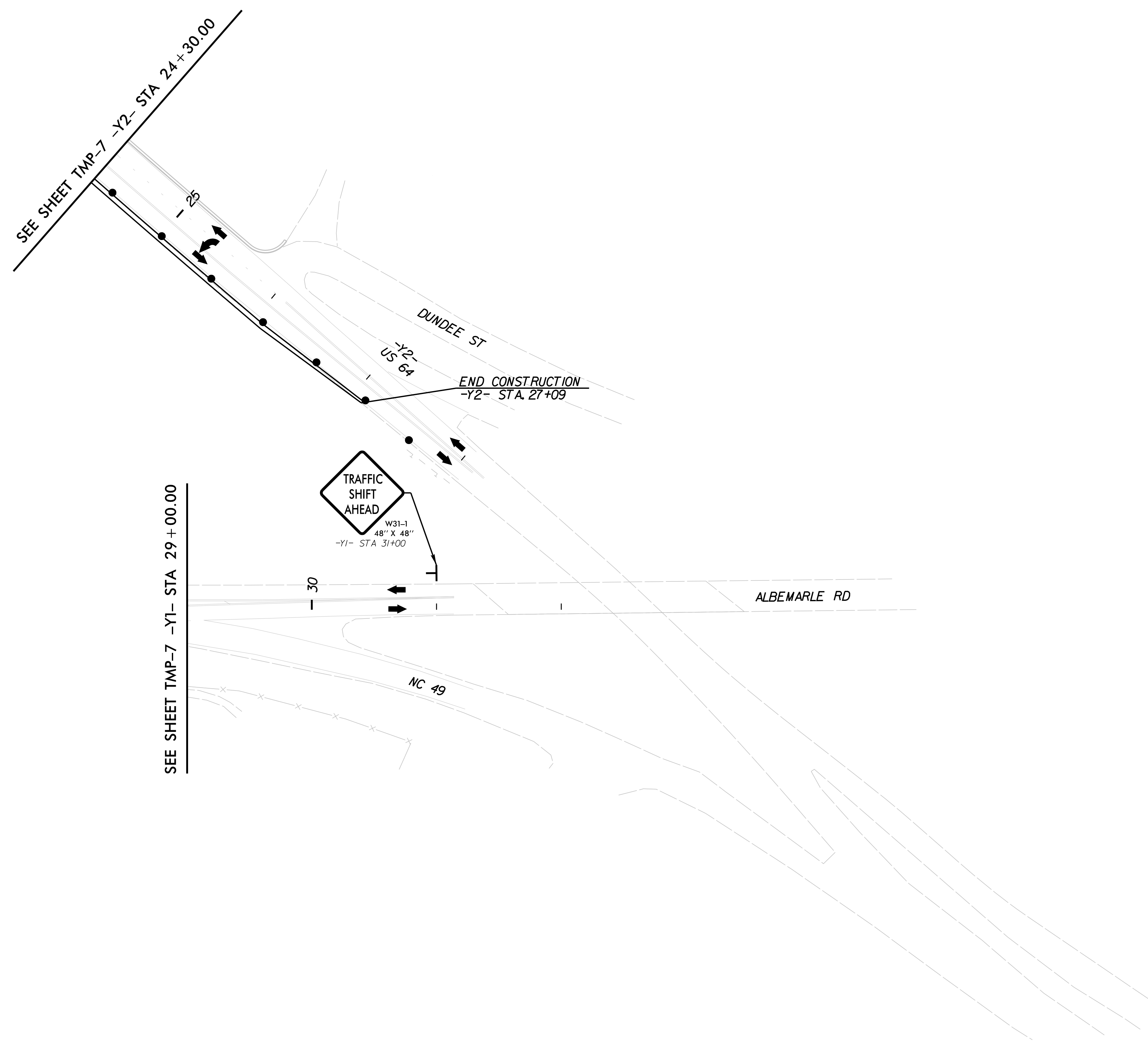
**TRAFFIC CONTROL
PHASE II**

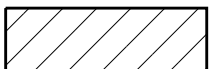

-  WORK AREA
-  PAVEMENT REMOVAL
-  WEDGING

3/24/2015 K:\RAL_Roadway\01036234 - U-5305 TMP\Plan\Plan Sheets\U5305_TMP_PSH_09.dgn

DocuSigned by:
Matt West
AC71A1D0798425
4/6/2015

APPROVED: _____ DATE: _____

SEAL

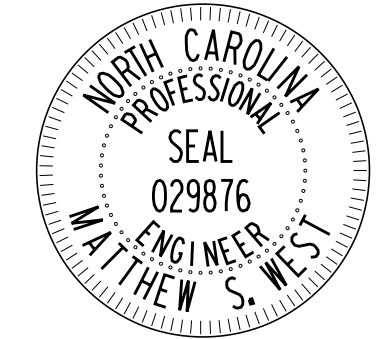
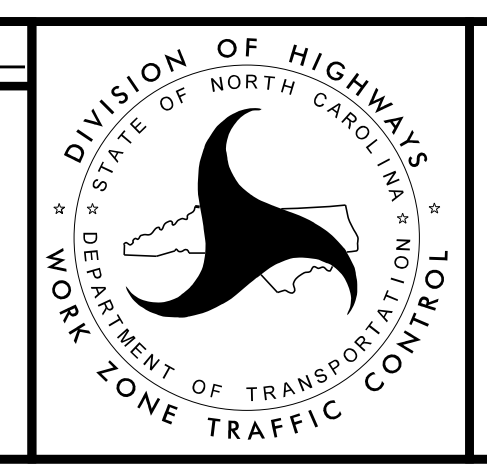
TRAFFIC CONTROL PHASE II

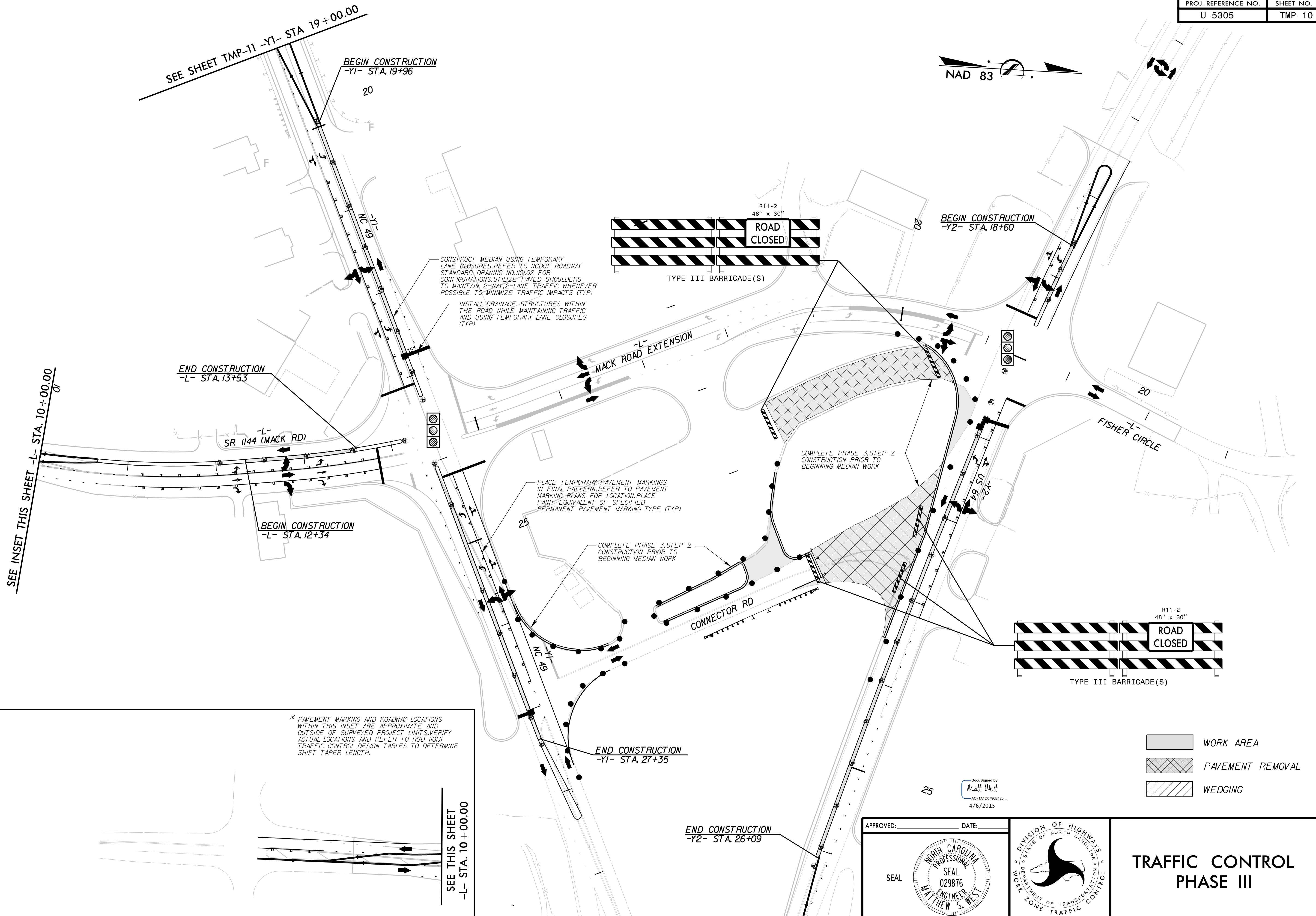
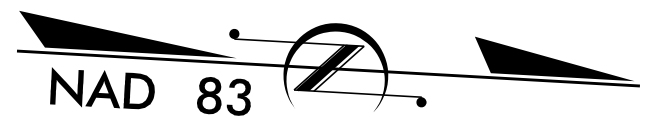

* PAVEMENT MARKING AND ROADWAY LOCATIONS WITHIN THIS INSET ARE APPROXIMATE AND OUTSIDE OF SURVEYED PROJECT LIMITS. VERIFY ACTUAL LOCATIONS AND REFER TO RSD 1101J TRAFFIC CONTROL DESIGN TABLES TO DETERMINE SHIFT TAPER LENGTH.

SEE THIS SHEET -L- STA. 10+00.00

3/24/2015 K:\RAL_Roadway\01036234 - U-5305 TMP\Plan\Plan Sheets\U5305_TMP_PSH_10.dgn

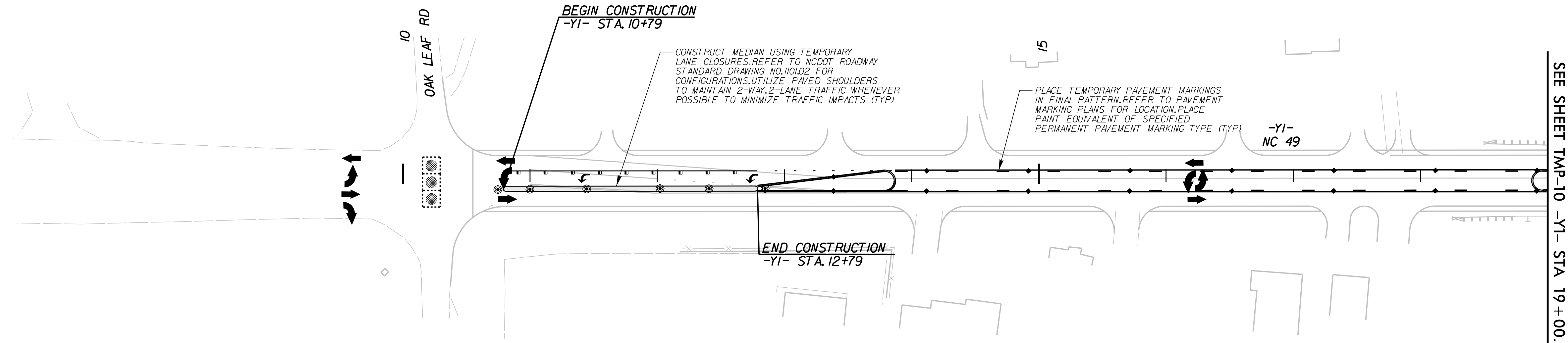
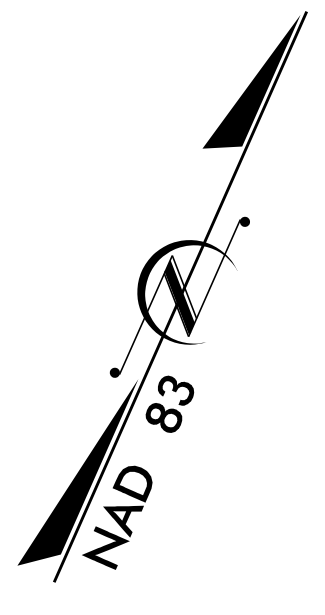

SEE SHEET TMP-10 -YI- STA 19+00.00

- WORK AREA
- PAVEMENT REMOVAL
- WEDGING

3/24/2015 K:\RAL_Roadway\01036234 - U-5305 TMP\Plan\Plan Sheets\U5305_TMP_PSH_11.dgn

DocuSigned by:
Matthew West
AG71A1D0798B425
 4/6/2015

APPROVED: _____ DATE: _____

SEAL

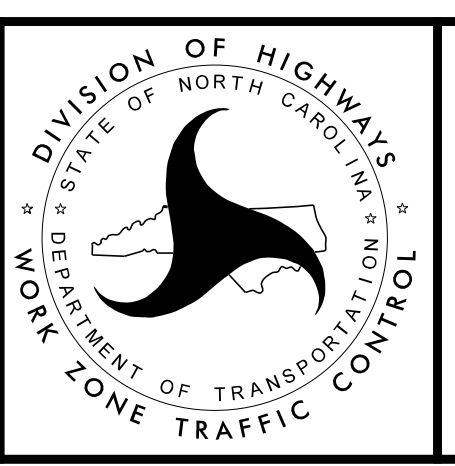

**TRAFFIC CONTROL
 PHASE III**