

DRAWING 1

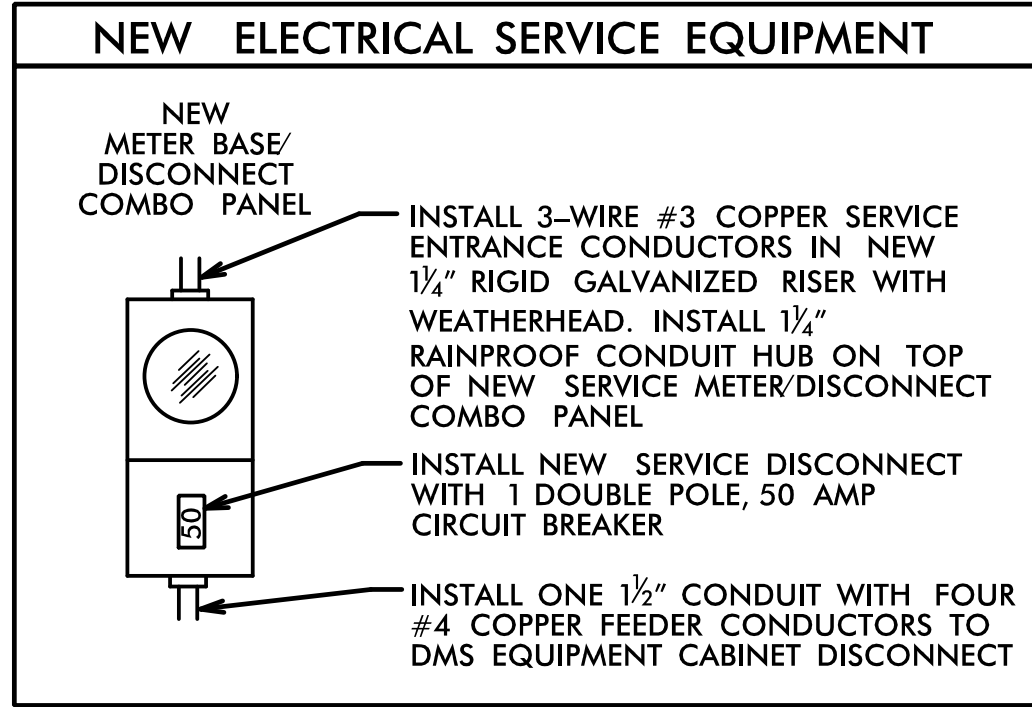

DRAWING 2

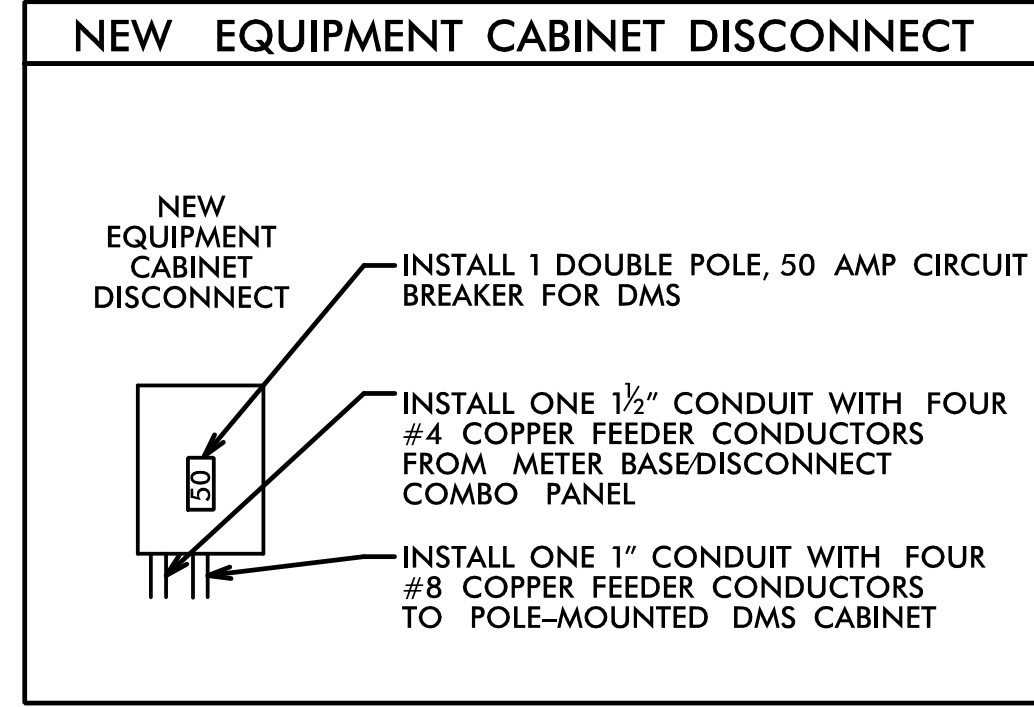

DMS-1 GPS COORDINATES

N 35° 22.150'
W 80° 47.036'

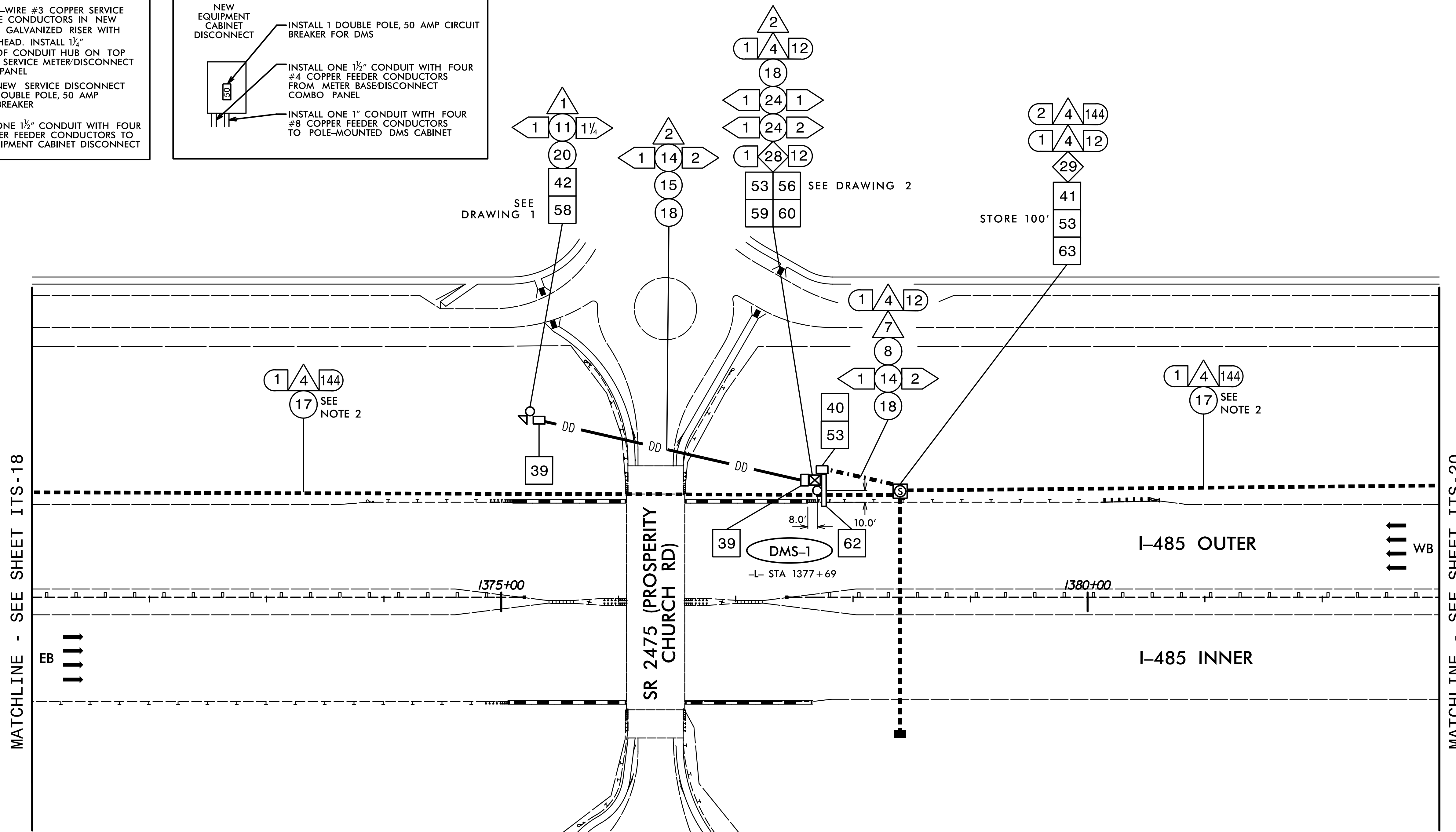

NOTES:

1. MAINTAIN A MINIMUM OF SIX (6) FEET FROM THE EDGE OF PAVEMENT WHEN TRENCHING PARALLEL TO THE ROADWAY.
2. INSTALL FIBER-OPTIC CABLE INTO THE EXISTING BLACK DUCT.
3. CONTACT THE REGIONAL ITS ENGINEER AT (704) 347-6601 TO CONFIRM THE LOCATION OF THE DMS.
4. INSTALL A NEW DMS, WALKWAY, LADDER, AND POLE-MOUNTED CABINET ON THE NEW DMS STRUCTURE.
5. INSTALL A LEVEL CONCRETE TECHNICIAN PAD MEASURING A MINIMUM OF 4 INCHES THICK, 24 INCHES WIDE AND 36 INCHES LONG AT THE FRONT DOOR OF THE DMS EQUIPMENT CABINET. SEE TYPICAL DETAILS SHEET.
6. CONTACT TOM EDELEN (DUKE ENERGY) AT (704) 582-8070 TO OBTAIN POWER TO ELECTRICAL SERVICE.

NOTE:
ELECTRICAL SERVICE DETAILS AND CONSTRUCTION METHODS DEPICT FIELD CONDITIONS AT THE TIME OF DESIGN. CONTRACTOR IS TO VERIFY ACTUAL CONDITIONS AT THE TIME OF CONSTRUCTION AND OBTAIN APPROVAL FROM THE ENGINEER PRIOR TO MAKING ANY CHANGES.

HNTB HNTB NORTH CAROLINA, P.C.
343 E. Six Forks Road, Suite 200
Raleigh, North Carolina 27609
NC License No: C-1554

<p>Plans Prepared for:</p> <p>250 N. Greenfield Place, Garner, NC 27529</p>	<p>CABLE ROUTING PLAN</p>		<p>SEAL</p> <p>H.L. Winstead, Jr.</p>					
	<p>DIVISION 10 MECKLENBURG CO. CHARLOTTE</p> <p>PLAN DATE: FEBRUARY 2015 REVIEWED BY: A.D. KLINKSIEK</p> <p>PREPARED BY: T.R. TERRELL REVIEWED BY: H.L. WINSTEAD</p>	<table border="1"> <thead> <tr> <th>REVISIONS</th> <th>INIT.</th> <th>DATE</th> </tr> </thead> <tbody> <tr> <td> </td> <td> </td> <td> </td> </tr> </tbody> </table>		REVISIONS	INIT.	DATE		
REVISIONS	INIT.	DATE						