

**NOTE: SEE UC PLANS FOR EXACT REQUIREMENTS FOR THE CONSTRUCTION OF THE WATERLINES.

- A) REMOVE EXISTING MONOLITHIC ISLAND ON US 421/NC 27
- B) INSTALL 20" WATERLINE
- C) INSTALL TEMPORARY 16" BYPASS WATERLINE AND OPEN TO SERVICE
- D) CONSTRUCT THE PEDESTRIAN CULVERT UNDER US 421/NC 27 AND TEMPORARY HEADWALLS
- E) OPEN 20" WATERLINE TO SERVICE AND REMOVE BYPASS 16" WATERLINE
- F) INSTALL STORMWATER DRAINAGE ITEMS AS SHOWN ON THIS SHEET INCLUDING STEEL PLATE COVERS FOR DRAINAGE BOXES

UP TO BUT NOT INCLUDING THE FINAL LAYER OF SURFACE COURSE, COMPLETE RECONSTRUCTION OF ROADWAY THAT WAS REMOVED TO INSTALL THE PEDESTRIAN CULVERT

ALL WORK DESCRIBED ABOVE TO BE COMPLETED IN 30 CONSECUTIVE CALENDAR DAYS

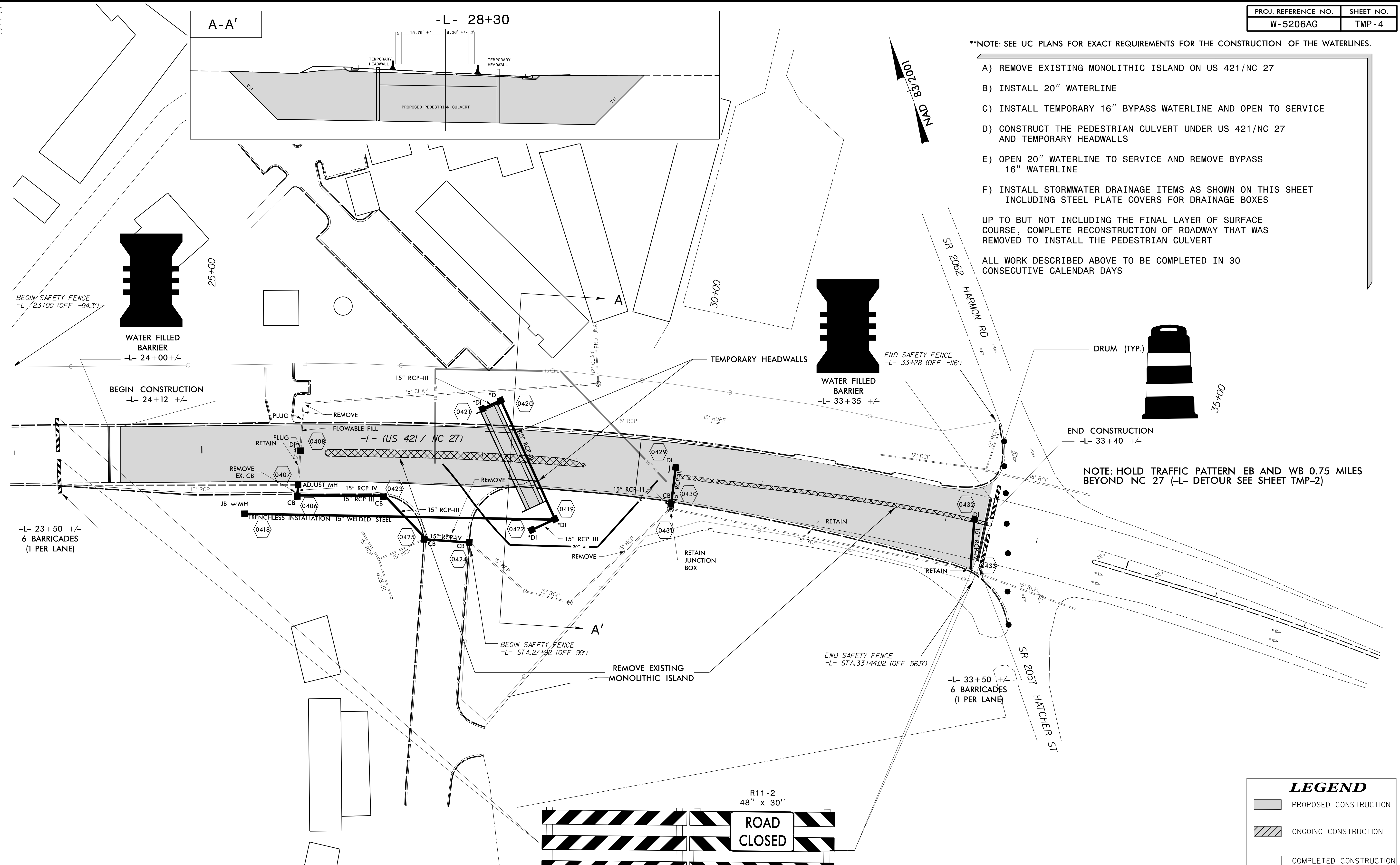

NOTE: HOLD TRAFFIC PATTERN EB AND WB 0.75 MILES BEYOND NC 27 (-L- DETOUR SEE SHEET TMP-2)

LEGEND

	PROPOSED CONSTRUCTION
	ONGOING CONSTRUCTION
	COMPLETED CONSTRUCTION

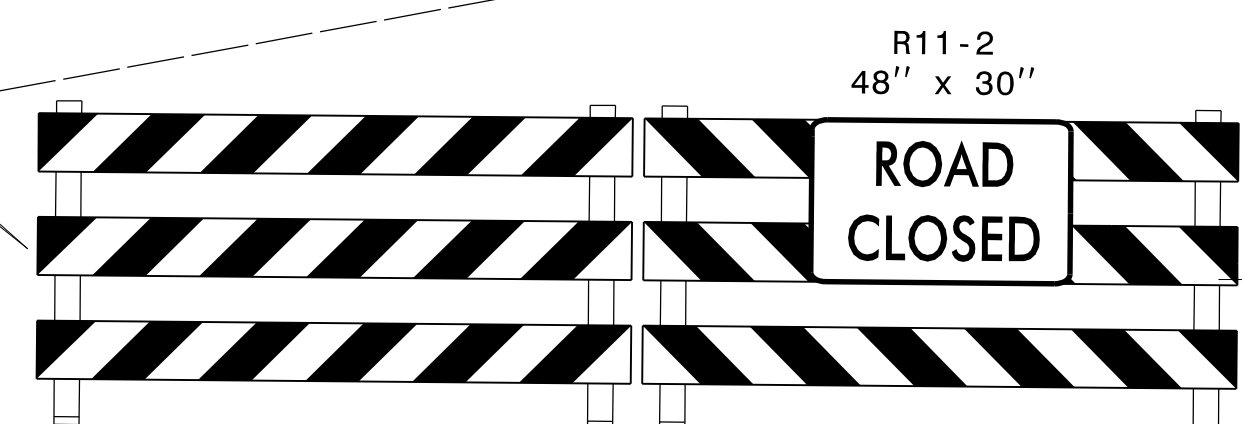

APPROVED: _____ DATE: _____

SEAL

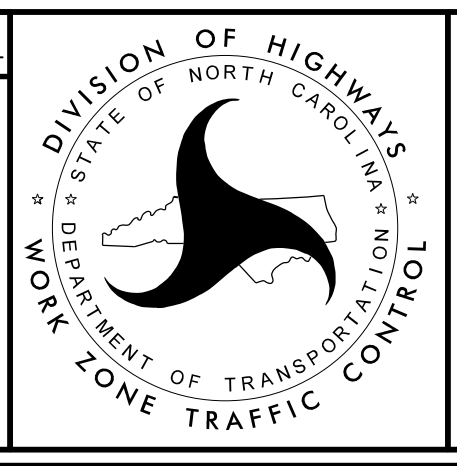

TRANSPORTATION MANAGEMENT PLAN

**PHASE I
DETAIL 1**

PLANS PREPARED BY:
PARSONS
2540 CENTERVIEW DR., SUITE 207
RALEIGH, NORTH CAROLINA 27606
NC LICENSE NO. F-0246
FOR NORTH CAROLINA STATE OF TRANSPORTATION

31-MAR-2015 20:57
 J:\W-5206AG\TrafficControl\TCP\W-5206AG-TC-TMP_04.dgn
 \$\$\$USERNAME\$\$\$