

PROJECT REFERENCE NO.	SHEET NO.
W-5512	EC-16/CONST.16
RW SHEET NO.	
ROADWAY DESIGN ENGINEER	HYDRAULICS ENGINEER

NOTES: ANY DEVIATION FROM OPTIONS GIVEN WILL REQUIRE PRIOR APPROVAL BY ENGINEER.
 ADDITIONAL EROSION CONTROL DEVICES MAY NEED TO BE INSTALLED AS DIRECTED BY THE ENGINEER.

-L-
 PI Sta 216+04.01
 $\Delta = 0^{\circ}13'02.6''$ (LT)
 $D = 0^{\circ}28'38.9''$
 $L = 45.53'$
 $T = 22.77'$
 $R = 12,000.00'$
 SE = NC

NOTE: PLACE TEMPORARY ROCK SEDIMENT DAMS TYPE - B AND TEMPORARY ROCK SILT CHECKS TYPE - A AT DRAINAGE OUTLETS.

CLEARING AND GRUBBING EROSION CONTROL FOR CONSTRUCTION SHEET 16

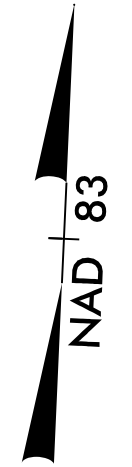
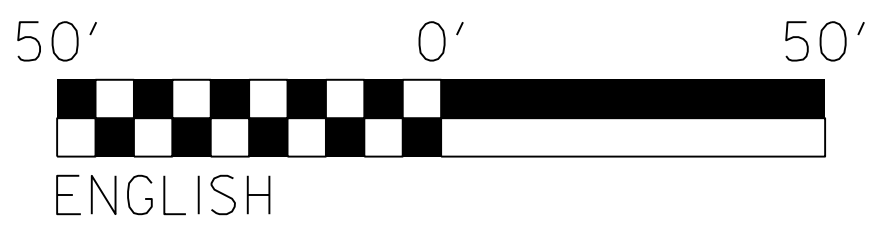

MATCH LINE -L- STA 210+00 SEE SHEET 16

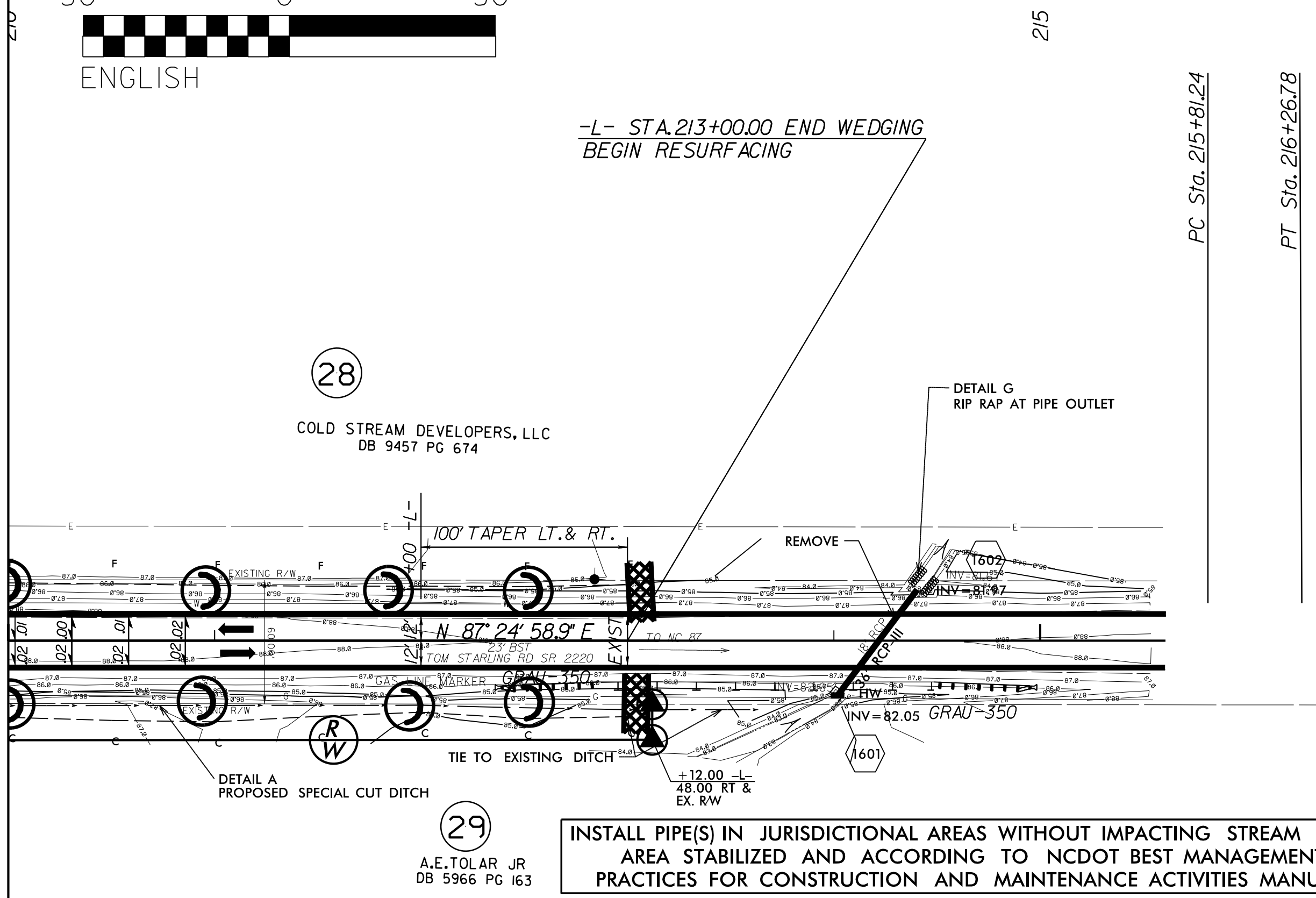

INSTALL PIPE(S) IN JURISDICTIONAL AREAS WITHOUT IMPACTING STREAM UNTIL AREA STABILIZED AND ACCORDING TO NCDOT BEST MANAGEMENT PRACTICES FOR CONSTRUCTION AND MAINTENANCE ACTIVITIES MANUAL.

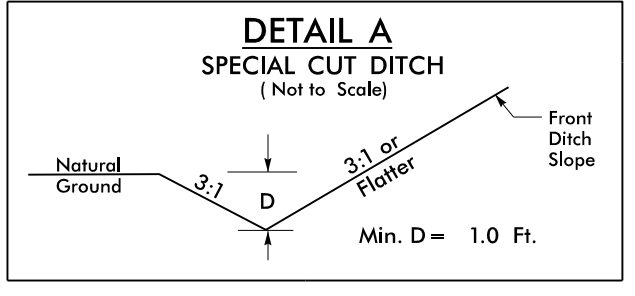

FROM STA. 207+50 TO STA. 213+00 -L- RT

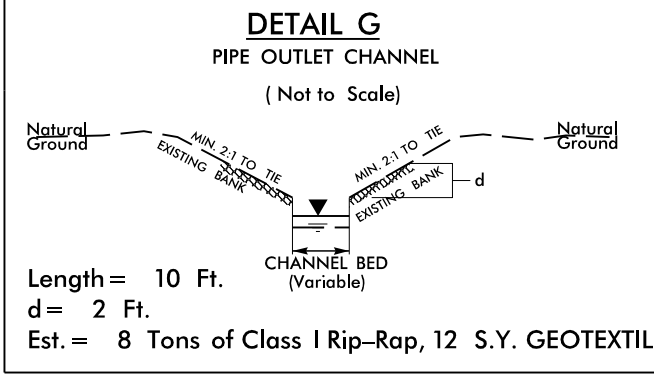

STA. 214+22 -L- LT
 DDE=5 C.Y.

NOTE: SEE SHEET 22 FOR -L- PROFILE

*NOTE: RESURFACING TO END -L- STA.245+23.91 (SEE T.S.NO.1 SHEET 2)