

Signal Cable

Head 11 : 3+87+167+30+26+3 = 316'  
 Head 33 : 3+52+159+30+26+3 = 273'  
 Head 42 : 3+98+30+26+3 = 160'  
 Head 51 : 3+63+30+26+3 = 125'  
 -----  
 Total : 874'

SIGNAL FACE	PHASE					FLASH
	Ø1+5	Ø1+6	Ø2+5	Ø2+6	Ø3	
11	—	—	R	R	R	R
21	R	R	G	G	R	Y
22	R	R	G	G	R	Y
31	R	R	R	R	G	R
32	R	R	R	R	G	R
33	R	R	R	R	G	R
41	R	R	R	R	G	R
42	R	R	R	R	G	R
43	R	R	R	R	G	R
51	—	—	R	R	R	R
61	R	G	R	G	R	Y
62	R	G	R	G	R	Y

SIGNAL FACE I.D.

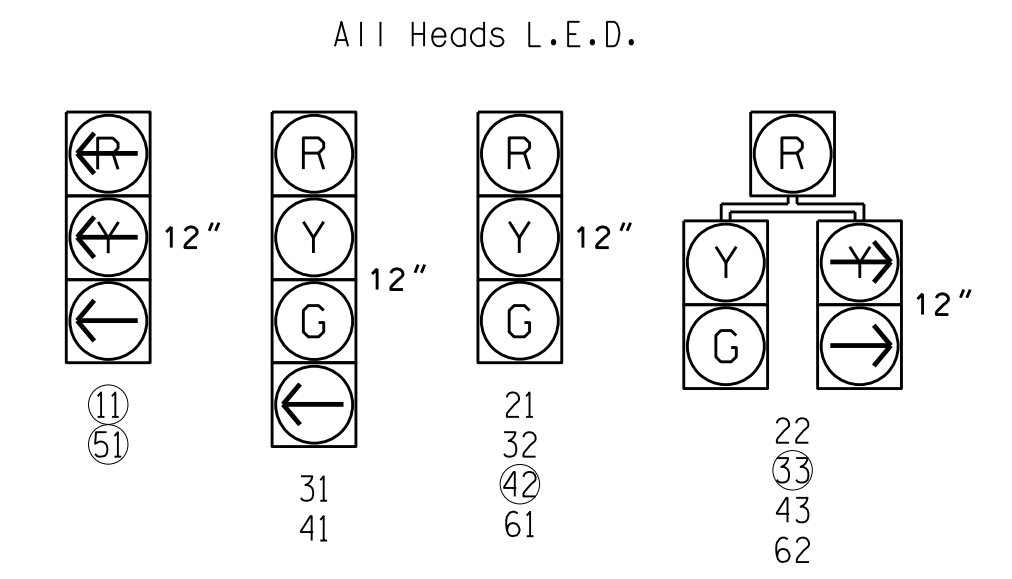

6 Phase  
Fully Actuated  
Isolated

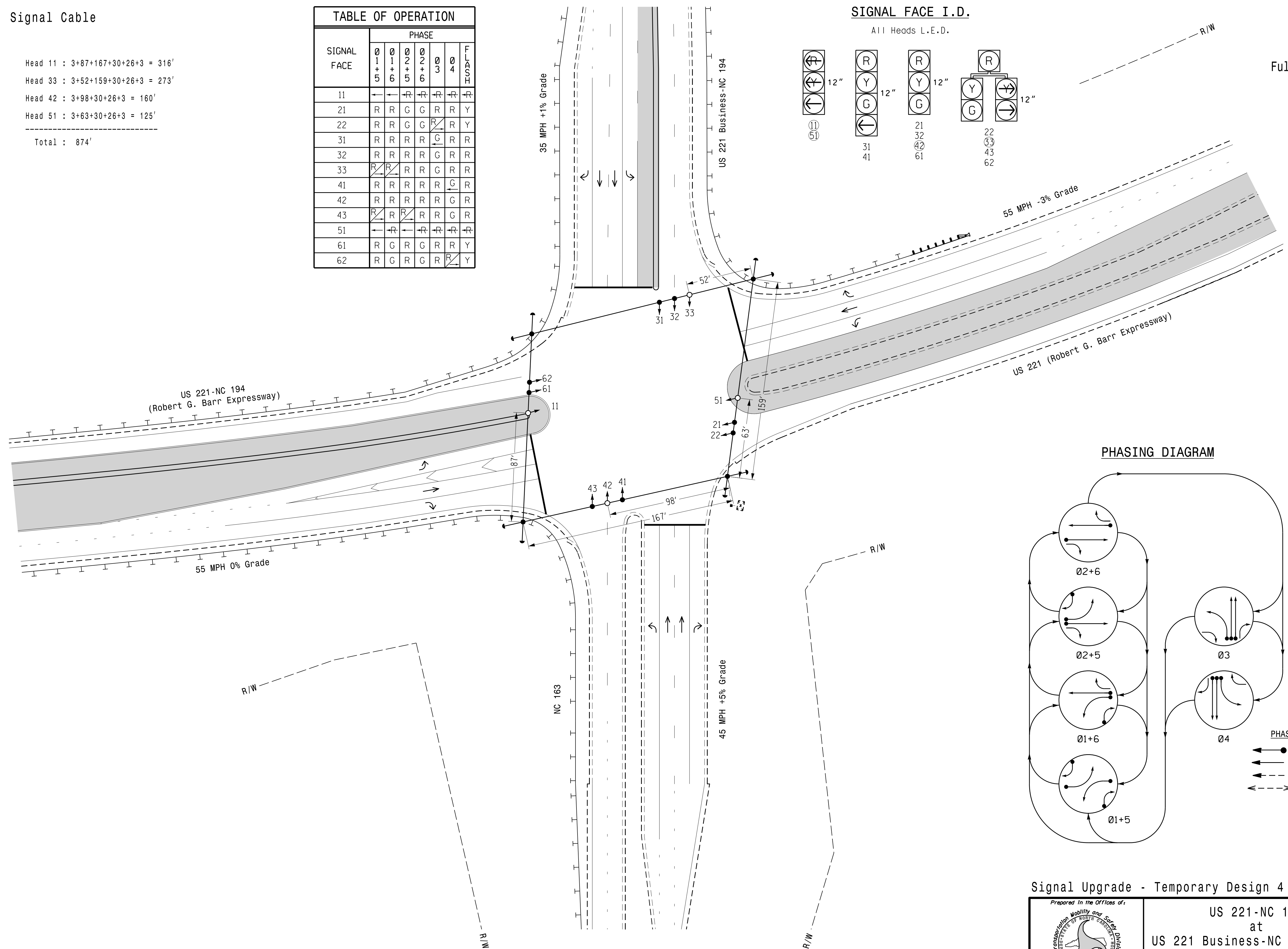

PHASING DIAGRAM

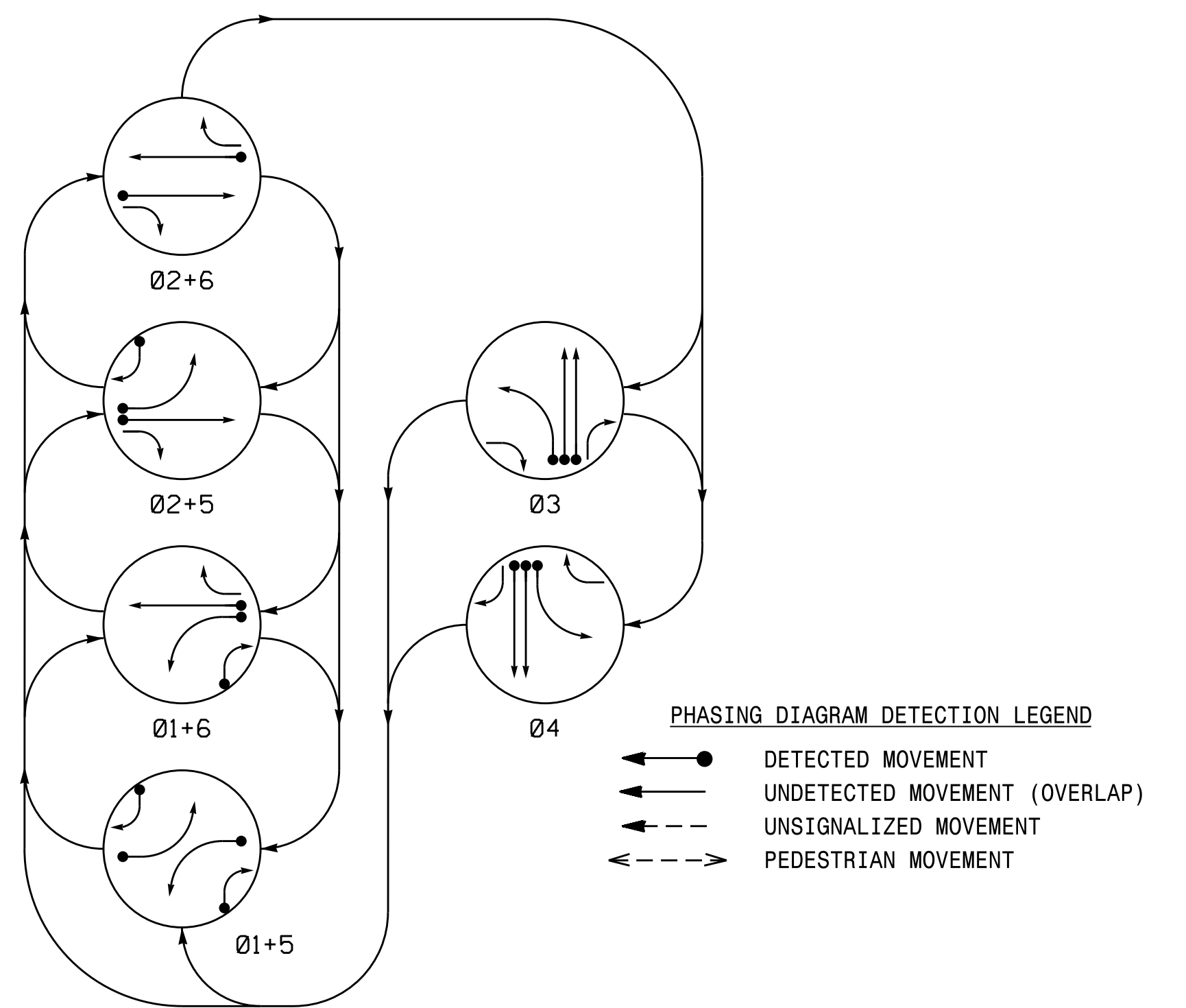

Signal Upgrade - Temporary Design 4 - TCP Phase III (Step 5)

	US 221-NC 194 at US 221 Business-NC 194/NC 163		
	Division 11 Ashe County near West Jefferson		
	PLAN DATE: September 2014	REVIEWED BY: Z.M. Little	
PREPARED BY: C.L. Sweeney	REVIEWED BY:		
SCALE: 1"=40'	REVISIONS:	INIT.	DATE
		DocuSigned by: <i>Zachary M. Little</i> 10/14/2014	
		SIG. INVENTORY NO. II-0341 T4	

28-Oct-2014 11:27  
 R:\C\Projects\2014\Signal Design\20141007.dgn  
 C:\Users\csweeney