

**END TIP PROJECT R-2915C
BEGIN TIP PROJECT R-2915D**
-TIE- POT Sta. 25+44.02 =
-L- ST Sta. 464+44.02

-L-
Pls Sta 462+60.70
Os = 2' 37" 33.8"
Ls = 275.00'
LT = 183.35'
ST = 91.69'

THOMAS M. HOWELL AND WIFE,
KATHY H. HOWELL
DB 313 PG 1332

ALICE H. ATWOOD AND HUSBAND,
CECIL FOREST ATWOOD
DB 128 PG 555

CHARLES BONGOMAN
SAUNDERS
DB 222 PG 2292

PROJECT REFERENCE NO. <i>R-2915D</i>	SHEET NO. <i>EC-25/CONST.05</i>
RW SHEET NO.	
ROADWAY DESIGN ENGINEER	HYDRAULICS ENGINEER

FINAL GRADE
EROSION CONTROL FOR
CONSTRUCTION SHEET 05

Place Matting for Erosion Control
on Slopes Adjacent to Permitted
Wetlands as Work Allows.

INSTALL MATTING FOR
EROSION CONTROL IN THE
PROPOSED DITCH LINE.

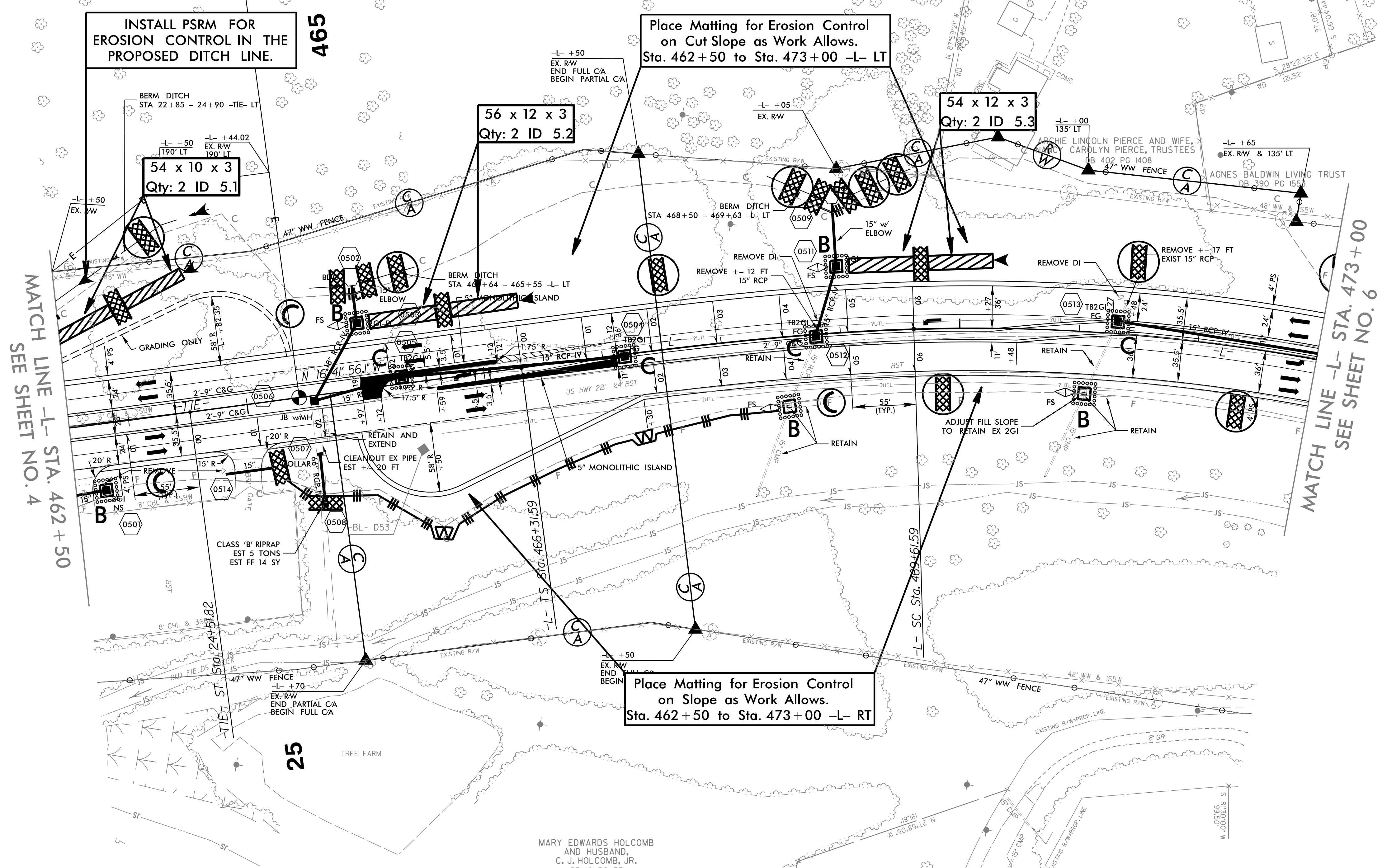

NOTES: ANY DEVIATION FROM OPTIONS GIVEN WILL REQUIRE PRIOR APPROVAL BY ENGINEER.

ADDITIONAL EROSION CONTROL DEVICES MAY NEED TO BE INSTALLED AS DIRECTED BY THE ENGINEER.

-L-
Pls Sta 468+51.71
Os = 5' 54' 31.1"
Ls = 330.00'
LT = 220.12'
ST = 110.11'

PI Sta 474+40.42
Δ = 33' 19' 17.0" (RT)
D = 3' 34' 51.6"
L = 930.51'
T = 478.83'
R = 1,600.00'
SE = .06
RUNOFF = 330'

-TIE-
Pls Sta 22+68.50
Os = 2' 37" 33.8"
Ls = 275.00'
LT = 183.35'
ST = 91.69'