

PROJECT REFERENCE NO.	SHEET NO.
R-2915D	EC-06/CONST.06
RW SHEET NO.	
ROADWAY DESIGN ENGINEER	HYDRAULICS ENGINEER

CLEARING AND GRUBBING EROSION CONTROL FOR CONSTRUCTION SHEET 06

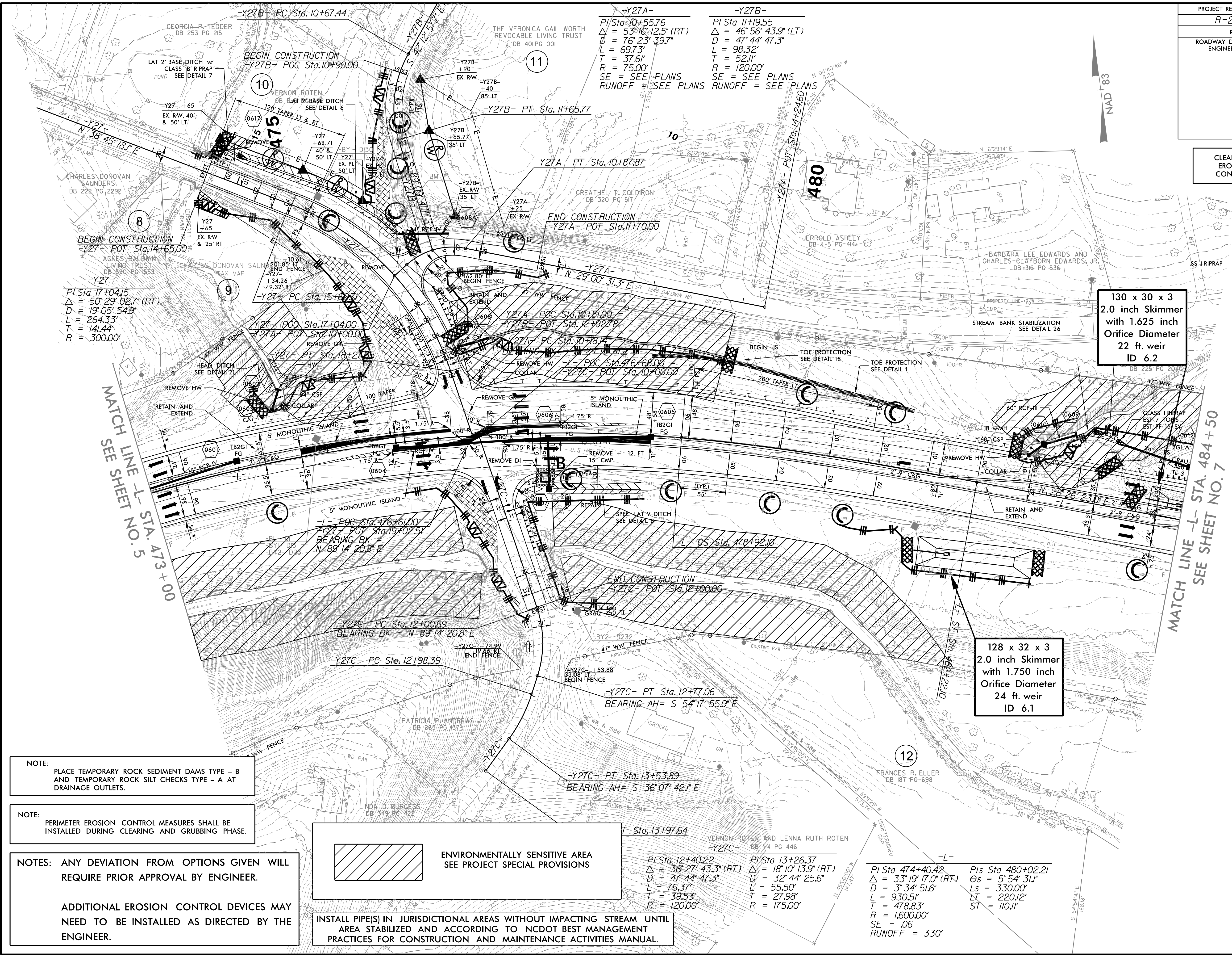

Y27-
 PI Sta 17+04.15
 $\Delta = 50^{\circ} 29' 02.7''$ (RT)
 $D = 19^{\circ} 05' 54.9''$
 $L = 264.33'$
 $T = 141.44'$
 $R = 300.00'$

Y27A-
 PI Sta 10+55.76
 $\Delta = 53^{\circ} 16' 12.5''$ (RT)
 $D = 76^{\circ} 23' 39.7''$
 $L = 697.3'$
 $T = 37.61'$
 $R = 75.00'$
 SE = SEE PLANS
 RUNOFF = SEE PLANS

Y27B-
 PI Sta 11+19.55
 $\Delta = 46^{\circ} 56' 43.9''$ (LT)
 $D = 47^{\circ} 44' 47.3''$
 $L = 98.32'$
 $T = 52.11'$
 $R = 120.00'$
 SE = SEE PLANS
 RUNOFF = SEE PLANS

130 x 30 x 3
 2.0 inch Skimmer
 with 1.625 inch
 Orifice Diameter
 22 ft. weir
 ID 6.2

128 x 32 x 3
 2.0 inch Skimmer
 with 1.750 inch
 Orifice Diameter
 24 ft. weir
 ID 6.1

NOTE:
 PLACE TEMPORARY ROCK SEDIMENT DAMS TYPE - B
 AND TEMPORARY ROCK SILT CHECKS TYPE - A AT
 DRAINAGE OUTLETS.

NOTE:
 PERIMETER EROSION CONTROL MEASURES SHALL BE
 INSTALLED DURING CLEARING AND GRUBBING PHASE.

NOTES: ANY DEVIATION FROM OPTIONS GIVEN WILL
 REQUIRE PRIOR APPROVAL BY ENGINEER.

ADDITIONAL EROSION CONTROL DEVICES MAY
 NEED TO BE INSTALLED AS DIRECTED BY THE
 ENGINEER.

 ENVIRONMENTALLY SENSITIVE AREA
 SEE PROJECT SPECIAL PROVISIONS

INSTALL PIPE(S) IN JURISDICTIONAL AREAS WITHOUT IMPACTING STREAM UNTIL
 AREA STABILIZED AND ACCORDING TO NCDOT BEST MANAGEMENT
 PRACTICES FOR CONSTRUCTION AND MAINTENANCE ACTIVITIES MANUAL.

Y27C-
 PI Sta 12+40.22
 $\Delta = 36^{\circ} 27' 43.3''$ (RT)
 $D = 47^{\circ} 44' 47.3''$
 $L = 76.37'$
 $T = 39.53'$
 $R = 120.00'$

Y27C-
 PI Sta 13+26.37
 $\Delta = 18^{\circ} 10' 13.9''$ (RT)
 $D = 32^{\circ} 44' 25.6''$
 $L = 55.50'$
 $T = 27.98'$
 $R = 175.00'$

-L-
 PI Sta 474+40.42
 $\Delta = 33^{\circ} 19' 17.0''$ (RT)
 $D = 3^{\circ} 34' 51.6''$
 $L = 930.51'$
 $T = 478.83'$
 $R = 1,600.00'$
 $SE = .06$
 $RUNOFF = 330'$

PIs Sta 480+02.21
 $\Delta s = 5^{\circ} 54' 31.1''$
 $Ls = 330.00'$
 $LT = 220.12'$
 $ST = 110.11'$