

PROJECT REFERENCE NO. R-2915D	SHEET NO. 17
RW SHEET NO.	
ROADWAY DESIGN ENGINEER	HYDRAULICS ENGINEER
KCI Engineers • Planners • Scientists • Construction Managers 4601 Six Forks Road, Landmark Center II, Suite 220 Raleigh, NC 27609-5210 Phone (919) 783-9214 • Fax (919) 783-9266	
SUNGATE DESIGN GROUP, P.A. 915 JONES FRANKLIN ROAD RALEIGH, NORTH CAROLINA 27606 TEL (919) 859-2345 FAX (919) 859-4258 ENG FIRM LICENSE NO. C-890	

-L-
 Pts Sta 608+81.22
 $\theta_s = 2^\circ 42' 59.8''$
 Ls = 275.00'
 LT = 183.35'
 ST = 91.69'

MATCH LINE -L- STA. 608 + 50
 SEE SHEET NO. 16

MATCH LINE -L- STA. 621 + 50
 SEE SHEET NO. 18

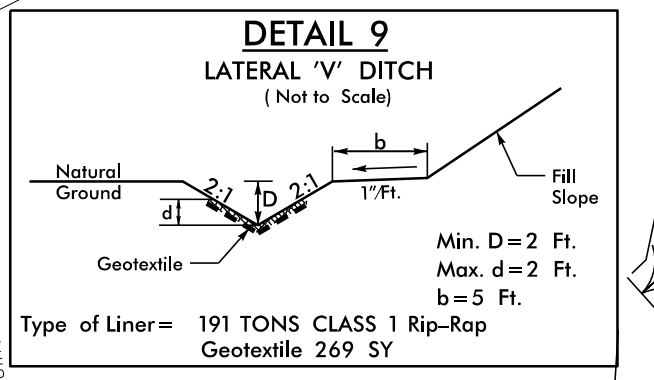
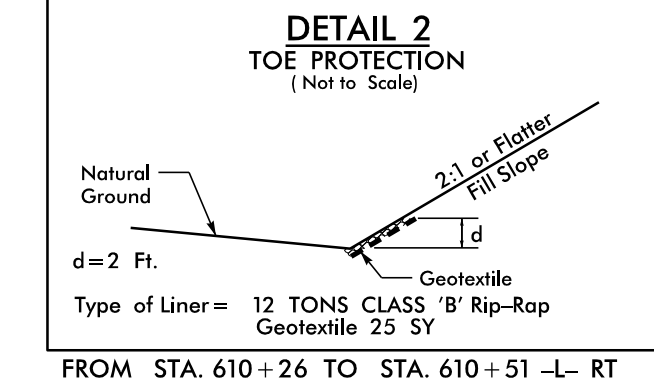
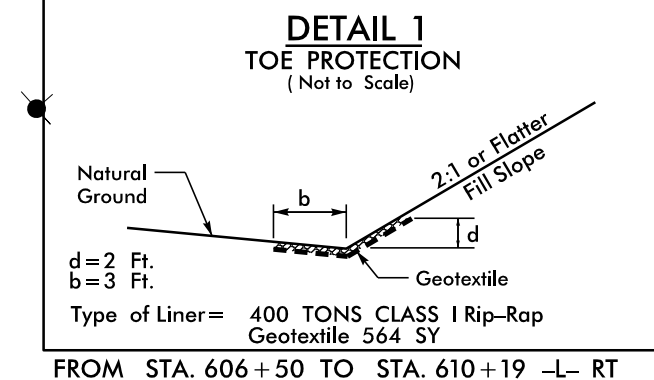
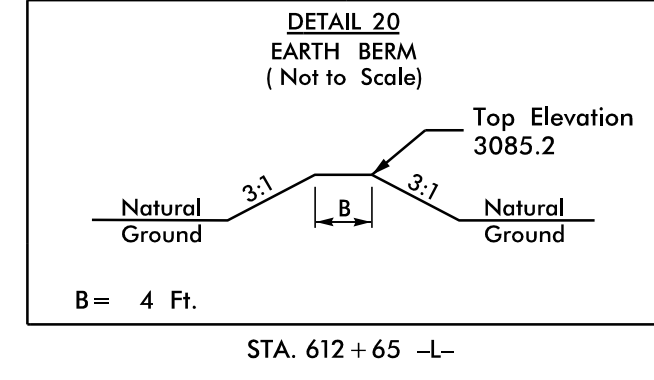
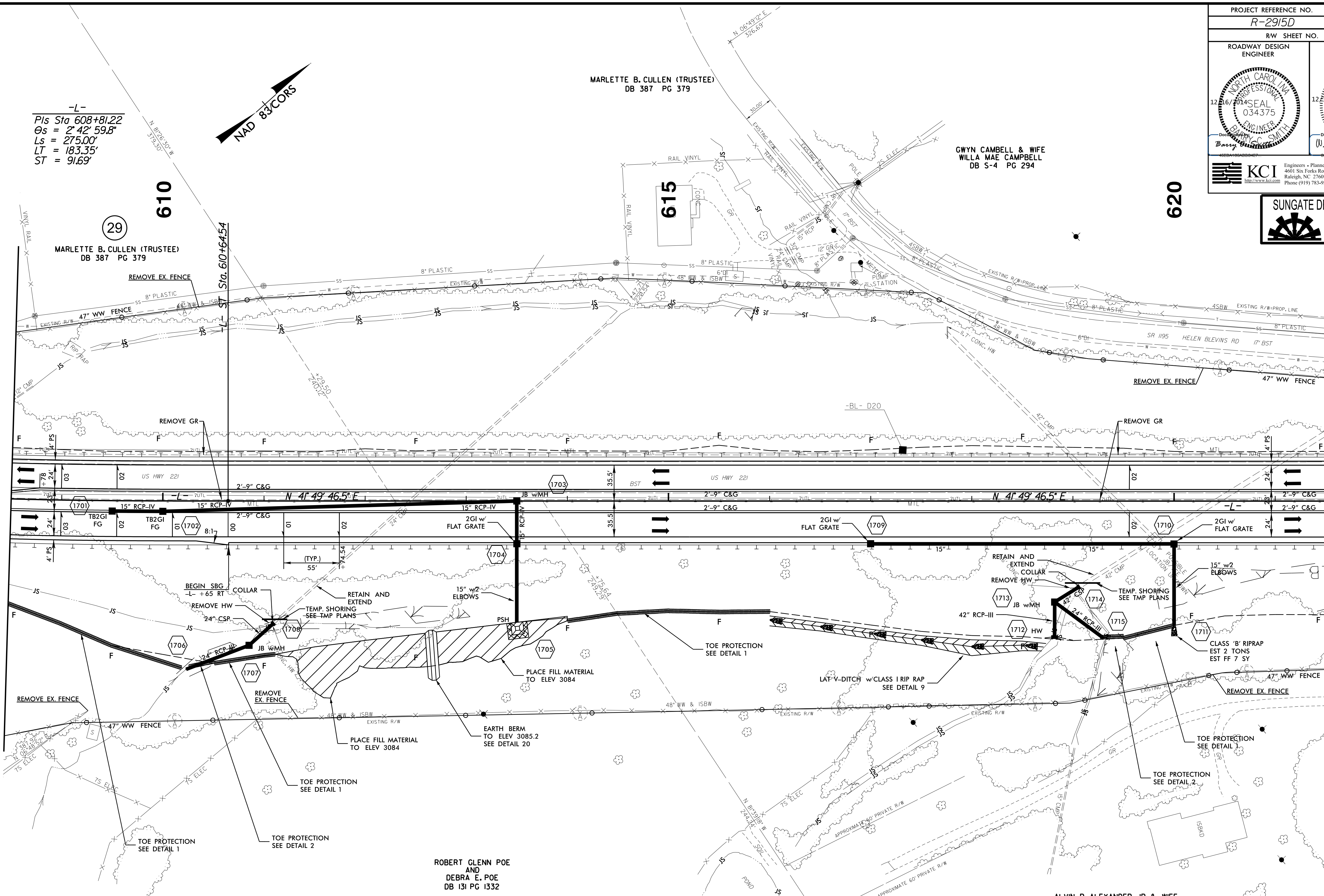

ALVIN P. ALEXANDER JR. & WIFE
 ALMA W. ALEXANDER
 GARY E. KEY & WIFE
 JEANNETTE A. KEY
 DB 188 PG 1208
 DB 188 PG 1214

NOTE: ALL EXISTING CONTROL OF ACCESS FENCE TO BE REMOVED UNLESS OTHERWISE NOTED.

8.17.799
 24-NOV-2014 08:32
 P:\2014\2915D\Roadway\Proj\2915D_Rdw_psh_17.dgn
 \$\$\$\$\$\$USERNAME\$\$\$\$\$\$