

PROJECT REFERENCE NO. R-2915D		SHEET NO. 16	
RW SHEET NO.			
ROADWAY DESIGN ENGINEER		HYDRAULICS ENGINEER	
Engineers • Planners • Scientists • Construction Managers 4601 Six Forks Road, Landmark Center II, Suite 220 Raleigh, NC 27609-5210 Phone (919) 783-9214 • Fax (919) 783-9266			
915 JONES FRANKLIN ROAD RALEIGH, NORTH CAROLINA 27608 TEL: (919) 856-2343 FAX: (919) 856-2359 ENG FIRM LICENSE NO. C-880			

-L-

PI Sta 598+87.47	PIs Sta 608+81.22
$\Delta = 36^{\circ} 59' 04.8" (LT)$	$\Theta_s = 2^{\circ} 42' 59.8"$
$D = 1^{\circ} 58' 32.6"$	$L_s = 275.00'$
$L = 1,871.96'$	$LT = 183.35'$
$T = 969.90'$	$ST = 91.69'$
$R = 2,900.00'$	
$SE = .05$	
$RUNOFF = 275'$	

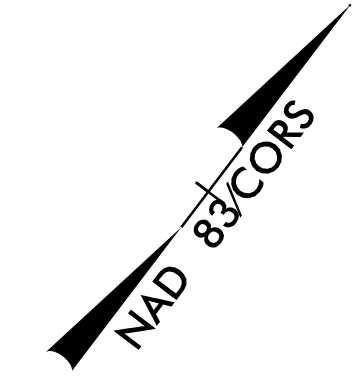

MATCH LINE -L- STA. 597+00
SEE SHEET NO. 15

MATCH LINE -L- STA. 608+50
SEE SHEET NO. 17

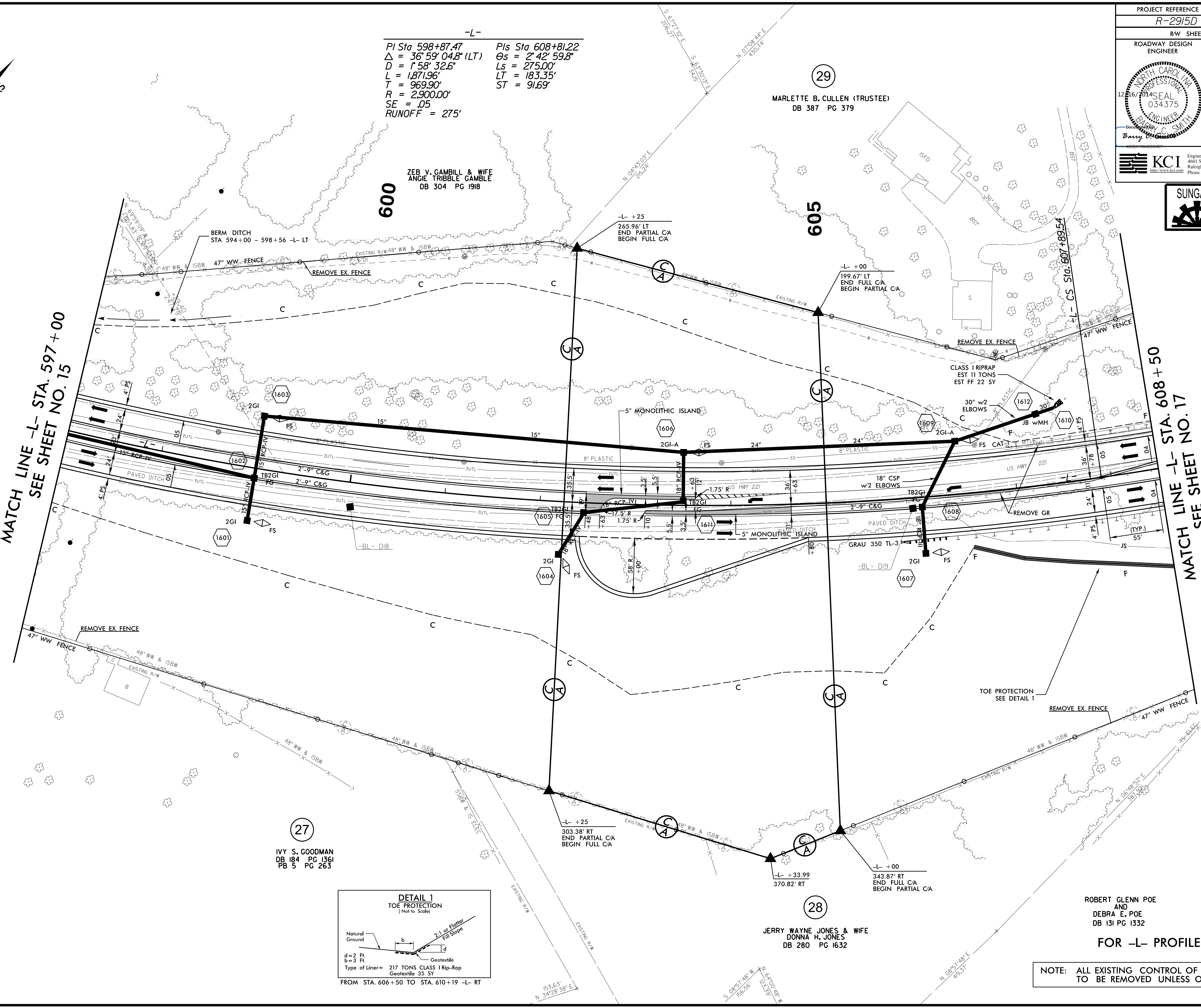

27
 IVY S. GOODMAN
 DB 184 PG 1361
 PB 5 PG 263

28
 JERRY WAYNE JONES & WIFE
 DONNA H. JONES
 DB 280 PG 1632

ROBERT GLENN POE
 AND
 DEBRA E. POE
 DB 131 PG 1332

FOR -L- PROFILE, SEE SHEET 30

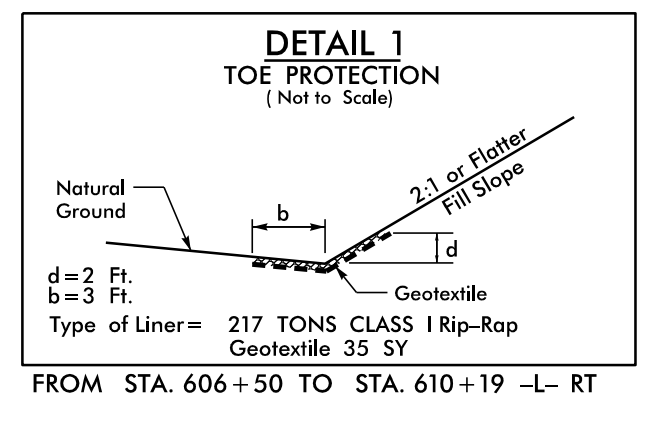

NOTE: ALL EXISTING CONTROL OF ACCESS FENCE TO BE REMOVED UNLESS OTHERWISE NOTED.

8/17/99
 24-NOV-2014 08:32
 P:\2011\2411015\2915D\Roadway\Pro\2915D_Rdwy_psh_16.dgn
 \$\$\$\$\$\$USERNAME\$\$\$\$\$\$