

PROJECT REFERENCE NO. <b>R-2915D</b>		SHEET NO. <b>15</b>	
RW SHEET NO.		HYDRAULICS ENGINEER	
ROADWAY DESIGN ENGINEER		ENGINEER	

ZEB V. GAMBILL & WIFE  
ANGIE TRIBBLE GAMBILL  
DB 304 PG 1918

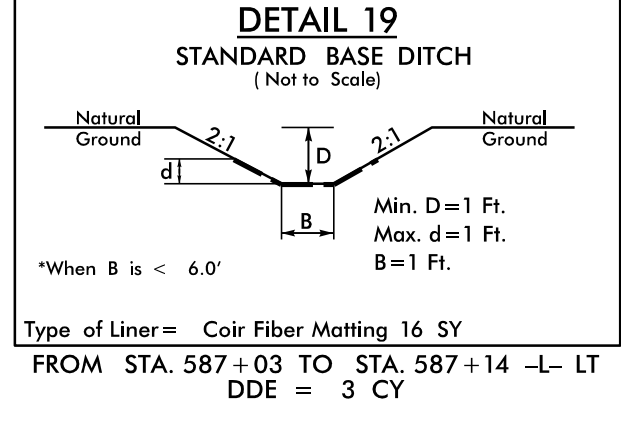
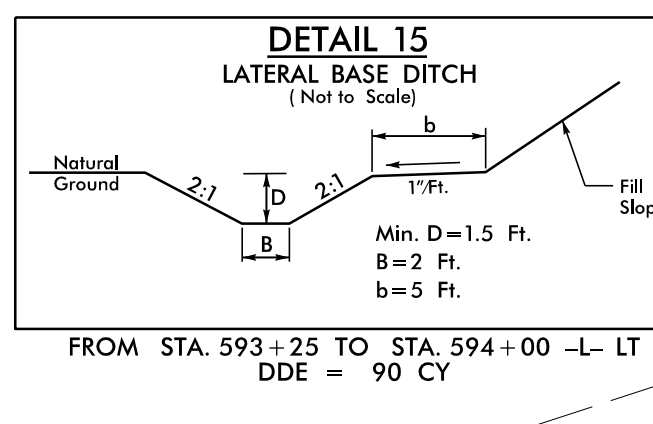
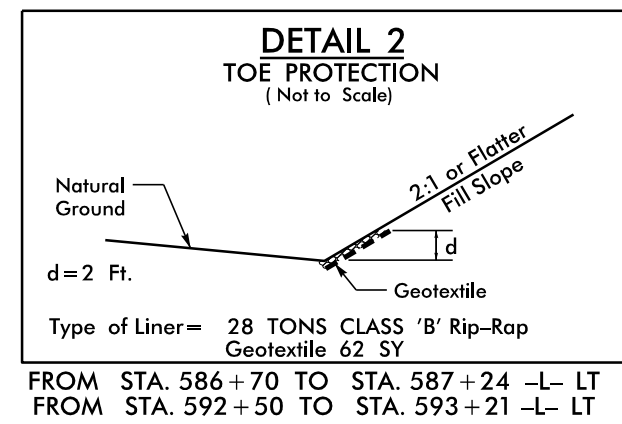
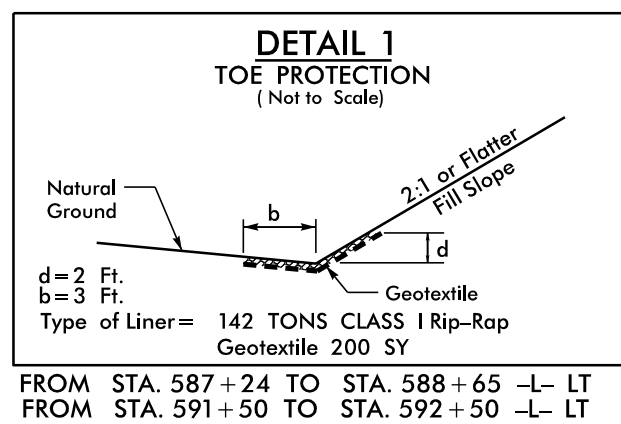

**-L-**

PI Sta 588+25.93  
Os = 2' 42" 59.8"  
Ls = 275.00'  
LT = 183.35'  
ST = 91.69'

PI Sta 598+87.47  
Δ = 36' 59" 04.8" (LT)  
D = 1' 58" 32.6"  
L = 1,871.96'  
T = 969.90'  
R = 2,900.00'  
SE = .05  
RUNOFF = 275'

MATCH LINE -L- STA. 584+50  
SEE SHEET NO. 14

MATCH LINE -L- STA. 597+00  
SEE SHEET NO. 16

8/17/09  
R:\01\2014\_10\_30\2915D\Roadway\Proc\15-R2915D\_Rdwy\_psh\_15.dgn  
P&M:JSD/10/30/2014 10:32  
R:\01\2014\_10\_30\2915D\Roadway\Proc\15-R2915D\_Rdwy\_psh\_15.dgn

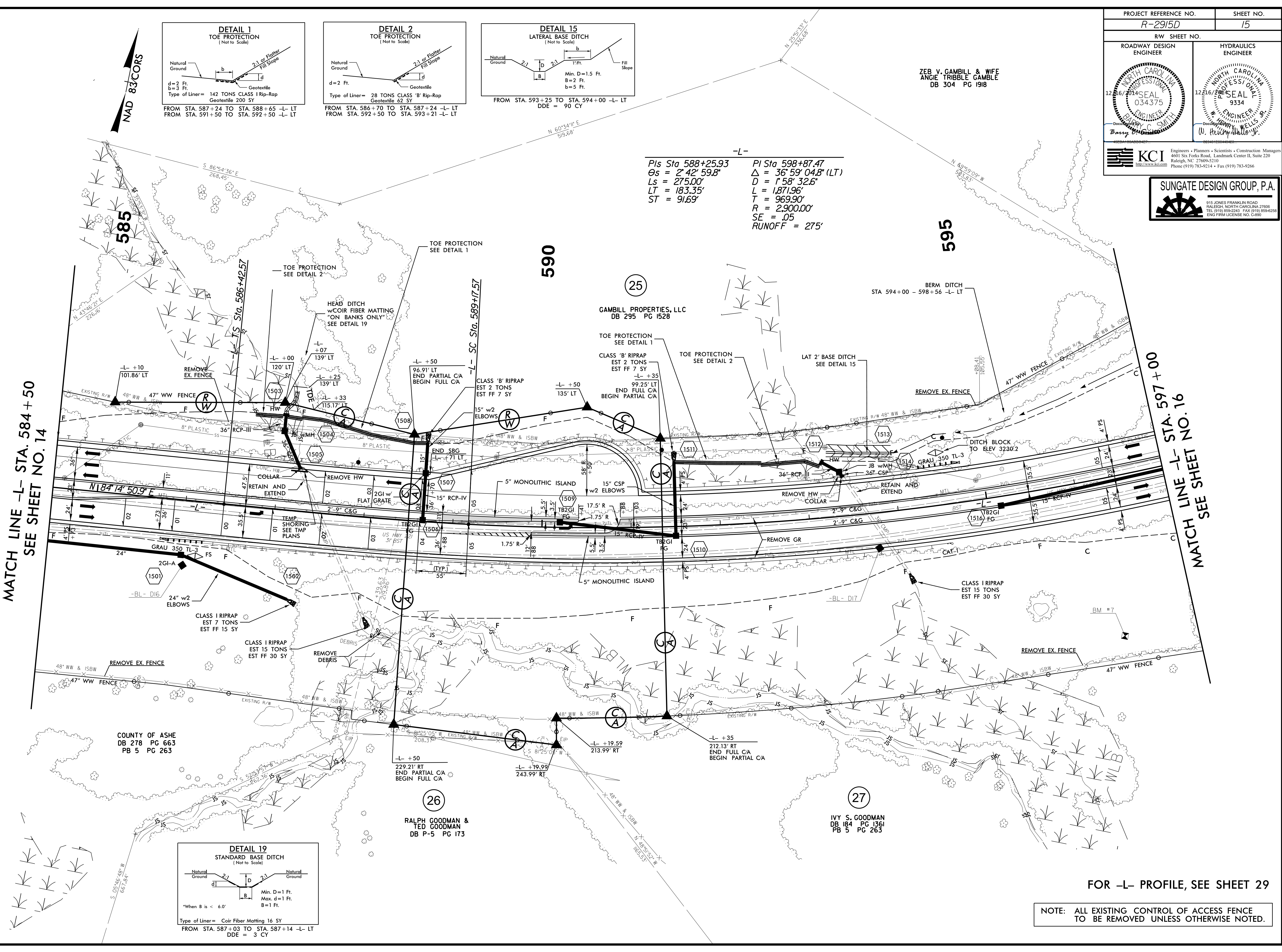

FOR -L- PROFILE, SEE SHEET 29

NOTE: ALL EXISTING CONTROL OF ACCESS FENCE TO BE REMOVED UNLESS OTHERWISE NOTED.