

PROJECT NO.	SHEET NO.	TOTAL SHEETS
13CR.10121.13, 13CR.20121.15	1	

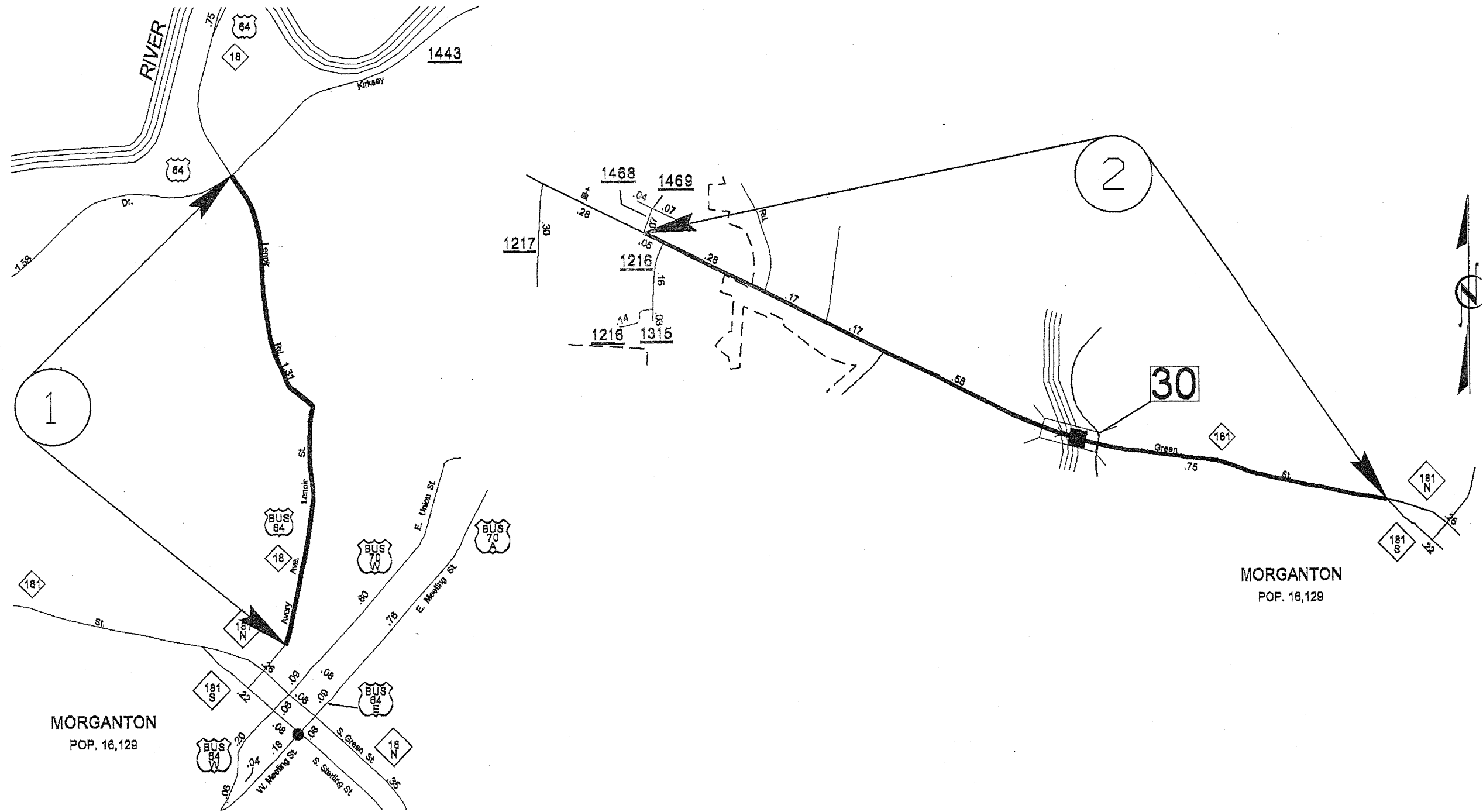

PROJECT NO.	SHEET NO.	TOTAL SHEETS
13CR.10121.13, 13CR.20121.15	2	

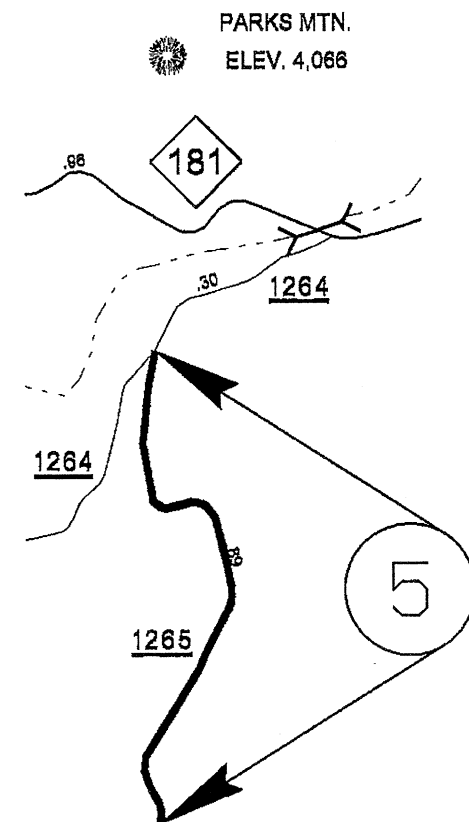
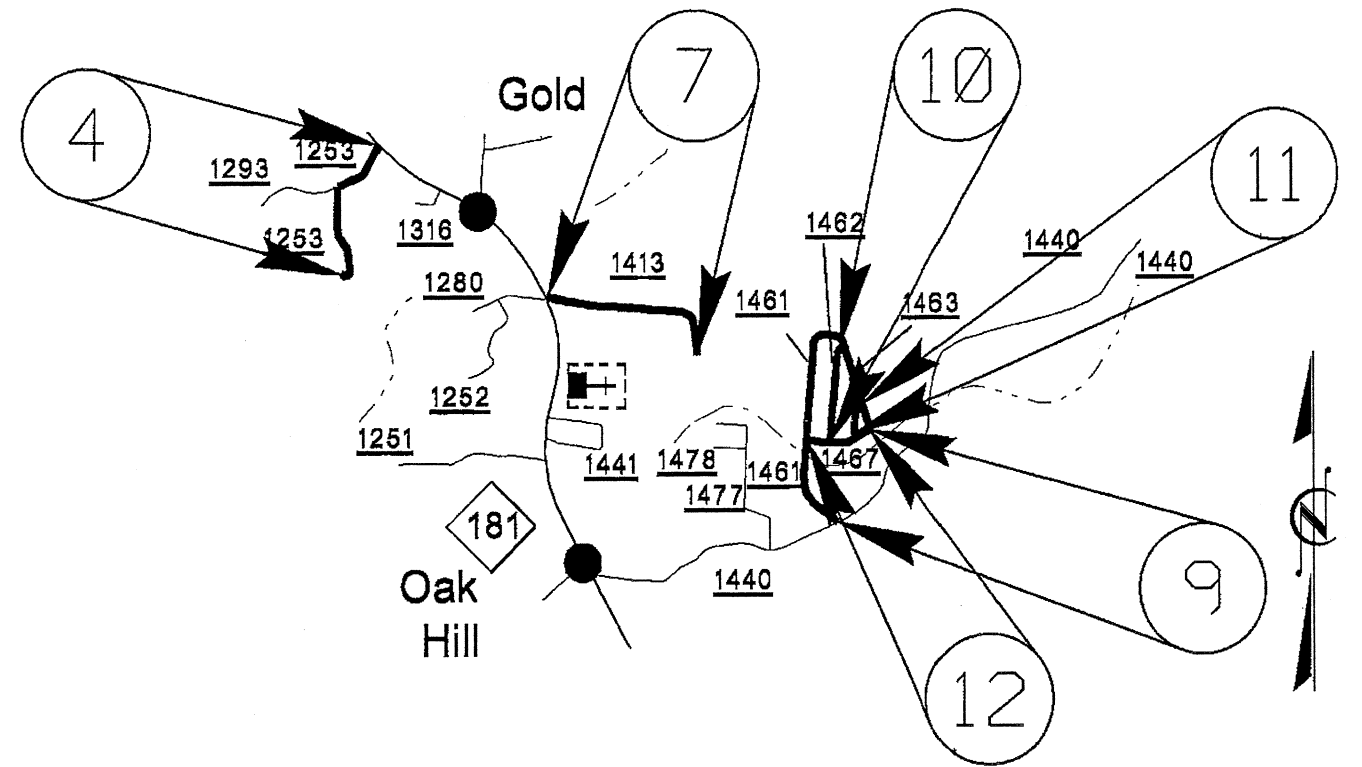
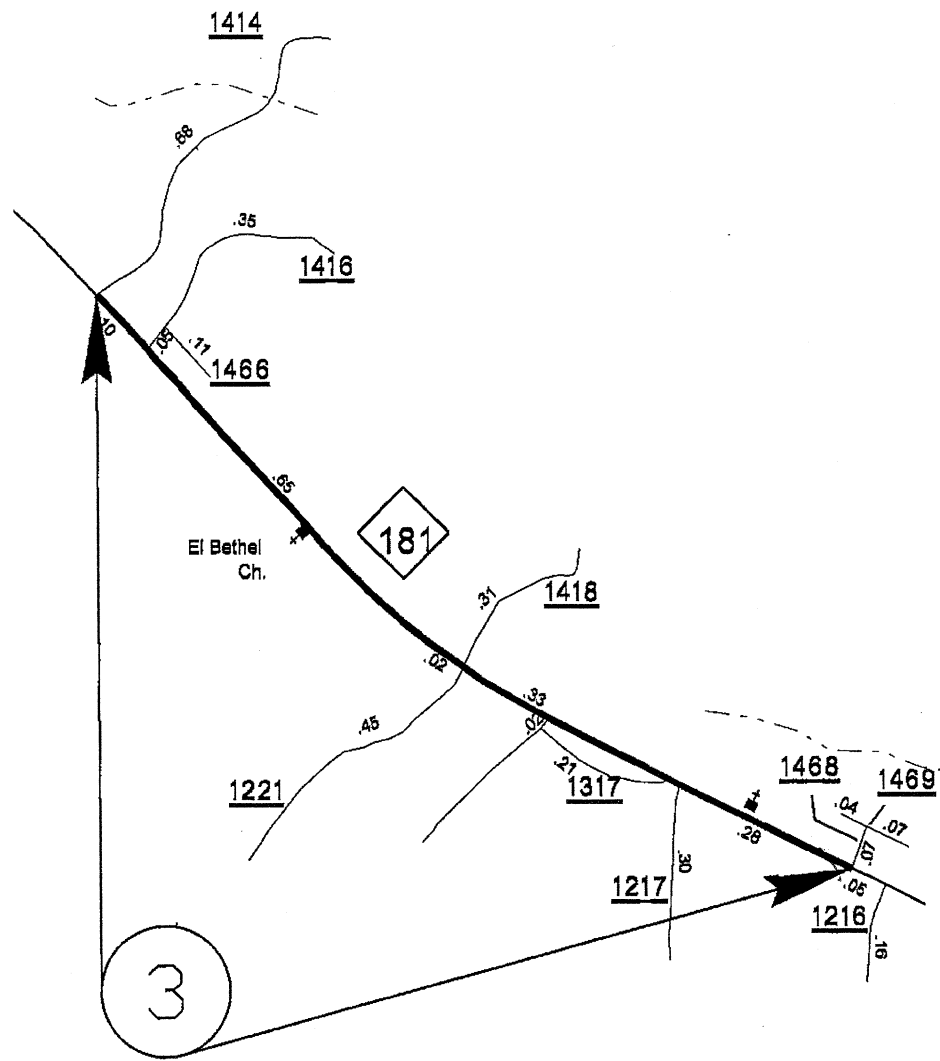

PARKS MTN.
ELEV. 4,066

BURKE COUNTY

PROJECT NO.	SHEET NO.	TOTAL SHEETS
13CR.10121.13, 13CR.20121.15	3	

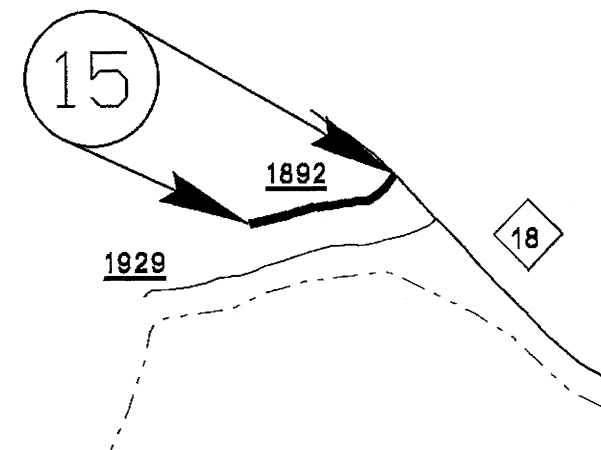
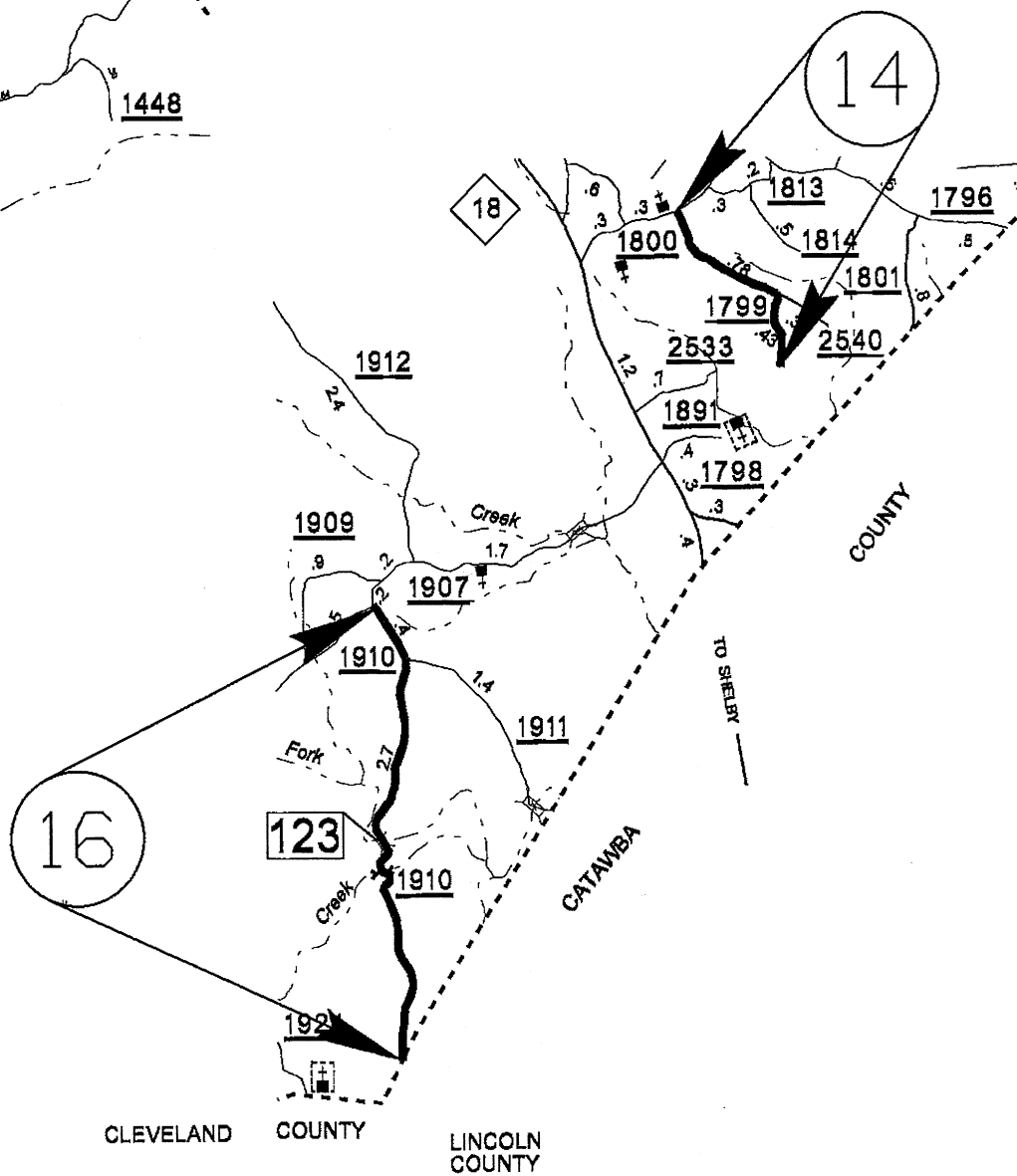
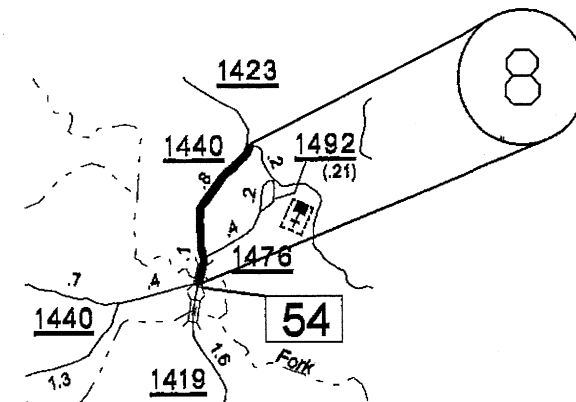
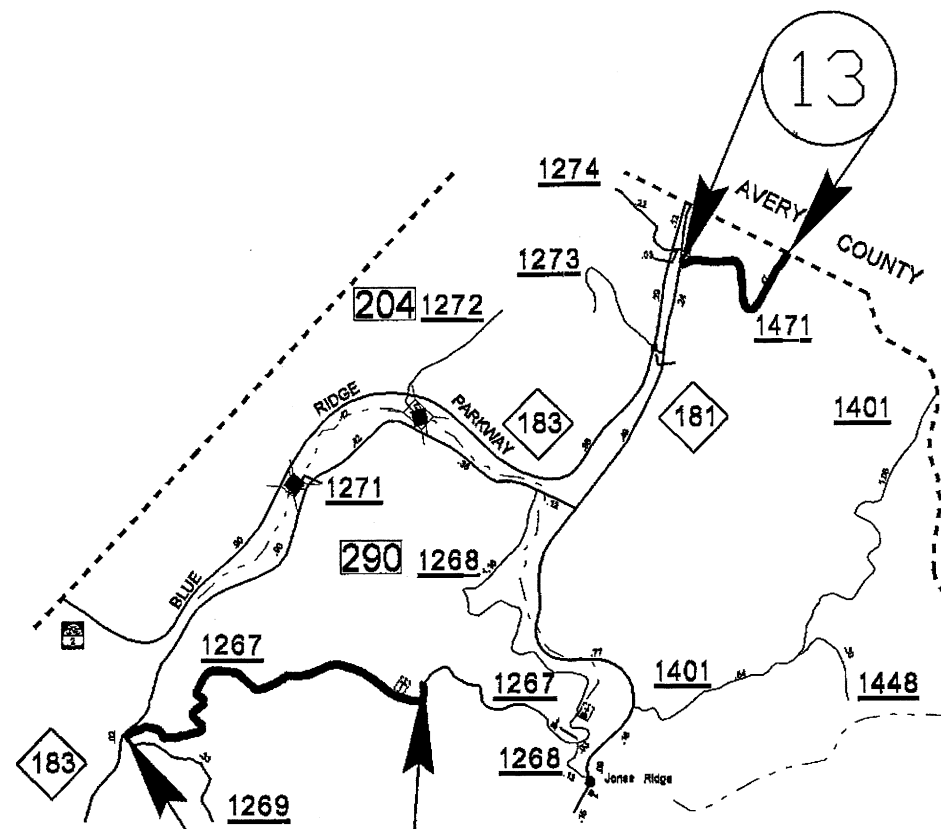

BURKE COUNTY

PROJECT NO. 13CR.10121.13, 13CR.20121.15	SHEET NO. 4	TOTAL SHEETS
--	----------------	--------------

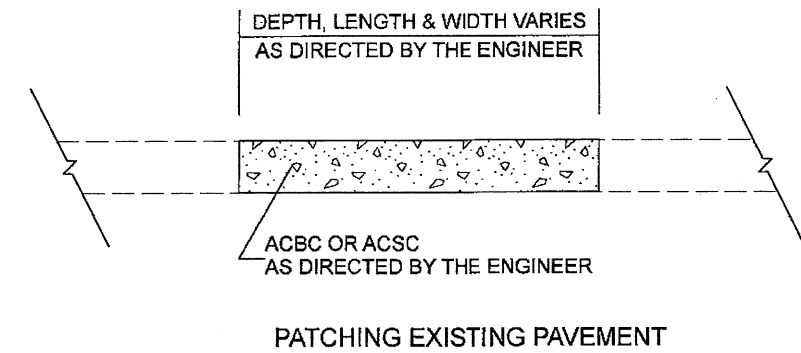
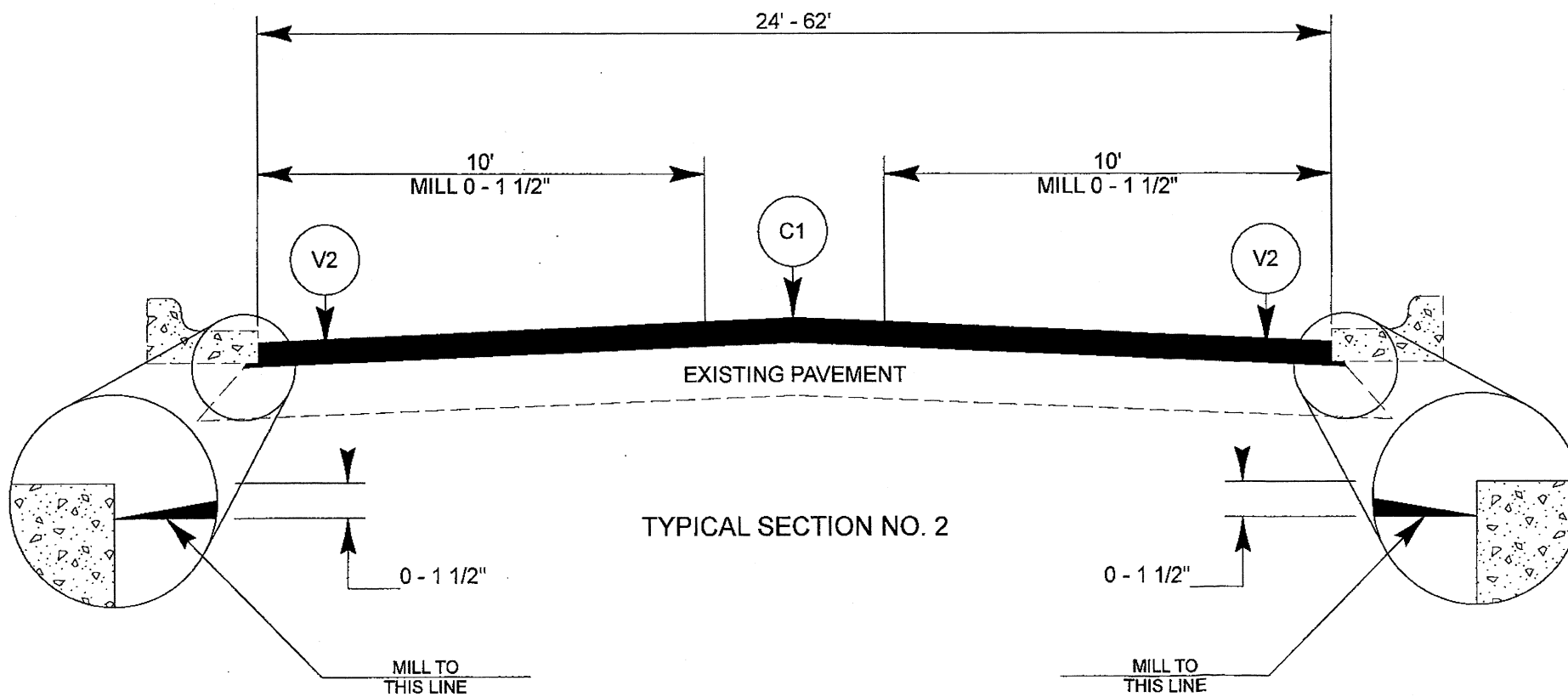
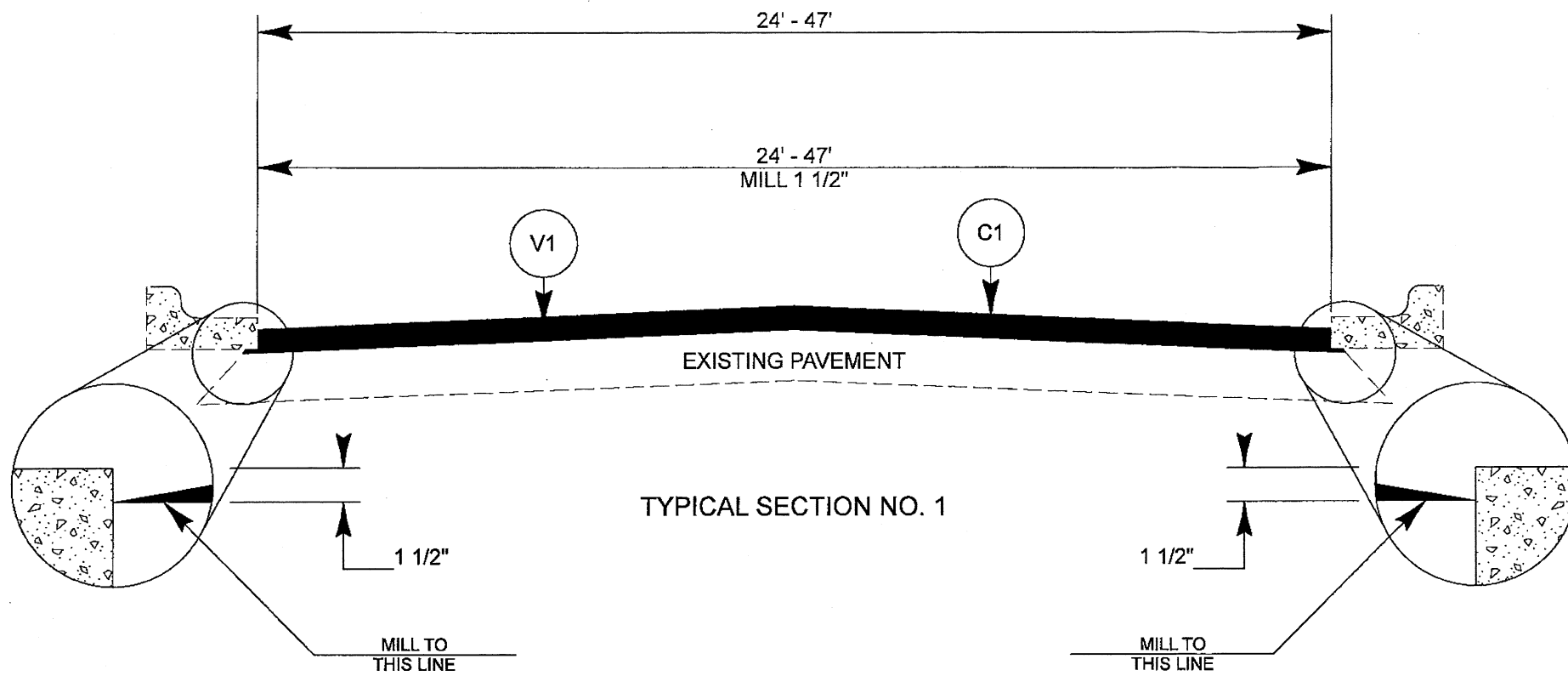

PAVEMENT SCHEDULE	
C1	PROP. APPROX. 1-1/2" ACSC, TYPE S9.5B, AT AN AVERAGE RATE OF 168 LBS. PER SQ. YD.
C2	PROP. APPROX. 1" ACSC, TYPE SF9.5A, AT AN AVERAGE RATE OF 110 LBS. PER SQ. YD.
C3	PROP. APPROX. 1-1/2" ACSC, TYPE SF9.5A, AT AN AVERAGE RATE OF 165 LBS. PER SQ. YD.
T1	SHOULDER RECONSTRUCTION
V1	MILLING ASPHALT PAVEMENT, 1-1/2" DEPTH
V2	MILLING ASPHALT PAVEMENT, 0 TO 1-1/2" DEPTH
V3	INCIDENTAL MILLING

PROJECT NO. 13CR.10121.13, 13CR.20121.15	SHEET NO. 5	TOTAL SHEETS
--	-----------------------	--------------

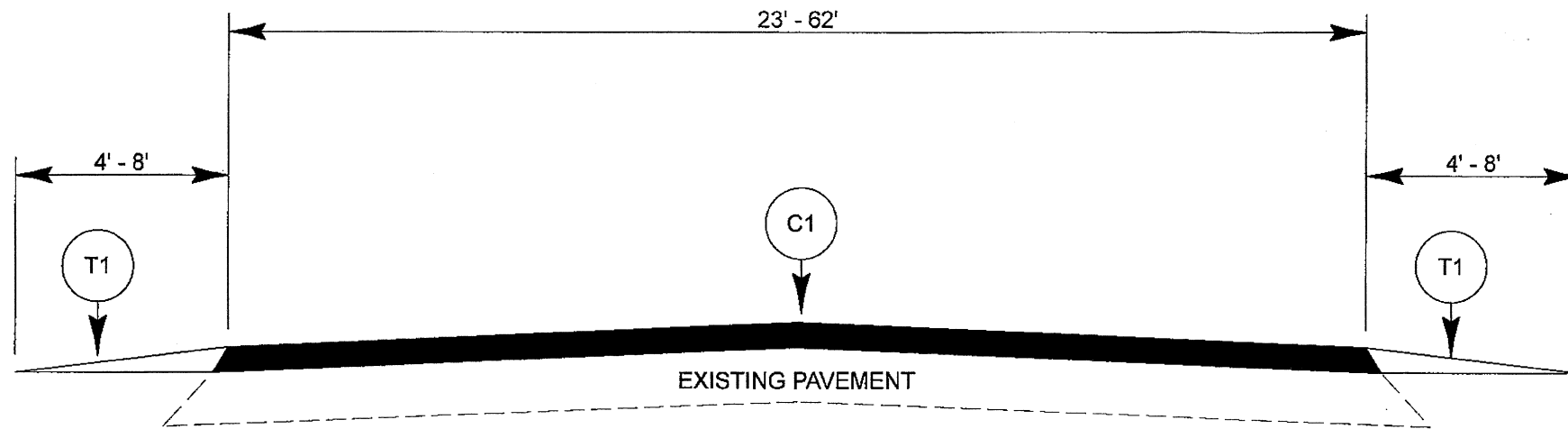

TYPICAL SECTION NO. 3

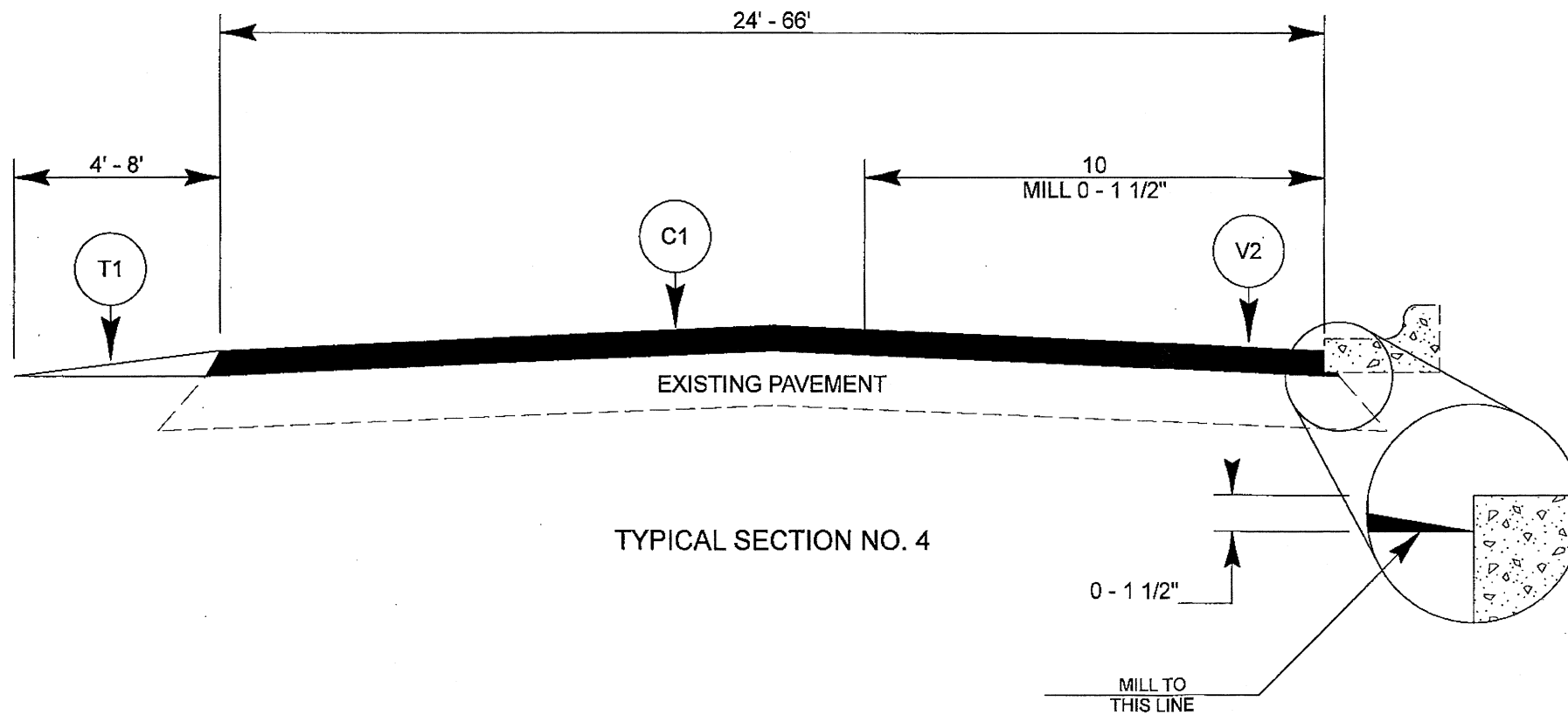

TYPICAL SECTION NO. 4

PAVEMENT SCHEDULE	
C1	PROP. APPROX. 1-1/2" ACSC, TYPE S9.5B, AT AN AVERAGE RATE OF 168 LBS. PER SQ. YD.
C2	PROP. APPROX. 1" ACSC, TYPE SF9.5A, AT AN AVERAGE RATE OF 110 LBS. PER SQ. YD.
C3	PROP. APPROX. 1-1/2" ACSC, TYPE SF9.5A, AT AN AVERAGE RATE OF 165 LBS. PER SQ. YD.
T1	SHOULDER RECONSTRUCTION
V1	MILLING ASPHALT PAVEMENT, 1-1/2" DEPTH
V2	MILLING ASPHALT PAVEMENT, 0 TO 1-1/2" DEPTH
V3	INCIDENTAL MILLING

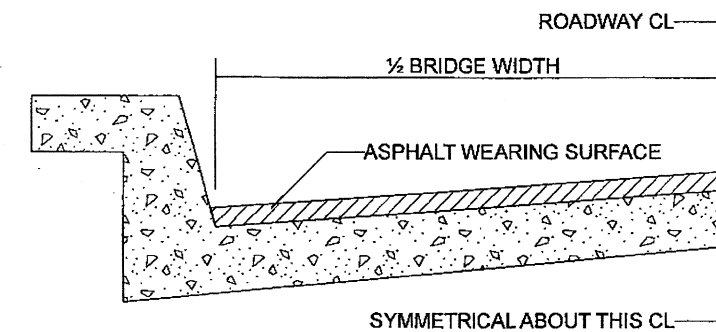

BRIDGE HALF TYPICAL SECTION

FOR BRIDGES WITH FLOOR DRAINS, CARE SHALL BE EXERCISED IN PLACING THE WEARING SURFACE AROUND FLOOR DRAINS SO AS NOT TO HINDER EFFECTIVE DRAINAGE. ALL DRAINS SHALL BE LEFT OPEN

THE PROPOSED WEARING SURFACE SHALL VARY IN THICKNESS AS NECESSARY TO PROVIDE A SMOOTH RIDING SURFACE. THE MINIMUM THICKNESS SHOULD DEPEND ON PAVEMENT TYPE AS FOLLOWS: S4.75A 3/4", SF9.5A 1.0", S9.5X 1.5", S12.5X 2.0", ULTRATHIN HOT MIX ASPHALT-TYPE A 3/4", ULTRATHIN HOT MIX ASPHALT-TYPE B 5/8", ULTRATHIN HOT MIX ASPHALT-TYPE C 1/2". THE MAXIMUM THICKNESS SHOULD DEPEND ON PAVEMENT TYPE AS FOLLOWS: S4.75A 1.0", SF9.5A 1.5", S9.5X 2.0", S12.5X 2.0", ULTRATHIN HOT MIX ASPHALT-TYPE A 3/4", ULTRATHIN HOT MIX ASPHALT-TYPE B 5/8", ULTRATHIN HOT MIX ASPHALT-TYPE C 1/2".

NOTES

ALL UNPAVED ROADS TO BE RESURFACED 50' FROM EDGE OF PAVEMENT OF MAIN PROJECT. ALL PAVED S.R. ROADS TO BE RESURFACED TO THE ENDS OF THE RADII, OR AS DIRECTED BY THE ENGINEER. EDGES, PAVEMENT WIDENING, INTERSECTIONS AND BRIDGE FLARES ARE INCLUDED IN THE TABLE OF QUANTITIES. SHOULDERS AND DITCHES ARE TO BE CONSTRUCTED BY OTHERS UNLESS OTHERWISE INDICATED. BRIDGES ARE TO BE RESURFACED AT LOCATIONS AND TO DEPTH AS DIRECTED BY THE ENGINEER.

PROJECT NO. 13CR.10121.13, 13CR.20121.15	SHEET NO. <i>6</i>	TOTAL SHEETS
--	-----------------------	--------------

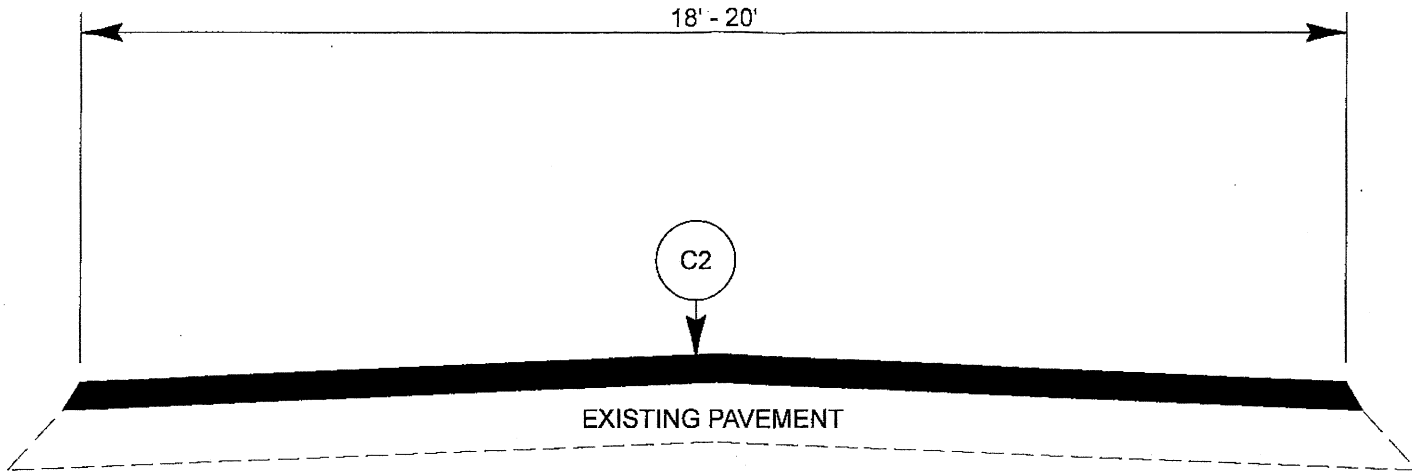

TYPICAL SECTION NO. 5

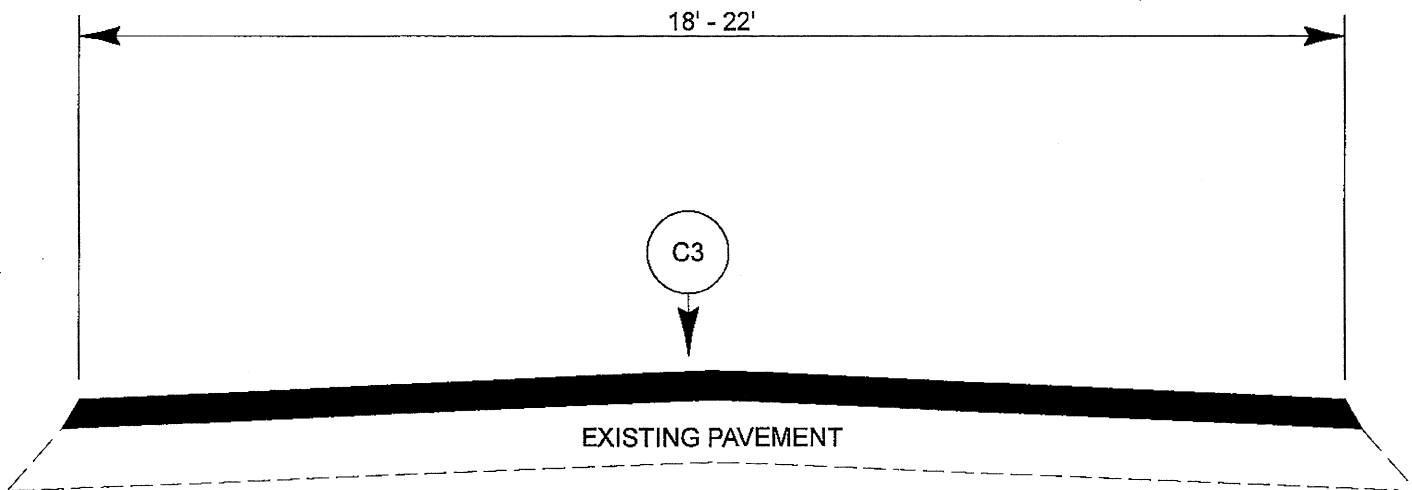

TYPICAL SECTION NO. 6

PAVEMENT SCHEDULE	
C1	PROP. APPROX. 1-1/2" ACSC, TYPE S9.5B, AT AN AVERAGE RATE OF 168 LBS. PER SQ. YD.
C2	PROP. APPROX. 1" ACSC, TYPE SF9.5A, AT AN AVERAGE RATE OF 110 LBS. PER SQ. YD.
C3	PROP. APPROX. 1-1/2" ACSC, TYPE SF9.5A, AT AN AVERAGE RATE OF 165 LBS. PER SQ. YD.
T1	SHOULDER RECONSTRUCTION
V1	MILLING ASPHALT PAVEMENT, 1-1/2" DEPTH
V2	MILLING ASPHALT PAVEMENT, 0 TO 1-1/2" DEPTH
V3	INCIDENTAL MILLING

PROJECT NO.	SHEET NO.	TOTAL SHEETS
13CR.10121.13, 13CR.20121.15	7	

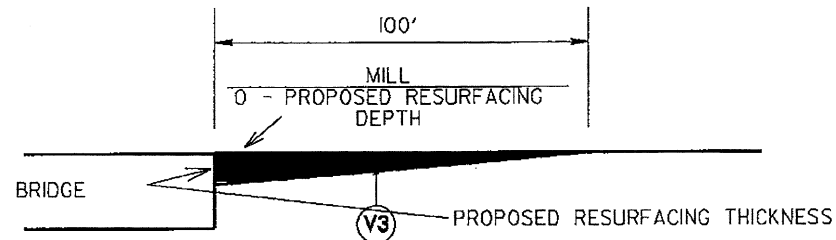

INCIDENTAL MILLING DETAIL AT BRIDGE APPROACHES
WHERE BRIDGES WILL NOT BE RESURFACED.
THIS WILL BE PAID FOR AS INCIDENTAL MILLING.

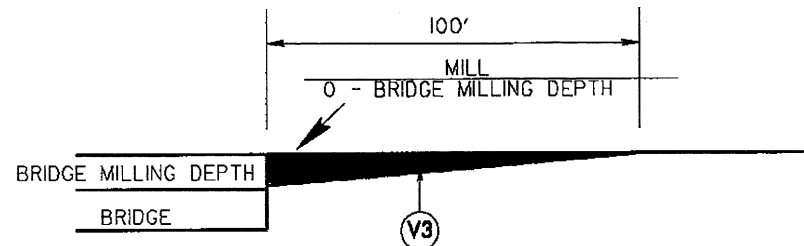

INCIDENTAL MILLING DETAIL AT BRIDGE APPROACHES
WHERE BRIDGES WILL BE MILLED THEN RESURFACED.
THIS WILL BE PAID FOR AS INCIDENTAL MILLING.

PAVEMENT SCHEDULE	
C1	PROP. APPROX. 1-1/2" ACSC, TYPE S9.5B, AT AN AVERAGE RATE OF 168 LBS. PER SQ. YD.
C2	PROP. APPROX. 1" ACSC, TYPE SF9.5A, AT AN AVERAGE RATE OF 110 LBS. PER SQ. YD.
C3	PROP. APPROX. 1-1/2" ACSC, TYPE SF9.5A, AT AN AVERAGE RATE OF 165 LBS. PER SQ. YD.
T1	SHOULDER RECONSTRUCTION
V1	MILLING ASPHALT PAVEMENT, 1-1/2" DEPTH
V2	MILLING ASPHALT PAVEMENT, 0 TO 1-1/2" DEPTH
V3	INCIDENTAL MILLING

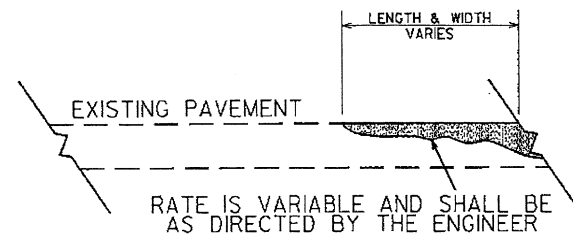
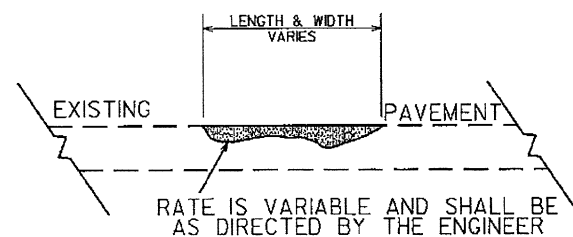

**DETAIL SHOWING
METHOD OF WEDGING**

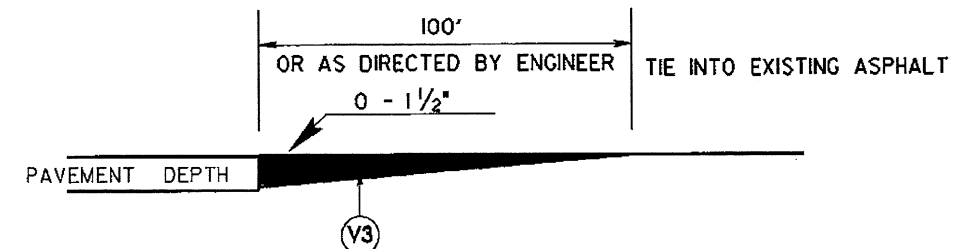

DETAIL TO TIE INTO EXIST PAVEMENT

THE CONTRACTOR'S ATTENTION IS DIRECTED TO THE FACT THAT HE WILL BE REQUIRED TO MILL THE EXISTING ASPHALT PAVEMENT TO ENSURE A PROPER TIE-IN WITH THE EXISTING SURFACE AT THE BEGINNING, END AND Y LINES OF EACH MAP TO BE RESURFACED WITH ASPHALT CONC SURFACE COURSE, TYPE S9.5B. THIS WILL BE PAID FOR AS INCIDENTAL MILLING.

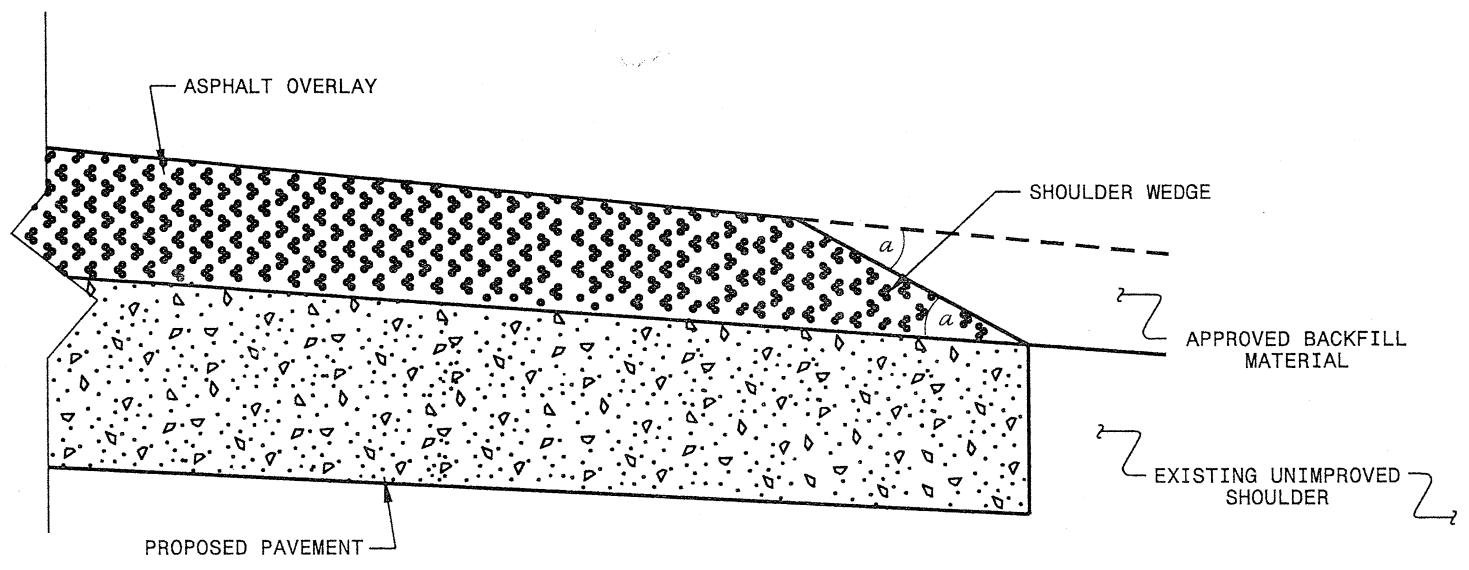

SHOULDER WEDGE DETAIL
 (Resurfacing Projects w/ Widening or
 with Existing Paved Shoulder > 2 ft.)

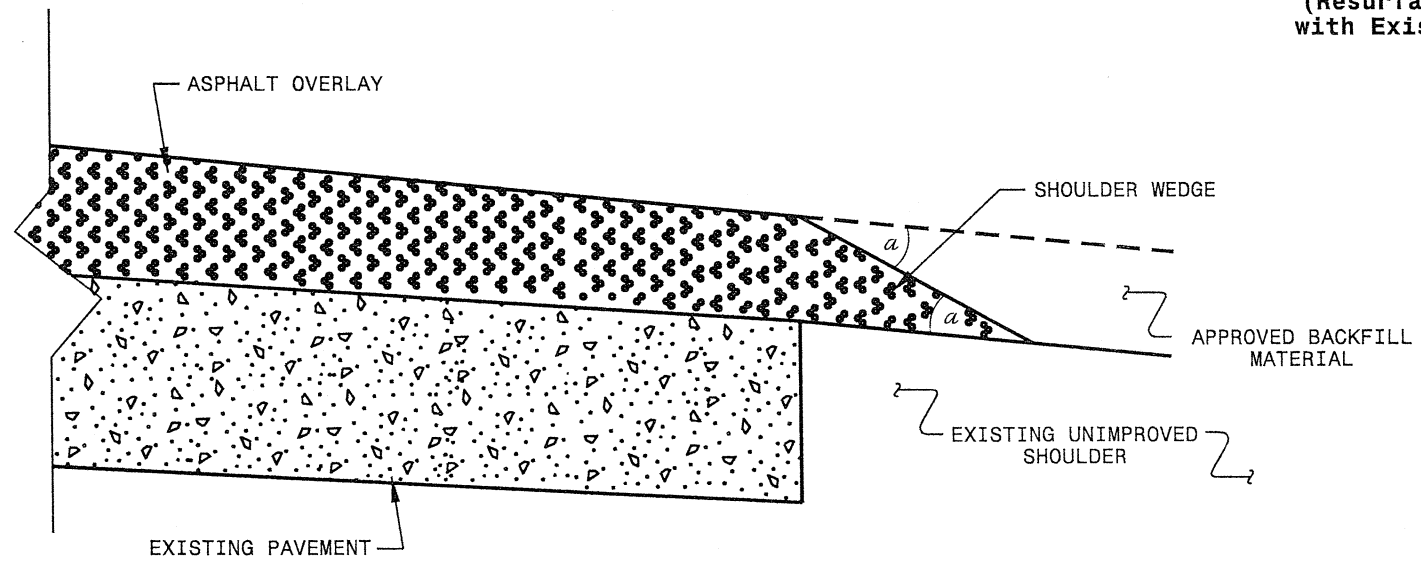

SHOULDER WEDGE DETAIL
 (Resurfacing Projects w/ NO Widening)

 SYSTEMS

- NOTES:
- 1) DETAIL DOES NOT APPLY TO OGAFC AND ULTRA-THIN BONDED WEARING COURSE.
 - 2) BACKFILL SHOULDER WITH APPROVED MATERIAL.
 - 3) THE SHOULDER WEDGE DEVICE MAY BE DISENGAGED AT PAVED DRIVEWAYS AND SIDE STREETS.

a - SHOULDER WEDGE ANGLE = 30°

CONTRACT STANDARDS AND DEVELOPMENT UNIT			
Office 919-707-6950		FAX 919-250-4119	
SHOULDER WEDGE DETAILS			
ORIGINAL BY: T.SPELL	DATE: 7-19-11		
MODIFIED BY:	DATE: 10/16/12		
CHECKED BY:	DATE:		
FILE SPEC.: s:\usr\details\stand\shoulderwedgedetail.dgn			

5/14/99
 14-SEP-2011 08:03
 J:\projects\Special Details\Howerton\Standard Drawings\2012 Curb Ramp Special Details\Curb Ramp Details.dgn
 J:\projects\Special Details\Howerton\Standard Drawings\2012 Curb Ramp Special Details\Curb Ramp Details.dgn
 J:\projects\Special Details\Howerton\Standard Drawings\2012 Curb Ramp Special Details\Curb Ramp Details.dgn

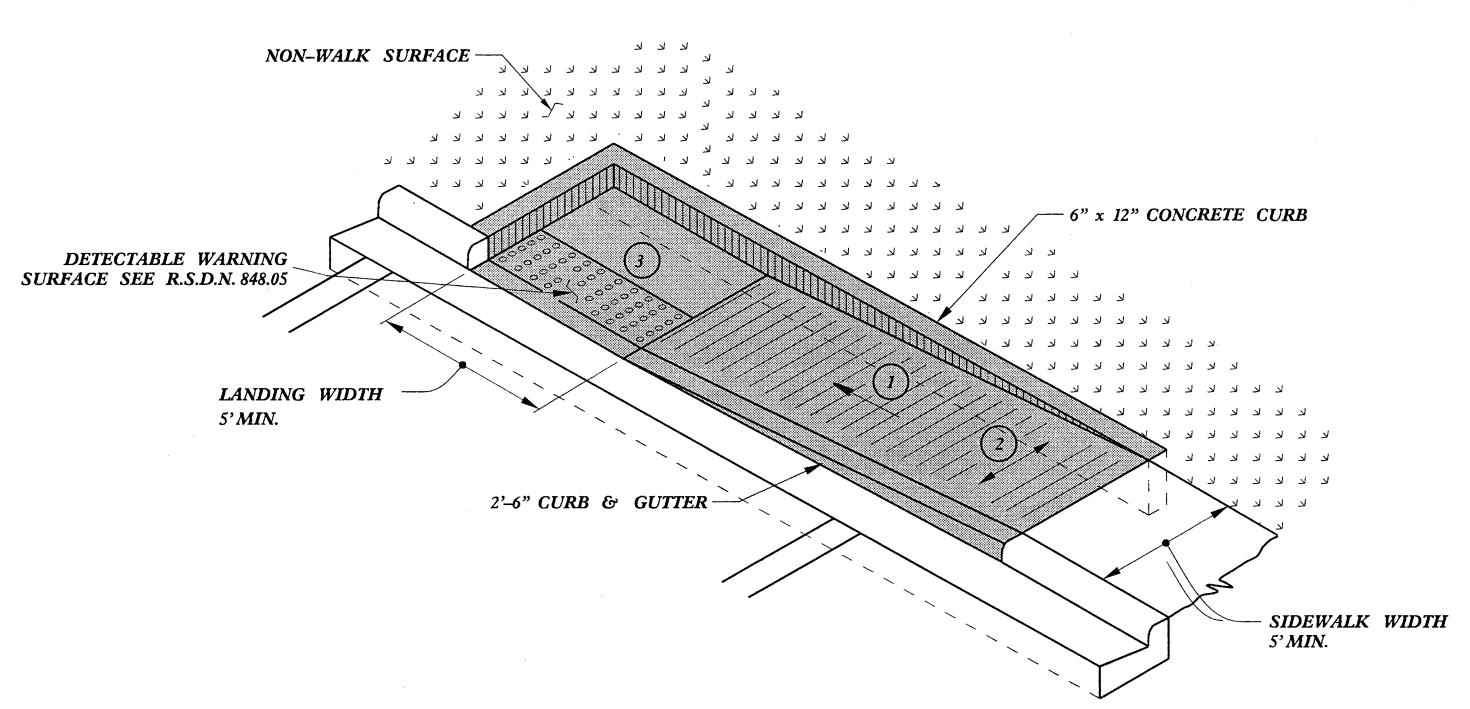

TYPE 1A

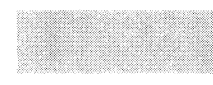
 PAY LIMITS FOR CURB RAMP

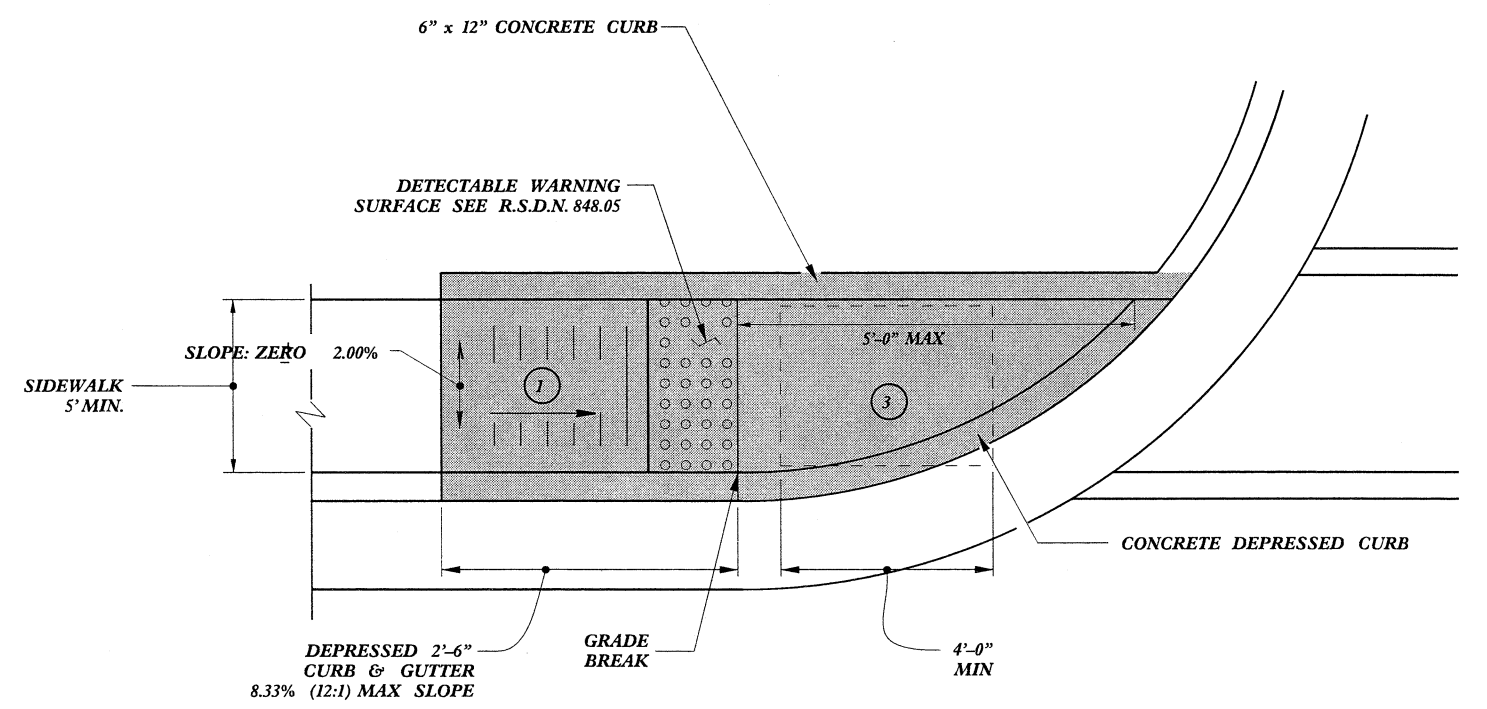

TYPE 1

- ① 8.33% (12:1) MAX RAMP SLOPE
- ② CROSS SLOPE: 2.00%
- ③ CURB RAMPS REQUIRE A (4'-0") MINIMUM LANDING WITH A MAXIMUM CROSS SLOPE AND LONGITUDINAL SLOPE OF 2.00% WHERE PEDESTRIANS PERFORM TURNING MANEUVERS. SLOPE TO DRAIN TO CURB.

REFER TO ROADWAY STANDARD DRAWING NUMBER 848.05 SHEET 3 OF 3 FOR ALL RAMP NOTES

CONTRACT STANDARDS AND DEVELOPMENT UNIT Office 919-707-6950 FAX 919-250-4119	
CURB RAMPS Directional Ramps	
ORIGINAL BY: J.S. HOWERTON	DATE: 7/7/11
MODIFIED BY: _____	DATE: _____
CHECKED BY: _____	DATE: _____
FILE SPEC: stds/2012CurbRamp/CurbRampDetails.dgn	

5/14/09
I:\SEP-2011\08-04\Special Details\Howerton\Standard Drawings\2012 Curb Ramp Special Details\Curb Ramp Details.dgn
J:\Projects\AT\250237501\Howerton

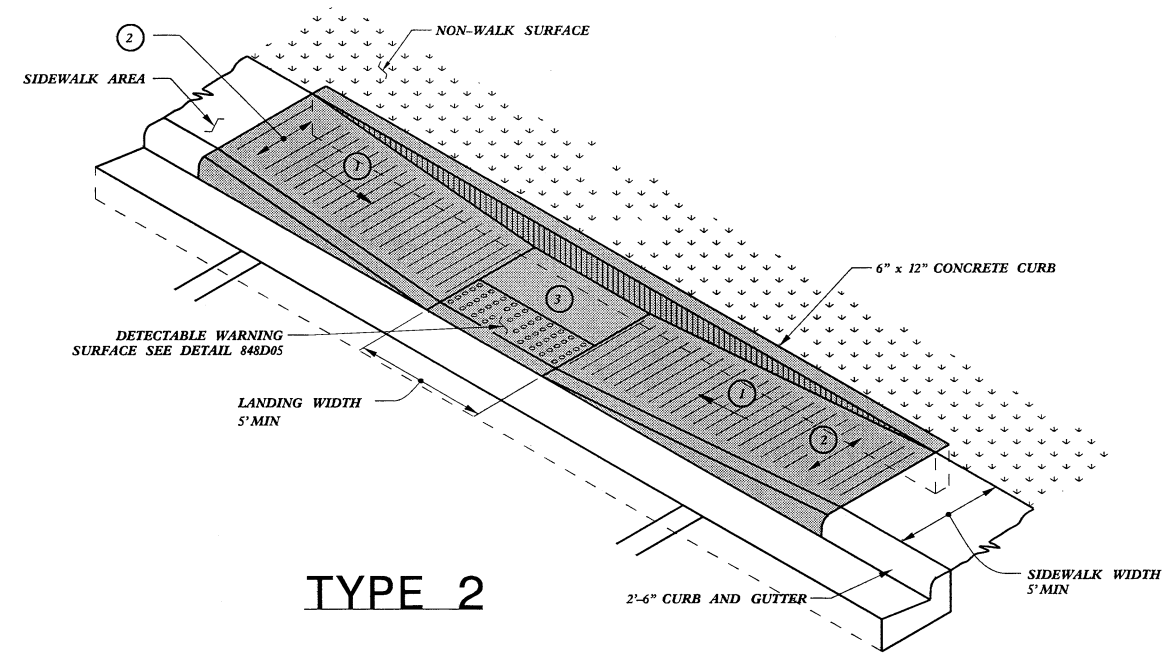

TYPE 2

PAY LIMITS FOR CURB RAMP

- ① 8.33% (12:1) MAX RAMP SLOPE
- ② CROSS SLOPE: 2.00%
- ③ CURB RAMPS REQUIRE A (4'-0") MINIMUM LANDING WITH A MAXIMUM CROSS SLOPE AND LONGITUDINAL SLOPE OF 2.00% WHERE PEDESTRIANS PERFORM TURNING MANEUVERS. SLOPE TO DRAIN TO CURB.

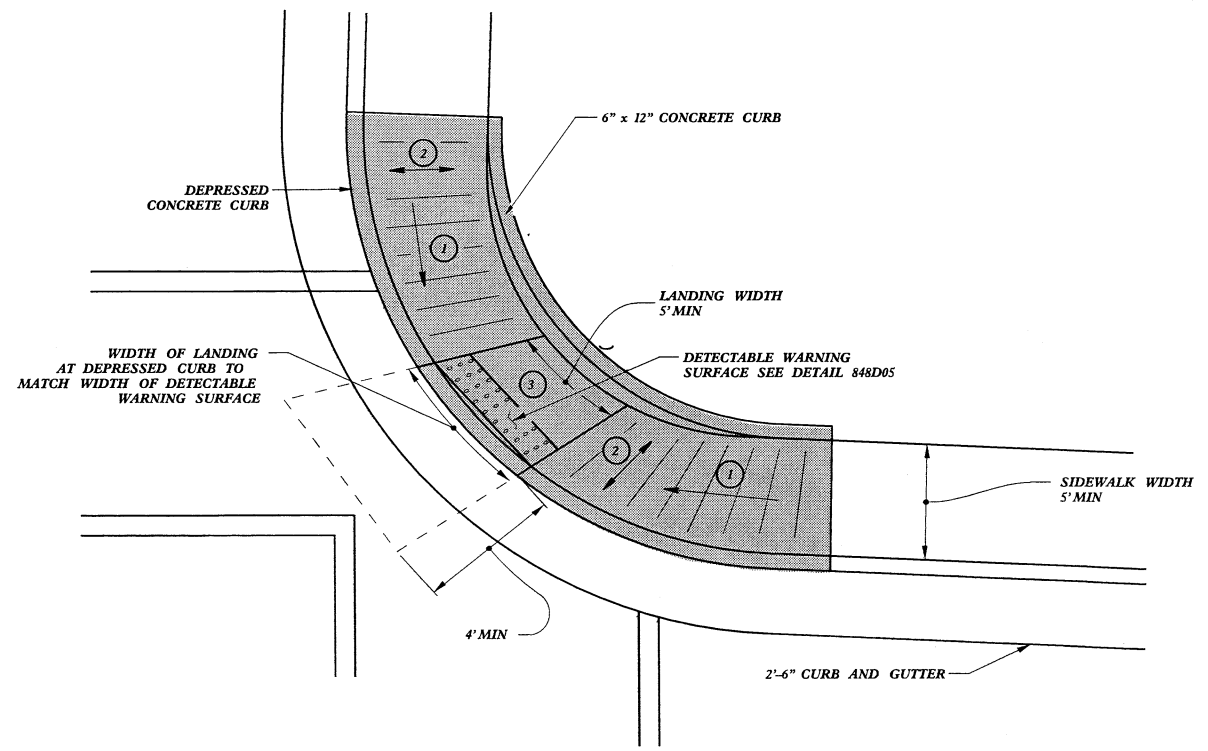

TYPE 2A

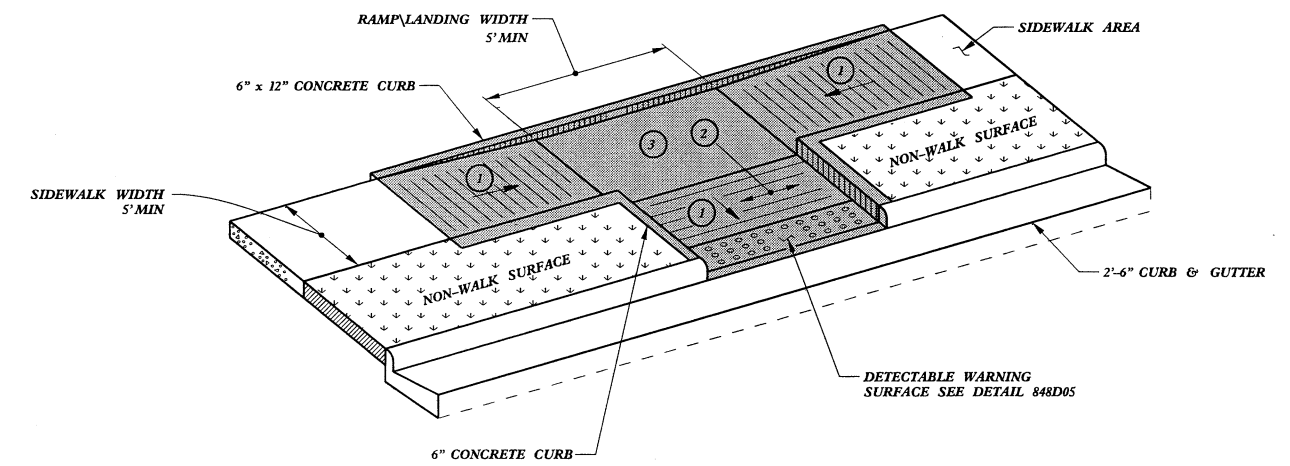

TYPE 3

REFER TO ROADWAY STANDARD DRAWING NUMBER 848.05 SHEET 3 OF 3 FOR ALL RAMP NOTES

CONTRACT STANDARDS AND DEVELOPMENT UNIT	
Office 919-707-6950 FAX 919-250-4119	
CURB RAMPS	
Parallel Ramps	
ORIGINAL BY: J.S. HOWERTON	DATE: 7/7/11
MODIFIED BY:	DATE:
CHECKED BY:	DATE:
FILE SPEC. stds/2012CurbRamp/CurbRampDetails.dgn	

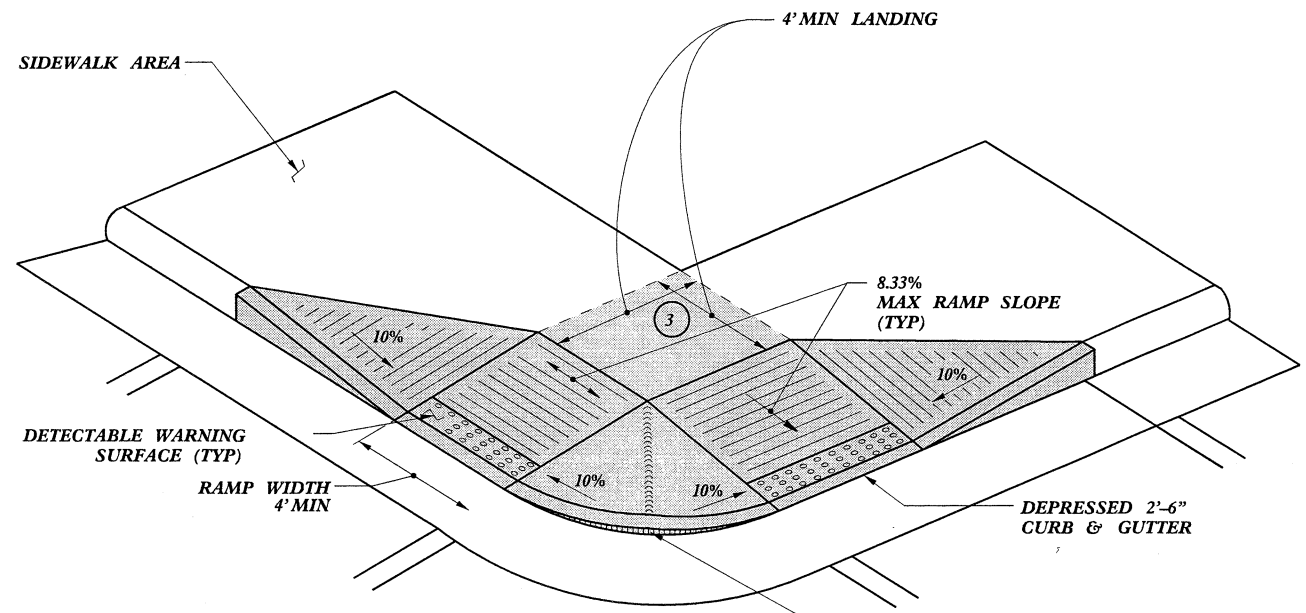

TYPE 4

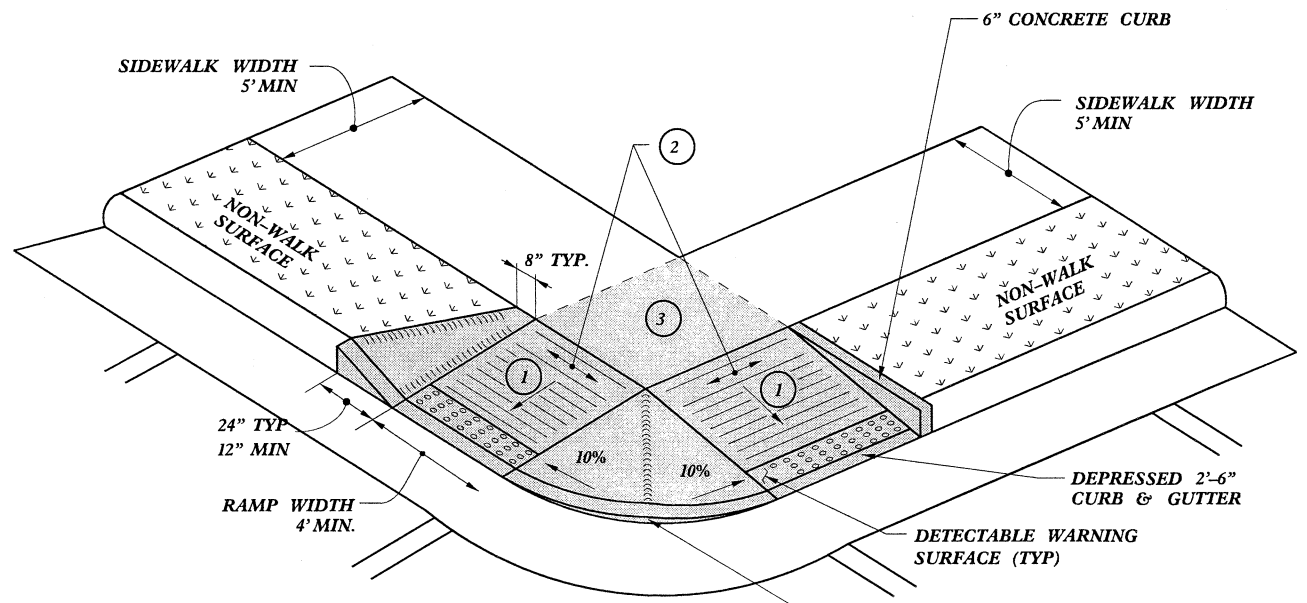

TYPE 4A

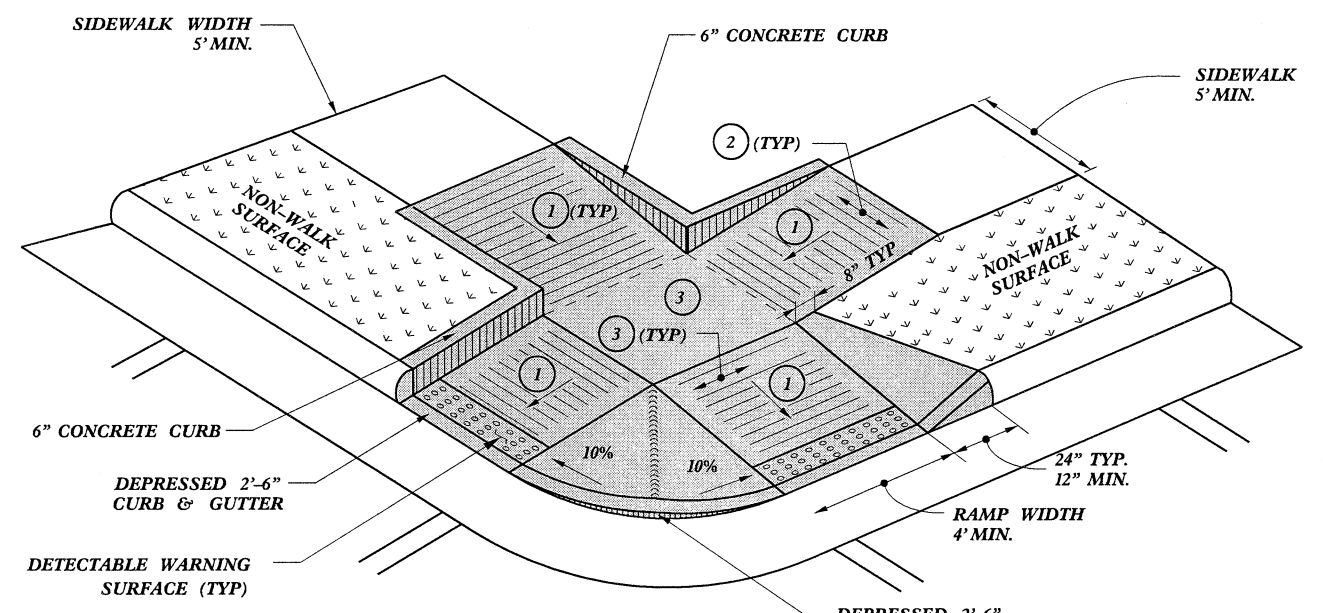

TYPE 5

PAY LIMITS FOR CURB RAMP

- ① 8.33% (12:1) MAX RAMP SLOPE
- ② CROSS SLOPE: 2.00%
- ③ CURB RAMPS REQUIRE A (4'-0") MINIMUM LANDING WITH A MAXIMUM CROSS SLOPE AND LONGITUDINAL SLOPE OF 2.00% WHERE PEDESTRIANS PERFORM TURNING MANEUVERS. SLOPE TO DRAIN TO CURB.

CONTRACT STANDARDS AND DEVELOPMENT UNIT	
Office 919-707-6950	FAX 919-250-4119
CURB RAMPS	
Shared Landing	
ORIGINAL BY: J.S. HOWERTON	DATE: 7/7/11
MODIFIED BY:	DATE:
CHECKED BY:	DATE:
FILE SPEC: stds/2012CurbRamp/CurbRampDetails.dgn	

REFER TO ROADWAY STANDARD DRAWING NUMBER 848.05 SHEET 3 OF 3 FOR ALL RAMP NOTES

16-SEP-2011 15:06
 S:\Contracts\AT\USD237581\Howerton\Standard Drawings\2012 Standard Drawings\2012 Curb Ramp Special Details\Curb Ramp Details.dgn
 JHowerton

5/14/99

04-AUG-2010 09:03
 3636 USER:RAMEE888
 C:\projects\Special Details\curb Ramp Details.dgn
 2012 Standard Drawings\2012 Curb Ramp Special Details\Curb Ramp Details.dgn
 5/14/99

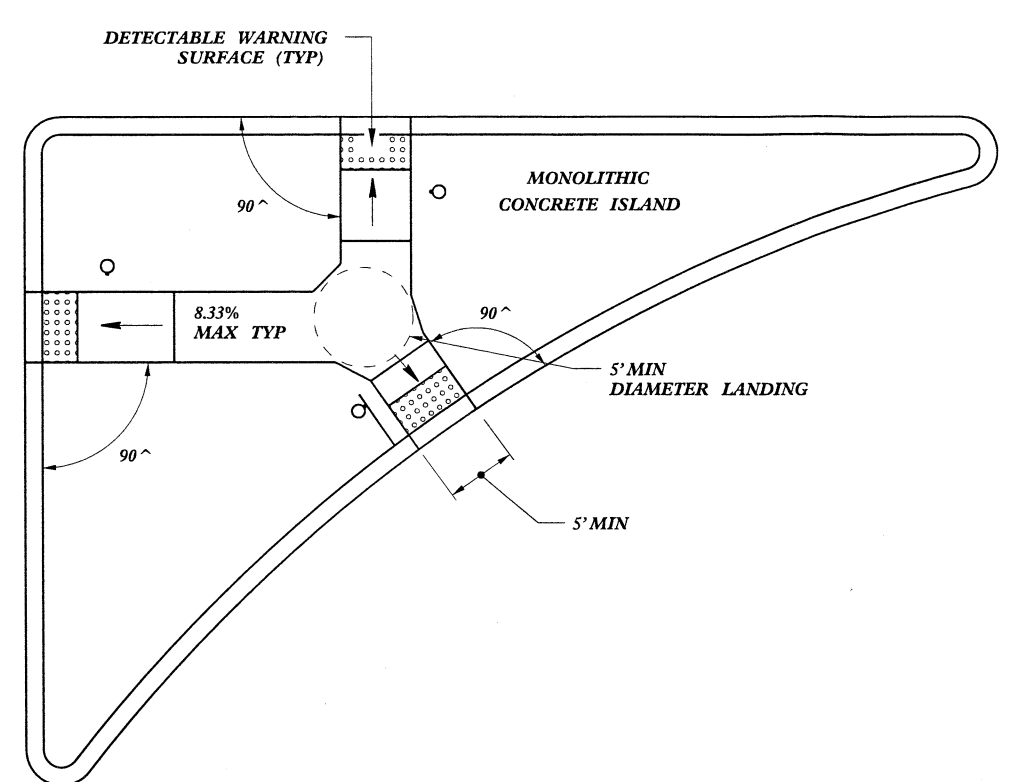

**LARGE ISLAND
CURB RAMPS**

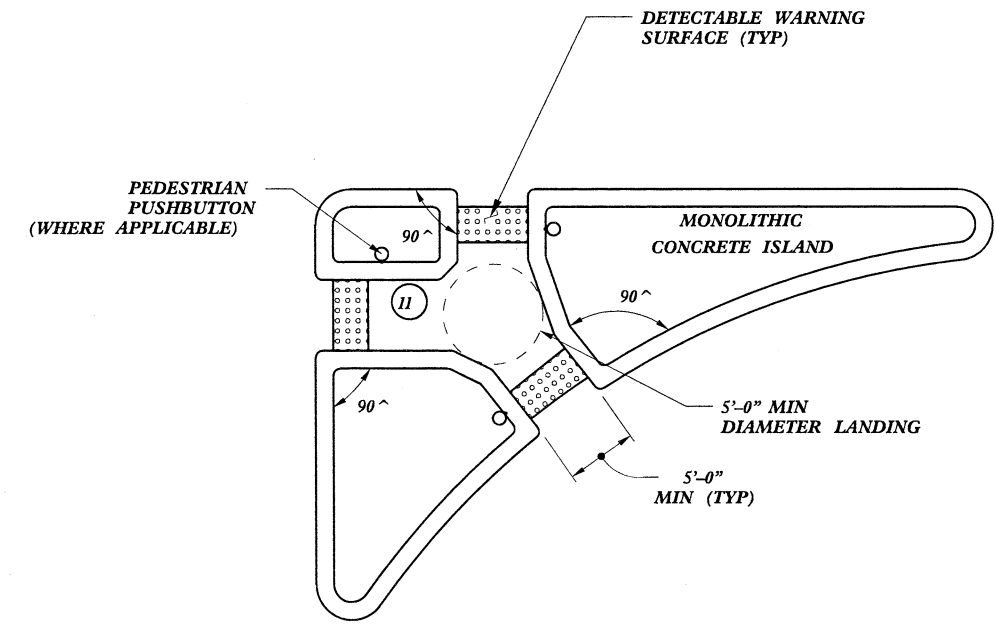

**SMALL ISLAND
WITH CUT THROUGH**

-SEE ROADWAY DETAIL DRAWING 848D05 FOR DETECTABLE WARNING SURFACE AND FOR RAMP NOTES.
 -SEE ROADWAY STANDARD DRAWING 852.01 FOR CONCRETE ISLAND DIMENSIONS.

CONTRACT STANDARDS AND DEVELOPMENT UNIT	
Office 919-707-6950 FAX 919-250-4119	
CURB RAMPS	
Median or Turn Lane Islands	
ORIGINAL BY: J.S. HOWERTON	DATE: 7/7/11
MODIFIED BY: _____	DATE: _____
CHECKED BY: _____	DATE: _____
FILE SPEC: sds/2012CurbRamp/CurbRampDetails.dgn	

PROJECT NO.	SHEET NO.	TOTAL NO.
13CR.10121.13, 13CR.20121.15	13	

SUMMARY OF QUANTITIES

PROJECT NO	COUNTY	MAP NO	ROUTE	DESCRIPTION	TYP NO	LANES	LANE TYPE	FINAL SURFACE TESTING REQUIRED	WARM MIX ASPHALT REQUIRED	LENGTH MI	WIDTH FT	INCIDENTAL STONE BASE TON	SHOULDER RECONSTRUCTION SMI	MILLING ASPHALT PAVEMENT, 1-1/2" DEPTH SY	MILLING ASPHALT PAVEMENT, 0" TO 1 1/2" DEPTH SY	INCIDENTAL MILLING SY	ASPHALT CONC SURFACE COURSE, TYPE S9.5B TON	ASPHALT CONC SURFACE COURSE, TYPE SF9.5A TON	ASPHALT BINDER FOR PLANT MIX TON	PATCHING EXISTING PAVEMENT TON	CONCRETE CURB RAMP EA	ADJUSTMENT OF MANHOLES EA	ADJUSTMENT OF METER BOXES OR VALVE BOXES EA	PORTABLE LIGHTING LS
13CR.10121.13	Burke	1	US 64 BUSINESS	FROM US 64 BUSINESS TO US 64 (MP 1.58 - MP 2.82)	1	3	M2 - Multi-lane two-way traffic	NO	NO	1.24	24 - 47			21,824			2,025		121	500	31	21	26	*
13CR.10121.13	Burke	2	NC 181	FROM NC 181 TO SR 1468 (MP 0.337 - MP 2.337)	2,3,4	5	M2 - Multi-lane two-way traffic	NO	NO	1.76	23 - 66	62	2.45		11,194	3,577	4,878		293	700	19	17	22	
13CR.10121.13	Burke	3	NC 181	FROM SR 1468 TO SR 1414 (MP 2.337 - MP 3.741)	3	2	2WU - Two-lane two-way undivided traffic	NO	NO	1.4	23	70	2.80			3,100	1,755		105	100		1	10	
TOTAL FOR PROJ NO. 13CR.10121.13											4.4	132	5.25	21,824	11,194	6,677	8,658		519	1,300	50	39	58	1
13CR.20121.15	Burke	4	SR 1253	FROM NC 181 TO END PAVEMENT (MP 0.00 - MP 0.30)	5	2	2WU	NO	NO	0.3	18							193	13	50				
13CR.20121.15	Burke	5	SR 1265	FROM SR 1264 TO E.O.M. (MP 0.00 - MP 0.81)	5	2	2WU	NO	NO	0.81	18							520	35	700				
13CR.20121.15	Burke	6	SR 1267	FROM E.O.P. TO NC 183 (MP 0.66 - MP 1.75)	6	2	2WU	NO	NO	1.09	18	55						1,052	70	1,000				
13CR.20121.15	Burke	7	SR 1413	FROM NC 181 TO E.O.M. (MP 0.00 - MP 0.54)	5	2	2WU	NO	NO	0.54	20							385	26	200				
13CR.20121.15	Burke	8	SR 1440	FROM SR 1423 TO SR 1419 (MP 0.00 - MP 0.90)	6	2	2WU	NO	NO	0.9	18	45				400		868	58	150				
13CR.20121.15	Burke	9	SR 1461	FROM SR 1440 TO SR 1467 (MP 0.00 - MP 0.94)	6	2	2WU	NO	NO	0.94	22	47						1,107	74	150				
13CR.20121.15	Burke	10	SR 1462	FROM SR 1461 TO SR 1467 (MP 0.00 - MP 0.29)	6	2	2WU	NO	NO	0.29	22	14						342	23	50				
13CR.20121.15	Burke	11	SR 1463	FROM SR 1461 TO SR 1467 (MP 0.00 - MP 0.11)	6	2	2WU	NO	NO	0.11	20	6						118	8	50				
13CR.20121.15	Burke	12	SR 1467	FROM SR 1461 TO SR 1461 (MP 0.00 - MP 0.20)	6	2	2WU	NO	NO	0.2	22	10						236	16	25				
13CR.20121.15	Burke	13	SR 1471	FROM NC 181 TO AVERY COUNTY (MP 0.00 - MP 0.51)	6	2	2WU	NO	NO	0.51	18	26						492	33	400				
13CR.20121.15	Burke	14	SR 1799	FROM SR 1800 TO E.O.M. (MP 0.00 - MP 1.239)	6	2	2WU	NO	NO	1.24	18	62						1,197	80	750				
13CR.20121.15	Burke	15	SR 1892	FROM NC 18 TO E.O.M. (MP 0.00 - MP 0.23)	6	2	2WU	NO	NO	0.23	18	12						222	15	100				
13CR.20121.15	Burke	16	SR 1910	FROM SR 1907 TO CLEVELAND COUNTY (MP 0.00 - MP 2.80)	6	2	2WU	NO	NO	2.8	18	140						2,702	181	1,000				
TOTAL FOR PROJ NO. 13CR.20121.15											9.96	417	5.25	21,824	11,194	7,077	8,658	9,434	1,151	5,925	50	39	58	1
GRAND TOTAL											14.36	549	5.25	21,824	11,194	7,077	8,658	9,434	1,151	5,925	50	39	58	1

PROJECT NO.	SHEET NO.	TOTAL NO.
13CR.10121.13, 13CR.20121.15	14	

THERMOPLASTIC AND PAINT QUANTITIES

PROJECT NO	COUNTY	MAP NO	ROUTE	DESCRIPTION	TYP	LANES	LANE TYPE	LENGTH	WIDTH	4413000000-E	4457000000-N	4695000000-E	4697000000-E	4710000000-E	4721000000-E	4725000000-E				4810000000-E		4820000000-E	4835000000-E	4845000000-N		4847000000-E		4847110000-E	4905000000-N	
										WORK ZONE ADVANCE/GENERAL WARNING SIGNING	TEMPORARY TRAFFIC CONTROL	THERMOPLASTIC PAVEMENT MARKING LINES (8", 90 MILS) YELLOW	THERMOPLASTIC PAVEMENT MARKING LINES (8", 120 MILS) WHITE	THERMOPLASTIC PAVEMENT MARKING LINES (24", 120 MILS) WHITE	THERMOPLASTIC PAVEMENT MARKING CHARACTER (120 MILS) ONLY	THERMOPLASTIC PAVEMENT MARKING SYMBOL (90 MILS) LT ARROW	THERMOPLASTIC PAVEMENT MARKING SYMBOL (90 MILS) MERGE ARROW	THERMOPLASTIC PAVEMENT MARKING SYMBOL (90 MILS) RT ARROW	THERMOPLASTIC PAVEMENT MARKING SYMBOL (90 MILS) STR ARROW	THERMOPLASTIC PAVEMENT MARKING SYMBOL (90 MILS) STR & LT	PAINT PAVEMENT MARKING LINES (4") WHITE	PAINT PAVEMENT MARKING LINES (4") YELLOW	8" WHITE PAINT	PAINT PAVEMENT MARKING LINES (24") WHITE	PAINT LT ARROW	PAINT MERGE ARROW	POLYUREA PAVEMENT MARKING LINES (4") WHITE (HIGHLY REFLECTIVE ELEMENTS)	POLYUREA PAVEMENT MARKING LINES (4") YELLOW (HIGHLY REFLECTIVE ELEMENTS)	POLYUREA PAVEMENT MARKING LINES (8") WHITE (HIGHLY REFLECTIVE ELEMENTS)	SNOWPLOWABLE PAVEMENT MARKERS
NO		NO			NO					SF	LS	LF	LF	LF	EA	EA	EA	EA	EA	EA	EA	EA	EA	EA	EA	EA	EA	EA	EA	EA
13CR.10121.13	Burke	1	US 64 BUSINESS	FROM US 64 BUSINESS TO US 64 (MP 1.58 - MP 2.82)	1	3	M2 - Multi-lane two-way traffic	1.24	24 - 47				75	36			25	4			450	14,731	375	36	10	1	450	14,731	300	164
13CR.10121.13	Burke	2	NC 181	FROM NC 181 TO SR 1468 (MP 0.337 - MP 2.337)	2,3,4	5	M2 - Multi-lane two-way traffic	1.76	23 - 66	283	*	400		450	4		33		4	3							22,374	21,120	2,000	320
13CR.10121.13	Burke	3	NC 181	FROM SR 1468 TO SR 1414 (MP 2.337 - MP 3.741)	3	2	2WU - Two-lane two-way undivided traffic	1.4	23																					93
TOTAL FOR PROJ NO. 13CR.10121.13								4.4		283	1	400	75	486	4	58	4	4	3	2	450	14,731	375	36	10	1	14,784	50,635	2,300	577
																71					15,181			11		88,243				
13CR.20121.15	Burke	4	SR 1253	FROM NC 181 TO END PAVEMENT (MP 0.00 - MP 0.30)	5	2	2WU	0.3	18																					
13CR.20121.15	Burke	5	SR 1265	FROM SR 1264 TO E.O.M. (MP 0.00 - MP 0.81)	5	2	2WU	0.81	18												17,107	17,107								
13CR.20121.15	Burke	6	SR 1267	FROM E.O.P. TO NC 183 (MP 0.66 - MP 1.75)	6	2	2WU	1.09	18												23,021	23,021								
13CR.20121.15	Burke	7	SR 1413	FROM NC 181 TO E.O.M. (MP 0.00 - MP 0.54)	5	2	2WU	0.54	20																					
13CR.20121.15	Burke	8	SR 1440	FROM SR 1423 TO SR 1419 (MP 0.00 - MP 0.90)	6	2	2WU	0.9	18												19,008	19,008								
13CR.20121.15	Burke	9	SR 1461	FROM SR 1440 TO SR 1467 (MP 0.00 - MP 0.94)	6	2	2WU	0.94	22																					
13CR.20121.15	Burke	10	SR 1462	FROM SR 1461 TO SR 1467 (MP 0.00 - MP 0.29)	6	2	2WU	0.29	22	1,116	*																			
13CR.20121.15	Burke	11	SR 1463	FROM SR 1461 TO SR 1467 (MP 0.00 - MP 0.11)	6	2	2WU	0.11	20																					
13CR.20121.15	Burke	12	SR 1467	FROM SR 1461 TO SR 1461 (MP 0.00 - MP 0.20)	6	2	2WU	0.2	22																	16				
13CR.20121.15	Burke	13	SR 1471	FROM NC 181 TO AVERY COUNTY (MP 0.00 - MP 0.51)	6	2	2WU	0.51	18												10,771	10,771								
13CR.20121.15	Burke	14	SR 1799	FROM SR 1800 TO E.O.M. (MP 0.00 - MP 1.239)	6	2	2WU	1.24	18												26,189	26,189								
13CR.20121.15	Burke	15	SR 1892	FROM NC 18 TO E.O.M. (MP 0.00 - MP 0.23)	6	2	2WU	0.23	18																					
13CR.20121.15	Burke	16	SR 1910	FROM SR 1907 TO CLEVELAND COUNTY (MP 0.00 - MP 2.80)	6	2	2WU	2.8	18												59,136	59,136								
TOTAL FOR PROJ NO. 13CR.20121.15								9.96		1,116	1										155,232	155,232			16					
GRAND TOTAL								14.36		1,399	1	400	75	486	4	58	4	4	3	2	155,682	169,963	375	52	10	1	37,608	50,635	2,300	577
																71					325,645			11		88,243				