

STATE OF NORTH CAROLINA
DEPARTMENT OF TRANSPORTATION

PAVEMENT MARKING PLAN
NASH COUNTY

LOCATION: SR-1616 (COUNTRY CLUB ROAD) FROM US 64 BUSINESS
(BUCK LEONARD BLVD) TO SR-1541 (JEFFREYS ROAD)

TIP NO. U-3331	SHEET NO. PMP-1
APPROVED: <i>Ayman Alqudwah</i>	
DATE: 2-11-14	
SEAL	

T.I.P.: U-3331

U-3331 FINAL PAVEMENT MARKING SCHEDULE

SYMBOL	DESCRIPTION
	(FINAL PAVEMENT MARKINGS)
	THERMOPLASTIC (24", 120 MILS)
T2	WHITE STOPBAR THERMOPLASTIC (4", 120 MILS)
T3	2 FT.-6 FT./SP WHITE MINISKIP
TC	10 FT. WHITE SKIP
TD	3 FT.-9 FT./SP WHITE MINISKIP
TE	WHITE SOLID LANE LINE
TF	10 FT. YELLOW SKIP
TH	YELLOW SINGLE CENTER
TI	YELLOW DOUBLE CENTER THERMOPLASTIC (8", 120 MILS)
TR	WHITE SOLID LANE LINE
T13	3 FT.-9 FT./SP WHITE MINISKIP THERMOPLASTIC (8", 90 MILS)
TN	THERMOPLASTIC WHITE GORELINE
TO	THERMOPLASTIC WHITE DIAGONAL
TP	THERMOPLASTIC YELLOW DIAGONAL
TQ	THERMOPLASTIC WHITE CROSSWALK LINE THERMOPLASTIC (4", 90 MILS)
TA	WHITE EDGELINE
TB	YELLOW EDGELINE COLD APPLIED PLASTIC (TYPE-II)
CA	COLD APPLIED PLASTIC WHITE EDGELINE (4")
CC	COLD APPLIED PLASTIC 10 FT WHITE SKIP (4")
CI	COLD APPLIED PLASTIC YELLOW DOUBLE CENTER (4")
CP	COLD APPLIED PLASTIC YELLOW DIAGONAL (8") THERMOPLASTIC PAVEMENT MARKING SYMBOLS (90 MILS)
UA	LEFT TURN ARROW
UB	RIGHT TURN ARROW
UC	STRAIGHT ARROW
UE	COMBO STRAIGHT/RIGHT ARROW
UF	COMBO LEFT/RIGHT ARROW
UG	COMBO LEFT/RIGHT/STRAIGHT ARROW
UN	24" YIELD LINE TRIANGLE THERMOPLASTIC PAVEMENT MARKING CHARACTER (120 MILS)
UI	ALPHANUMERIC CHAR.
	(MARKERS)
	NONE

ROADWAY STANDARD DRAWING

THE FOLLOWING ROADWAY STANDARDS AS APPEAR IN "ROADWAY STANDARD DRAWINGS" - PROJECT SERVICES UNIT - N.C. DEPARTMENT OF TRANSPORTATION - RALEIGH, N.C., DATED JANUARY 2012 ARE APPLICABLE TO THIS PROJECT AND BY REFERENCE HEREBY ARE CONSIDERED A PART OF THESE PLANS:

STD. NO.	TITLE
1205.01	PAVEMENT MARKINGS - LINE TYPES AND OFFSETS
1205.02	PAVEMENT MARKINGS - 2 LANE AND MULTILANE ROADWAYS
1205.04	PAVEMENT MARKINGS - INTERSECTIONS
1205.05	PAVEMENT MARKINGS - TURN LANES
1205.06	PAVEMENT MARKINGS - LANE DROPS
1205.07	PAVEMENT MARKINGS - PEDESTRIAN CROSSINGS
1205.08	PAVEMENT MARKINGS - SYMBOL AND WORD MESSAGES
1205.09	PAVEMENT MARKINGS - PAINTED ISLANDS
1205.12	PAVEMENT MARKINGS - BRIDGES
1250.01	PAVEMENT MARKER SPACING
1251.01	RAISED PAVEMENT MARKERS
1261.01	GUARDRAIL AND BARRIER DELINEATOR SPACING
1261.02	GUARDRAIL AND BARRIER DELINEATOR TYPES
1262.01	GUARDRAIL END DELINEATION

GENERAL NOTES

THE FOLLOWING GENERAL NOTES APPLY AT ALL TIMES FOR THE DURATION OF THE CONSTRUCTION PROJECT, EXCEPT WHEN OTHERWISE NOTED IN THE PLAN, OR DIRECTED BY THE ENGINEER.

- A) INSTALL PAVEMENT MARKINGS AND PAVEMENT MARKERS ON THE FINAL SURFACE AS FOLLOWS:

ROAD NAME	MARKING	MARKER
-L- COUNTRY CLUB ROAD	THERMOPLASTIC	NONE
-L- BRIDGE DECK	COLD APPLIED PLASTIC (TYPE-II OR III)	NONE

- B) TIE PROPOSED PAVEMENT MARKING LINES TO EXISTING PAVEMENT MARKING LINES.
C) REMOVE/REPLACE ANY CONFLICTING/DAMAGED PAVEMENT MARKINGS AND MARKERS.
D) PASSING ZONES WILL BE DETERMINED IN THE FIELD AND MUST BE APPROVED BY THE ENGINEER.
E) STOP BAR LOCATION AT NON-SIGNALIZED INTERSECTIONS MAY BE ADJUSTED AS DIRECTED BY THE ENGINEER.
F) REMOVE ALL RESIDUE AND SURFACE LAITANCE BY ACCEPTABLE METHODS ON CONCRETE BRIDGE DECKS PRIOR TO PLACING (COLD APPLIED PLASTIC) PAVEMENT MARKING MATERIAL.
G) UNLESS OTHERWISE SPECIFIED, HEATED-IN-PLACE THERMOPLASTIC MAY BE USED IN LIEU OF EXTRUDED THERMOPLASTIC FOR STOP BARS, SYMBOLS, CHARACTERS AND DIAGONALS. IF HEATED-IN-PLACE IS USED, IT SHALL BE PAID FOR USING THE EXTRUDED THERMOPLASTIC PAY ITEM.
H) TYPE III COLD APPLIED PLASTIC MAY BE USED IN LIEU OF TYPE II COLD APPLIED PLASTIC. IF TYPE III COLD APPLIED PLASTIC IS USED, IT SHALL BE PAID FOR USING THE TYPE II COLD APPLIED PLASTIC PAY ITEM.
I) SEE ROADWAY PLANS FOR ALTERNATE CURB RAMP DESIGNS WHEN INDICATED ON PAVEMENT MARKING DETAIL SHEETS.

INDEX

SHEET NO.	DESCRIPTION
PMP-1	PAVEMENT MARKING PLAN TITLE AND SCHEDULE SHEET
PMP-2-6	PAVEMENT MARKING DETAIL

PLAN PREPARED BY: N.C.D.O.T. SIGNING AND DELINEATION UNIT

AYMAN ALQUDWAH, PE, CPM SIGNING & DELINEATION REGIONAL ENGINEER
BASIR A. RASHID SIGNING & DELINEATION PROJECT DESIGN ENGINEER

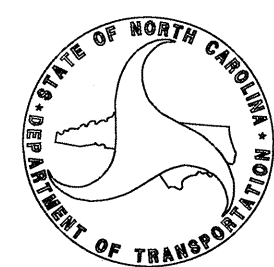

CONTRACT:

TIP NO. U-3331	SHEET NO. PMP-2
APPROVED: <i>[Signature]</i>	
DATE: 2-11-14	
SEAL	

BEGIN MARKINGS PROJECT U-3331
-L- STA. 12+90.00
TIE TO EXISTING MARKINGS

-Y1- POT 10+00.00
BEGIN CONST
TIE TO EXISTING MARKINGS

-Y2- POT 11+07.34
END CONST

PAVEMENT MARKING DETAIL

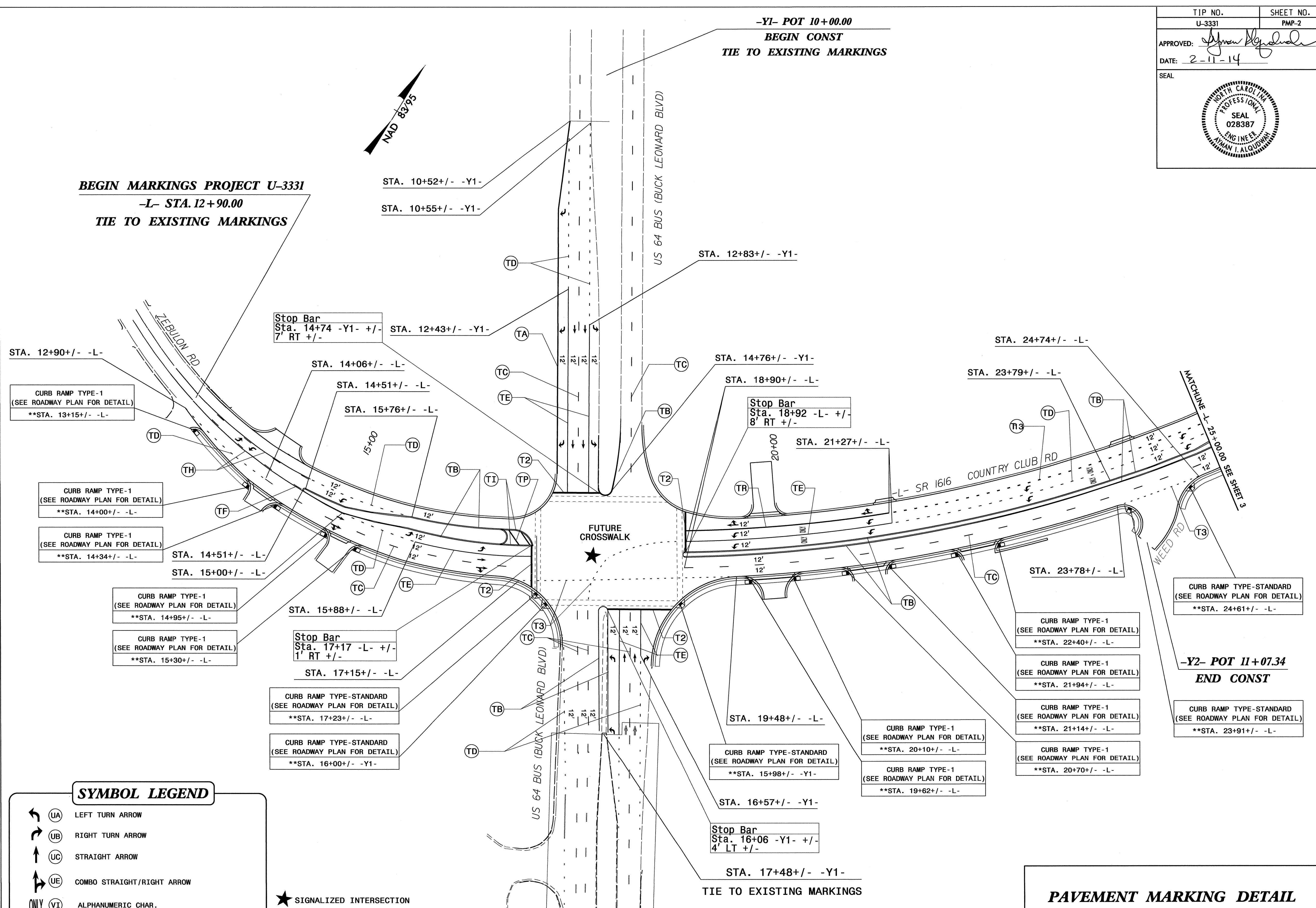

SYMBOL LEGEND

	UA	LEFT TURN ARROW
	UB	RIGHT TURN ARROW
	UC	STRAIGHT ARROW
	UE	COMBO STRAIGHT/RIGHT ARROW
	VI	ALPHANUMERIC CHAR.

ONLY

★ SIGNALIZED INTERSECTION
 ** CENTER OF CURB RAMP

06-FEB-2014 09:53
 P:\TIP\Projects\U-3331\Traffic\Signing\CADD\PMU-U-3331_Sgn_PMP_Sheet-2.dgn
 brashnd - AT 12/24/12

TIP NO. U-3331	SHEET NO. PMP-3
APPROVED: <i>[Signature]</i>	
DATE: 2-11-14	
SEAL	

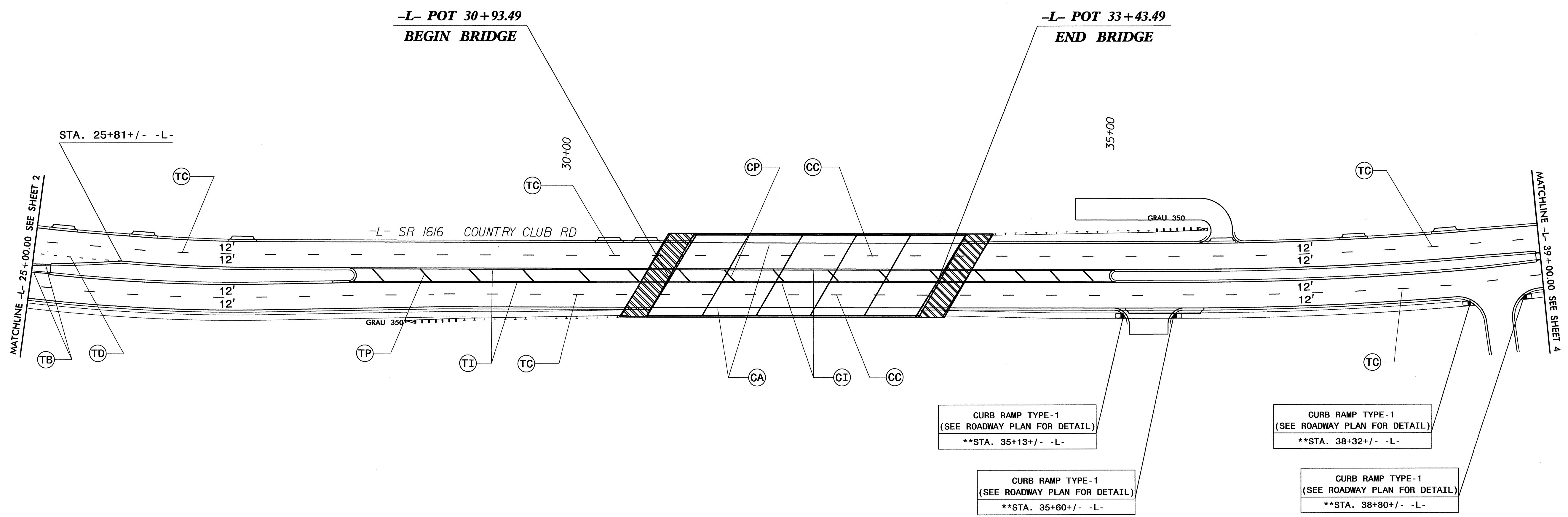
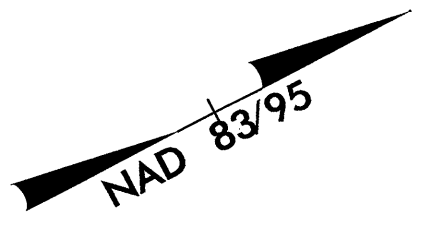

CURB RAMP TYPE-1
(SEE ROADWAY PLAN FOR DETAIL)
**STA. 35+13+/- -L-

CURB RAMP TYPE-1
(SEE ROADWAY PLAN FOR DETAIL)
**STA. 38+32+/- -L-

CURB RAMP TYPE-1
(SEE ROADWAY PLAN FOR DETAIL)
**STA. 35+60+/- -L-

CURB RAMP TYPE-1
(SEE ROADWAY PLAN FOR DETAIL)
**STA. 38+80+/- -L-

** CENTER OF CURB RAMP

PAVEMENT MARKING DETAIL

06-FEB-2014 12:21
 P:\TIP\Projects\U-3331\Traffic\Signing\CADD\PMU-U-3331_Sgn_PMP_Sheet-3.dgn
 P:\TIP\Projects\U-3331\Traffic\Signing\CADD\PMU-U-3331_Sgn_PMP_Sheet-3.dgn
 P:\TIP\Projects\U-3331\Traffic\Signing\CADD\PMU-U-3331_Sgn_PMP_Sheet-3.dgn
 P:\TIP\Projects\U-3331\Traffic\Signing\CADD\PMU-U-3331_Sgn_PMP_Sheet-3.dgn

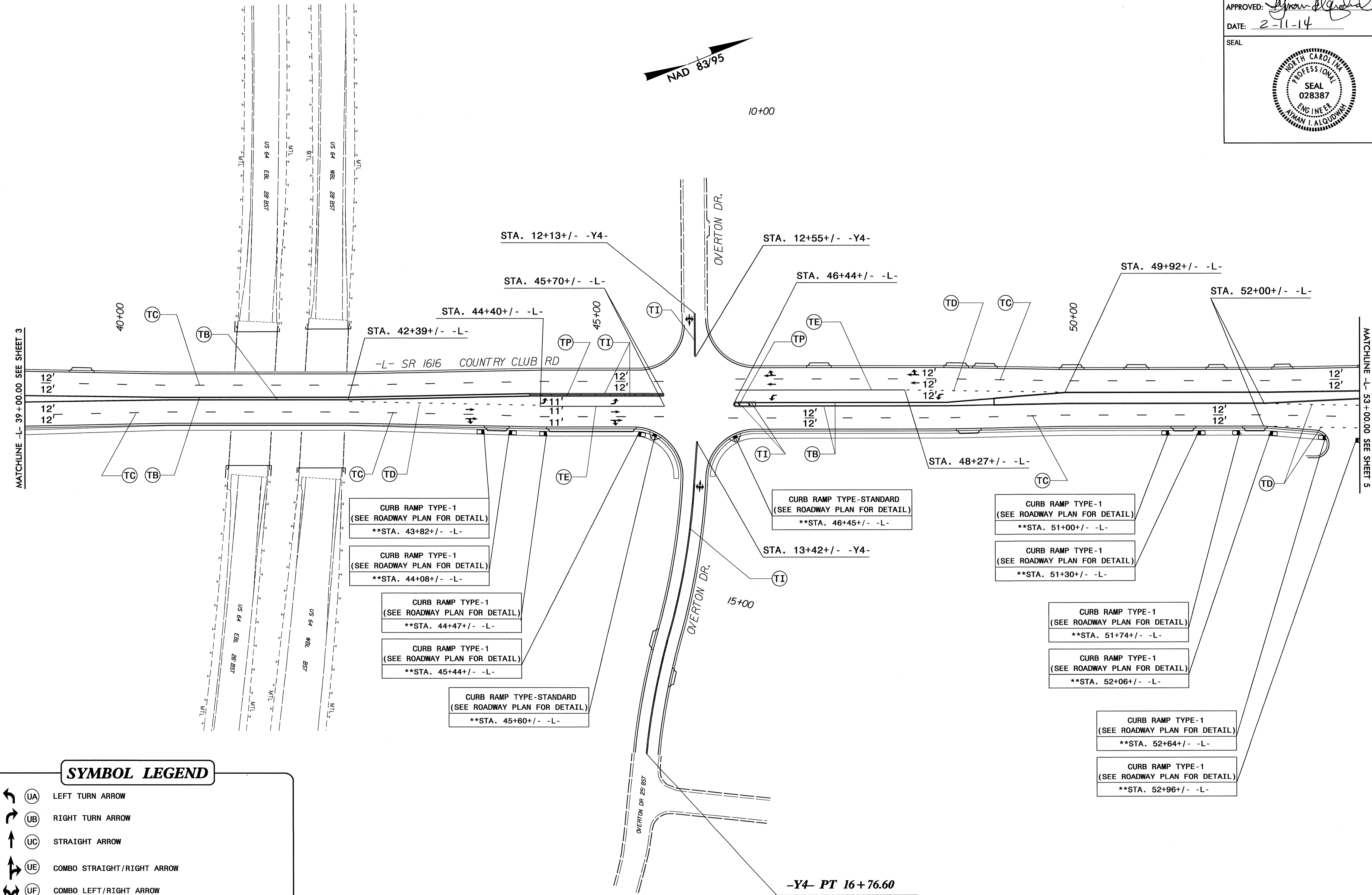

SYMBOL LEGEND

- (UA) LEFT TURN ARROW
- (UB) RIGHT TURN ARROW
- (UC) STRAIGHT ARROW
- (UE) COMBO STRAIGHT/RIGHT ARROW
- (UF) COMBO LEFT/RIGHT ARROW
- (UG) COMBO LEFT/RIGHT/STRAIGHT ARROW

** CENTER OF CURB RAMP

-Y4- PT 16+76.60
END CONST
TIE TO EXISTING

PAVEMENT MARKING DETAIL

06-FEB-2014 10:55
 P:\TIP\Projects\U-3331\Traffic\Signing\CADD\PMU-U-3331.Sgn_PMP_Sheet-4.dgn
 P:\TIP\Projects\U-3331\Traffic\Signing\CADD\PMU-U-3331.dwg
 P:\TIP\Projects\U-3331\Traffic\Signing\CADD\PMU-U-3331.dwg
 P:\TIP\Projects\U-3331\Traffic\Signing\CADD\PMU-U-3331.dwg

SYMBOL LEGEND

- UA LEFT TURN ARROW
- UB RIGHT TURN ARROW
- UC STRAIGHT ARROW
- UE COMBO STRAIGHT/RIGHT ARROW

TIP NO. U-3331	SHEET NO. PMP-5
APPROVED: <i>[Signature]</i>	
DATE: 2-11-14	
SEAL	

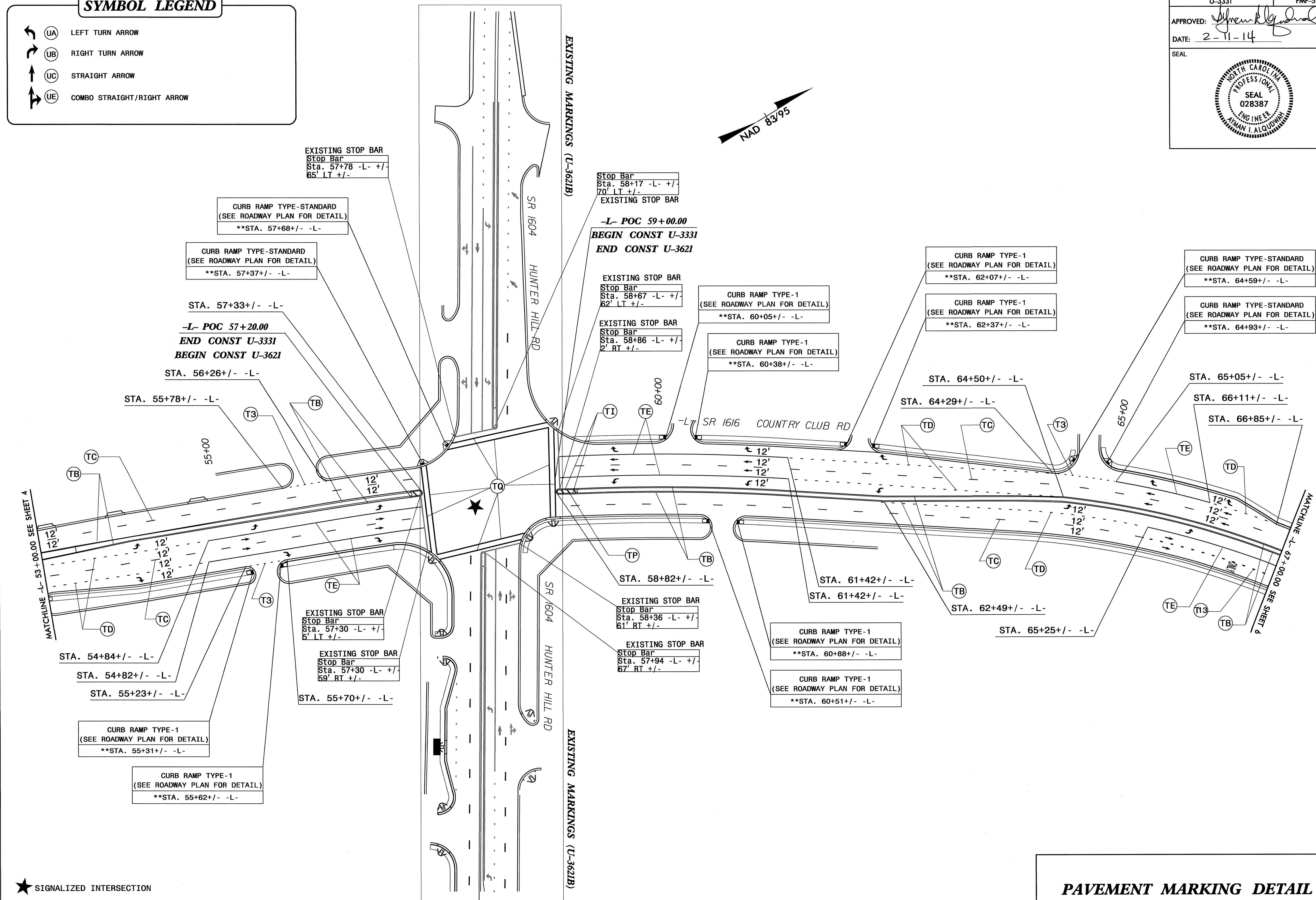

06-FEB-2014 11:28
 P:\TIP\Projects\U-3331\Traffic\Signing\CADD\PMP\U-3331_Sgn_PMP_Sheet-5.dgn
 brashnd AT TEL274712

★ SIGNALIZED INTERSECTION
 ** CENTER OF CURB RAMP

PAVEMENT MARKING DETAIL

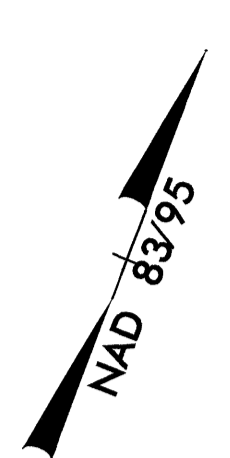

-Y6- POT 14+20.00
END CONST
TIE TO EXISTING MARKINGS

CURB RAMP TYPE-1
 (SEE ROADWAY PLAN FOR DETAIL)
 **STA. 11+90+/- -Y6-

CURB RAMP TYPE-STANDARD
 (SEE ROADWAY PLAN FOR DETAIL)
 **STA. 68+24+/- -L-

CURB RAMP TYPE-STANDARD
 (SEE ROADWAY PLAN FOR DETAIL)
 **STA. 68+04+/- -L-

STA. 67+89+/- -L-

Stop Bar
 Sta. 67+86 -L- +/-
 5' LT +/-

Stop Bar
 Sta. 10+55 -Y6- +/-
 0' LT +/-

STA. 68+83+/- -L-

Stop Bar
 Sta. 68+86 -L- +/-
 5' LT +/-

STA. 70+64+/- -L-

STA. 70+69+/- -L-

STA. 71+15+/- -L-

STA. 72+02+/- -L-

STA. 72+95+/- -L-

MATCHLINE 1-67+00.00 SEE SHEET 5

FUTURE CROSSWALK

SR 154I (JEFFREYS RD)

CURB RAMP TYPE-3
 (SEE ROADWAY PLAN FOR DETAIL)
 **STA. 67+99+/- -L-

CURB RAMP TYPE-3
 (SEE ROADWAY PLAN FOR DETAIL)
 **STA. 68+78+/- -L-

STA. 68+81+/- -L-

STA. 70+05+/- -L-

CURB RAMP TYPE-STANDARD
 (SEE ROADWAY PLAN FOR DETAIL)
 **STA. 70+20+/- -L-

STA. 70+64+/- -L-

STA. 70+69+/- -L-

STA. 71+15+/- -L-

STA. 72+02+/- -L-

STA. 72+95+/- -L-

STA. 71+40+/- -L-







STA. 10+28+/- -Y9-

STA. 10+34+/- -Y9-

STA. 11+32+/- -Y9-

END MARKINGS PROJECT U-3331
-L- STA. 72+95.00
TIE TO EXISTING MARKINGS

SYMBOL LEGEND

-  (UA) LEFT TURN ARROW
-  (UB) RIGHT TURN ARROW
-  (UC) STRAIGHT ARROW
-  (UE) COMBO STRAIGHT/RIGHT ARROW
-  (UF) COMBO LEFT/RIGHT ARROW
-  (VI) ALPHANUMERIC CHAR.

24" YIELD LINE SYMBOL

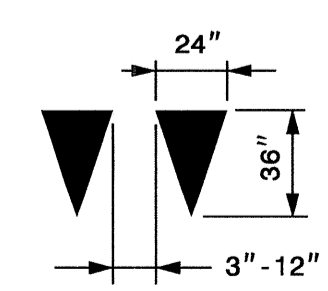

★ SIGNALIZED INTERSECTION
 ** CENTER OF CURB RAMP

PAVEMENT MARKING DETAIL

06-FEB-2014 12:02 P:\Projects\U3331\Traffic\Signing\CADD\PMU-U-3331-Sgn_PMP_Sheet-6.dgn