

040397
15-JAN-2014 14:11
c:\nrc\p\2014\chatham_resurfacing_overview_map.dgn

WBS ELEMENT	SHEET NO.
8CR.20191.23	1

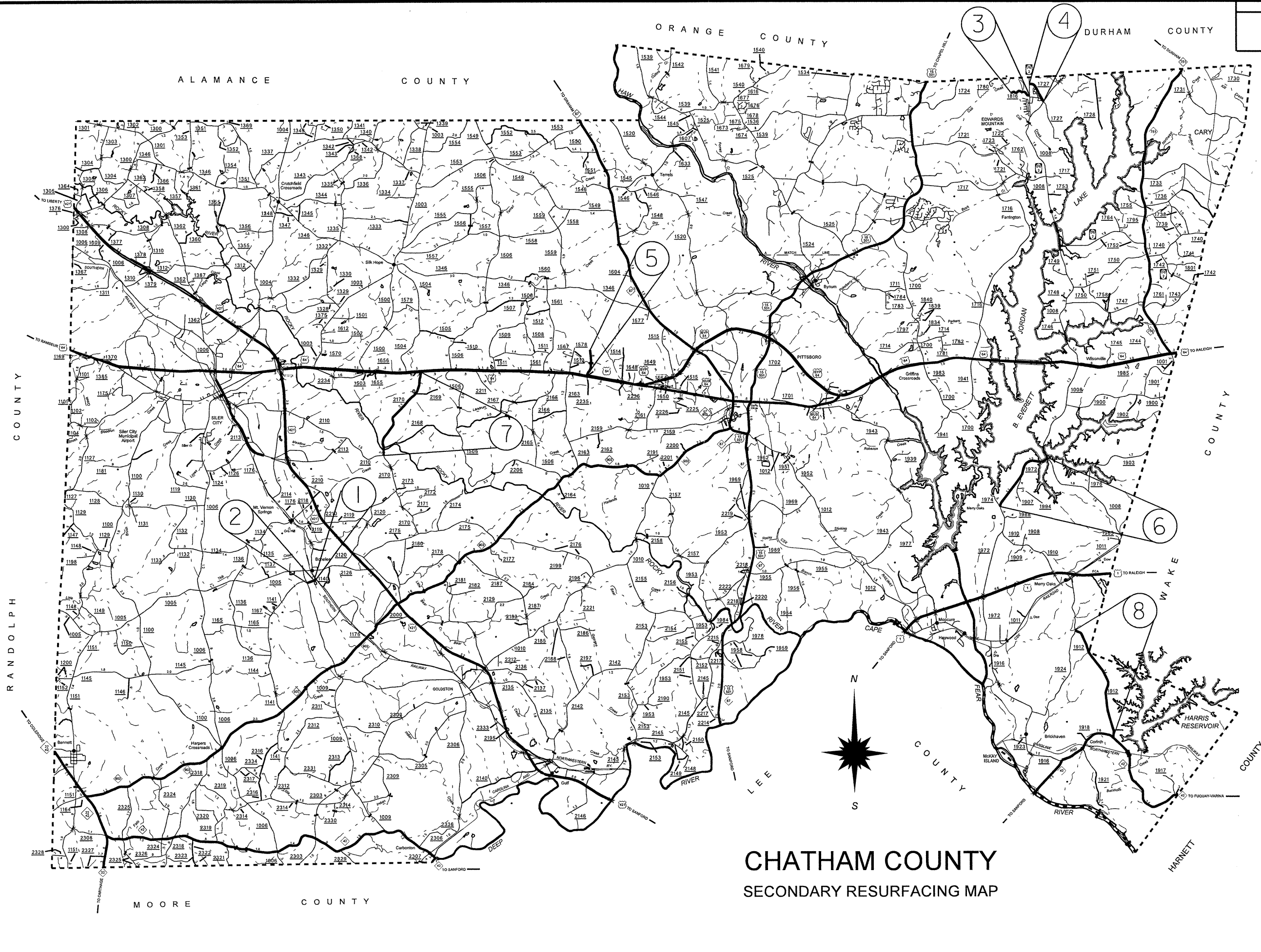

CHATHAM COUNTY SECONDARY RESURFACING MAP

MAPS #1, #2, & #7

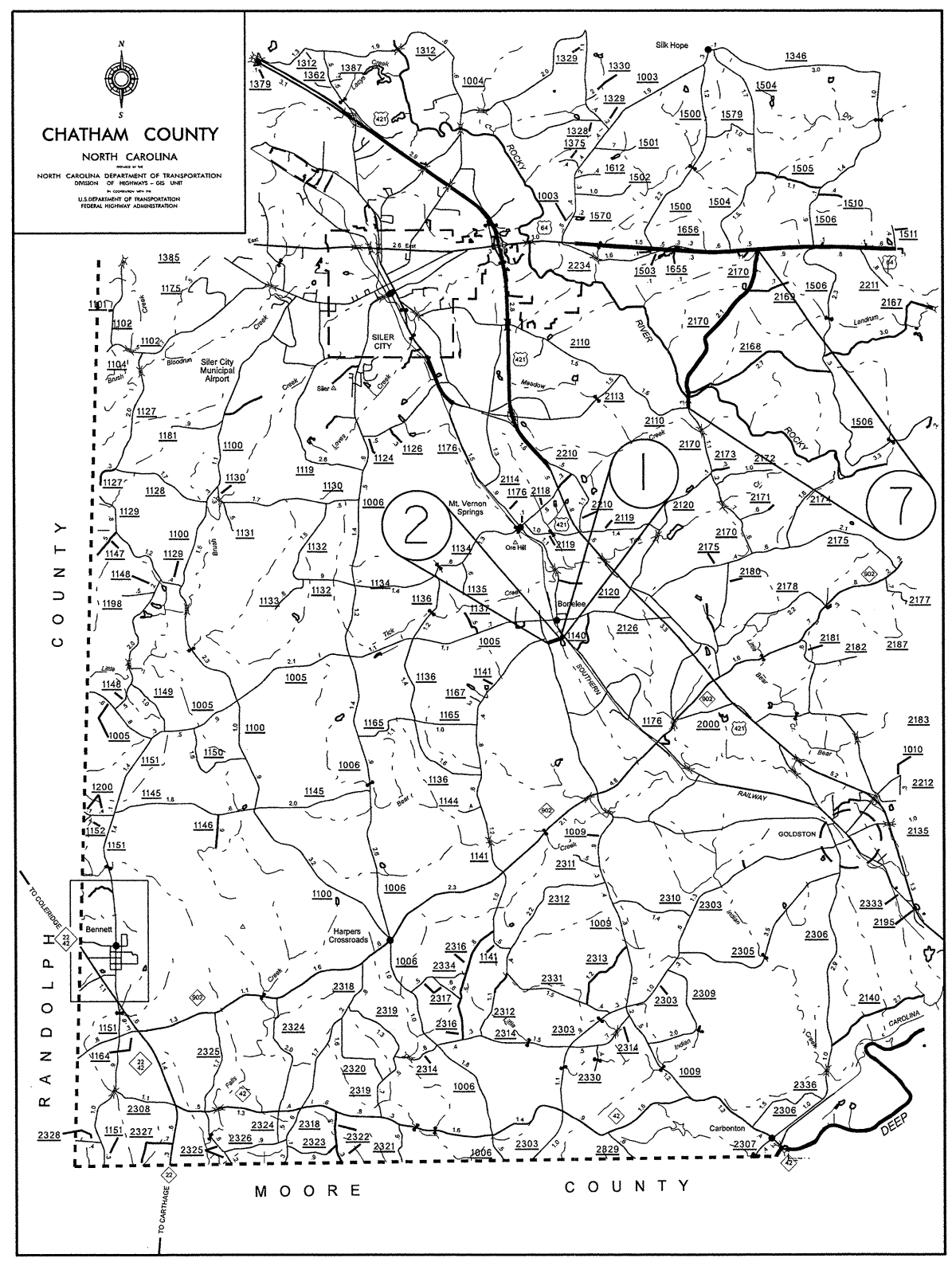

MAP #3, & #4

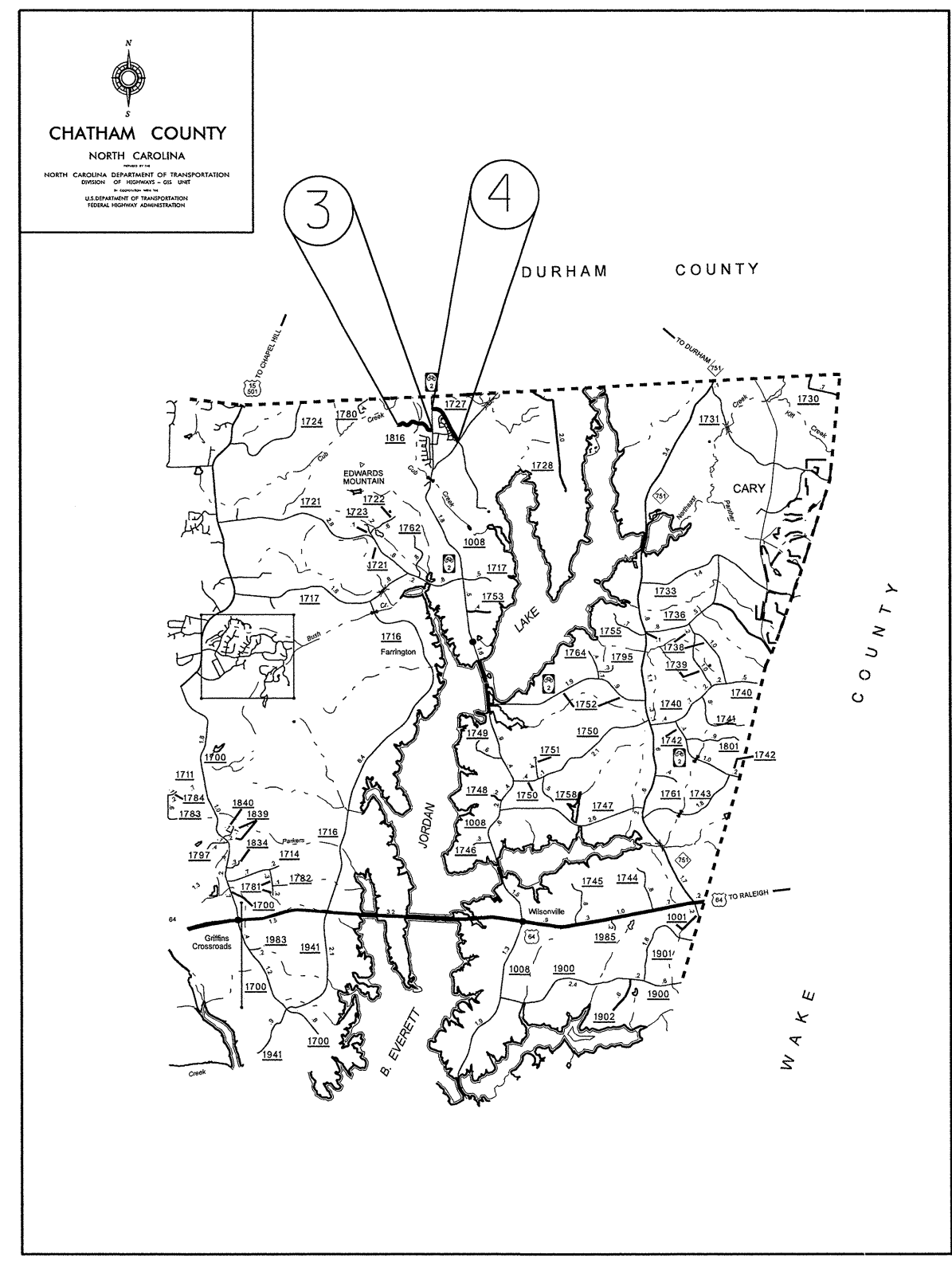

MAP #5

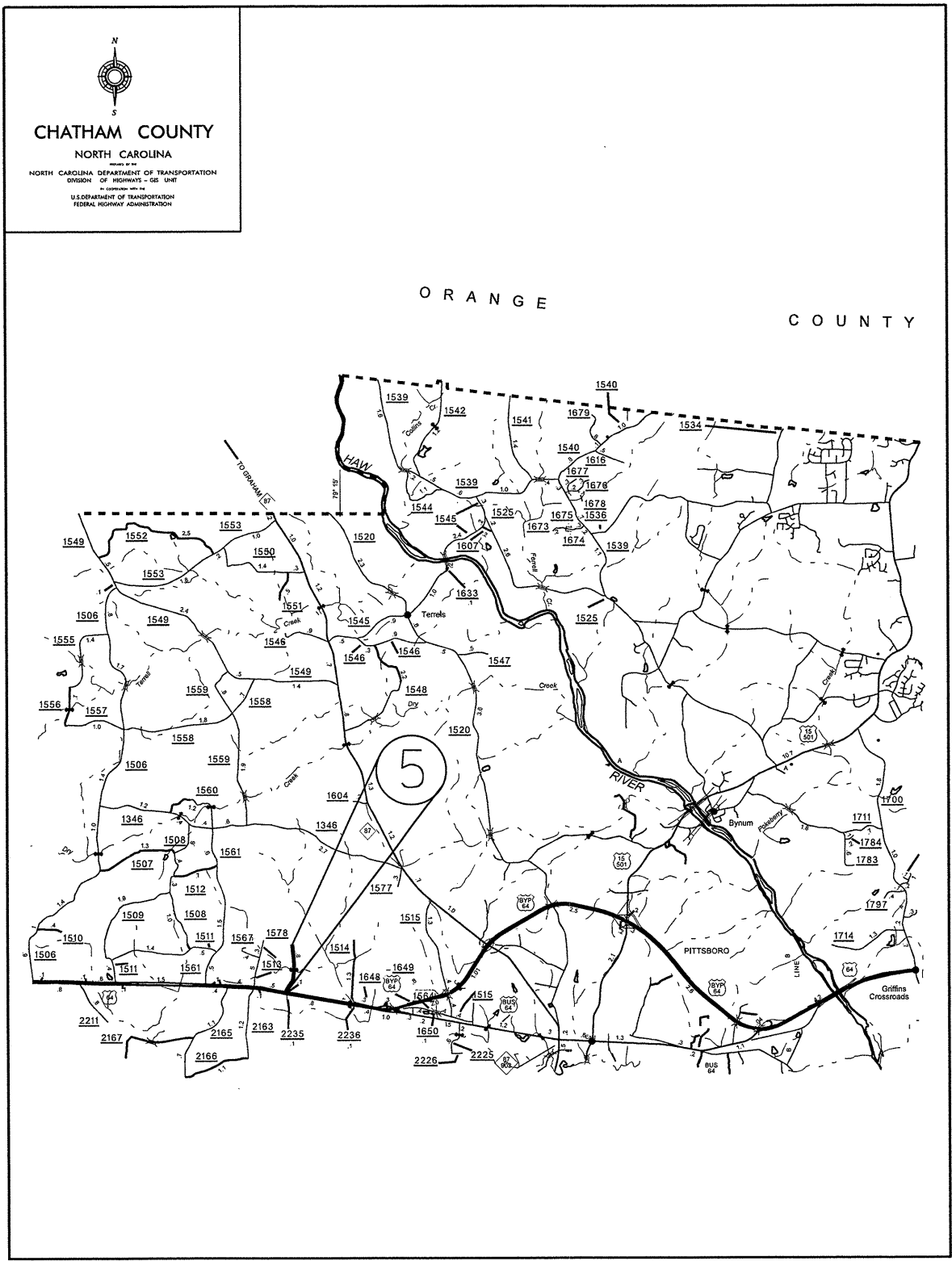

MAPS #6, & #8

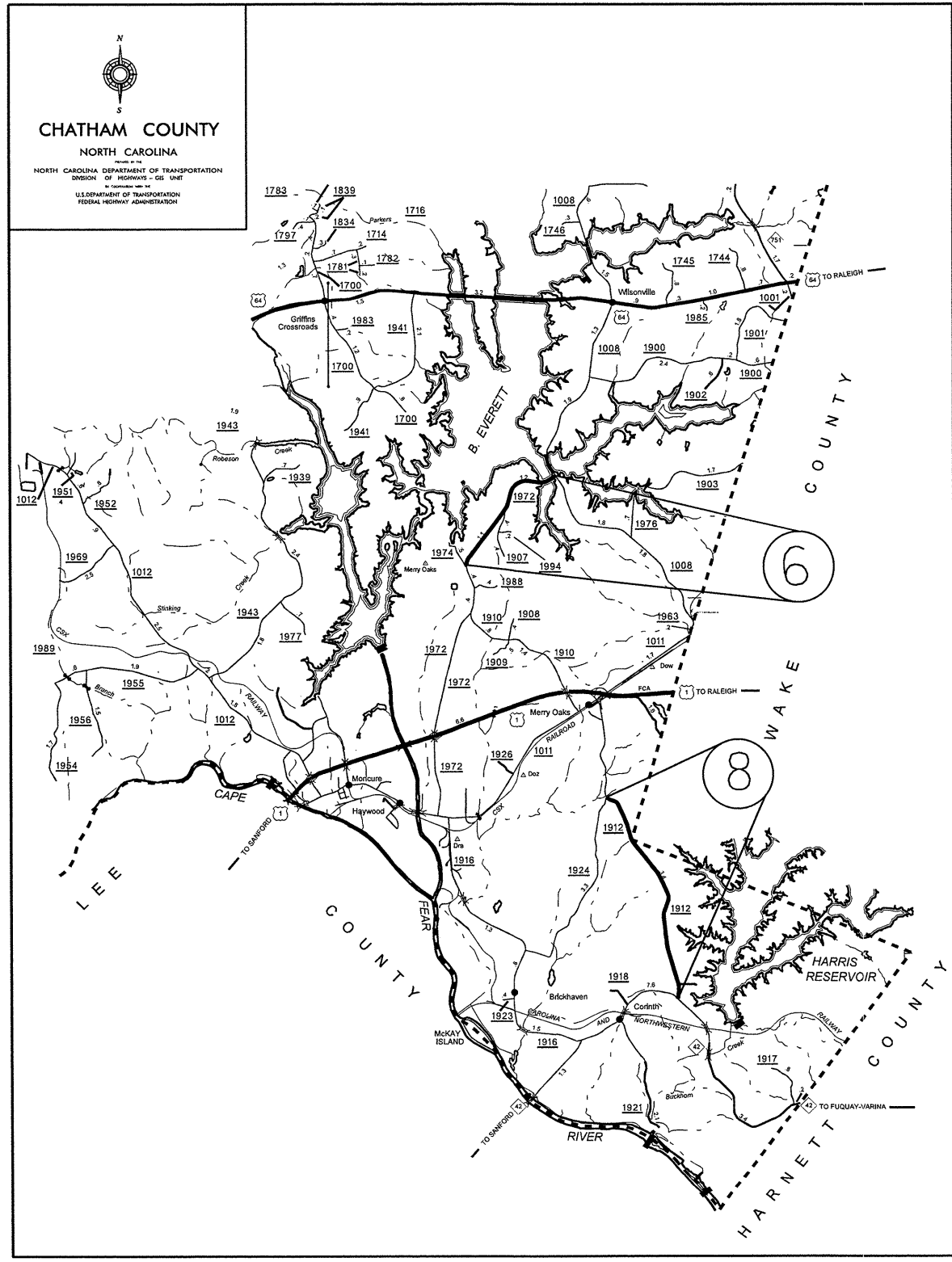

- NOTES:
 1) DETAIL DOES NOT APPLY TO OGAFB AND ULTRA-THIN BONDED WEARING COURSE.
 2) BACKFILL SHOULDER WITH APPROVED MATERIAL.
 3) THE SHOULDER WEDGE DEVICE MAY BE DISENGAGED AT PAVED DRIVEWAYS AND SIDE STREETS.

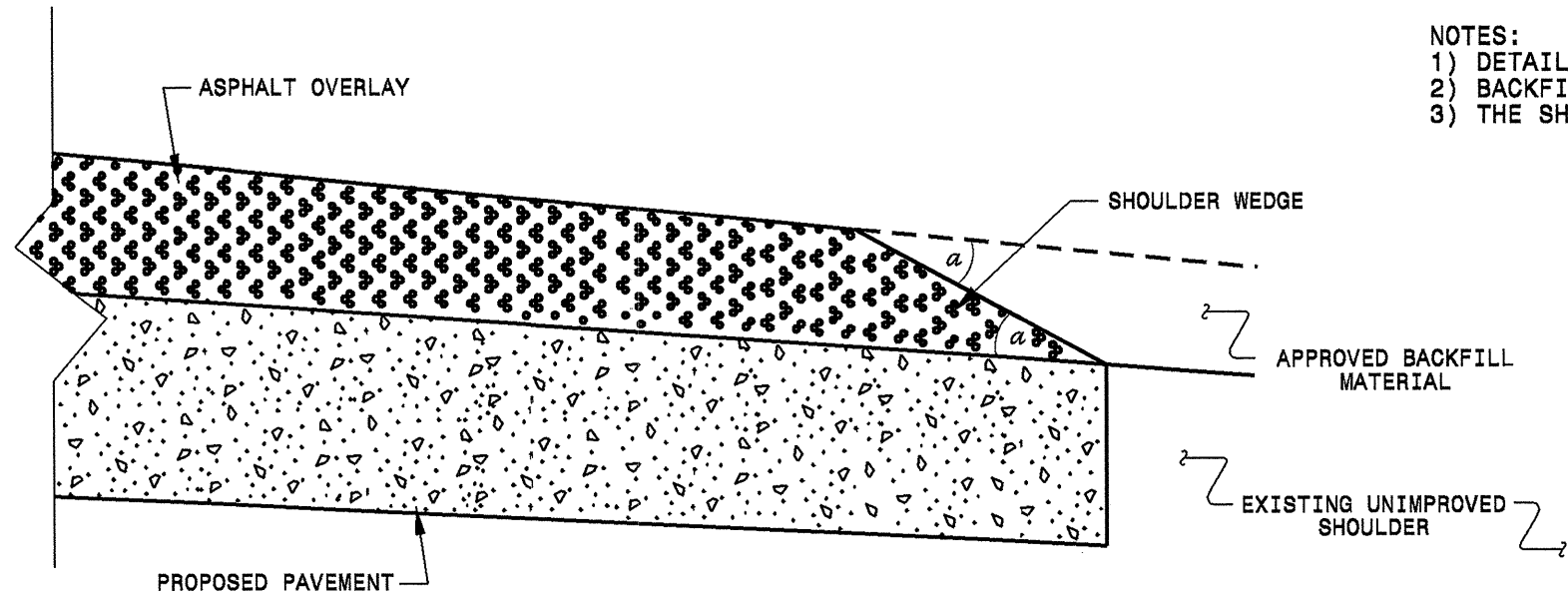

SHOULDER WEDGE DETAIL
 (Resurfacing Projects w/ Widening or
 with Existing Paved Shoulder having no dropoffs)

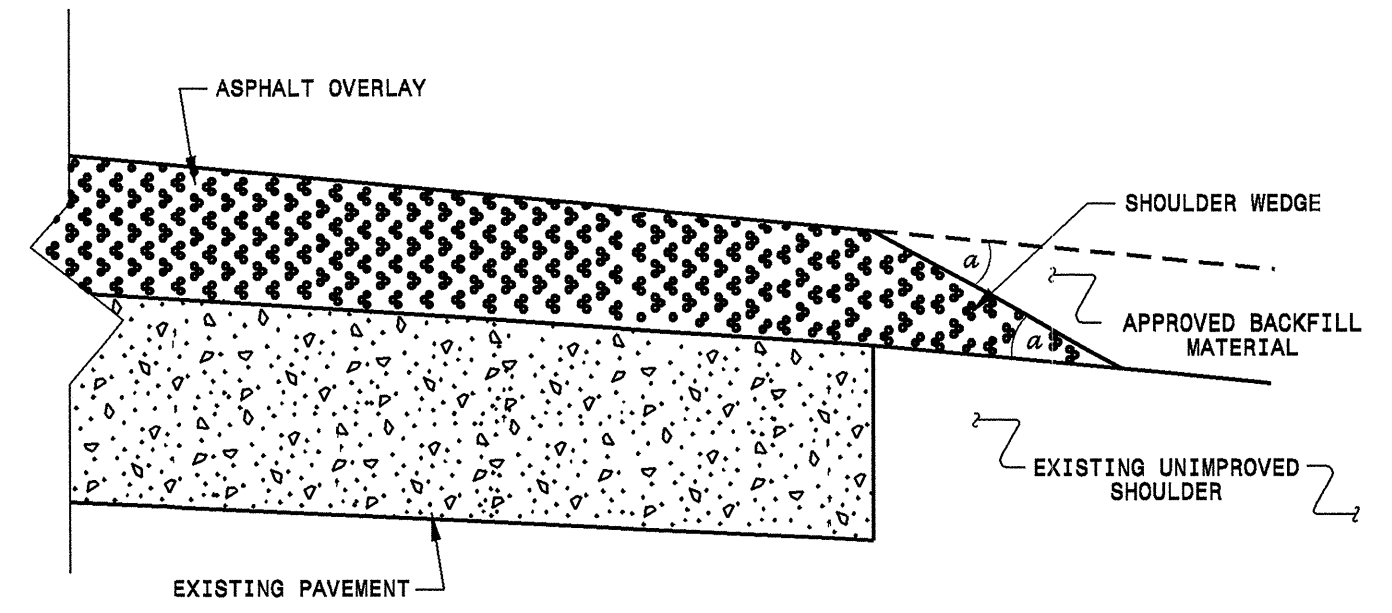

SHOULDER WEDGE DETAIL
 (Resurfacing Projects w/ NO Widening)

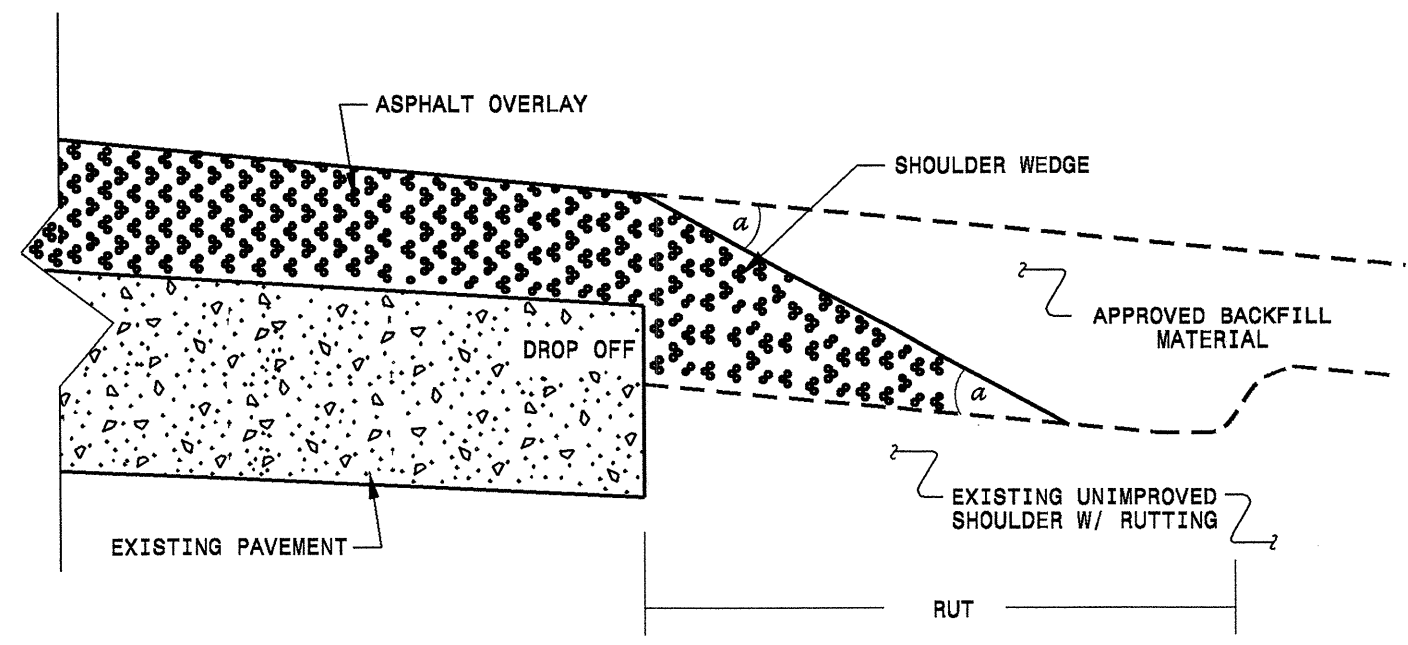

SHOULDER WEDGE DETAIL
 (Resurfacing Adjacent to
 Rutted Shoulder)

- SHOULDER WEDGE ANGLE = 30°

CONTRACT STANDARDS AND DEVELOPMENT UNIT			
Office 919-707-6950		FAX 919-250-4119	
SHOULDER WEDGE DETAILS			
ORIGINAL BY:	T. SPELL	DATE:	7-19-11
MODIFIED BY:		DATE:	10/16/12
CHECKED BY:		DATE:	
FILE SPEC.:	s:\usr\details\stand\shoulderwedgedetail.dgn		

31-JAN-2014 11:42
 S:\Contracts\Resurfacing Projects\Revised Shoulder Wedge Detail.dgn
 \$\$\$USERNAME\$\$\$

NOTES: Less than 5' - 10' undisturbed buffer from ROW, ditchline, water feature, or drainage inlet, add BMP.

EROSION CONTROL DETAIL

BMP Options: Wattle, Silt Fence or Hardened Aggregate.

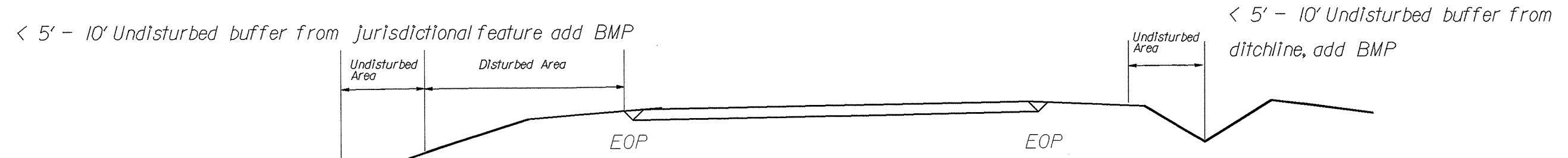
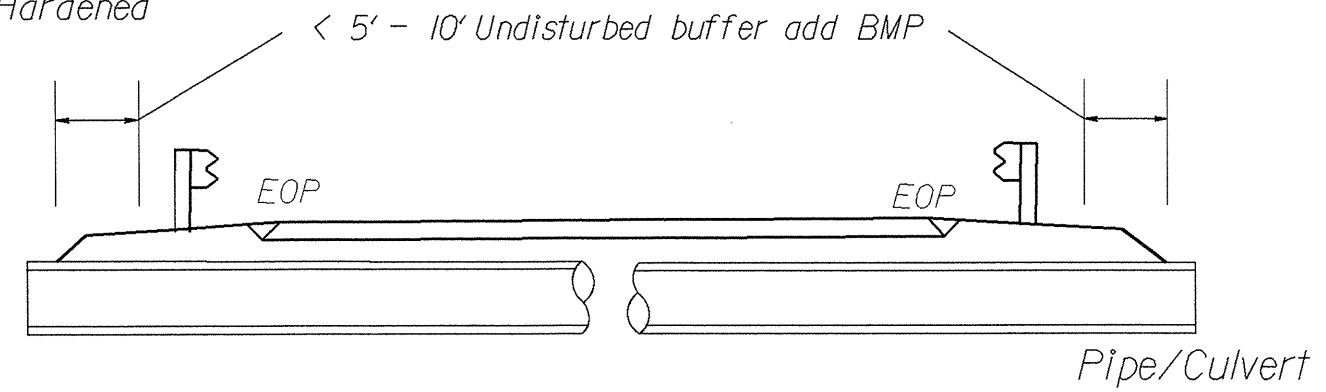

Jurisdictional Feature

Use BMP's if shoulders and/or front slopes and/or ditchline and/or backslopes are disturbed

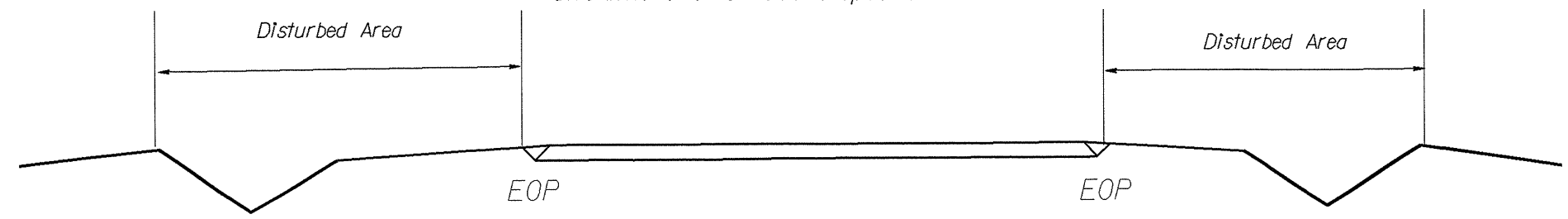

< 5' - 10' Undisturbed buffer from inlet, add wattle

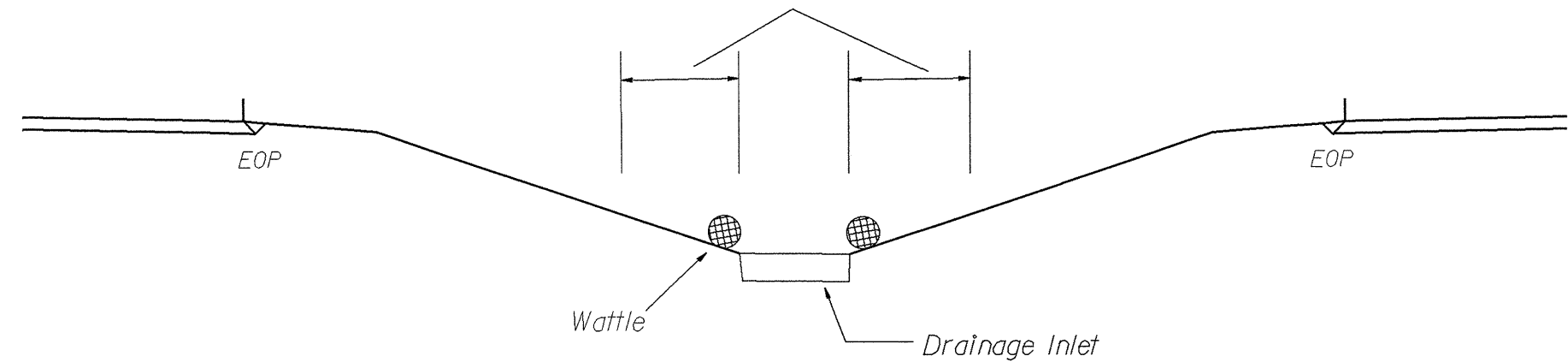

NOT TO SCALE

PROJECT NO.	SHEET NO.	TOTAL NO.
8CR.20191.23	7	8

SUMMARY OF QUANTITIES

PROJECT NO	COUNTY	MAP NO	ROUTE	DESCRIPTION	TYP	LANES	LANE TYPE	FINAL SURFACE TESTING REQUIRED	WARM MIX ASPHALT REQUIRED	LENGTH MI	WIDTH FT	GENERIC GRADING ITEM - AGGREGATE SHOULDER BORROW TON	SHOULDER RECONSTRUCTION SMI	0" TO 1.5" MILLING SY	INCIDENTAL MILLING SY	INTERMEDIATE COURSE, I19.0B TONS	SURFACE COURSE, S9.5B TONS	SURFACE COURSE, SF9.5A TON	ASPHALT BINDER FOR PLANT MIX TONS	PATCHING EXISTING PAVEMENT TONS	ASPHALT SURFACE TREATMENT, MATCOAT, #6M STONE SY
8CR.20191.23	Chatham	1	SR 1140 (CC ROUTH RD)	FROM SR 1139 (BONLEE SCHOOL RD) TO WIDTH CHANGE	1	2	2WU	NO	NO	0.065	22	13.00	0.13		367			105	7	50	
TOTAL FOR MAP NO. 1										0.065		13.00	0.13		367			105	7	50	
8CR.20191.23	Chatham	2	SR 1140 (CC ROUTH RD)	FROM WIDTH CHANGE TO SR 1170 (OLD US 421)	2	2	2WU	NO	NO	0.231	17	46.20	0.46		190	335		240	32	100	
TOTAL FOR MAP NO. 2										0.231		46.20	0.46		190	335		240	32	100	
8CR.20191.23	Chatham	3	SR 1816 (EDWARDS RIDGE RD)	FROM SR 1008 (MT CARMEL CH RD) TO END MAINTNENCE (CUL-DE-SAC)	1	2	2WU	NO	NO	0.643	16	128.60	1.29		90			580	39	150	
TOTAL FOR MAP NO. 3										0.643		128.60	1.29		90			580	39	150	
8CR.20191.23	Chatham	4	SR 1727 (WHIPPORWILL LN)	FROM SR 1008 (MT CARMEL CH RD) TO SR 1726 (OLD FARRINGTON RD)	1	2	2WU	NO	NO	0.715	20	143.00	1.43		115			850	57	200	
TOTAL FOR MAP NO. 4										0.715		143.00	1.43		115			850	57	200	
8CR.20191.23	Chatham	5	SR 1578 (COUNTY LANDFILL RD)	FROM US 64 TO END OF MAINTENANCE	3	2	2WU	NO	NO	0.794	20-30	158.80	1.59		115		895		54	260	9,316.00
TOTAL FOR MAP NO. 5										0.794		158.80	1.59		115		895		54	260	9,316.00
8CR.20191.23	Chatham	6	SR 1972 (PEA RIDGE RD)	FROM WEST END OF CONCRETE ISLAND AT SR 1008 (BEAVER CREEK RD) TO SR 1974 (WH JONES RD)	4	2	2WU	NO	NO	2.241	18-22	448.20	4.48		280			2,695	181	140	29,000.00
TOTAL FOR MAP NO. 6										2.241		448.20	4.48		280			2,695	181	140	29,000.00
8CR.20191.23	Chatham	7	SR 2170 (RIVES CHAPEL RD)	FROM US 64 TO SR 2110 (ALSTON BRIDGE RD)	1	2	2WU	NO	NO	2.935	17	587.00	5.87	300	236			2,715	182	180	
TOTAL FOR MAP NO. 7										2.935		587.00	5.87	300	236			2,715	182	180	
8CR.20191.23	Chatham	8	SR 1912 (CHRISTIAN CHAPEL CH RD)	FROM NC 42 TO SR 1924 (MONCURE FLATWOOD RD)	4	2	2WU	NO	NO	3.59	18-20	718.00	7.18		167			3,875	260	330	40,100.00
TOTAL FOR MAP NO. 8										3.59		718.00	7.18		167			3,875	260	330	40,100.00
TOTAL FOR PROJ NO. 8CR.20191.23										11.214		2,242.80	22.43	300	1,560	335	895	11,060	812	1,410	78,416.00
GRAND TOTAL										11.214		2,242.80	22.43	300	1,560	335	895	11,060	812	1,410	78,416.00

PROJECT NO.	SHEET NO.	TOTAL NO.
8CR.20191.23	8	8

THERMOPLASTIC AND PAINT QUANTITIES

PROJECT NO	COUNTY	MAP NO	ROUTE	DESCRIPTION	TYP	LANES	LANE TYPE	LENGTH	WIDTH	4457000000-N	4413000000-E	4685000000-E	4686000000-E	4810000000-E		4830000000-E	4835000000-E	4840000000-N	4900000000-N
										TEMPORARY TRAFFIC CONTROL	WORK ZONE ADVANCE/GENERAL WARNING SIGNING	4" X 90 M WHITE THERMO	4" X 120 M YELLOW THERMO	4" WHITE PAINT	4" YELLOW PAINT	16" WHITE PAINT	24" WHITE PAINT	PAINT MSG RXR	YELLOW & YELLOW MARKERS
										LS	SF	LF	LF	LF	LF	LF	LF	EA	EA
8CR.20191.23	Chatham	1	SR 1140 (CC ROUTH RD)	FROM SR 1139 (BONLEE SCHOOL RD) TO WIDTH CHANGE	1	2	2WU	0.065	22					1,399	1,399			15	
TOTAL FOR MAP NO. 1													1,399	1,399			15		
8CR.20191.23	Chatham	2	SR 1140 (CC ROUTH RD)	FROM WIDTH CHANGE TO SR 1170 (OLD US 421)	2	2	2WU	0.231	17					4,879	4,879	50	25	2	
TOTAL FOR MAP NO. 2													4,879	4,879	50	25	2		
8CR.20191.23	Chatham	3	SR 1816 (EDWARDS RIDGE RD)	FROM SR 1008 (MT CARMEL CH RD) TO END MAINTNENCE (CUL-DE-SAC)	1	2	2WU	0.643	16										
TOTAL FOR MAP NO. 3																			
8CR.20191.23	Chatham	4	SR 1727 (WHIPPORWILL LN)	FROM SR 1008 (MT CARMEL CH RD) TO SR 1726 (OLD FARRINGTON RD)	1	2	2WU	0.715	20										
TOTAL FOR MAP NO. 4																			
8CR.20191.23	Chatham	5	SR 1578 (COUNTY LANDFILL RD)	FROM US 64 TO END OF MAINTENANCE	3	2	2WU	0.794	20-30										
TOTAL FOR MAP NO. 5																			
8CR.20191.23	Chatham	6	SR 1972 (PEA RIDGE RD)	FROM WEST END OF CONCRETE ISLAND AT SR 1008 (BEAVER CREEK RD) TO SR 1974 (WH JONES RD)	4	2	2WU	2.241	18-22			24,113	24,113						148
TOTAL FOR MAP NO. 6											24,113	24,113						148	
8CR.20191.23	Chatham	7	SR 2170 (RIVES CHAPEL RD)	FROM US 64 TO SR 2110 (ALSTON BRIDGE RD)	1	2	2WU	2.935	17					63,161	63,161				
TOTAL FOR MAP NO. 7													63,161	63,161					
8CR.20191.23	Chatham	8	SR 1912 (CHRISTIAN CHAPEL CH RD)	FROM NC 42 TO SR 1924 (MONCURE FLATWOOD RD)	4	2	2WU	3.59	18-20										
TOTAL FOR MAP NO. 8																			
TOTAL FOR PROJ NO. 8CR.20191.23									1	1256	24,113	24,113	69,439	69,439	50	40	2	148	
GRAND TOTAL									1	1256	24,113	24,113	69,439	69,439	50	40	2	148	

SIGNING FOR RESURFACING PROJECTS

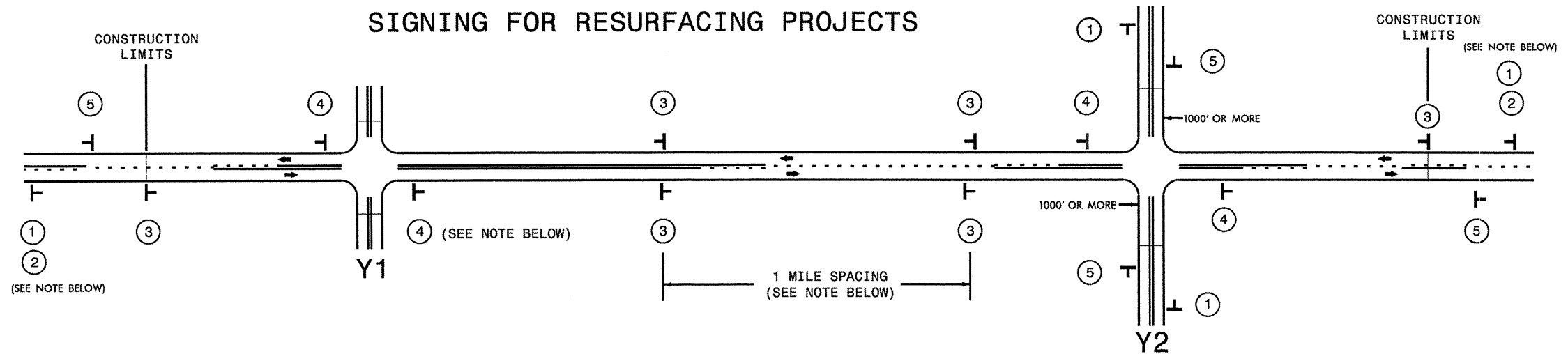

LEGEND	
T	STATIONARY SIGN
←	DIRECTION OF TRAFFIC FLOW

MAINLINE (-L-) SIGNING

-Y- LINE SIGNING

SIGNING NOTES AND PLACEMENT PER DIRECTION	MAINLINE (-L-) SIGNING		-Y- LINE SIGNING	
	1		<p>PLACE 1000' PRIOR TO BEGINNING OF CONSTRUCTION LIMITS. ONLY USED ON -Y- LINES IF RESURFACING LIMITS EXTEND 1000' ALONG -Y- LINE.</p>	<p>NO REQUIRED STATIONARY SIGNING FOR THE FOLLOWING -Y- LINE CONDITIONS:</p> <ol style="list-style-type: none"> 1) LESS THAN 1000' OF RESURFACING ALONG -Y- LINE 2) SUBDIVISION ROADS 3) DEAD END ROADS <p>WHEN PAVING/CONSTRUCTION ACTIVITIES PROCEED ACROSS AN UNSIGNED -Y- LINE, ADVANCE WARNING PORTABLE SIGNS SHALL BE USED ALONG THE -Y- LINE AS SHOWN BELOW. REMOVE UPON COMPLETION OF WORK.</p> <div style="display: flex; justify-content: space-around;"> </div> <p>PLACED 500' IN ADVANCE OF FLAGGER. PLACED 250' IN ADVANCE OF FLAGGER.</p>
	2		<p>#2 SIGN ONLY USED WHEN RESURFACING LIMITS ARE 2 OR MORE MILES IN LENGTH. ROUND UP TO NEXT WHOLE NUMBER. (NO FRACTIONAL OR DECIMAL NUMBERS)</p>	
	3		<p>PLACE INITIALLY AT THE CONSTRUCTION LIMITS AND SPACED 1 MILE APART THEREAFTER. IF NO -Y- LINES EXIST, PLACE 2ND SET 1/2 MILE FROM THE CONSTRUCTION LIMITS AND THEN SPACE 1 MILE THEREAFTER.</p>	
4		<p>THESE ARE FOR -Y- LINES THAT ARE "THROUGH" ROADWAYS. DEAD END AND SUBDIVISION ROADS ARE NOT "THROUGH" ROADWAYS. INSTALL 500' +/- FROM EACH -Y- LINE APPROACH AS SHOWN ABOVE. FOR MULTIPLE -Y- LINES THAT ARE SEPARATED BY 0.25 MILES OR LESS, TREAT AS A SINGLE UNIT AND INSTALL WITHIN 500' OF EACH APPROACH. A MAXIMUM OF 2 SIGN SETS PER MILE. DO NOT INSTALL WHEN -Y- LINES ARE WITHIN 0.5 MILES FROM "END ROAD WORK" SIGN.</p>		
5		<p>PLACE 500' FOLLOWING THE END OF CONSTRUCTION LIMITS.</p>		

30-JAN-2014 16:04
 C:\Users\p... \Public\Projects\Resurfacing\Mar ch...2014\Chatham\Chatham_Submit\HdL_Mar ch...2014\Resurfacing_AdvWarn_2Ln.dgn
 gsgovis AT D8CAD-27040

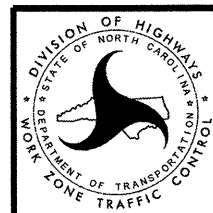

RESURFACING
 ADVANCE WARNING SIGNS
 FOR
 RURAL AND SUBURBAN
 2 LANE ROADWAYS