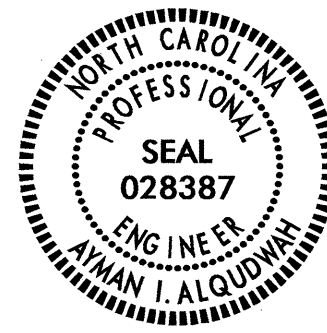

TIP NO.	SHEET NO.
U-2810C	PMP-1
APPROVED: <i>Ayman Alqudwah</i>	
DATE: 8-14-13	
SEAL	
	

**STATE OF NORTH CAROLINA
DEPARTMENT OF TRANSPORTATION**

**PAVEMENT MARKING PLAN
CUMBERLAND COUNTY**

**LOCATION: SR 1003 (CAMDEN ROAD) FROM EAST OF OAKLAND AVENUE
TO NORTH OF SR 1007 (OWEN DRIVE)**

T.I.P.: U-2810C

CONTRACT: C203291

ROADWAY STANDARD DRAWING

THE FOLLOWING ROADWAY STANDARDS AS APPEAR IN "ROADWAY STANDARD DRAWINGS" - PROJECT SERVICES UNIT - N.C. DEPARTMENT OF TRANSPORTATION - RALEIGH, N.C., DATED JULY 2012 ARE APPLICABLE TO THIS PROJECT AND BY REFERENCE HEREBY ARE CONSIDERED A PART OF THESE PLANS:

STD. NO.	TITLE
1205.01	PAVEMENT MARKINGS - LINE TYPES AND OFFSETS
1205.02	PAVEMENT MARKINGS - 2 LANE AND MULT-LANE ROADWAYS
1205.04	PAVEMENT MARKINGS - INTERSECTIONS
1205.05	PAVEMENT MARKINGS - TURN LANES
1205.08	PAVEMENT MARKINGS - SYMBOL AND WORD MESSAGES
1205.09	PAVEMENT MARKINGS - PAINTED ISLANDS
1205.13	PAVEMENT MARKINGS - LANE REDUCTIONS
1250.01	RAISED PAVEMENT MARKERS - INSTALLATION SPACING
1251.01	RAISED PAVEMENT MARKERS - PERMANENT AND TEMPORARY
1261.01	GUARDRAIL AND BARRIER DELINEATORS - INSTALLATION SPACING
1261.02	GUARDRAIL AND BARRIER DELINEATORS - TYPES AND MOUNTING
1262.01	GUARDRAIL END DELINEATION

PAVEMENT MARKING SCHEDULE

SYMBOL	DESCRIPTION
T8	THERMOPLASTIC (24", 120 MILS)
T2	WHITE STOPBAR
	THERMOPLASTIC (4", 120 MILS)
T8	2 FT. - 8 FT./SP WHITE MINISKIP
T9	2 FT. - 8 FT./SP YELLOW MINISKIP
TC	10 FT. WHITE SKIP
TD	3 FT. - 9 FT./SP WHITE MINISKIP
TE	WHITE SOLID LANE LINE
TI	YELLOW DOUBLE CENTER
	THERMOPLASTIC (4", 90 MILS)
TA	WHITE EDGELINE
TB	YELLOW EDGELINE
	THERMOPLASTIC (8", 90 MILS)
TN	WHITE GORELINE
TO	WHITE DIAGONAL
TP	YELLOW DIAGONAL
	THERMOPLASTIC (8", 120 MILS)
TQ	WHITE CROSSWALK LINE
	THERMOPLASTIC PAVEMENT MARKING SYMBOLS (90 MILS)
UA	LEFT TURN ARROW
UB	RIGHT TURN ARROW
UC	STRAIGHT ARROW
UE	COMBO STRAIGHT/RIGHT ARROW
UT	U-TURN ARROW

GENERAL NOTES

THE FOLLOWING GENERAL NOTES APPLY AT ALL TIMES FOR THE DURATION OF THE CONSTRUCTION PROJECT, EXCEPT WHEN OTHERWISE NOTED IN THE PLAN, OR DIRECTED BY THE ENGINEER.

- A) INSTALL PAVEMENT MARKINGS AND PAVEMENT MARKERS ON THE FINAL SURFACE AS FOLLOWS:

ROAD NAME	MARKING	MARKER
ALL	THERMOPLASTIC	RAISED
- B) TIE PROPOSED PAVEMENT MARKING LINES TO EXISTING PAVEMENT MARKING LINES.
- C) REMOVE/REPLACE ANY CONFLICTING/DAMAGED PAVEMENT MARKINGS AND MARKERS.
- D) PASSING ZONES WILL BE DETERMINED IN THE FIELD AND MUST BE APPROVED BY THE ENGINEER.
- E) STOP BAR LOCATION AT NON-SIGNALIZED INTERSECTIONS MAY BE ADJUSTED AS DIRECTED BY THE ENGINEER.
- F) UNLESS OTHERWISE SPECIFIED, HEATED-IN-PLACE THERMOPLASTIC MAY BE USED IN LIEU OF EXTRUDED THERMOPLASTIC FOR STOP BARS, SYMBOLS, CHARACTERS AND DIAGONALS. IF HEATED-IN-PLACE IS USED, IT SHALL BE PAID FOR USING THE EXTRUDED THERMOPLASTIC PAY ITEM.
- G) SEE ROADWAY PLANS FOR ALTERNATE CURB RAMP DESIGNS WHEN INDICATED ON PAVEMENT MARKING DETAIL SHEETS.

INDEX

SHEET NO.	DESCRIPTION
PMP-1	PAVEMENT MARKING PLAN TITLE AND SCHEDULE SHEET
PMP-1A	CROSSWALK PAVEMENT MARKING GUIDANCE DETAIL
PMP-2-10	PAVEMENT MARKING DETAIL

PLAN PREPARED BY: N.C.D.O.T. SIGNING AND DELINEATION UNIT

AYMAN I. ALQUDWAH, P.E. SIGNING & DELINEATION REGIONAL ENGINEER
ERIC WARD SIGNING & DELINEATION DESIGN ENGINEER

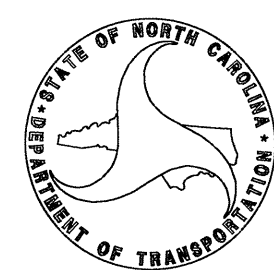

TIP NO.	SHEET NO.
U-2810C	PMP-1A
APPROVED: <i>[Signature]</i>	
DATE: 8-14-13	
SEAL	
	
REVISIONS	

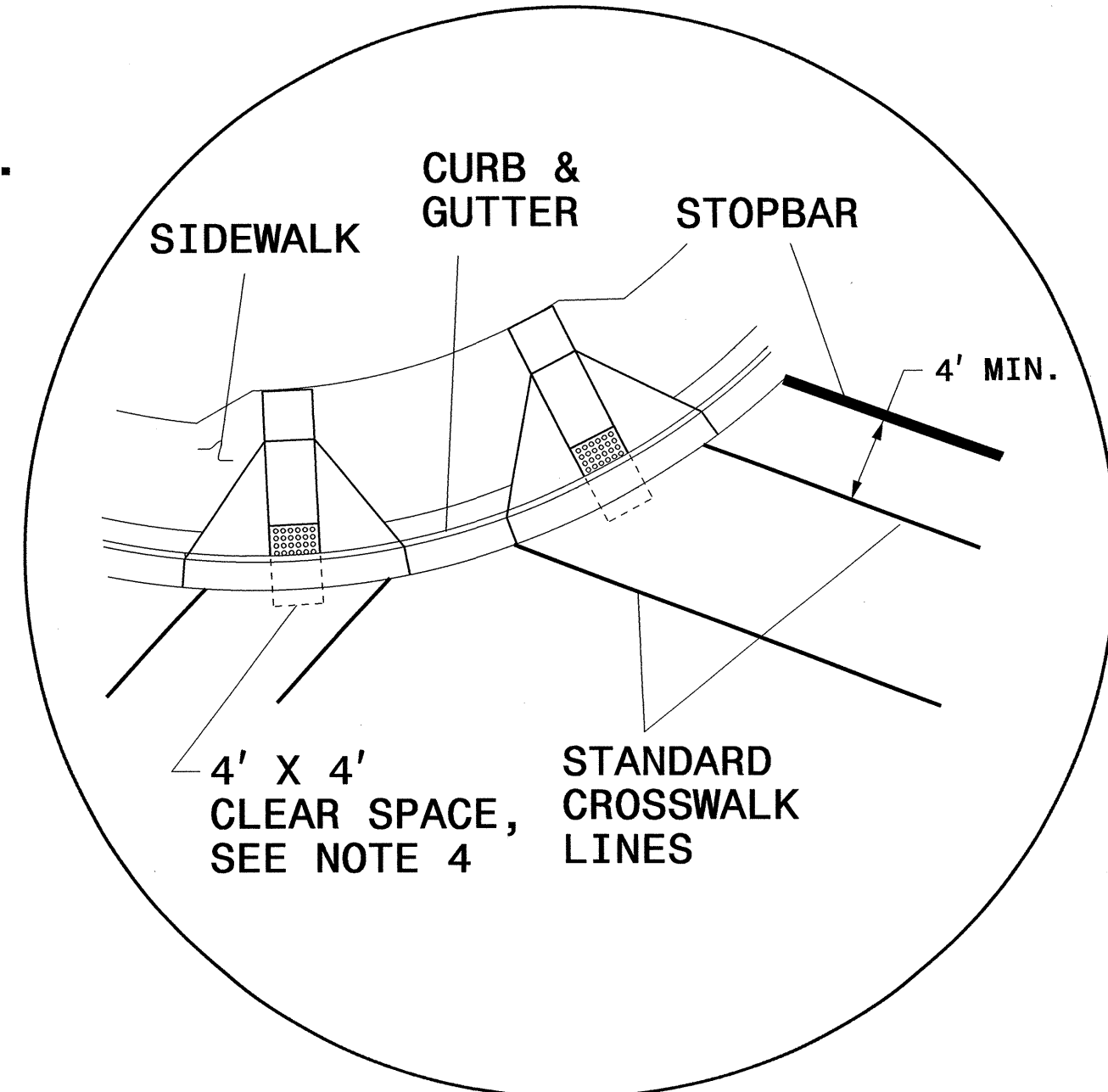
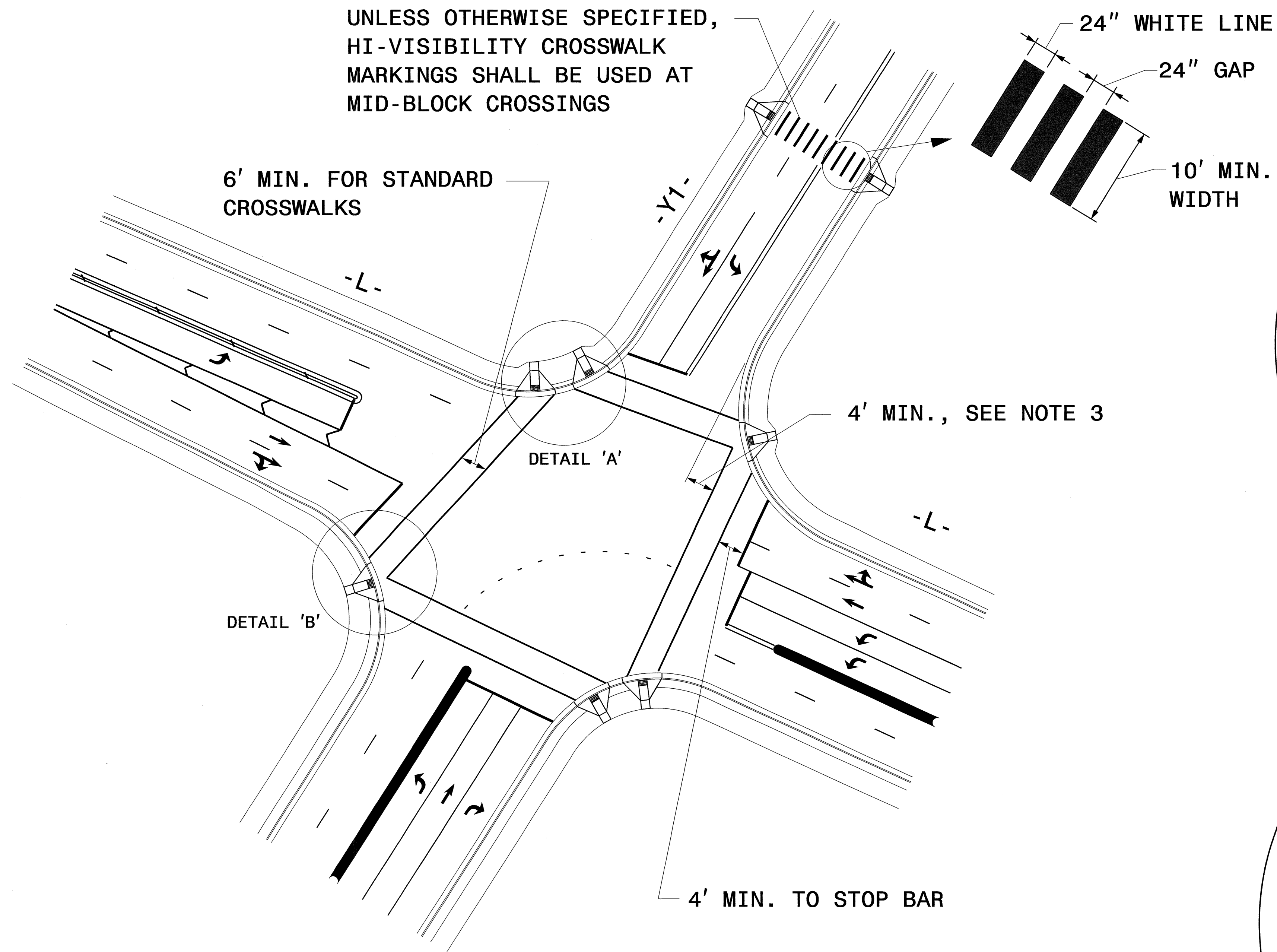

DETAIL 'A'- DUAL CURB RAMPS

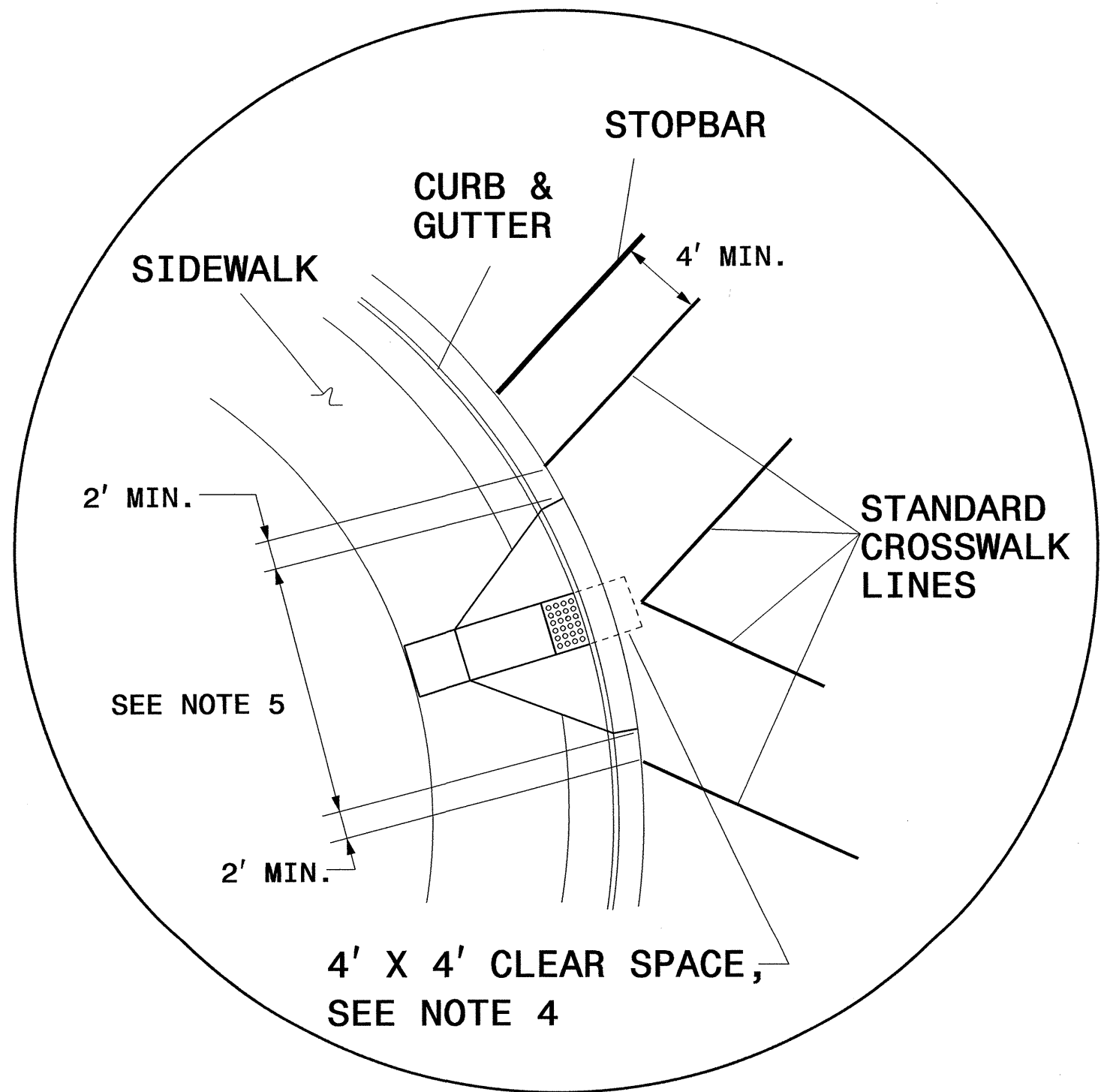

DETAIL 'B'- SINGLE DIAGONAL CURB RAMP

GUIDANCE DETAIL FOR CROSSWALK MARKINGS

NOTES:

1. USE THE DETAILS ABOVE AND THE FOLLOWING NOTES FOR GUIDANCE IN PLACING CROSSWALK MARKINGS NOT STATIONED ON THE DETAIL SHEETS OR WHEN FIELD ADJUSTMENTS REQUIRED MOVING STATIONED MARKINGS AS DIRECTED BY THE ENGINEER. REFER TO NCDOT ROADWAY STANDARD DRAWINGS, MUTCD AND ADA STANDARDS FOR ADDITIONAL GUIDANCE.
2. THE CROSSWALK MARKINGS SHOWN ON THE ABOVE DETAILS ARE FOR REFERENCE ONLY. ONLY INSTALL CROSSWALK MARKINGS WHERE SHOWN ON THE DETAIL SHEETS OR AS DIRECTED BY THE ENGINEER. THE CROSSWALK MARKING TYPE, STANDARD OR HI-VISIBILITY, SHALL BE INSTALL AS SPECIFIED ON THE DETAIL SHEETS OR AS DIRECTED BY THE ENGINEER.
3. SET BACK DISTANCE FROM INSIDE CROSSWALK MARKING TO NEAREST EDGE OF TRAVEL IS 4' MIN.
4. BEYOND THE BOTTOM GRADE BRAKE, A CLEAR SPACE OF 4' X 4' MINIMUM SHALL BE PROVIDED WITHIN THE MARKINGS.
5. SINGLE DIAGONAL CURB RAMPS WITH FLARED SIDES SHALL HAVE A SEGMENT OF CURB 2 FEET LONG MINIMUM LOCATED ON EACH SIDE OF THE CURB RAMP AND WITHIN THE MARKED CROSSING, SEE DETAIL 'B'.
6. CURB RAMPS SHALL BE CONSTRUCTED IN ACCORDANCE TO THE LATEST NCDOT ROADWAY STANDARD DRAWINGS.

**CROSSWALK PAVEMENT MARKING
GUIDANCE DETAIL**

13-AUG-2013 10:48
 P:\TIP\Projects-U\U2810C\Traffic\Signing\CADD\VPMP\U2810C.pmp_psh.dgn
 erfcward AT TE27497

01/08

TIP NO. U-2810C	SHEET NO. PMP-2
APPROVED: <i>[Signature]</i>	
DATE: 8-14-13	
SEAL	

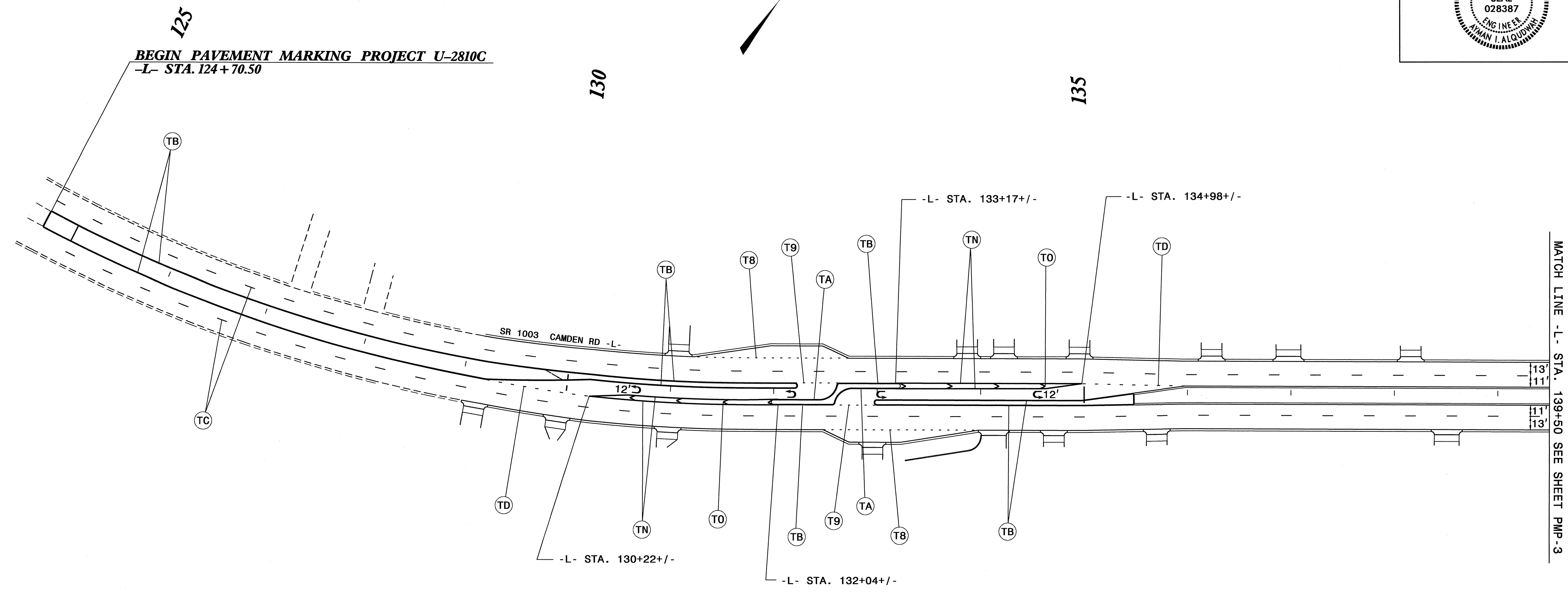

SYMBOL LEGEND	
	LEFT TURN ARROW
	RIGHT TURN ARROW
	STRAIGHT ARROW
	COMBO STRAIGHT/RIGHT ARROW
	U-TURN ARROW

PAVEMENT MARKING DETAIL

09-AUG-2013 13:49
 F:\TIPPrj\U-2810C\Traffic\Signing\CADD\PMF\U2810C_pmp_psh2.dgn
 12/17/13

TIP NO.	SHEET NO.
U-2810C	PMP 3-3
APPROVED: <i>[Signature]</i>	
DATE: 8-14-13	
SEAL	

140

145

150

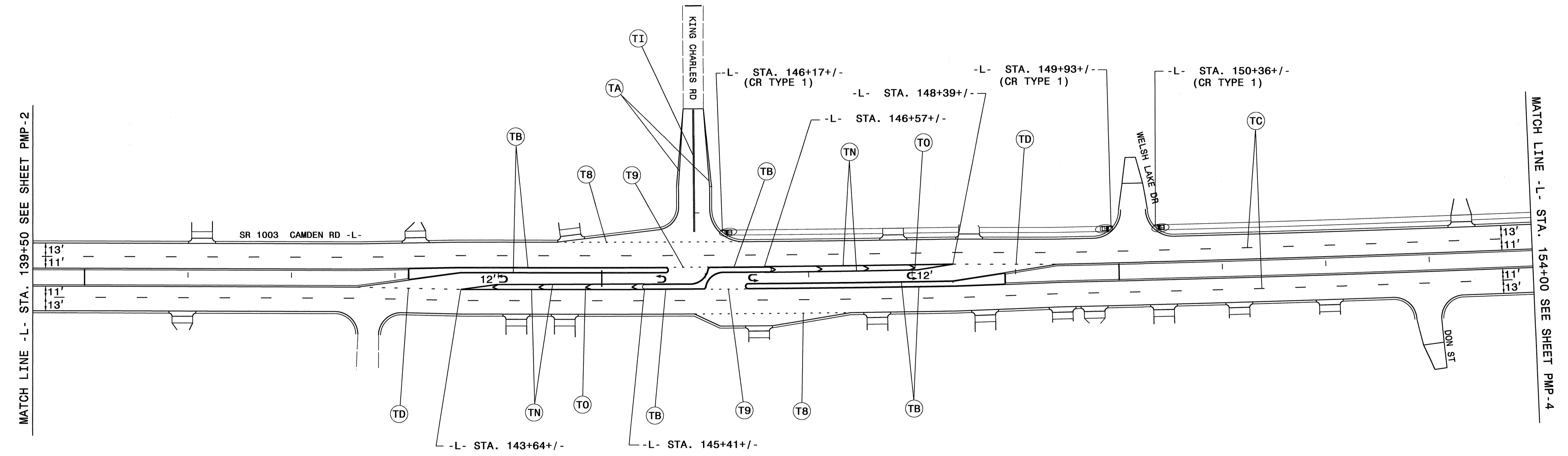

SYMBOL LEGEND	
	(UA) LEFT TURN ARROW
	(UB) RIGHT TURN ARROW
	(UC) STRAIGHT ARROW
	(UE) COMBO STRAIGHT/RIGHT ARROW
	(UT) U-TURN ARROW

PAVEMENT MARKING DETAIL

09-AUG-2013 13:46 U:\2810C\Traffic\Signing\CADD\PM\U2810C-pmp-psh3.dgn
 erikard AT 12/24/17

TIP NO.	SHEET NO.
U-2810C	PMP-4
APPROVED: <i>[Signature]</i>	
DATE: 8-14-13	
SEAL	

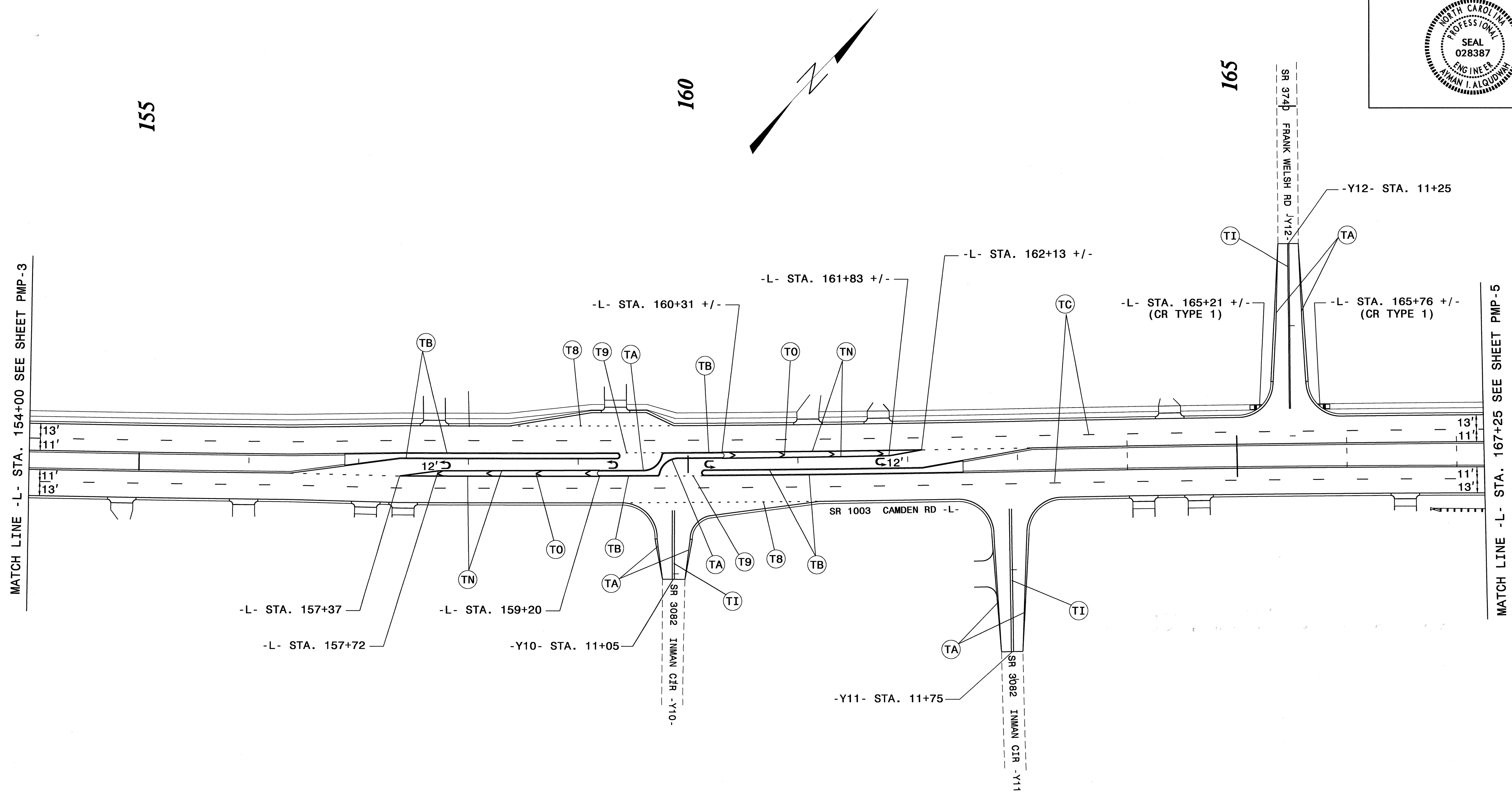

SYMBOL LEGEND	
	UA LEFT TURN ARROW
	UB RIGHT TURN ARROW
	UC STRAIGHT ARROW
	UE COMBO STRAIGHT/RIGHT ARROW
	UT U-TURN ARROW

PAVEMENT MARKING DETAIL

09-AUG-2013 11:41 AM C:\Users\jgarcia\Documents\Projects\U-2810C\Traffic\Signing\CADD\PMF\U-2810C-pmp-psht4.dgn
 jgarcia AT 12/24/13

TIP NO. U-2810C	SHEET NO. PMP-5
APPROVED: <i>[Signature]</i>	
DATE: 8-19-13	
SEAL	

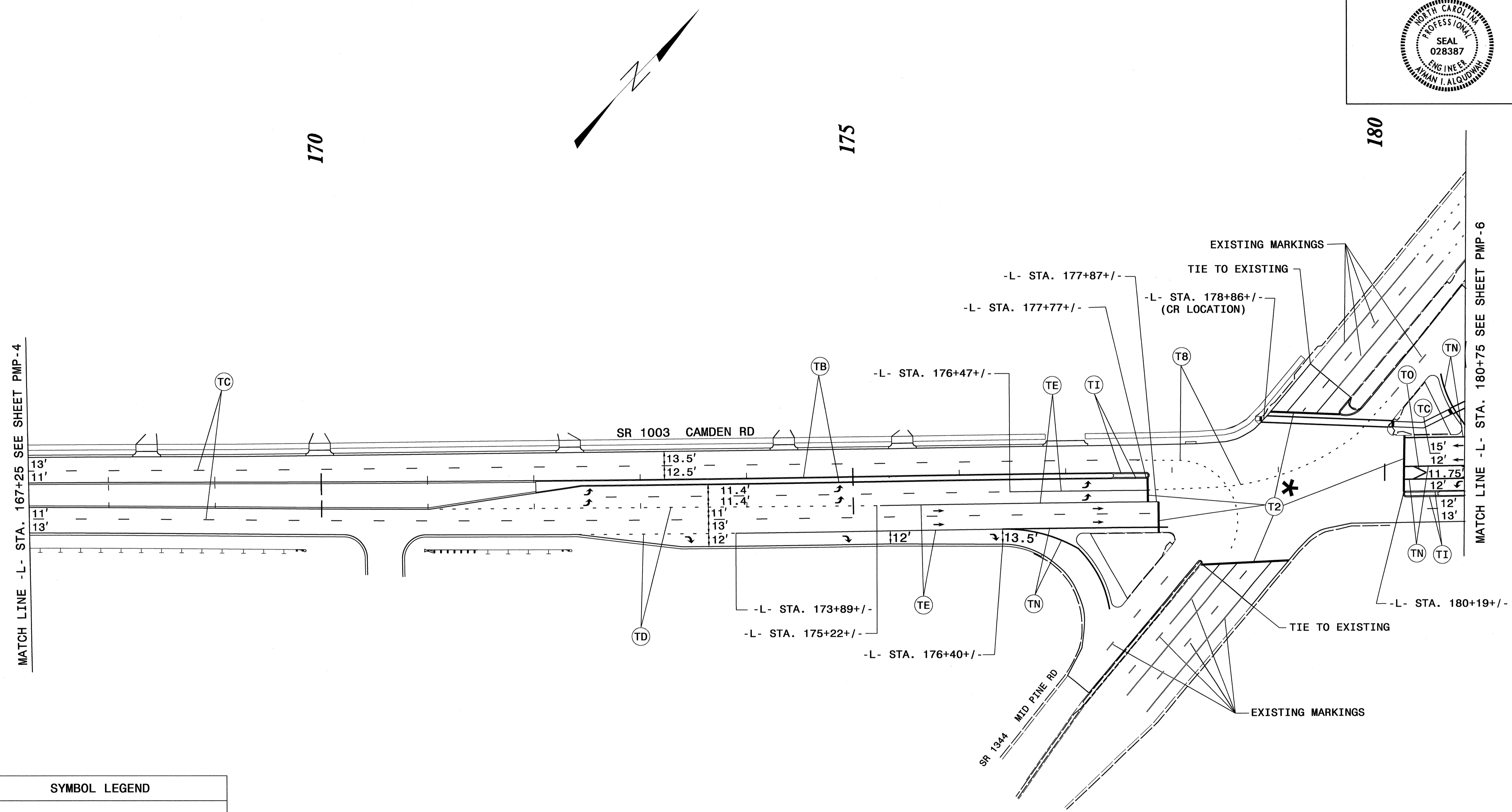

SYMBOL LEGEND	
	UA LEFT TURN ARROW
	UB RIGHT TURN ARROW
	UC STRAIGHT ARROW
	UE COMBO STRAIGHT/RIGHT ARROW
	UT U-TURN ARROW

PAVEMENT MARKING DETAIL

16-AUG-2013 15:55
 P:\TIP\U-2810C\U-2810C-Traffic\Signing\CADD\PMP\U2810C.pmp-psh5.dgn
 ericward_01 12/7/13

TIP NO. U-2810C	SHEET NO. PMP-6
APPROVED: <i>[Signature]</i>	
DATE: 8-29-13	
SEAL	

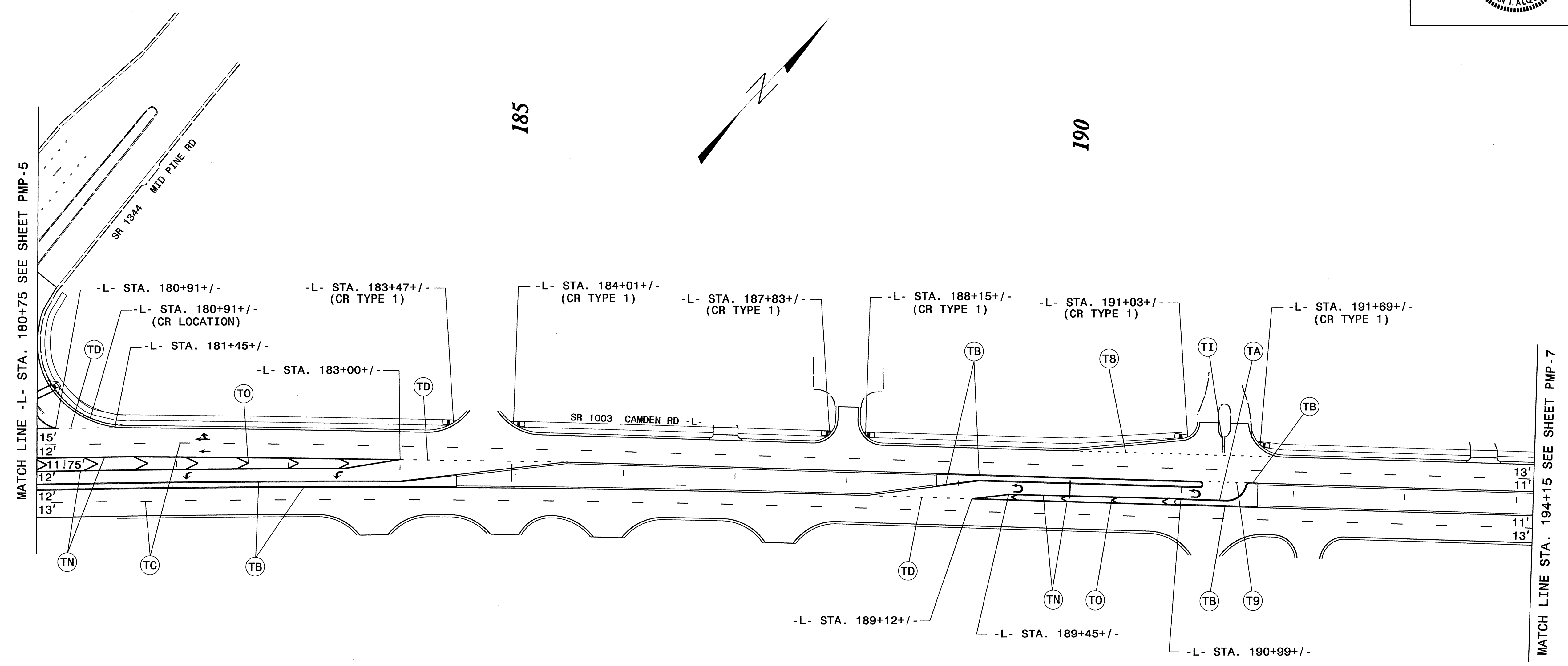

SYMBOL LEGEND	
	UA LEFT TURN ARROW
	UB RIGHT TURN ARROW
	UC STRAIGHT ARROW
	UE COMBO STRAIGHT/RIGHT ARROW
	UT U-TURN ARROW

PAVEMENT MARKING DETAIL

2013.08.29 14:27
 C:\Users\joe\Documents\Projects\2810C\Traffic\Signing\CADD\PMU\2810c.pmp_psh6.dgn
 ericward

TIP NO. U-2810C	SHEET NO. PMP-7
APPROVED: <i>[Signature]</i>	
DATE: 8-29-15	
SEAL	



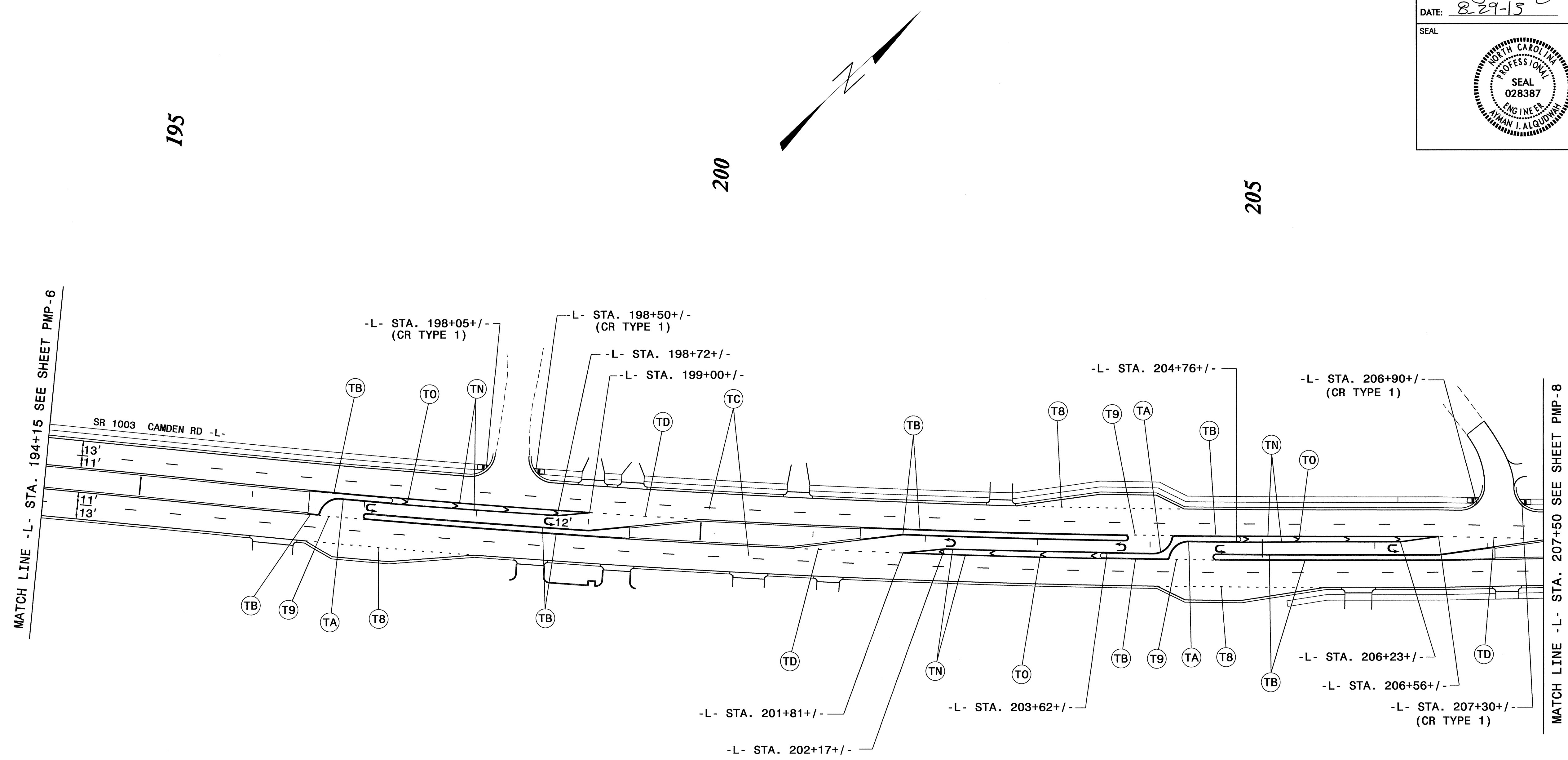

195

200

205

MATCH LINE -L- STA. 194+15 SEE SHEET PMP-6





MATCH LINE -L- STA. 207+50 SEE SHEET PMP-8

PAVEMENT MARKING DETAIL

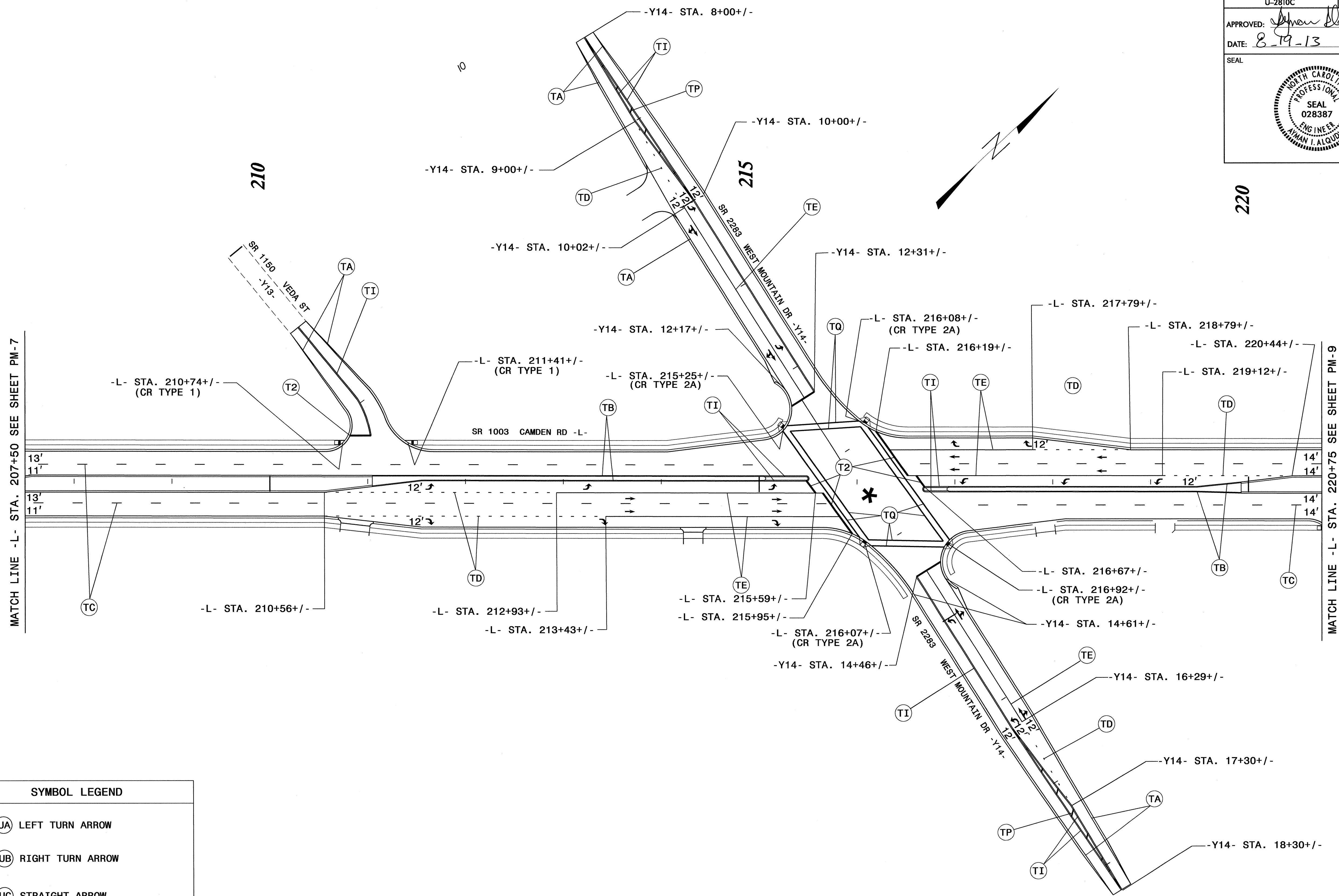
29-AUG-2015 14:04
 F:\projects\U2810C\Traffic\Signing\CADD\PMU2810C_pmp.psh7.dgn
 ericward AT TE274817

TIP NO. U-2810C	SHEET NO. PMP-8
APPROVED: <i>[Signature]</i>	
DATE: 8-19-13	
SEAL	
	



SYMBOL LEGEND	
	UA LEFT TURN ARROW
	UB RIGHT TURN ARROW
	UC STRAIGHT ARROW
	UE COMBO STRAIGHT/RIGHT ARROW
	UT U-TURN ARROW

PAVEMENT MARKING DETAIL

I9-AUG-2013 09:59
 P:\Projects\U2810C\Traffic\Signing\CADD\PM-PMP-U2810C_pmp-psh8.dgn
 ericward AT TE27417

TIP NO. U-2810C	SHEET NO. PMP-9
APPROVED: <i>Syman Alqubabi</i>	
DATE: 9-27-13	
SEAL	

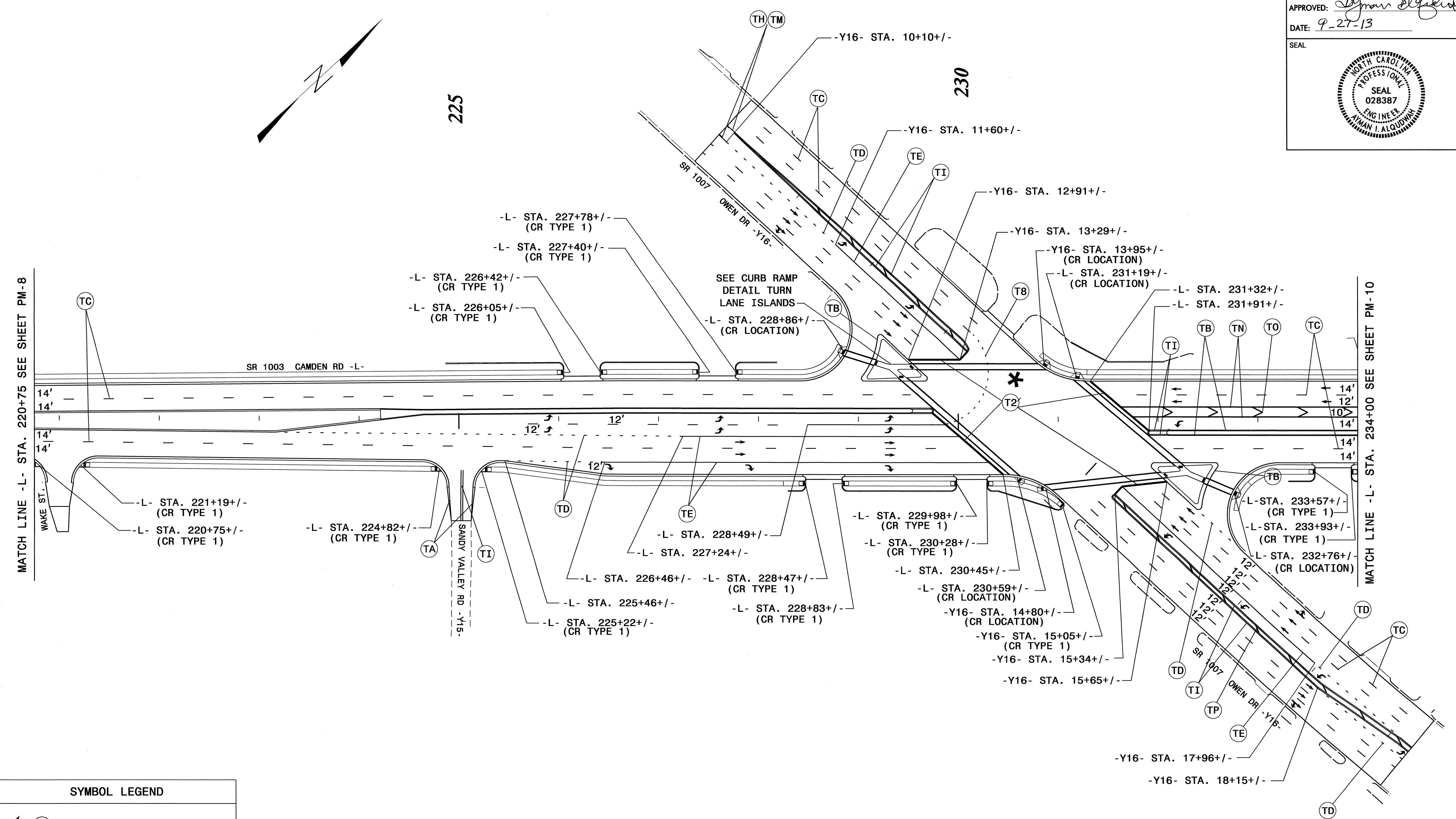

SYMBOL LEGEND	
	(UA) LEFT TURN ARROW
	(UB) RIGHT TURN ARROW
	(UC) STRAIGHT ARROW
	(UE) COMBO STRAIGHT/RIGHT ARROW
	(UT) U-TURN ARROW

PAVEMENT MARKING DETAIL





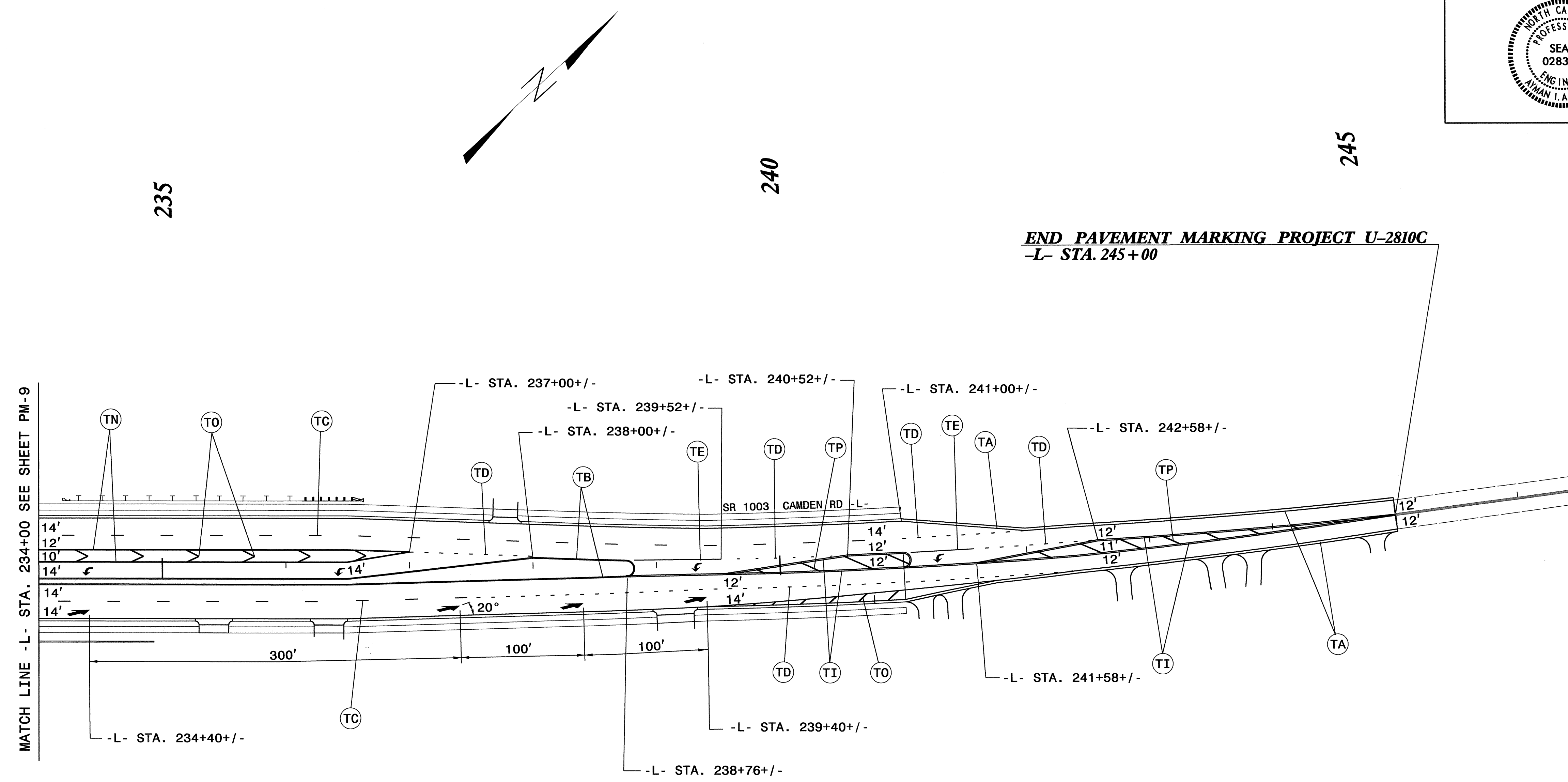

27-SEP-2013 10:26
 R:\TIP\Projects\U2810C\Traffic\Signting\CADD\PM\U2810C.pmp-psh9.dgn
 ericward AT TE274517

TIP NO. U-2810C	SHEET NO. PMP-10
APPROVED: <i>[Signature]</i>	
DATE: 9-27-13	
SEAL	
	



END PAVEMENT MARKING PROJECT U-2810C
-L- STA. 245+00

MATCH LINE -L- STA. 234+00 SEE SHEET PM-9

SYMBOL LEGEND	
	(UA) LEFT TURN ARROW
	(UB) RIGHT TURN ARROW
	(UC) STRAIGHT ARROW
	(UE) COMBO STRAIGHT/RIGHT ARROW
	(UT) U-TURN ARROW
	(UT) MERGE ARROW

PAVEMENT MARKING DETAIL

27-SEP-2013 08:17
 F:\TIP\Projects\U-2810C\Traffic\Signaling\CADD\PM\U2810C_pmp_psh10.dgn
 ericward - AT 1E274517