

T.I.P.: R-4750

CONTRACT: C202664

**STATE OF NORTH CAROLINA
DEPARTMENT OF TRANSPORTATION**

**PAVEMENT MARKING PLAN
DAVIDSON COUNTY**

TIP NO. R-4750	SHEET NO. PMP-1
APPROVED:	
DATE: 6/27/13	

ROADWAY STANDARD DRAWING

THE FOLLOWING ROADWAY STANDARDS AS APPEAR IN "ROADWAY STANDARD DRAWINGS" - PROJECT SERVICES UNIT - N.C. DEPARTMENT OF TRANSPORTATION - RALEIGH, N.C., DATED JANUARY 2012 ARE APPLICABLE TO THIS PROJECT AND BY REFERENCE HEREBY ARE CONSIDERED A PART OF THESE PLANS:

STD. NO.	TITLE
1205.01	PAVEMENT MARKINGS - LINE TYPES AND OFFSETS
1205.02	PAVEMENT MARKINGS - TWO-LANE AND MULTILANE ROADWAYS
1205.03	PAVEMENT MARKINGS - EXIT AND ENTRANCE RAMPS
1205.04	PAVEMENT MARKINGS - INTERSECTIONS
1205.08	PAVEMENT MARKINGS - SYMBOLS AND WORD MESSAGES
1205.09	PAVEMENT MARKINGS - PAINTED ISLANDS
1250.01	RAISED PAVEMENT MARKERS - INSTALLATION SPACING
1251.01	RAISED PAVEMENT MARKERS - PERMANENT AND TEMPORARY
1253.01	RAISED PAVEMENT MARKERS - SNOWPLOWABLE
1261.01	GUARDRAIL AND BARRIER DELINEATORS - INSTALLATION SPACING
1261.02	GUARDRAIL AND BARRIER DELINEATORS - TYPES AND MOUNTING
1262.01	GUARDRAIL END DELINEATION
1264.01	OBJECT MARKERS - TYPES
1264.02	OBJECT MARKERS - INSTALLATION
1267.01	FLEXIBLE DELINEATORS - INSTALLATION
1267.02	FLEXIBLE DELINEATORS - SPACING TABLES
1267.03	FLEXIBLE DELINEATORS - INTERCHANGE PLACEMENT

GENERAL NOTES

THE FOLLOWING GENERAL NOTES APPLY AT ALL TIMES FOR THE DURATION OF THE CONSTRUCTION PROJECT, EXCEPT WHEN OTHERWISE NOTED IN THE PLAN, OR DIRECTED BY THE ENGINEER.

- A) INSTALL PAVEMENT MARKINGS AND PAVEMENT MARKERS ON THE FINAL SURFACE AS FOLLOWS:

<u>ROAD NAME</u>	<u>MARKING</u>	<u>MARKER</u>
ALL ROADS	POLYUREA WITH HIGHLY REFLECTIVE ELEMENTS	SNOWPLOWABLE (I-85 BUS. ONLY)
- B) TIE PROPOSED PAVEMENT MARKING LINES TO EXISTING PAVEMENT MARKING LINES.
- C) REMOVE/REPLACE ANY CONFLICTING/DAMAGED PAVEMENT MARKINGS AND MARKERS.
- D) STOP BAR LOCATION AT NON-SIGNALIZED INTERSECTIONS MAY BE ADJUSTED AS DIRECTED BY THE ENGINEER.
- E) REMOVE ALL RESIDUE AND SURFACE LAITANCE BY ACCEPTABLE METHODS ON CONCRETE BRIDGE DECKS PRIOR TO PLACING POLYUREA PAVEMENT MARKING MATERIAL.
- F) USE FLEXIBLE DELINEATORS ON LEFT SIDE OF LOOPS AND RIGHT SIDE OF RAMPS IN LOCATIONS WHERE THERE IS NO GUARDRAIL OR OTHER DELINEATION.

PAVEMENT MARKING SCHEDULE

SYMBOL	DESCRIPTION
THERMOPLASTIC(24", 120 MILS)	
T2	WHITE STOPBAR
POLYUREA(4")	
VA	WHITE EDGELINE
VC	10 FT. WHITE SKIP (4")
VE	WHITE SOLID LANE LINE
VI	YELLOW DOUBLE CENTER
V8	2 FT. - 6 FT./SP WHITE MINISKIP
POLYUREA(6")	
V6	WHITE EDGELINE
V7	YELLOW EDGELINE
V11	2 FT. - 6 FT./SP WHITE MINISKIP
VJ	10 FT. WHITE SKIP
POLYUREA(12")	
VS	WHITE GORELINE
VT	WHITE SOLID LANE LINE
THERMOPLASTIC PAVEMENT MARKING SYMBOLS (90 MILS)	
UP	MERGE ARROW
UN	24" YIELD LINE TRIANGLE
<u>MARKERS</u>	
SNOWPLOWABLE RAISED PAVEMENT MARKERS	
ME	YELLOW & YELLOW
MF	CRYSTAL & RED

INDEX

SHEET NO.	DESCRIPTION
PMP-1	PAVEMENT MARKING PLAN COVER SHEET AND PAVEMENT MARKING SCHEDULE
PMP-2-13	PAVEMENT MARKING DETAILS

PLAN PREPARED BY: Ramey Kemp & Associates

W. JASON HAMILTON PROJECT MANAGER
NICHOLAS E. BURNS PROJECT ENGINEER



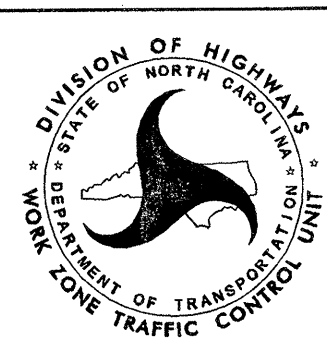

PLAN REVIEWED BY: N.C.D.O.T. SIGNING AND DELINEATION UNIT

SUSAN KUNZ SIGNING & DELINEATION REGIONAL ENGINEER
STACEY JOHNS SIGNING & DELINEATION DESIGN ENGINEER

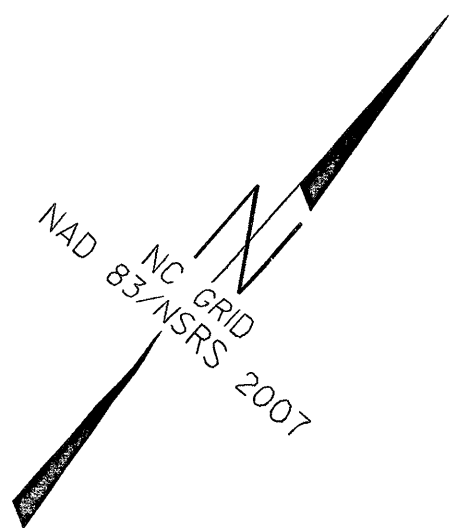
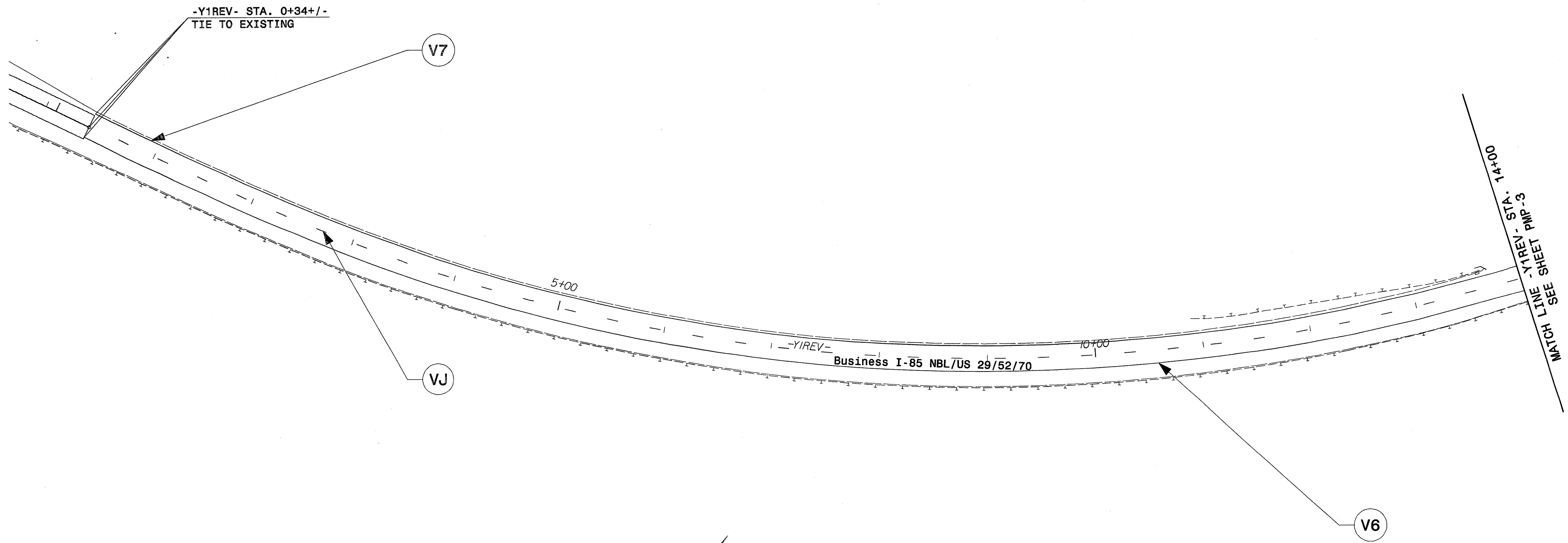

TIP NO. R-4750	SHEET NO. PMP-2
APPROVED: <i>WJH</i>	
DATE: 6/27/13	
SEAL	
	



Prepared in the offices of:

RAMEY KEMP ASSOCIATES, INC.
 Transportation Engineers
 6008 Farrington Place, Suite 100
 Raleigh, North Carolina 27609
 919-872-9119 Tel. 919-879-4418 Fax.
 www.rkemp.com

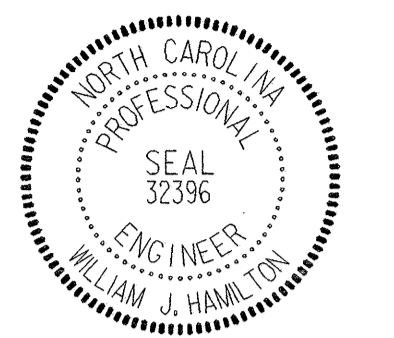
PAVEMENT MARKING DETAIL

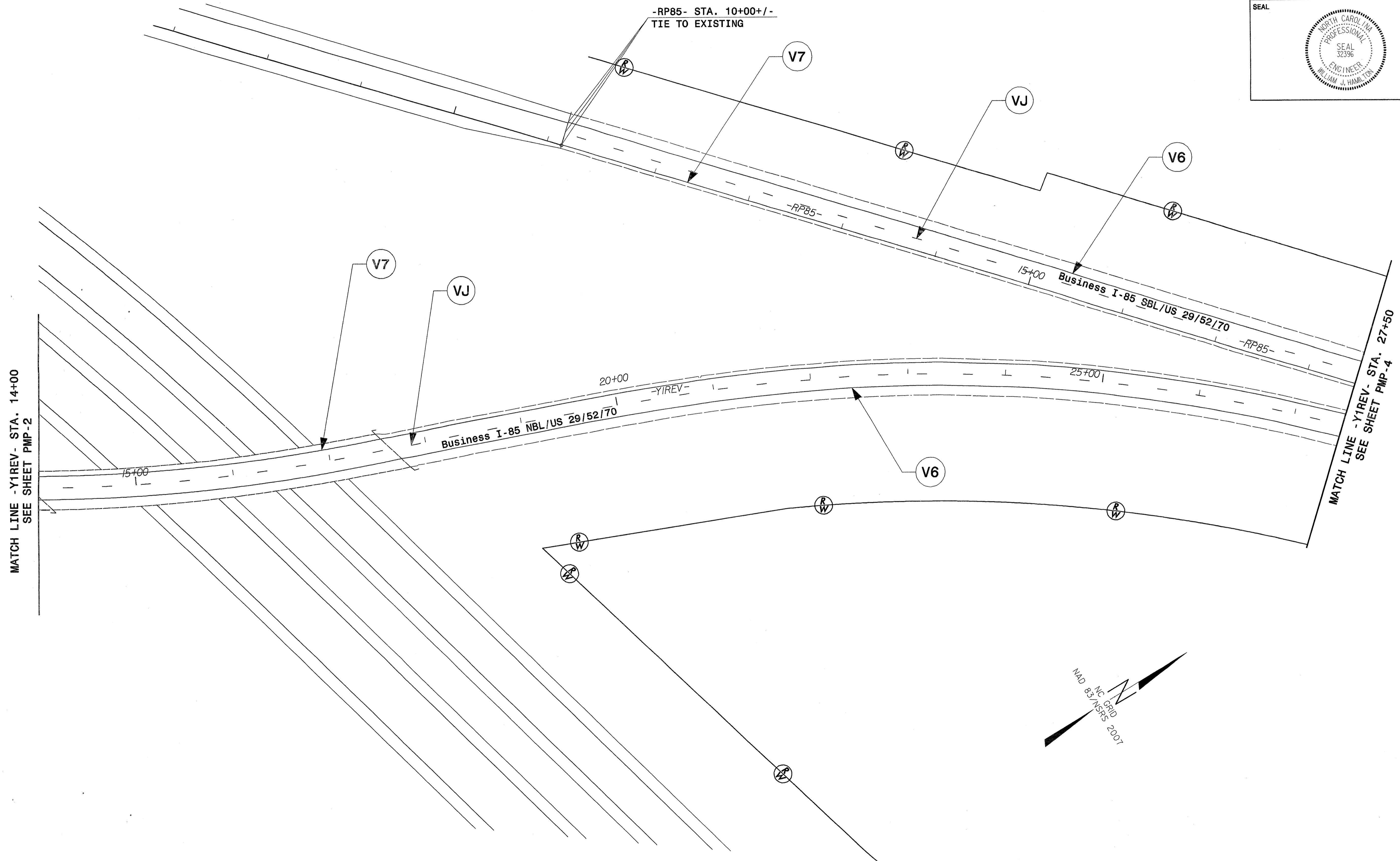
TIP NO. R-4750	SHEET NO. PMP-3
APPROVED: <i>WJH</i>	
DATE: 6/27/13	
SEAL	
	



MATCH LINE -Y1REV- STA. 14+00
SEE SHEET PMP-2

MATCH LINE -Y1REV- STA. 27+50
SEE SHEET PMP-4

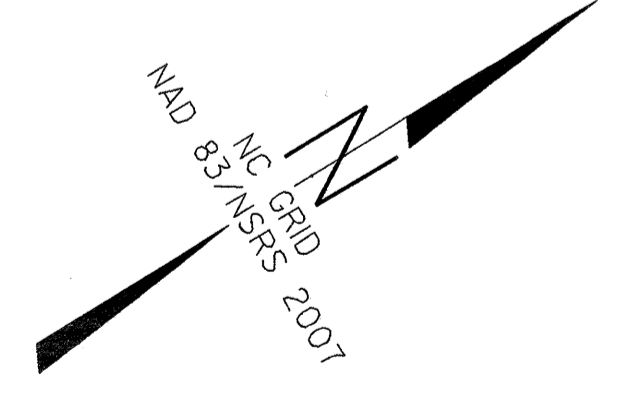

Prepared in the offices of:

RAMEY KEMP ASSOCIATES, INC.
 Transportation Engineers
 1808 Parkington Place, Suite 100
 Raleigh, North Carolina 27609
 919-872-2616 Tel. 919-870-8410 Fax
 www.rameykemp.com

PAVEMENT MARKING DETAIL

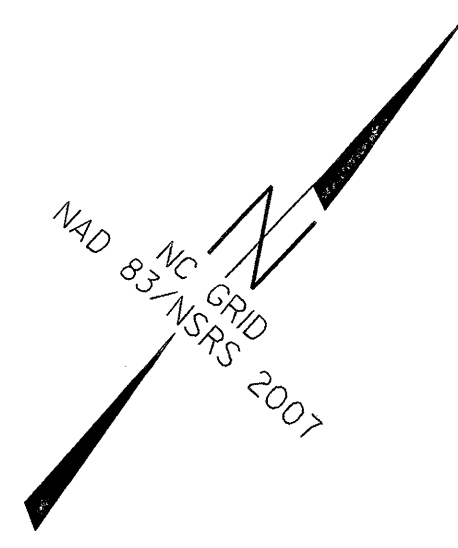
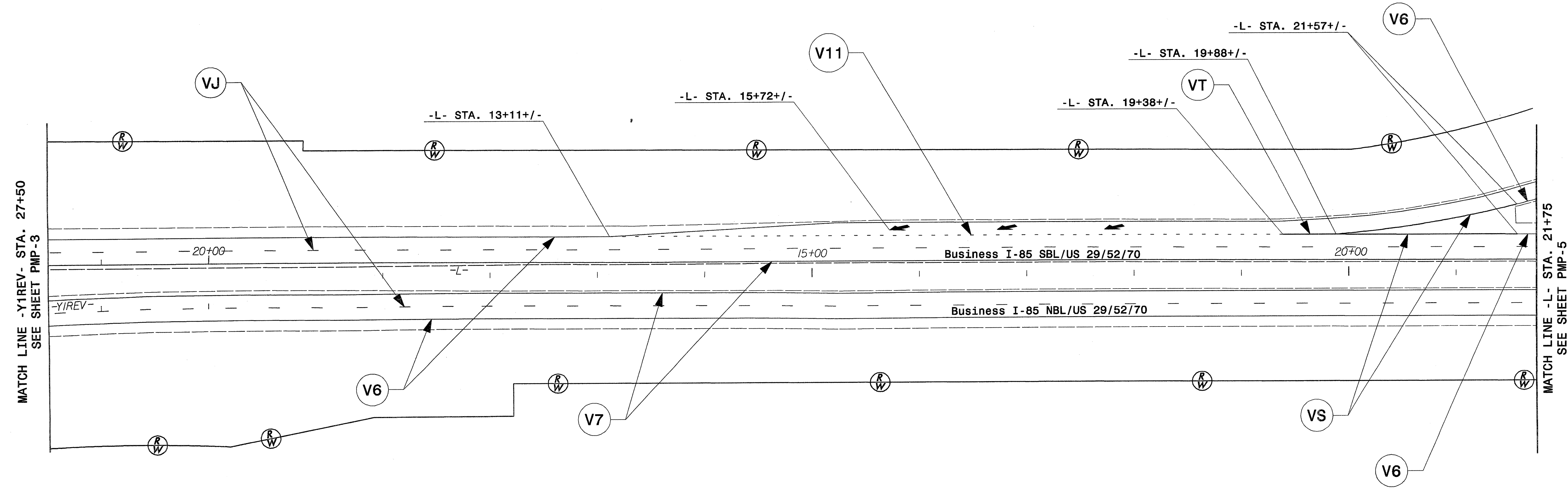
TIP NO. R-4750	SHEET NO. PMP-4
APPROVED: <i>WJH</i>	
DATE: 6/27/13	
SEAL	
	



Prepared in the offices of:

RAMEY KEMP ASSOCIATES, INC.
 PROFESSIONAL ENGINEERS
 608 Parkington Place, Suite 100
 Raleigh, North Carolina 27609
 919-872-8115 Tel. 919-870-6418 Fax.
 www.rameykemp.com

PAVEMENT MARKING DETAIL

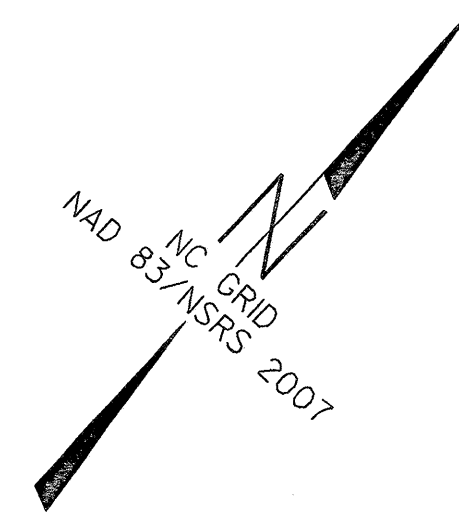
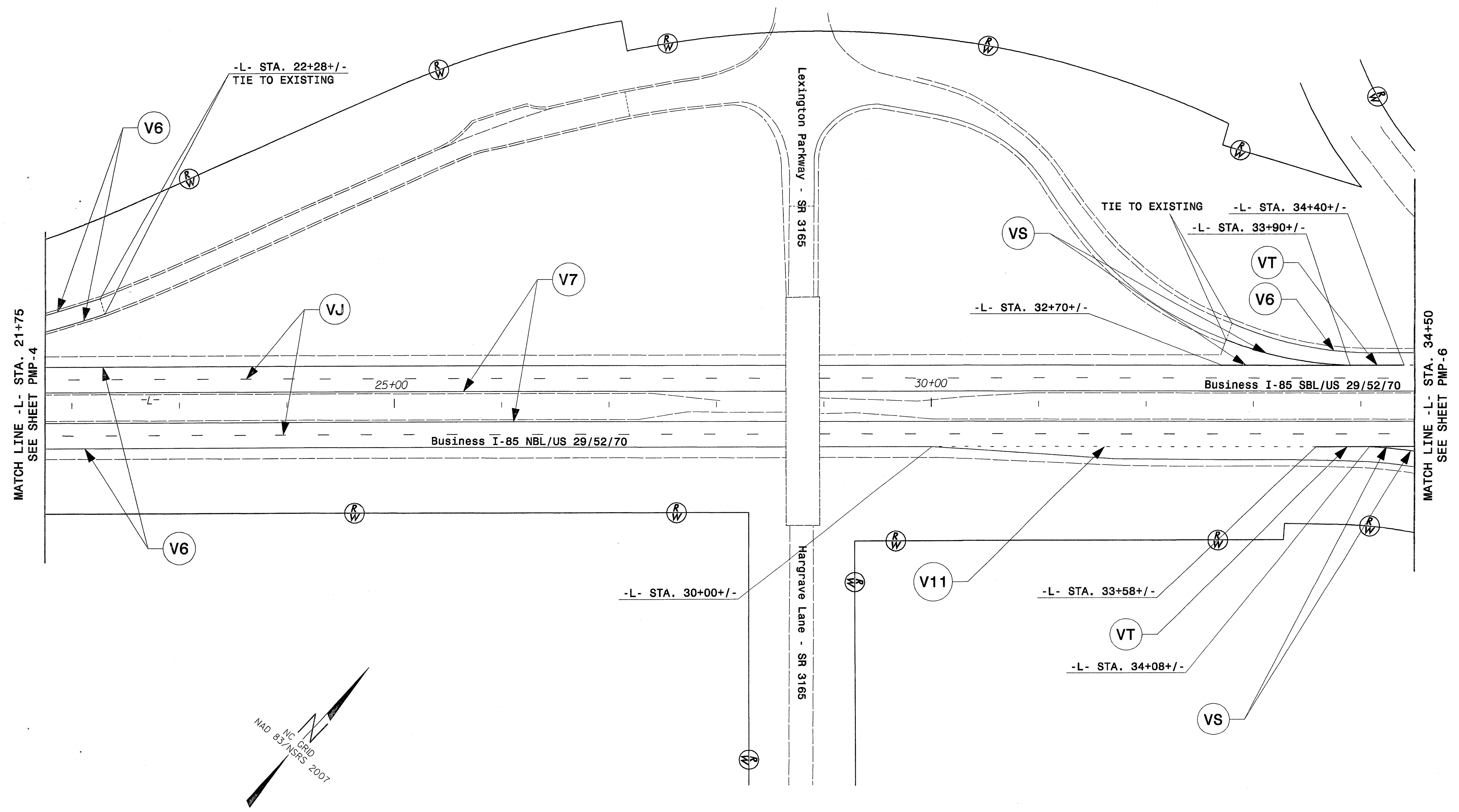
TIP NO.	SHEET NO.
R-4750	PMP-5
APPROVED:	<i>[Signature]</i>
DATE:	6/27/13
SEAL	



Prepared in the offices of:

RAMEY KEMP ASSOCIATES, INC.
 Transportation Engineers
 8005 Parkington Place, Suite 100
 Raleigh, North Carolina 27616
 919-872-8616 Tel. 919-876-8410 Fax.
 www.rkeng.com

PAVEMENT MARKING DETAIL

TIP NO. R-4750	SHEET NO. PMP-6
APPROVED: <i>[Signature]</i>	
DATE: 6/27/13	
SEAL	
	

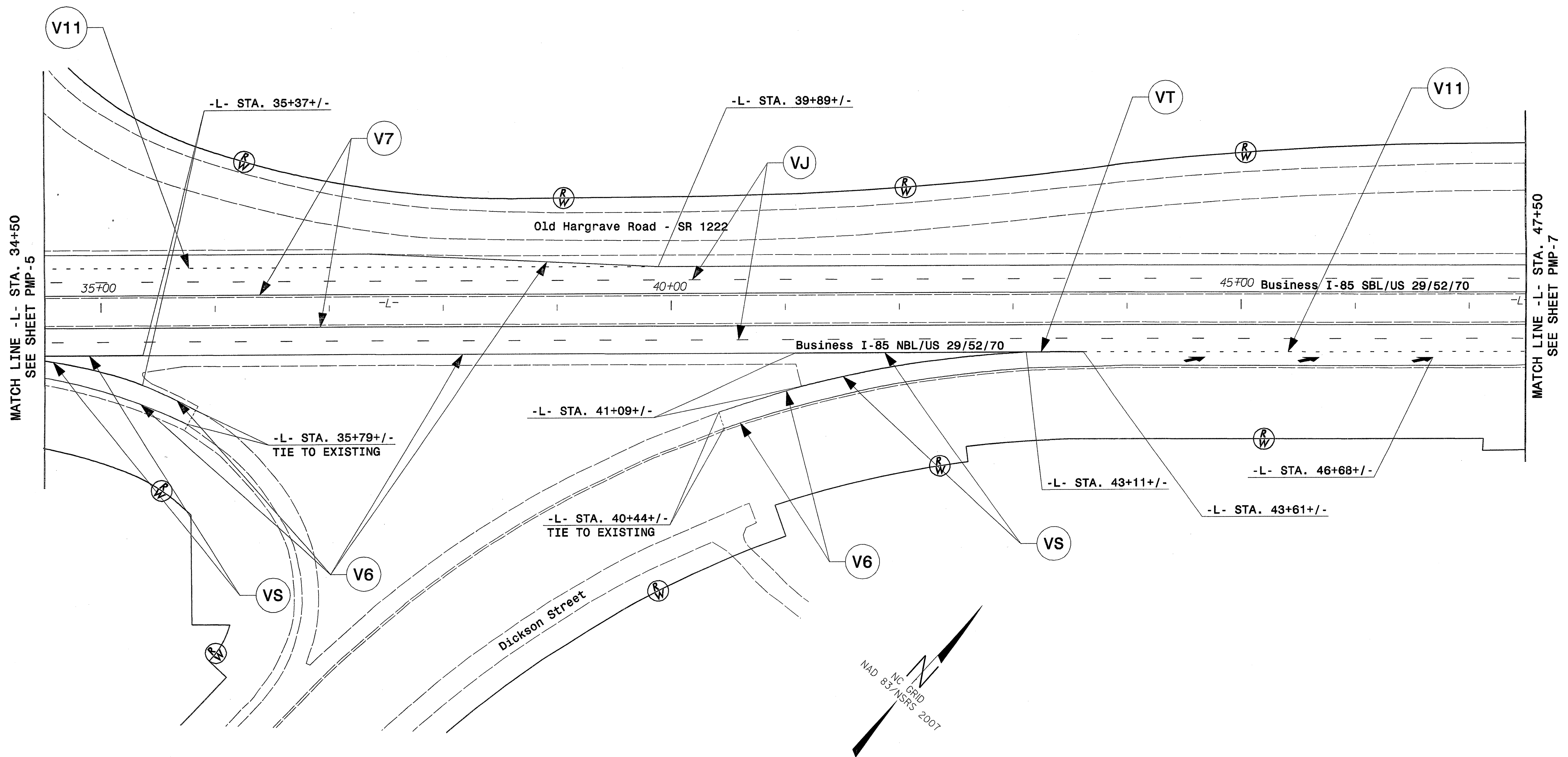

Prepared in the offices of:

RAMEY KEMP ASSOCIATES, INC.
TRANSPORTATION ENGINEERS
 8800 Parkington Place, Suite 100
 Raleigh, North Carolina 27602
 919-872-8115 Tel. 919-875-6416 Fax.
 www.rameykemp.com

PAVEMENT MARKING DETAIL

TIP NO. R-4750	SHEET NO. PMP-7
APPROVED: <i>W. H. H.</i>	
DATE: 6/27/13	
SEAL	
	

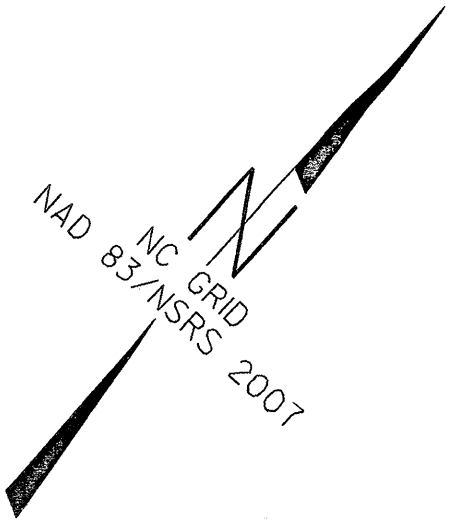
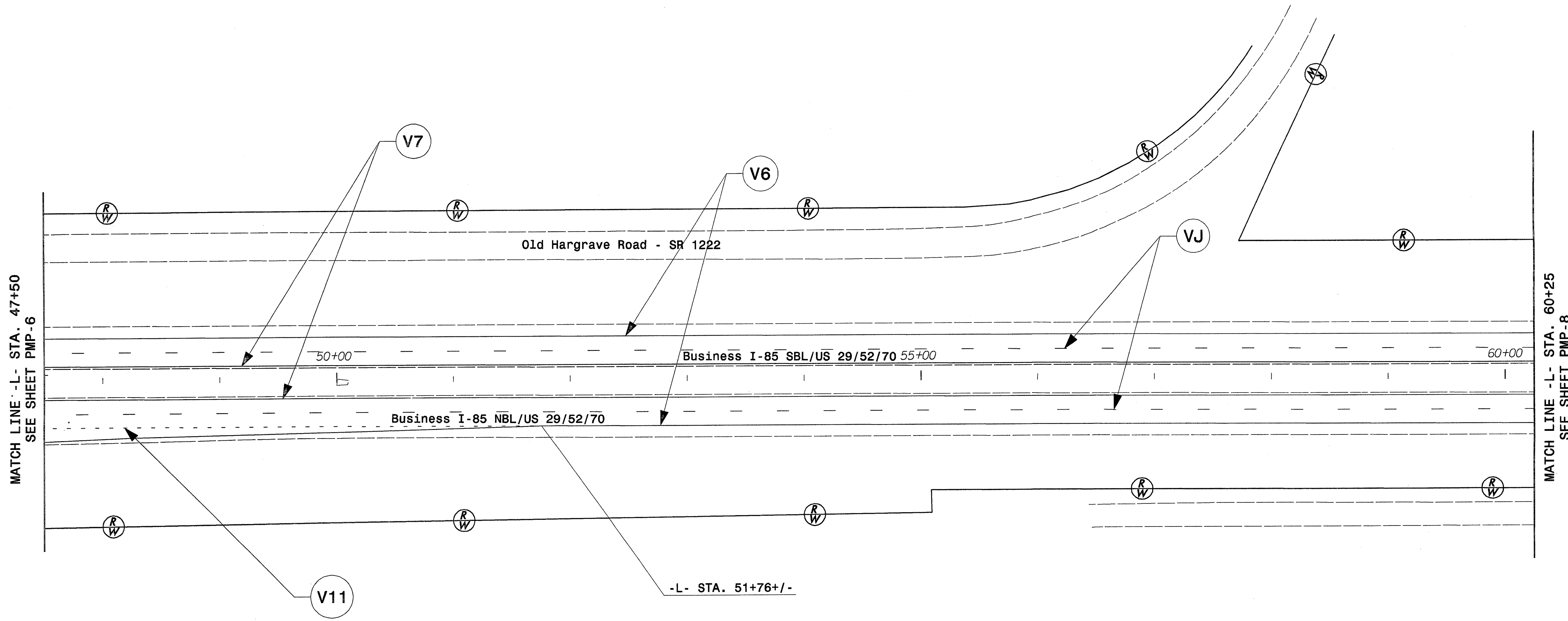

Prepared in the offices of:



RAMEY KEMP ASSOCIATES, INC.
 TRANSPORTATION ENGINEERS
 8008 Farrington Place, Suite 100
 Raleigh, North Carolina 27616
 919-872-2119 Tel. 919-872-6441 Fax
 www.rameykemp.com

PAVEMENT MARKING DETAIL

TIP NO. R-4750	SHEET NO. PMP-8
APPROVED: <i>[Signature]</i>	
DATE: 6/27/13	
SEAL	
	

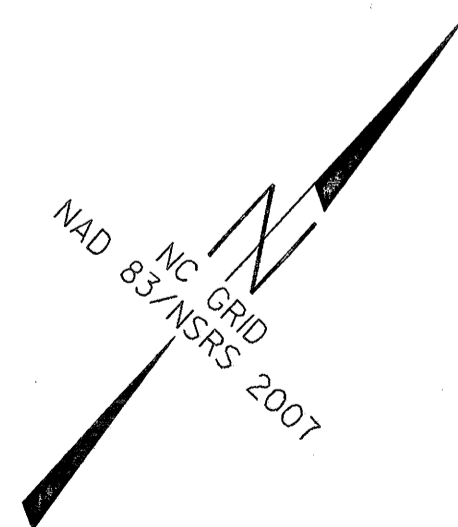
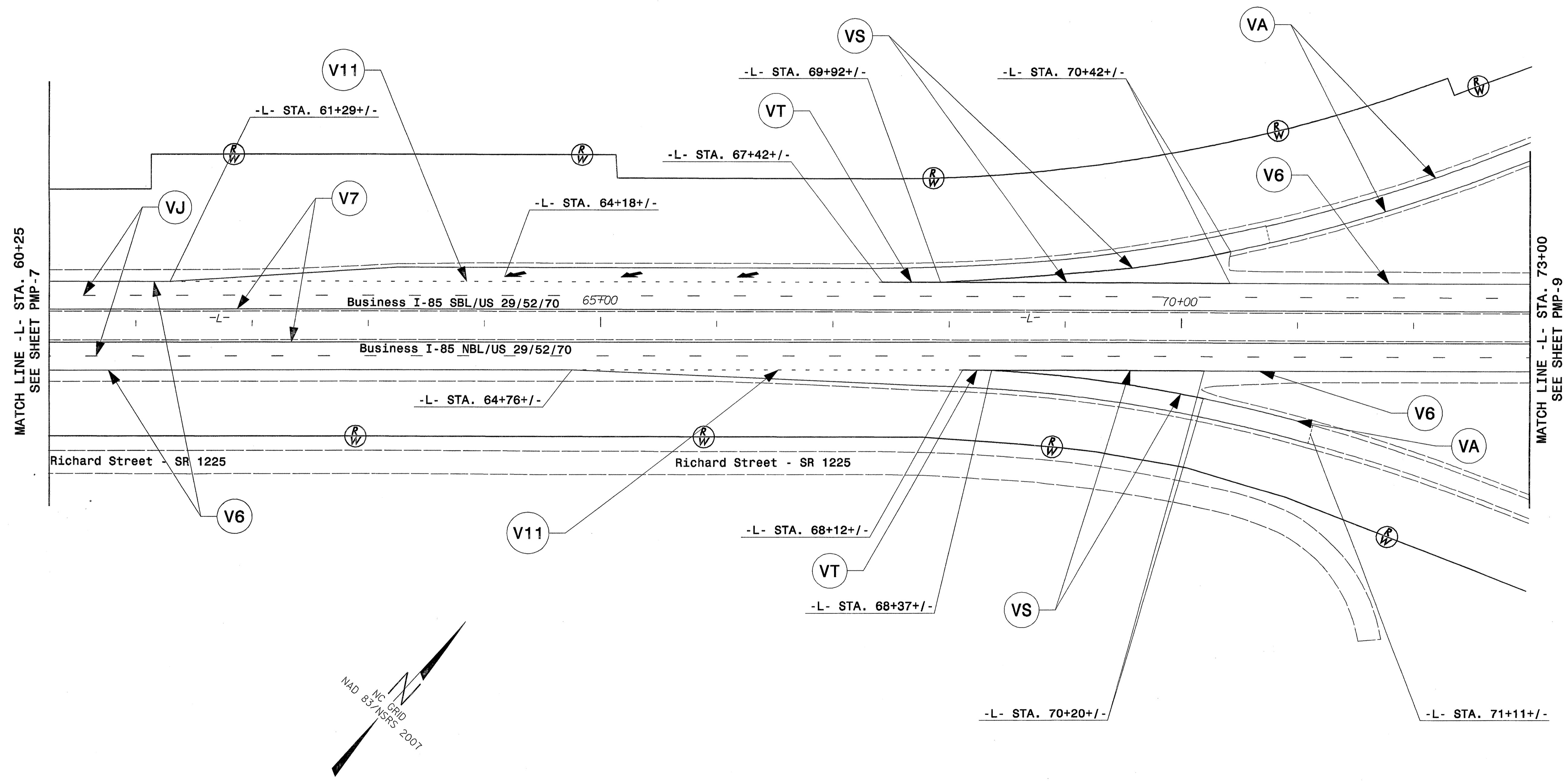

Prepared in the offices of:



RAMEY KEMP & ASSOCIATES, INC.
 Transportation Engineers
 9209 Parkside Place, Suite 100
 Raleigh, North Carolina 27609
 919-872-9115 Tel. 919-872-5441 Fax
 www.rameykemp.com

PAVEMENT MARKING DETAIL

TIP NO. R-4750	SHEET NO. PMP-9
APPROVED: <i>[Signature]</i>	
DATE: 6/29/13	
SEAL	

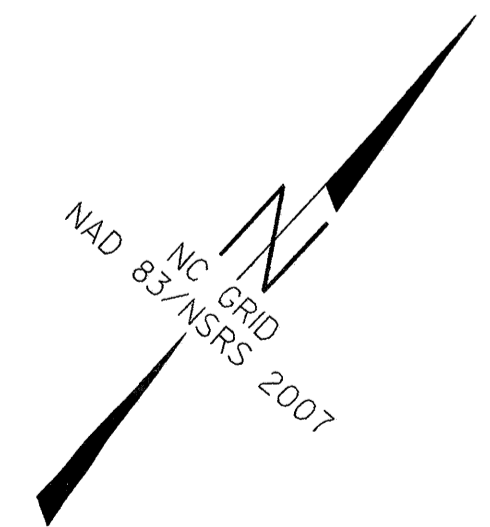
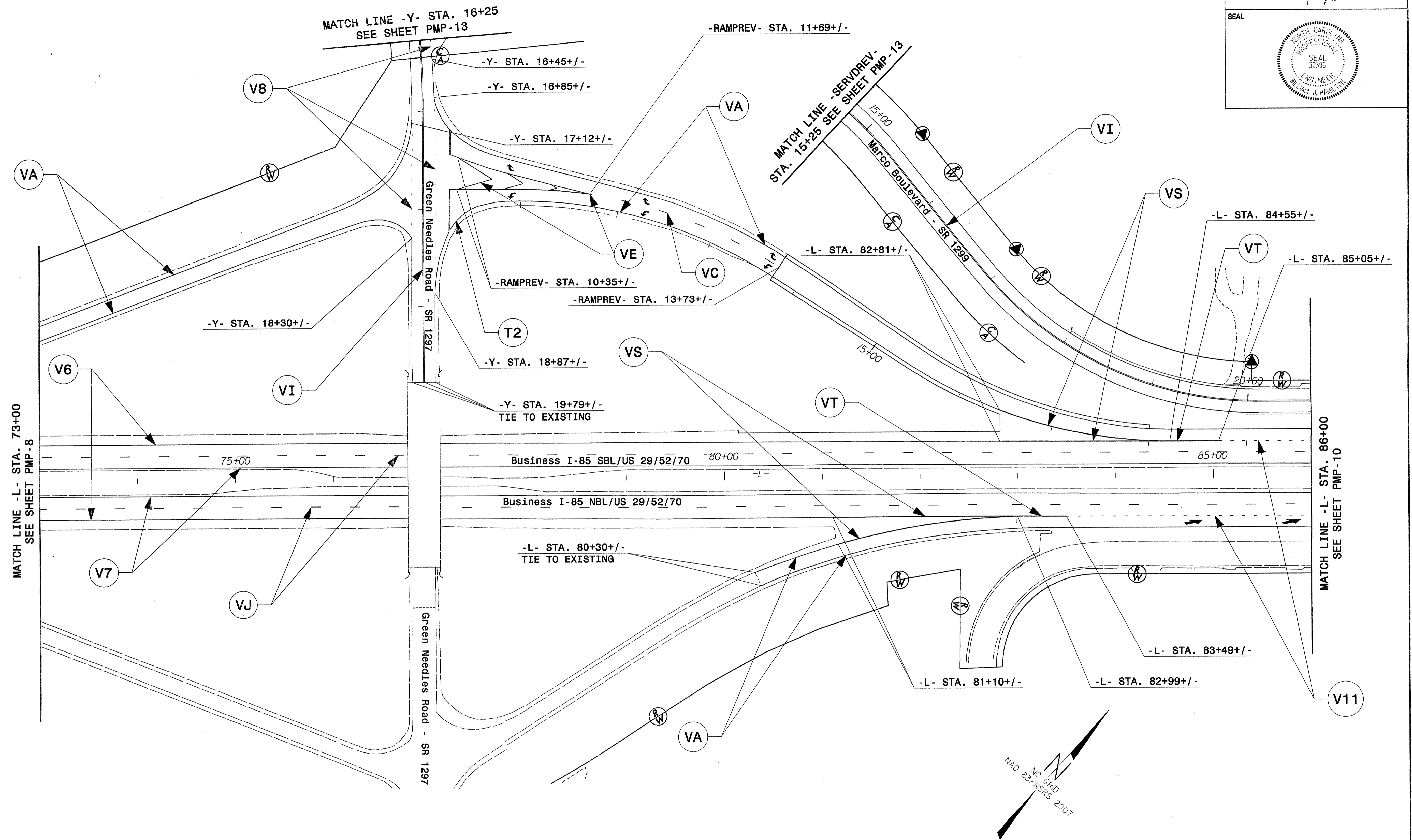

Prepared in the offices of:
RAMEY KEMP ASSOCIATES, INC.
 Transportation Engineers
 808 Parkington Place, Suite 100
 Raleigh, North Carolina 27609
 919-872-6115 Tel. 919-872-6418 Fax.
 www.rkeng.com

PAVEMENT MARKING DETAIL

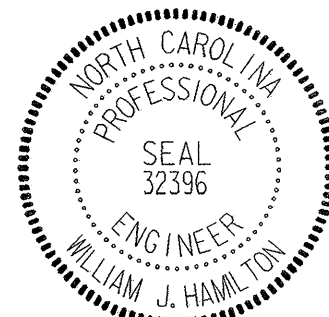
TIP NO. R-4750	SHEET NO. PMP-10
APPROVED: <i>WJH</i>	
DATE: 6/29/13	
SEAL	
	

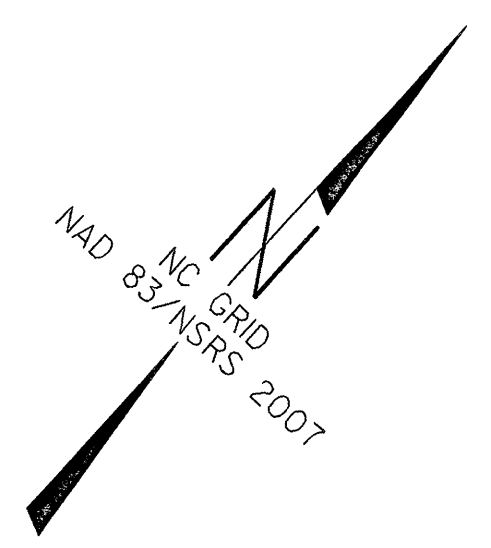
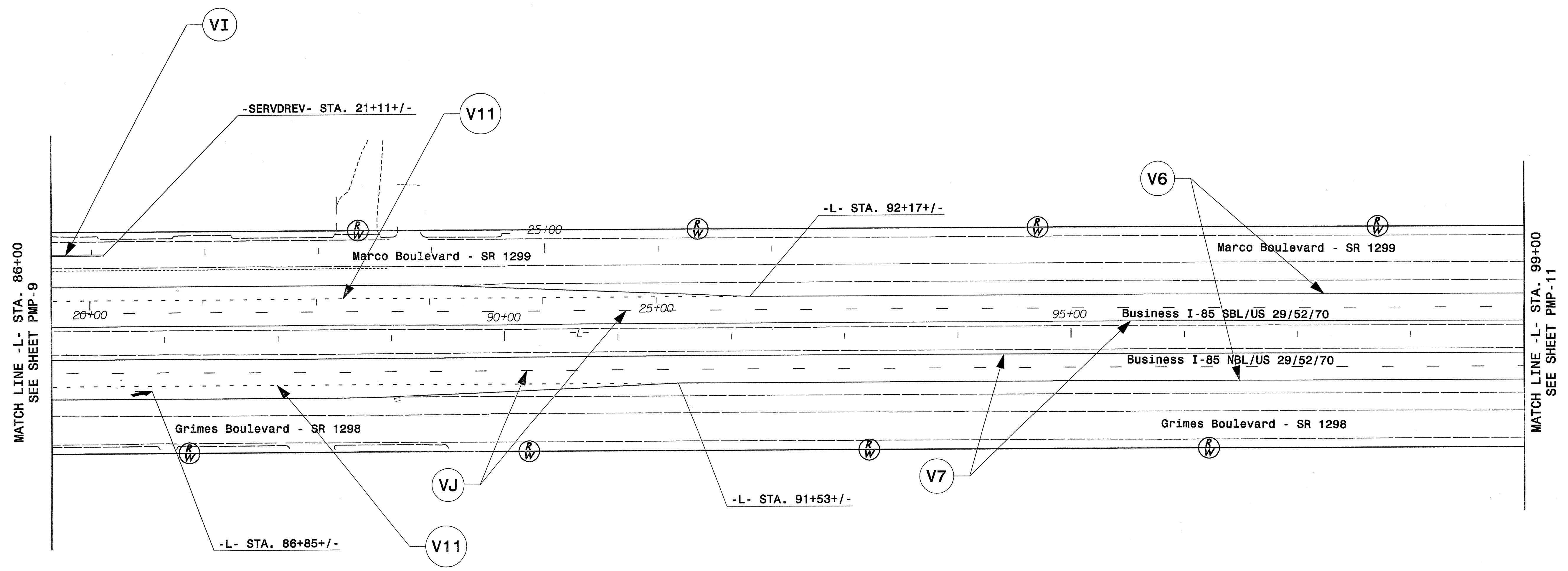

Prepared in the offices of:

RAMEY KEMP ASSOCIATES, INC.
TRANSPORTATION ENGINEERS
 8000 Farmington Place, Suite 100
 Raleigh, North Carolina 27607
 919-875-5175 FAX 919-875-5415
 www.rameykemp.com

PAVEMENT MARKING DETAIL

TIP NO. R-4750	SHEET NO. PMP-11
APPROVED: <i>WJH</i>	
DATE: 6/27/13	
SEAL	

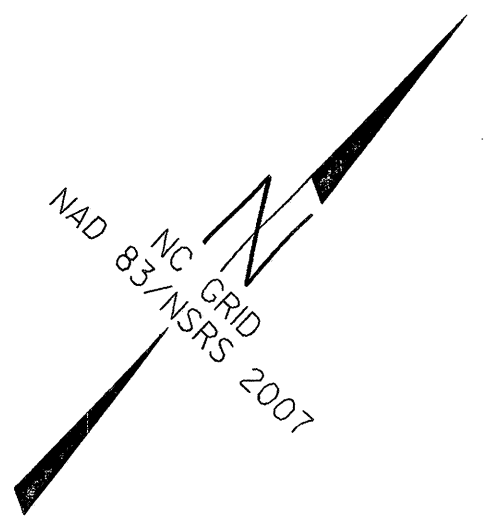
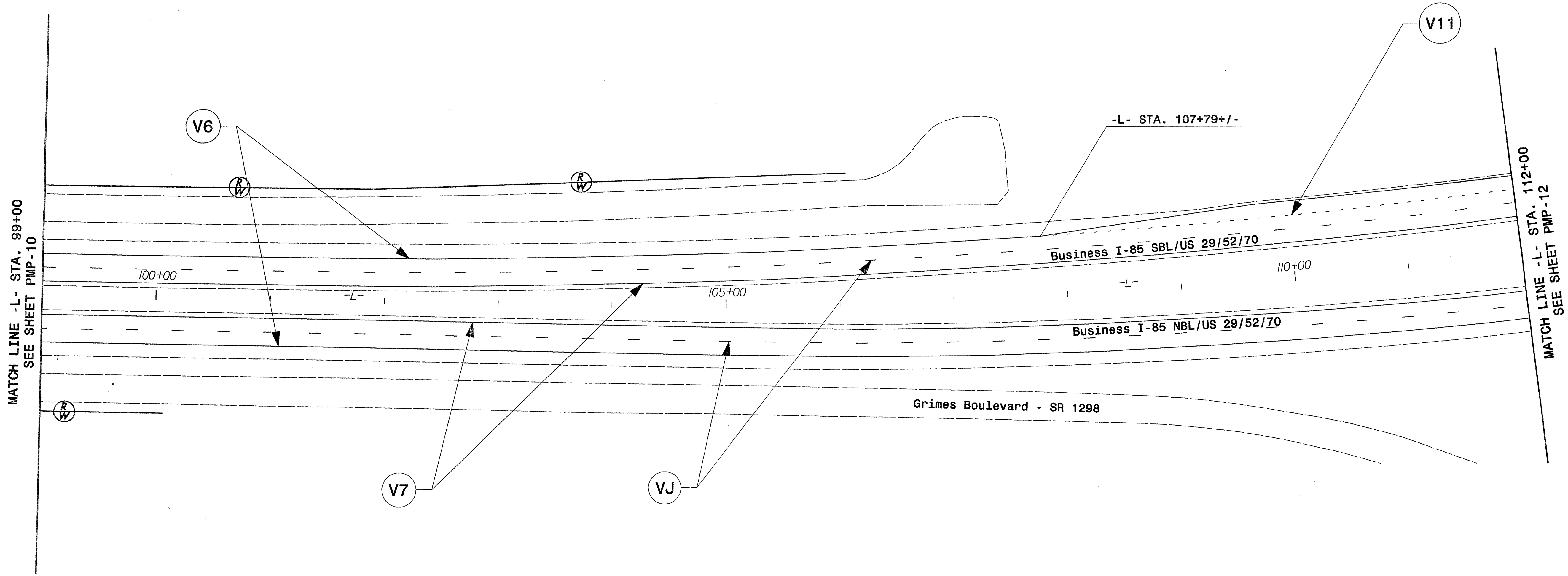

Prepared in the offices of:
RAMEY KEMP ASSOCIATES, INC.
 Transportation Engineers
 8000 Farrington Place, Suite 100
 Raleigh, North Carolina 27617
 919-872-5515 Tel. 919-870-6410 Fax
 www.rkemp.com

PAVEMENT MARKING DETAIL

TIP NO.	SHEET NO.
R-4750	PMP-12
APPROVED: <i>WJH</i>	
DATE: 6/22/13	
SEAL	
	

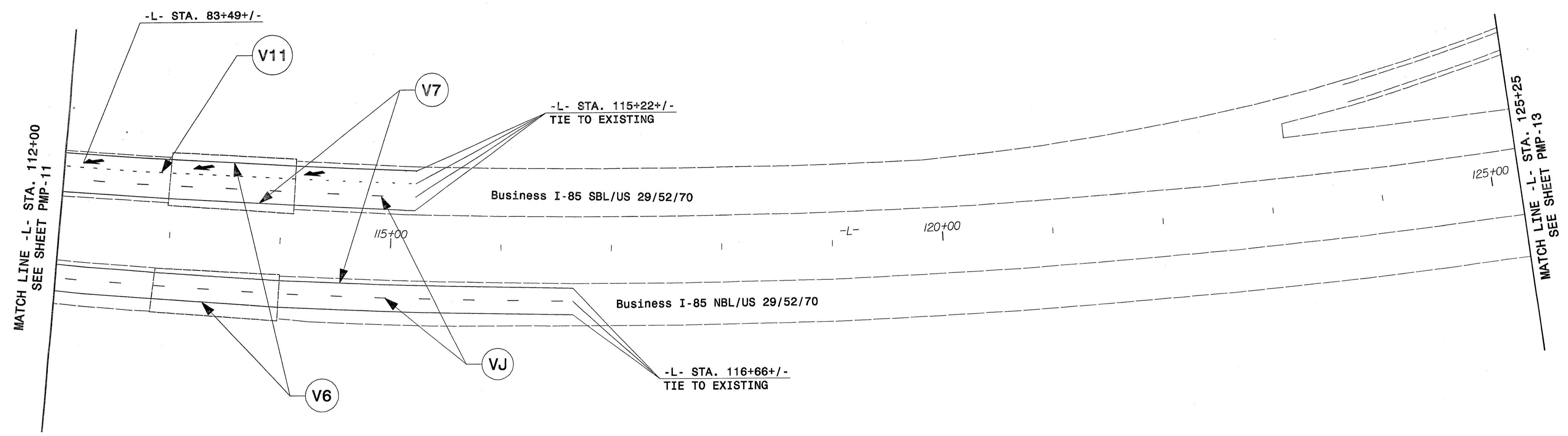



Prepared in the offices of:

RAMEY KEMP ASSOCIATES, INC.
 Transportation Engineers
 6008 Perfection Place, Suite 100
 Raleigh, North Carolina 27609
 919-475-5116 TEL 919-475-6414 FAX
 www.rameykemp.com

PAVEMENT MARKING DETAIL

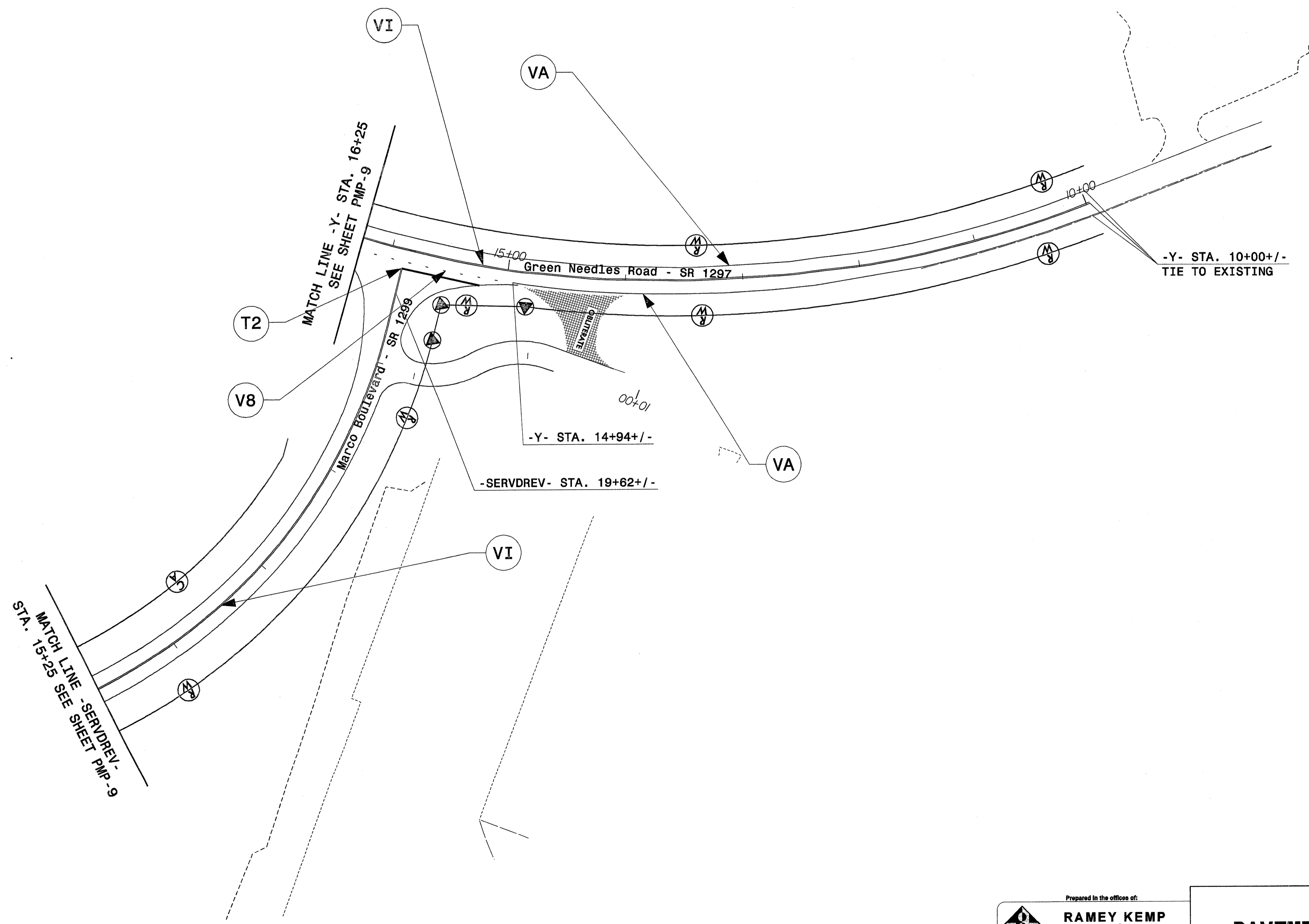
TIP NO. R-4750	SHEET NO. PMP-13
APPROVED: <i>[Signature]</i>	
DATE: 6/27/13	
SEAL	
	



Prepared in the office of:

RAMEY KEMP & ASSOCIATES, INC.
 TRANSPORTATION ENGINEERS
 8005 Pottersville Place, Suite 100
 Raleigh, North Carolina 27605
 919-872-8110 Tel. 919-872-6416 Fax
 www.rameykemp.com

PAVEMENT MARKING DETAIL