

STATE OF NORTH CAROLINA  
DIVISION OF HIGHWAYS

**TRANSPORTATION MANAGEMENT PLAN**

**ROBESON COUNTY**

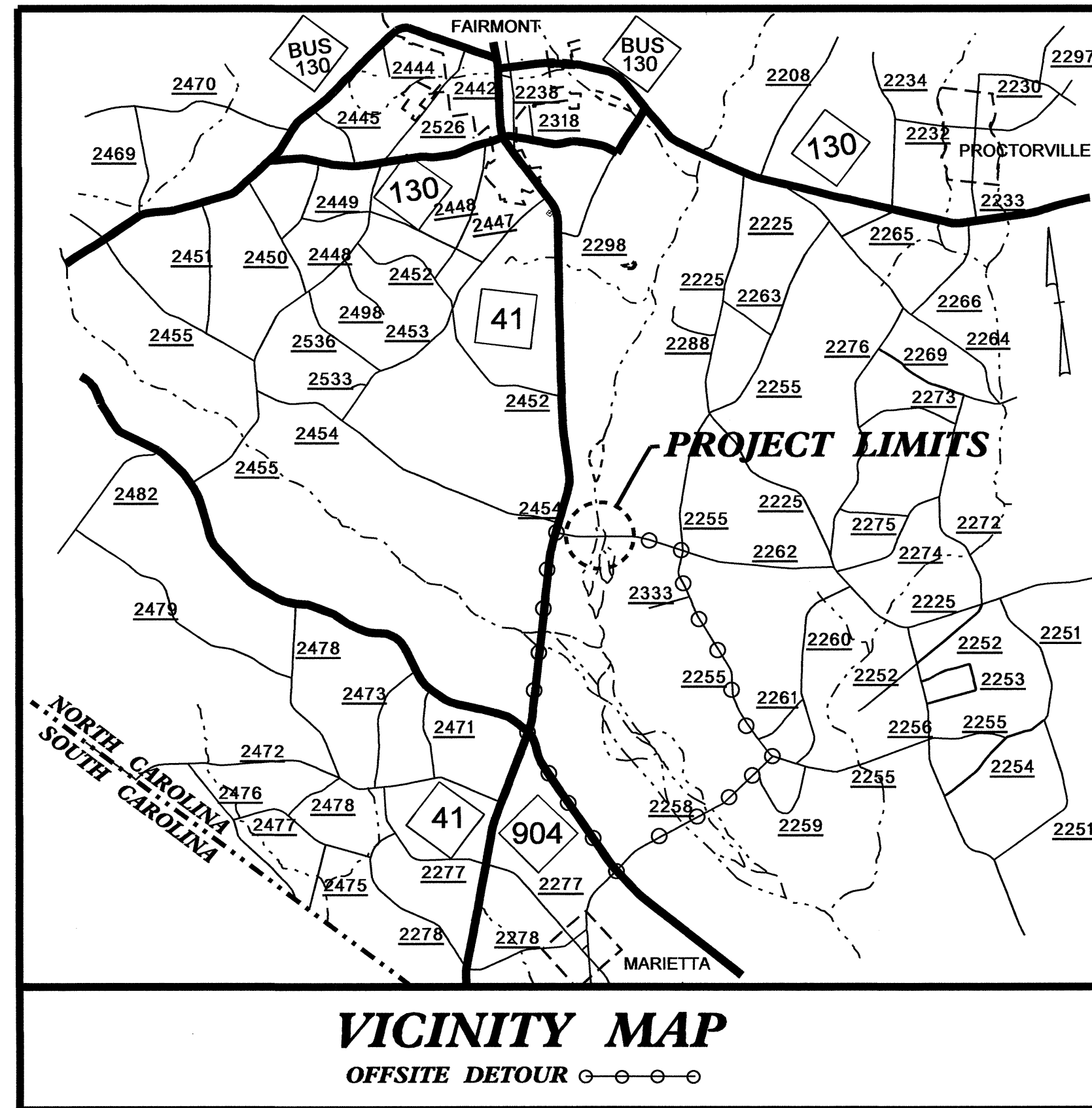
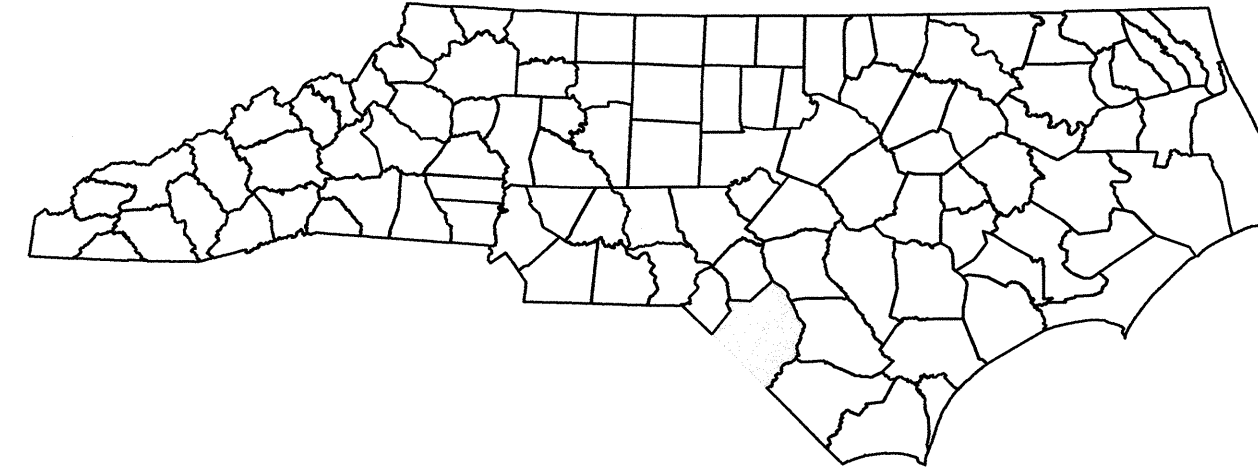

**INDEX OF SHEETS**

SHEET NO.	TITLE
TMP-1	TITLE SHEET, VICINITY MAP AND INDEX OF SHEETS
TMP-1A	LIST OF APPLICABLE ROADWAY STANDARD DRAWINGS, AND LEGEND
TMP-1B	TRANSPORTATION OPERATIONS PLAN: (MANAGEMENT STRATEGIES, GENERAL NOTES AND PHASING)
TMP-2	SPECIAL SIGN DESIGN
TMP-3	OFF-SITE DETOUR ROUTE AND BARRICADE PLACEMENT

SHEET NO.  
TMP-1

**B-4619**

**TIP PROJECT:**

13-MAR-2013 11:37  
 C:\DOT\WORK\TIP\Projects\B-4619\TrafficControl\B-4619-TC-TMP-1.dgn  
 submittings AT 12:26:58

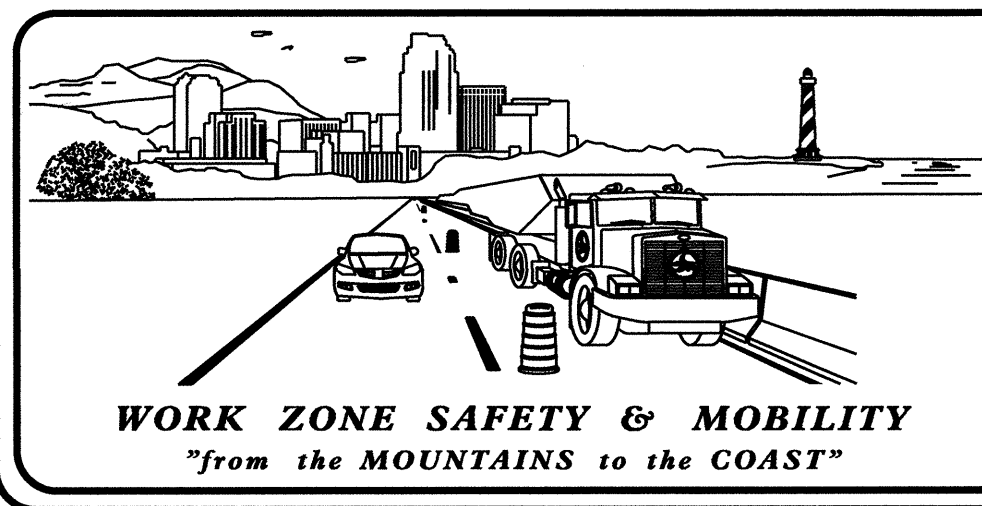

**N.C.D.O.T. WORK ZONE TRAFFIC CONTROL**  
 1561 MAIL SERVICE CENTER (MSC) RALEIGH, NC 27699-1561  
 750 N. GREENFIELD PARKWAY, GARNER, NC 27529 (DELIVERY)  
 PHONE: (919) 773-2800 FAX: (919) 771-2745

J. S. BOURNE, P.E. STATE TRAFFIC MANAGEMENT ENGINEER  
 J. S. KITE, P.E. TRAFFIC CONTROL PROJECT ENGINEER  
 DON PARKER TRAFFIC CONTROL PROJECT DESIGN ENGINEER  
 S. B. JENNINGS TRAFFIC CONTROL DESIGN ENGINEER

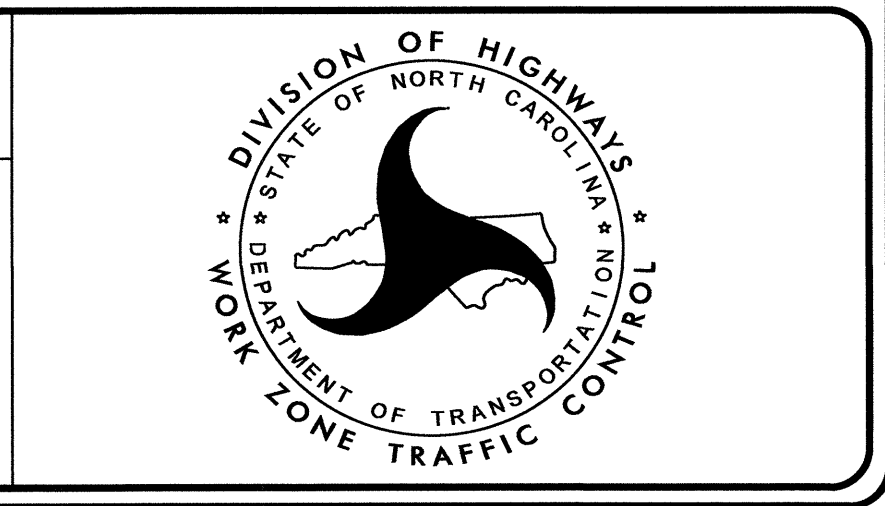

APPROVED: *[Signature]*  
 DATE: *March 14, 2013*

## ROADWAY STANDARD DRAWINGS

THE FOLLOWING ROADWAY STANDARDS AS SHOWN IN "ROADWAY STANDARD DRAWINGS" - PROJECT SERVICES UNIT - N.C. DEPARTMENT OF TRANSPORTATION - RALEIGH, N.C., DATED JANUARY 2012 ARE APPLICABLE TO THIS PROJECT AND BY REFERENCE HEREBY ARE CONSIDERED A PART OF THESE PLANS:

<u>STD. NO.</u>	<u>TITLE</u>
1101.01	WORK ZONE WARNING SIGNS
1101.11	TRAFFIC CONTROL DESIGN TABLES
1110.01	STATIONARY WORK ZONE SIGNS
1145.01	BARRICADES

## LEGEND

### GENERAL

- DIRECTION OF TRAFFIC FLOW
- DIRECTION OF PEDESTRIAN TRAFFIC FLOW
- EXIST. PVMT.
- NORTH ARROW
- PROPOSED PVMT.
- TEMP. SHORING (LOCATION PURPOSES ONLY)

WORK AREA

REMOVAL

USER DEFINED (IF NEEDED)

USER DEFINED (IF NEEDED)

### SIGNALS

- EXISTING
- PROPOSED
- TEMPORARY

### PAVEMENT MARKINGS

- EXISTING LINES
- TEMPORARY LINES

### TRAFFIC CONTROL DEVICES

- BARRICADE (TYPE III)
- CONE
- DRUM
- SKINNY DRUM
- TUBULAR MARKER
- TEMPORARY CRASH CUSHION
- FLASHING ARROW BOARD
- FLAGGER
- LAW ENFORCEMENT
- TRUCK MOUNTED ATTENUATOR (TMA)
- CHANGEABLE MESSAGE SIGN

### TEMPORARY SIGNING

- PORTABLE SIGN
- STATIONARY SIGN
- STATIONARY OR PORTABLE SIGN

### PAVEMENT MARKERS

- CRYSTAL / CRYSTAL
- CRYSTAL / RED
- YELLOW / YELLOW

### PAVEMENT MARKING SYMBOLS

- PAVEMENT MARKING SYMBOLS

### TEMPORARY PAVEMENT MARKING

N/A

I:\MAR-2013\1139\DOT\DOT\SR001\1\PROJ\TrafficControl\B-4619-TC-TMP-1a.dgn  
 2/26/13 AT 12:25:58

APPROVED:  DATE: 3/14/13		
<b>ROADWAY STANDARD DRAWINGS &amp; LEGEND</b>		

## MANAGEMENT STRATEGIES

- DURING REPLACEMENT OF BRIDGE No.116 AND 117 OVER HOG SWAMP, SR 2262 (BETHESDA CHURCH ROAD) WILL BE CLOSED TO THROUGH TRAFFIC. SR 2262 TRAFFIC WILL BE DETOURED OFF-SITE VIA NC 41 TO NC 904 TO SR 2258 BACK TO SR 2262.

## GENERAL NOTES

CHANGES MAY BE REQUIRED WHEN PHYSICAL DIMENSIONS IN THE DETAIL DRAWINGS, STANDARD DETAILS, AND ROADWAY DETAILS ARE NOT ATTAINABLE TO MEET FIELD CONDITIONS OR RESULT IN DUPLICATE OR UNDESIRE OVERLAPPING OF DEVICES. MODIFICATION MAY INCLUDE: MOVING, SUPPLEMENTING, COVERING, OR REMOVAL OF DEVICES AS DIRECTED BY THE ENGINEER.

THE FOLLOWING GENERAL NOTES APPLY AT ALL TIMES FOR THE DURATION OF THE CONSTRUCTION PROJECT EXCEPT WHEN OTHERWISE NOTED IN THE PLAN OR DIRECTED BY THE ENGINEER.

### TRAFFIC PATTERN ALTERATIONS

- A) NOTIFY THE ENGINEER THIRTY (30) CALENDAR DAYS PRIOR TO ANY TRAFFIC PATTERN ALTERATION.

### SIGNING

- B) PROVIDE SIGNING AND DEVICES REQUIRED TO CLOSE THE ROAD ACCORDING TO THE ROADWAY STANDARD DRAWINGS AND TRAFFIC CONTROL PLANS.  
  
PROVIDE SIGNING REQUIRED FOR THE OFF-SITE DETOUR ROUTE AS SHOWN IN THE TRAFFIC CONTROL PLANS.
- C) COVER OR REMOVE ALL SIGNS AND DEVICES REQUIRED TO CLOSE THE ROAD WHEN ROAD CLOSURE IS NOT IN OPERATION.  
  
COVER OR REMOVE ALL SIGNS REQUIRED FOR THE OFF-SITE DETOUR WHEN THE DETOUR IS NOT IN OPERATION.
- D) ENSURE ALL NECESSARY SIGNING IS IN PLACE PRIOR TO ALTERING ANY TRAFFIC PATTERN.

### TRAFFIC CONTROL DEVICES

- E) PLACE TYPE III BARRICADES, WITH "ROAD CLOSED" SIGN R11-2 ATTACHED, OF SUFFICIENT LENGTH TO CLOSE ENTIRE ROADWAY.

### PAVEMENT MARKINGS AND MARKERS

- F) INSTALL PAVEMENT MARKINGS AND PAVEMENT MARKERS ON THE FINAL SURFACE AS SHOWN IN THE PAVEMENT MARKING PLAN.
- G) TIE PROPOSED PAVEMENT MARKING LINES TO EXISTING PAVEMENT MARKING LINES.

## PHASING

MAINTAIN ACCESS TO ALL RESIDENCES AT ALL TIMES WITHIN THE PROJECT LIMITS

### STEP 1:

USING RSD 1101.03, SHEET 1 OF 9, SHEETS TMP-2 AND SD-1, INSTALL DETOUR SIGNS, PLACE TYPE III BARRICADES TO CLOSE SR 2262 (BETHESDA CHURCH RD.) TO THROUGH TRAFFIC, AND DETOUR TRAFFIC OFF-SITE.

### STEP 2:

AWAY FROM TRAFFIC, COMPLETE THE FOLLOWING:

- 1) REMOVE EXISTING STRUCTURES (NO. 116 AND NO. 117) AND CONSTRUCT PROPOSED STRUCTURES. (SEE ROADWAY AND STRUCTURE PLANS)
- 2) CONSTRUCT PROPOSED ROADWAY UP TO AND INCLUDING FINAL LAYER OF SURFACE COURSE. (SEE ROADWAY PLANS)
- 3) PLACE FINAL PAVEMENT MARKINGS AND TIE INTO EXISTING PAVEMENT MARKINGS. (SEE PAVEMENT MARKING PLANS)

### STEP 3:

REMOVE ALL TRAFFIC CONTROL DEVICES, ALL DETOUR SIGNING AND OPEN SR 2262 (BETHESDA CHURCH RD.) TO PROPOSED TRAFFIC PATTERN.

13-MAY-2013 14:15  
S:\DOT\NF\SR007\CON\PROJ\N\TIP\Projects-B\B4619\Traffic\TrafficControl\TCP\B-4619-TC-TMP-1B.dgn  
S:\DOT\NF\SR007\CON\PROJ\N\TIP\Projects-B\B4619\Traffic\TrafficControl\TCP\B-4619-TC-TMP-1B.dgn

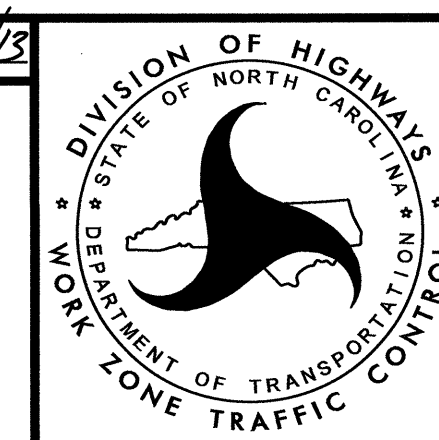
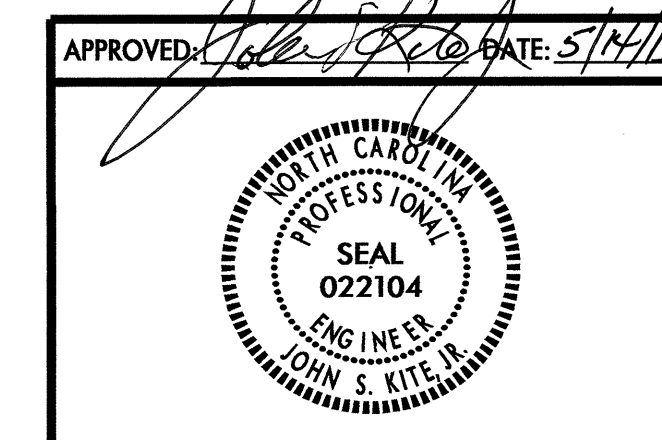

**TRANSPORTATION  
OPERATIONS  
PLAN**





# ROBESON COUNTY

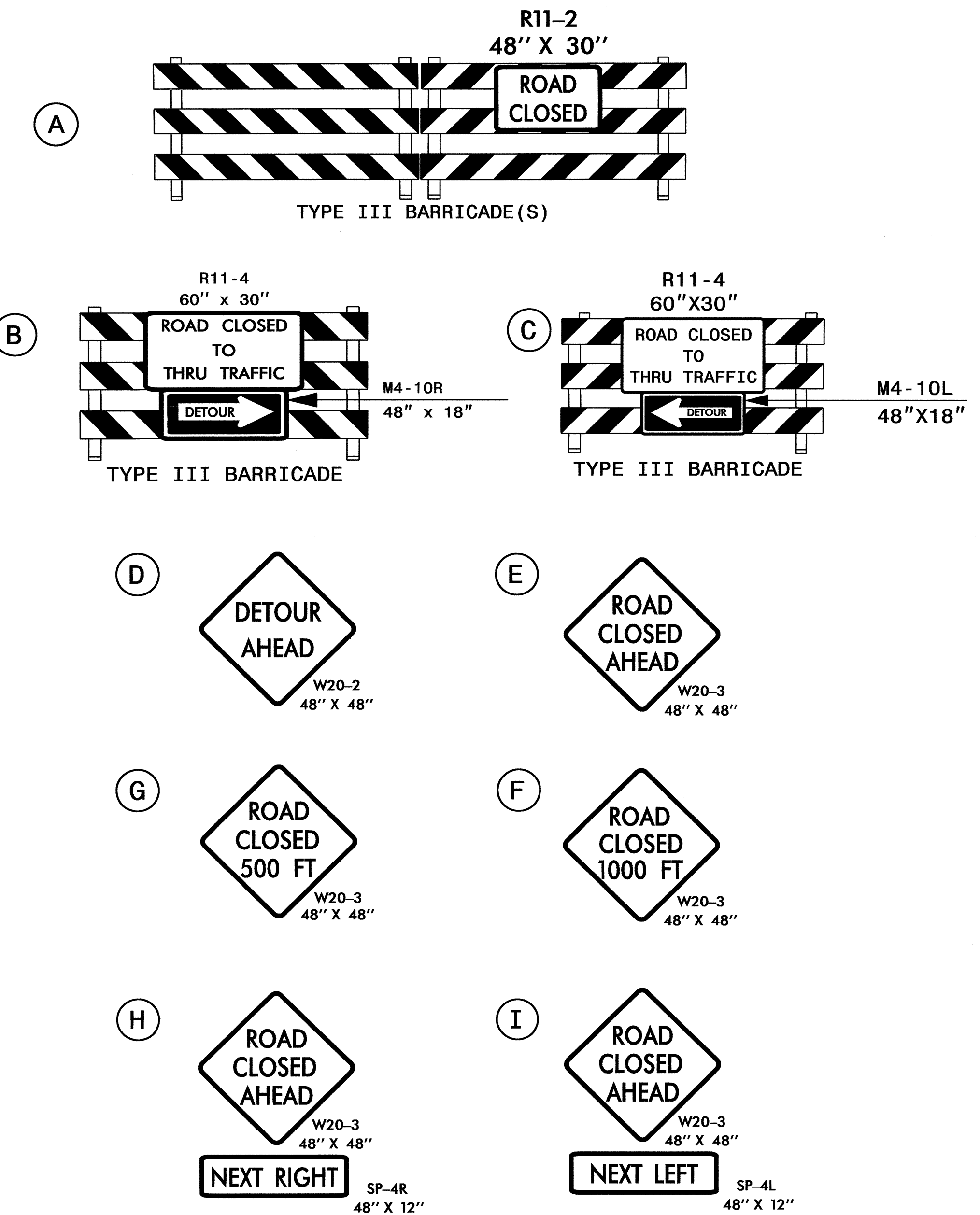
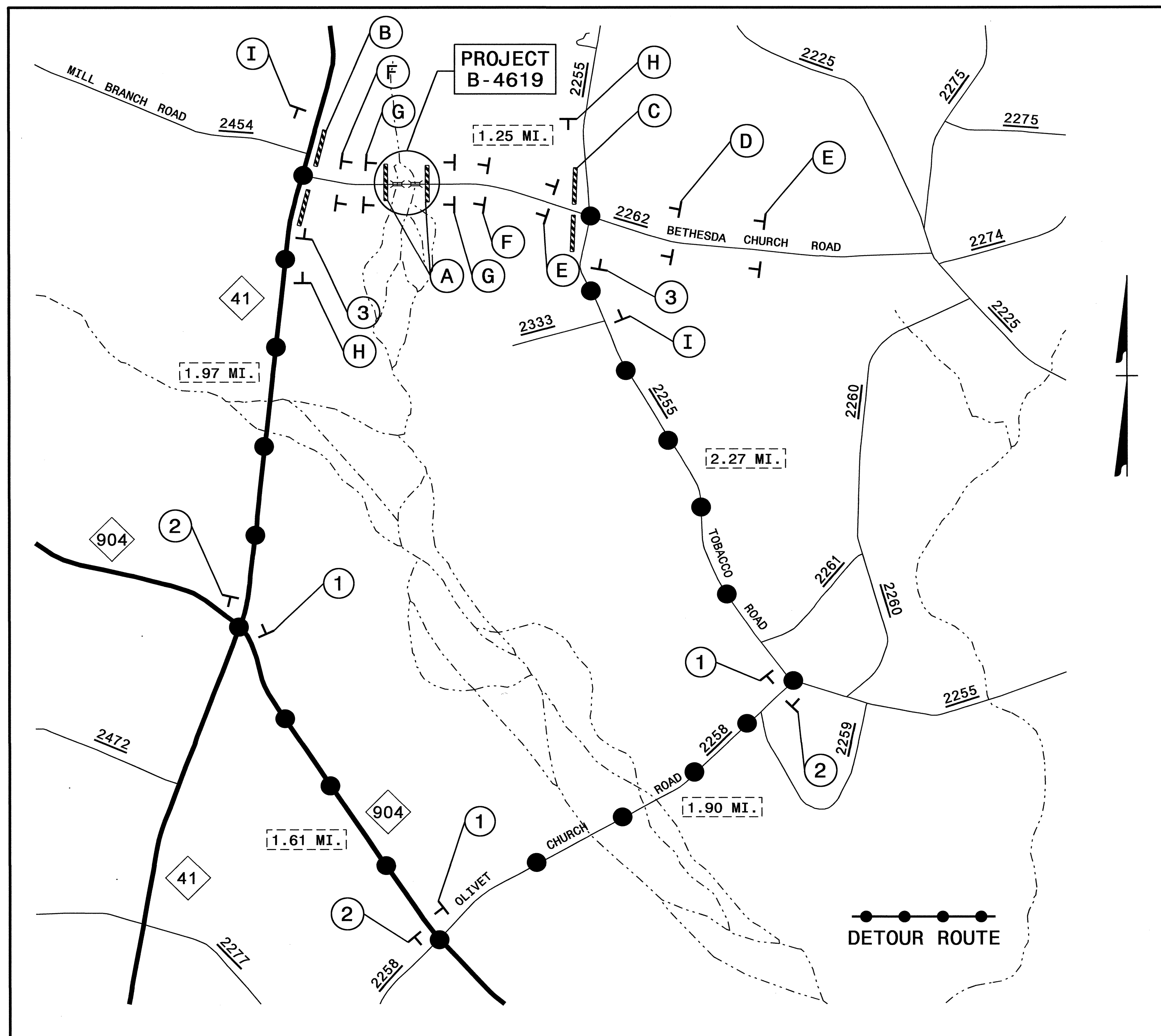

NOTES:  
 TRAFFIC CONTROL DEVICES (A) THRU (I) SHALL BE INSTALLED ACCORDING TO ROADWAY STANDARD DRAWING NO. 1101.03, SHEETS 1 AND 2 OF 9.  
 TRAFFIC CONTROL DEVICES (1) THRU (3) SHALL BE INSTALLED AS SHOWN ON PLAN OR AS DIRECTED BY THE ENGINEER.

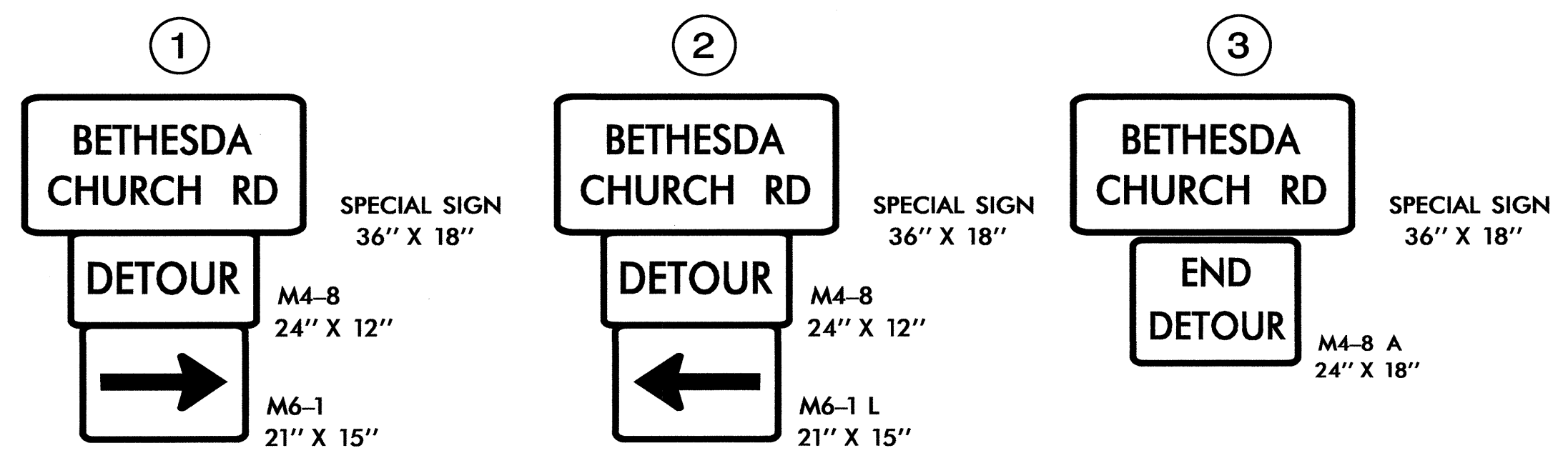

APPROVED:  DATE: 3/14/13			<b>OFF-SITE DETOUR ROUTE AND BARRICADE PLACEMENT</b>
--------------------------	--	--	--

13-MAR-2013 13:21 \\dot\ndf\sho01\proj\proj\B-4619\TrafficControl\TCP\B-4619\_TC\_TMP\_3.dgn  
 SD Jennings AT 12:26:38