

09/08/99

T.I.P. NO.	SHEET NO.
B-4643	UO-1

STATE OF NORTH CAROLINA
DIVISION OF HIGHWAYS

**UTILITIES BY OTHERS PLANS
STANLY COUNTY**

LOCATION: BRIDGE 24 AND APPROACHES ON NC 49

TYPE OF WORK: RELOCATION OF WATER LINE, POWER, TELEPHONE AND CABLE TV

TIP PROJECT: B-4643

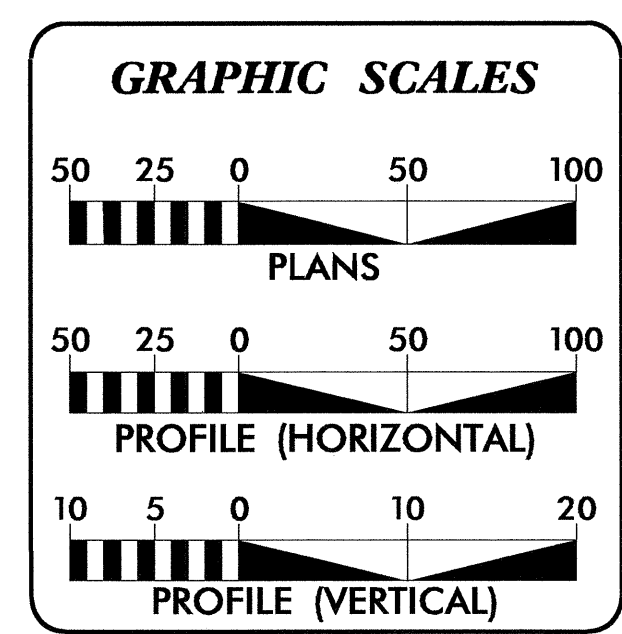
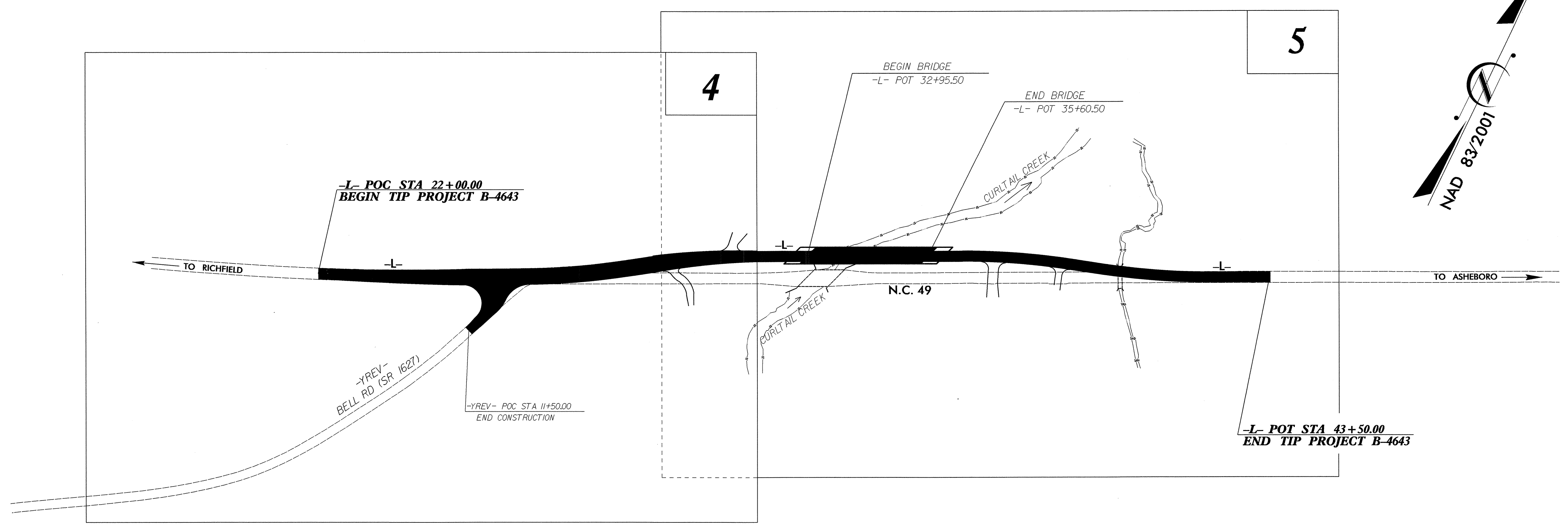
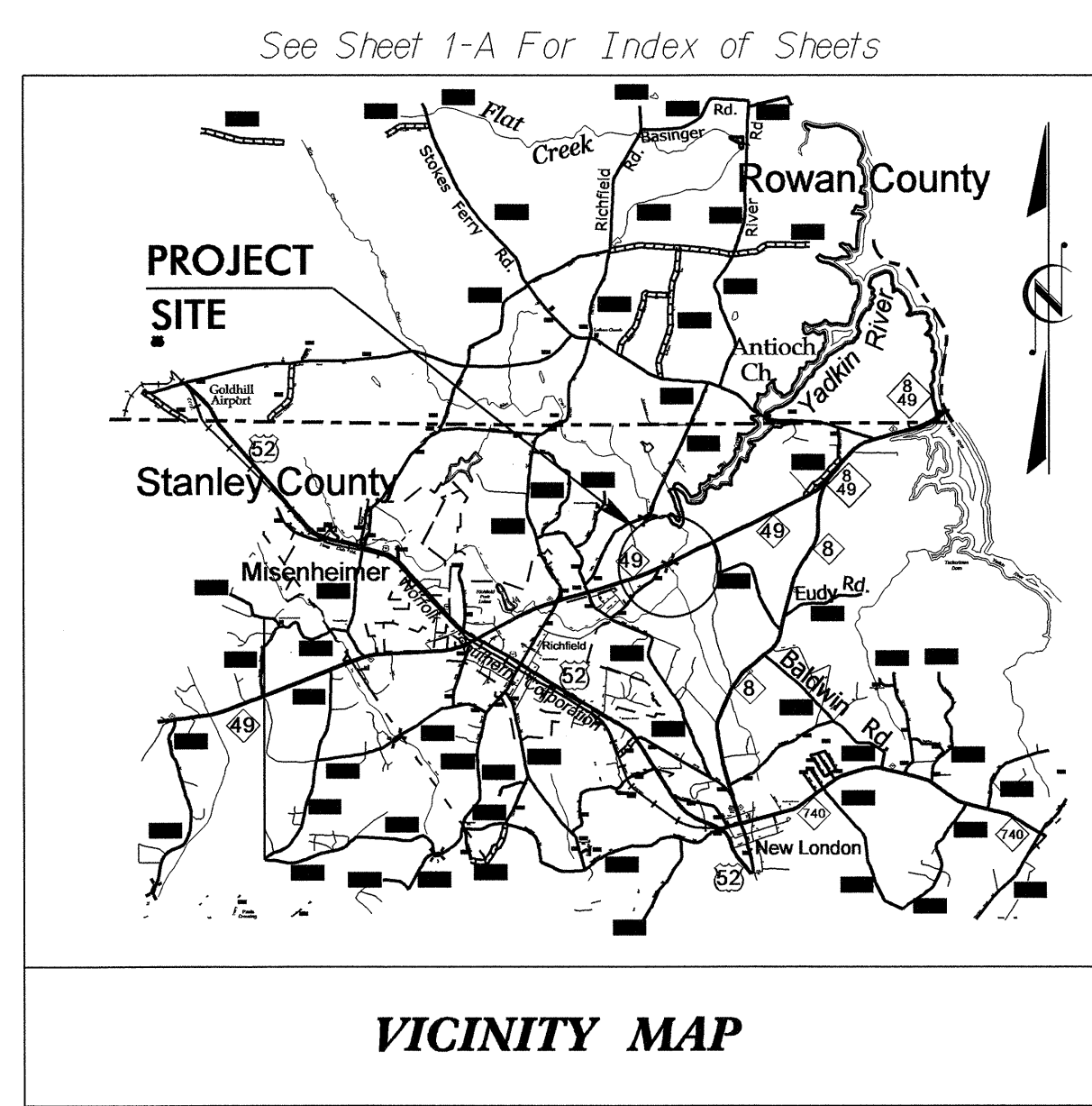

INDEX OF SHEETS

SHEET NO.	DESCRIPTION
UO-1	TITLE SHEET
UO-2 THRU UO-3	UTILITY BY OTHERS PLAN SHEETS

UTILITY OWNERS ON PROJECT

(1) UNION POWER	POWER LINE
(2) WIND STREAM	TELEPHONE LINE
(3) TIME WARNER	CABLE TV
(4) CITY OF ALBEMARLE	WATER

PREPARED IN THE OFFICE OF:
**DIVISION OF HIGHWAYS
UTILITIES UNIT
UTILITIES ENGINEERING**

1591 MAIL SERVICES CENTER
RALEIGH NC 27699-1591
PHONE (919) 707-6690
FAX (919) 250-4151

Roger Worthington, P.E. UTILITIES SECTION ENGINEER
Carl Barclay, P.E. UTILITIES SQUAD LEADER PROJECT ENGINEER
Ali Kouchehi, P.E. UTILITIES PROJECT DESIGNER

05-MAR-2013 09:41
R:\Utilities\RDY_Ut\Proj\B4643_Rdy_tsh.dgn
\$\$\$\$\$USERNAME\$\$\$\$\$

UTILITIES BY OTHERS

NOTE:
ALL PROPOSED UTILITY WORK SHOWN ON THIS SHEET WILL BE DONE BY OTHERS

* NOTE: USE 6' PAVED SHOULDER FOR TEMPORARY MAINTENANCE OF TRAFFIC DURING CONSTRUCTION.

PI Sta 23+34.40 Δ = 6° 36' 43.6" (LT) D = 0° 49' 49.3" L = 796.28' T = 398.58' R = 6,900.00' e = SEE PLAN	PI Sta 28+32.94 Δ = 7° 26' 42.8" (LT) D = 3° 41' 47.4" L = 201.41' T = 100.85' R = 1,550.00' e = SEE PLAN	PI Sta 30+59.72 Δ = 9° 18' 38.4" (RT) D = 3° 41' 47.4" L = 251.88' T = 126.22' R = 1,550.00' e = SEE PLAN
---	---	---

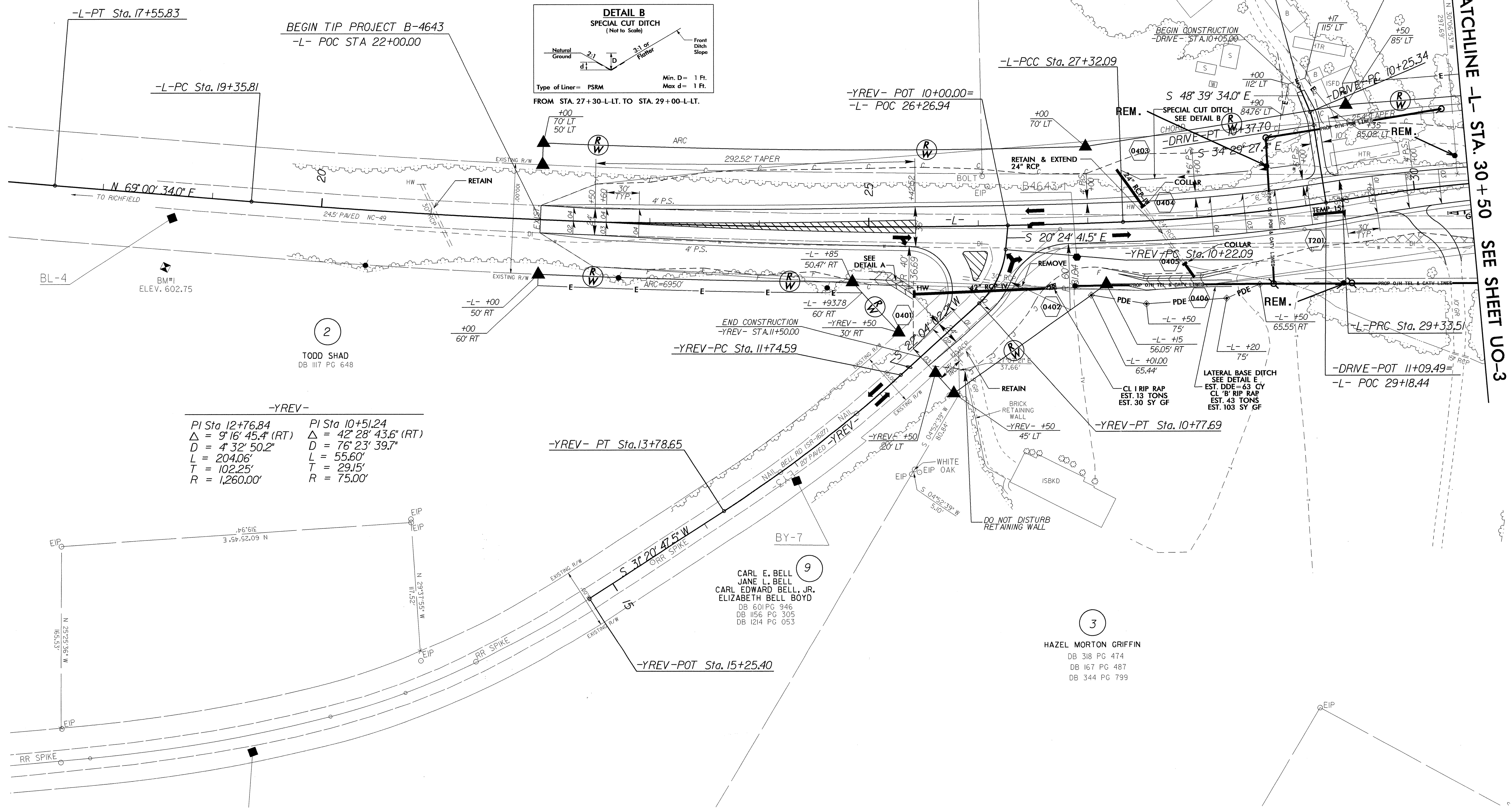
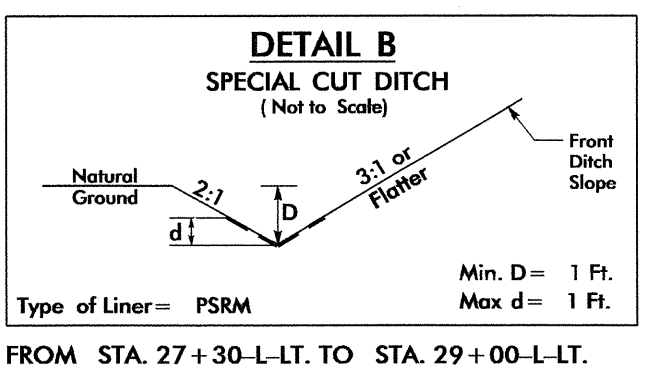
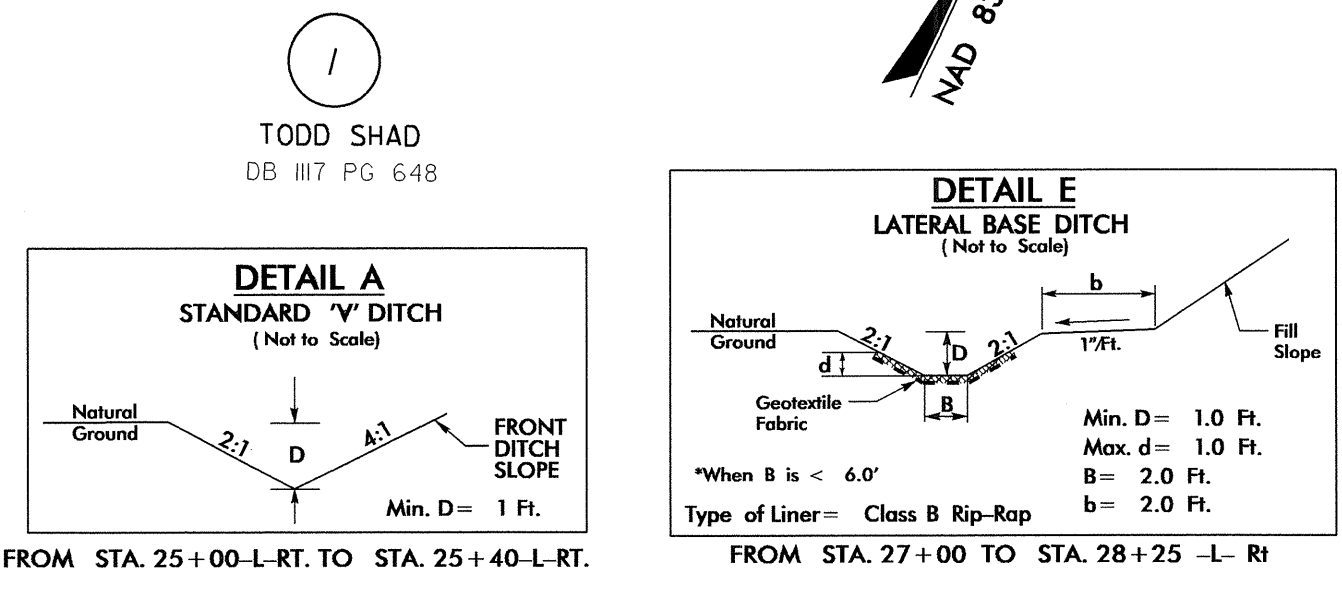

PI Sta 12+76.84 Δ = 9° 16' 45.4" (RT) D = 4° 32' 50.2" L = 204.06' T = 102.25' R = 1,260.00'	PI Sta 10+51.24 Δ = 42° 28' 43.6" (RT) D = 76° 23' 39.7" L = 55.60' T = 29.15' R = 75.00'
---	--

5/14/99

U:\05-MAR-2013 09:52...B4643_Rdy_psh04.dgn

UTILITIES BY OTHERS

NOTE:
ALL PROPOSED UTILITY WORK
SHOWN ON THIS SHEET WILL
BE DONE BY OTHERS

NOTE: MAINTAIN TRAFFIC DURING CONSTRUCTION
UTILIZING EXISTING ROADWAY

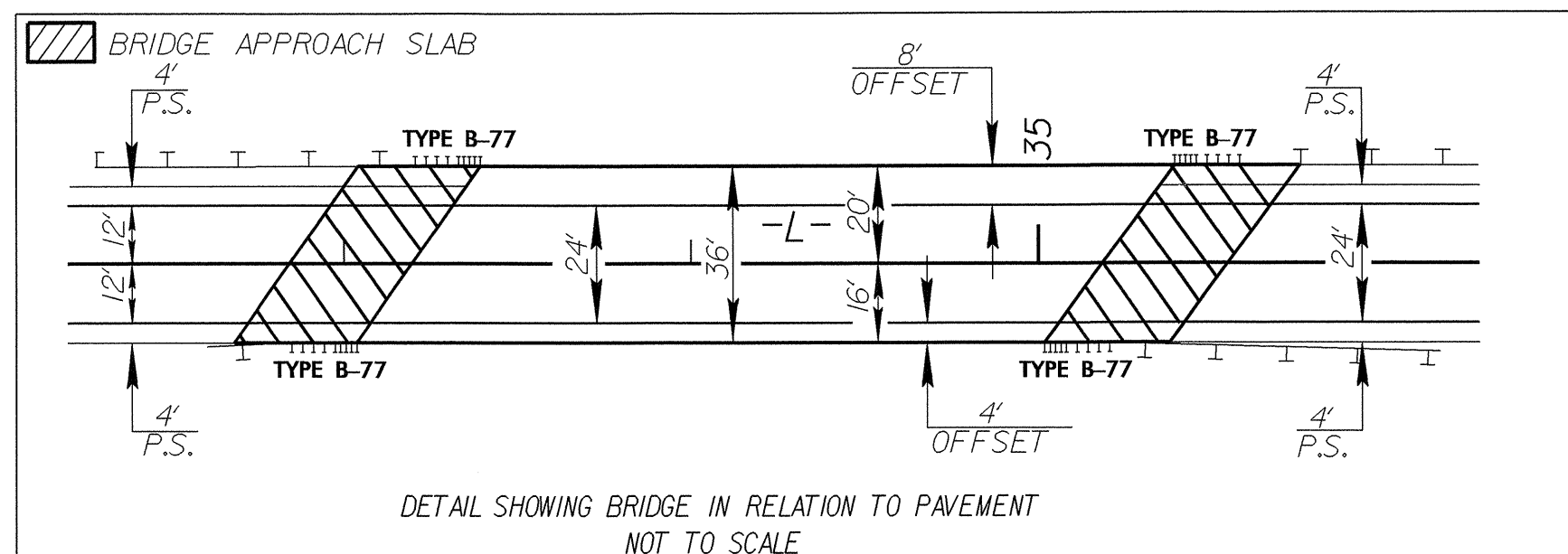

-L-		
PI Sta 30+59.72	PI Sta 37+73.34	PI Sta 40+43.29
$\Delta = 9' 18' 38.4''$ (RT)	$\Delta = 9' 58' 43.9''$ (RT)	$\Delta = 9' 58' 43.9''$ (LT)
$D = 3' 41' 47.4''$	$D = 3' 41' 47.4''$	$D = 3' 41' 47.4''$
$L = 251.88'$	$L = 269.95'$	$L = 269.95'$
$T = 126.22'$	$T = 135.32'$	$T = 135.32'$
$R = 1,550.00'$	$R = 1,550.00'$	$R = 1,550.00'$
$e = \text{SEE PLAN}$	$e = \text{SEE PLAN}$	$e = \text{SEE PLAN}$

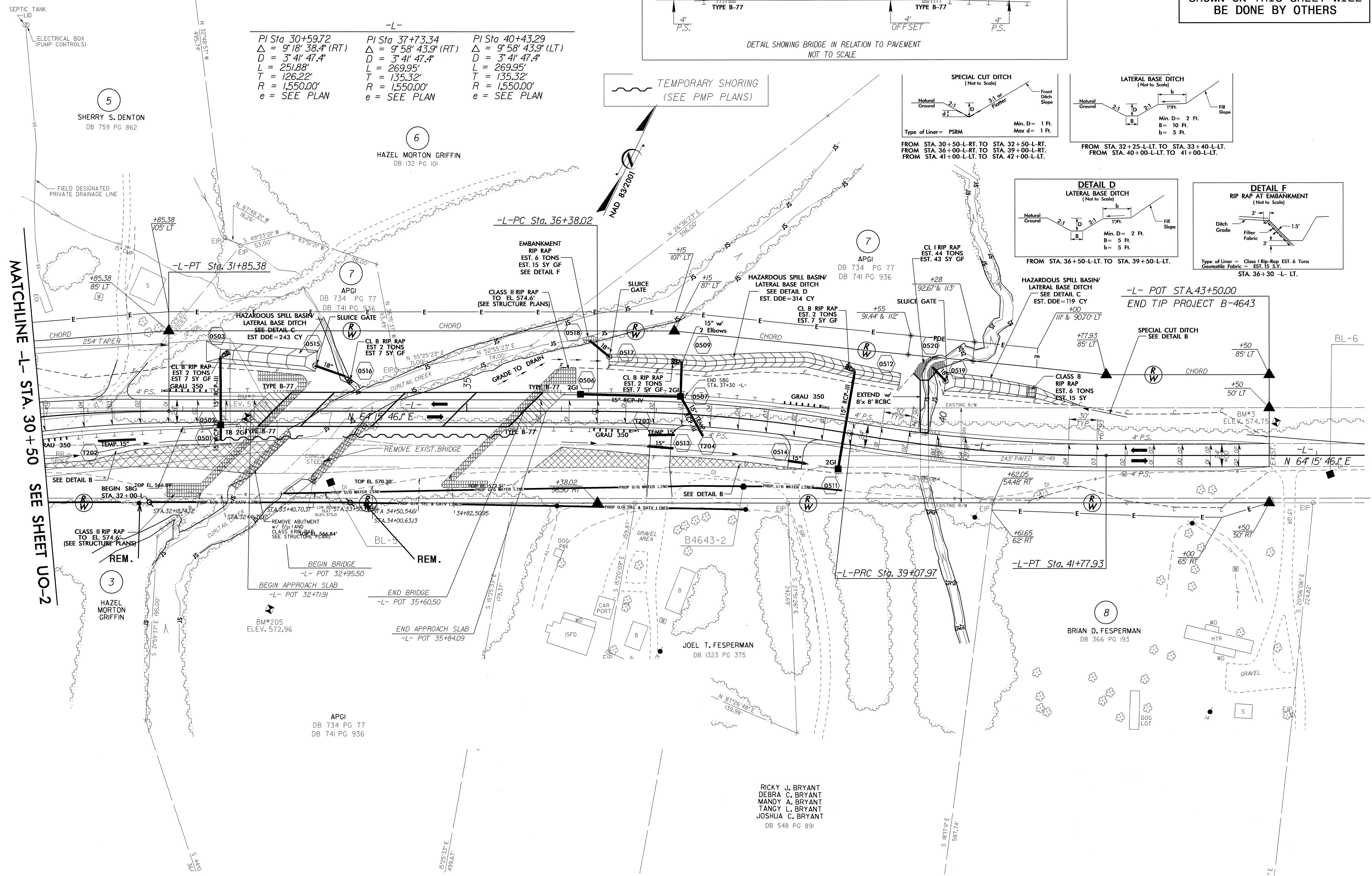
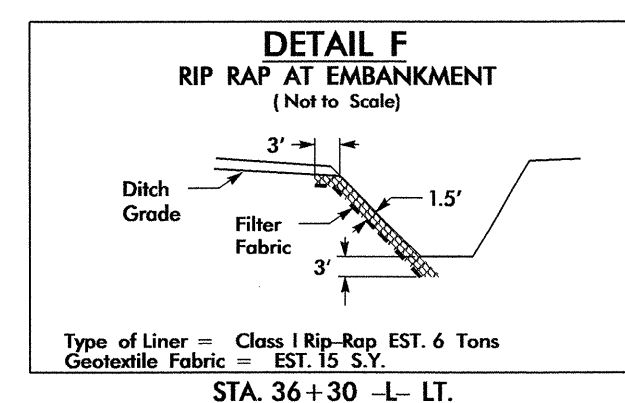
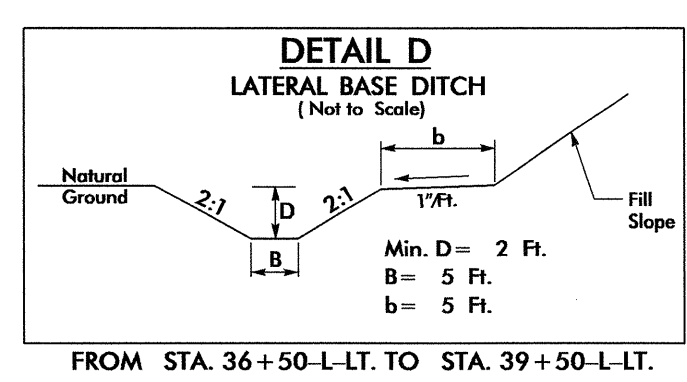
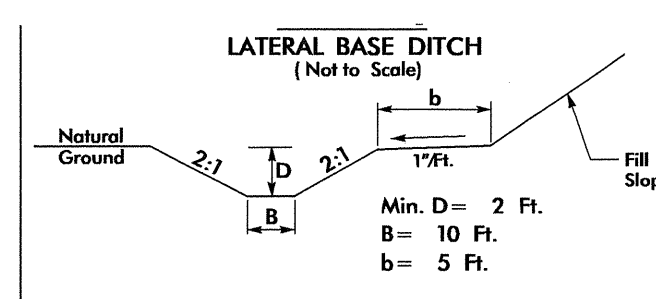
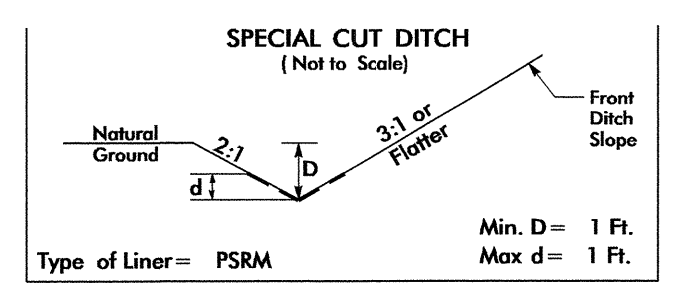

8/13/99

REVISIONS

05-MAR-2013 15:02
R:\UO\UO-3\B-4643-Rd\UO-3.dgn