

T.I.P.: P-5208F

CONTRACT:

**STATE OF NORTH CAROLINA
DEPARTMENT OF TRANSPORTATION**

**SIGNING PLAN
CABARRUS COUNTY**

TIP NO. P-5208F	SHEET NO. SIGN-1
APPROVED: <i>Bob G. May</i>	
DATE: 2/21/13	
SEAL	

INDEX	
SHEET NO.	DESCRIPTION
SIGN-1	TITLE SHEET
SIGN-2	SIGNING PLAN SHEET

GENERAL NOTES

- IF REMOVAL OR RELOCATION OF SIGNS ON PRIVATE STREET (NON-MAINTAINED) IS REQUIRED DUE TO CONSTRUCTION, THE CONTRACTOR SHALL INFORM THE ENGINEER. THE WORK WILL BE COMPLETED BY OTHERS.
- WHEN NOT STATIONED OR DIMENSIONED ON PLANS, ALL 'E' AND 'F' SIGNS SHALL BE FIELD LOCATED BY THE ENGINEER.
- WHEN EXISTING SIGNS ARE REMOVED AND INSTALLED ON NEW SUPPORTS, THE RE-ERECTION SHALL IMMEDIATELY FOLLOW THE REMOVAL.

ROADWAY STANDARD DRAWING

THE FOLLOWING ROADWAY STANDARDS AS APPEAR IN "ROADWAY STANDARD DRAWINGS" - PROJECT SERVICES UNIT - N.C. DEPARTMENT OF TRANSPORTATION - RALEIGH, N.C., DATED JANUARY 2012 ARE APPLICABLE TO THIS PROJECT AND BY REFERENCE HEREBY ARE CONSIDERED A PART OF THESE PLANS:

STD. NO.	TITLE
904.50	MOUNTING OF TYPE 'D', 'E' AND 'F' SIGNS ON 'U' CHANNEL POSTS

SUMMARY OF QUANTITIES

ITEM NO.		ITEM DESCRIPTION	QUANTITY	UNIT
DESC. NO.	SECT. NO.			
4072000000	903	SUPPORTS, 3 LB. STEEL U-CHANNEL	14	LF
4102000000	904	SIGN ERECTION, TYPE E	1	EA
4155000000	907	DISPOSAL OF SIGN SYSTEM, U-CHANNEL	5	EA
4025000000	901	CONTRACTOR FURNISHED, TYPE 'E' SIGN	6.25	SF

PLAN REVIEWED BY: N.C.D.O.T. SIGNING AND DELINEATION UNIT		
KELVIN JORDAN	SIGNING & DELINEATION STANDARDS ENGINEER	
JOSE MARTINEZ	SIGNING & DELINEATION PROJECT DESIGN ENGINEER	

PLAN PREPARED BY: WETHERILL ENGINEERING		
BOB MAY, P.E.	ROADWAY PROJECT ENGINEER	
CHARLES MULLEN	TRAFFIC CONTROL SPECIALIST	

0515DEL_P21a2

TIP NO. P-5208F	SHEET NO. SIGN-2
APPROVED: <i>Bob A. May</i>	
DATE: 1/21/13	
SEAL	

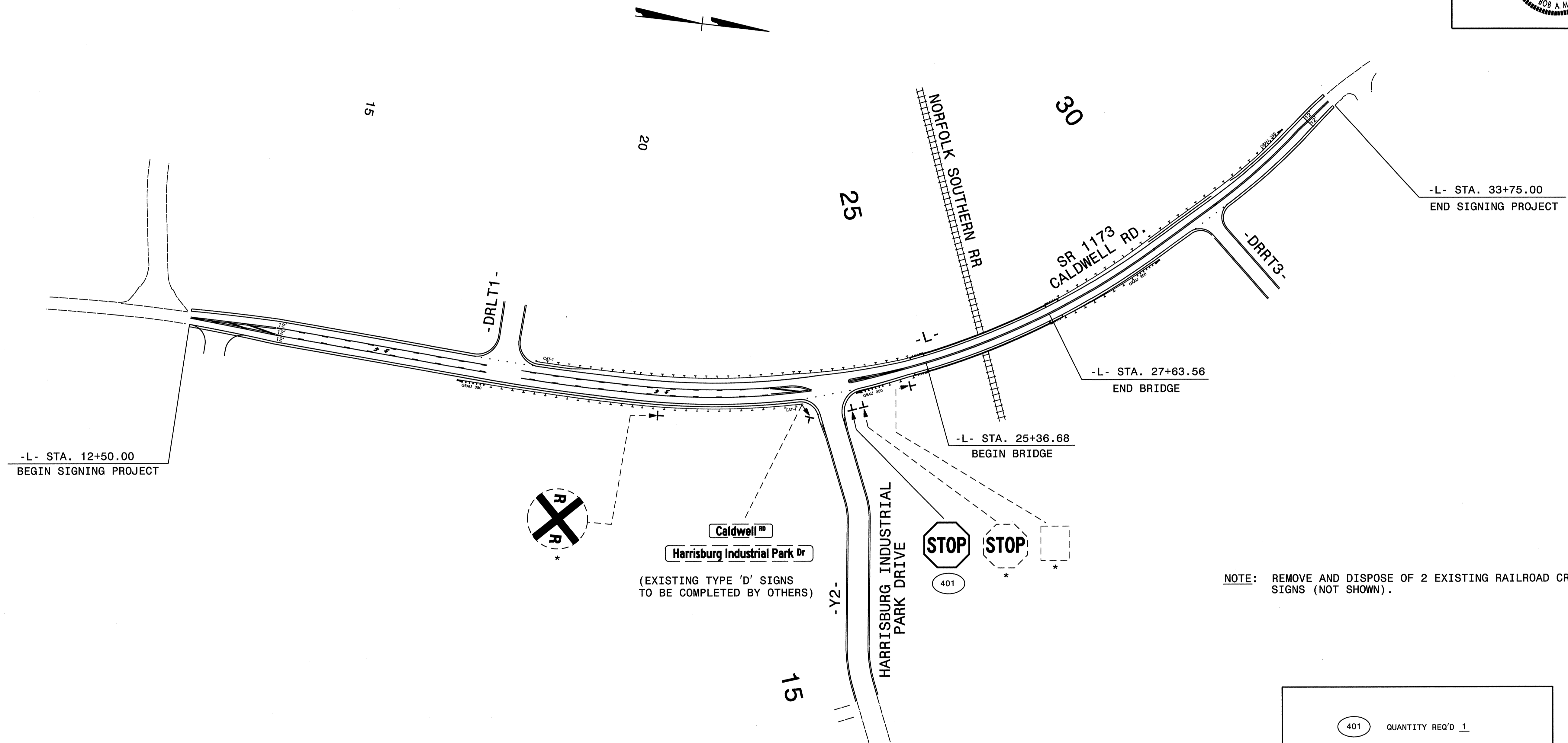

NOTE: REMOVE AND DISPOSE OF 2 EXISTING RAILROAD CROSSING SIGNS (NOT SHOWN).

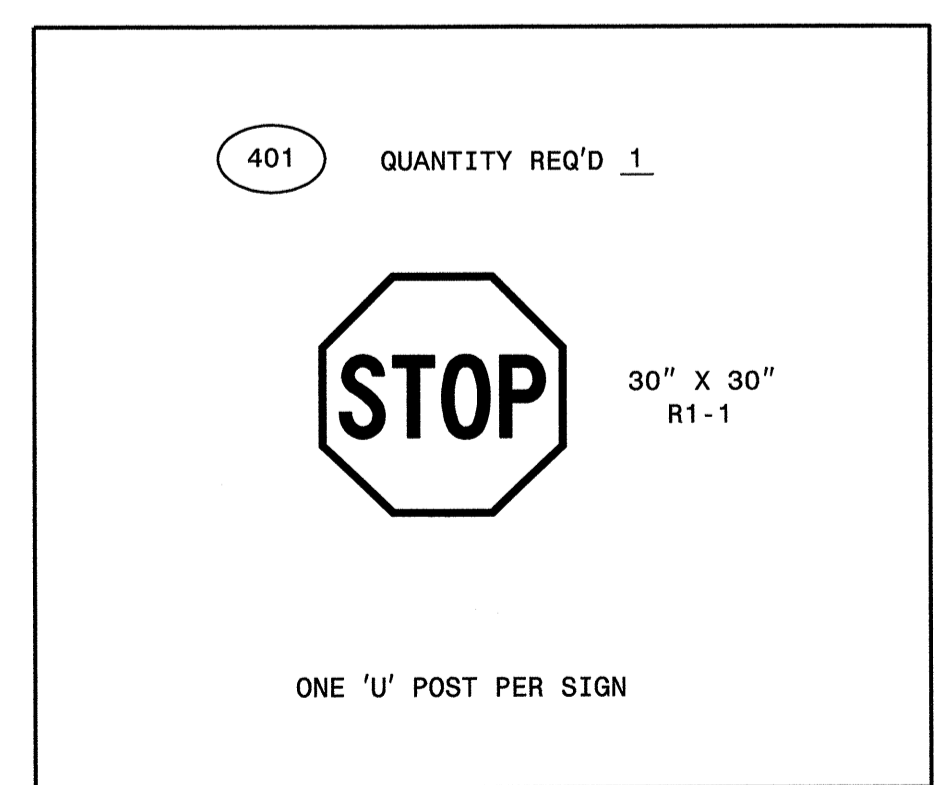

* DISPOSAL OF SIGN SYSTEM, U-CHANNEL

WETHERILL ENGINEERING
 559 Jones Franklin Rd. Suite 164
 Raleigh, N.C. 27606
 License No. F-0377
 Bus: 919 851 8077
 Fax: 919 851 8107

TRANSPORTATION PLANNING/DESIGN - BRIDGE/STRUCTURE DESIGN
 CIVIL/SITE DESIGN - GIS/GPS - CONSTRUCTION OBSERVATION

12/31/2012 10:40:04 AM
 P:\2012\01\04\01\IP-5208F\TrafficControl\TCP\IP5208F_SIGN_S2.dgn

SIGNING PLAN SHEET