

T.I.P.: P-5208D

CONTRACT:

STATE OF NORTH CAROLINA  
DEPARTMENT OF TRANSPORTATION

PAVEMENT MARKING PLAN  
CABARRUS COUNTY

TIP NO.	SHEET NO.
P-5208D	PMP-1
APPROVED: _____	
DATE: _____	
SEAL	

INDEX

SHEET NO.	DESCRIPTION
PMP-1	PAVEMENT MARKING PLAN COVER SHEET
PMP-2	CROSSWALK AND STOP BAR PM DETAIL
PMP-3-5	PAVEMENT MARKING DETAIL

ROADWAY STANDARD DRAWING

THE FOLLOWING ROADWAY STANDARDS AS APPEAR IN "ROADWAY STANDARD DRAWINGS" - PROJECT SERVICES UNIT - N.C. DEPARTMENT OF TRANSPORTATION - RALEIGH, N.C., DATED JANUARY 2012 ARE APPLICABLE TO THIS PROJECT AND BY REFERENCE HEREBY ARE CONSIDERED A PART OF THESE PLANS:

STD. NO.	TITLE
1205.01	PAVEMENT MARKINGS - LINE TYPES AND OFFSETS
1205.02	PAVEMENT MARKINGS - TWO-LANE AND MULTILANE ROADWAYS
1205.04	PAVEMENT MARKINGS - INTERSECTIONS
1205.05	PAVEMENT MARKINGS - TURN LANES
1205.06	PAVEMENT MARKINGS - LANE DROPS
1205.07	PAVEMENT MARKINGS - PEDESTRIAN CROSSWALKS
1205.08	PAVEMENT MARKINGS - SYMBOLS AND WORD MESSAGES
1205.09	PAVEMENT MARKINGS - PAINTED ISLANDS
1205.12	PAVEMENT MARKINGS - BRIDGES
1205.13	PAVEMENT MARKINGS - LANE REDUCTIONS
1250.01	RAISED PAVEMENT MARKERS - INSTALLATION SPACING
1251.01	RAISED PAVEMENT MARKERS - PERMANENT AND TEMPORARY

GENERAL NOTES

THE FOLLOWING GENERAL NOTES APPLY AT ALL TIMES FOR THE DURATION OF THE CONSTRUCTION PROJECT, EXCEPT WHEN OTHERWISE NOTED IN THE PLAN, OR DIRECTED BY THE ENGINEER.

- A) INSTALL PAVEMENT MARKINGS AND PAVEMENT MARKERS ON THE FINAL SURFACE AS FOLLOWS:

ROAD NAME	MARKING	MARKER
NC 49	THERMOPLASTIC	PERMANENT
ROBERTA ROAD	THERMOPLASTIC/COLD APPLIED PLASTIC	
STALLINGS ROAD	THERMOPLASTIC	
HICKORY RIDGE ROAD	THERMOPLASTIC	
SCHOOL CIRCLE	THERMOPLASTIC	

- B) PLACE TWO APPLICATIONS OF PAINT PAVEMENT MARKINGS ON THE FINAL WEARING SURFACE. PLACE THE SECOND APPLICATION OF PAINT UPON SUFFICIENT DRYING TIME OF THE FIRST.
- C) TIE PROPOSED PAVEMENT MARKING LINES TO EXISTING PAVEMENT MARKING LINES.
- D) REMOVE/REPLACE ANY CONFLICTING/DAMAGED PAVEMENT MARKINGS AND MARKERS.
- E) STOP BAR LOCATION AT NON-SIGNALIZED INTERSECTIONS MAY BE ADJUSTED AS DIRECTED BY THE ENGINEER.
- F) REMOVE ALL RESIDUE AND SURFACE LAITANCE BY ACCEPTABLE METHODS ON CONCRETE BRIDGE DECKS PRIOR TO PLACING COLD APPLIED PLASTIC PAVEMENT MARKING MATERIAL.
- G) UNLESS OTHERWISE SPECIFIED, HEATED-IN-PLACE THERMOPLASTIC MAY BE USED IN LIEU OF EXTRUDED THERMOPLASTIC FOR STOP BARS, SYMBOLS, CHARACTERS AND DIAGONALS. IF HEATED-IN-PLACE IS USED, IT SHALL BE PAID FOR USING THE EXTRUDED THERMOPLASTIC PAY ITEM.
- H) UNLESS OTHERWISE SPECIFIED, HEATED-IN-PLACE THERMOPLASTIC MAY BE USED IN LIEU OF COLD APPLIED PLASTIC FOR STOP BARS, SYMBOLS, CHARACTERS AND DIAGONALS ON ASPHALT OR CONCRETE ROADWAYS. IF HEATED-IN-PLACE IS USED, IT SHALL BE PAID FOR USING THE COLD APPLIED PAY ITEM.

PLAN REVIEWED BY: N.C.D.O.T. SIGNING AND DELINEATION UNIT

CHRIS HOWARD SIGNING & DELINEATION STANDARDS ENGINEER  
MARK MANRIQUEZ SIGNING & DELINEATION PROJECT DESIGN ENGINEER

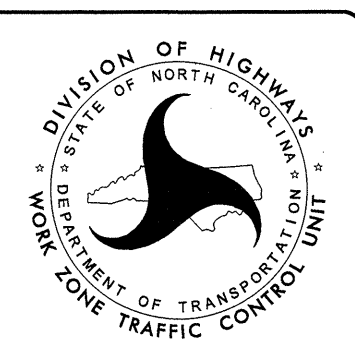

PLAN PREPARED BY: Michael Baker Engineering, Inc.

W. S. HOOD, PE PROJECT ENGINEER  
J. TRUEBLOOD PROJECT DESIGN ENGINEER

MICHAEL BAKER ENGINEERING, INC.  
8000 Regency Parkway, Suite 600  
Cary, NC 27518  
NC LICENSE NO. - F-1084

TIP NO.	SHEET NO.
P-5208D	PMP-2
APPROVED:	
DATE:	
SEAL	

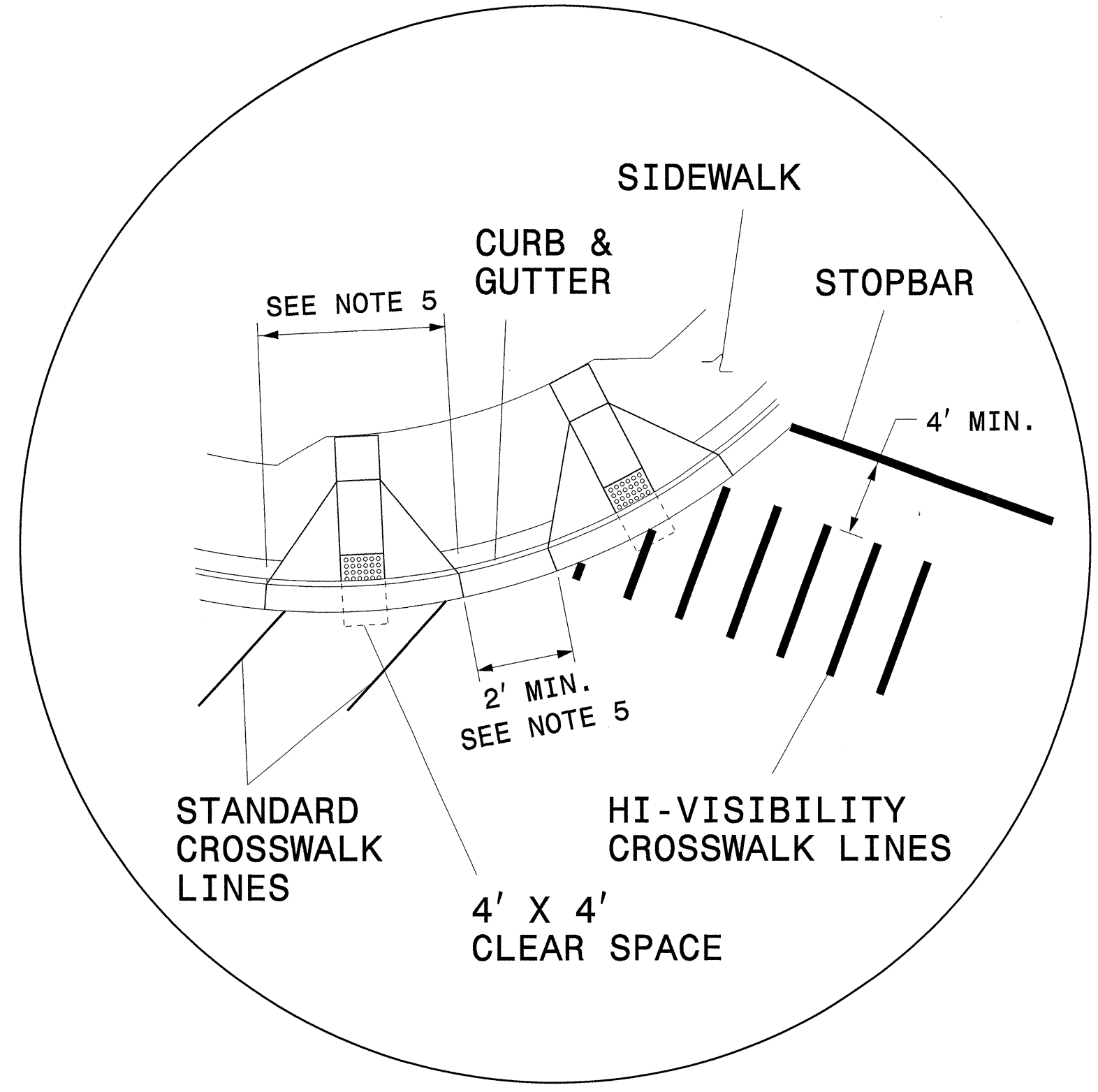
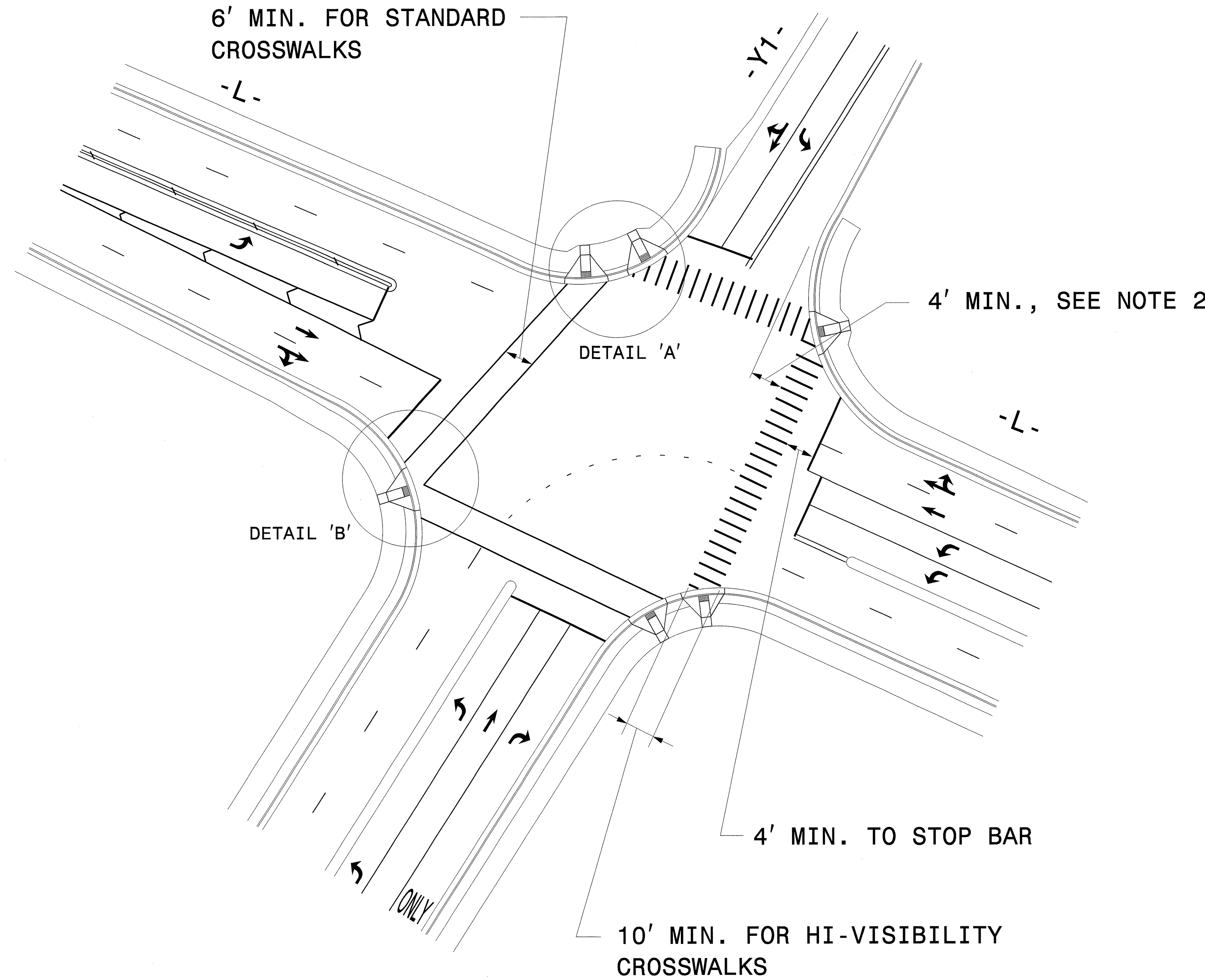
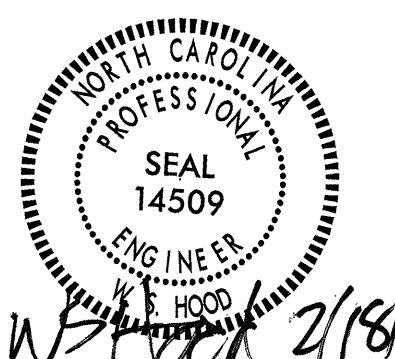

DETAIL 'A'- DUAL CURB RAMPS

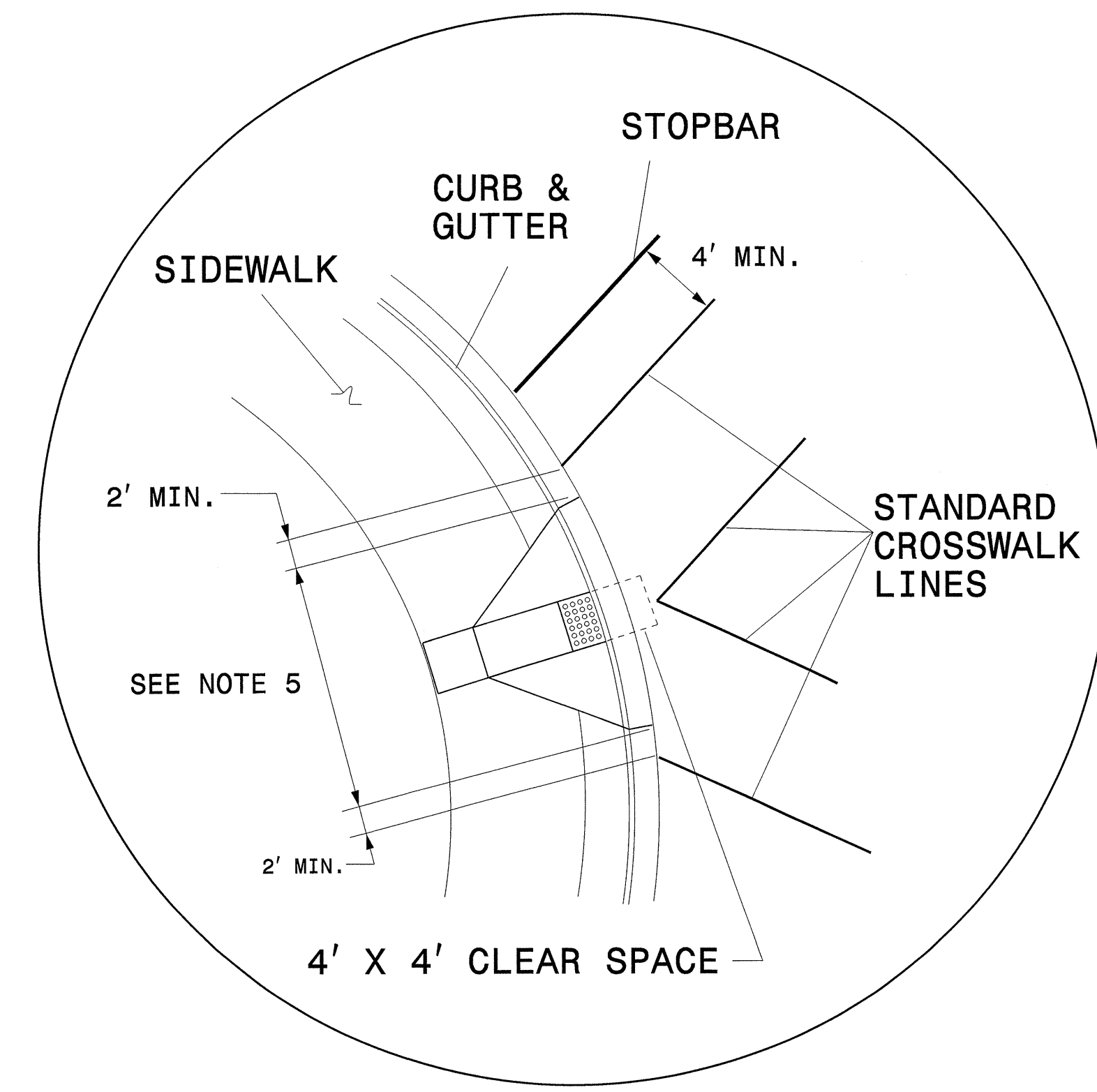

DETAIL 'B'- SINGLE DIAGONAL CURB RAMP

**GUIDANCE DETAIL FOR STANDARD AND HI-VISIBILITY CROSSWALKS AT SIGNALIZED OR STOP SIGN CONTROLLED INTERSECTIONS**

**NOTES:**

1. USE DETAILS ABOVE AND THE FOLLOWING NOTES FOR GUIDANCE IN PLACING CROSSWALKS AND STOP BARS NOT STATIONED ON THE DETAIL SHEETS OR WHEN FIELD ADJUSTMENTS REQUIRED MOVING STATIONED MARKINGS AS DIRECTED BY THE ENGINEER. REFER TO NCDOT ROADWAY STANDARD DRAWINGS, MUTCD AND ADA STANDARDS FOR ADDITIONAL GUIDANCE.
2. SET BACK DISTANCE FROM INSIDE CROSSWALK MARKING TO NEAREST EDGE OF TRAVEL IS 4' MIN.
3. BEYOND THE BOTTOM GRADE BRAKE, A CLEAR SPACE OF 4' X 4' MINIMUM SHALL BE PROVIDED WITHIN THE WIDTH OF THE CROSSWALK.
4. SINGLE DIAGONAL CURB RAMPS WITH FLARED SIDES SHALL HAVE A SEGMENT OF CURB 2 FEET LONG MINIMUM LOCATED ON EACH SIDE OF THE CURB RAMP AND WITHIN THE MARKED CROSSING, SEE DETAIL 'B'.
5. CURB RAMPS SHALL BE CONSTRUCTED IN ACCORDANCE TO THE LATEST NCDOT ROADWAY STANDARD DRAWINGS.

**CROSSWALK AND STOP BAR PAVEMENT MARKING DETAIL**

13-FEB-2013 17:41  
 X:\Projects\NCDOT\5208D\DISCIPLINE\Traffic\MP\PMP-2.dgn  
 MEJOHNSON AT CARTRIMJOHNSON

0077DEL\_P10a4

TIP NO. P-5208D	SHEET NO. PMP-3
APPROVED: _____	
DATE: _____	
SEAL	

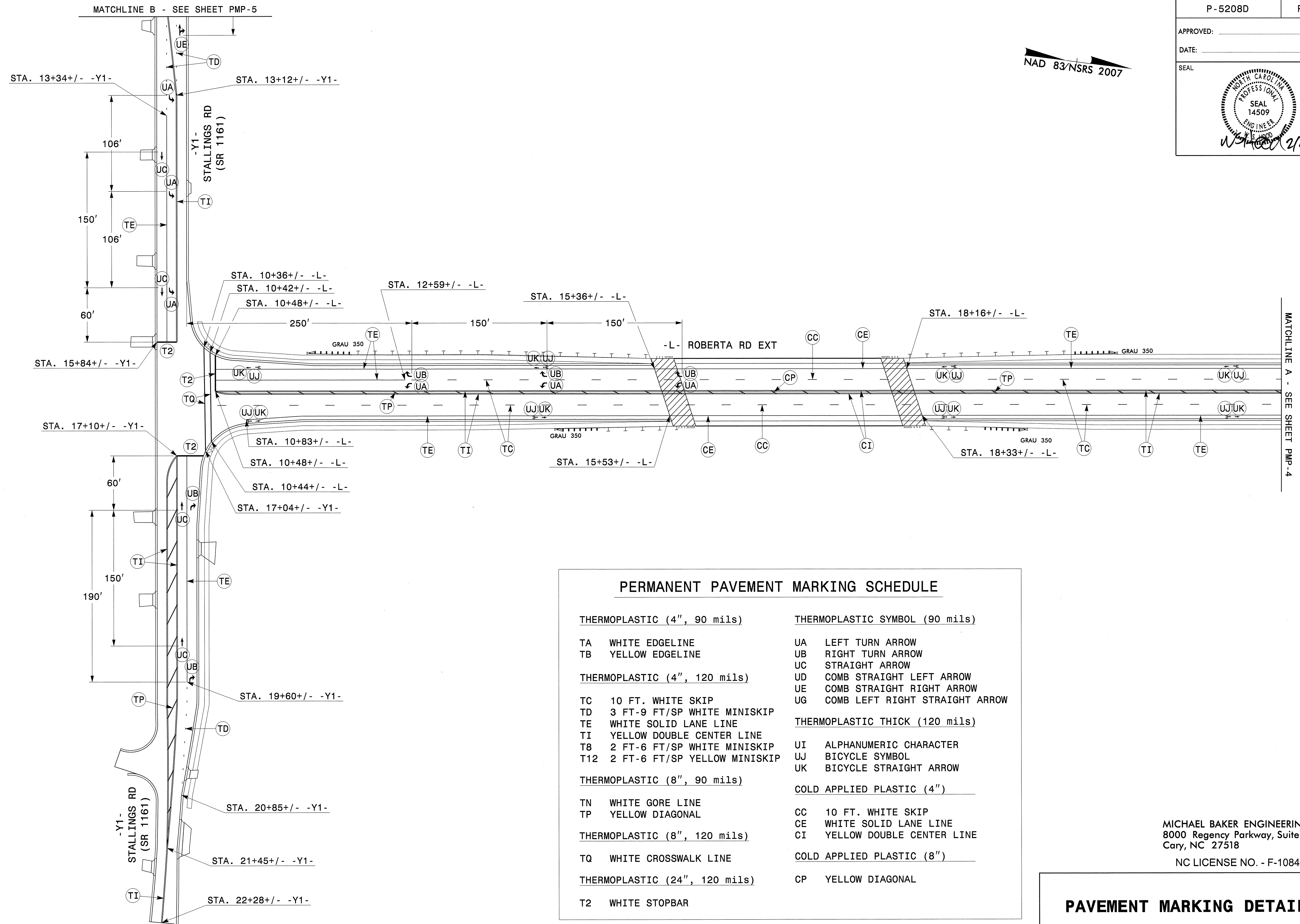

### PERMANENT PAVEMENT MARKING SCHEDULE

<b>THERMOPLASTIC (4", 90 mils)</b>	<b>THERMOPLASTIC SYMBOL (90 mils)</b>
TA WHITE EDGELINE	UA LEFT TURN ARROW
TB YELLOW EDGELINE	UB RIGHT TURN ARROW
	UC STRAIGHT ARROW
<b>THERMOPLASTIC (4", 120 mils)</b>	UD COMB STRAIGHT LEFT ARROW
	UE COMB STRAIGHT RIGHT ARROW
	UG COMB LEFT RIGHT STRAIGHT ARROW
TC 10 FT. WHITE SKIP	<b>THERMOPLASTIC THICK (120 mils)</b>
TD 3 FT-9 FT/SP WHITE MINISKIP	UI ALPHANUMERIC CHARACTER
TE WHITE SOLID LANE LINE	UJ BICYCLE SYMBOL
TI YELLOW DOUBLE CENTER LINE	UK BICYCLE STRAIGHT ARROW
T8 2 FT-6 FT/SP WHITE MINISKIP	
T12 2 FT-6 FT/SP YELLOW MINISKIP	
<b>THERMOPLASTIC (8", 90 mils)</b>	<b>COLD APPLIED PLASTIC (4")</b>
TN WHITE GORE LINE	CC 10 FT. WHITE SKIP
TP YELLOW DIAGONAL	CE WHITE SOLID LANE LINE
<b>THERMOPLASTIC (8", 120 mils)</b>	CI YELLOW DOUBLE CENTER LINE
TQ WHITE CROSSWALK LINE	<b>COLD APPLIED PLASTIC (8")</b>
<b>THERMOPLASTIC (24", 120 mils)</b>	CP YELLOW DIAGONAL
T2 WHITE STOPBAR	

MICHAEL BAKER ENGINEERING, INC.  
8000 Regency Parkway, Suite 600  
Cary, NC 27518  
NC LICENSE NO. - F-1084

**PAVEMENT MARKING DETAIL**

13-FEB-2013 11:11  
 I:\Projects\13080\DISCIPLINE\Traffic\PM\PM-3.dgn  
 WEDOMINSON AT CARY\WEDOMINSON

NAD 83/NSRS 2007

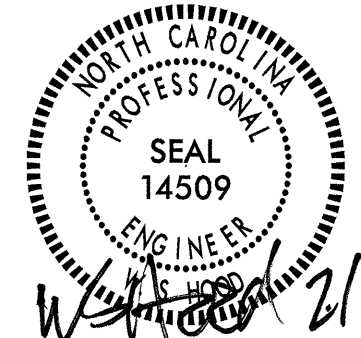

### PERMANENT PAVEMENT MARKING SCHEDULE

THERMOPLASTIC (4", 90 mils)		THERMOPLASTIC SYMBOL (90 mils)	
TA	WHITE EDGELINE	UA	LEFT TURN ARROW
TB	YELLOW EDGELINE	UB	RIGHT TURN ARROW
THERMOPLASTIC (4", 120 mils)		UC	STRAIGHT ARROW
TC	10 FT. WHITE SKIP	UD	COMB STRAIGHT LEFT ARROW
TD	3 FT-9 FT/SP WHITE MINISKIP	UE	COMB STRAIGHT RIGHT ARROW
TE	WHITE SOLID LANE LINE	UG	COMB LEFT RIGHT STRAIGHT ARROW
TI	YELLOW DOUBLE CENTER LINE	THERMOPLASTIC THICK (120 mils)	
T8	2 FT-6 FT/SP WHITE MINISKIP	UI	ALPHANUMERIC CHARACTER
T12	2 FT-6 FT/SP YELLOW MINISKIP	UJ	BICYCLE SYMBOL
THERMOPLASTIC (8", 90 mils)		UK	BICYCLE STRAIGHT ARROW
TN	WHITE GORE LINE	COLD APPLIED PLASTIC (4")	
TP	YELLOW DIAGONAL	CC	10 FT. WHITE SKIP
THERMOPLASTIC (8", 120 mils)		CE	WHITE SOLID LANE LINE
TQ	WHITE CROSSWALK LINE	CI	YELLOW DOUBLE CENTER LINE
THERMOPLASTIC (24", 120 mils)		COLD APPLIED PLASTIC (8")	
T2	WHITE STOPBAR	CP	YELLOW DIAGONAL

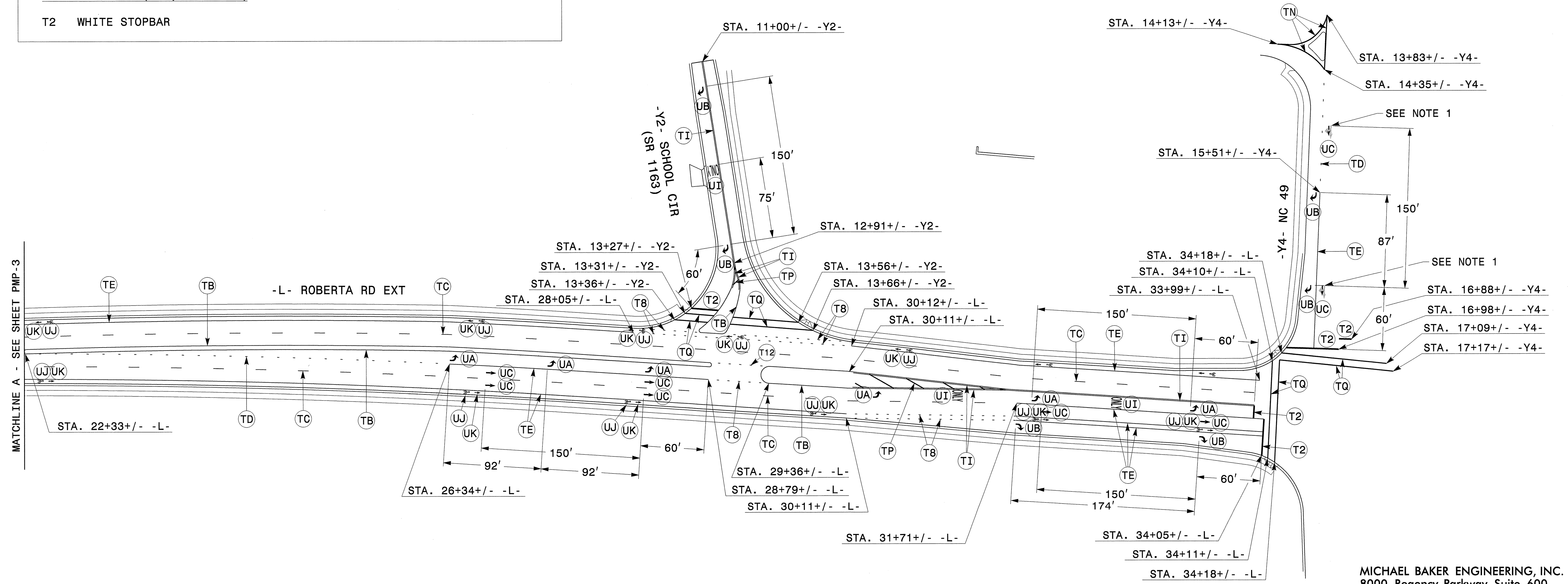

13-FEB-2013 17:41:51 \\P:\Projects\5208D\DISCIPLINE\Trafic\pmp\pmp-4.dgn W. Johnson AT CARY W. JOHNSON

NOTES:  
1. REMOVE EXISTING PAVEMENT MARKING.

MICHAEL BAKER ENGINEERING, INC.  
8000 Regency Parkway, Suite 600  
Cary, NC 27518  
NC LICENSE NO. - F-1084

## PAVEMENT MARKING DETAIL

APPROVED: \_\_\_\_\_

DATE: \_\_\_\_\_

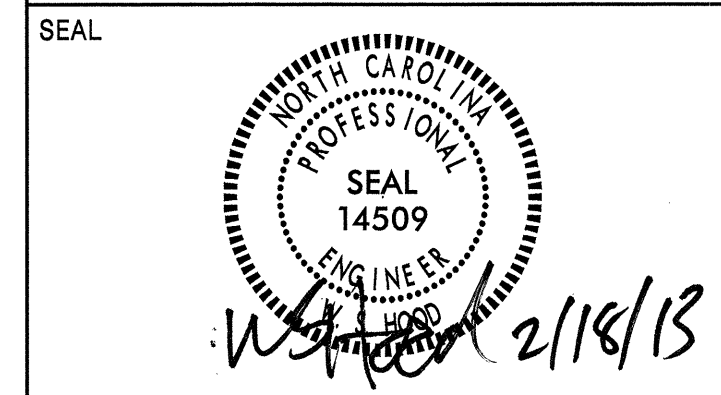

**PERMANENT PAVEMENT MARKING SCHEDULE**

<u>THERMOPLASTIC (4", 90 mils)</u>	<u>THERMOPLASTIC SYMBOL (90 mils)</u>
TA WHITE EDGELINE	UA LEFT TURN ARROW
TB YELLOW EDGELINE	UB RIGHT TURN ARROW
	UC STRAIGHT ARROW
<u>THERMOPLASTIC (4", 120 mils)</u>	UD COMB STRAIGHT LEFT ARROW
TC 10 FT. WHITE SKIP	UE COMB STRAIGHT RIGHT ARROW
TD 3 FT-9 FT/SP WHITE MINISKIP	UG COMB LEFT RIGHT STRAIGHT ARROW
TE WHITE SOLID LANE LINE	<u>THERMOPLASTIC THICK (120 mils)</u>
TI YELLOW DOUBLE CENTER LINE	UI ALPHANUMERIC CHARACTER
T8 2 FT-6 FT/SP WHITE MINISKIP	UJ BICYCLE SYMBOL
<u>THERMOPLASTIC (8", 90 mils)</u>	UK BICYCLE STRAIGHT ARROW
TN WHITE GORE LINE	<u>COLD APPLIED PLASTIC (4")</u>
TP YELLOW DIAGONAL	CC 10 FT. WHITE SKIP
<u>THERMOPLASTIC (8", 120 mils)</u>	CE WHITE SOLID LANE LINE
TQ WHITE CROSSWALK LINE	CI YELLOW DOUBLE CENTER LINE
<u>THERMOPLASTIC (24", 120 mils)</u>	<u>COLD APPLIED PLASTIC (8")</u>
T2 WHITE STOPBAR	CP YELLOW DIAGONAL

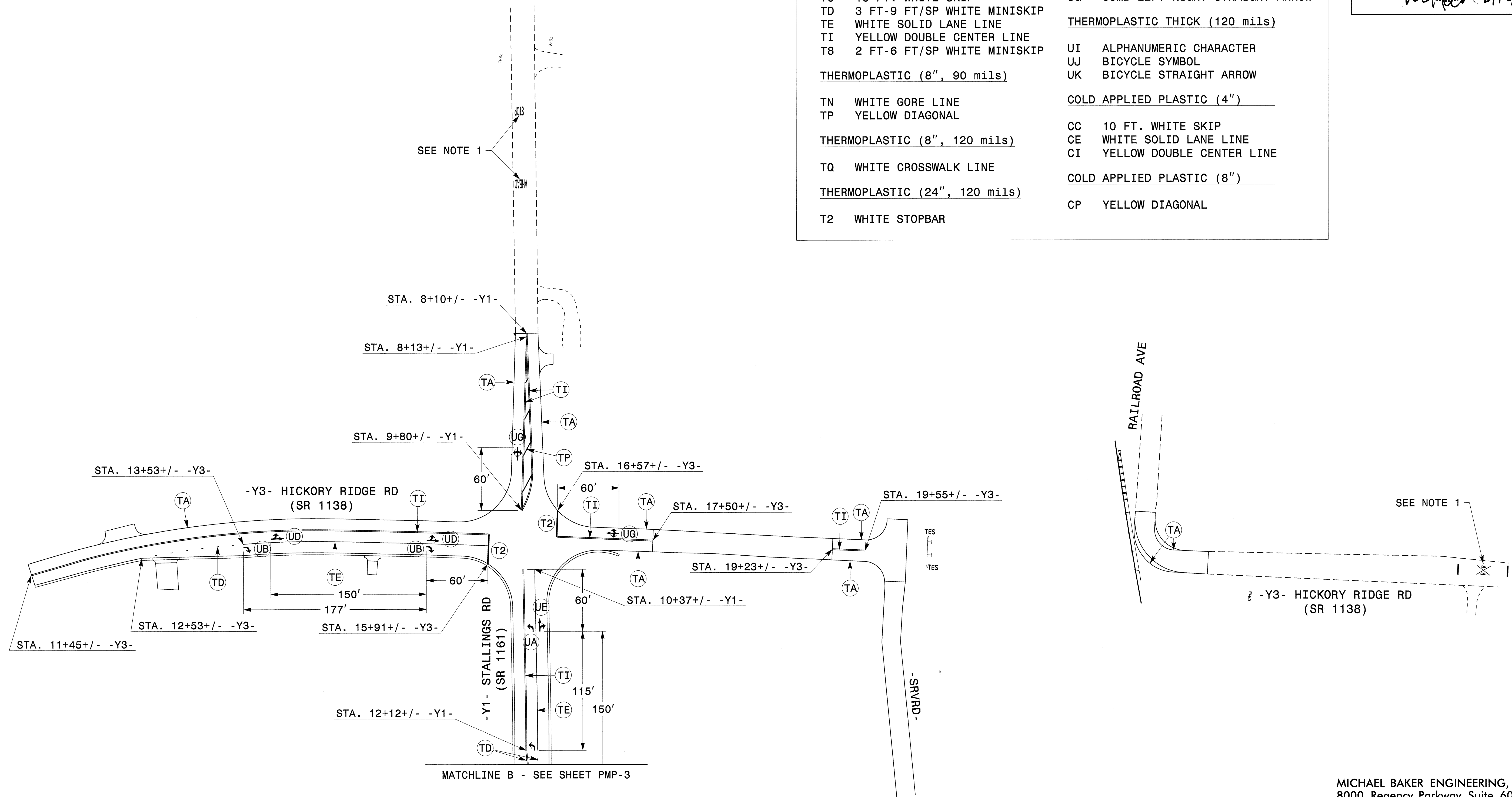

NOTES:  
1. REMOVE EXISTING PAVEMENT MARKING.

MICHAEL BAKER ENGINEERING, INC.  
8000 Regency Parkway, Suite 600  
Cary, NC 27518  
NC LICENSE NO. - F-1084

**PAVEMENT MARKING DETAIL**