

PROJ. REFERENCE NO.	SHEET NO.
B-4836	X-1A

STATE OF NORTH CAROLINA
DIVISION OF HIGHWAYS

NOTE: EMBANKMENT COLUMN DOES NOT INCLUDE BACKFILL FOR UNDERCUT

CROSS-SECTION SUMMARY

PHASE 1		
Station	Uncl. Exc.	Embt
-L-	(cu. yd.)	(cu. yd.)
12+50.00	0	0
12+74.69	0	483

Station	Uncl. Exc.	Embt
-L-	(cu. yd.)	(cu. yd.)
14+00.00	0	0
14+50.00	0	93
14+92.31	0	468
15+00.00	0	120
15+50.00	0	671
16+00.00	0	506
16+50.00	0	345
17+00.00	0	197

PHASE 2		
Station	Uncl. Exc.	Embt
-L-	(cu. yd.)	(cu. yd.)
10+65.00	0	0
11+00.00	27	48
11+50.00	32	189
12+00.00	0	232
12+50.00	17	111
12+74.69	97	2

Station	Uncl. Exc.	Embt
-L-	(cu. yd.)	(cu. yd.)
14+28.00	0	0
14+50.00	302	0
14+92.31	485	0
15+00.00	70	0
15+50.00	230	0
16+00.00	2	0
17+00.00	0	0
17+50.00	13	21
18+00.00	25	31
18+50.00	46	22
19+00.00	41	16
19+10.00	3	1

Station	Uncl. Exc.	Embt
-Y-	(cu. yd.)	(cu. yd.)
10+09.04	0	0
10+25.00	0	20
10+50.00	0	8
10+75.00	1	4
11+00.00	4	6
11+25.00	6	6
11+50.00	7	1
11+75.00	8	3
11+80.00	1	1

Station	Uncl. Exc.	Embt
-DR-	(cu. yd.)	(cu. yd.)
10+09.00	0	0
10+25.00	0	43
10+50.00	0	128
10+75.00	0	91
10+89.50	0	48
11+00.00	0	45
11+25.00	0	113
11+34.49	0	38
11+39.72	0	9

Earthwork quantities are calculated by the Roadway Design Unit. These earthwork quantities are based in part on subsurface data provided by the Geotechnical Engineering Unit.

Approximate quantities only. Unclassified excavation, fine grading and clearing and grubbing will be paid for at the lump sum price for "Grading".

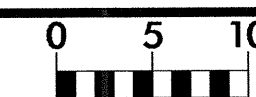

150 140 130 120 110 100 90 80 70 60 50 40 30 20 10 0 10 20 30 40 50 60 70 80 90 100 110 120 130 140 150

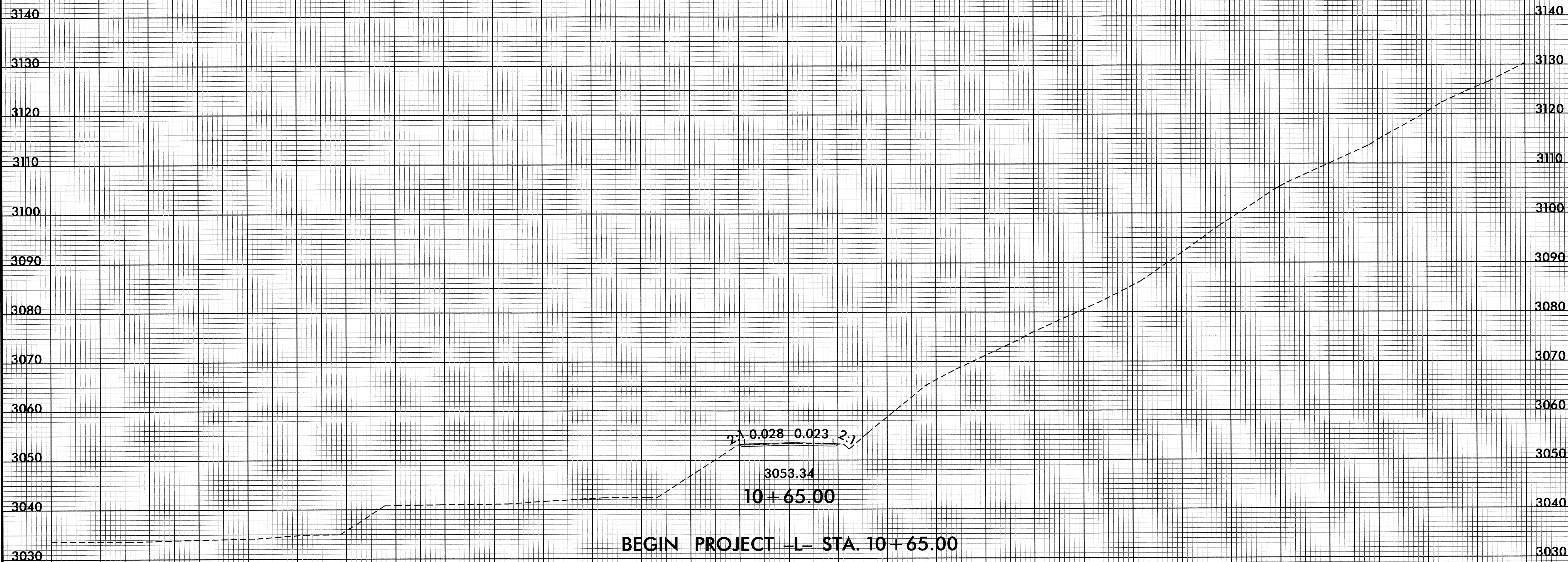

150 140 130 120 110 100 90 80 70 60 50 40 30 20 10 0 10 20 30 40 50 60 70 80 90 100 110 120 130 140 150

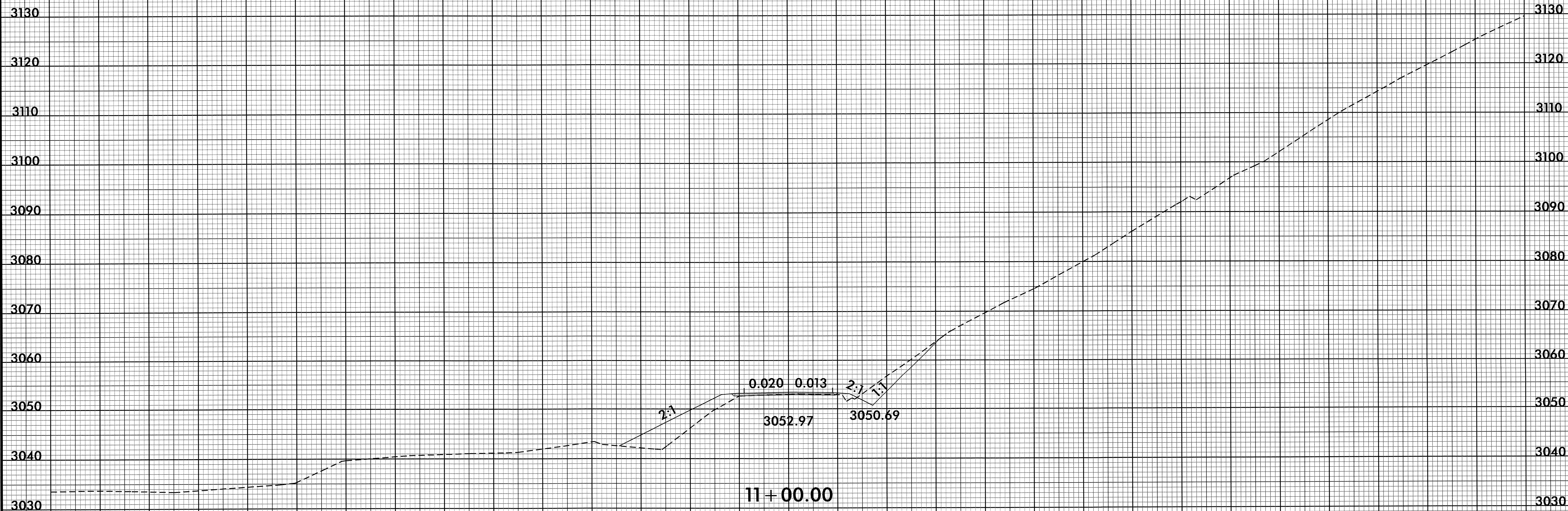

8/23/99

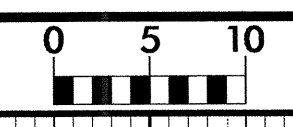

PROJ. REFERENCE NO.	SHEET NO.
B-4836	X-4

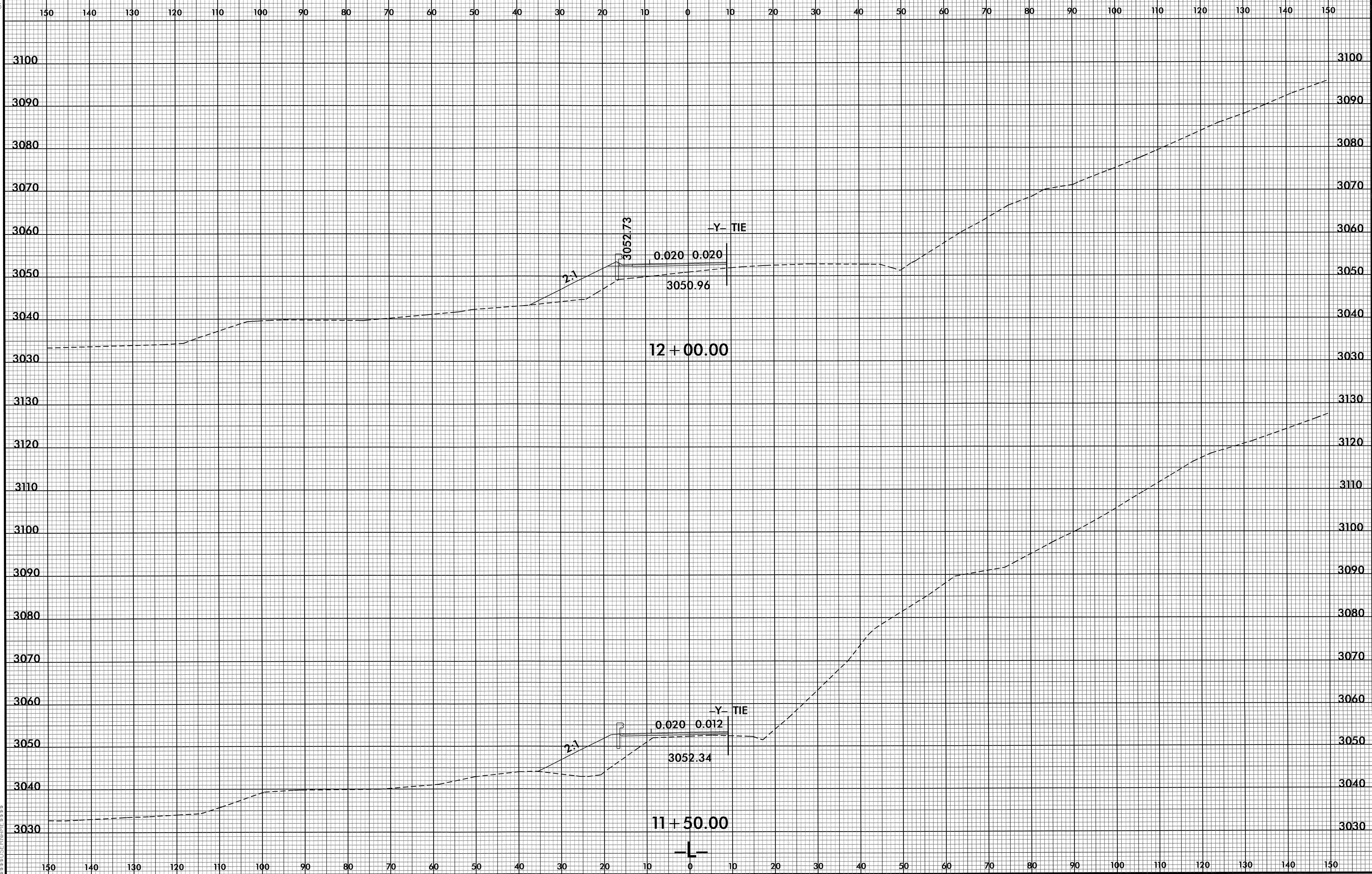

b

b

05-OCT-2012 15:48
 4489128.DWG
 4489128.DWG

8/23/99

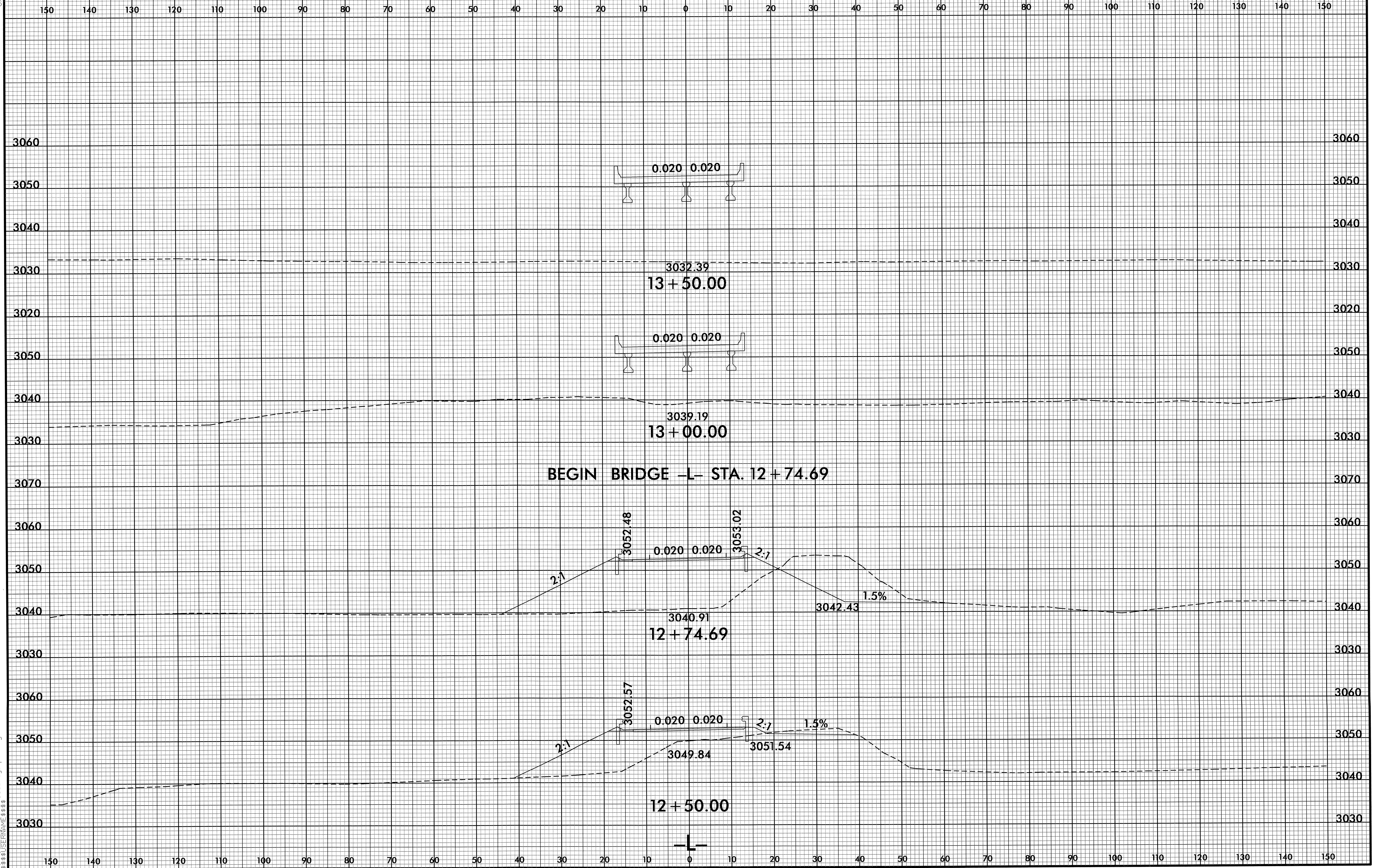

10-OCT-2012 14:15
F:\Projects\XSC\B4836_Rdy-xxp1.L.dgn
\$\$\$\$\$USERNAME\$\$\$\$\$

8/23/99

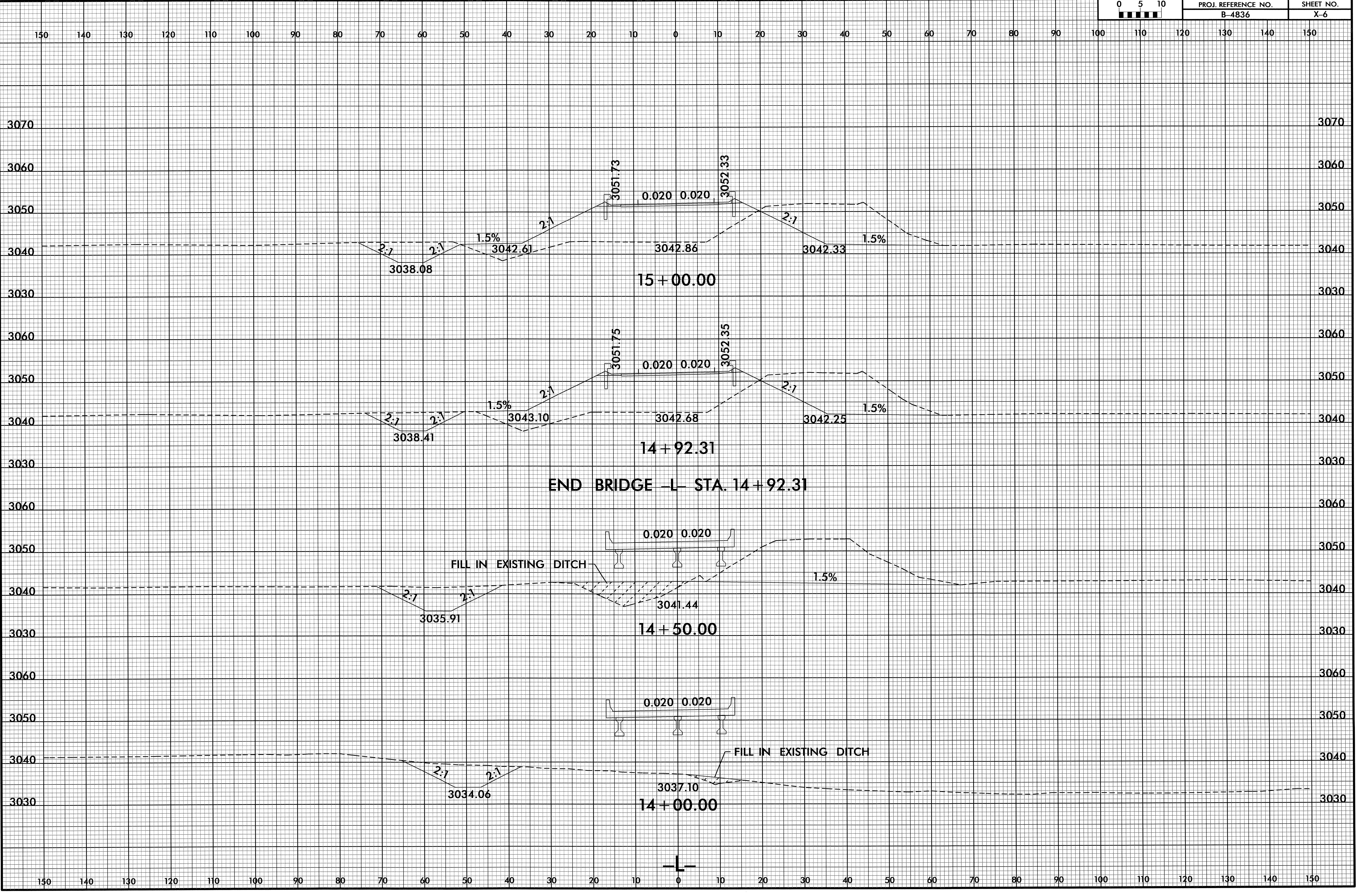

10-OCT-2002 14:15
R:\Roadwork\XSC B4836_Rdy_xpl.L.dgn
\$\$\$\$\$USER\$NAME\$\$\$\$

8/23/99

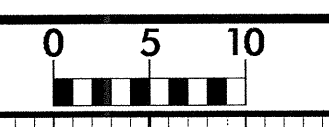

PROJ. REFERENCE NO.
B-4836

SHEET NO.
X-7

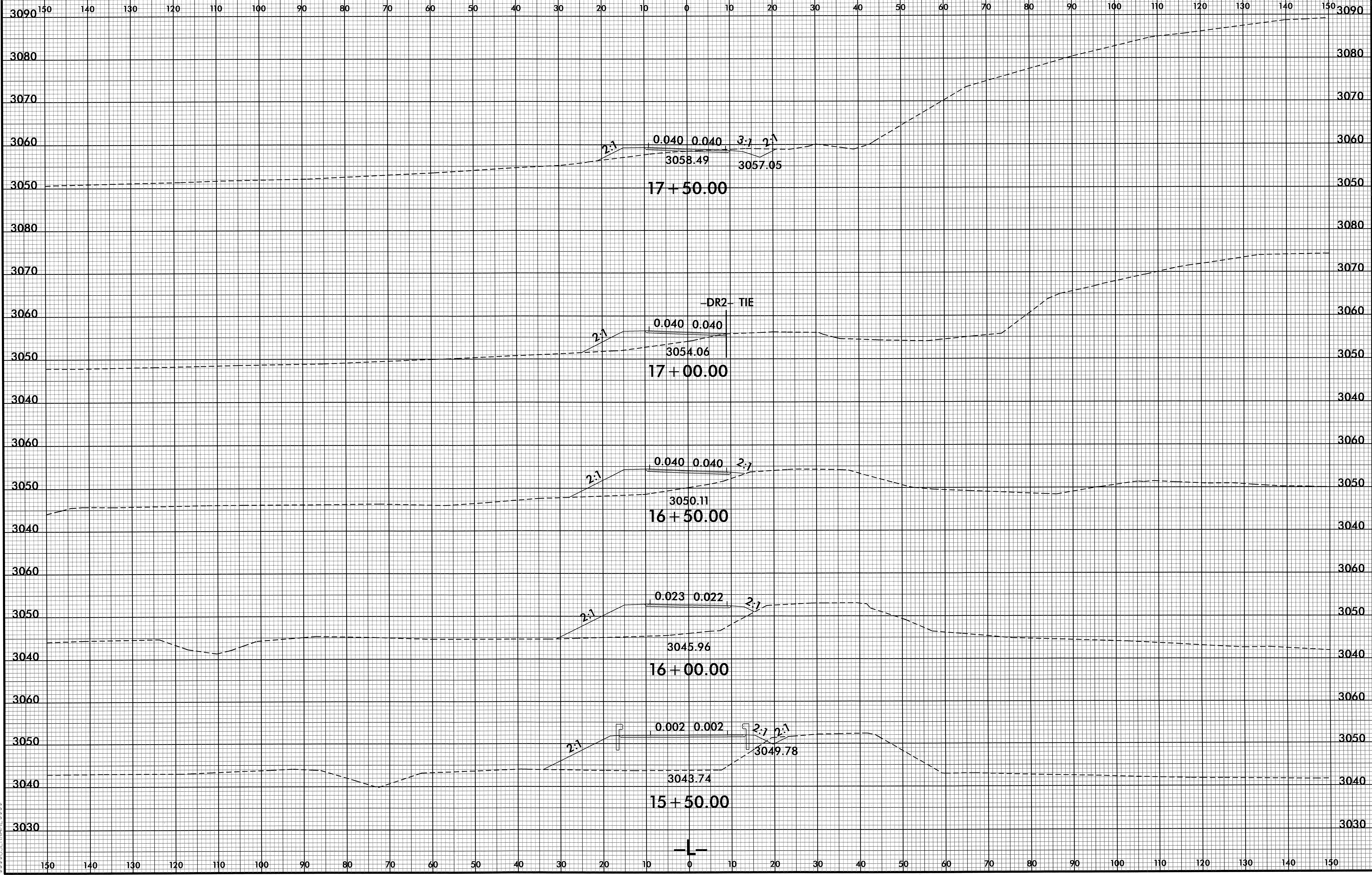

22-OCT-2012 14:37 B:\6836_Rdy_xpl.dgn
3:33:58

8/23/99



PROJ. REFERENCE NO.
B-4836

SHEET NO.
X-8

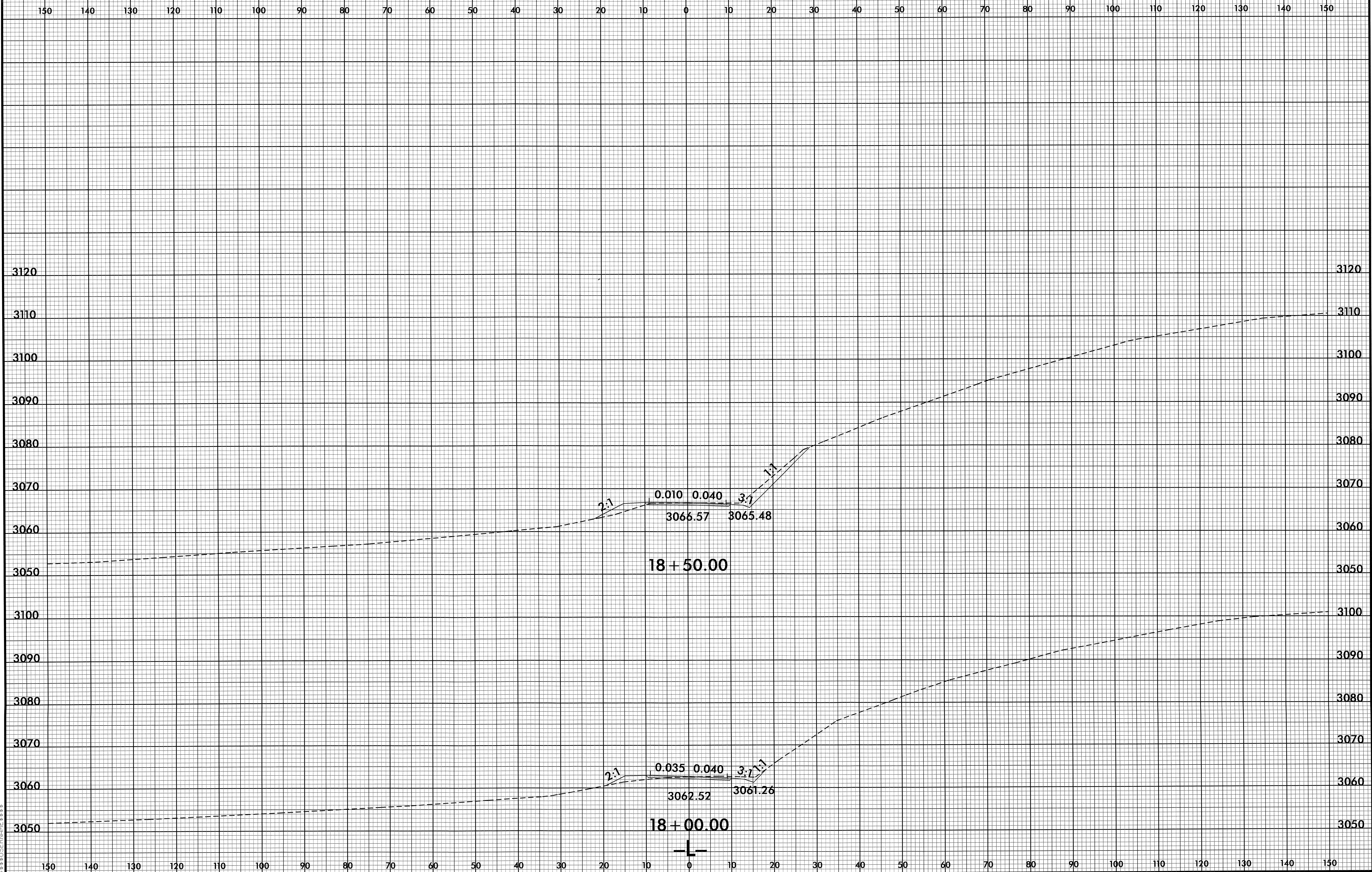

09-OCT-2012 15:48 P:\836_Rdy_xp1.L.dgn
3:35:50 PM

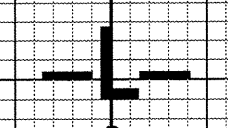

8/23/99

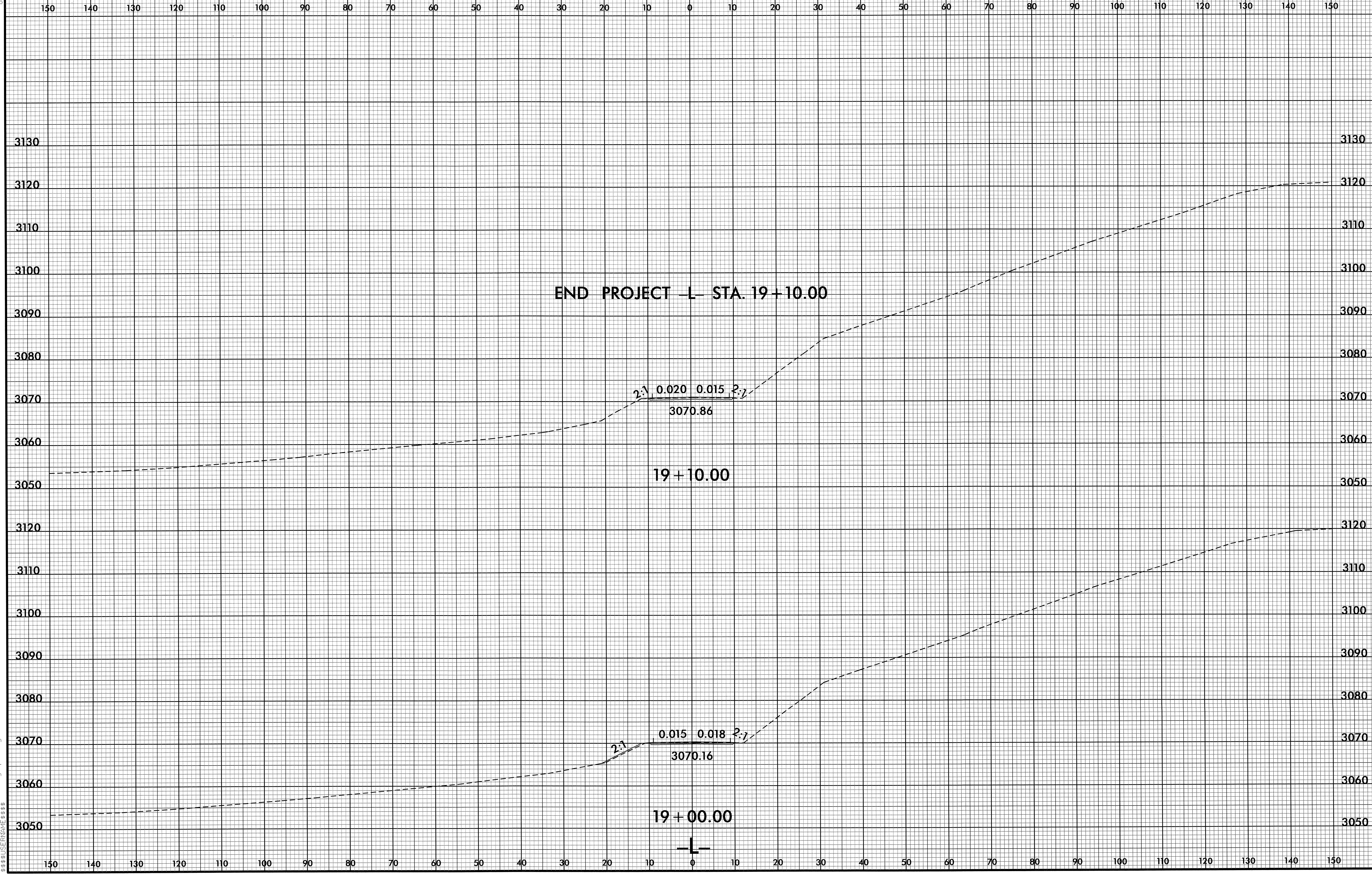

09-OCT-2012 15:48
R:\Roadway\XSC\B4836_Rdy_xpl.L.dgn
\$\$\$\$USERNAME\$\$\$\$

8/23/99

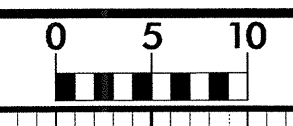

PROJ. REFERENCE NO.
B-4836

SHEET NO.
X-11

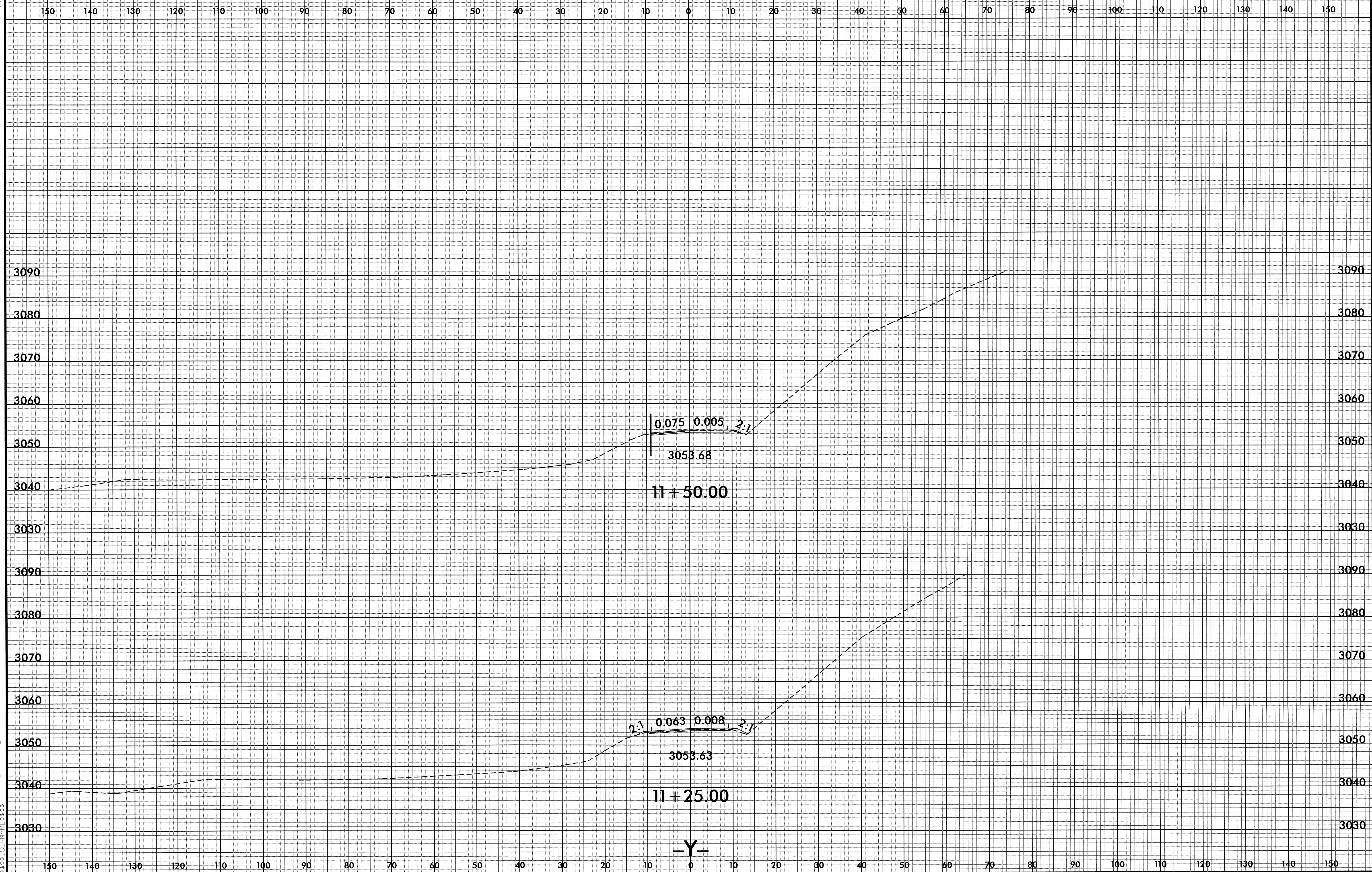

09-OCT-2012 10:24
 P:\PROJECTS\B-4836\Fldy_xp1.Y.dgn
 11+25.00

—Y—

8/23/99

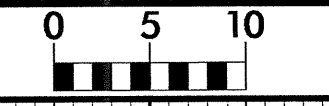

PROJ. REFERENCE NO.
B-4836

SHEET NO.
X-12

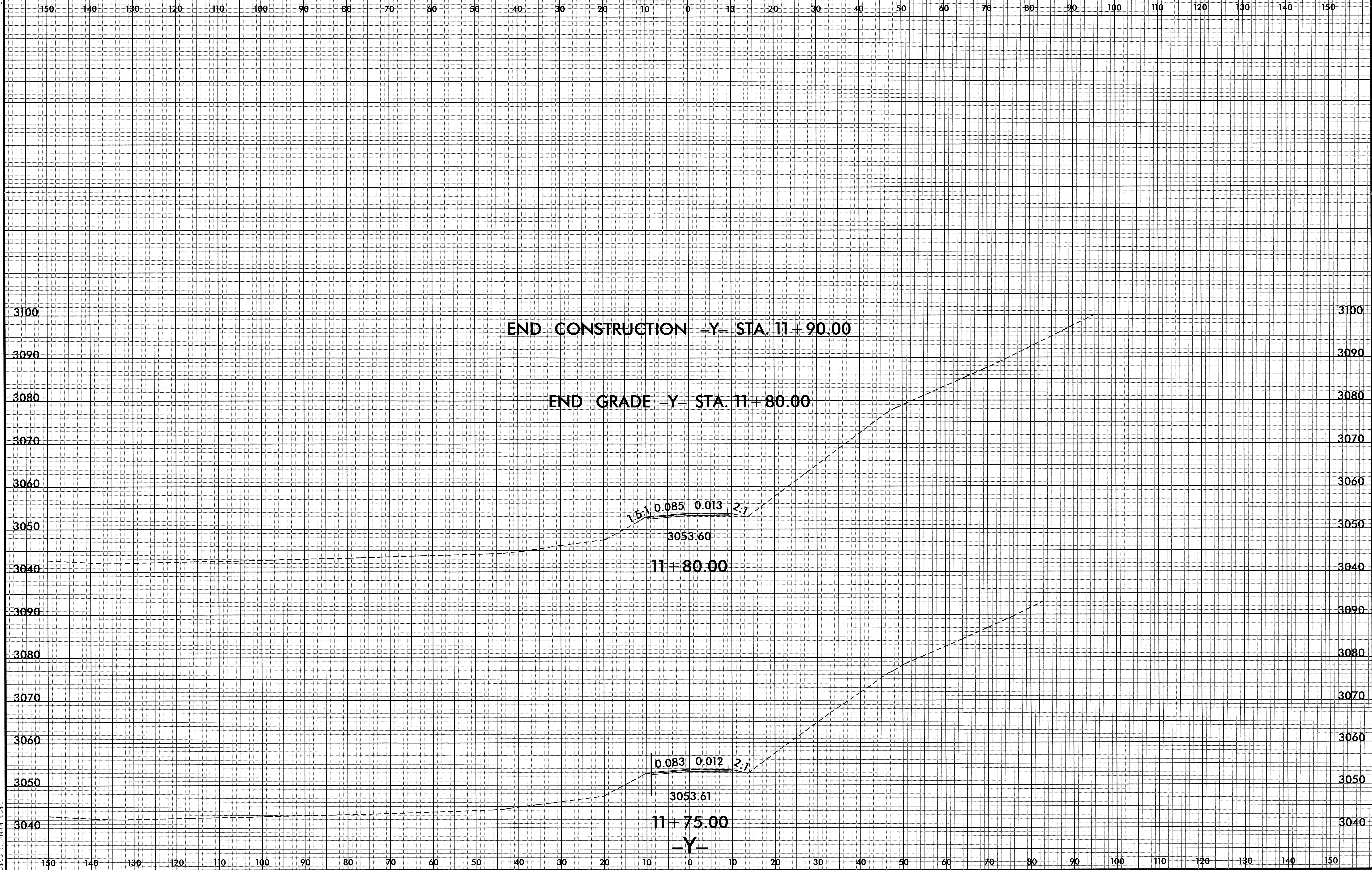

09-OCT-2012 10:24
S:\PROJECTS\B4836-Rdg-xpl-Y.dgn

B/23/99

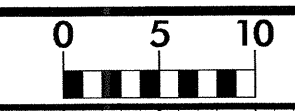

PROJ. REFERENCE NO. B-4836	SHEET NO. X-13
-------------------------------	-------------------

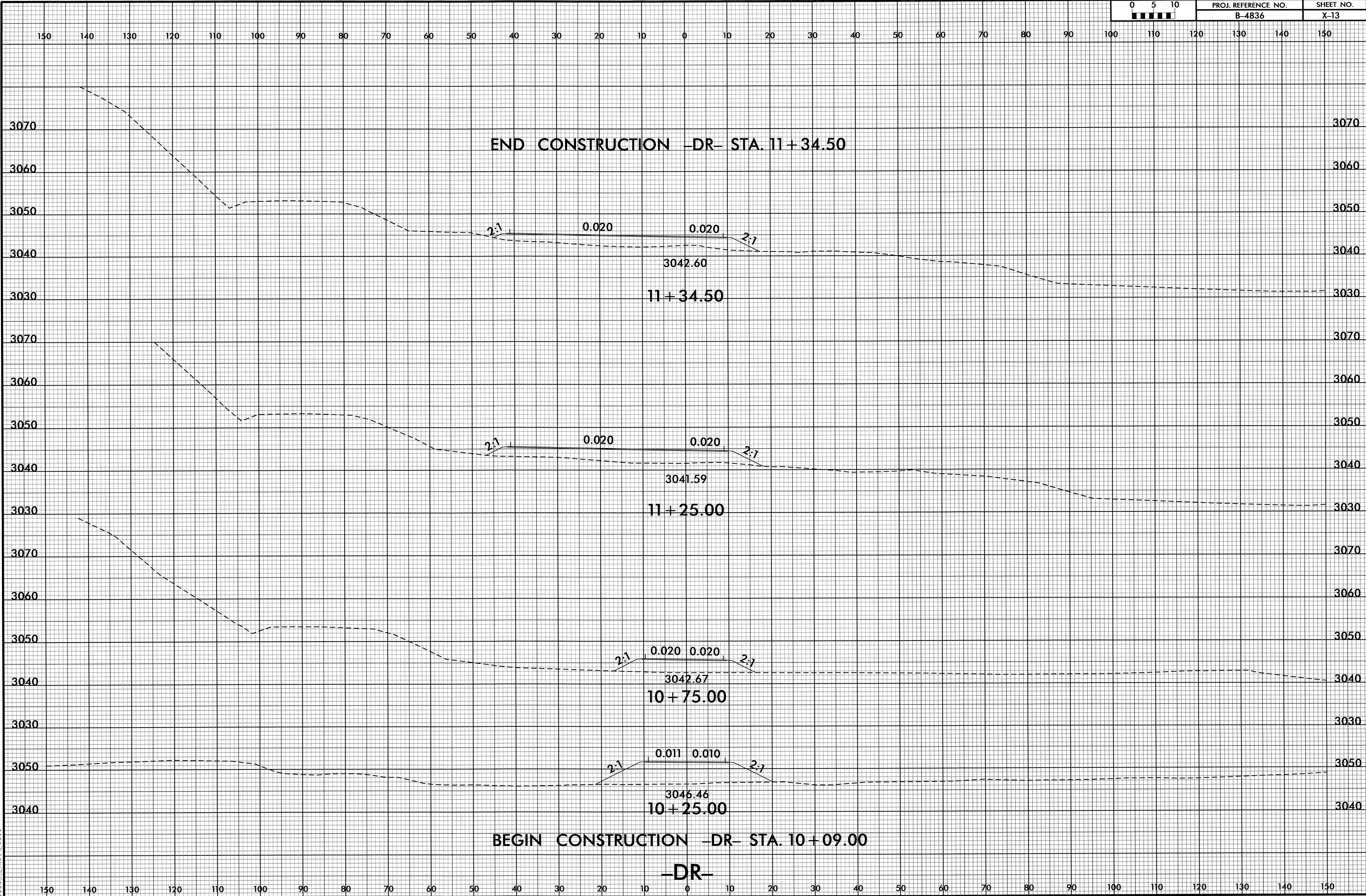

END CONSTRUCTION -DR- STA. 11+34.50

11+34.50

11+25.00

10+75.00

10+25.00

BEGIN CONSTRUCTION -DR- STA. 10+09.00

-DR-

09-OCT-2012 10:24
F:\Roadway\SC-B4836_Rdwy_xpl_DR.dgn
\$\$\$\$\$RENAME\$\$\$\$\$