

PROJECT NO.	SHEET NO.	TOTAL SHEETS
13CR.10571.10 13CR.20571.11	1	

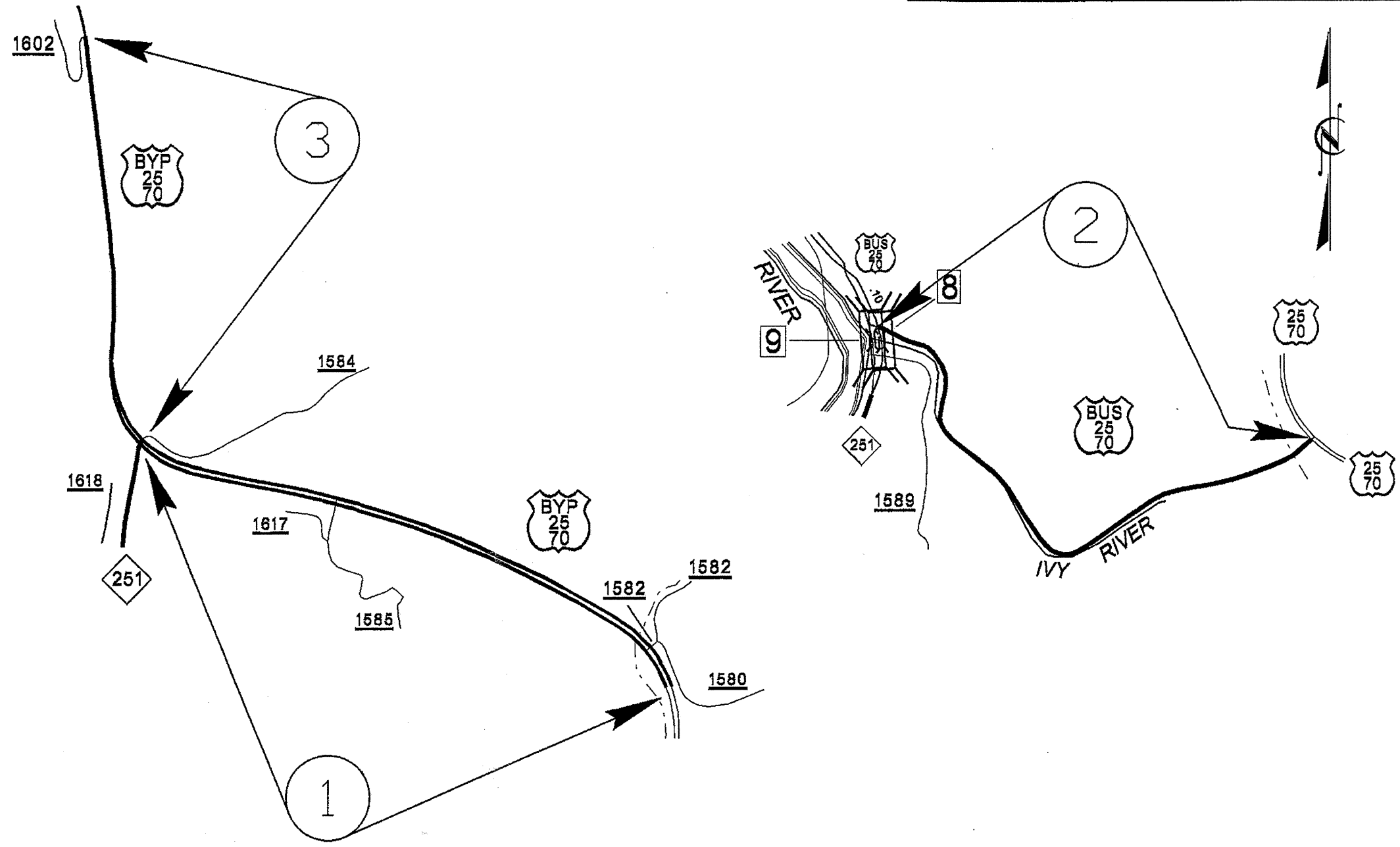

**MADISON COUNTY**

PROJECT NO.	SHEET NO.	TOTAL SHEETS
13CR.10571.10 13CR.20571.11	2	

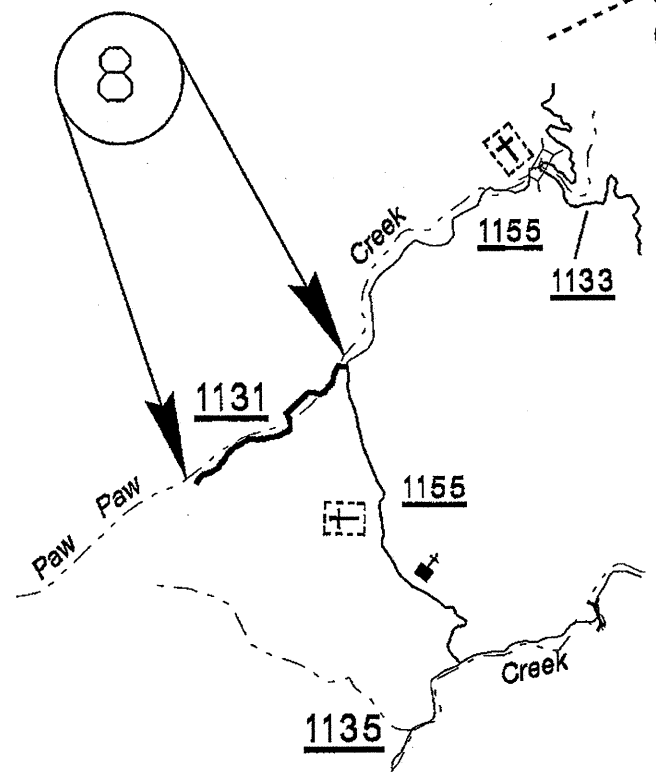
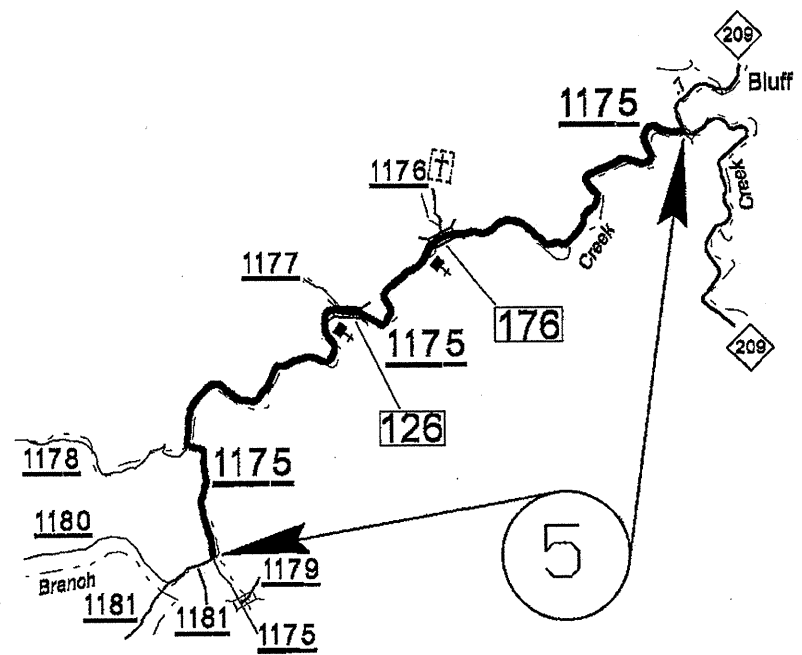
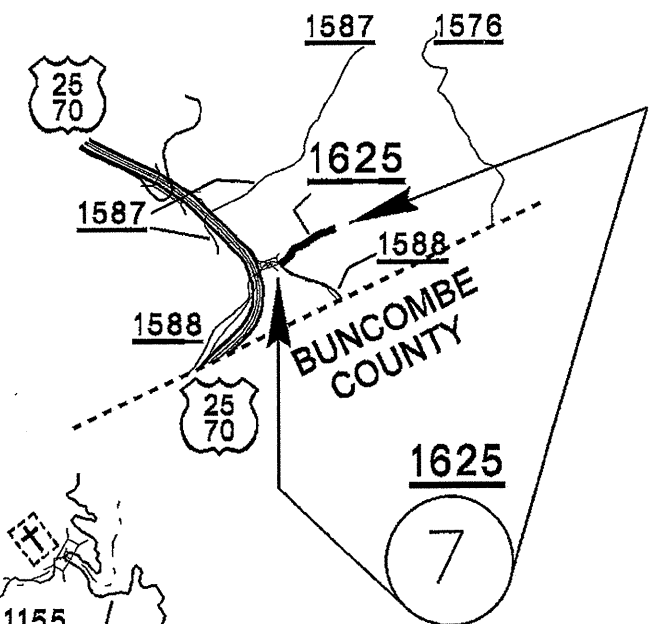
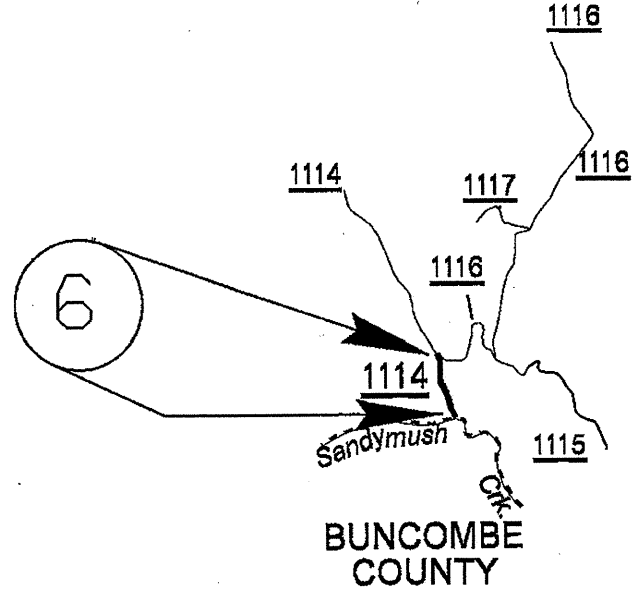
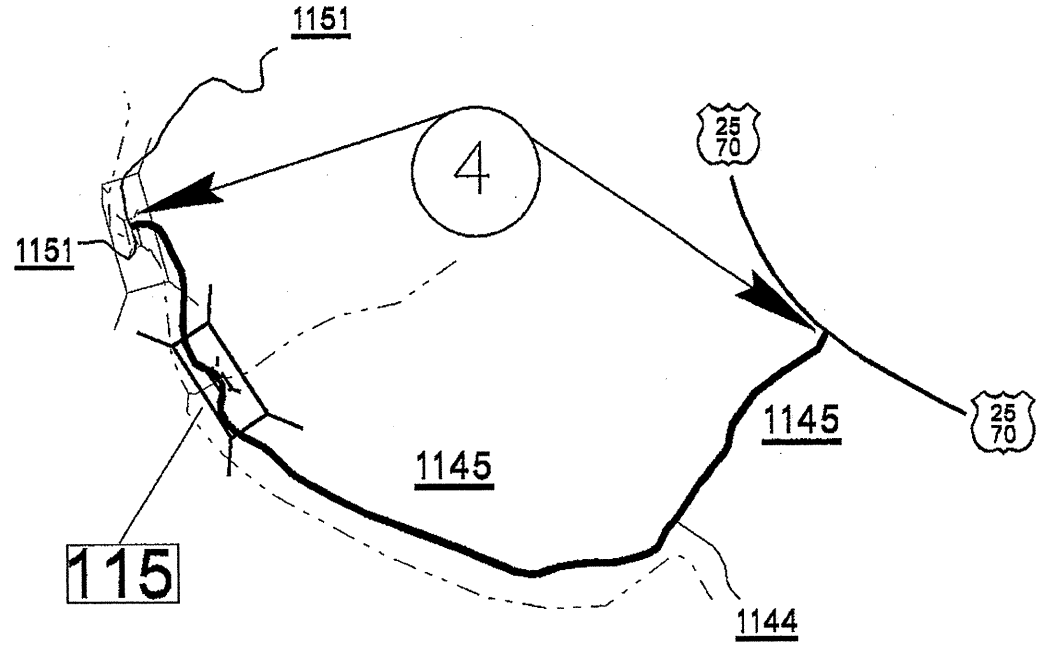

**MADISON COUNTY**

PROJECT NO.	SHEET NO.	TOTAL SHEETS
13CR.10571.10 13CR.20571.11	3	

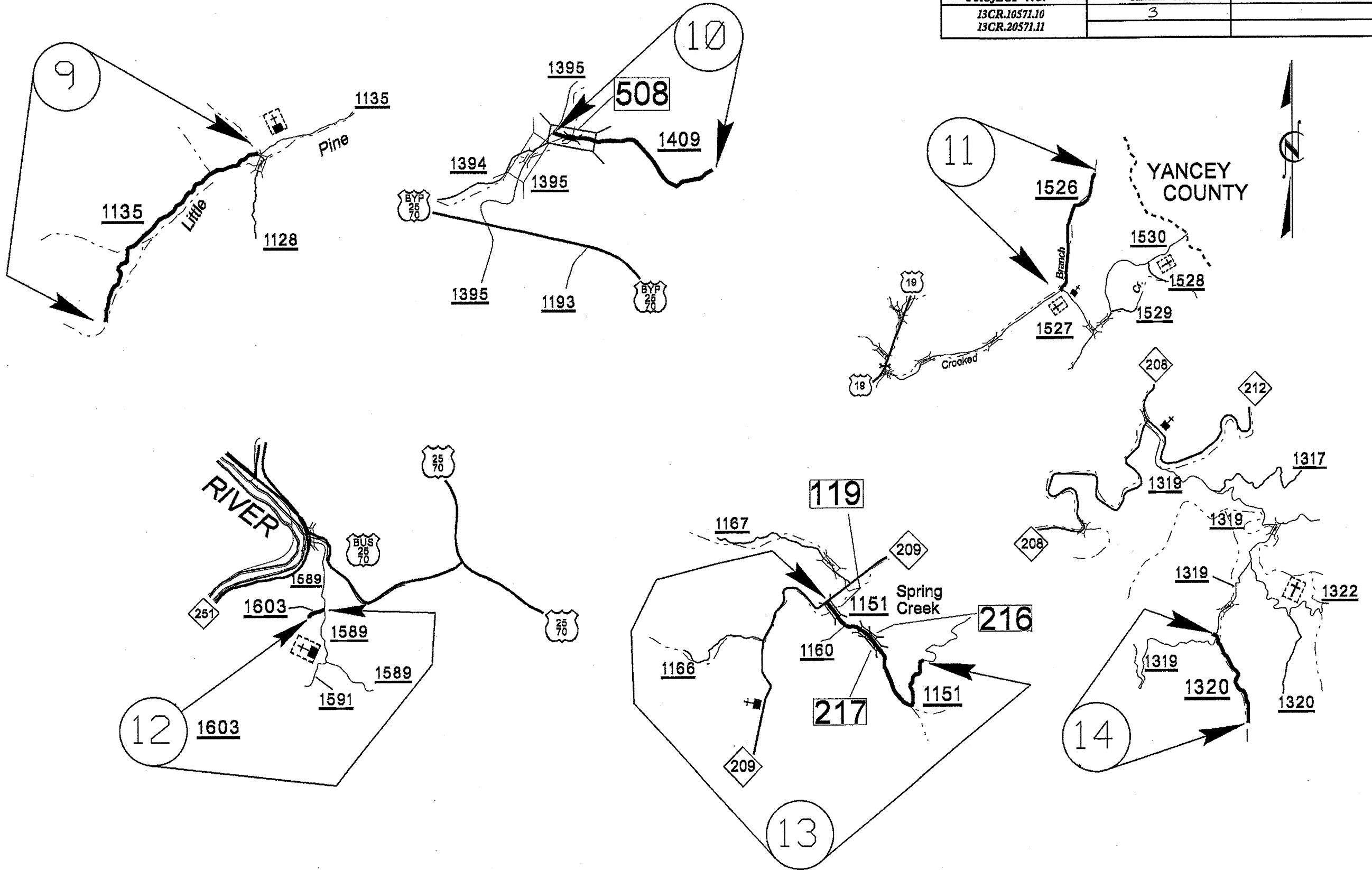

**MADISON COUNTY**

<b>PROJECT NO.</b>	<b>SHEET NO.</b>	<b>TOTAL SHEETS</b>
13CR.10571.10 , 13CR.20571.11	4	

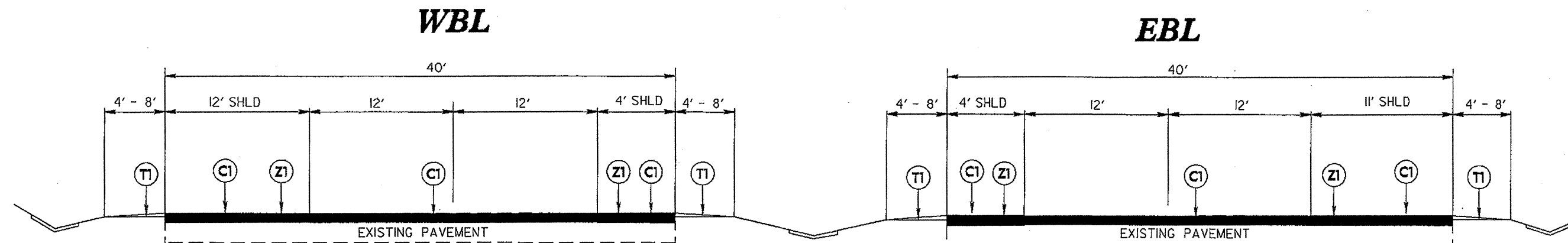

**TYPICAL SECTION NO. 1**

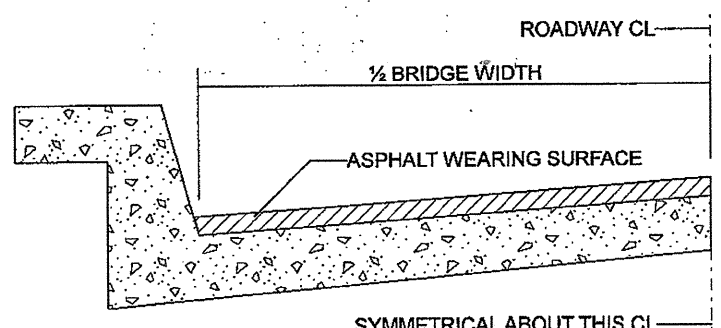

**BRIDGE HALF TYPICAL SECTION**

FOR BRIDGES WITH FLOOR DRAINS, CARE SHALL BE EXERCISED IN PLACING THE WEARING SURFACE AROUND FLOOR DRAINS SO AS NOT TO HINDER EFFECTIVE DRAINAGE. ALL DRAINS SHALL BE LEFT OPEN

THE PROPOSED WEARING SURFACE SHALL VARY IN THICKNESS AS NECESSARY TO PROVIDE A SMOOTH RIDING SURFACE. THE MINIMUM THICKNESS SHOULD DEPEND ON PAVEMENT TYPE AS FOLLOWS: S4.75A 1/2", SF9.5A 1.0", S9.5X 1.5", S12.5X 2.0", ULTRATHIN HOT MIX ASPHALT-TYPE A 1/4", ULTRATHIN HOT MIX ASPHALT-TYPE B 5/8", ULTRATHIN HOT MIX ASPHALT-TYPE C 1/2". THE MAXIMUM THICKNESS SHOULD DEPEND ON PAVEMENT TYPE AS FOLLOWS: S4.75A 1.0", SF9.5A 1.5", S9.5X 2.0", S12.5X 2.0", ULTRATHIN HOT MIX ASPHALT-TYPE A 1/4", ULTRATHIN HOT MIX ASPHALT-TYPE B 5/8", ULTRATHIN HOT MIX ASPHALT-TYPE C 1/2".

**NOTES**

ALL UNPAVED ROADS TO BE RESURFACED 50' FROM EDGE OF PAVEMENT OF MAIN PROJECT.  
 ALL PAVED S.R. ROADS TO BE RESURFACED TO THE ENDS OF THE RADII, OR AS DIRECTED BY THE ENGINEER.  
 EDGES, PAVEMENT WIDENING, INTERSECTIONS AND BRIDGE FLARES ARE INCLUDED IN THE TABLE OF QUANTITIES.  
 SHOULDERS AND DITCHES ARE TO BE CONSTRUCTED BY OTHERS UNLESS OTHERWISE INDICATED.  
 BRIDGES ARE TO BE RESURFACED AT LOCATIONS AND TO DEPTH AS DIRECTED BY THE ENGINEER.

PAVEMENT SCHEDULE	
C1	PROP. APPROX. 1 1/2" ASPHALT CONCRETE SURFACE COURSE, TYPE S9.5B, AT AN AVERAGE RATE OF 168 LBS. PER SQ. YD.
T1	SHOULDER RECONSTRUCTION
Z1	MILLED RUMBLE STRIPS

PROJECT NO.	SHEET NO.	TOTAL SHEETS
13CR.10571.10, 13CR.20571.11	5	

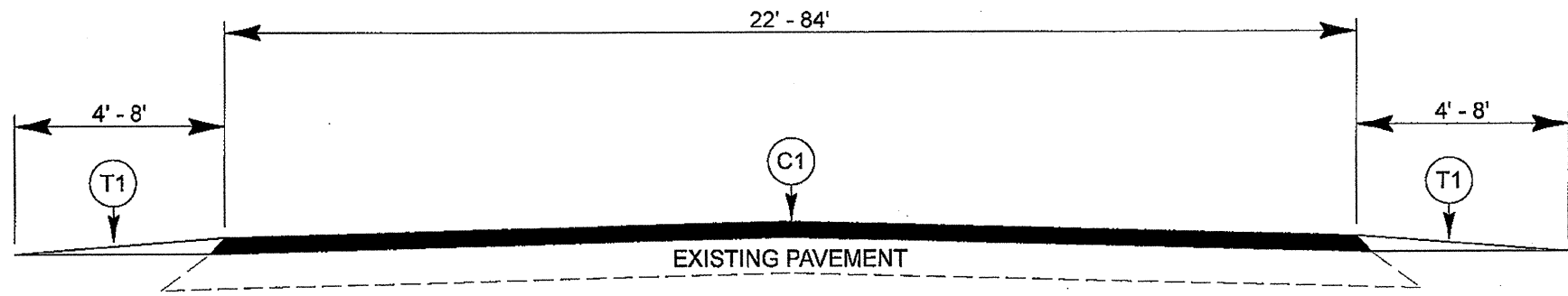

TYPICAL SECTION NO. 2

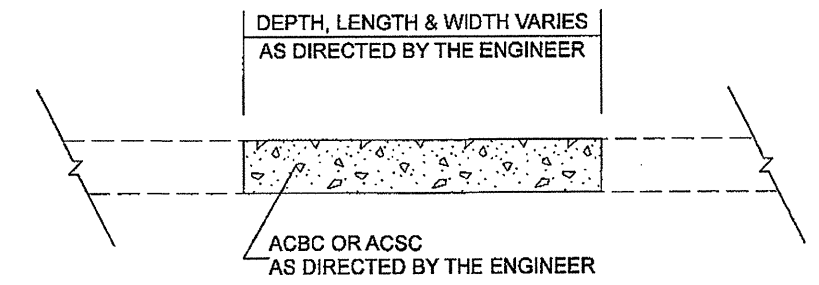

PATCHING EXISTING PAVEMENT

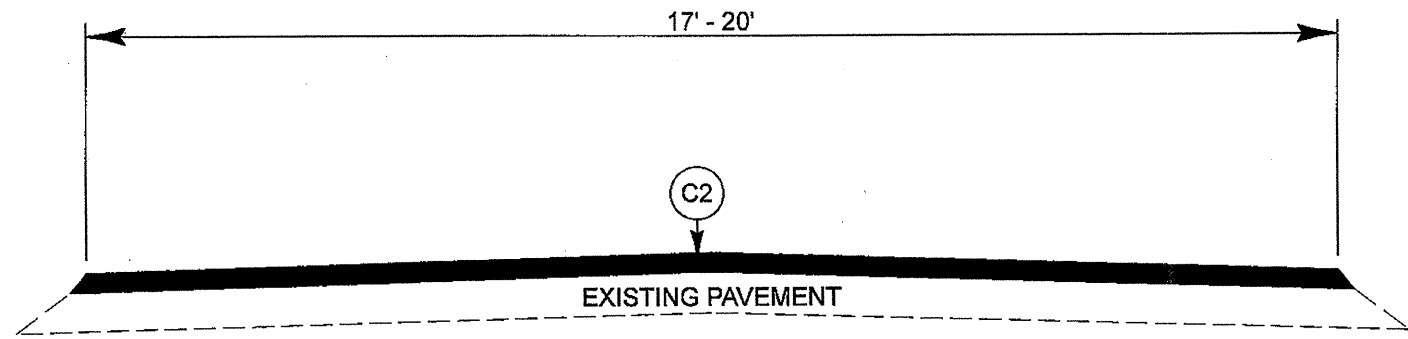

TYPICAL SECTION NO. 3

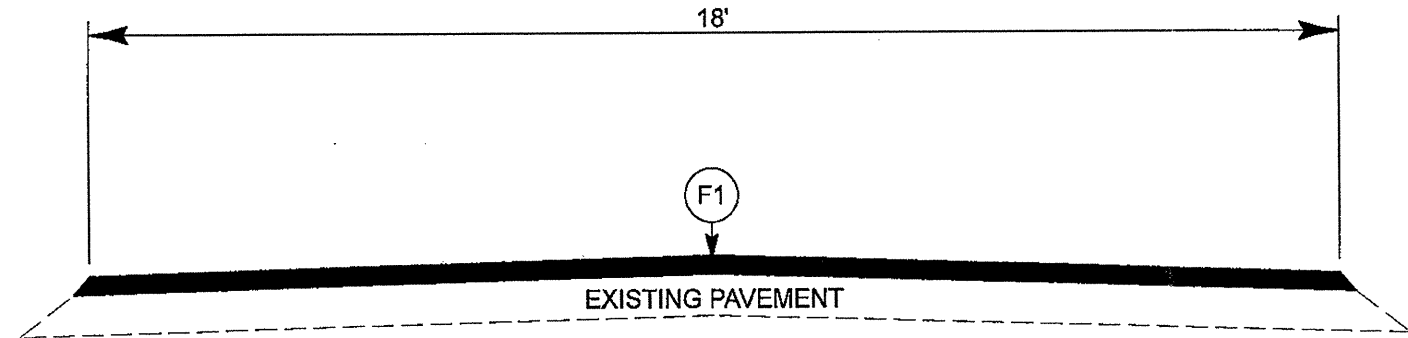

TYPICAL SECTION NO. 4

PAVEMENT SCHEDULE	
C1	PROP. APPROX. 1-1/2" ASPHALT CONCRETE SURFACE COURSE, TYPE S9.5B, AT AN AVERAGE RATE OF 168 LBS. PER SQ. YD.
C2	PROP. APPROX. 1-1/2" ASPHALT CONCRETE SURFACE COURSE, TYPE SF9.5A, AT AN AVERAGE RATE OF 165 LBS. PER SQ. YD.
F1	ASPHALT SURFACE TREATMENT, SPLIT SEAL
T1	SHOULDER RECONSTRUCTION

<b>PROJECT NO.</b>	<b>SHEET NO.</b>	<b>TOTAL SHEETS</b>
13CR.10571.10 , 13CR.20571.11	6	

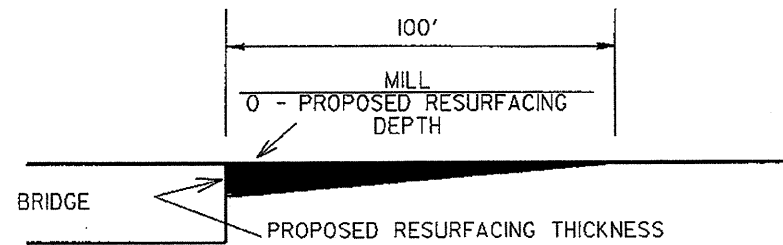

**INCIDENTAL MILLING DETAIL AT BRIDGE APPROACHES**  
**WHERE BRIDGES WILL NOT BE RESURFACED**  
**COST OF BRIDGE APPROACH MILLING IS INCIDENTAL TO OTHER ITEMS**

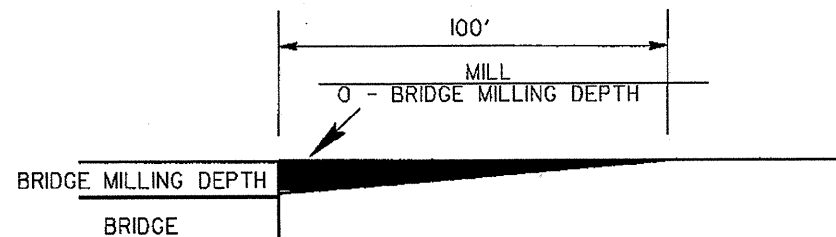

**INCIDENTAL MILLING DETAIL AT BRIDGE APPROACHES**  
**WHERE BRIDGES WILL BE MILLED THEN RESURFACED**  
**COST OF BRIDGE APPROACH MILLING IS INCIDENTAL TO OTHER ITEMS**

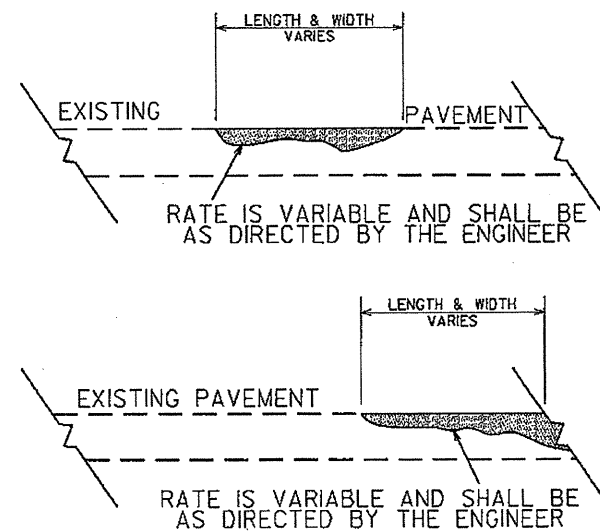

**DETAIL SHOWING  
METHOD OF WEDGING**

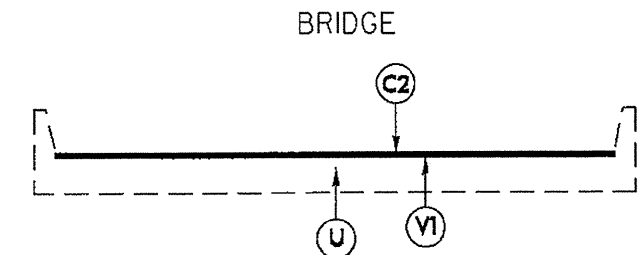

**BRIDGE DETAIL**

**BRIDGE # 115 MAP 4 AND  
BRIDGE # 126 AND # 176 MAP 5  
MILL 1/2" OFF EXISTING PAVEMENT  
SEE MAPS FOR BRIDGE LOCATION**

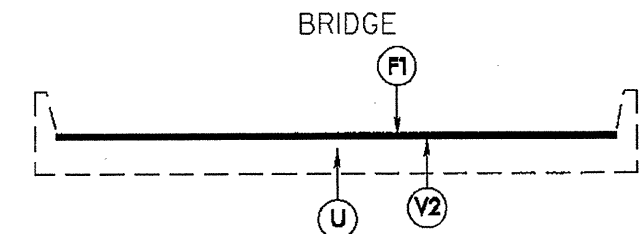

**BRIDGE DETAIL**

**BRIDGE # 508 MAP 10 AND  
BRIDGE # 119 AND # 216 MAP 13  
MILL 1" OFF EXISTING PAVEMENT  
SEE MAPS FOR BRIDGE LOCATION**

PAVEMENT SCHEDULE	
C2	PROP. APPROX. 1 1/2" ASPHALT CONCRETE SURFACE COURSE, TYPE SF8.5A, AT AN AVERAGE RATE OF 165 LBS. PER SQ. YD.
F1	ASPHALT SURFACE TREATMENT, SPLIT SEAL
U	EXISTING PAVEMENT
V1	MILLING ASPHALT PAVEMENT, 1 1/2" DEPTH
V2	MILLING ASPHALT PAVEMENT, 1" DEPTH



PROJECT NO.	SHEET NO.	TOTAL NO.
13CR.10571.10, 13CR.20571.11	8	

## SUMMARY OF QUANTITIES

PROJECT NO	COUNTY	MAP NO	ROUTE	DESCRIPTION	TYP NO	FINAL SURFACE TESTING REQUIRED	WARM MIX ASPHALT REQUIRED	LENGTH MI	WIDTH FT	INCIDENTAL STONE BASE TON	SHOULDER RECONSTRUCTION SMI	1½" MILLING SY	1" MILLING SY	ASPHALT CONC SURFACE COURSE, TYPE S9.5B TON	ASPHALT CONC SURFACE COURSE, TYPE SF9.5A TON	ASPHALT BINDER FOR PLANT MIX TON	PATCHING EXISTING PAVEMENT TON	ASPHALT SURFACE TREATMENT, SPLIT SEAL SY	MILLED RUMBLE STRIPS LF
13CR.10571.10	Madison	1	US 25/70	FROM 0.15 MILES SOUTH OF SR 1582 (LONG BR.) TO NC 251 (MP 1.94 - 3.31) AND SOUTHBOUND (MP 24.93 - 23.57)	1	NO	NO	1.37	80	68.50	4.80			5,950		357	450		28,934
		2	US 25/70 BUS	FROM NC 251 (MP 1.30) TO US 25/70 (MP 0.00)	2	NO	NO	1.3	22	65.00	2.60			1,559		94	270		
		3	US 25/70	FROM SR 1602 (FORE RD. -- MP 4.19) TO NC 251 (MP 3.31)	2	NO	NO	0.88	36 - 84	44.00	1.76			1,723		103	153		
<b>TOTAL FOR PROJ NO. 13CR.10571.10</b>								<b>3.55</b>		<b>177.50</b>	<b>9.16</b>			<b>9,232</b>		<b>554</b>	<b>873</b>		<b>28,934</b>
13CR.20571.11	Madison	4	SR 1145 (SHARP HOLLOW)	FROM US 25/70 (MP 1.13) TO SR 1151 (BIG PINE RD. -- MP 0.00)	3	NO	NO	1.13	20	56.50		40			1,211	81	700		
		5	SR 1175 (MEADOW FORK RD.)	FROM SR 1181 (LITTLE CR -- MP 5.38) TO NC 209 (MP 10.69)	3	NO	NO	5.31	17	265.50		139			4,841	324	3,500		
		6	SR 1114 (BEAR CR)	FROM SR 1116 (RECTOR CORNER -- MP 0.30) TO BRIDGE (MP 0.01)	3	NO	NO	0.29	20	14.50					311	21	250		
		7	SR 1625 (IVY TRAILS)	FROM SR 1588 TO EOP ( MP 0 - 0.25)	4	NO	NO	0.25	18										2,640
		8	SR 1131 (JOE PAYNE RD.)	FROM SR 1155 TO EOP ( MP 0 - 0.90)	4	NO	NO	0.9	18										9,504
		9	SR 1135 (LITTLE PINE)	FROM SR 1128 TO EOP ( MP 6.70 - 8.65)	4	NO	NO	1.95	18										20,592
		10	SR 1409 (DOGWOOD)	FROM SR 1395 TO EOP (MP 0 - 0.30)	4	NO	NO	0.3	18				75						3,168
		11	SR 1526 (CHRISTMAS VALLEY)	FROM SR 1527 TO EOP ( MP 2.25 - 3.65)	4	NO	NO	1.4	18										14,784
		12	SR 1603 (MT. ZION)	FROM SR 1589 TO EOP ( MP 0 - 0.13)	4	NO	NO	0.13	18										1,373
		13	SR 1151 (BALTIMORE BR)	FROM NC 209 TO EOP ( MP 15-35 - 14.05)	4	NO	NO	1.3	18				340						13,728
		14	SR 1320 (BOBBY GOSNELL)	FROM SR 1319 TO EOP (MP 0 - 0.80)	4	NO	NO	0.8	18										8,448
<b>TOTAL FOR PROJ NO. 13CR.20571.11</b>								<b>13.76</b>		<b>336.50</b>	<b>9.16</b>	<b>179</b>	<b>415</b>		<b>6,363</b>	<b>426</b>	<b>4,450</b>	<b>74,237</b>	
<b>GRAND TOTAL</b>								<b>17.31</b>		<b>514.00</b>	<b>9.16</b>	<b>179</b>	<b>415</b>	<b>9,232</b>	<b>6,363</b>	<b>980</b>	<b>5,323</b>	<b>74,237</b>	<b>28,934</b>



PROJECT NO.	SHEET NO.	TOTAL NO.
13CR.10571.10, 13CR.20571.11	9	

## THERMOPLASTIC AND PAINT QUANTITIES

PROJECT NO	COUNTY	MAP NO	ROUTE	DESCRIPTION	LENGTH	WIDTH	4685000000-E		4686000000-E		4695000000-E	4725000000-E		4810000000-E		4905000000-N
							4" X 90 M WHITE THERMO LF	4" X 90 M YELLOW THERMO LF	4" X 120 M WHITE THERMO LF	4" X 120 M YELLOW THERMO LF	8" X 90 M YELLOW THERMO LF	THERMOPLASTIC PAVEMENT MARKING SYMBOL (90 MILS, LT ARROW) EA	THERMOPLASTIC PAVEMENT MARKING SYMBOL (90 MILS, MERGE ARROW) EA	PAINT PAVEMENT MARKING LINES (4") WHITE LF	PAINT PAVEMENT MARKING LINES (4") YELLOW LF	SNOWPLOWABLE PAVEMENT MARKERS EA
13CR.10571.10	Madison	1	US 25/70	FROM 0.15 MILES SOUTH OF SR 1582 (LONG BR.) TO NC 251 (MP 1.94 - 3.31) AND SOUTHBOUND (MP 24.93 - 23.57)	1.37	80	14,467	14,467	3,617		200	6				181
		2	US 25/70 BUS	FROM NC 251 (MP 1.30) TO US 25/70 (MP 0.00)	1.3	22	13,728			13,728						172
		3	US 25/70	FROM SR 1602 (FORE RD. -- MP 4.19) TO NC 251 (MP 3.31)	0.88	36 - 84	9,293		436	11,616		10	9			116
<b>TOTAL FOR PROJ NO. 13CR.10571.10</b>					<b>3.55</b>		<b>37,488</b>	<b>14,467</b>	<b>4,053</b>	<b>25,344</b>	<b>200</b>	<b>16</b>	<b>9</b>			<b>469</b>
							<b>51,955</b>		<b>29,397</b>		<b>25</b>					
13CR.20571.11	Madison	4	SR 1145 (SHARP HOLLOW)	FROM US 25/70 (MP 1.13) TO SR 1151 (BIG PINE RD. -- MP 0.00)	1.13	20								23,866	23,866	
		5	SR 1175 (MEADOW FORK RD.)	FROM SR 1181 (LITTLE CR -- MP 5.38) TO NC 209 (MP 10.69)	5.31	17								112,147	112,147	
		6	SR 1114 (BEAR CR)	FROM SR 1116 (RECTOR CORNER -- MP 0.30) TO BRIDGE (MP 0.01)	0.29	20								6,125	6,125	
		7	SR 1625 (IVY TRAILS)	FROM SR 1588 TO EOP ( MP 0 - 0.25)	0.25	18										
		8	SR 1131 (JOE PAYNE RD.)	FROM SR 1155 TO EOP ( MP 0 - 0.90)	0.9	18										
		9	SR 1135 (LITTLE PINE)	FROM SR 1128 TO EOP ( MP 6.70 - 8.65)	1.95	18										
		10	SR 1409 (DOGWOOD)	FROM SR 1395 TO EOP (MP 0 - 0.30)	0.3	18										
		11	SR 1526 (CHRISTMAS VALLEY)	FROM SR 1527 TO EOP ( MP 2.25 - 3.65)	1.4	18										
		12	SR 1603 (MT. ZION)	FROM SR 1589 TO EOP ( MP 0 - 0.13)	0.13	18										
		13	SR 1151 (BALTIMORE BR)	FROM NC 209 TO EOP ( MP 15-35 - 14.05)	1.3	18										
		14	SR 1320 (BOBBY GOSNELL)	FROM SR 1319 TO EOP (MP 0 - 0.80)	0.8	18										
<b>TOTAL FOR PROJ NO. 13CR.20571.11</b>					<b>13.76</b>									<b>142,138</b>	<b>142,138</b>	
												<b>284,276</b>				
<b>GRAND TOTAL</b>					<b>17.31</b>		<b>37,488</b>	<b>14,467</b>	<b>4,053</b>	<b>25,344</b>	<b>200</b>	<b>16</b>	<b>9</b>	<b>142,138</b>	<b>142,138</b>	<b>469</b>
							<b>51,955</b>		<b>29,397</b>		<b>25</b>	<b>284,276</b>				