

STATE OF NORTH CAROLINA
DIVISION OF HIGHWAYS

TRANSPORTATION MANAGEMENT PLAN

ORANGE COUNTY

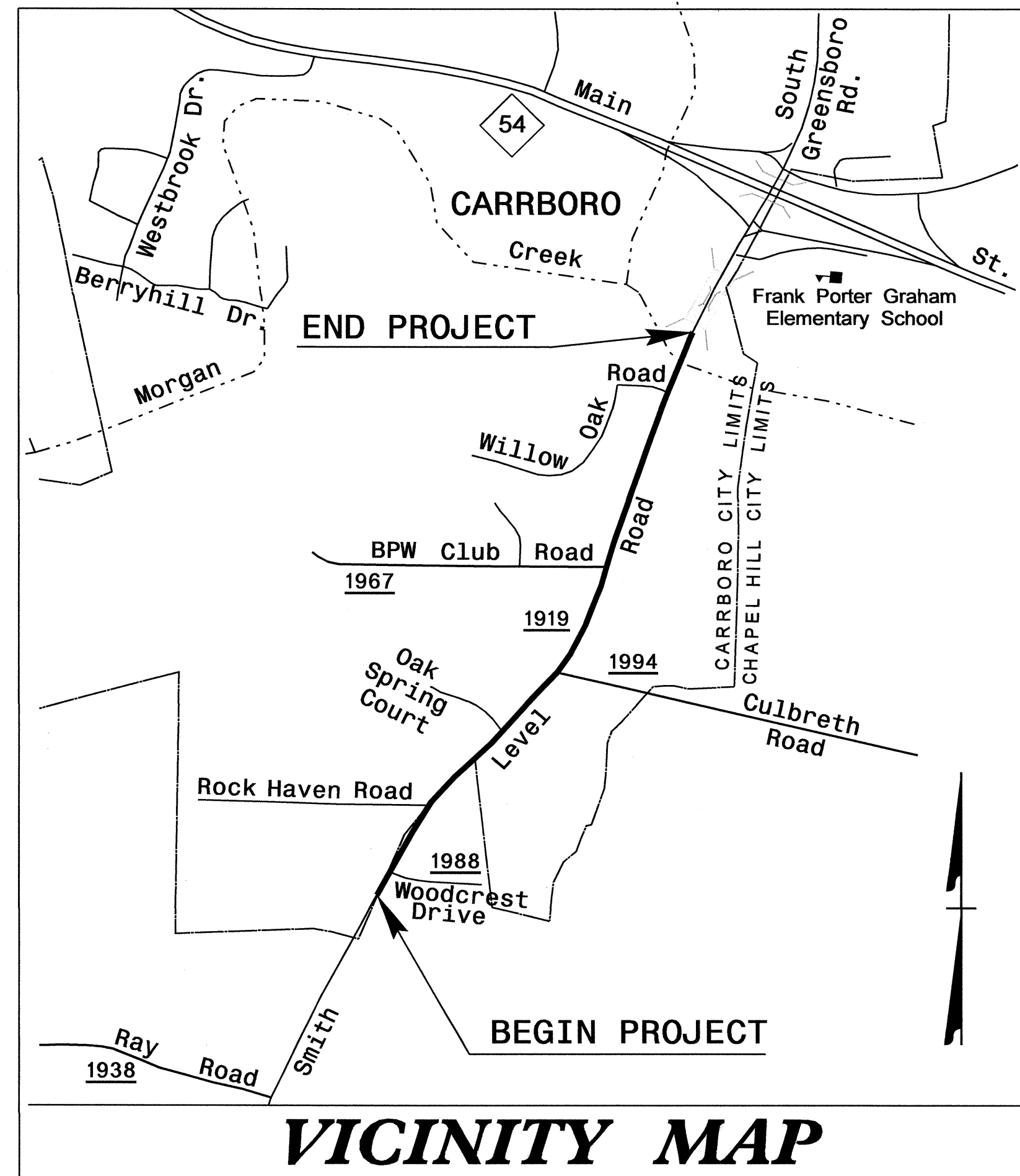
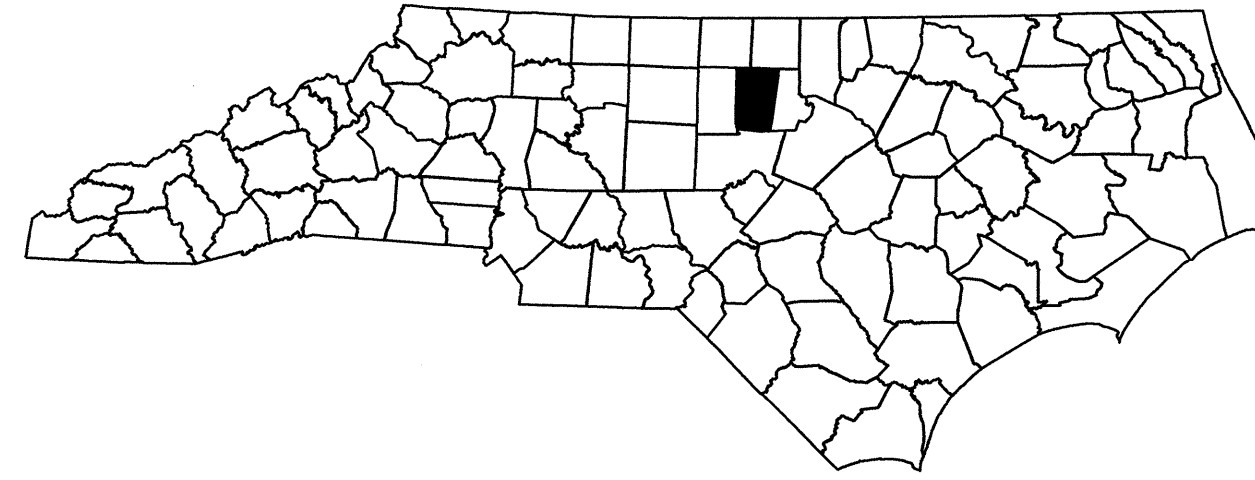

VICINITY MAP

INDEX OF SHEETS

SHEET NO.	TITLE
TMP-1	TITLE SHEET, AND INDEX OF SHEETS
TMP-1A	LIST OF APPLICABLE ROADWAY STANDARD DRAWINGS, LEGEND, AND TEMPORARY PAVEMENT MARKING
TMP-1B	TRANSPORTATION OPERATIONS PLAN: (GENERAL NOTES AND LOCAL NOTES)
TMP-2	TEMPORARY TRAFFIC CONTROL PHASING
TMP-3 THRU 5	PHASE I DETAIL
TMP-5A	TEMPORARY TRAFFIC CONTROL DETAIL FOR FULL DEPTH PAVEMENT REPLACEMENT -L- STA. 53+40 TO 53+90
TMP-6 THRU 8	PHASE II DETAIL
TMP-9 THRU 11	PHASE III DETAIL
SD -1	SPECIAL SIGN DESIGN

SHEET NO.
TMP-1

U-2803

TIP PROJECT:

04-SEP-2012 12:46 \\joe\projects\U2803\TrafficControl\top\U-2803.TC.TMP.Ldgn

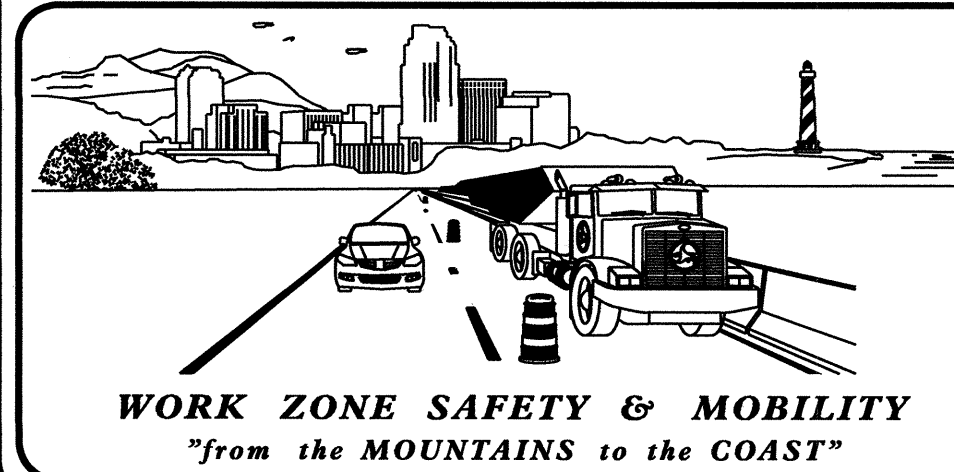

N.C.D.O.T. WORK ZONE TRAFFIC CONTROL
1561 MAIL SERVICE CENTER (MSC) RALEIGH, NC 27699-1561
750 N. GREENFIELD PARKWAY, GARNER, NC 27529 (DELIVERY)
PHONE: (919) 773-2800 FAX: (919) 771-2745

J. S. BOURNE, P.E. STATE TRAFFIC MANAGEMENT ENGINEER
STEVE KITE, P.E. TRAFFIC CONTROL PROJECT ENGINEER
DON PARKER TRAFFIC CONTROL PROJECT DESIGN ENGINEER
ASHVIN PATEL, P.E. TRAFFIC CONTROL DESIGN ENGINEER

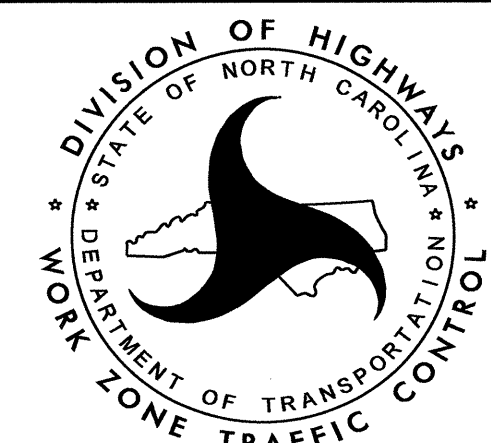

APPROVED: *[Signature]*
DATE: *September 4, 2012*

SEAL

ROADWAY STANDARD DRAWINGS

THE FOLLOWING ROADWAY STANDARDS AS SHOWN IN "ROADWAY STANDARD DRAWINGS" - PROJECT SERVICES UNIT - N.C. DEPARTMENT OF TRANSPORTATION - RALEIGH, N.C., DATED JANUARY 2012 ARE APPLICABLE TO THIS PROJECT AND BY REFERENCE HEREBY ARE CONSIDERED A PART OF THESE PLANS:

STD. NO.	TITLE
1101.01	WORK ZONE WARNING SIGNS
1101.02	TEMPORARY LANE CLOSURES
1101.03	TEMPORARY ROAD CLOSURES
1101.11	TRAFFIC CONTROL DESIGN TABLES
1110.01	STATIONARY WORK ZONE SIGNS
1110.02	PORTABLE WORK ZONE SIGNS
1115.01	FLASHING ARROW BOARDS
1130.01	DRUMS
1135.01	CONES
1145.01	BARRICADES
1150.01	FLAGGING DEVICES
1180.01	SKINNY - DRUM
1205.01	PAVEMENT MARKINGS - LINE TYPES AND OFFSETS
1205.02	PAVEMENT MARKINGS - TWO LANE AND MULTILANE ROADWAYS
1205.04	PAVEMENT MARKINGS - INTERSECTIONS
1205.05	PAVEMENT MARKINGS - TURN LANES
1205.06	PAVEMENT MARKINGS - LANE DROPS
1205.07	PAVEMENT MARKINGS - PEDESTRIAN CROSSWALKS
1205.08	PAVEMENT MARKINGS - SYMBOLS AND WORD MESSAGES
1205.09	PAVEMENT MARKINGS - PAINTED ISLANDS
1205.10	PAVEMENT MARKINGS - SCHOOL AREAS
1205.13	PAVEMENT MARKINGS - LANE REDUCTIONS
1250.01	RAISED PAVEMENT MARKERS - INSTALLATION SPACING
1251.01	RAISED PAVEMENT MARKERS - (PERMANENT AND TEMPORARY)

LEGEND

GENERAL

- DIRECTION OF TRAFFIC FLOW
- DIRECTION OF PEDESTRIAN TRAFFIC FLOW
- EXIST. PVMT.
- NORTH ARROW
- PROPOSED PVMT.



WORK AREA

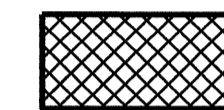

REMOVAL

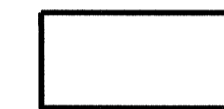

USER DEFINED (IF NEEDED)

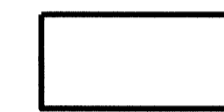

USER DEFINED (IF NEEDED)

TRAFFIC CONTROL DEVICES

- BARRICADE (TYPE III)
- CONE
- DRUM SKINNY DRUM TUBULAR MARKER
- TEMPORARY CRASH CUSHION
- FLASHING ARROW BOARD
- FLAGGER
- LAW ENFORCEMENT
- TRUCK MOUNTED ATTENUATOR (TMA)
- CHANGEABLE MESSAGE SIGN

TEMPORARY SIGNING

- PORTABLE SIGN
- STATIONARY SIGN
- STATIONARY OR PORTABLE SIGN

SIGNALS

- EXISTING
- PROPOSED
- TEMPORARY

PAVEMENT MARKINGS

- EXISTING LINES
- TEMPORARY LINES

PAVEMENT MARKERS

- CRYSTAL / CRYSTAL
- CRYSTAL / RED
- YELLOW / YELLOW

PAVEMENT MARKING SYMBOLS

- PAVEMENT MARKING SYMBOLS

TEMPORARY PAVEMENT MARKING

SYMBOL DESCRIPTION

PAINT (4")

- PA WHITE EDGELINE
- PB YELLOW EDGELINE
- PC 10 FT. WHITE SKIP
- PD 2 FT. WHITE MINISKIP
- PE WHITE SOLID LANE LINE
- PI YELLOW DOUBLE CENTER
- PT SHARK TEETH SYMBOL

PAINT (8")

- PR WHITE GORELINE
- PS WHITE DIAGONAL
- PV YELLOW DIAGONAL
- PX WHITE CROSSWALK LINE

PAINT (12")

- P10 3 FT. - 3 FT. / SP WHITE MINISKIP 12"

PAINT (24")

- P4 WHITE STOPBAR

PAINT MARKING SYMBOLS

- QA LEFT TURN ARROW
- QB RIGHT TURN ARROW
- QC STRAIGHT ARROW
- QE STRAIGHT & RIGHT TURN ARROW
- QN 24" YIELD LINE

TEMPORARY RAISED PAVEMENT MARKERS

- MH YELLOW & YELLOW
- MI CRYSTAL & RED

04-SEP-2012 12:49
\\dot1.dfsr0010\NSPProj\TIPProjects-U\U2803\TrafficControl\Top\U-2803-TC-TMP-1.dgn
akpdtel AT 12:46:00

APPROVED: DATE: 9/4/12 		ROADWAY STANDARD DRAWINGS & LEGEND
-----------------------------	--	---

GENERAL NOTES / LOCAL NOTES

CHANGES MAY BE REQUIRED WHEN PHYSICAL DIMENSIONS IN THE DETAIL DRAWINGS, STANDARD DETAILS, AND ROADWAY DETAILS ARE NOT ATTAINABLE TO MEET FIELD CONDITIONS OR RESULT IN DUPLICATE OR UNDESIRABLE OVERLAPPING OF DEVICES. MODIFICATION MAY INCLUDE: MOVING, SUPPLEMENTING, COVERING, OR REMOVAL OF DEVICES AS DIRECTED BY THE ENGINEER.

THE FOLLOWING GENERAL NOTES APPLY AT ALL TIMES FOR THE DURATION OF THE CONSTRUCTION PROJECT EXCEPT WHEN OTHERWISE NOTED IN THE PLAN OR DIRECTED BY THE ENGINEER.

TIME RESTRICTIONS

A) DO NOT CLOSE OR NARROW TRAVEL LANES AS FOLLOWS:

ROAD NAME	DAY AND TIME RESTRICTIONS
SR 1919	MONDAY THRU FRIDAY 7:00 AM TO 9:00 AM

B) DO NOT CONDUCT ANY HAULING OPERATIONS AGAINST THE FLOW OF TRAFFIC OF AN OPEN TRAVELWAY UNLESS THE HAULING OPERATION IS PROTECTED BY BARRIER OR GUARDRAIL OR AS DIRECTED BY THE ENGINEER.

LANE AND SHOULDER CLOSURE REQUIREMENTS

C) REMOVE LANE CLOSURE DEVICES FROM THE LANE WHEN WORK IS NOT BEING PERFORMED BEHIND THE LANE CLOSURE OR WHEN A LANE CLOSURE IS NO LONGER NEEDED OR AS DIRECTED BY THE ENGINEER.

D) WHEN PERSONNEL AND/OR EQUIPMENT ARE WORKING ON THE SHOULDER ADJACENT TO AN UNDIVIDED FACILITY AND WITHIN 5 FT OF AN OPEN TRAVEL LANE, CLOSE THE NEAREST OPEN TRAVEL LANE USING ROADWAY STANDARD DRAWING NO. 1101.02 UNLESS THE WORK AREA IS PROTECTED BY BARRIER OR GUARDRAIL.

E) WHEN PERSONNEL AND/OR EQUIPMENT ARE WORKING WITHIN A LANE OF TRAVEL OF AN UNDIVIDED OR DIVIDED FACILITY, CLOSE THE LANE ACCORDING TO THE TRAFFIC CONTROL PLANS, ROADWAY STANDARD DRAWINGS, OR AS DIRECTED BY THE ENGINEER. CONDUCT THE WORK SO THAT ALL PERSONNEL AND/OR EQUIPMENT REMAIN WITHIN THE CLOSED TRAVEL LANE.

F) DO NOT WORK SIMULTANEOUSLY WITHIN 15 FT ON BOTH SIDES OF AN OPEN TRAVELWAY, RAMP, OR LOOP WITHIN THE SAME LOCATION UNLESS PROTECTED WITH GUARDRAIL OR BARRIER.

PAVEMENT EDGE DROP OFF REQUIREMENTS

G) BACKFILL AT A 6:1 SLOPE UP TO THE EDGE AND ELEVATION OF EXISTING PAVEMENT IN AREAS ADJACENT TO AN OPENED TRAVEL LANE THAT HAS AN EDGE OF PAVEMENT DROP-OFF AS FOLLOWS:

BACKFILL DROP-OFFS THAT EXCEED 3 INCHES ON ROADWAYS WITH POSTED SPEED LIMITS LESS THAN 45 MPH.

BACKFILL WITH SUITABLE COMPACTED MATERIAL, AS APPROVED BY THE ENGINEER, AT NO EXPENSE TO THE DEPARTMENT.

H) DO NOT EXCEED A DIFFERENCE OF 2 INCHES IN ELEVATION BETWEEN OPEN LANES OF TRAFFIC FOR NOMINAL LIFTS OF 1.5 INCHES. INSTALL ADVANCE WARNING "UNEVEN LANES" SIGNS (W8-11) 350 FT IN ADVANCE AND A MINIMUM OF EVERY HALF MILE THROUGHOUT THE UNEVEN AREA., DRAINAGE, ETC.).

TRAFFIC PATTERN ALTERATIONS

I) NOTIFY THE ENGINEER TWENTY ONE (21) CALENDAR DAYS PRIOR TO ANY TRAFFIC PATTERN ALTERATION.

SIGNING

J) INSTALL ADVANCE WORK ZONE WARNING SIGNS WHEN WORK IS WITHIN 40 FT FROM THE EDGE OF TRAVEL LANE AND NO MORE THAN THREE (3) DAYS PRIOR TO THE BEGINNING OF CONSTRUCTION.

K) ENSURE ALL NECESSARY SIGNING IS IN PLACE PRIOR TO ALTERING ANY TRAFFIC PATTERN.

L) INSTALL BLACK ON ORANGE "DIP" SIGNS (W8-2) AND/OR "BUMP" SIGNS (W8-1) IN ADVANCE OF THE UNEVEN AREA, OR AS DIRECTED BY THE ENGINEER.

TRAFFIC CONTROL DEVICES

M) WHEN LANE CLOSURES ARE NOT IN EFFECT SPACE CHANNELIZING DEVICES IN WORK AREAS NO GREATER IN FEET THAN TWICE THE POSTED SPEED LIMIT (MPH) EXCEPT, 10 FT ON-CENTER IN RADII, AND 3 FT OFF THE EDGE OF AN OPEN TRAVELWAY. REFER TO STANDARD SPECIFICATIONS FOR ROADS AND STRUCTURES SECTIONS 1130 (DRUMS), 1135 (CONES) AND 1180 (SKINNY DRUMS) FOR ADDITIONAL REQUIREMENTS.

N) INSTALL TEMPORARY PAVEMENT MARKINGS AND TEMPORARY PAVEMENT MARKERS ON INTERIM LAYERS OF PAVEMENT AS FOLLOWS:

ROAD NAME	MARKING	MARKER
ALL ROADS	PAINT	TEMP. RAISED

O) PLACE ONE APPLICATION OF PAINT FOR TEMPORARY TRAFFIC PATTERNS. PLACE A SECOND APPLICATION OF PAINT SIX (6) MONTHS AFTER THE INITIAL APPLICATION AND EVERY SIX MONTHS AS DIRECTED BY THE ENGINEER.

P) TIE PROPOSED PAVEMENT MARKING LINES TO EXISTING PAVEMENT MARKING LINES.

Q) REMOVE/REPLACE ANY CONFLICTING/DAMAGED PAVEMENT MARKINGS AND MARKERS BY THE END OF EACH DAY'S OPERATION.

R) TRACE THE PROPOSED MONOLITHIC ISLAND LOCATIONS WITH PROPER COLOR PAVEMENT MARKINGS PRIOR TO INSTALLATION. PLACE DRUMS/SKINNY DRUMS TO DELINEATE ANY PROPOSED MONOLITHIC ISLANDS BEFORE INSTALLATION

MISCELLANEOUS

S) LAW ENFORCEMENT MAY BE USED TO MAINTAIN TRAFFIC THROUGH THE WORK AREA AND/OR INTERSECTIONS AS DIRECTED BY THE ENGINEER.

04-SEP-2012 12:21
\\dot\dfs\02101\NSProj\TIPProjects-U\U2803\TrafficControl\Top\U-2803-TC-TMP-1B.dgn
akp@tel AT 1E266003

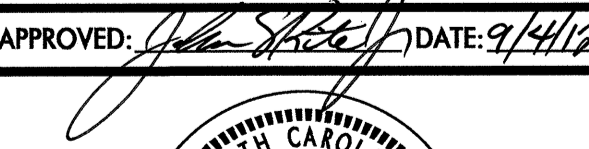
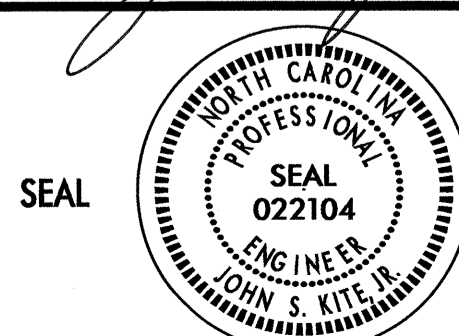
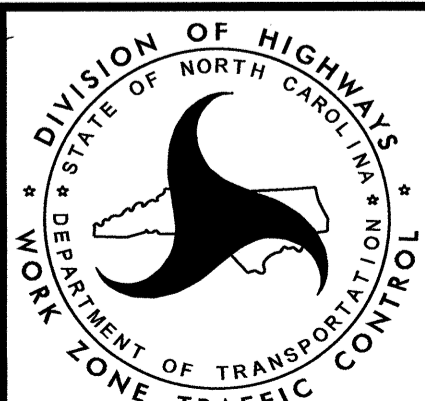
APPROVED:  DATE: 9/4/12 		<h1 style="margin: 0;">TRANSPORTATION OPERATIONS PLAN</h1>
---	---	--

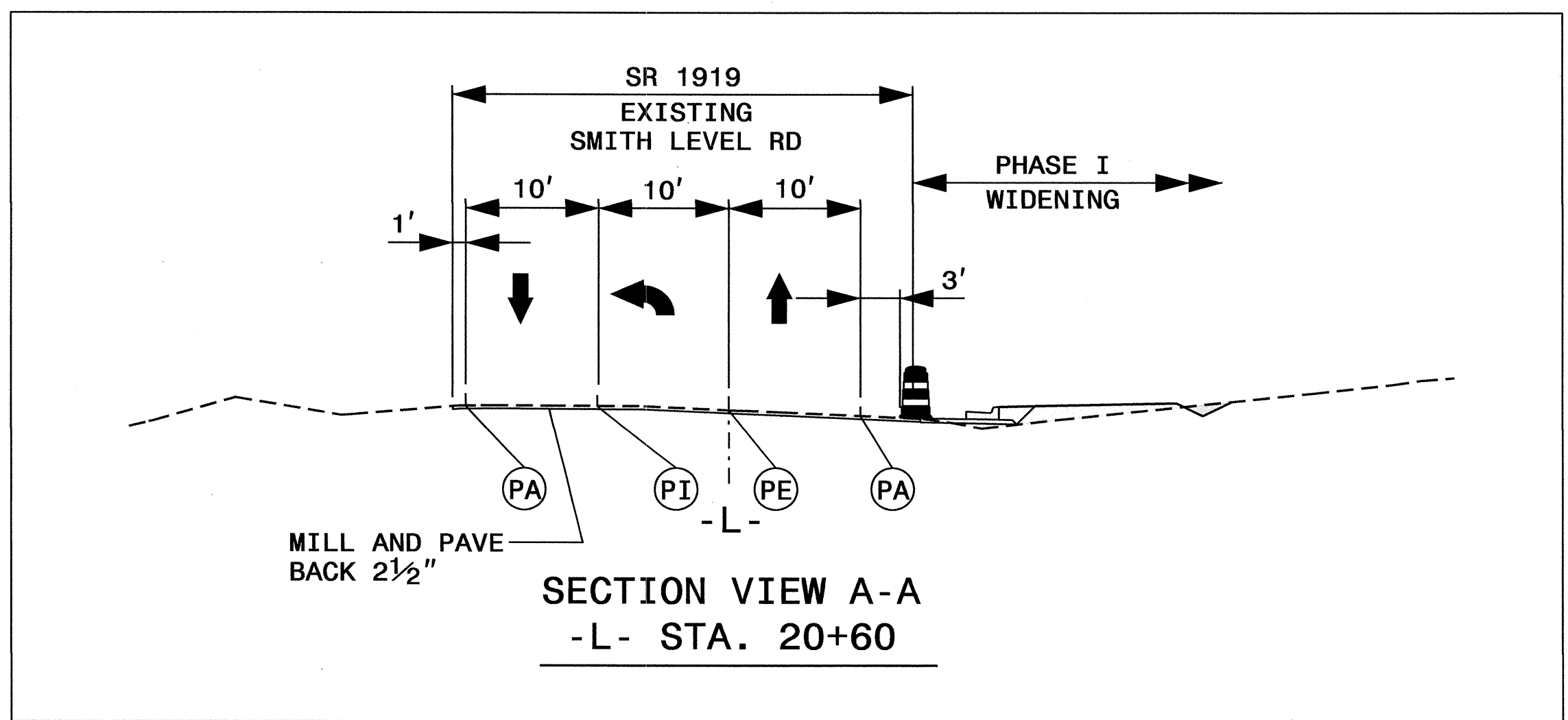
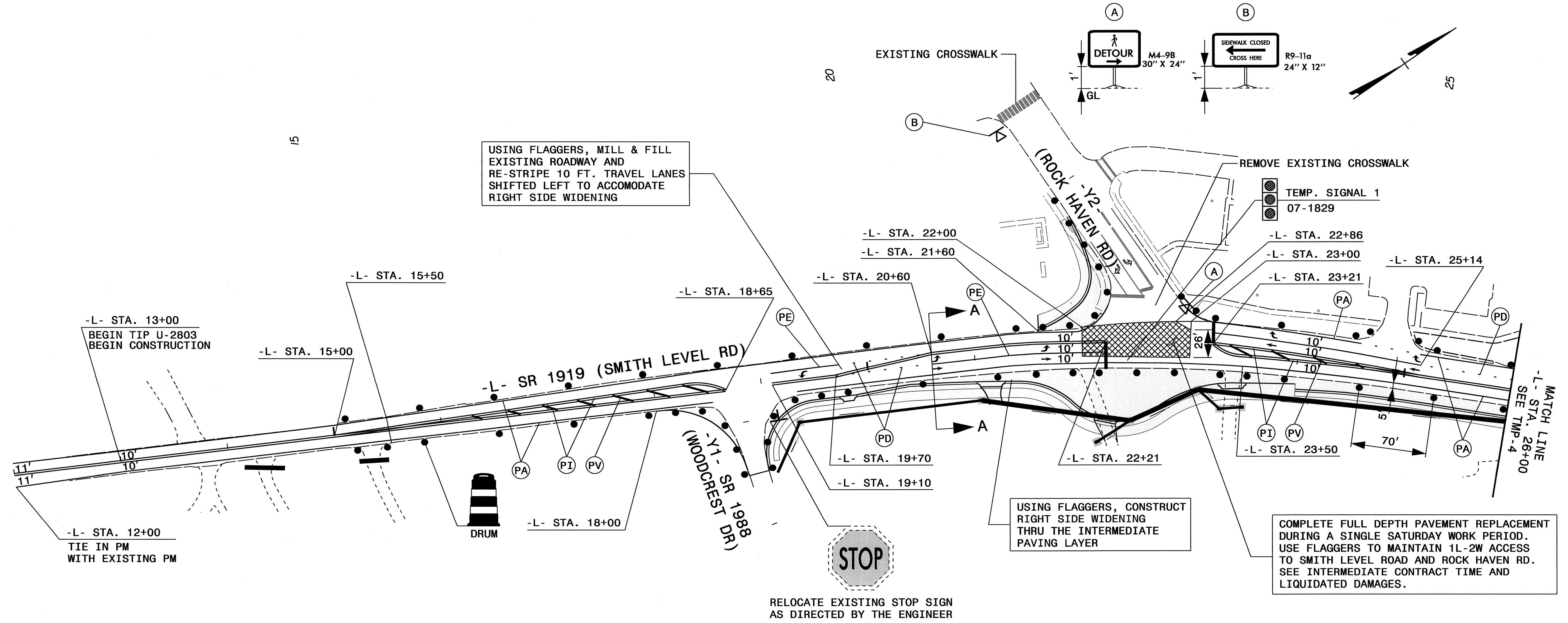

NOTE: INSTALL TEMPORARY RAISED PAVEMENT MARKERS AS PER RSD 1250.01 & 1251.01.
ALL STATIONS AND DIMENSIONS SHOWN ARE +/-

APPROVED: <i>[Signature]</i> DATE: 9/14/12 		<h1>PHASE I</h1>
--	--	------------------

04-SEP-2012 12:22
 \\dot\dfsroot\NSProj\TIPProjects-U\U2803\TrafficControl\top\U-2803-TC-TMP-3.dgn
 akpdtel AT 1E266003

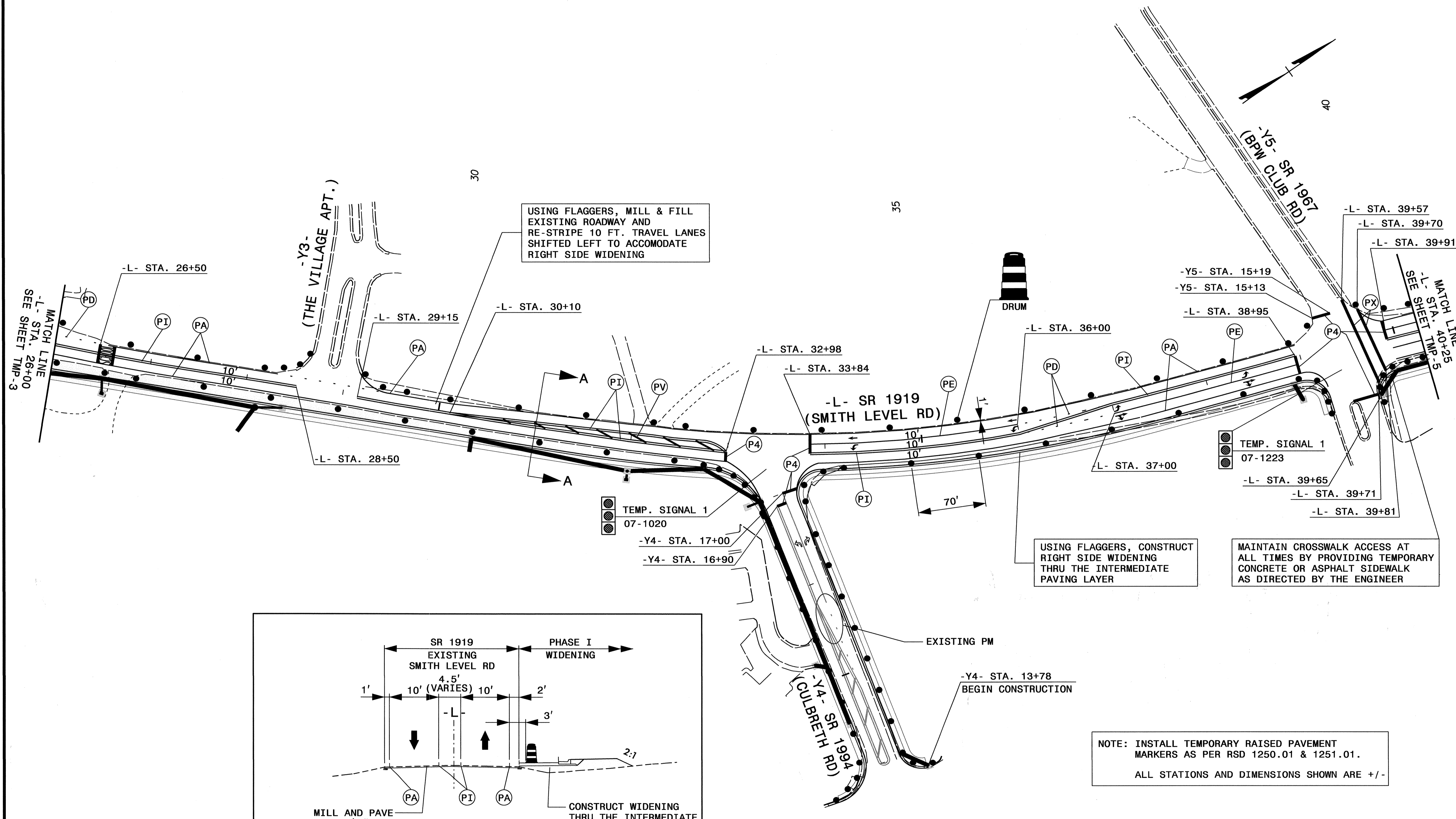

USING FLAGGERS, MILL & FILL EXISTING ROADWAY AND RE-STRIPE 10 FT. TRAVEL LANES SHIFTED LEFT TO ACCOMODATE RIGHT SIDE WIDENING

USING FLAGGERS, CONSTRUCT RIGHT SIDE WIDENING THRU THE INTERMEDIATE PAVING LAYER

MAINTAIN CROSSWALK ACCESS AT ALL TIMES BY PROVIDING TEMPORARY CONCRETE OR ASPHALT SIDEWALK AS DIRECTED BY THE ENGINEER

TEMP. SIGNAL 1
07-1020

TEMP. SIGNAL 1
07-1223

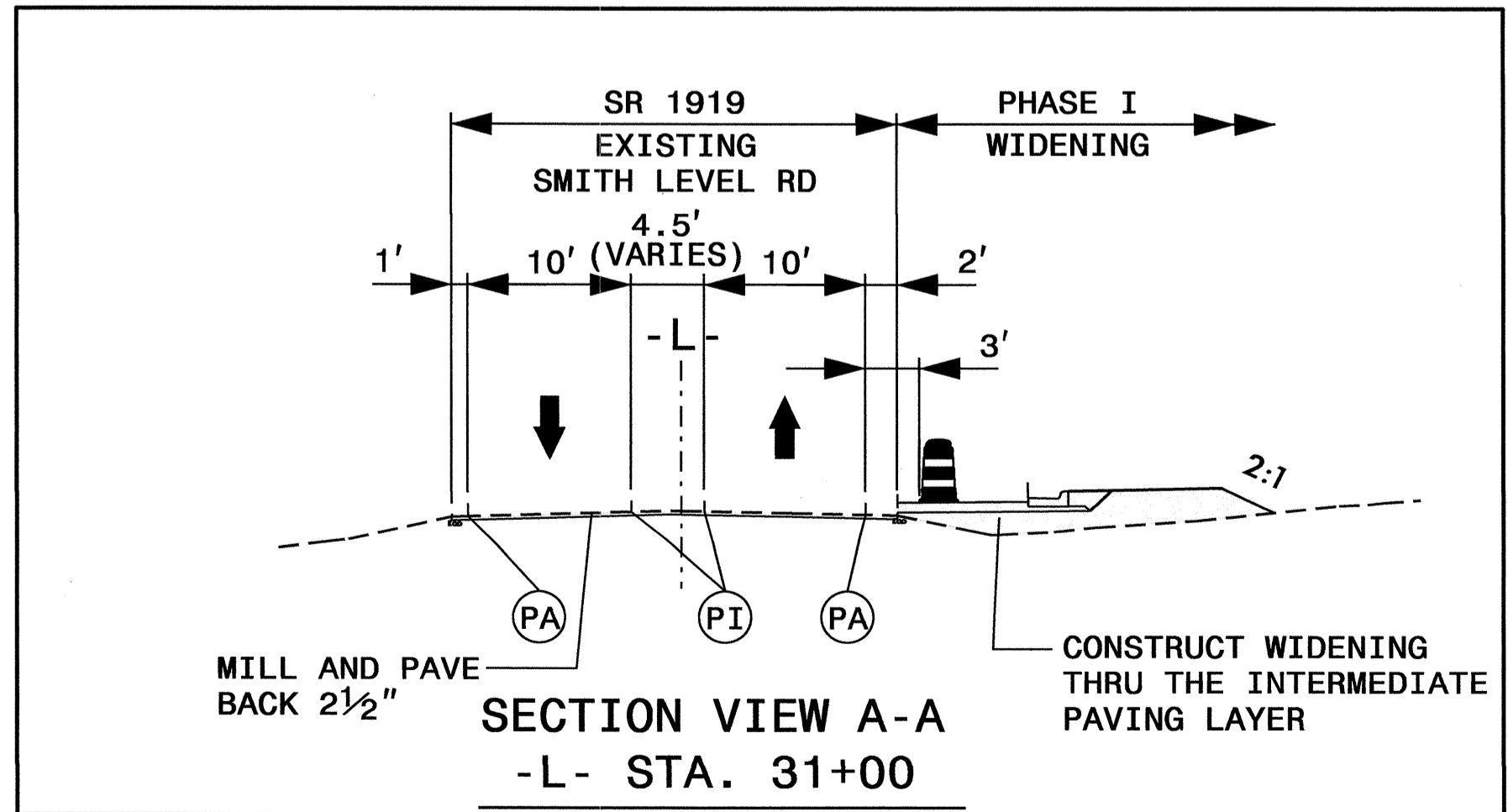

NOTE: INSTALL TEMPORARY RAISED PAVEMENT MARKERS AS PER RSD 1250.01 & 1251.01.
ALL STATIONS AND DIMENSIONS SHOWN ARE +/-

04-SEP-2012 12:23 \\dot\dfs\ofo\NSPProj\TIPProjects-U\U2803\TrafficControl\top\U-2803-TC-TMP-4.dgn akp\del AT TE266003

APPROVED: *John S. Kite* DATE: 9/11/12

SEAL
NORTH CAROLINA PROFESSIONAL ENGINEER
SEAL 022104
JOHN S. KITE, INC.

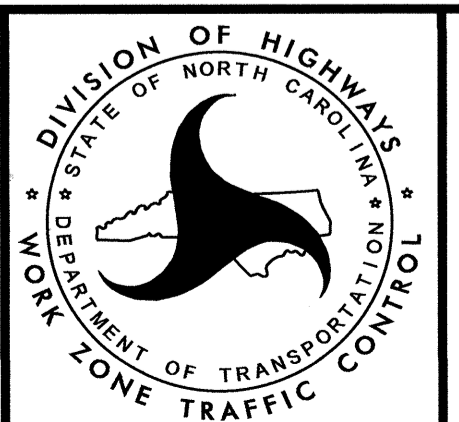

PHASE I

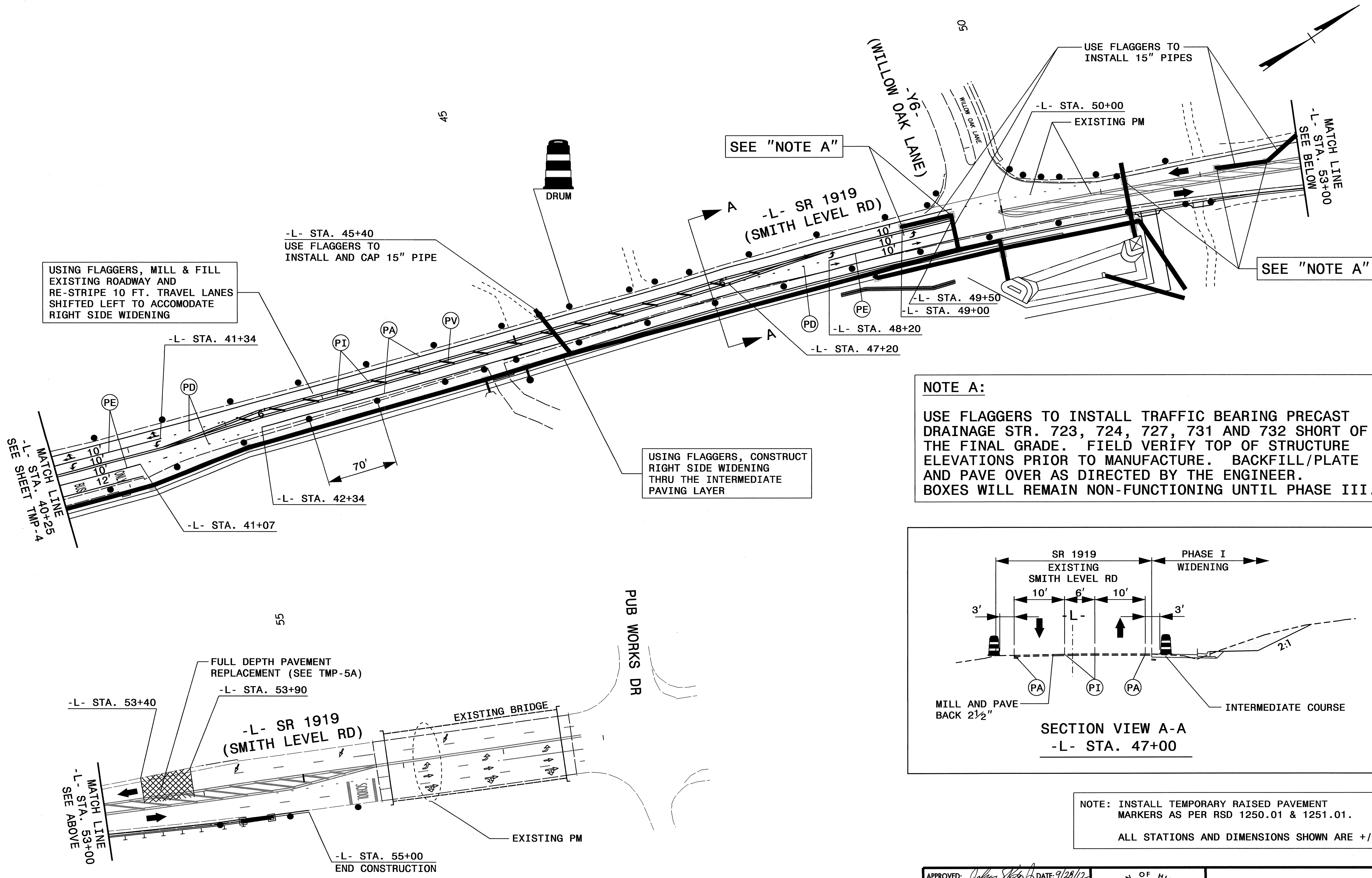

NOTE A:
 USE FLAGGERS TO INSTALL TRAFFIC BEARING PRECAST DRAINAGE STR. 723, 724, 727, 731 AND 732 SHORT OF THE FINAL GRADE. FIELD VERIFY TOP OF STRUCTURE ELEVATIONS PRIOR TO MANUFACTURE. BACKFILL/PLATE AND PAVE OVER AS DIRECTED BY THE ENGINEER. BOXES WILL REMAIN NON-FUNCTIONING UNTIL PHASE III.

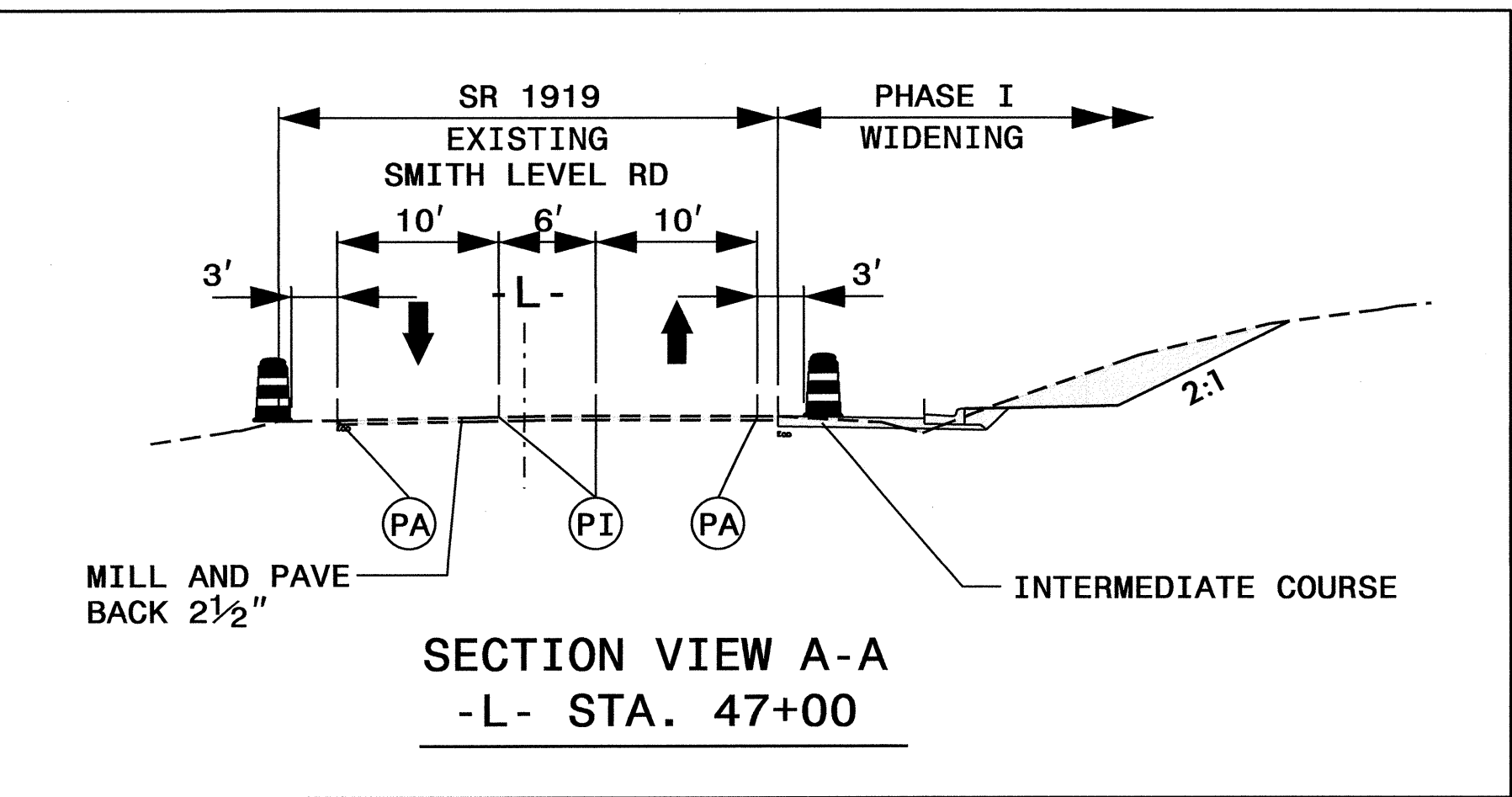

NOTE: INSTALL TEMPORARY RAISED PAVEMENT MARKERS AS PER RSD 1250.01 & 1251.01.
 ALL STATIONS AND DIMENSIONS SHOWN ARE +/-

26-SEP-2012 13:28
 \\dot\dfg\of\NSP\Proj\TIP\Projects\U2803\TrafficControl\top\U-2803_TC_TMP-5.dgn
 akp\at AT TE266003

APPROVED: *John S. Kite* DATE: 9/28/12

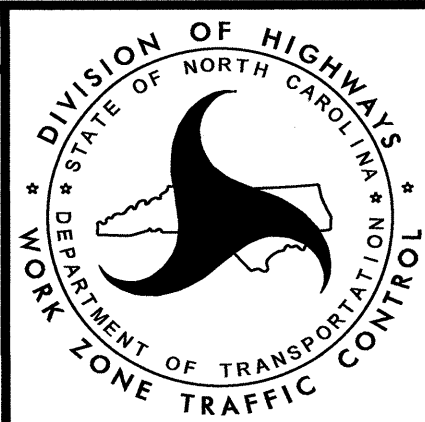
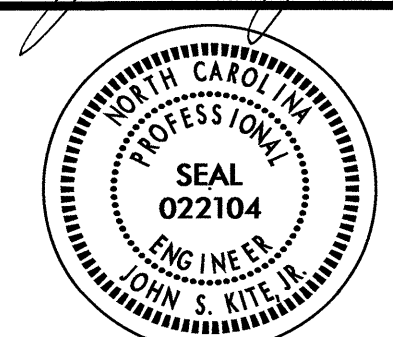

PHASE I

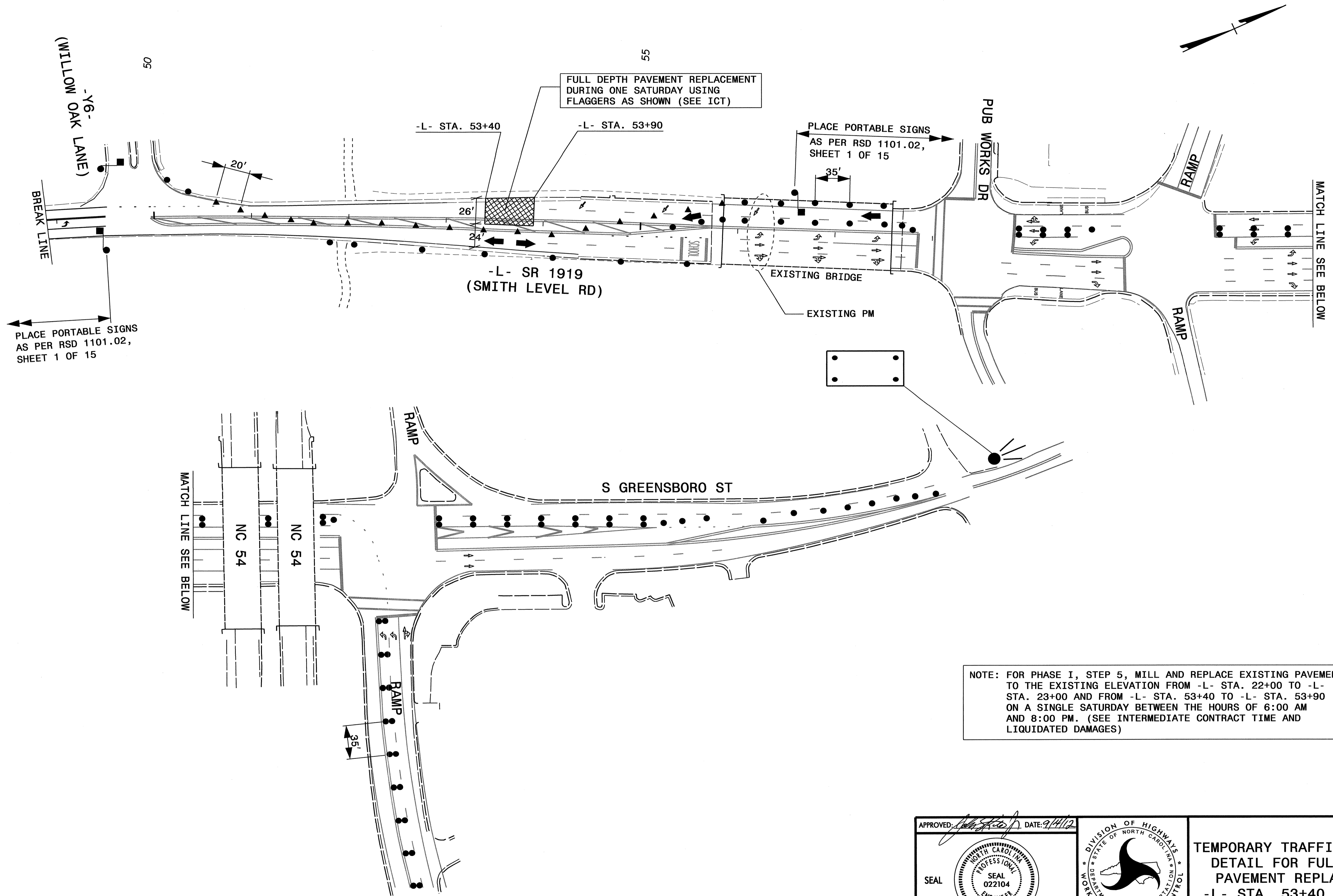

PLACE PORTABLE SIGNS
AS PER RSD 1101.02,
SHEET 1 OF 15

FULL DEPTH PAVEMENT REPLACEMENT
DURING ONE SATURDAY USING
FLAGGERS AS SHOWN (SEE ICT)

PLACE PORTABLE SIGNS
AS PER RSD 1101.02,
SHEET 1 OF 15

NOTE: FOR PHASE I, STEP 5, MILL AND REPLACE EXISTING PAVEMENT TO THE EXISTING ELEVATION FROM -L- STA. 22+00 TO -L- STA. 23+00 AND FROM -L- STA. 53+40 TO -L- STA. 53+90 ON A SINGLE SATURDAY BETWEEN THE HOURS OF 6:00 AM AND 8:00 PM. (SEE INTERMEDIATE CONTRACT TIME AND LIQUIDATED DAMAGES)

04-SEP-2012 12:22
 \\dot\dfs001\NSPProj\TIPProjects-U\U2803\TrafficControl\U-2803-TC-TMP-5A.dgn
 akd\AT 12266003

APPROVED: *[Signature]* DATE: 9/4/12

SEAL

**TEMPORARY TRAFFIC CONTROL
 DETAIL FOR FULL DEPTH
 PAVEMENT REPLACEMENT
 -L- STA. 53+40 TO 53+90**

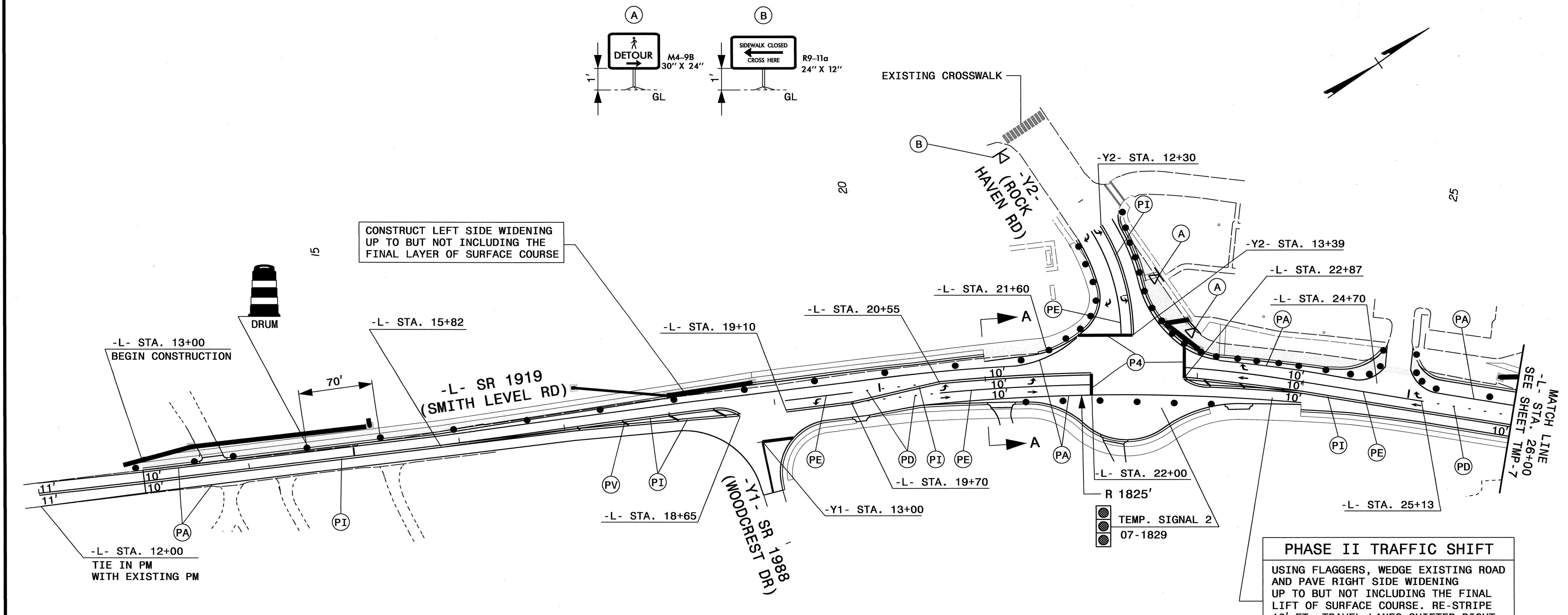
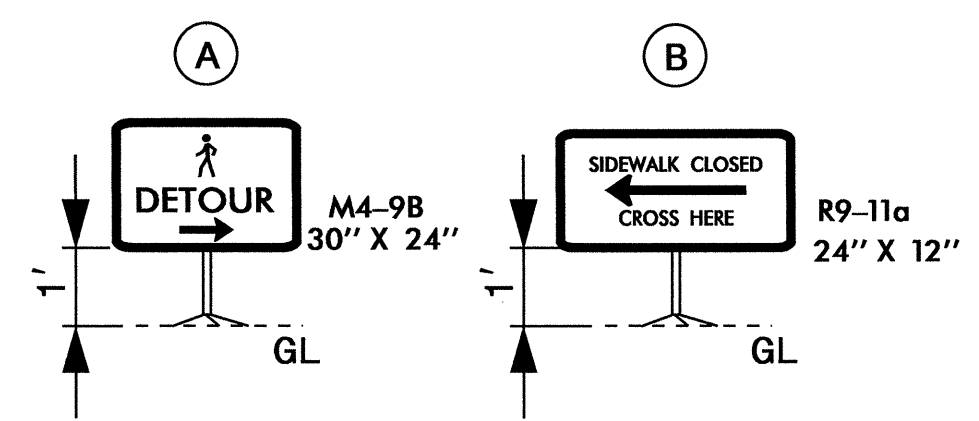

CONSTRUCT LEFT SIDE WIDENING UP TO BUT NOT INCLUDING THE FINAL LAYER OF SURFACE COURSE

PHASE II TRAFFIC SHIFT
 USING FLAGGERS, WEDGE EXISTING ROAD AND PAVE RIGHT SIDE WIDENING UP TO BUT NOT INCLUDING THE FINAL LIFT OF SURFACE COURSE. RE-STRIPE 10' FT. TRAVEL LANES SHIFTED RIGHT.

NOTE: INSTALL TEMPORARY RAISED PAVEMENT MARKERS AS PER RSD 1250.01 & 1251.01.
 ALL STATIONS AND DIMENSIONS SHOWN ARE +/-

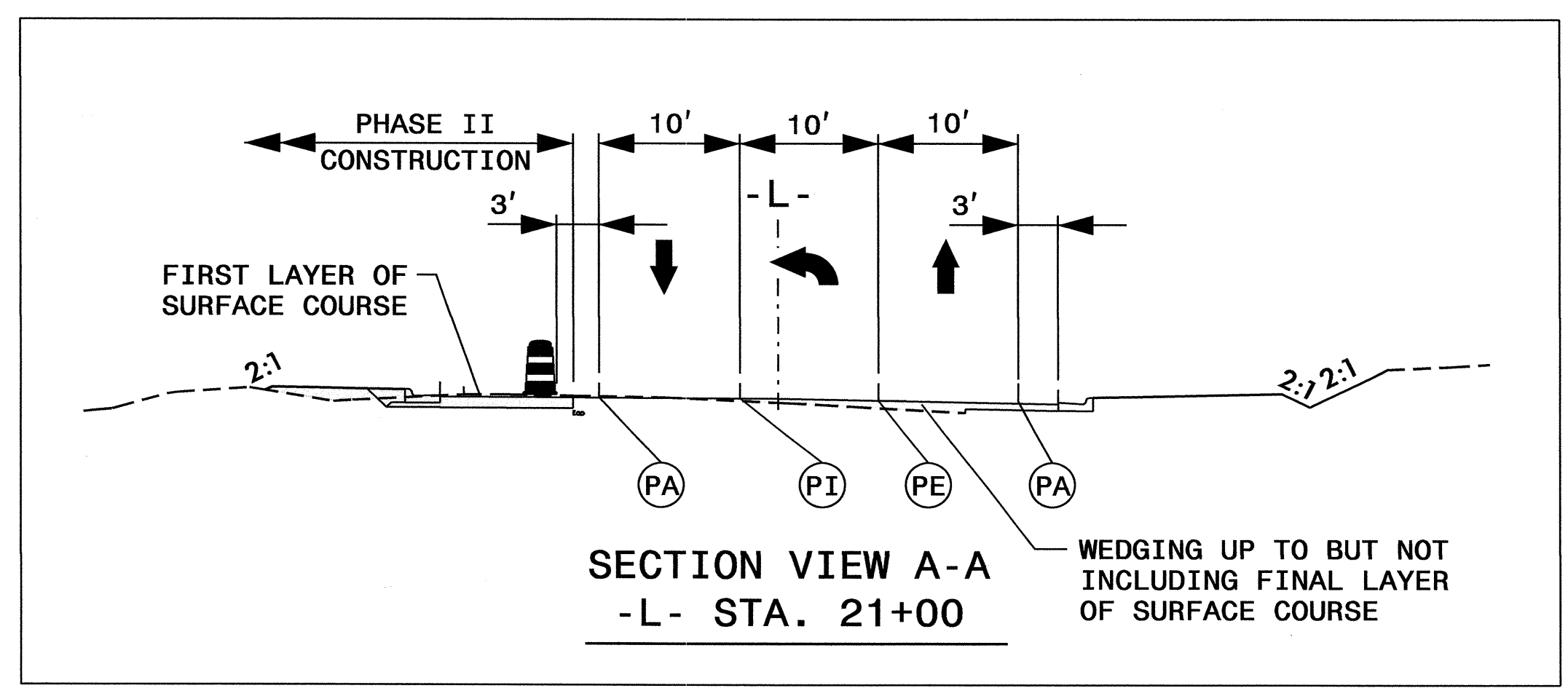

SECTION VIEW A-A
 -L- STA. 21+00
 WEDGING UP TO BUT NOT INCLUDING FINAL LAYER OF SURFACE COURSE

04-SEP-2012 12:23
 \\dot\df\proj\01\NSP\proj\TIP\Projects-U\U2803\Traffic\TrafficControl\top\U-2803-TC-TMP-6.dgn
 akpafel AT TE266003

APPROVED: <i>[Signature]</i> DATE: 7/4/12 SEAL 		<p style="text-align: center; font-size: 24pt; font-weight: bold;">PHASE II</p>
---	--	---

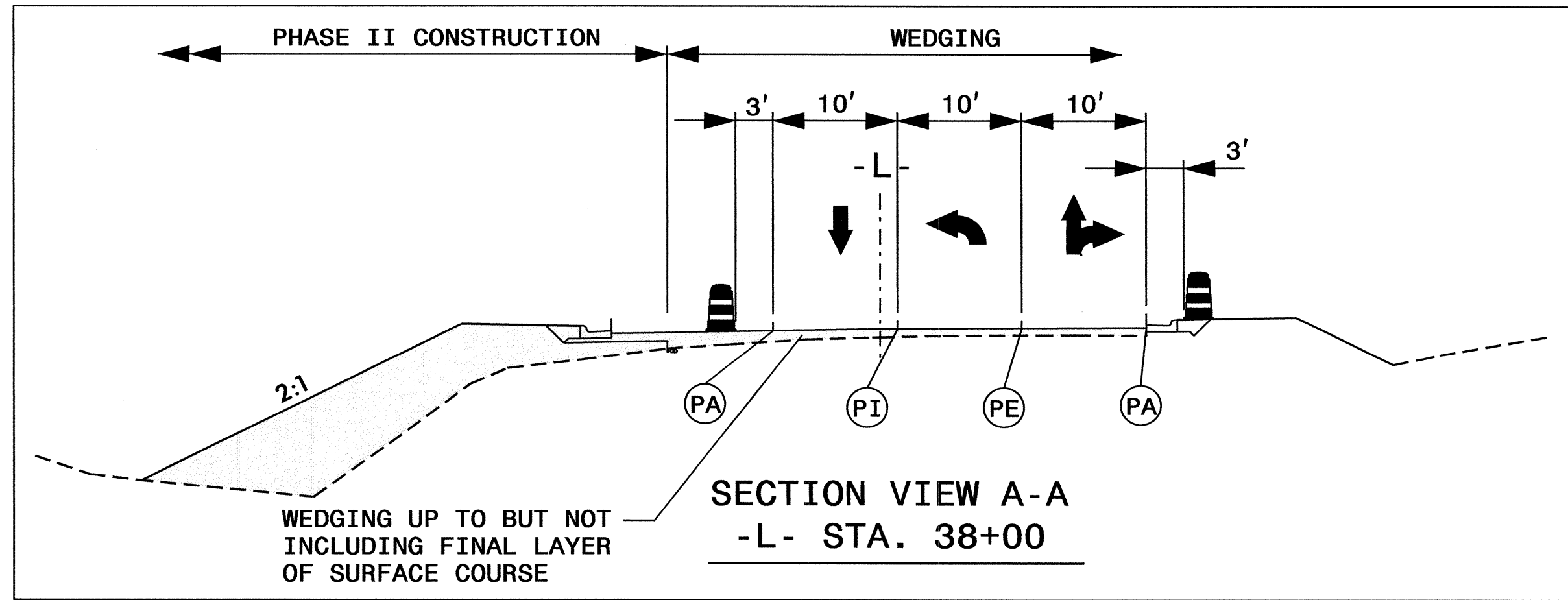
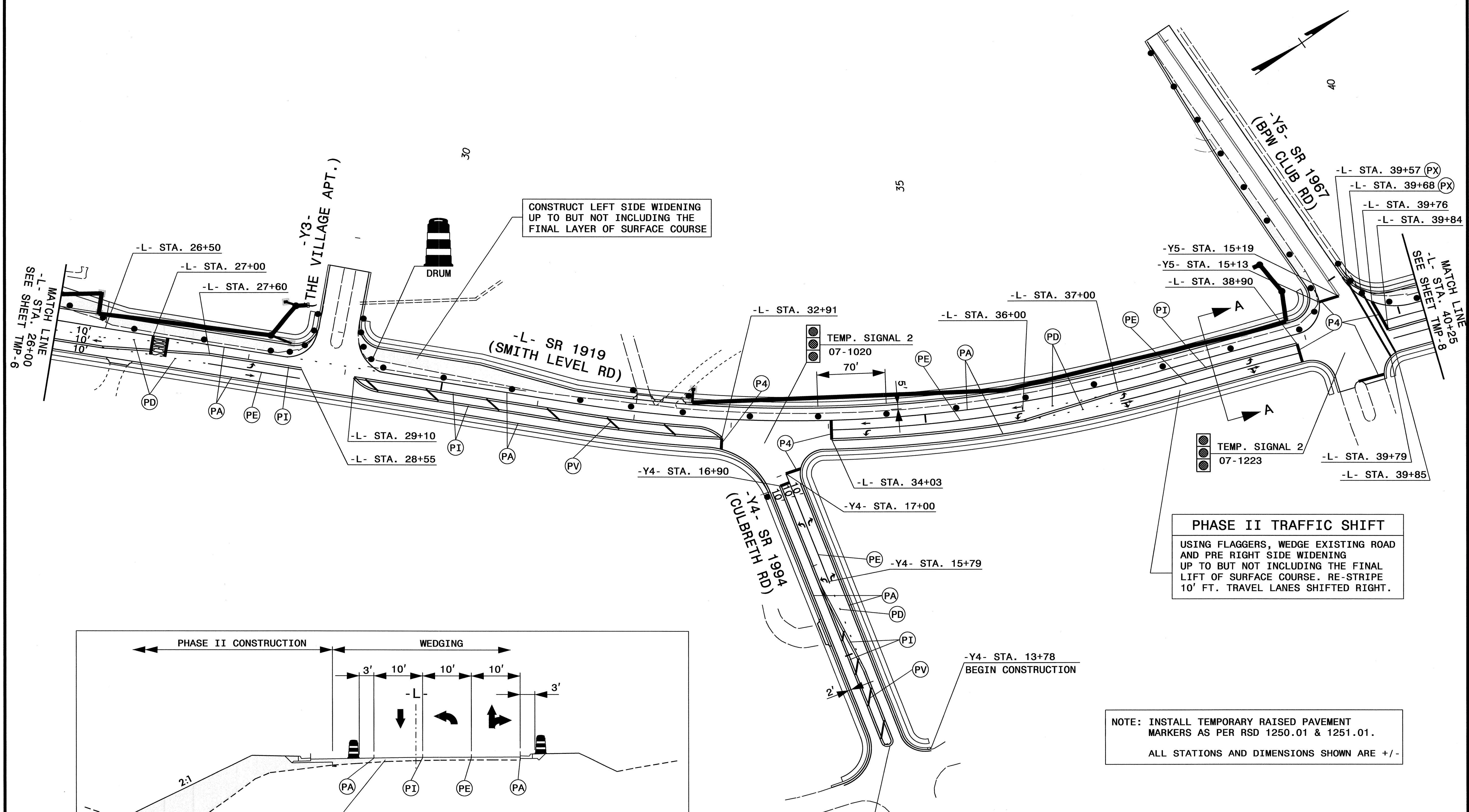

PHASE II TRAFFIC SHIFT
 USING FLAGGERS, WEDGE EXISTING ROAD AND PRE RIGHT SIDE WIDENING UP TO BUT NOT INCLUDING THE FINAL LIFT OF SURFACE COURSE. RE-STRIPE 10' FT. TRAVEL LANES SHIFTED RIGHT.

NOTE: INSTALL TEMPORARY RAISED PAVEMENT MARKERS AS PER RSD 1250.01 & 1251.01.
 ALL STATIONS AND DIMENSIONS SHOWN ARE +/-

APPROVED: *[Signature]* DATE: 9/11/12

SEAL

PROFESSIONAL ENGINEER
 JOHN S. KITE
 SEAL 022104

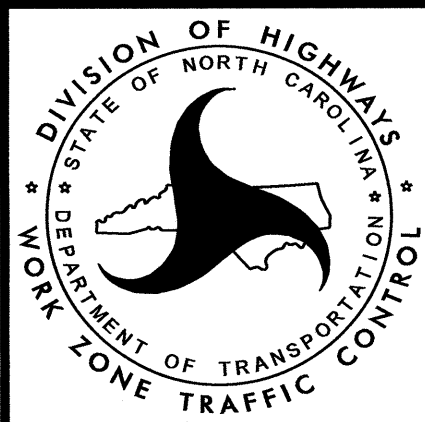

PHASE II

04-SEP-2012 12:47
 \\dot\dfs\proj\01\NSP\Proj\TIP\Projects-U\U2803\Traffic\TrafficControl\top\U-2803-TC-TMP-7.dgn
 akpatel AT TE266003

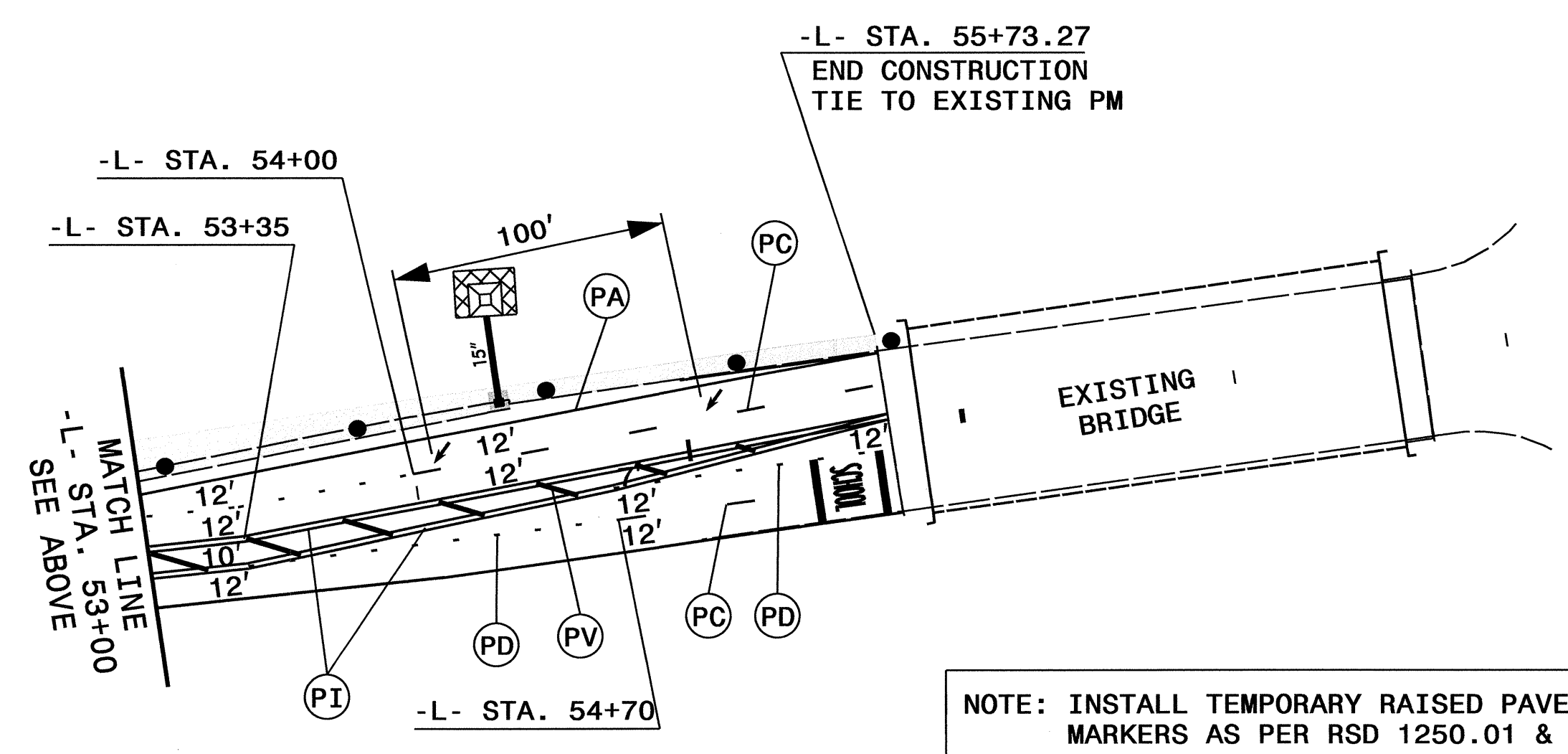
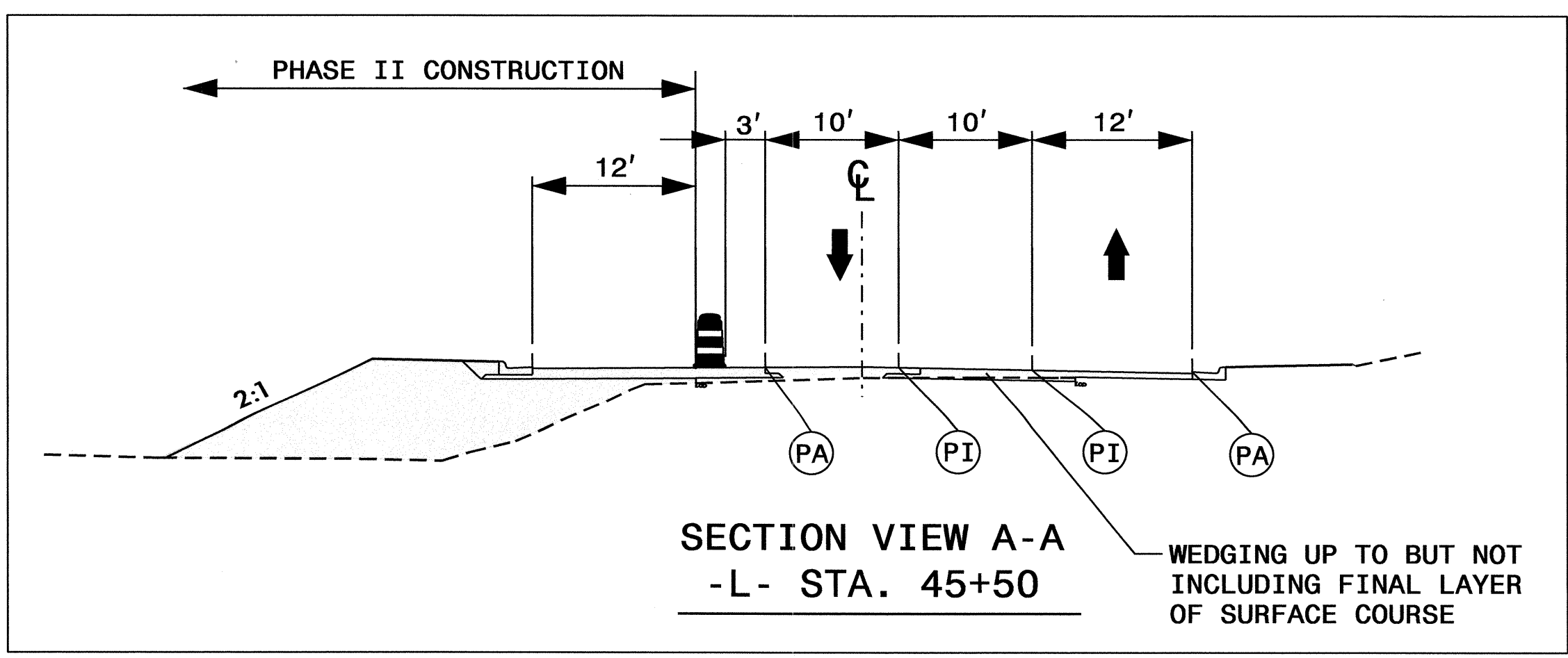
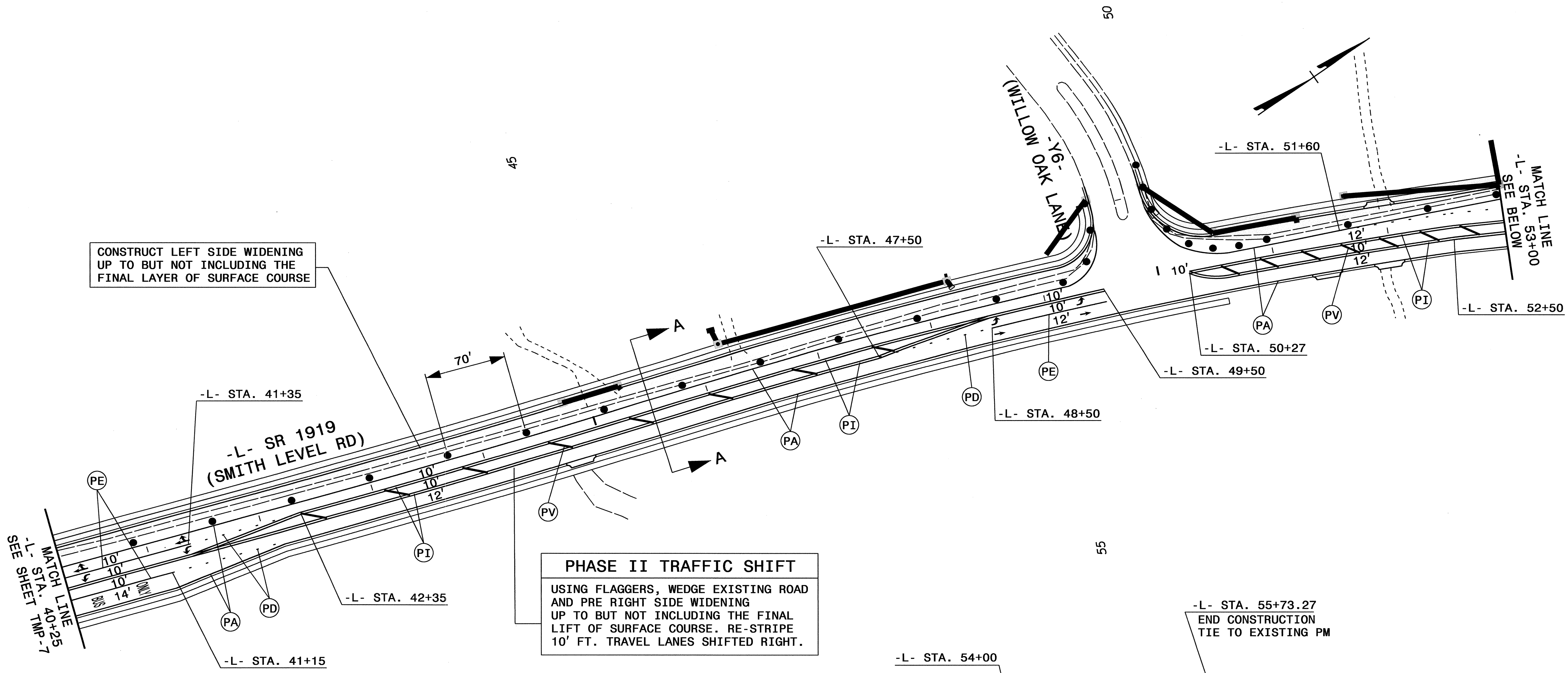

NOTE: INSTALL TEMPORARY RAISED PAVEMENT MARKERS AS PER RSD 1250.01 & 1251.01.
ALL STATIONS AND DIMENSIONS SHOWN ARE +/-

APPROVED: *[Signature]* DATE: 9/4/12
SEAL
NORTH CAROLINA PROFESSIONAL ENGINEER
SEAL 022104
JOHN S. KITE

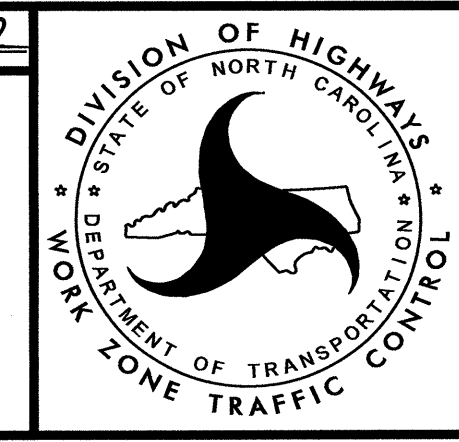

PHASE II

04-SEP-2012 12:46 \\dot\affs\of10\NSProj\TIPProjects-U\U2803\Traffic\TrafficControl\Top\U-2803-TC-TMP-8.dgn ckdptel AT 12266003

①		②		③	
MESSAGE NO. 1	MESSAGE NO. 2	MESSAGE NO. 1	MESSAGE NO. 2	MESSAGE NO. 1	MESSAGE NO. 2
NEW TRAFFIC PATTERN	BEGIN mm/dd	RNDAABOUT OPEN 1000 FT	ADVISORY SPEED 20 MPH	RNDAABOUT OPEN 500 FT	NO LEFT TURN
CHANGEABLE MESSAGE SIGN		CHANGEABLE MESSAGE		CHANGEABLE MESSAGE	

PLACE CHANGEABLE MESSAGE SIGN (SHORT TERM) ONE WEEK PRIOR TO OPENING ROUNDABOUT TRAFFIC PATTERN

CHANGEABLE MESSAGE SIGNS (SHORT TERM) REMOVE ONE WEEK AFTER NEW TRAFFIC PATTERN PLACED FOR ROUNDABOUT

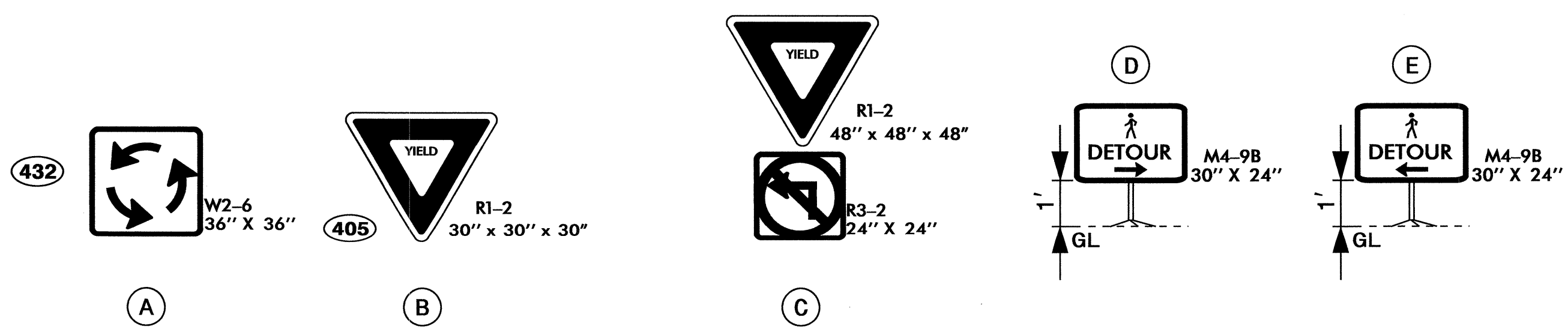
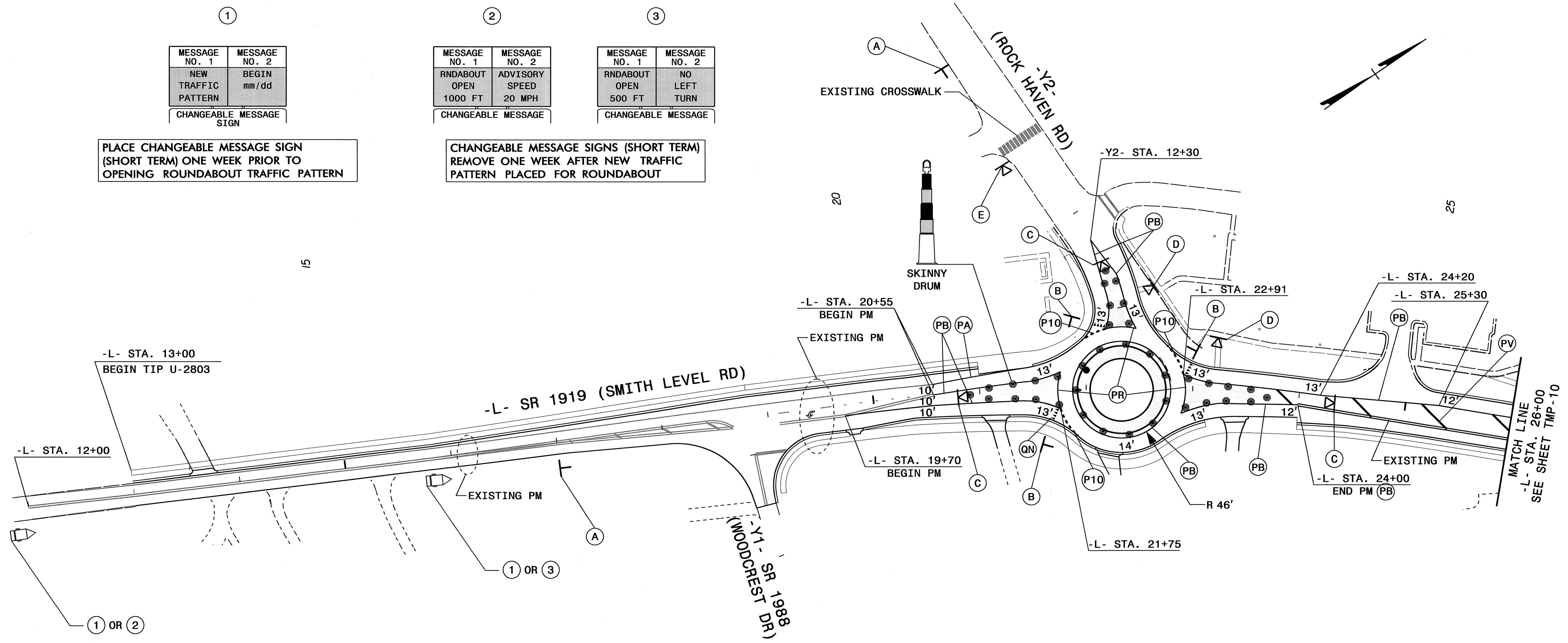

NOTE: INSTALL PERMANENT STATIONARY SIGNS (A) AND (B) AS PER SIGNING PLANS BEFORE PLACING NEW ROUNDABOUT TRAFFIC PATTERN

NOTE: INSTALL TEMPORARY RAISED PAVEMENT MARKERS AS PER RSD 1250.01 & 1251.01.
ALL STATIONS AND DIMENSIONS SHOWN ARE +/-

04-SEP-2012 12:52 \\dot\dfs\dot\TIPProjects\U2803\TrafficControl\U-2803_TC_TMP_9.dgn

APPROVED: *[Signature]* DATE: 9/11/12
SEAL
PROFESSIONAL ENGINEER
SEAL 022104
JOHN S. KITE, JR.

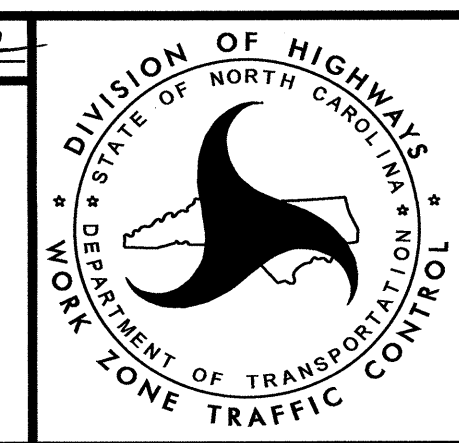

PHASE III

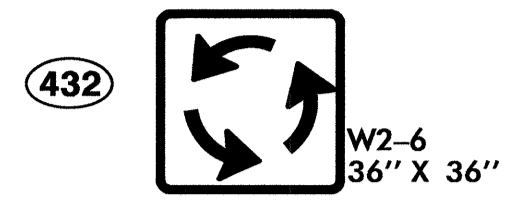

NOTE: INSTALL PERMANENT STATIONARY SIGN (A) AS PER SIGNING PLANS BEFORE PLACING NEW ROUNDABOUT TRAFFIC PATTERN

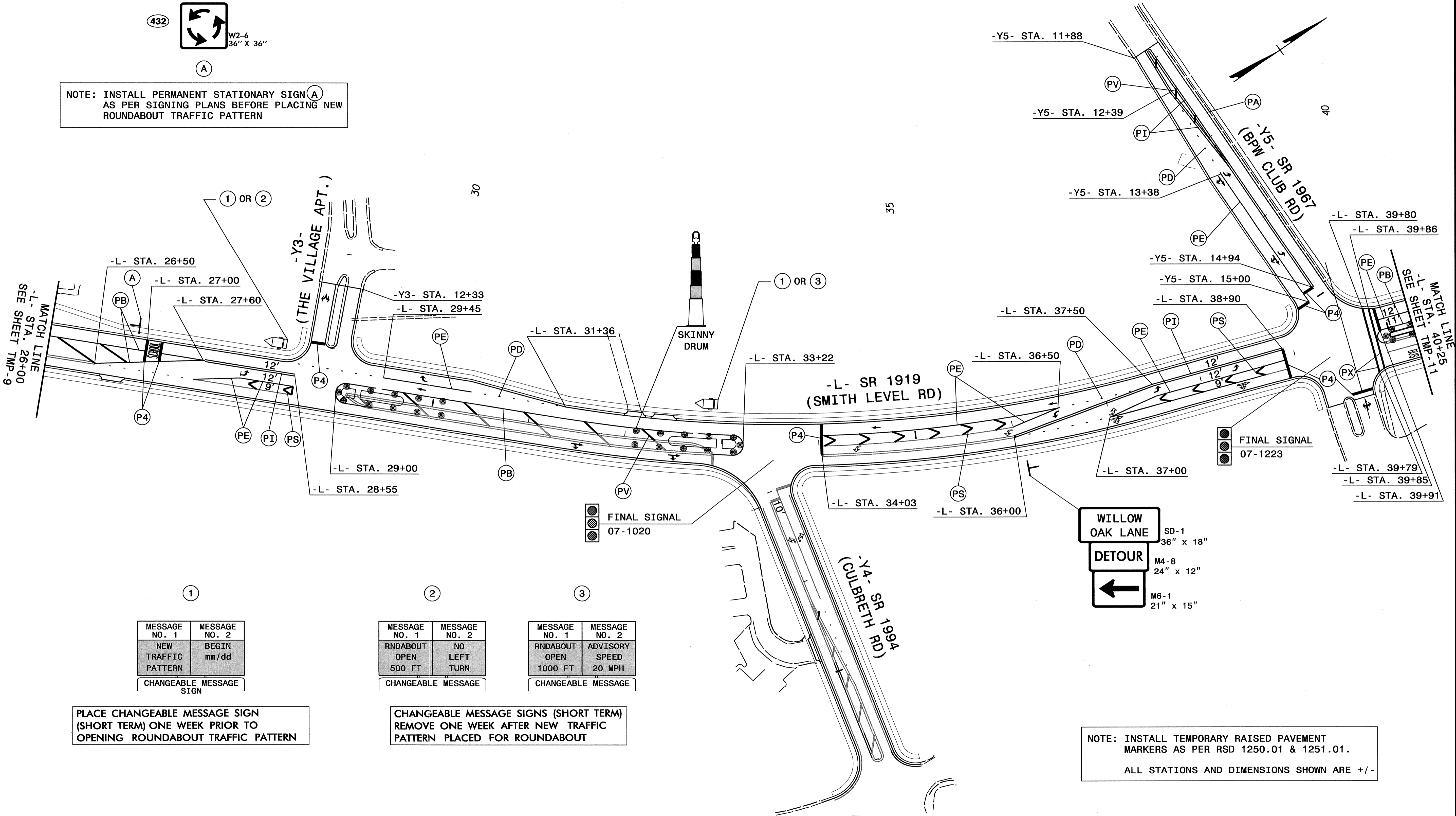

MESSAGE NO. 1	MESSAGE NO. 2
NEW TRAFFIC PATTERN	BEGIN mm/dd

CHANGEABLE MESSAGE SIGN

PLACE CHANGEABLE MESSAGE SIGN (SHORT TERM) ONE WEEK PRIOR TO OPENING ROUNDABOUT TRAFFIC PATTERN

MESSAGE NO. 1	MESSAGE NO. 2
RNDABOUT OPEN 500 FT	NO LEFT TURN

CHANGEABLE MESSAGE

CHANGEABLE MESSAGE SIGNS (SHORT TERM) REMOVE ONE WEEK AFTER NEW TRAFFIC PATTERN PLACED FOR ROUNDABOUT

MESSAGE NO. 1	MESSAGE NO. 2
RNDABOUT OPEN 1000 FT	ADVISORY SPEED 20 MPH

CHANGEABLE MESSAGE

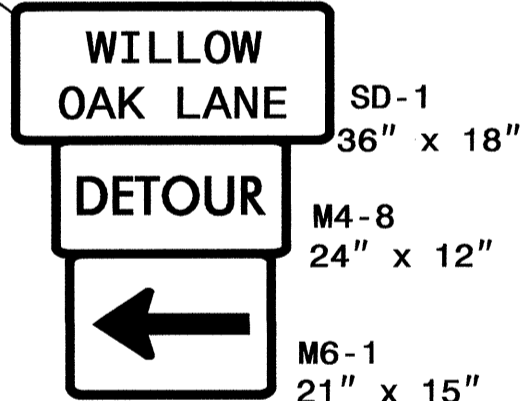

NOTE: INSTALL TEMPORARY RAISED PAVEMENT MARKERS AS PER RSD 1250.01 & 1251.01. ALL STATIONS AND DIMENSIONS SHOWN ARE +/-

04-SEP-2012 14:31 \\dot\dfs\001\NSPProj\TIPProjects-U\U2803\Traffic\TrafficControl\top\U-2803.TC.TMP_10.dgn akp\atel AT TE266003

APPROVED: *[Signature]* DATE: 9/4/12

SEAL

PHASE III

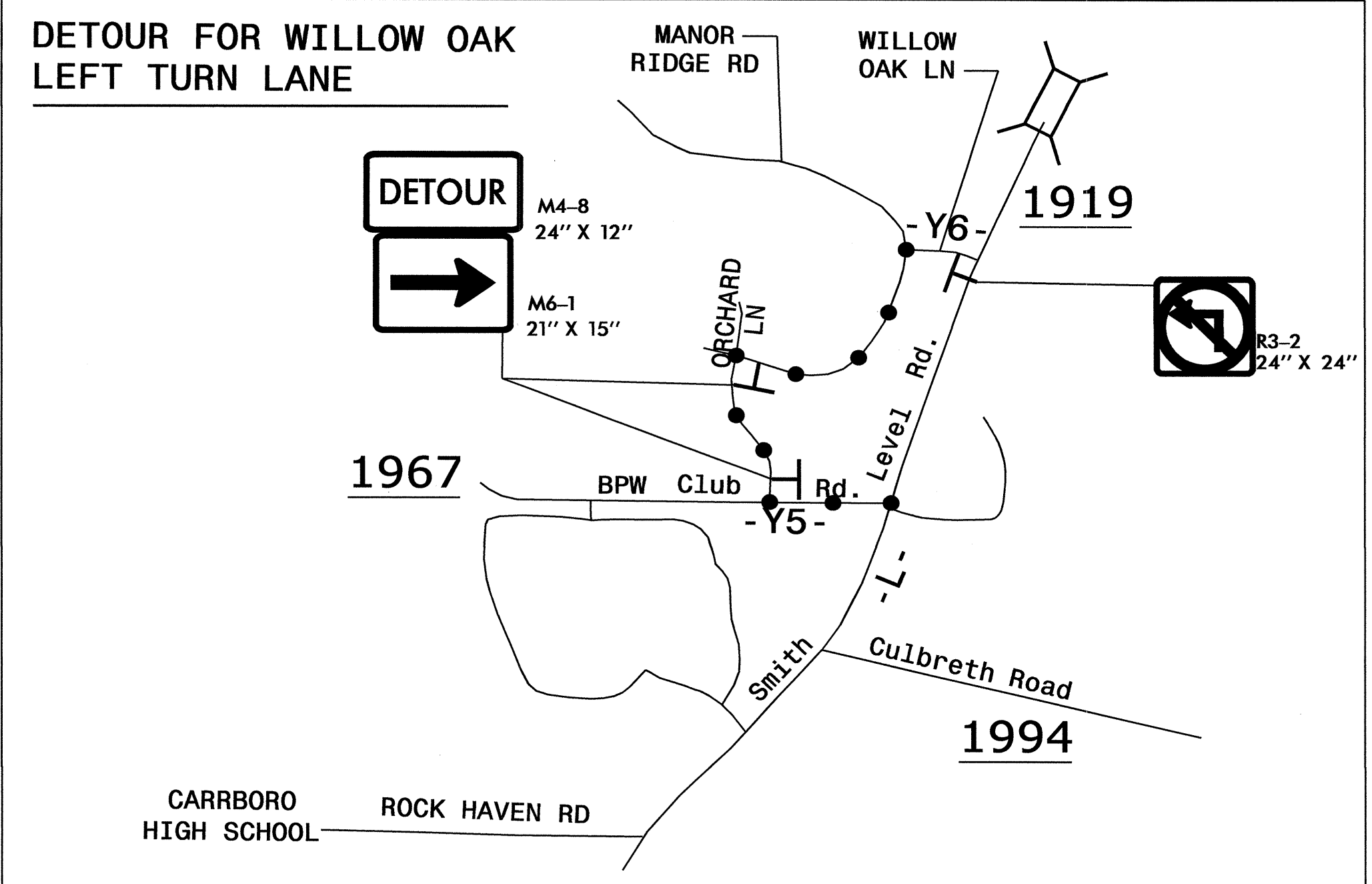

NOTE A:
 USE FLAGGERS TO BRING DRAINAGE STR. 723, 724, 727, 731 AND 732 TO THE FINAL GRADE, IN CONJUNCTION WITH CURB PLACEMENT

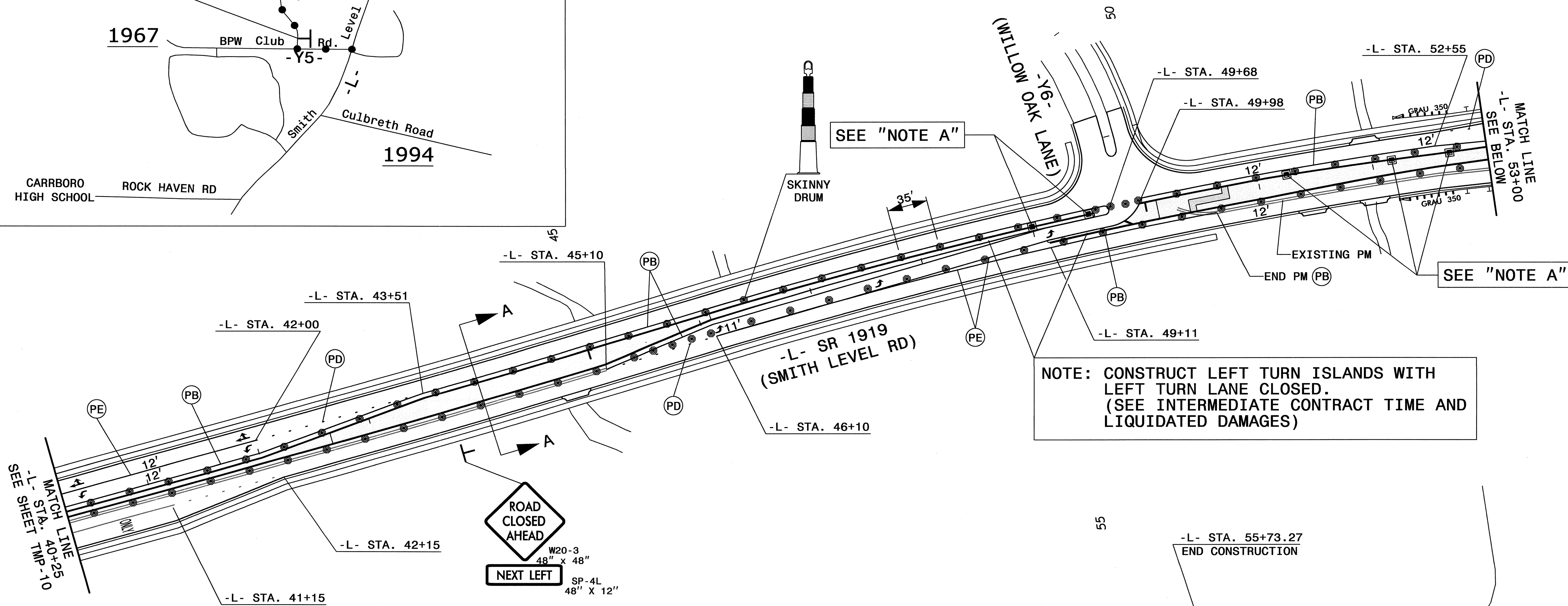
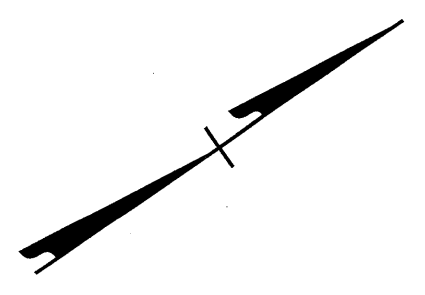

NOTE: CONSTRUCT LEFT TURN ISLANDS WITH LEFT TURN LANE CLOSED. (SEE INTERMEDIATE CONTRACT TIME AND LIQUIDATED DAMAGES)

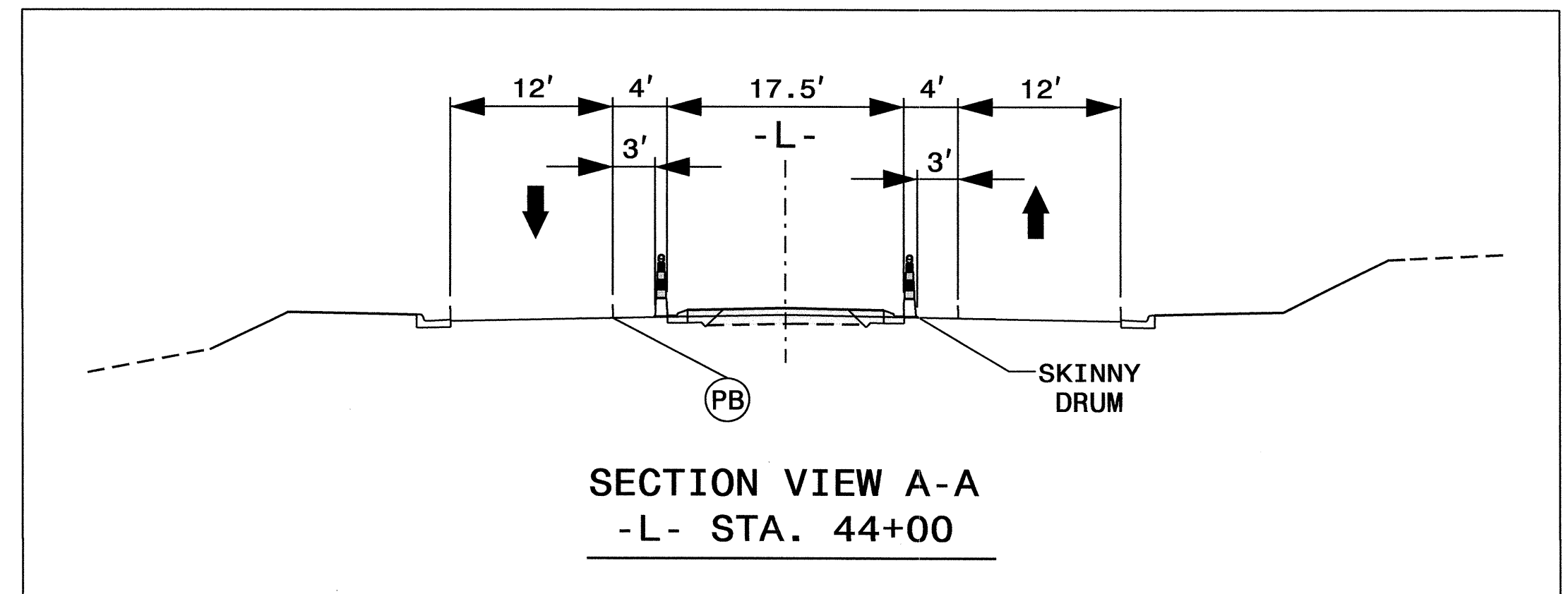

NOTE: INSTALL TEMPORARY RAISED PAVEMENT MARKERS AS PER RSD 1250.01 & 1251.01.
 ALL STATIONS AND DIMENSIONS SHOWN ARE +/-

APPROVED: *[Signature]* DATE: 9/28/12

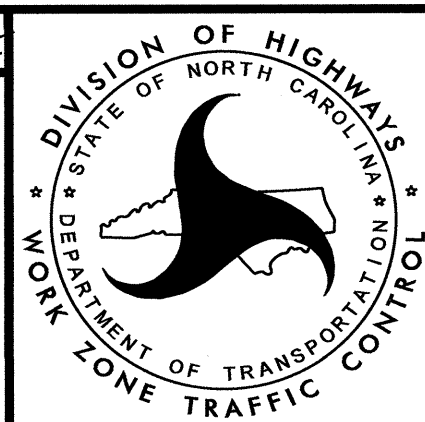

PHASE III

26-SEP-2012 13:27
 \\dot\dfs\proj\01\NSProj\TIPProjects-U\2803\TrafficControl\top\U-2803.TC_TMP-11.dgn
 akd\atel AT TE266003