

STATE OF NORTH CAROLINA
DIVISION OF HIGHWAYS

TRANSPORTATION MANAGEMENT PLAN

RUTHERFORD COUNTY

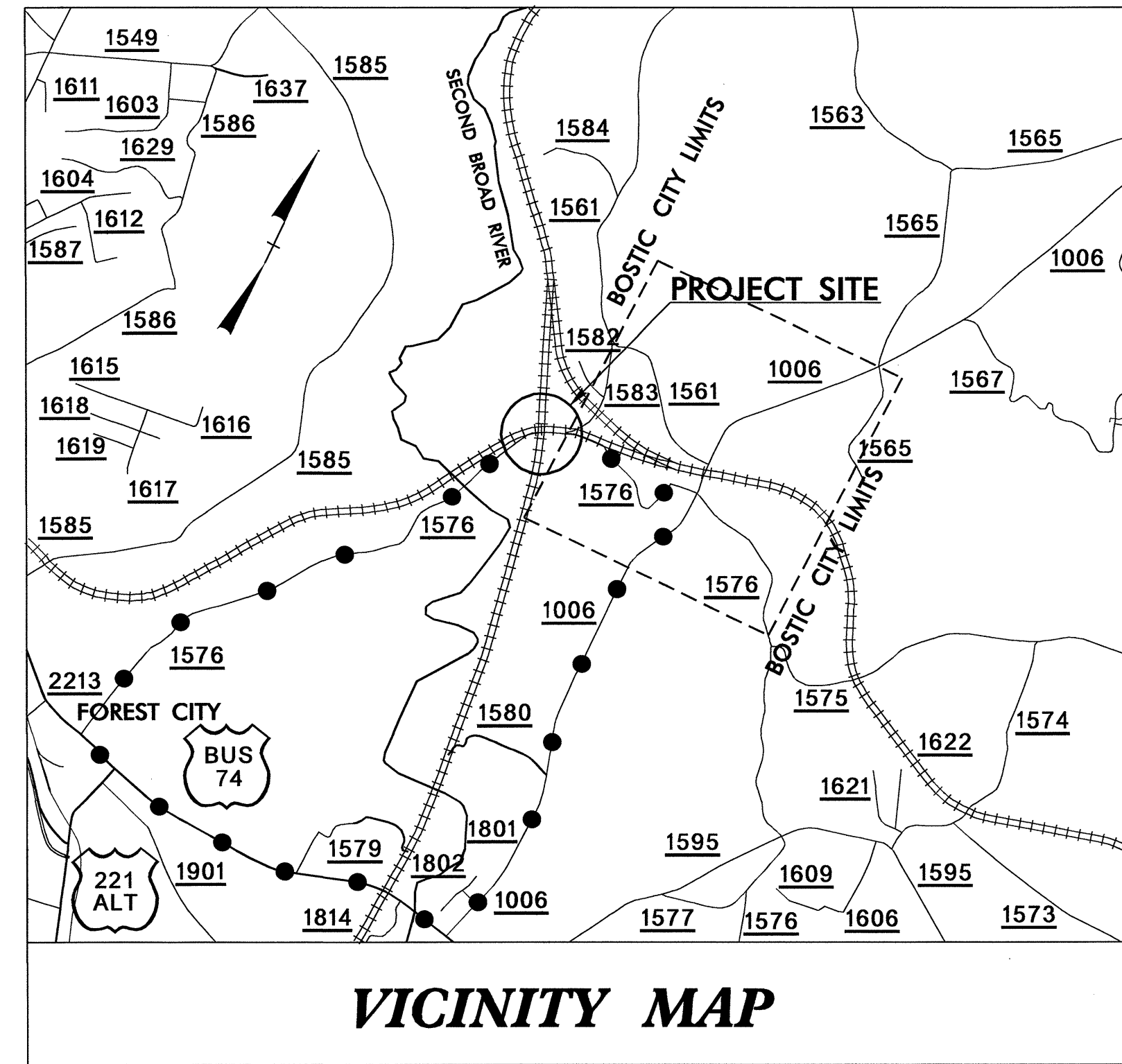
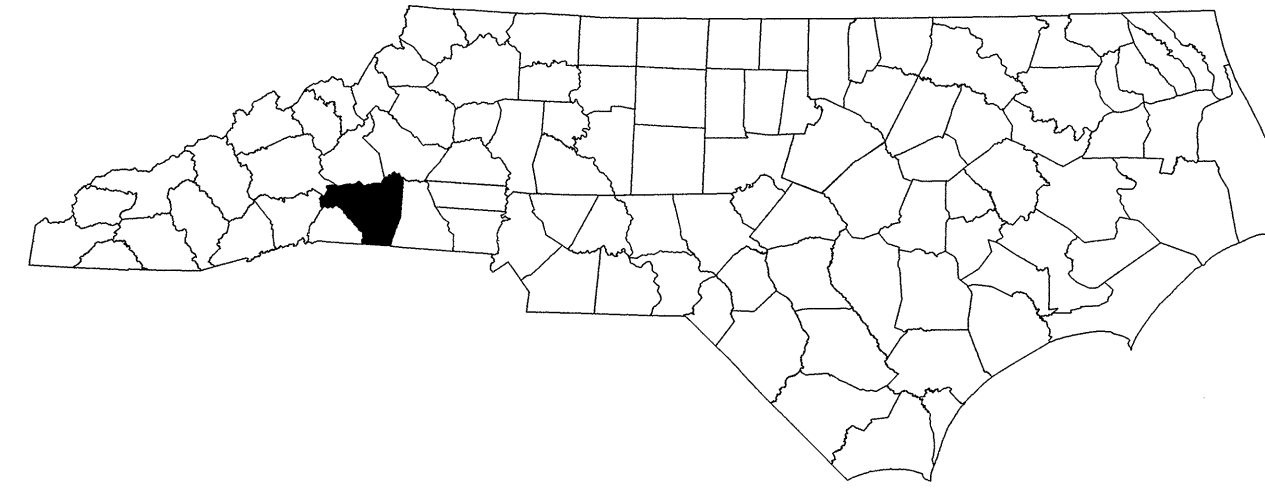

VICINITY MAP

● ● ● ● ● ● ● OFFSITE DETOUR

LOCATION: BRIDGE NO. 69 ON SR 1576 OVER CSX RAILROAD

INDEX OF SHEETS

SHEET NO.	TITLE
TMP-1	TITLE SHEET, AND INDEX OF SHEETS
TMP-1A	LIST OF APPLICABLE ROADWAY STANDARD DRAWINGS, LEGEND, AND TEMPORARY PAVEMENT MARKING
TMP-1B	TRANSPORTATION OPERATIONS PLAN AND PROJECT NOTES
TMP-2	DETOUR SIGN DETAIL
TMP-3	PHASING AND PLAN DETAILS
TMP-4	DETOUR PLAN

SHEET NO.

TMP-1

B-4632

TIP PROJECT:

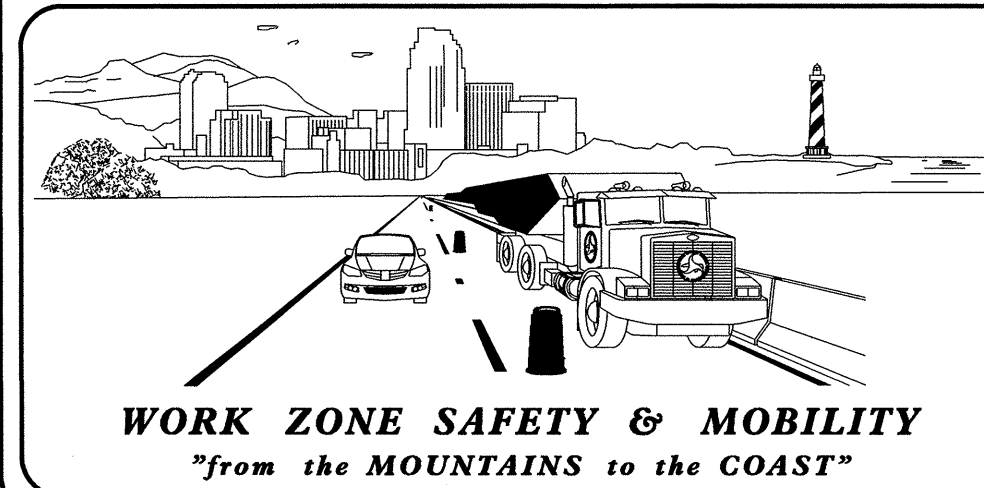

N.C.D.O.T. WORK ZONE TRAFFIC CONTROL
 1561 MAIL SERVICE CENTER (MSC) RALEIGH, NC 27699-1561
 750 N. GREENFIELD PARKWAY, GARNER, NC 27529 (DELIVERY)
 PHONE: (919) 773-2800 FAX: (919) 771-2745

J. S. BOURNE, P.E. STATE TRAFFIC MANAGEMENT ENGINEER
 G. L. GETTIER, P.E. TRAFFIC CONTROL PROJECT ENGINEER
 J. W. GILSTRAP TRAFFIC CONTROL PROJECT DESIGN ENGINEER
 KEN BROADWELL TRAFFIC CONTROL DESIGN ENGINEER

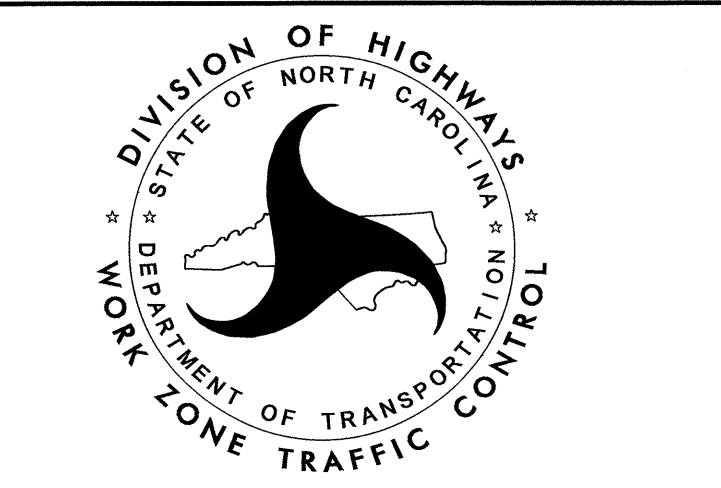

APPROVED: _____
 DATE: _____

SEAL

13-FEB-2012 08:58
 \\dot\cfs\root\N\Proj\TIP\Projects-B\B4632\Traffic\TrafficControl\TCP\B4632-TMP-1.dgn
 \$\$\$USERNAME\$\$\$

ROADWAY STANDARD DRAWINGS

THE FOLLOWING ROADWAY STANDARDS AS SHOWN IN "ROADWAY STANDARD DRAWINGS" - PROJECT SERVICES UNIT - N.C. DEPARTMENT OF TRANSPORTATION - RALEIGH, N.C., DATED JANUARY 2012 ARE APPLICABLE TO THIS PROJECT AND BY REFERENCE HEREBY ARE CONSIDERED A PART OF THESE PLANS:

<u>STD. NO.</u>	<u>TITLE</u>
1101.03	TEMPORARY ROAD CLOSURES
1101.05	WORK ZONE VEHICLE ACCESSES
1101.11	TRAFFIC CONTROL DESIGN TABLES
1110.01	STATIONARY WORK ZONE SIGNS
1130.01	DRUMS
1145.01	BARRICADES - TYPE III

LEGEND

GENERAL

- DIRECTION OF TRAFFIC FLOW
- NORTH ARROW

TEMPORARY PAVEMENT MARKING

N/A

TRAFFIC CONTROL DEVICES

- BARRICADE (TYPE III)
- CONE
- DRUM SKINNY DRUM

TEMPORARY SIGNING

- STATIONARY SIGN

13-FEB-2012 09:05
 \\dot\dfs\dot\Proj\TrafficControl\B4632-TMP-1A.dgn
 Kbradwell AT 12:44:39

APPROVED: _____ DATE: _____ 		<h3>ROADWAY STANDARD DRAWINGS & LEGEND</h3>
---------------------------------	--	---

TRANSPORTATION OPERATIONS

CONSTRUCTION

REMOVE AND REPLACE EXISTING STRUCTURE AND APPROACHES ALONG THE EXISTING ROADWAY ALIGNMENT AS SHOWN IN THE CONSTRUCTION PLANS.

TMP DESIGN PARAMETERS

TRAFFIC WILL BE DETOURED OFFSITE DURING THE CONSTRUCTION PERIOD.

THE OFFSITE DETOUR WILL INCLUDE SR 1561, SR 1006 AND US 74 BUS. (SEE SHEET TMP-4).

TRAFFIC WILL NEED TO BE MAINTAINED TO THE EXISTING DRIVEWAYS LOCATED WITHIN THE PROJECT LIMITS. (SEE SHEET TMP-3).

GENERAL NOTES

CHANGES MAY BE REQUIRED WHEN PHYSICAL DIMENSIONS IN THE DETAIL DRAWINGS, STANDARD DETAILS AND ROADWAY DETAILS ARE NOT ATTAINABLE TO MEET FIELD CONDITIONS, OR RESULT IN DUPLICATE, OR UNDESIRE OVERLAPPING OF DEVICES. MODIFICATION MAY INCLUDE: MOVING, SUPPLEMENTING, COVERING, OF REMOVAL OF DEVICES, AS DIRECTED BY THE ENGINEER.

THE FOLLOWING GENERAL NOTES APPLY AT ALL TIMES FOR THE DURATION OF THE CONSTRUCTION PROJECT EXCEPT WHEN OTHERWISE NOTED IN THE PLAN OR AS DIRECTED BY THE ENGINEER.

PAVEMENT EDGE DROP OFF REQUIREMENTS

A) BACKFILL AT A 6:1 SLOPE UP TO THE EDGE AND ELEVATION OF EXISTING PAVEMENT IN AREAS ADJACENT TO AN OPENED TRAVEL LANE THAT HAS A DROP-OFF AS FOLLOWS:

BACKFILL DROP-OFFS THAT EXCEED 2 INCHES ON ROADWAYS WITH POSTED SPEED LIMITS OF 45 MPH OR GREATER.

BACKFILL DROP-OFFS THAT EXCEED 3 INCHES ON ROADWAYS WITH POSTED SPEED LIMITS LESS THAN 45 MPH.

BACKFILL WITH SUITABLE COMPACTED MATERIAL, AS APPROVED BY THE ENGINEER, AT NO EXPENSE TO THE DEPARTMENT

TRAFFIC PATTERN ALTERATIONS

B) NOTIFY THE ENGINEER A MINIMUM OF THIRTY (30) CALENDAR DAYS PRIOR TO ANY TRAFFIC PATTERN ALTERATION.

SIGNING

C) PROVIDE SIGNING AND DEVICES REQUIRED TO CLOSE THE ROAD ACCORDING TO THE ROADWAY STANDARD DRAWINGS AND TRAFFIC CONTROL PLANS.

PROVIDE SIGNING REQUIRED FOR THE OFF-SITE DETOUR ROUTE AS SHOWN IN THE TRAFFIC CONTROL PLANS.

D) COVER OR REMOVE ALL SIGNS AND DEVICES REQUIRED TO CLOSE THE ROAD WHEN ROAD CLOSURE IS NOT IN OPERATION.

COVER OR REMOVE ALL SIGNS REQUIRED FOR THE OFF-SITE DETOUR WHEN THE DETOUR IS NOT IN OPERATION.

E) ENSURE ALL NECESSARY SIGNING IS IN PLACE PRIOR TO ALTERING ANY TRAFFIC PATTERN.

TRAFFIC CONTROL DEVICES

F) PLACE TYPE III BARRICADES WITH "ROAD CLOSED" SIGN R-11-2 ATTACHED OF SUFFICIENT LENGTH TO CLOSE ENTIRE ROADWAY.

PAVEMENT MARKINGS AND MARKERS

G) TIE PROPOSED PAVEMENT MARKING LINES TO EXISTING PAVEMENT MARKING LINES.

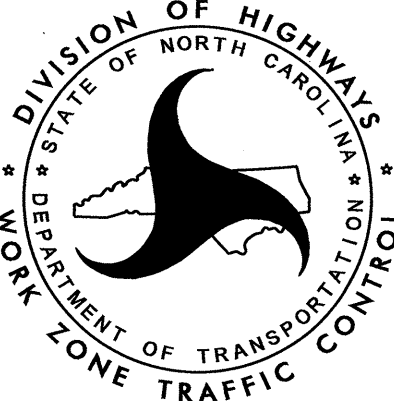
APPROVED: _____ DATE: _____			TRANSPORTATION OPERATIONS & PROJECT NOTES
SEAL			

SIGN NUMBER: SP12028 TYPE: STATIONARY QUANTITY: SEE PLANS SIGN WIDTH: 3'-6" HEIGHT: 1'-6" TOTAL AREA: 5.3 Sq.Ft. BORDER TYPE: INSET RECESS: 0.38" WIDTH: 0.63" RADII: 1.5" NO. Z BARS: LENGTH:	BACKG COLOR: Fluorescent Orange COPY COLOR: Black <table border="1" style="width: 100%; text-align: center;"> <tr> <th>SYMBOL</th> <th>X</th> <th>Y</th> <th>WID</th> <th>HT</th> </tr> <tr><td> </td><td> </td><td> </td><td> </td><td> </td></tr> <tr><td> </td><td> </td><td> </td><td> </td><td> </td></tr> <tr><td> </td><td> </td><td> </td><td> </td><td> </td></tr> <tr><td> </td><td> </td><td> </td><td> </td><td> </td></tr> <tr><td> </td><td> </td><td> </td><td> </td><td> </td></tr> <tr><td> </td><td> </td><td> </td><td> </td><td> </td></tr> <tr><td> </td><td> </td><td> </td><td> </td><td> </td></tr> </table> MAT'L: 0.080" (2.0 mm) ALUMINUM	SYMBOL	X	Y	WID	HT																																				DESIGN BY: DHB PROJECT ID: B-4632 CHECKED BY: KLJ DIV: 13 DATE: Feb 06, 2012
SYMBOL	X	Y	WID	HT																																						

BORDER R=1.5"
 TH=0.63"
 IN=0.38"

Spacing Factor is 1 unless specified otherwise

LETTER POSITIONS

Letter spacings are to start of next letter

													Series/Size Text Length
3.2	4.3	4.4	3.9	3.9	2	3.4	6	4.4	3.4	3.2			C 2000 35.6

FILENAME: B-4632_Sgn_SGN_design NORTH CAROLINA D.O.T. SIGN DETAIL

"The special sign design shown on this sheet was provided through a sealed document from Signing and Delineation. The document was submitted to WZTC on February 6, 2012 and sealed by a Professional Engineer, Ronald W. King, license # 022959".

13-FEB-2012 09:16
 \\dot\dfs\dot\proj\TIP\Projects-B\B4632\Traffic\TrafficControl\TCP\B-4632 TMP-2.dgn
 Kbradwell AT 12/24/12

APPROVED: _____ DATE: _____ 		SPECIAL SIGN DESIGN
---------------------------------	--	----------------------------

PHASING

STEP 1: - INSTALL OFF-SITE DETOUR ROUTE SIGN ASSEMBLIES FOR THE CLOSING OF SR 1576 (BOSTIC RD., -L-). SEE SHEETS TMP-2A AND TMP-4.

- USING ROADWAY STANDARD DRAWING NO. 1101.03, SHEET 1 OF 9 AND SHEETS TMP-3 AND TMP-4 CLOSE SR 1576 (BOSTIC RD., -L-) TO THRU TRAFFIC.

NOTE: INSTALL ADDITIONAL TYPE III BARRICADE AT STATION 33+75 +/- -L-, TO MAINTAIN ACCESS TO DRIVEWAYS DURING CONSTRUCTION.

STEP 2: - REMOVE THE EXISTING STRUCTURE AND CONSTRUCT THE PROPOSED STRUCTURE AND ROADWAY UP TO AND INCLUDING THE FINAL LAYER OF SURFACE COURSE AND PLACE FINAL PAVEMENT MARKINGS ON SR 1576 (BOSTIC RD., -L-). SEE CONSTRUCTION PLANS AND FINAL PAVEMENT MARKING PLANS.

STEP 3: - REMOVE ALL TRAFFIC CONTROL DEVICES, SIGNING AND DETOUR ROUTE SIGNING.

- OPEN TO FINAL TRAFFIC PATTERN.

NOTES:
1. TYPE III BARRICADE LOCATIONS ARE APPROXIMATE. FIELD ADJUST AS REQUIRED.

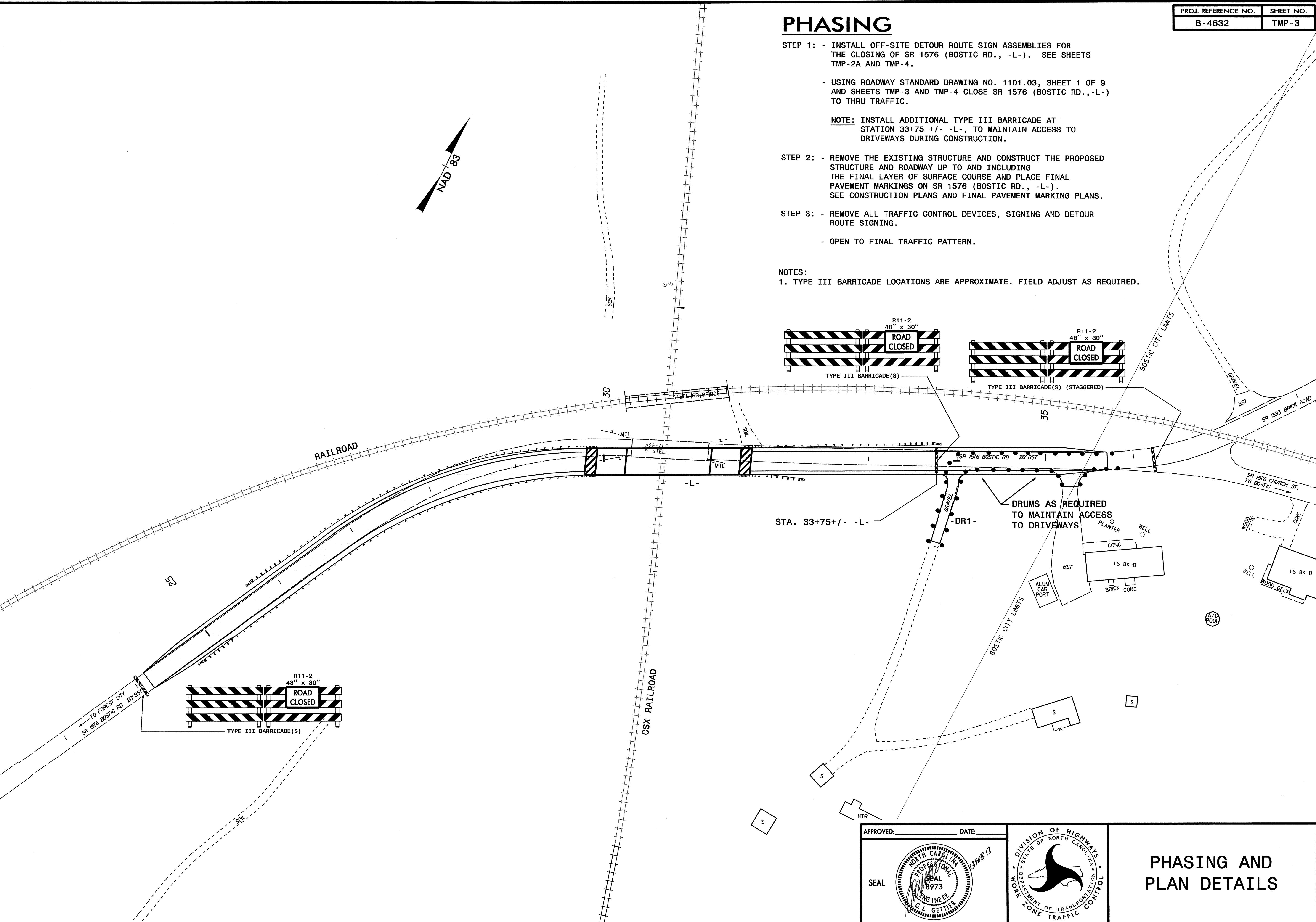
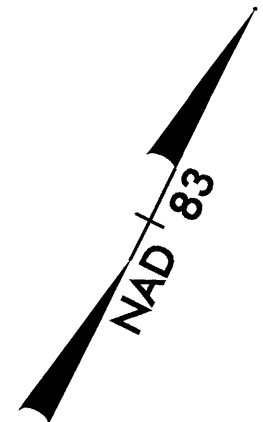

I:\3-FEB-2012 11:28
 \dot\gifs\001\Prj\01\TIP\Projects-B\4632\TrafficControl\TCP\B-4632 TMP-3.dgn
 K:\Production\AT\12244739

APPROVED: _____ DATE: _____

SEAL

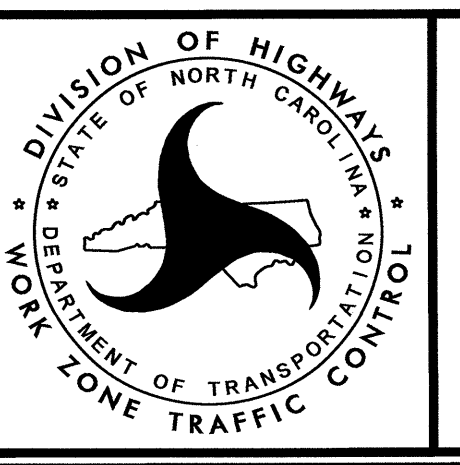

**PHASING AND
PLAN DETAILS**

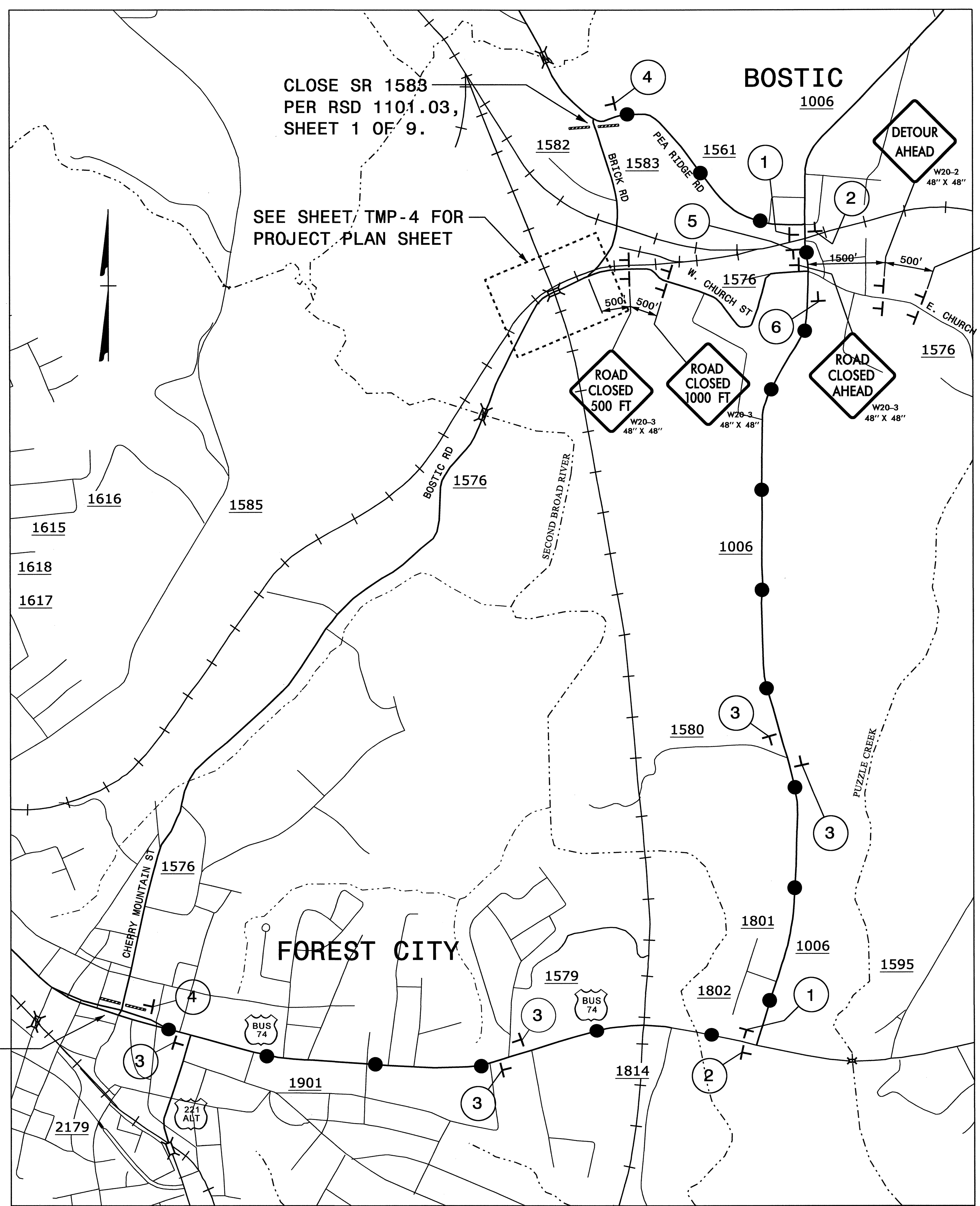

CLOSE SR 1583
PER RSD 1101.03,
SHEET 1 OF 9.

SEE SHEET TMP-4 FOR
PROJECT PLAN SHEET

CLOSE SR 1576
PER RSD 1101.03,
SHEET 1 OF 9
AS DIRECTED BY
THE ENGINEER

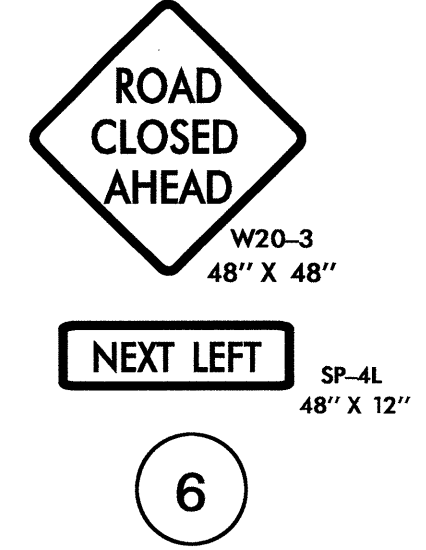
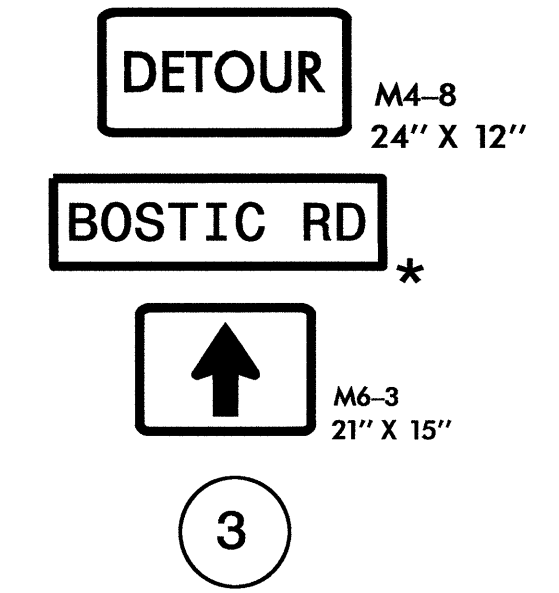
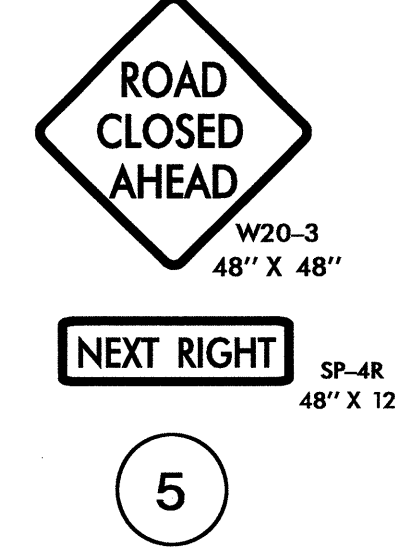
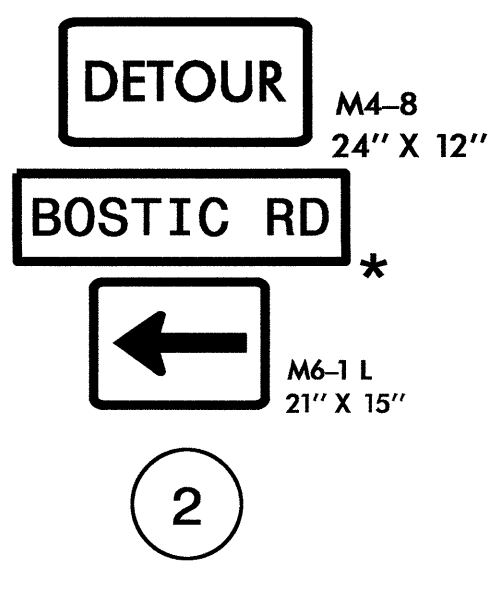
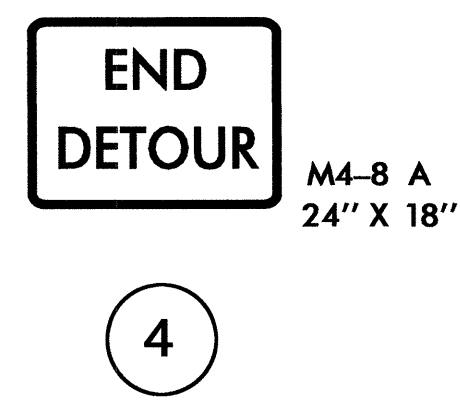
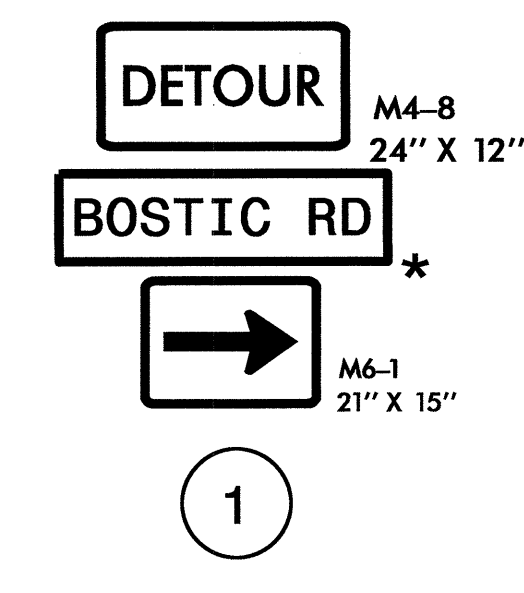

NOTES

1. DIMENSIONS ARE APPROXIMATE. FIELD ADJUST AS REQUIRED.

* — INDICATES SEE SHEET TMP-2 FOR SPECIAL SIGN DESIGN

13-FEB-2012 09:20
C:\Users\jg\Documents\Projects\B4632\TrafficControl\TCPAB-4632 TMP-4.dgn
K01000001 AT 12:44:19

APPROVED: _____ DATE: _____

DETOUR ROUTE