

TIP PROJECT: U-0624

STATE OF NORTH CAROLINA
 DIVISION OF HIGHWAYS
 PLAN FOR PROPOSED
 HIGHWAY EROSION CONTROL
ORANGE COUNTY

LOCATION: NC 86 (SOUTH COLUMBIA STREET) FROM
 SR 1906 (PUREFOY ROAD) TO SR 1902 (MANNING
 DRIVE) IN CHAPEL HILL
TYPE OF WORK: GRADING, DRAINAGE, PAVING, WIDENING,
 AND SIGNALS

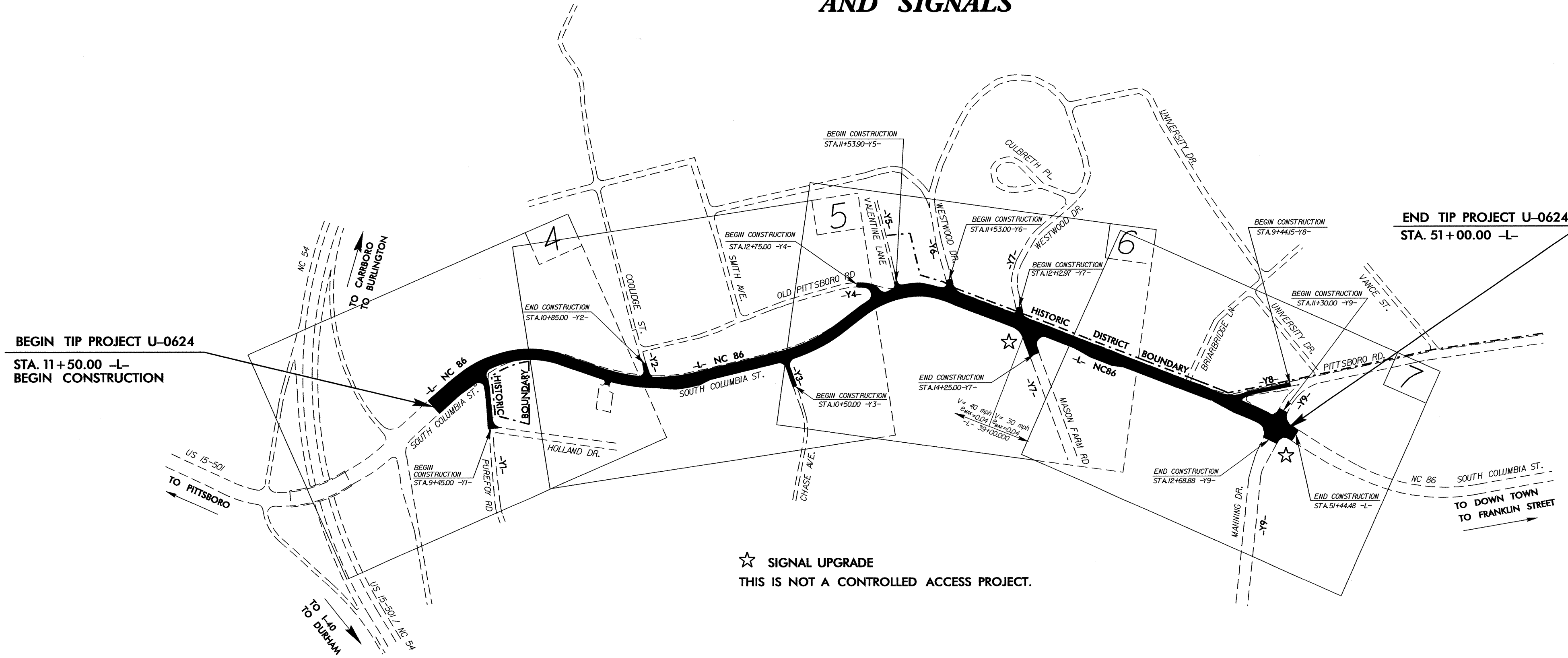
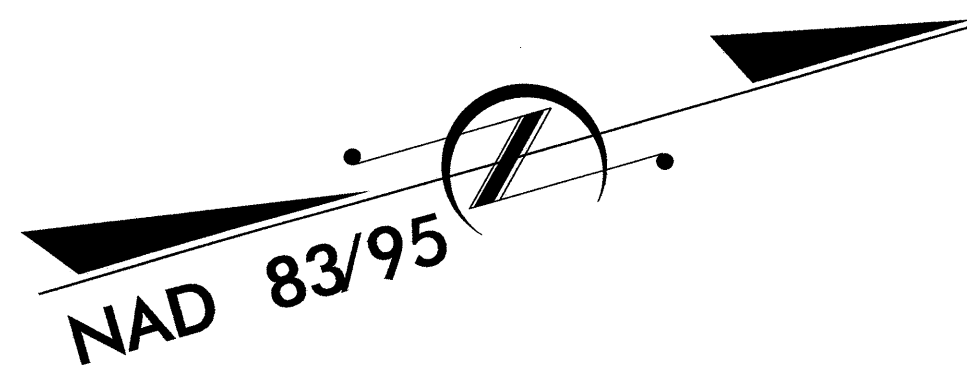

★ SIGNAL UPGRADE
 THIS IS NOT A CONTROLLED ACCESS PROJECT.

STATE	STATE PROJECT REFERENCE NO.	SHEET NO.	TOTAL SHEETS
N.C.	U-0624	EC-1	
STATE PROJ. NO.	F.A. PROJ. NO.	DESCRIPTION	

EROSION AND SEDIMENT CONTROL MEASURES

Sta. #	Description	Symbol
1630.03	Temporary Silt Ditch	TD
1630.05	Temporary Diversion	TD
1605.01	Temporary Silt Fence	III III III
1606.01	Special Sediment Control Fence	III III III
1622.01	Temporary Berms and Slope Drains	T
1630.02	Silt Basin Type B	Silt Basin Symbol
1635.01	Temporary Rock Silt Check Type-A	Rock Silt Check Symbol
	Temporary Rock Silt Check Type-A with Matting and Polyacrylamide (PAM)	Rock Silt Check Symbol
1635.02	Temporary Rock Silt Check Type-B	Rock Silt Check Symbol
	Wattle / Coir Fiber Wattle	Wattle Symbol
	Wattle / Coir Fiber Wattle with Polyacrylamide (PAM)	Wattle Symbol
1634.01	Temporary Rock Sediment Dam Type-A	Rock Sediment Dam Symbol
1634.02	Temporary Rock Sediment Dam Type-B	Rock Sediment Dam Symbol
1635.01	Rock Pipe Inlet Sediment Trap Type-A	Rock Pipe Inlet Sediment Trap Symbol
1635.02	Rock Pipe Inlet Sediment Trap Type-B	Rock Pipe Inlet Sediment Trap Symbol
1630.04	Stilling Basin	Stilling Basin Symbol
1630.06	Special Stilling Basin	Special Stilling Basin Symbol
	Rock Inlet Sediment Trap:	
1632.01	Type A	A
1632.02	Type B	B
1632.03	Type C	C
	Skimmer Basin	Skimmer Basin Symbol
	Tiered Skimmer Basin	Tiered Skimmer Basin Symbol
	Infiltration Basin	Infiltration Basin Symbol

**THIS PROJECT CONTAINS
 EROSION CONTROL PLANS
 FOR CLEARING AND
 GRUBBING PHASE OF
 CONSTRUCTION.**

GRAPHIC SCALE

0

PLANS

0

PROFILE (HORIZONTAL)

0

PROFILE (VERTICAL)

ROADSIDE ENVIRONMENTAL UNIT
 DIVISION OF HIGHWAYS
 STATE OF NORTH CAROLINA

THESE EROSION AND SEDIMENT CONTROL PLANS COMPLY
 WITH THE REGULATIONS SET FORTH BY THE
 NCG-010000 GENERAL CONSTRUCTION PERMIT EFFECTIVE AUGUST 3, 2011
 ISSUED BY THE NORTH CAROLINA DEPARTMENT OF ENVIRONMENT AND
 NATURAL RESOURCES DIVISION OF WATER QUALITY.

Prepared in the Office of:
ROADSIDE ENVIRONMENTAL UNIT
 1 South Wilmington St.
 Raleigh, NC 27611
2012 STANDARD SPECIFICATIONS

Roadway Standard Drawings

The following roadway english standards as appear in "Roadway Standard Drawings" - Roadway Design Unit - N. C. Department of Transportation - Raleigh, N. C., dated January 2012 and the latest revision thereto are applicable to this project and by reference hereby are considered a part of these plans.

1604.01 Railroad Erosion Control Detail	1632.01 Rock Inlet Sediment Trap Type A
1605.01 Temporary Silt Fence	1632.02 Rock Inlet Sediment Trap Type B
1606.01 Special Sediment Control Fence	1632.03 Rock Inlet Sediment Trap Type C
1607.01 Gravel Construction Entrance	1633.01 Temporary Rock Silt Check Type A
1622.01 Temporary Berms and Slope Drains	1633.02 Temporary Rock Silt Check Type B
1630.01 Riser Basin	1634.01 Temporary Rock Sediment Dam Type A
1630.02 Silt Basin Type B	1634.02 Temporary Rock Sediment Dam Type B
1630.03 Temporary Silt Ditch	1635.01 Rock Pipe Inlet Sediment Trap Type A
1630.04 Stilling Basin	1635.02 Rock Pipe Inlet Sediment Trap Type B
1630.05 Temporary Diversion	1640.01 Coir Fiber Baffle
1630.06 Special Stilling Basin	1645.01 Temporary Stream Crossing
1631.01 Matting Installation	

08 JUN 2010 15:42
 RA:EP/AR/CP/RE/ST/2010/0624/EC_tsh.dgn
 e:ep-1m 247REN222228

DIVISION OF HIGHWAYS
STATE OF NORTH CAROLINA

PROJECT REFERENCE NO. <i>U-0624</i>	SHEET NO. <i>EC-3A</i>
ROADWAY DESIGN ENGINEER	HYDRAULICS ENGINEER

SOIL STABILIZATION TIMEFRAMES

<i>SITE DESCRIPTION</i>	<i>STABILIZATION TIME</i>	<i>TIMEFRAME EXCEPTIONS</i>
PERIMETER DIKES, SWALES, DITCHES AND SLOPES	7 DAYS	NONE
HIGH QUALITY WATER (HQW) ZONES	7 DAYS	NONE
SLOPES STEEPER THAN 3:1	7 DAYS	IF SLOPES ARE 10' OR LESS IN LENGTH AND ARE NOT STEEPER THAN 2:1, 14 DAYS ARE ALLOWED.
SLOPES 3:1 OR FLATTER	14 DAYS	7 DAYS FOR SLOPES GREATER THAN 50' IN LENGTH.
ALL OTHER AREAS WITH SLOPES FLATTER THAN 4:1	14 DAYS	NONE, EXCEPT FOR PERIMETERS AND HQW ZONES.

8/17/99

CLEARING AND GRUBBING
EROSION CONTROL FOR
CONSTRUCTION SHEET 5

NOTE:

PLACE TEMPORARY ROCK SEDIMENT DAMS TYPE - B
AND TEMPORARY ROCK SILT CHECKS TYPE - A AT
DRAINAGE OUTLETS.

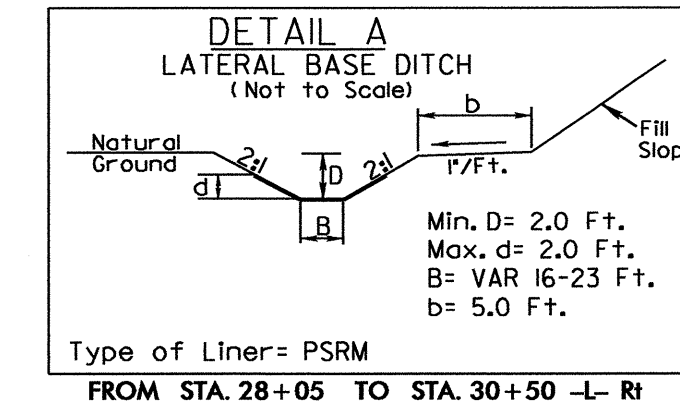
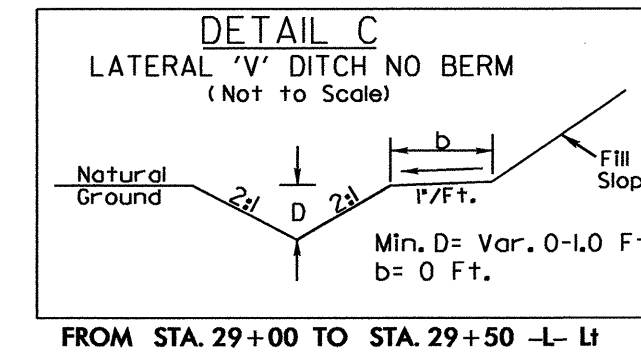
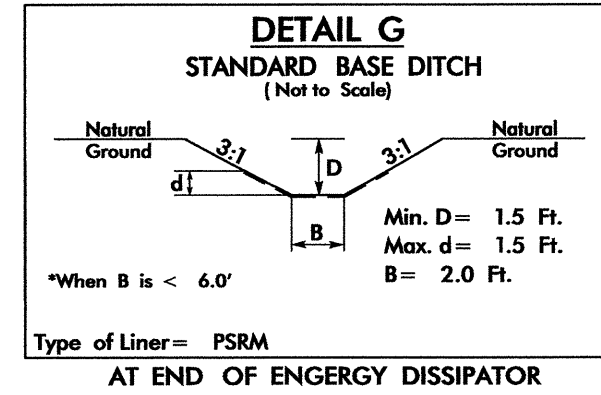
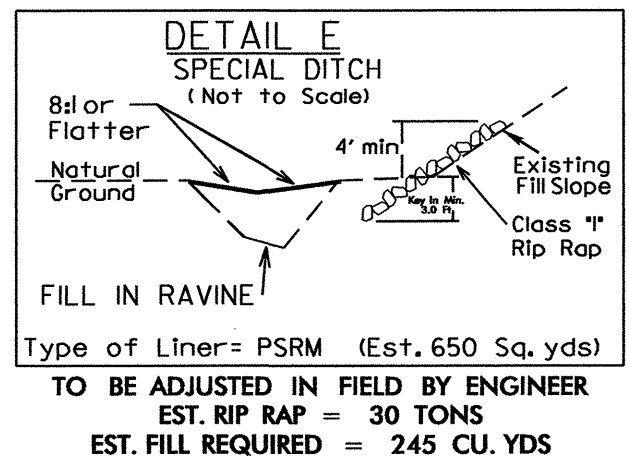
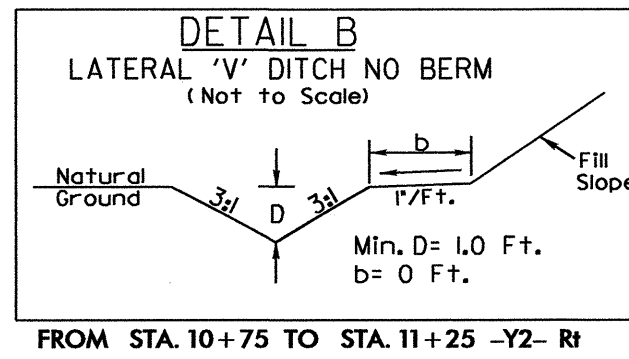

NAD 8395

PROJECT REFERENCE NO. U-0624	SHEET NO. EC-5/CONST.5
RW SHEET NO.	
ROADWAY DESIGN ENGINEER	HYDRAULICS ENGINEER

62 x 41 x 3
2.0 inch Skimmer
with 1.625 inch
Orifice Diameter
33 ft. weir
(See Tiered Skimmer
Basin Detail)
ID 5.1C&G

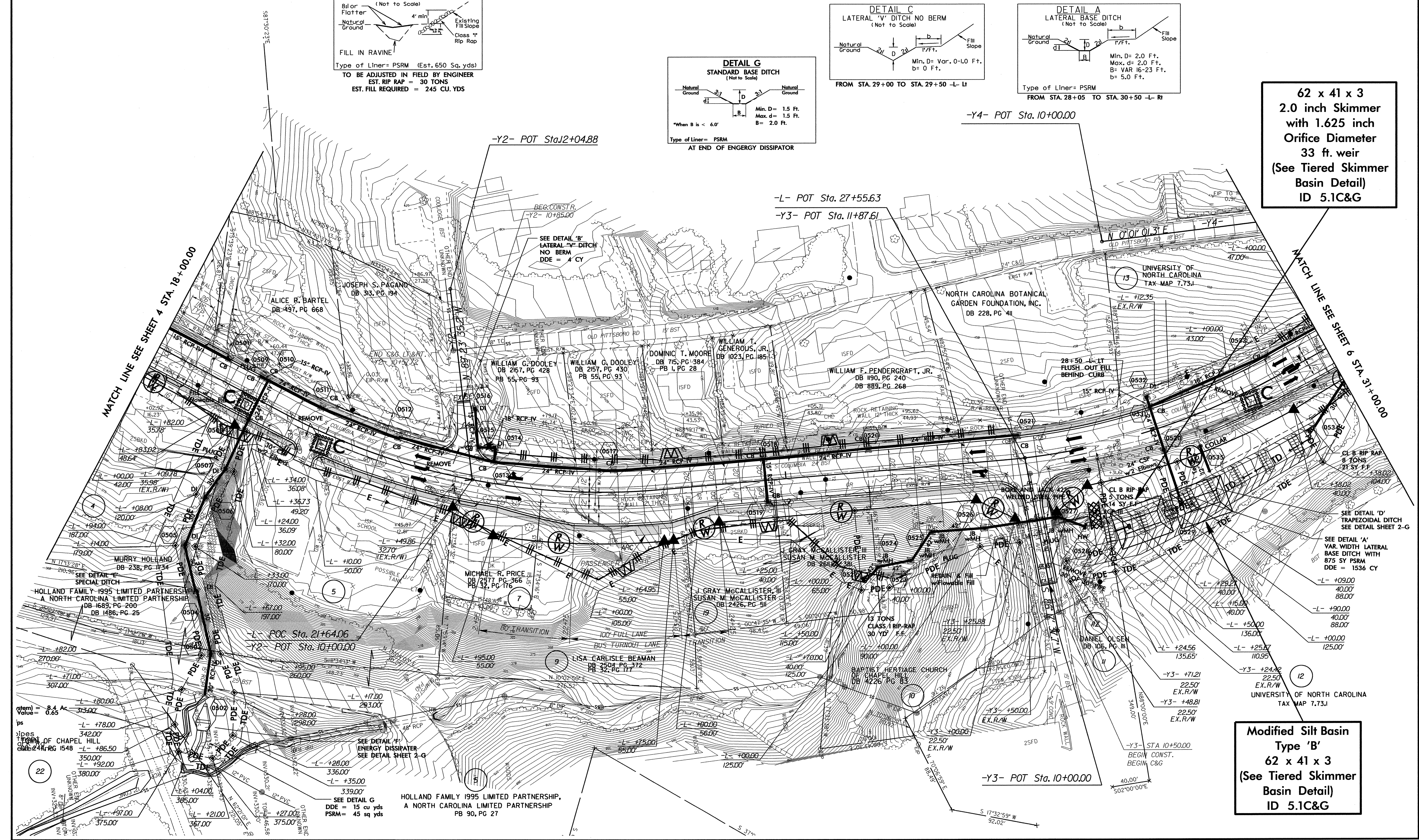

Modified Silt Basin
Type 'B'
62 x 41 x 3
(See Tiered Skimmer
Basin Detail)
ID 5.1C&G

8/17/99

CLEARING AND GRUBBING
EROSION CONTROL FOR
CONSTRUCTION SHEET 7

NOTE:
PLACE TEMPORARY ROCK SEDIMENT DAMS TYPE - B
AND TEMPORARY ROCK SILT CHECKS TYPE - A AT
DRAINAGE OUTLETS.

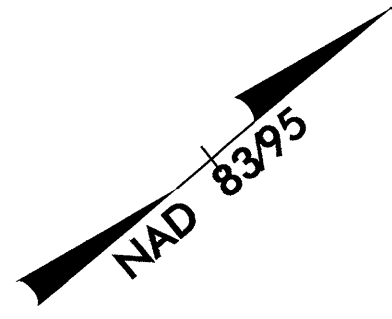

-L-	-Y8-	-Y9-	-Y9-	-Y9-
PI Sta 50+13.55 $\Delta = 11' 13" 57.6" (RT)$ $D = 4' 16" 32.9"$ $L = 262.70'$ $T = 131.77'$ $R = 1,340.00'$ SE = NC V = 40 mph		PI Sta 10+54.47 $\Delta = 24' 34" 59.6" (LT)$ $D = 22' 55" 05.9"$ $L = 107.26'$ $T = 54.47'$ $R = 250.00'$ SE = N/A V = 40 mph	PI Sta 11+98.13 $\Delta = 4' 19" 17.2" (LT)$ $D = 4' 24" 26.5"$ $L = 98.05'$ $T = 49.05'$ $R = 1,300.00'$	PI Sta 14+12.21 $\Delta = 19' 18" 21.8" (LT)$ $D = 1' 27" 33.0"$ $L = 168.48'$ $T = 85.04'$ $R = 500.00'$

PROJECT REFERENCE NO. U-0624	SHEET NO. EC-7/CONST.7
RW SHEET NO.	
ROADWAY DESIGN ENGINEER	HYDRAULICS ENGINEER

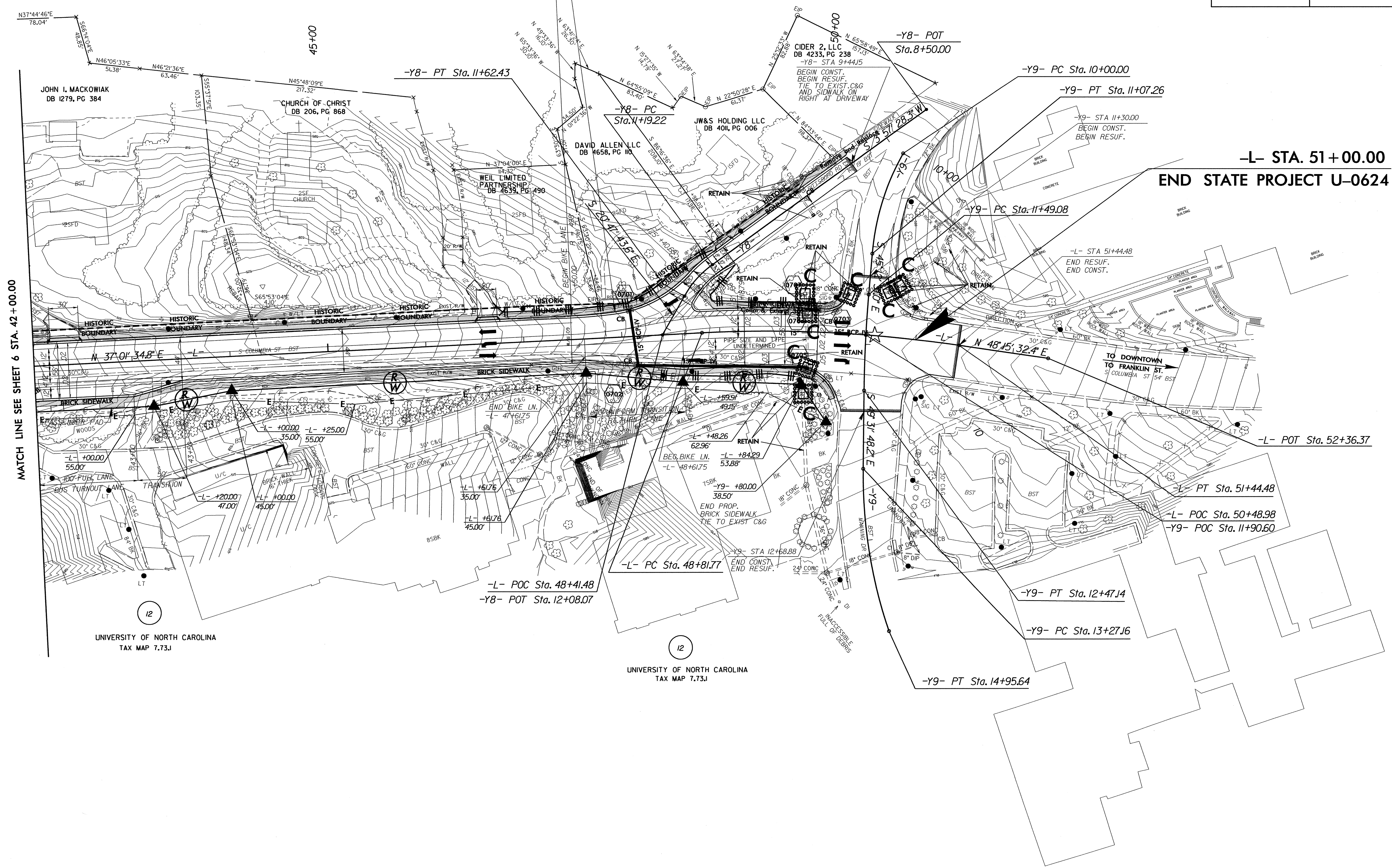

MATCH LINE SEE SHEET 6 STA. 42+00.00

-L- STA. 51+00.00
END STATE PROJECT U-0624

UNIVERSITY OF NORTH CAROLINA
TAX MAP 7.73J

UNIVERSITY OF NORTH CAROLINA
TAX MAP 7.73J

PROJECT REFERENCE NO. U-0624	SHEET NO. EC-8/CONST.4
RW SHEET NO.	
ROADWAY DESIGN ENGINEER	HYDRAULICS ENGINEER

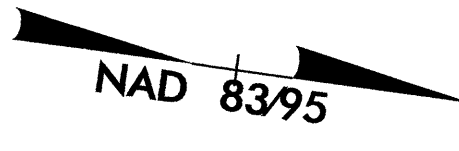

**-L- STA. 11+50.00
BEGIN STATE PROJECT U-624**

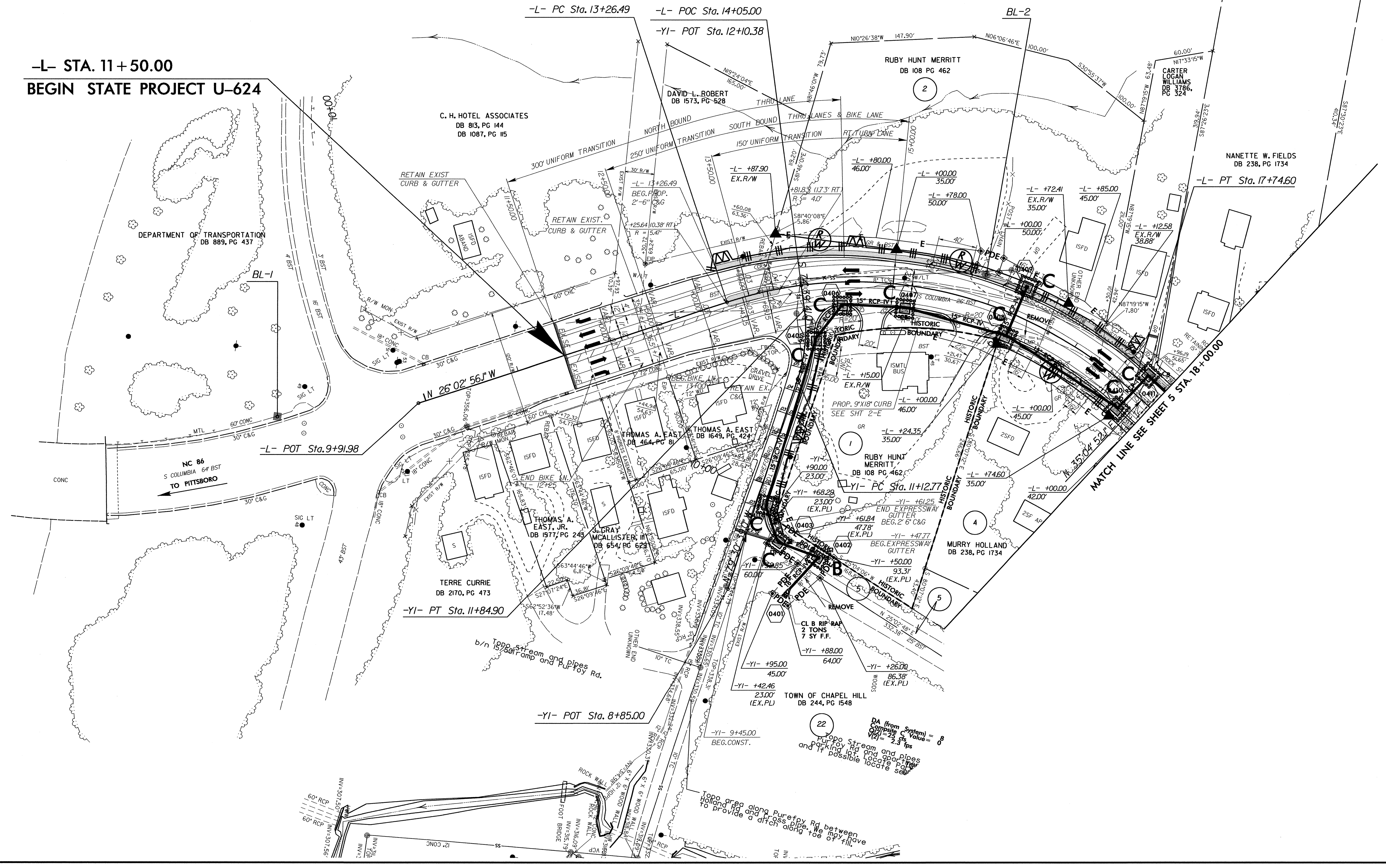

PROJECT REFERENCE NO. U-0624	SHEET NO. EC-9/CONST.5
RW SHEET NO.	
ROADWAY DESIGN ENGINEER	HYDRAULICS ENGINEER

NAD 8395

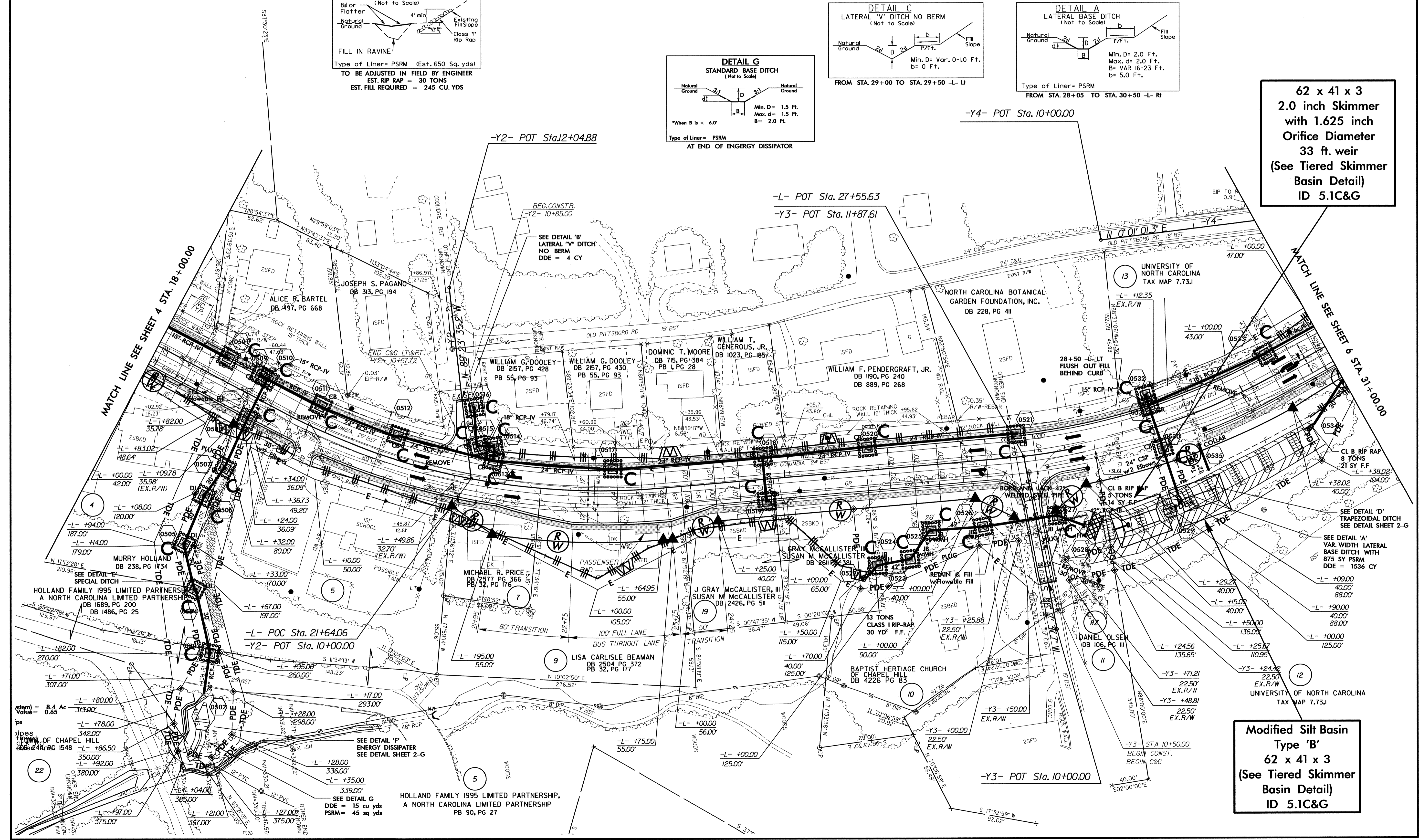
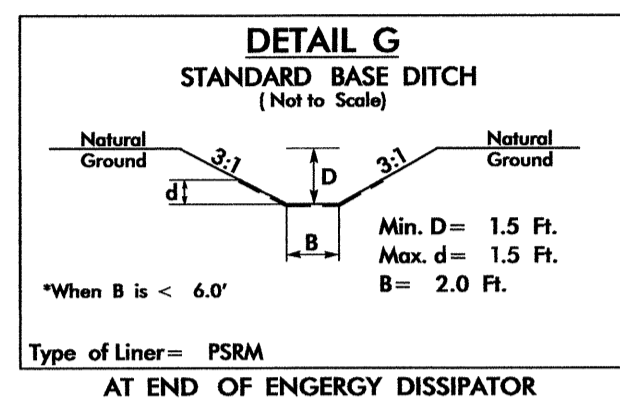
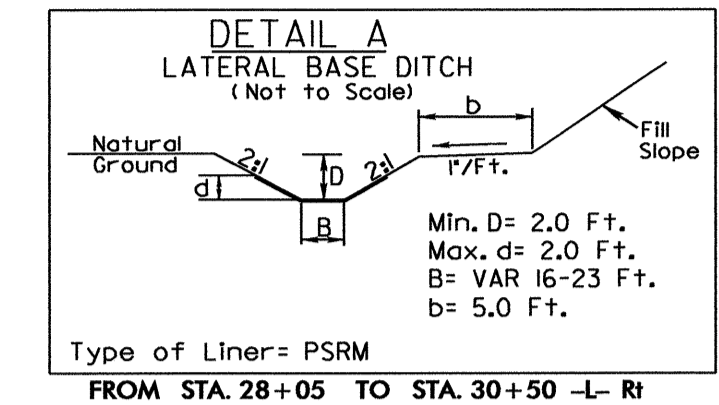
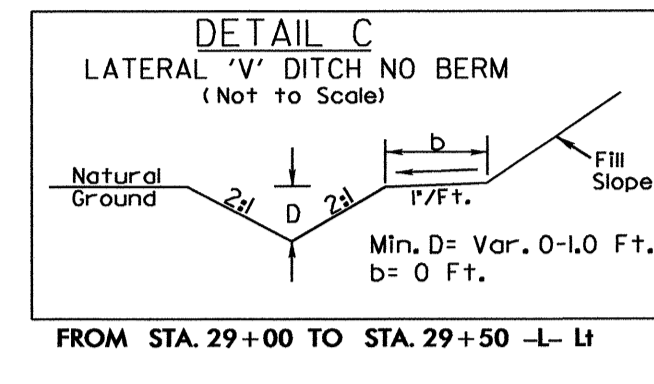
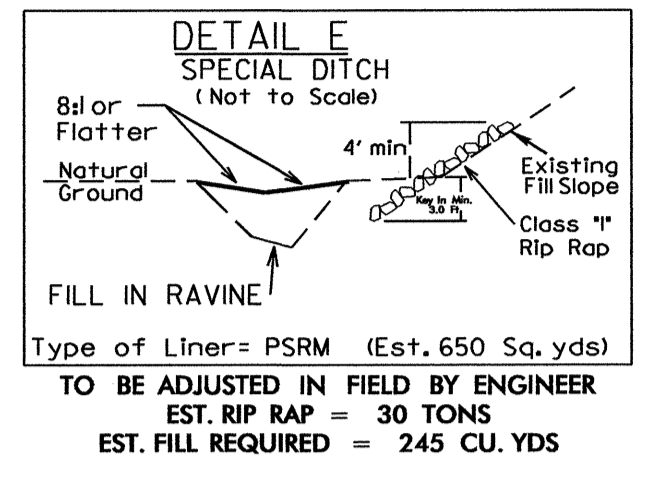
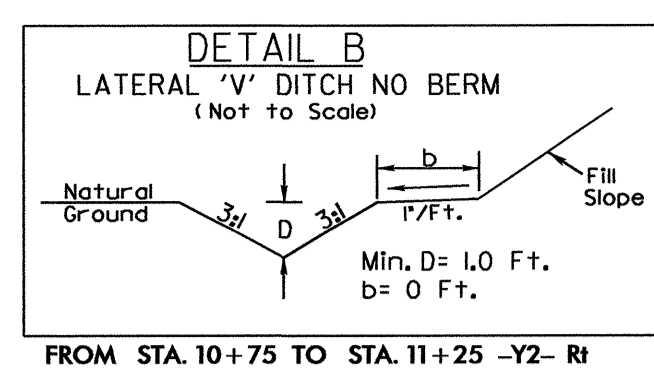

62 x 41 x 3
2.0 inch Skimmer
with 1.625 inch
Orifice Diameter
33 ft. weir
(See Tiered Skimmer
Basin Detail)
ID 5.1C&G

Modified Silt Basin
Type 'B'
62 x 41 x 3
(See Tiered Skimmer
Basin Detail)
ID 5.1C&G

8/17/99

PROJECT REFERENCE NO.		SHEET NO.	
U-0624		EC-10/CONST.6	
RW SHEET NO.			
ROADWAY DESIGN ENGINEER		HYDRAULICS ENGINEER	

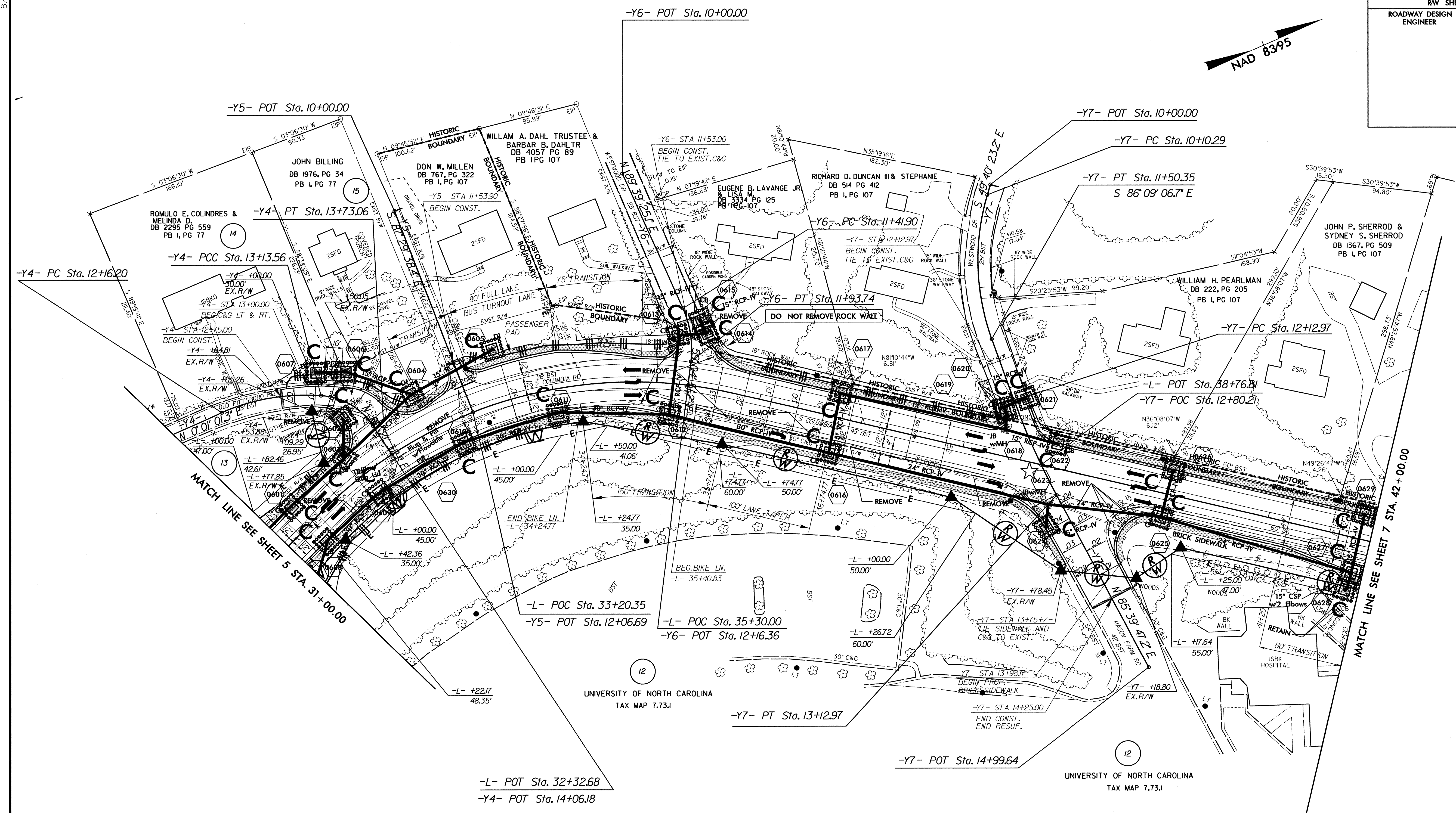

8/17/99

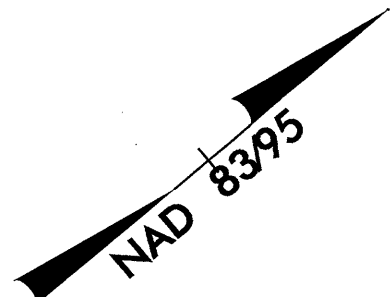

-L-	-Y8-	-Y9-	-Y9-	-Y9-
PI Sta 50+13.55 Δ = 11' 13" 57.6" (RT) D = 4' 16" 32.9" L = 262.70' T = 131.77' R = 1,340.00' SE = NC V = 40 mph	SE = N/A V = 40 mph	PI Sta 10+54.47 Δ = 24' 34" 59.6" (LT) D = 22' 55" 05.9" L = 107.26' T = 54.47' R = 250.00'	PI Sta 11+98.13 Δ = 4' 19" 17.2" (LT) D = 4' 24" 26.5" L = 98.05' T = 49.05' R = 1,300.00'	PI Sta 14+12.21 Δ = 19' 18" 21.8" (LT) D = 11' 27" 33.0" L = 168.48' T = 85.04' R = 500.00'

PROJECT REFERENCE NO. U-0624	SHEET NO. EC-11/CONST.7
RW SHEET NO.	
ROADWAY DESIGN ENGINEER	HYDRAULICS ENGINEER

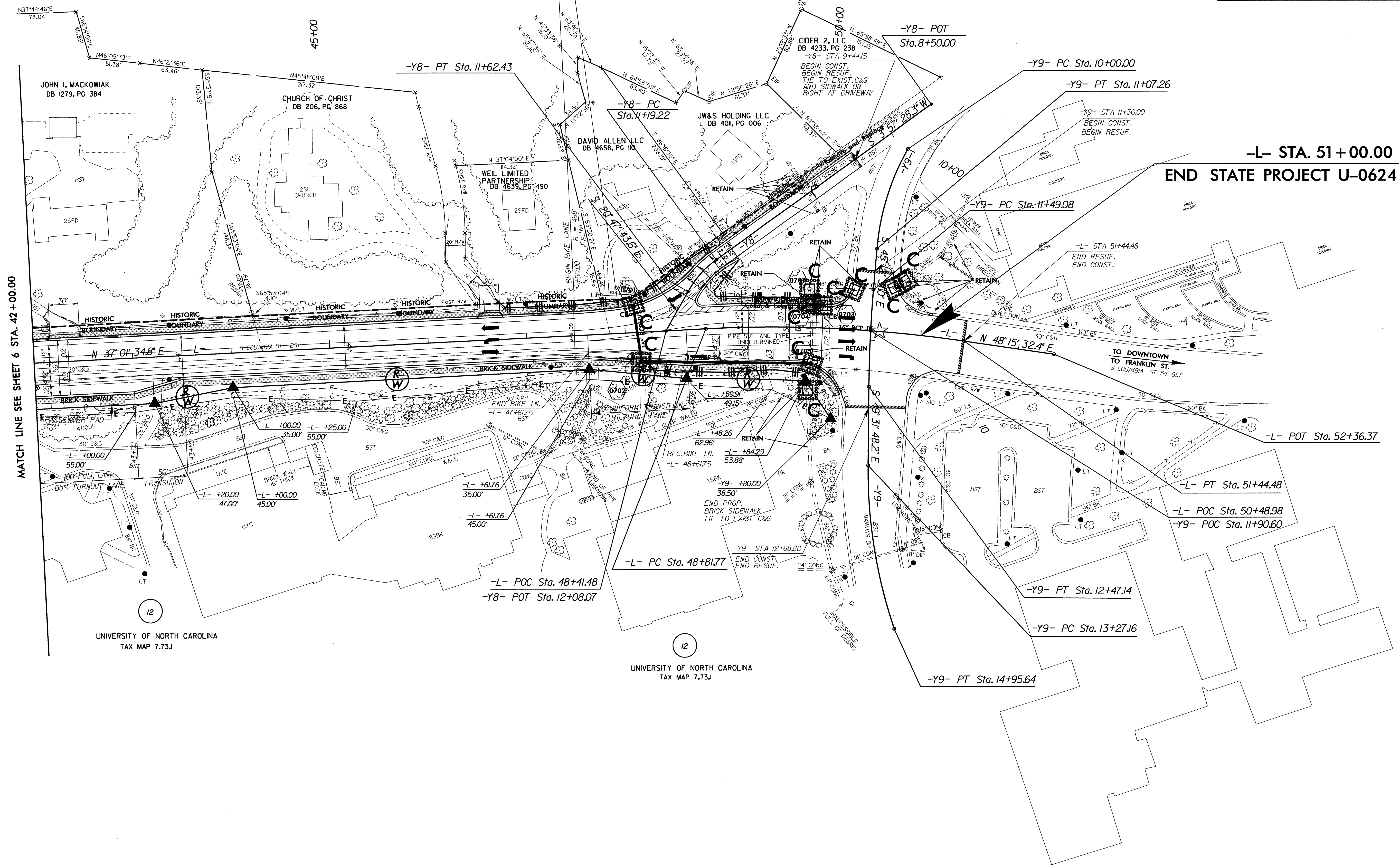

MATCH LINE SEE SHEET 6 STA. 42 + 00.00

-L- STA. 51 + 00.00
END STATE PROJECT U-0624

UNIVERSITY OF NORTH CAROLINA
TAX MAP 7.73.1

UNIVERSITY OF NORTH CAROLINA
TAX MAP 7.73.1