

STATE OF NORTH CAROLINA
DEPARTMENT OF TRANSPORTATION

TIP NO. U-2579G	SHEET NO. PMP-1
APPROVED: <i>[Signature]</i>	DATE: 6/29/12
SEAL 	

PAVEMENT MARKING PLAN
FORSYTH COUNTY

LOCATION: BRIDGE NO. 336 ON SR 2667 (HASTINGS HILL RD)
OVER I-40 BUS/US 421

ROADWAY STANDARD DRAWING

THE FOLLOWING ROADWAY STANDARDS AS APPEAR IN "ROADWAY STANDARD DRAWINGS" - PROJECT SERVICES UNIT - N.C. DEPARTMENT OF TRANSPORTATION - RALEIGH, N.C., DATED JANUARY 2012 ARE APPLICABLE TO THIS PROJECT AND BY REFERENCE HEREBY ARE CONSIDERED A PART OF THESE PLANS:

STD. NO.	TITLE
1205.01	PAVEMENT MARKINGS - LINE TYPES AND OFFSETS
1205.02	PAVEMENT MARKINGS - TWO-LANE AND MULTILANE ROADWAYS
1205.04	PAVEMENT MARKINGS - INTERSECTIONS
1205.05	PAVEMENT MARKINGS - TURN LANES
1205.09	PAVEMENT MARKINGS - PAINTED ISLANDS
1205.12	PAVEMENT MARKINGS - BRIDGES
1250.01	RAISED PAVEMENT MARKERS - INSTALLATION SPACING
1251.01	RAISED PAVEMENT MARKERS - PERMANENT AND TEMPORARY
1253.01	RAISED PAVEMENT MARKERS - SNOWPLOWABLE
1261.01	GUARDRAIL AND BARRIER DELINEATORS - INSTALLATION SPACING
1261.02	GUARDRAIL AND BARRIER DELINEATORS - TYPES AND MOUNTING
1262.01	GUARDRAIL END DELINEATION

PAVEMENT MARKING SCHEDULE

POLYUREA(4")	
V8	2 FT. - 6 FT./SP WHITE MINISKIP
VA	WHITE EDGELINE
VD	3 FT. - 9 FT./SP WHITE MINISKIP
VE	WHITE SOLID LANE LINE
VI	YELLOW DOUBLE CENTER
THERMOPLASTIC(24", 120 MILS)	
TZ	WHITE STOPBAR
THERMOPLASTIC(8", 90 MILS)	
TP	YELLOW DIAGONAL
THERMOPLASTIC PAVEMENT MARKING SYMBOLS (90 MILS)	
UA	LEFT TURN ARROW

GENERAL NOTES

- THE FOLLOWING GENERAL NOTES APPLY AT ALL TIMES FOR THE DURATION OF THE CONSTRUCTION PROJECT, EXCEPT WHEN OTHERWISE NOTED IN THE PLAN, OR DIRECTED BY THE ENGINEER.
- INSTALL PAVEMENT MARKINGS AND PAVEMENT MARKERS ON THE FINAL SURFACE AS FOLLOWS:

ROAD NAME	MARKING	MARKER
ALL	POLYUREA(EXCEPT AS LABELED THERMOPLASTIC)	NONE
 - TIE PROPOSED PAVEMENT MARKING LINES TO EXISTING PAVEMENT MARKING LINES. EXTEND BEYOND CONSTRUCTION LIMIT AS SHOWN.
 - REMOVE/REPLACE ANY CONFLICTING/DAMAGED PAVEMENT MARKINGS AND MARKERS. REMOVE EXISTING MARKING FOR NEW Y-LINE ALIGNMENT/TIE IN.
 - PASSING ZONES WILL BE DETERMINED IN THE FIELD AND MUST BE APPROVED BY THE ENGINEER.
 - STOP BAR LOCATION AT NON-SIGNALIZED INTERSECTIONS MAY BE ADJUSTED AS DIRECTED BY THE ENGINEER.
 - REMOVE ALL RESIDUE AND SURFACE LAITANCE BY ACCEPTABLE METHODS ON CONCRETE BRIDGE DECKS PRIOR TO PLACING (POLYUREA OR THERMOPLASTIC) PAVEMENT MARKING MATERIAL.
 - UNLESS OTHERWISE SPECIFIED, HEATED-IN-PLACE THERMOPLASTIC MAY BE USED IN LIEU OF EXTRUDED THERMOPLASTIC FOR STOP BARS, SYMBOLS, CHARACTERS AND DIAGONALS. IF HEATED-IN-PLACE IS USED, IT SHALL BE PAID FOR USING THE EXTRUDED THERMOPLASTIC PAY ITEM.

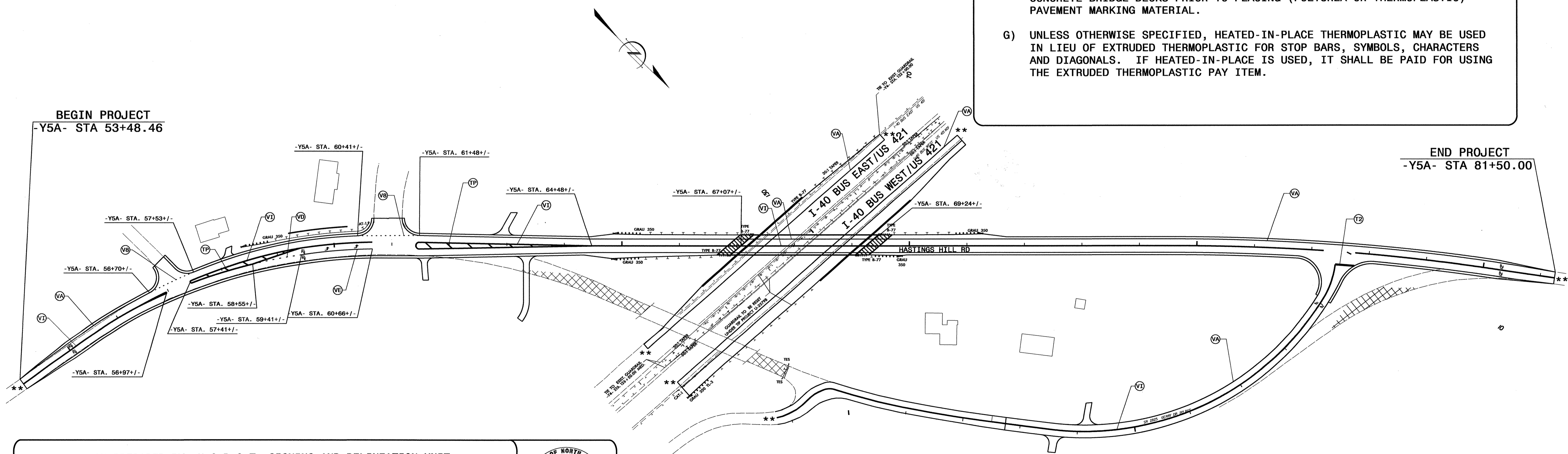

PLAN PREPARED BY: N.C.D.O.T. SIGNING AND DELINEATION UNIT
 SUSAN B. KUNZ SIGNING & DELINEATION REGIONAL ENGINEER
 SAMUEL COLEMAN SIGNING & DELINEATION PROJECT DESIGN ENGINEER

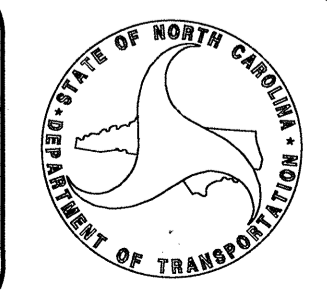

** TIE TO EXISTING

27-JUN-2012 17:43 P:\TIP\Projects\U-2579G\Traffic\Signing\PM\ Pavement Marking Seed 4-12-12.dgn
Scoleman AT 12/24/12

CONTRACT: 203015 T.I.P.: U-2579G