

STATE OF NORTH CAROLINA
DIVISION OF HIGHWAYS

PROJ. REFERENCE NO.	SHEET NO.
B-3861	X-1

CROSS-SECTION SUMMARY

NOTE: EMBANKMENT COLUMN DOES NOT INCLUDE BACKFILL FOR UNDERCUT

Station	Uncl. Exc.	Embt
DETOUR	(cu. yd.)	(cu. yd.)
10+10.38	0	0
10+21.36	1	24
10+46.36	0	264
10+60.00	0	205
Station	Uncl. Exc.	Embt
DETOUR	(cu. yd.)	(cu. yd.)
11+95.04	0	0
12+04.93	0	71
12+51.71	1	305
12+83.44	3	138
13+08.54	1	36
13+26.30	1	1
Station	Uncl. Exc.	Embt
L	(cu. yd.)	(cu. yd.)
10+10.38	0	0
10+25.00	3	3
10+25.75	1	1
Station	Uncl. Exc.	Embt
L	(cu. yd.)	(cu. yd.)
11+83.78	0	0
12+00.00	16	1
12+25.00	29	1
12+50.00	19	1
12+67.99	1	1
Station	Uncl. Exc.	Embt
DETOUR	(cu. yd.)	(cu. yd.)
REMOVAL		
10+10.38	0	0
10+21.36	25	0
10+46.36	230	0
10+60.00	190	0
Station	Uncl. Exc.	Embt
DETOUR	(cu. yd.)	(cu. yd.)
REMOVAL		
11+95.04	0	0
12+04.93	71	0
12+51.71	284	0
12+83.44	114	0
13+08.54	28	0

Approximate quantities only. Unclassified excavation, borrow excavation, fine grading, clearing and grubbing, and removal of existing pavement will be paid for at the lump sum price for "Grading".

8/23/99

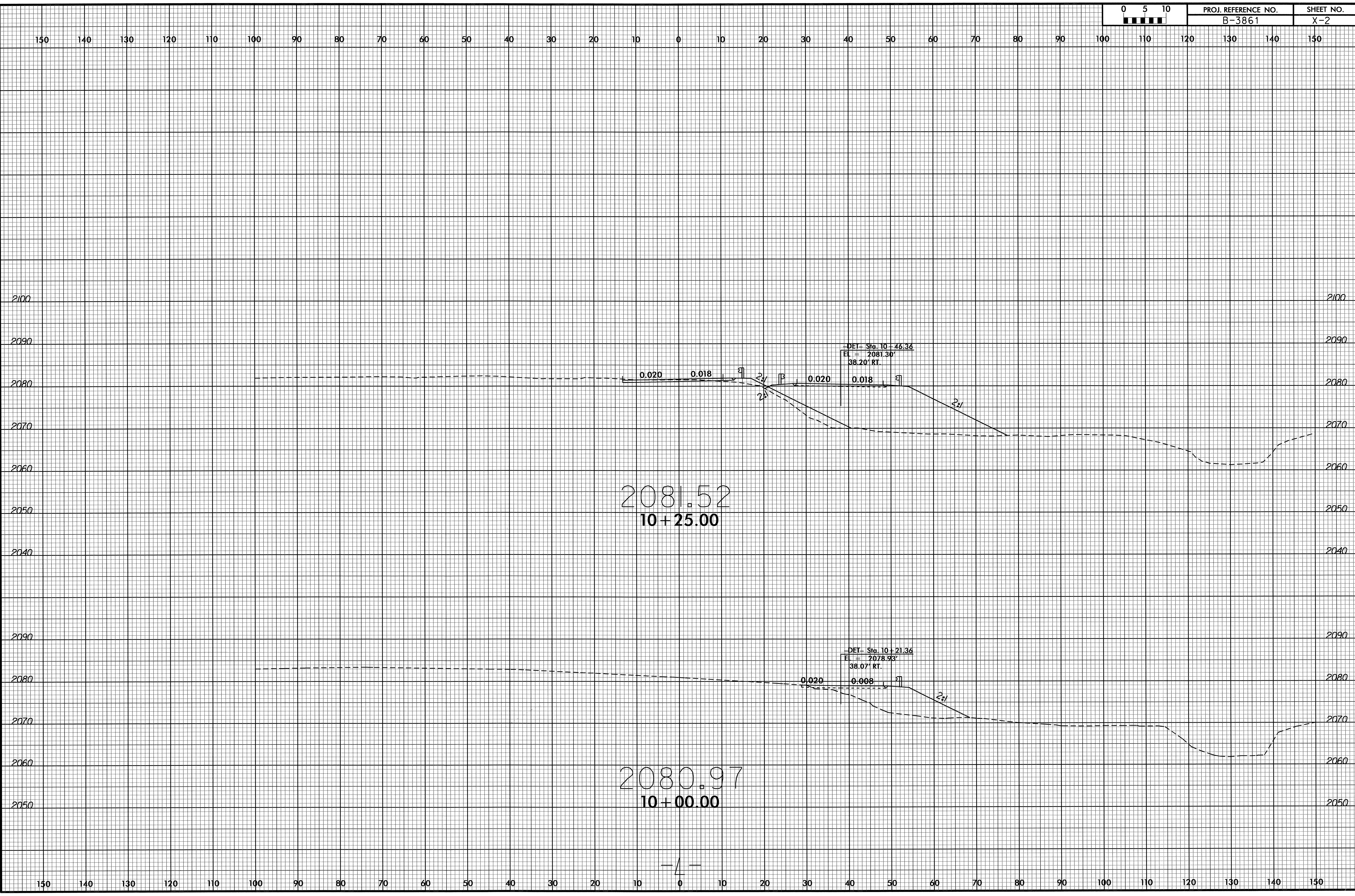

14-MAR-2012 14:55
R:\Roadwork\XSC\B-3861_ALL_xpl.dgn
\$\$\$\$USERNAME\$\$\$\$

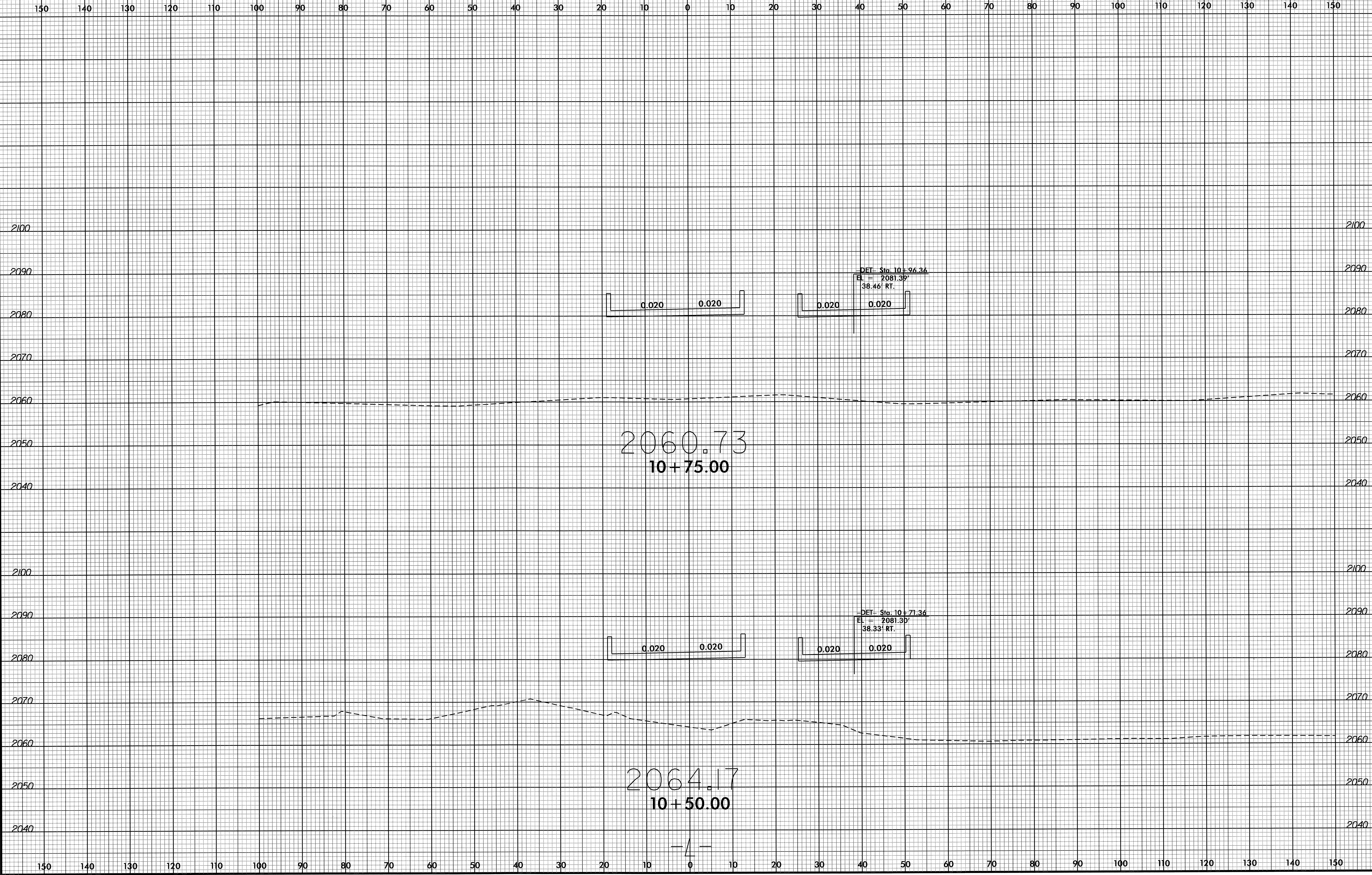

8/23/99

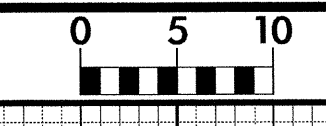

PROJ. REFERENCE NO. B-3861	SHEET NO. X-4
-------------------------------	------------------

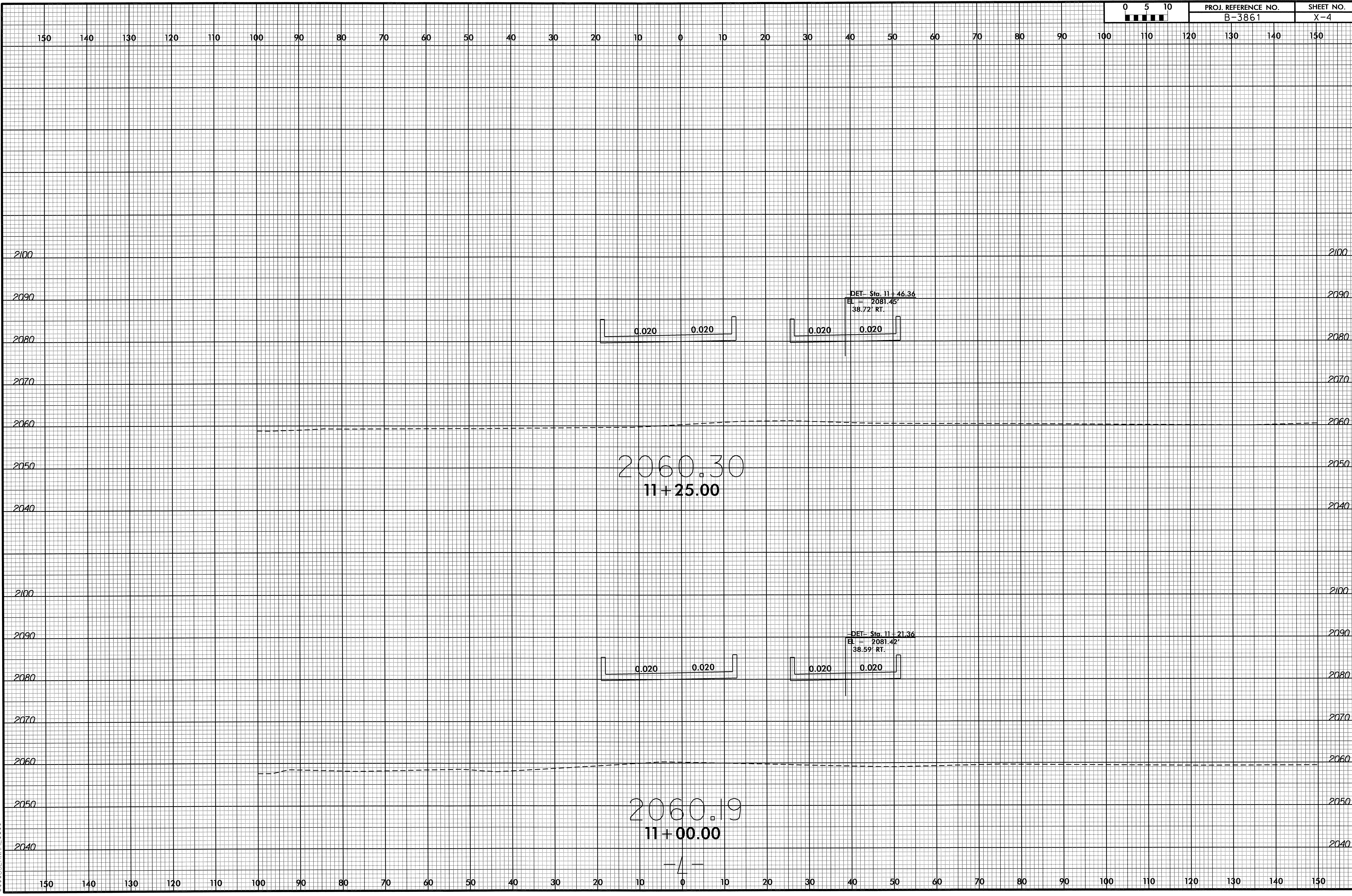

14-MAR-2012 14:56
 P:\Roadwork\X500\B-3861-ALL-XP1.dgn
 \$\$\$USERNAME\$\$\$

8/23/99

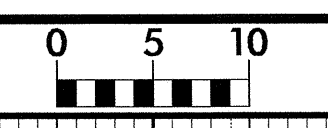

PROJ. REFERENCE NO.	SHEET NO.
B-3861	X-5

150 140 130 120 110 100 90 80 70 60 50 40 30 20 10 0 10 20 30 40 50 60 70 80 90 100 110 120 130 140 150

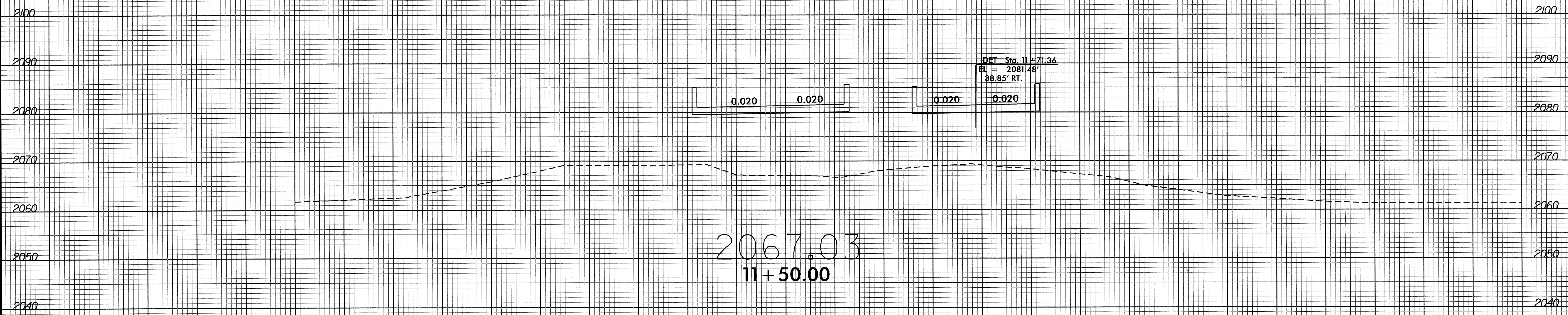
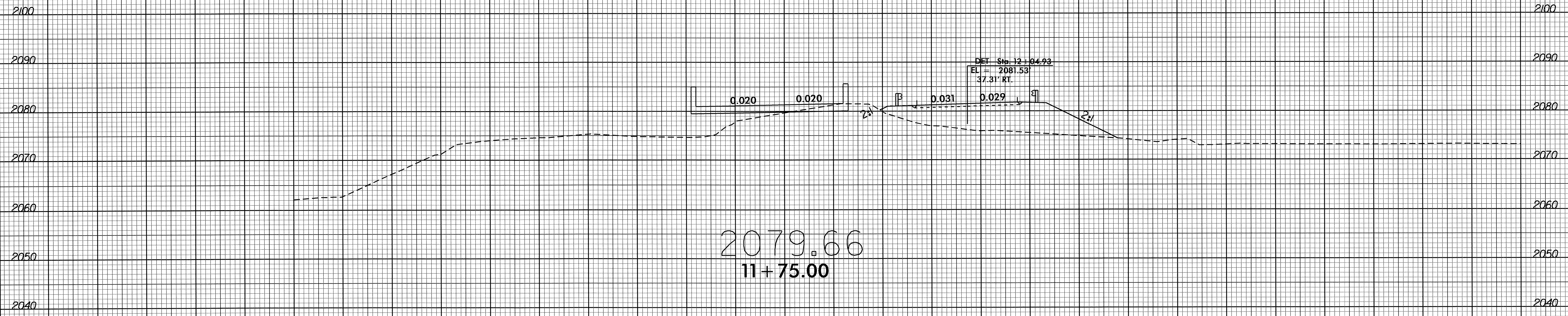

150 140 130 120 110 100 90 80 70 60 50 40 30 20 10 0 10 20 30 40 50 60 70 80 90 100 110 120 130 140 150

21-MAR-2012 09:34
R:\Roadwork\XSC\B-3861-ALL.dgn
\$\$\$\$\$

8/23/99

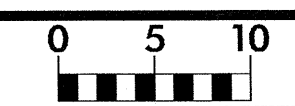

PROJ. REFERENCE NO.	SHEET NO.
B-3861	X-6

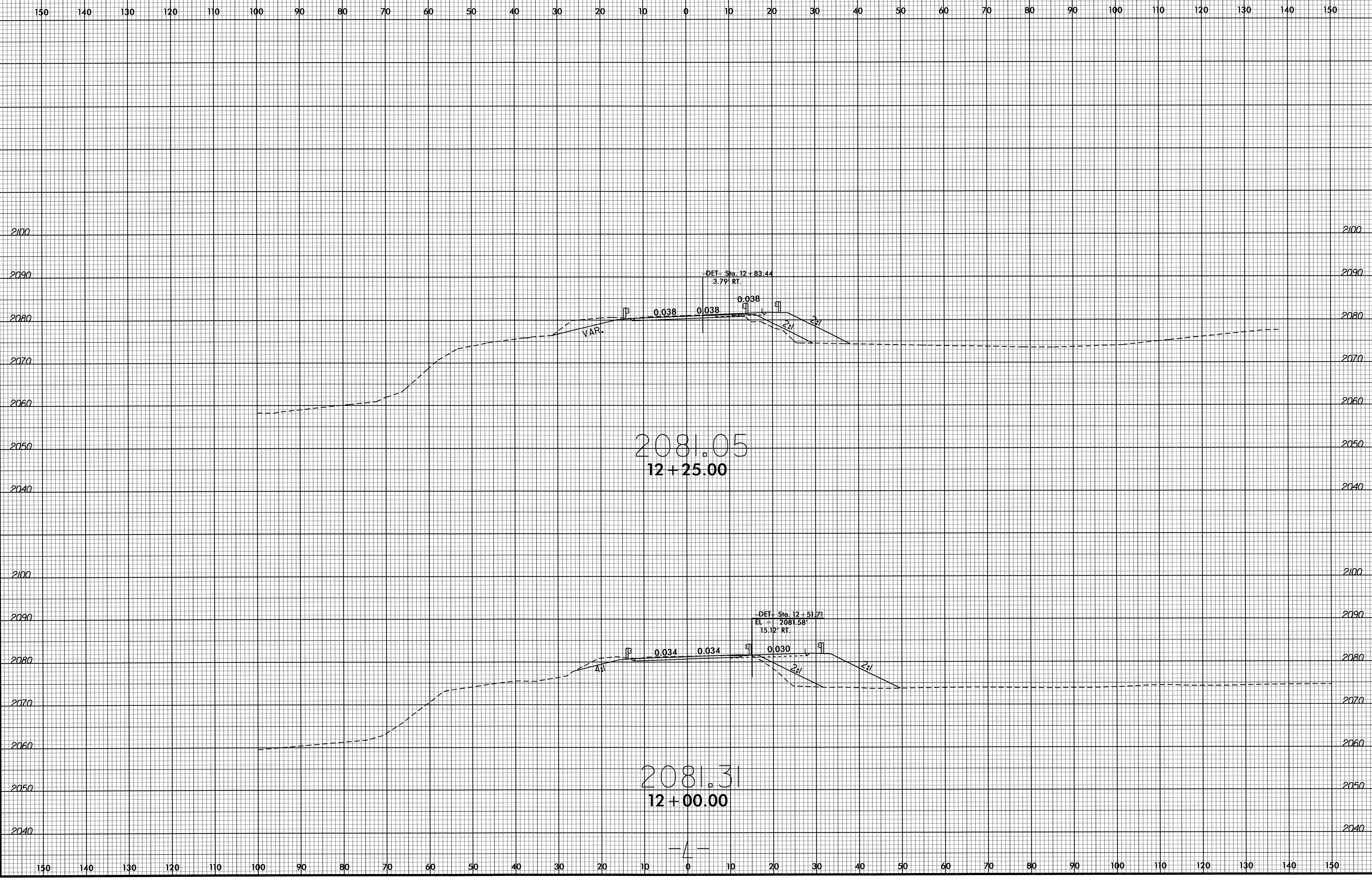

21-MAR-2012 09:34
 R:\Roadway\XSC\B-3861-ALL_xpl.dgn
 \$\$\$USERNAM\$\$\$\$

8/23/99

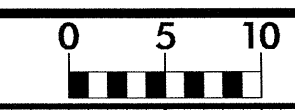

PROJ. REFERENCE NO.
B-3861

SHEET NO.
X-7

150 140 130 120 110 100 90 80 70 60 50 40 30 20 10 0 10 20 30 40 50 60 70 80 90 100 110 120 130 140 150

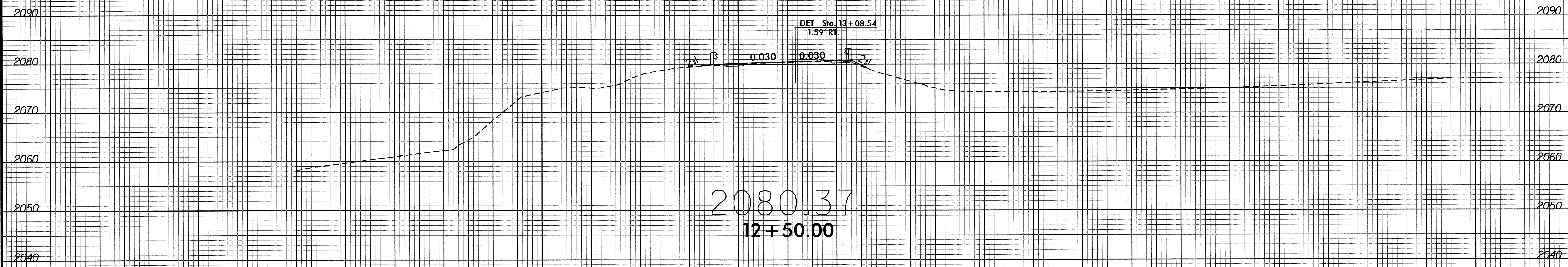

23-APR-2002 14:03
R:\Roadwork\XSC\B-3861-ALL.xpl.dgn
\$\$\$\$\$USERNAME\$\$\$\$

150 140 130 120 110 100 90 80 70 60 50 40 30 20 10 0 10 20 30 40 50 60 70 80 90 100 110 120 130 140 150