

# SHELBY

## CLEVELAND COUNTY NORTH CAROLINA

12CR.10231.11  
12CR.20231.14



BUS  
74

74

16

18

74

1253

1121

.10

2

Shelby Middle Sch

Graham Elem Sch

Ch of the Redeemer

Church of Christ

Church of God

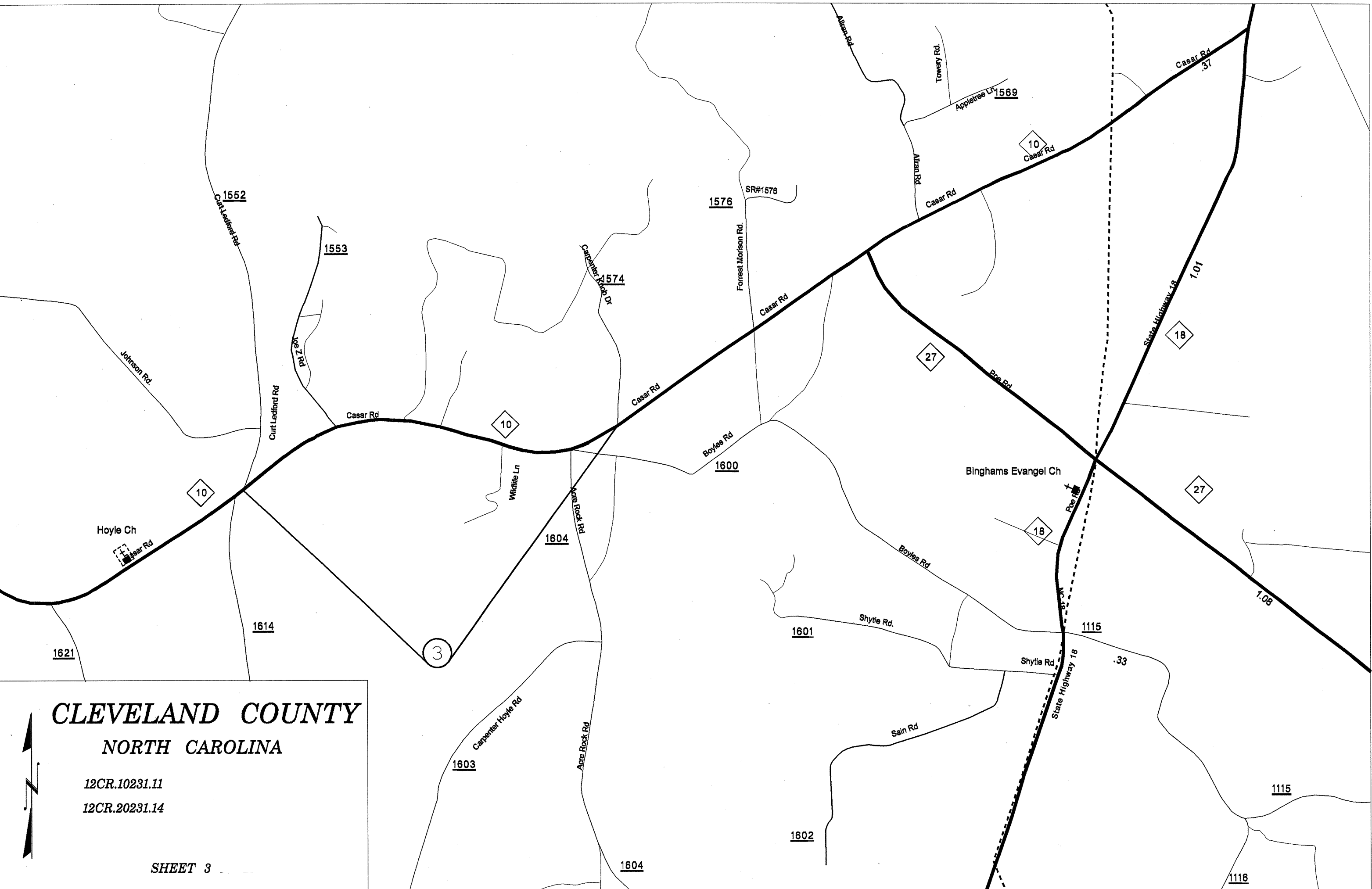

# CLEVELAND COUNTY

## NORTH CAROLINA

12CR.10231.11  
12CR.20231.14

SHEET 3





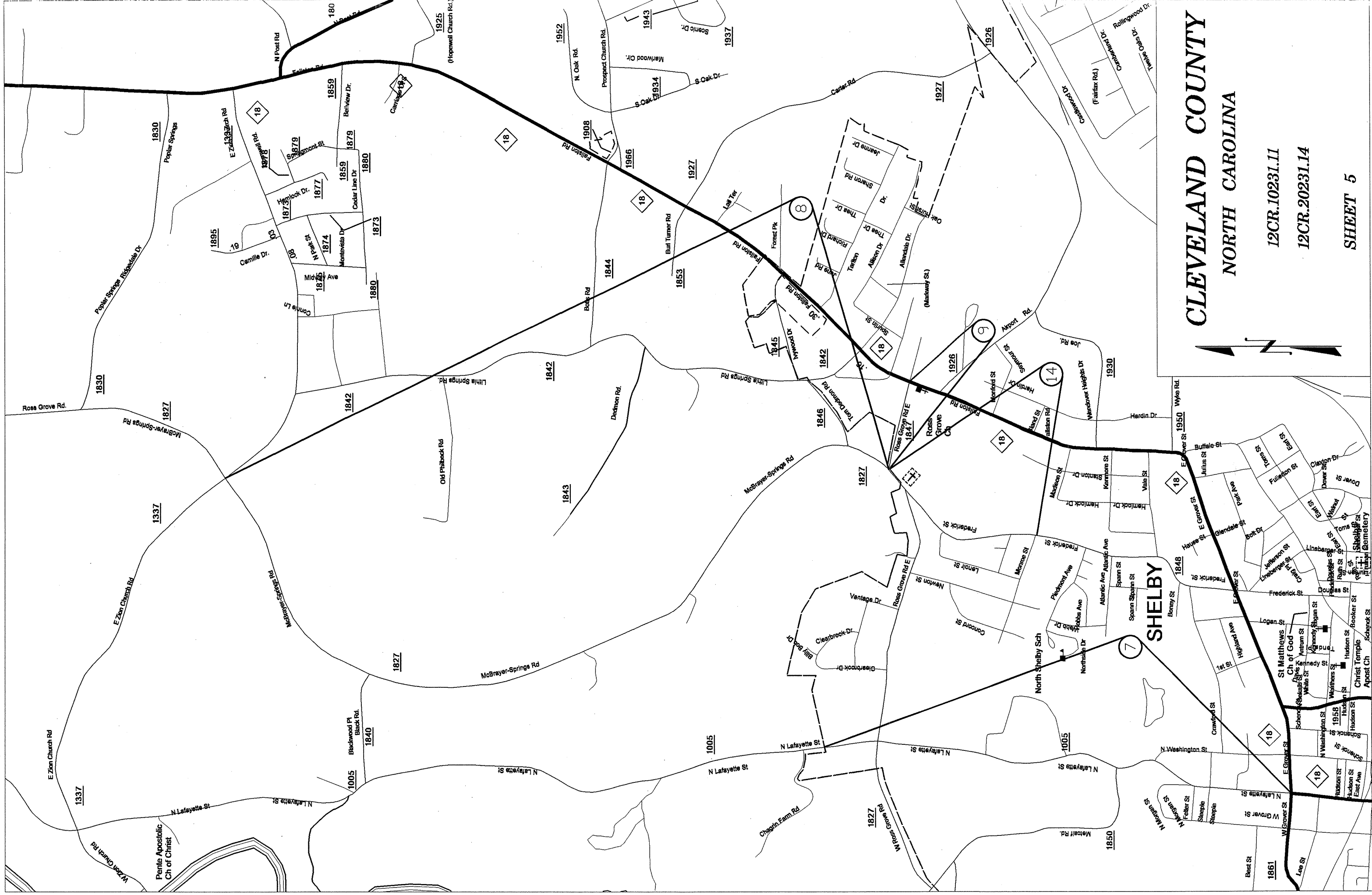

CLEVELAND COUNTY  
NORTH CAROLINA



12CR.10231.11

12CR.20231.14

SHEET 5

# CLEVELAND COUNTY NORTH CAROLINA

12CR.10231.11

12CR.20231.14

SHEET 6

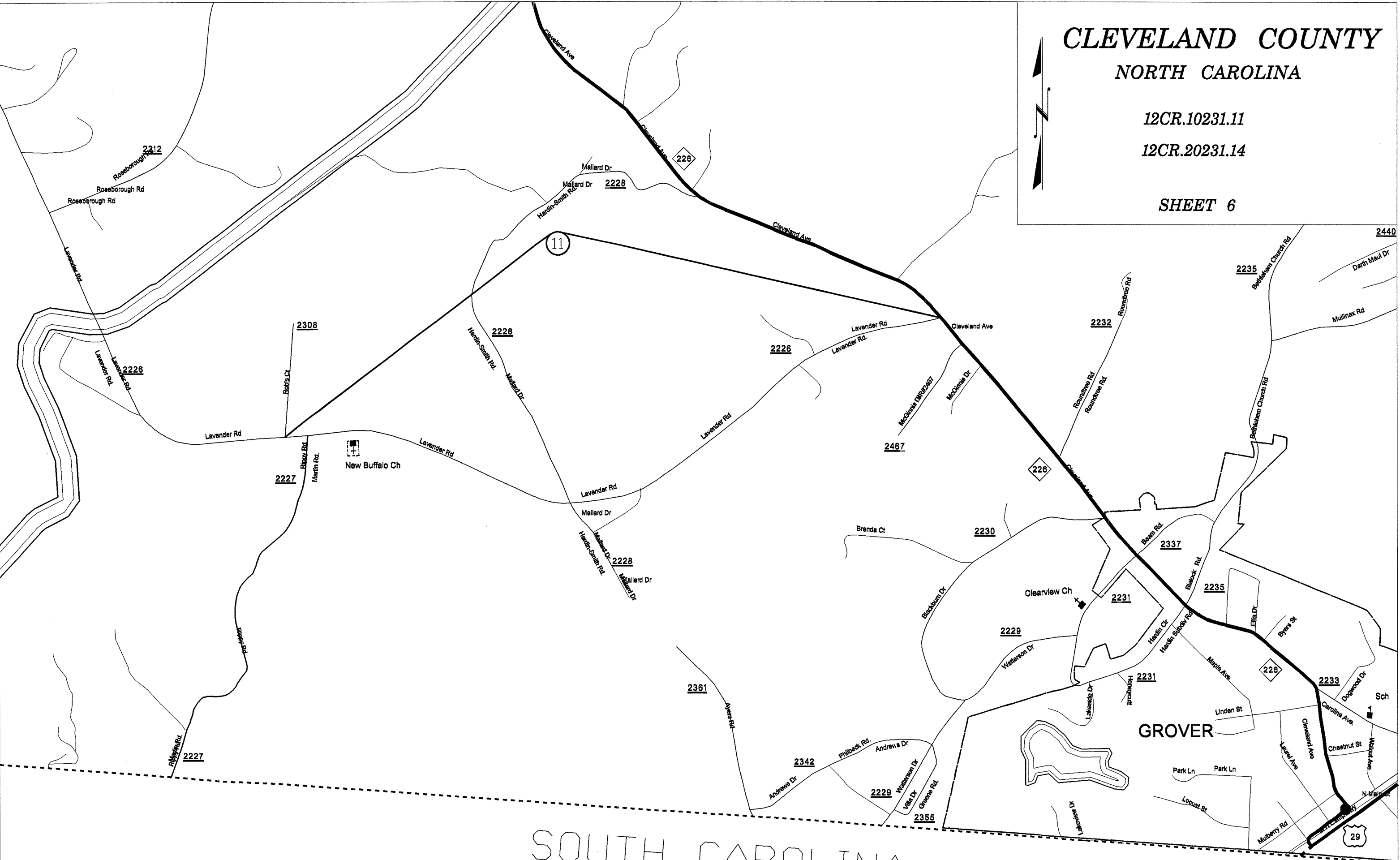

SOUTH CAROLINA

GROVER





**CLEVELAND COUNTY**  
**NORTH CAROLINA**

12CR.10231.11  
 12CR.20231.14  
 SHEET 7

# CLEVELAND COUNTY NORTH CAROLINA

12CR.10231.11  
12CR.20231.14

SHEET 8

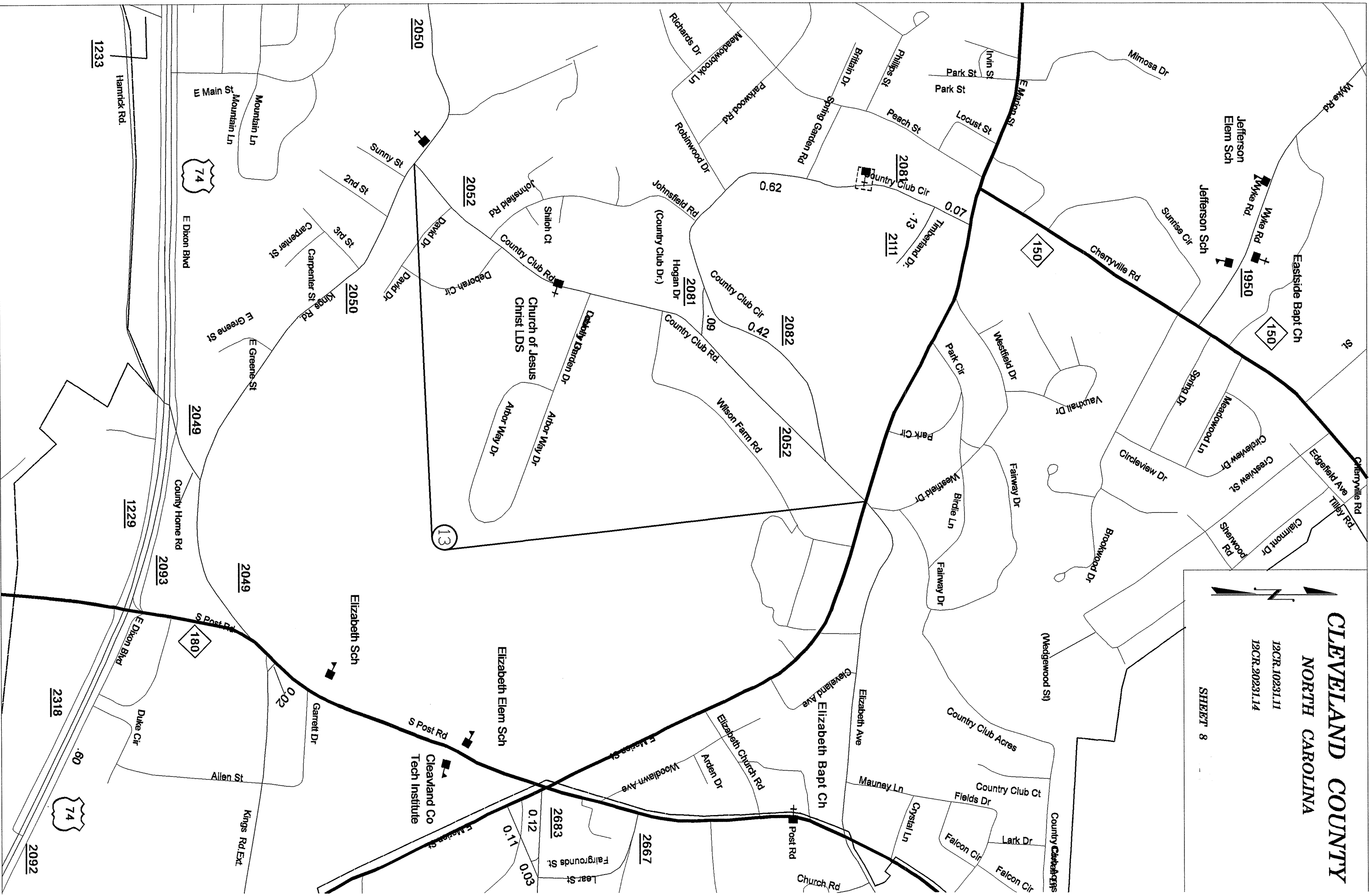





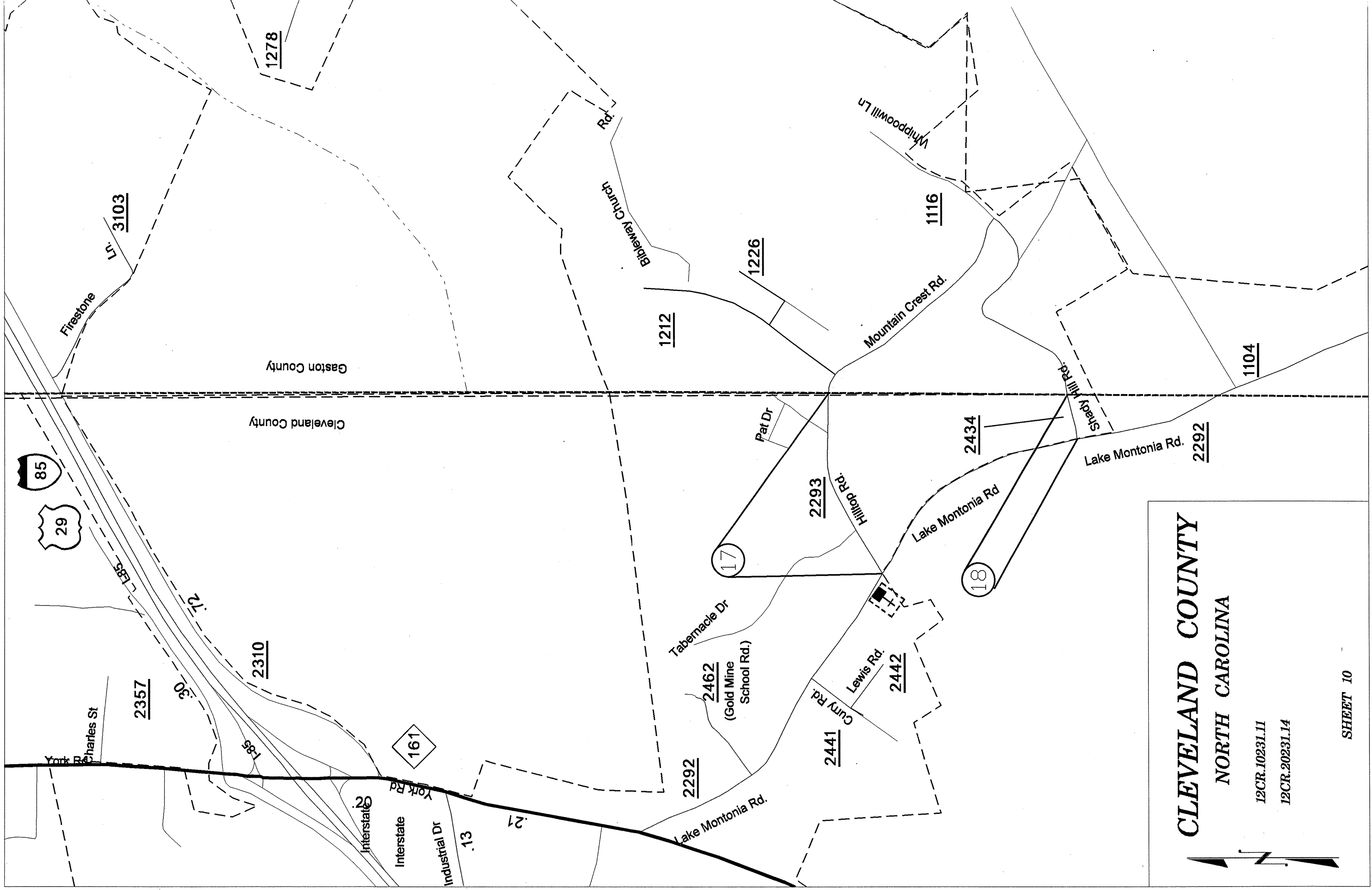

**CLEVELAND COUNTY**  
**NORTH CAROLINA**  
 12CR.10231.11  
 12CR.20231.14  
 SHEET 10

PROJ. REFERENCE NO.	SHEET NO.	TOTAL SHEETS
CLEVELAND CO. 2012-2013	11	
STATE PROJ. NO.	F. A. PROJ. NO.	DESCRIPTION
12CR.10231.11		
12CR.20231.14		

PAVEMENT SCHEDULE	
Y	SHOULDER RECONSTRUCTION
C1	PROP. APPROX. 1½" ASPHALT CONCRETE SURFACE COURSE, TYPE S9.5B, AT AN AVERAGE RATE OF 168 LBS. PER SQ. YD.
E1	PROP. APPROX. 5.5" ASPHALT CONCRETE BASE COURSE, TYPE B25.0B, AT AN AVERAGE RATE OF 627 LBS. PER SQ. YD.
V1	MILL ASPHALT PAVEMENT APPROX. 1½" TO 0" (LANE WIDTH ALONG CURB AS DIRECTED BY THE ENGINEER)
V2	MILL ASPHALT PAVEMENT APPROX. 1½" TO 3" (LANE WIDTH ALONG CURB AS DIRECTED BY THE ENGINEER)

NOTE: PAVEMENT EDGE SLOPES ARE 1:1 UNLESS SHOWN OTHERWISE.

MILL BRIDGE APPROACHES 100' TO PROVIDE A SMOOTH TRANSITION AS DIRECTED.

MILL INTO GUTTER LINE WHERE SHOWN AND AS DIRECTED.

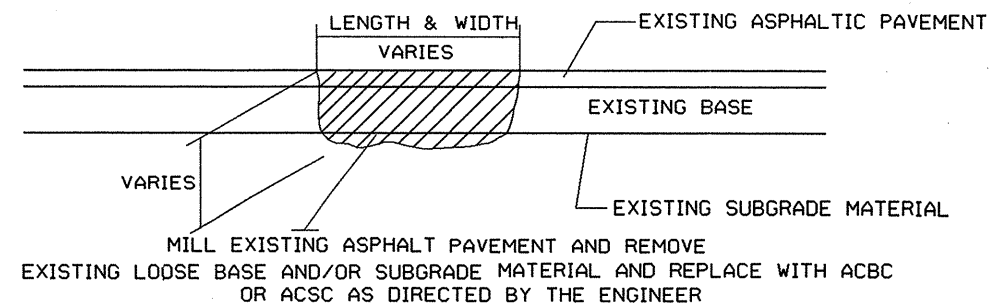
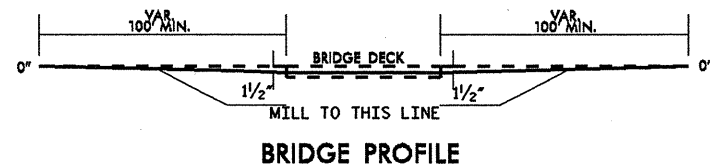

**PATCHING EXISTING PAVEMENT**

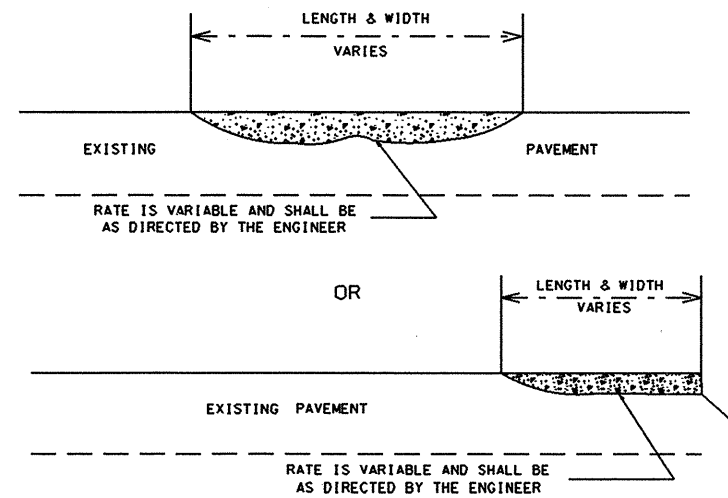

ASPHALT CONCRETE SURFACE COURSE  
TYPE S9.5B. (LEVELING COURSE)

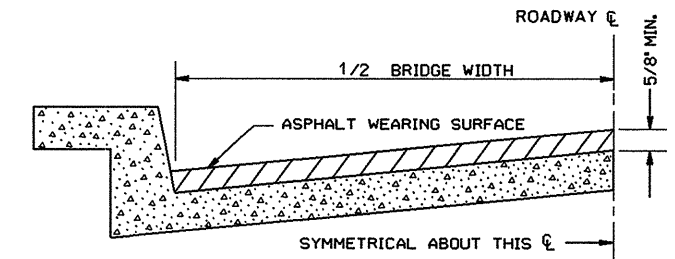

BRIDGE HALF TYPICAL SECTION

FOR BRIDGES WITH FLOOR DRAINS, CARE SHALL BE EXERCISED IN PLACING THE WEARING SURFACE AROUND FLOOR DRAINS SO AS NOT TO HINDER EFFECTIVE DRAINAGE. ALL DRAINS SHALL BE LEFT OPEN.

THE PROPOSED WEARING SURFACE SHALL VARY IN THICKNESS AS NECESSARY TO PROVIDE A SMOOTH RIDING SURFACE. A THICKNESS OF NOT LESS THAN 5/8" SHALL BE PROVIDED. THE MAXIMUM THICKNESS SHALL PREFERABLY BE 1-1/2" UNLESS IT IS IMPRACTICAL TO PROVIDE A SMOOTH RIDING SURFACE OTHERWISE.

**NOTES**

ALL UNPAVED S.R. ROADS TO BE SURFACED 50' FROM EDGE OF PAVEMENT OF MAIN PROJECT.  
ALL PAVED S.R. ROADS TO BE RESURFACED TO THE ENDS OF THE RADII, OR AS DIRECTED BY THE ENGINEER.  
EDGES, PAVEMENT WIDENING, INTERSECTIONS AND BRIDGE FLARES ARE INCLUDED IN THE TABLE OF QUANTITIES.  
SHOULDERS AND DITCHES ARE TO BE CONSTRUCTED BY OTHERS UNLESS OTHERWISE NOTED.  
BRIDGES TO BE RESURFACED AT LOCATIONS AND TO DEPTH AS DIRECTED BY THE ENGINEER.

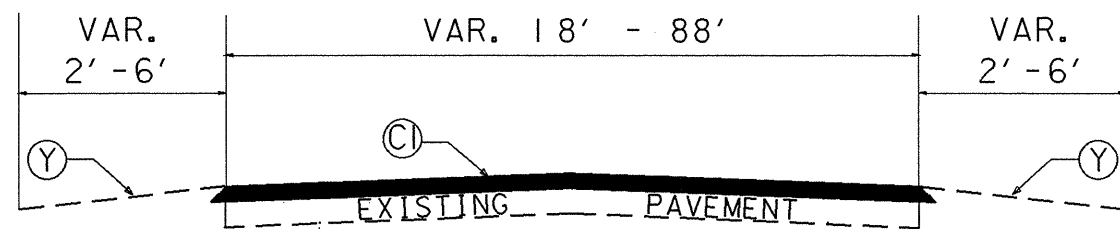

TYPICAL SECTION NO. 1

(Maps 2, 3, 7, 10, 16)

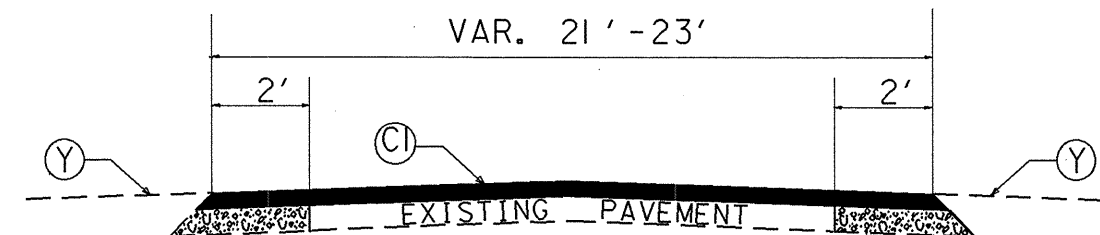

TYPICAL SECTION NO. 3

(Maps 4, 5, 6, 11, 12)

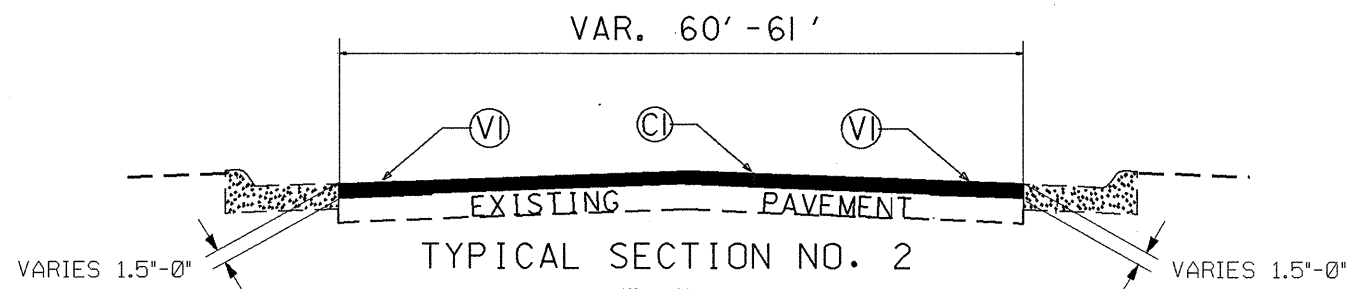

TYPICAL SECTION NO. 2

(Map 1)

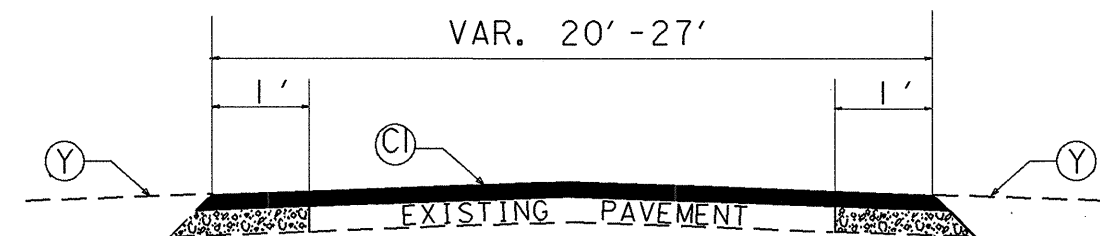

TYPICAL SECTION NO. 4

(Maps 8, 9, 13, 14, 15)

PROJ. REFERENCE NO.	SHEET NO.	TOTAL SHEETS
CLEVELAND CO. 2012-2013	12	
STATE PROJ. NO.	F. A. PROJ. NO.	DESCRIPTION
12CR.10231.11		
12CR.20231.14		

PAVEMENT SCHEDULE	
Y	SHOULDER RECONSTRUCTION
C1	PROP. APPROX. 1½" ASPHALT CONCRETE SURFACE COURSE, TYPE S9.5B, AT AN AVERAGE RATE OF 168 LBS. PER SQ. YD.
E1	PROP. APPROX. 5.5" ASPHALT CONCRETE BASE COURSE, TYPE B25.0B, AT AN AVERAGE RATE OF 627 LBS. PER SQ. YD.
V1	MILL ASPHALT PAVEMENT APPROX. 1½" TO 0" (LANE WIDTH ALONG CURB AS DIRECTED BY THE ENGINEER)
V2	MILL ASPHALT PAVEMENT APPROX. 1½" TO 3" (LANE WIDTH ALONG CURB AS DIRECTED BY THE ENGINEER)

NOTE: PAVEMENT EDGE SLOPES ARE 1:1 UNLESS SHOWN OTHERWISE.

MILL BRIDGE APPROACHES 100' TO PROVIDE A SMOOTH TRANSITION AS DIRECTED.

MILL INTO GUTTER LINE WHERE SHOWN AND AS DIRECTED.

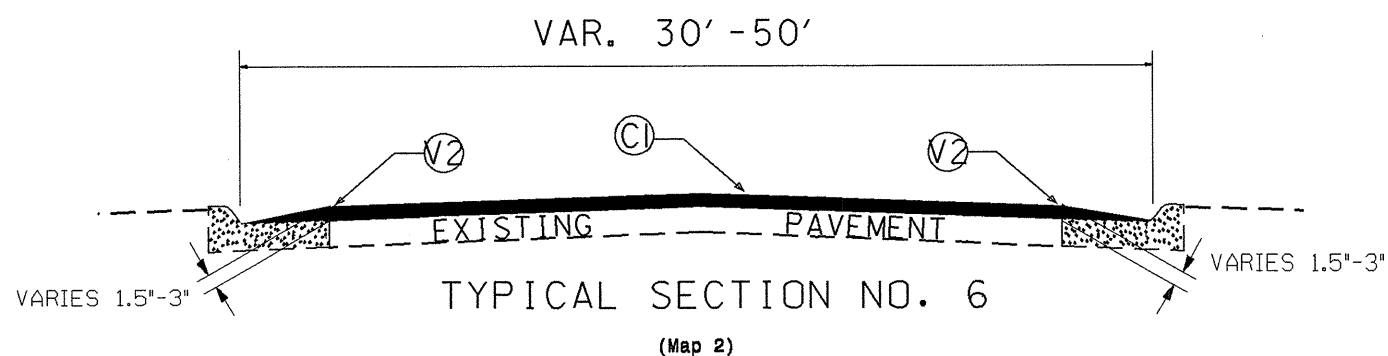
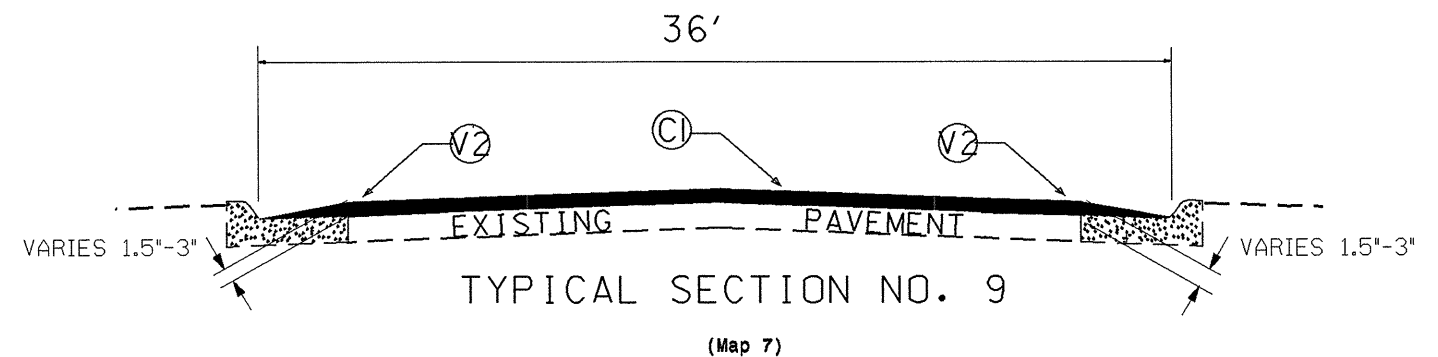
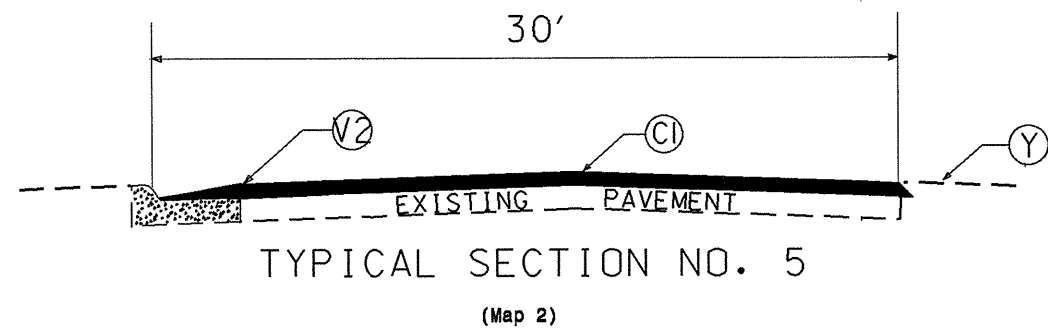
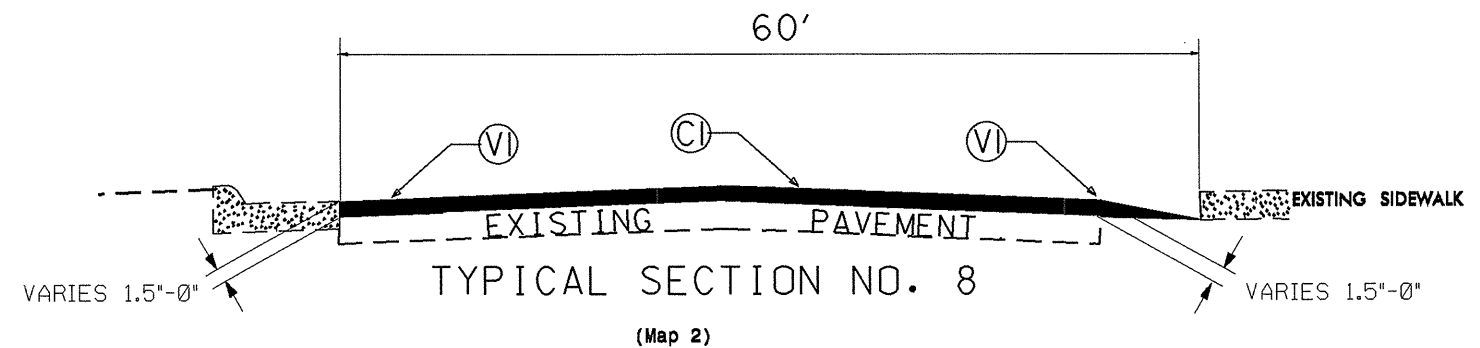
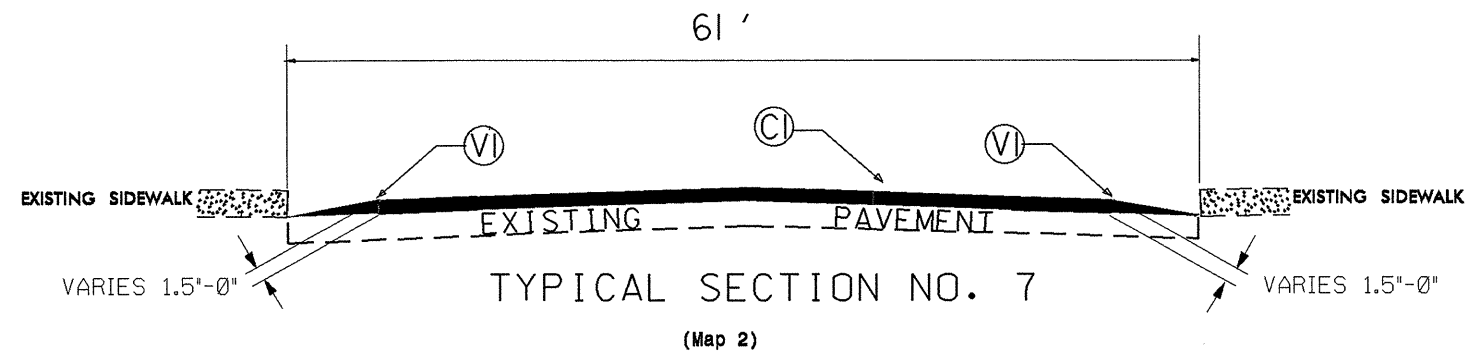

PROJ. REFERENCE NO.	SHEET NO.	TOTAL SHEETS
CLEVELAND CO. 2012-2013	13	
STATE PROJ. NO.	F. A. PROJ. NO.	DESCRIPTION
12CR.10231.11		
12CR.20231.14		

PAVEMENT SCHEDULE	
Y	SHOULDER RECONSTRUCTION
C1	PROP. APPROX. 1½" ASPHALT CONCRETE SURFACE COURSE, TYPE S9.5B, AT AN AVERAGE RATE OF 168 LBS. PER SQ. YD.
E1	PROP. APPROX. 5.5" ASPHALT CONCRETE BASE COURSE, TYPE B25.0B, AT AN AVERAGE RATE OF 627 LBS. PER SQ. YD.
V1	MILL ASPHALT PAVEMENT APPROX. 1½" TO 0" (LANE WIDTH ALONG CURB AS DIRECTED BY THE ENGINEER)
V2	MILL ASPHALT PAVEMENT APPROX. 1½" TO 3" (LANE WIDTH ALONG CURB AS DIRECTED BY THE ENGINEER)

NOTE: PAVEMENT EDGE SLOPES ARE 1:1 UNLESS SHOWN OTHERWISE.

MILL BRIDGE APPROACHES 100' TO PROVIDE A SMOOTH TRANSITION AS DIRECTED.

MILL INTO GUTTER LINE WHERE SHOWN AND AS DIRECTED.

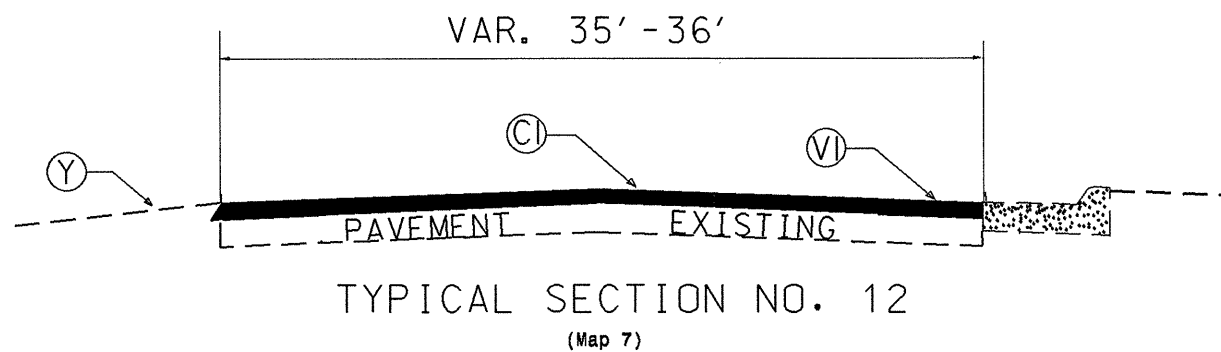
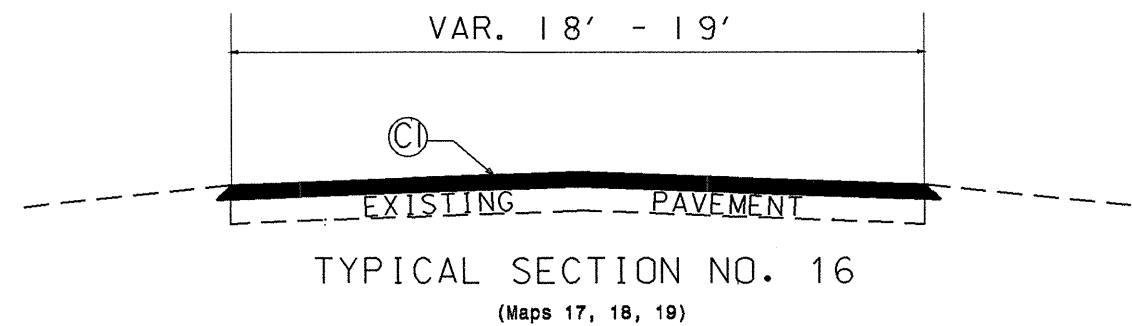
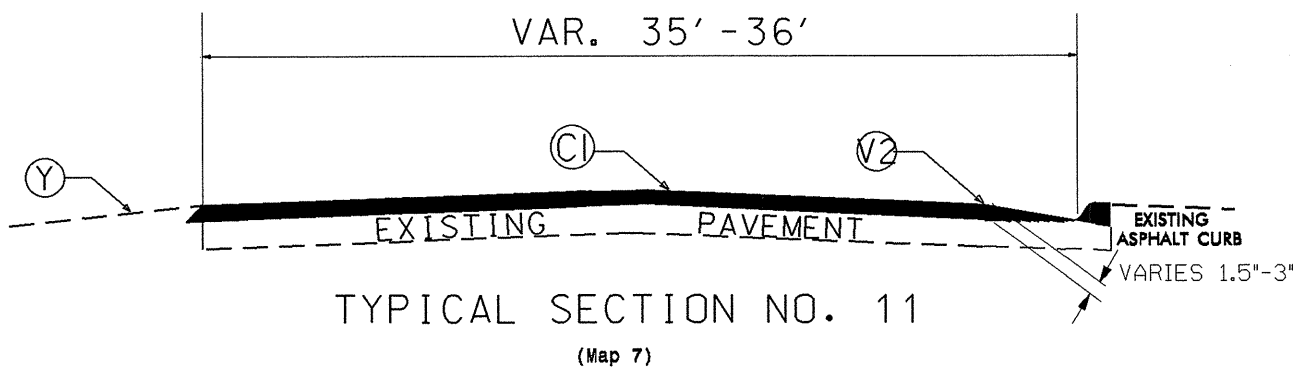
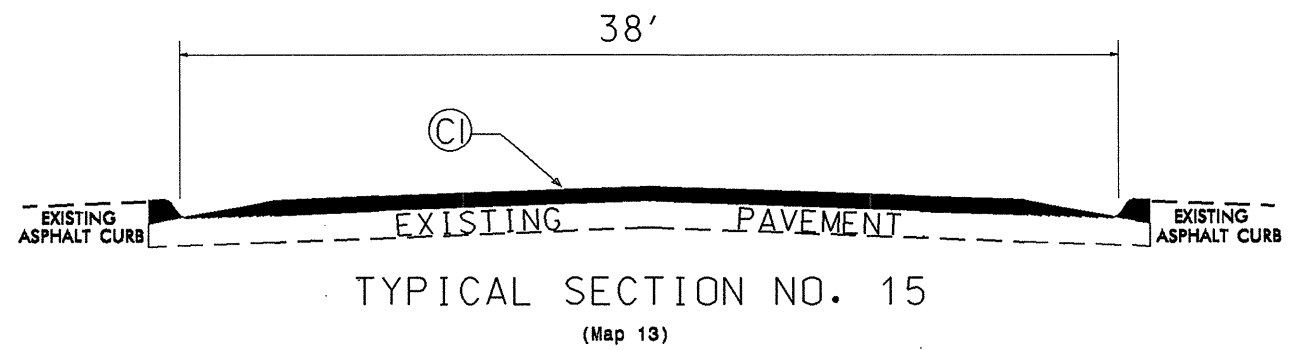
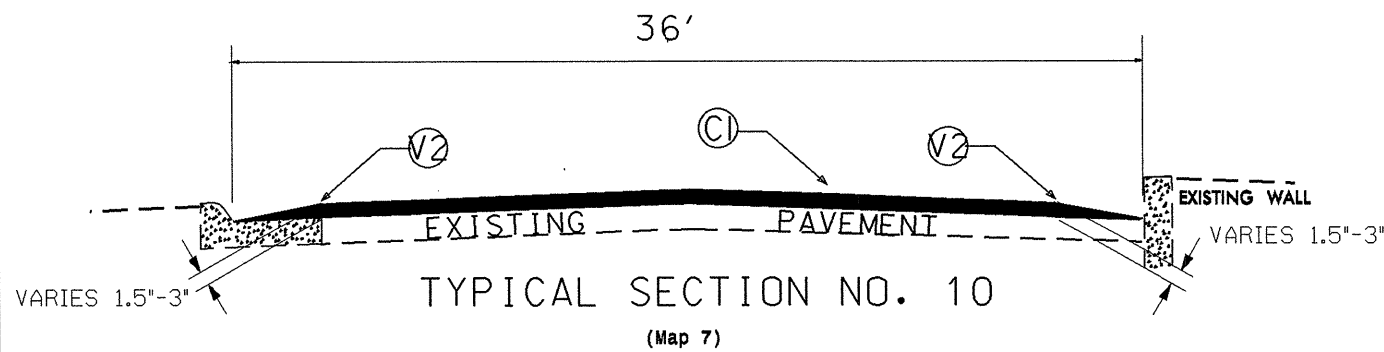
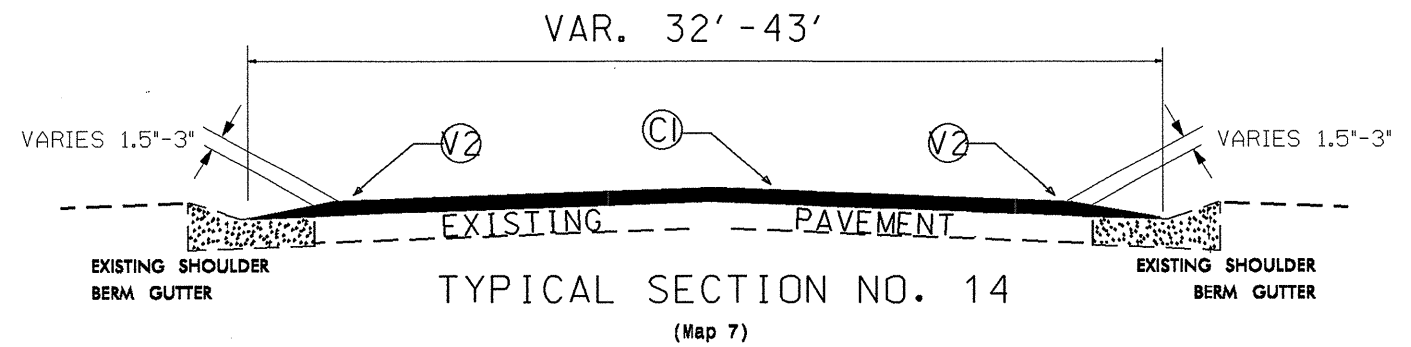
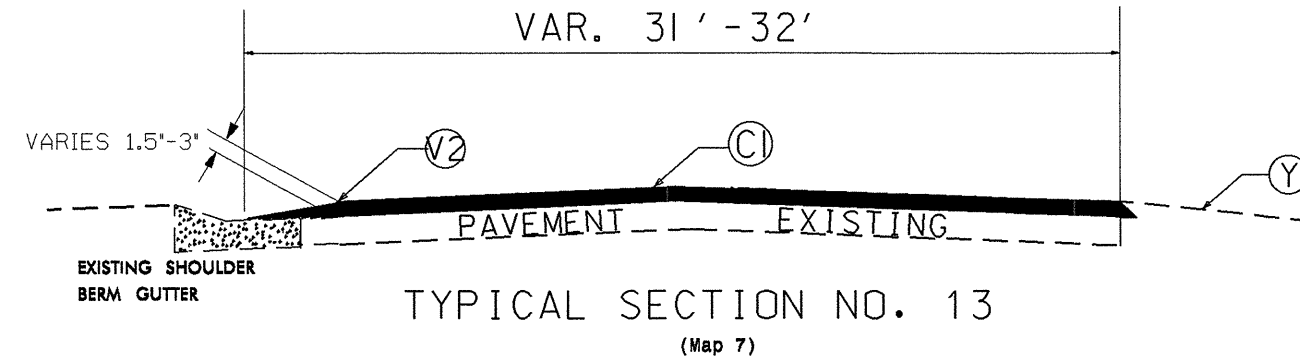

PROJECT NO.	SHEET NO.	TOTAL NO.
12CR.10231.11, 12CR.10231.14	14	15

### SUMMARY OF QUANTITIES

PROJECT NO	COUNTY	MAP NO	ROUTE	DESCRIPTION	TYP	FINAL SURFACE TESTING REQUIRED	LENGTH MI	WIDTH FT	AGGREGATE SHOULDER BORROW TON	INCIDENTAL STONE BASE TONS	SHOULDER RECONSTRUCTION SMI	0" TO 1-1/2" MILLING (LANE WIDTH FROM C&G) SY	INCIDENTAL MILLING SY	1.5" TO 3" MILLING (LANE WIDTH FROM C&G) SY	BASE COURSE, B25.08 TONS	SURFACE COURSE, S9.5B TONS	LEVELING COURSE, S9.5B TONS	ASPHALT BINDER FOR PLANT MIX TONS	PATCHING EXISTING PAVEMENT TONS	ADJ. OF DROP INLET EA	ADJ. OF MANHOLES EA	ADJ. OF METER OR VALVE BOX EA	PORTABLE LIGHTING EA		
12CR.10231.11	Cleveland	1	NC 150 (S. DEKALB ST.)	NC 18 TO RXR	2	NO	1.4	VAR. 60-61				18,070	100 (From Exist'g Pvmt)			4,592	233	291	491						
<b>TOTAL FOR MAP NO. 1</b>							1.4					18,070	100			4,592	233	291	491						
12CR.10231.11	Cleveland	2	US 74 BUS E (WARREN ST)	US 74 TO NC 150 (DEKALB ST)	1 5 6 7 8	NO	0.31 0.02 1.09 0.09 0.17	VAR. 19-31 30 VAR. 30-50 61 60	43		0.64	2,195	1,100 (RXR)	14,328		3,306	165	209	503	22	42	17	1		
<b>TOTAL FOR MAP NO. 2</b>							1.68		43		0.64	2,195	1,100	14,328		3,306	165	209	503	22	42	17	1		
12CR.10231.11	Cleveland	3	NC 10 (CASAR RD)	SR 1552 TO SR 1574	1	NO	0.9	VAR. 21-22	119	50	1.80		50 (From Exist'g Pvmt) 489 (Bridge Approach)			1,079	54	68	210						
<b>TOTAL FOR MAP NO. 3</b>							0.9		119	50	1.80		539			1,079	54	68	210						
<b>TOTAL FOR PROJ NO. 12CR.10231.11</b>							3.98		162	50	2.44	20,265	1,739	14,328		8,977	452	568	1,204	22	42	17	1		
12CR.20231.14	Cleveland	4	SR 1909 (DELVIEW RD)	SR 1908 (CLINELAND RD) TO GASTON CL	3	NO	0.31	VAR. 21-22	41	15	0.62		20 (From Exist'g Pvmt)		254	372	112	41	79						
<b>TOTAL FOR MAP NO. 4</b>							0.31		41	15	0.62		20		254	372	112	41	79						
12CR.20231.14	Cleveland	5	SR 1908 (CLINELAND RD)	SR 1001 TO GASTON CL	3	NO	0.85	22	112	60	1.70		40 (From Exist'g Pvmt)		697	1,019	308	112	197						
<b>TOTAL FOR MAP NO. 5</b>							0.85		112	60	1.70		40		697	1,019	308	112	197						
12CR.20231.14	Cleveland	6	SR 1908 (NEW PROSPECT CH RD)	SR 1001 TO SR 1913	3	NO	1.5	22	198	75	3.00		40 (From Exist'g Pvmt)		1,230	1,799	543	197	282						
<b>TOTAL FOR MAP NO. 6</b>							1.5		198	75	3.00		40		1,230	1,799	543	197	282						
12CR.20231.14	Cleveland	7	SR 1005 (N. LAFAYETTE ST)	NC 18 (GROVER ST) TO CL SHELBY	1 9 10 11 12 13 14	NO	0.65 0.13 0.04 0.04 0.02 0.15 0.32	VAR. 21-26 36 36 VAR. 35-36 VAR. 35-36 VAR. 31-32 VAR. 32-43	100	30	1.51	143		8,916		2,324	116	147	567	2	22	13			
<b>TOTAL FOR MAP NO. 7</b>							1.35		100	30	1.51	143		8,916		2,324	116	147	567	2	22	13			
12CR.20231.14	Cleveland	8	SR 1827 (MCBRAYER SPRINGS RD)	SR 1337 TO SR 1847	4	NO	2.41	VAR. 20-27	318	100	4.82		25 (From Exist'g Pvmt)		1,090	2,760	583	251	509						
<b>TOTAL FOR MAP NO. 8</b>							2.41		318	100	4.82		25		1,090	2,760	583	251	509						
12CR.20231.14	Cleveland	9	SR 1847 (ROSS GROVE RD)	SR 1827 TO NC 18	4	NO	0.25	VAR. 21-22	33	10	0.50		20 (From Exist'g Pvmt)		113	300	63	27	55						
<b>TOTAL FOR MAP NO. 9</b>							0.25		33	10	0.50		20		113	300	63	27	55						
12CR.20231.14	Cleveland	10	SR 1151 (POPLAR SPRINGS CH RD)	US 74 TO SR 1123	1	NO	1.14	VAR. 22-23	150	75	2.28		150 (From Existing Pvmt)			1,429	71	90	257						
<b>TOTAL FOR MAP NO. 10</b>							1.14		150	75	2.28		150			1,429	71	90	257						
12CR.20231.14	Cleveland	11	SR 2226 (LAVENDER RD)	NC 226 TO SR 2308	3	NO	1.92	VAR. 22-23	254	115	3.84		50 (From Exist'g Pvmt)		1,574	2,407	363	237	645						
<b>TOTAL FOR MAP NO. 11</b>							1.92		254	115	3.84		50		1,574	2,407	363	237	645						
12CR.20231.14	Cleveland	12	SR 1151 (POPLAR SPRINGS CH RD)	NC 150 TO SR 1123	3	NO	2.52	VAR. 22-23	333	155	5.04		150 (From Existing Pvmt)		2,066	3,159	763	330	490						
<b>TOTAL FOR MAP NO. 12</b>							2.52		333	155	5.04		150		2,066	3,159	763	330	490						
12CR.20231.14	Cleveland	13	SR 2052 (COUNTRY CLUB)	US 74 BUS TO SR 2050	4 15	NO	0.96 0.10	VAR. 20-21 38	127	10	1.92		50 (From Exist'g Pvmt)		434	1,299	183	109	372						
<b>TOTAL FOR MAP NO. 13</b>							1.06		127	10	1.92		50		434	1,299	183	109	372						
12CR.20231.14	Cleveland	14	SR 1848 (FREDERICK ST)	END C&G TO SR 1827	4	NO	0.5	21	66	20	1.00		20 (From Exist'g Pvmt)		226	573	86	50	170						
<b>TOTAL FOR MAP NO. 14</b>							0.5		66	20	1.00		20		226	573	86	50	170						
12CR.20231.14	Cleveland	15	SR 1001 (WACO-FALLSTON RD)	SR 1913 TO 600 FT S OF SR 1908	4	NO	1.21	23	290	70	2.42		230 (From Exist'g Pvmt)		547	1,517	229	130	257						
<b>TOTAL FOR MAP NO. 15</b>							1.21		290	70	2.42		230		547	1,517	229	130	257						
12CR.20231.14	Cleveland	16	SR 1253 (CHARLES RD)	US 74 BYP TO US 74 BUS	1	NO	0.18	VAR. 21-88	22	5	0.34					289	13	18	27						
<b>TOTAL FOR MAP NO. 16</b>							0.18		22	5	0.34					289	13	18	27						
12CR.20231.14	Cleveland	17	SR 2293 (HILLWAY DR)	SR 2292 TO GASTON CL	16	NO	0.28	VAR. 18-19	40							290	38	20	60						
<b>TOTAL FOR MAP NO. 16</b>							0.28		40							290	38	20	60						
12CR.20231.14	Cleveland	18	SR 2434 (SHADY HILL RD)	SR 2292 TO GASTON CL	16	NO	0.08	VAR. 18-19	10							83	11	6	19						
<b>TOTAL FOR MAP NO. 16</b>							0.08		10							83	11	6	19						
12CR.20231.14	Cleveland	19	SR 1858 (POTATO HOUSE RD)	SR 1849 TO DE	16	NO	0.6	18	40							590	60	39	120						
<b>TOTAL FOR MAP NO. 16</b>							0.6		40							590	60	39	120						
<b>TOTAL FOR PROJ NO. 12CR.20231.14</b>							16.16		2,044	830	28.99	143	775	8,916	8,231	20,210	3,542	1,804	4,106	24	64	30	1		
<b>GRAND TOTAL</b>							20.14		2,206	880	31.43	20,408	2,514	23,244	8,231	29,187	3,994	2,372	5,310	24	64	30	1		

PROJECT NO.	SHEET NO.	TOTAL NO.
12CR.10231.11, 12CR.10231.14	15	15

### THERMOPLASTIC AND PAINT QUANTITIES

PROJECT NO	COUNTY	MAP NO	ROUTE	DESCRIPTION	LENGTH	4685000000-E		4686000000-E		4697000000-E	4705000000-E	4710000000-E	4721000000-E			4725000000-E			4810000000-E		4905000000-N			
						4" X 90 M WHITE THERMO	4" X 90 M YELLOW THERMO	4" X 120 M YELLOW THERMO	4" X 120 M WHITE THERMO	8" X 120 M WHITE THERMO	16" X 120 M WHITE THERMO	24" X 120 M WHITE THERMO	THERMO MSG ONLY 120 M	THERMO RXR 120 M	THERMO MSG SCHOOL 120 M	THERMO LT ARROW 90 M	THERMO RT ARROW 90 M	THERMO STR ARROW 90 M	THERMO STR & RT ARROW 90 M	THERMO STR & LT ARROW 90 M	4" WHITE PAINT	4" YELLOW PAINT	SNOW PLOWABLE MARKERS	
						LF	LF	LF	LF	LF	LF	LF	EA	EA	EA	EA	EA	EA	EA	EA	EA			
12CR.10231.11	Cleveland	1	NC 150 (S. DEKALB ST.)	NC 18 TO RXR	1.4			18,500	4,100			100	190	8	4		EA	EA	EA					
TOTAL FOR MAP NO. 1						1.4		18,500	4,100			100	190	8	4							400		
12CR.10231.11	Cleveland	2	US 74 BUS E (WARREN ST)	US 74 TO NC 150 (DEKALB ST)	1.68	2,490	1,004	15,946	1,610	730		100	190	8	4							400		
TOTAL FOR MAP NO. 2						1.68	2,490	1,004	15,946	1,610	730	100	190	8	4								400	
12CR.10231.11	Cleveland	3	NC 10 (CASAR RD)	SR 1552 TO SR 1574	0.9	9,684		7,940						6	12				16	12	6,600	1,800	300	
TOTAL FOR MAP NO. 3						0.9	9,684		7,940					6	12				16	12	6,600	1,800	300	
TOTAL FOR PROJ NO. 12CR.10231.11						3.98	12,174	1,004	42,386	5,710	730	200	550	8	10	12	50	4	3	16	12	6,600	1,800	762
							13,178		48,096					30				85			8,400			
12CR.10231.14	Cleveland	4	SR 1909 (DELVIEW RD)	SR 1908 (CLINELAND RD) TO GASTON CL	0.31																			
TOTAL FOR MAP NO. 4						0.31																6,671	6,671	
12CR.10231.14	Cleveland	5	SR 1908 (CLINELAND RD)	SR 1001 TO GASTON CL	0.85																			
TOTAL FOR MAP NO. 5						0.85																18,292	18,292	
12CR.10231.14	Cleveland	6	SR 1908 (NEW PROSPECT CH RD)	SR 1001 TO SR 1913	1.5																			
TOTAL FOR MAP NO. 6						1.5																32,280	32,280	
12CR.10231.14	Cleveland	7	SR 1005 (N. LAFAYETTE ST)	NC 18 (GROVER ST) TO CL SHELBY	1.35	7,904		14,526		72			18											
TOTAL FOR MAP NO. 7						1.35	7,904		14,526		72		18										200	
12CR.10231.14	Cleveland	8	SR 1827 (MCBRAYER SPRINGS RD)	SR 1337 TO SR 1847	2.41																			
TOTAL FOR MAP NO. 8						2.41																	200	
12CR.10231.14	Cleveland	9	SR 1847 (ROSS GROVE RD)	SR 1827 TO NC 18	0.25																			
TOTAL FOR MAP NO. 9						0.25																51,863	41,812	
12CR.10231.14	Cleveland	10	SR 1151 (POPLAR SPRINGS CH RD)	US 74 TO SR 1123	1.14																			
TOTAL FOR MAP NO. 10						1.14																51,863	41,812	
12CR.10231.14	Cleveland	11	SR 2226 (LAVENDER RD)	NC 226 TO SR 2308	1.92																			
TOTAL FOR MAP NO. 11						1.92																5,380	5,380	
12CR.10231.14	Cleveland	12	SR 1151 (POPLAR SPRINGS CH RD)	NC 150 TO SR 1123	2.52																			
TOTAL FOR MAP NO. 12						2.52																24,452	24,452	
12CR.10231.14	Cleveland	13	SR 2052 (COUNTRY CLUB)	US 74 BUS TO SR 2050	1.06																			
TOTAL FOR MAP NO. 13						1.06																41,318	25,344	
12CR.10231.14	Cleveland	14	SR 1848 (FREDERICK ST)	END C&G TO SR 1827	0.5																			
TOTAL FOR MAP NO. 14						0.5																41,318	25,344	
12CR.10231.14	Cleveland	15	SR 1001 (WACO FALLSTON RD)	SR 1913 TO 600 FT S OF SR 1908	1.21																			
TOTAL FOR MAP NO. 15						1.21																54,230	54,230	
12CR.10231.14	Cleveland	16	SR 1253 (CHARLES RD)	US 74 BYP TO US 74 BUS	0.18	1,937		1,795																
TOTAL FOR MAP NO. 15						0.5	1,937		1,795													20,276	16,992	
12CR.10231.14	Cleveland	17	SR 2293 (HILLWAY DR)	SR 2292 TO GASTON CL	0.28																			
TOTAL FOR MAP NO. 15						0.28																10,760	10,760	
12CR.10231.14	Cleveland	18	SR 2434 (SHADY HILL RD)	SR 2292 TO GASTON CL	0.08																			
TOTAL FOR MAP NO. 16						0.08																26,039	26,039	
12CR.10231.14	Cleveland	19	SR 1858 (POTATO HOUSE RD)	SR 1849 TO DE	0.6																			
TOTAL FOR MAP NO. 16						0.6																26,039	26,039	
TOTAL FOR PROJ NO. 12CR.10231.14						15.62	9,841		16,321	72		40										20,276	16,992	
							9,841		16,321												20,276	16,992		
																					54,230	54,230		
																					54,230	54,230		
																					20,276	16,992		
																					20,276	16,992		
																					10,760	10,760		
																					10,760	10,760		
																					26,039	26,039		
																					26,039	26,039		
																					6026	6026		
																					6026	6026		
																					1722	1722		
																					1722	1722		
																					1,722	1,722		
																					1,722	1,722		
TOTAL FOR PROJ NO. 12CR.10231.14						15.62	9,841		16,321	72		40										1,722	1,722	
							9,841		16,321												301,031	271,722		
																					301,031	271,722		
																					572,753			
GRAND TOTAL						19.6	22,015	1,004	58,707	5,710	802	200	590	8	10	12	51	4	3	16	12	307,631	273,522	
							23,019		64,417						30						581,153	1,077		