

CONTRACT NO.: **WBS ELEMENT: ICR.20151.40, ETC.**

STATE OF NORTH CAROLINA  
 DIVISION OF HIGHWAYS

**CAMDEN COUNTY**

LOCATION: MAP 1 SR 1225 FROM SR 1226 TO SR 1224  
 TYPE OF WORK: MILLING, RESURFACING & PAVEMENT MARKINGS

STATE	STATE PROJECT REFERENCE NO.	SHEET NO.	TOTAL SHEETS
N.C.	ICR.20151.40, ETC.	1	
STATE PROJECT	S.A. PROJECT	DESCRIPTION	
ICR.20151.40		MAP 1	

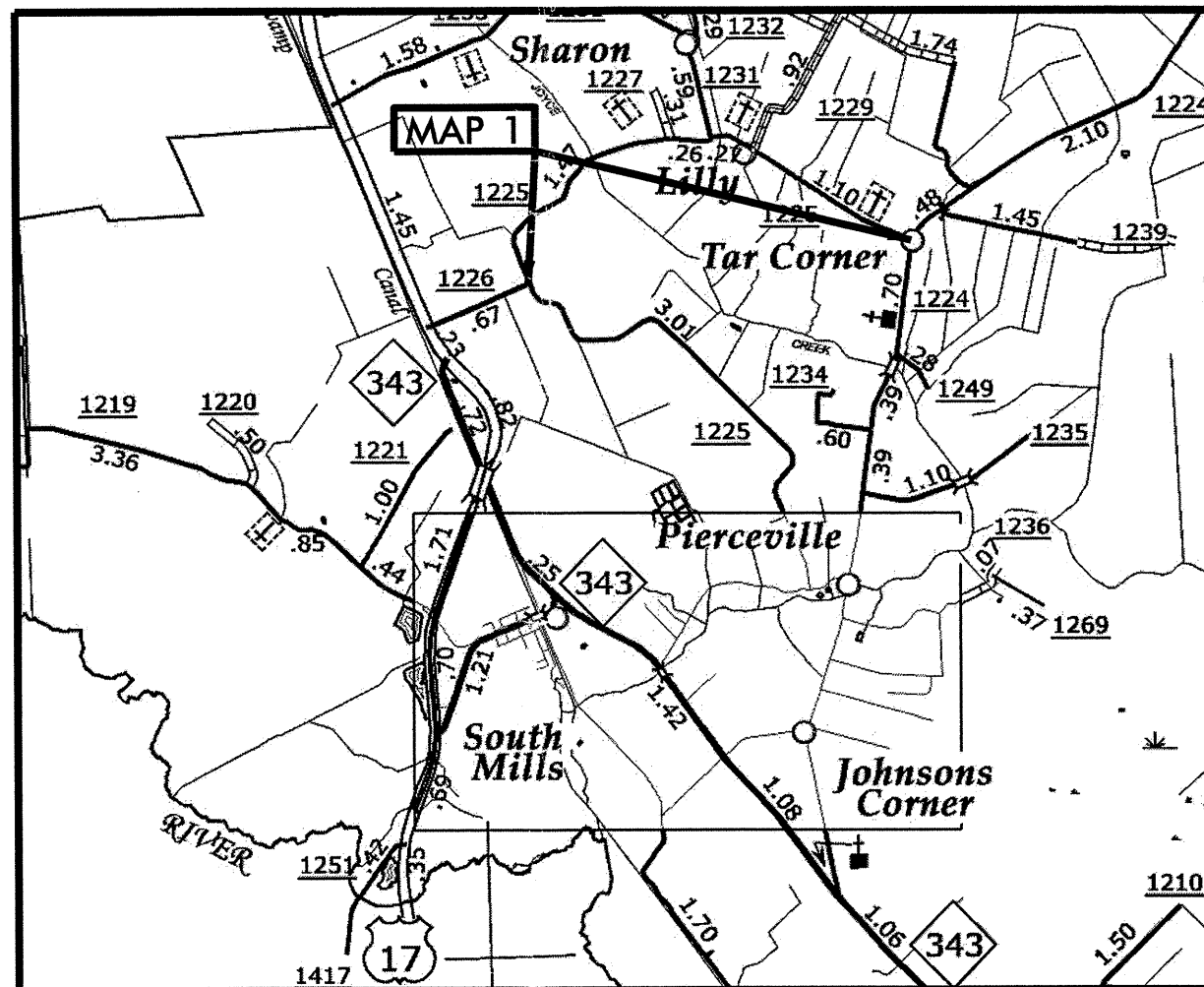

**NTS**

PROJECT LENGTH  
 LENGTH OF ROADWAY PROJECT MAP 1 = 3.10 MI.

Prepared in the Office of:  
**DIVISION OF HIGHWAYS**  
 113 Airport Dr., Edenton NC, 27932

2012 STANDARD SPECIFICATIONS

LETTING DATE:  
 XXXXXXXXX

W.B. HOBBS, P.E.  
 DIVISION PROJECT MANAGER

C.E. SLACHTA  
 DIVISION PROPOSALS ENGINEER

DIVISION OF HIGHWAYS  
 STATE OF NORTH CAROLINA

09/20/2017

CONTRACT NO.: **WBS ELEMENT: ICR.20151.40, ETC.**

STATE OF NORTH CAROLINA  
DIVISION OF HIGHWAYS

**CURRITUCK COUNTY**

LOCATION: MAP 2 SR 1353 FROM SR 1216 TO END  
MAP 7 SR 1351 FROM SR 1216 TO END  
MAP 9 SR 1329 FROM SR 1216 TO SR 1328  
MAP 10 SR 1330 FROM SR 1328 TO END  
MAP 12 SR 1326 FROM SR 1328 TO SR 1216  
MAP 13 SR 1327 FROM SR 1328 TO END  
MAP 15 SR 1214 FROM NC 168 TO SR 1222

TYPE OF WORK: MILLING, RESURFACING & PAVEMENT MARKINGS

STATE	STATE PROJECT REFERENCE NO.	SHEET NO.	TOTAL SHEETS
N.C.	ICR.20151.40, ETC.	2	
STATE PROJ. NO.	P.L. PROJ. NO.	DESCRIPTION	
1CR.20271.54		MAP 2	
1CR.20271.59		MAP 7	
1CR.20271.61		MAP 9	
1CR.20271.62		MAP 10	
1CR.20271.64		MAP 12	
1CR.20271.65		MAP 13	
1CR.20271.67		MAP 15	

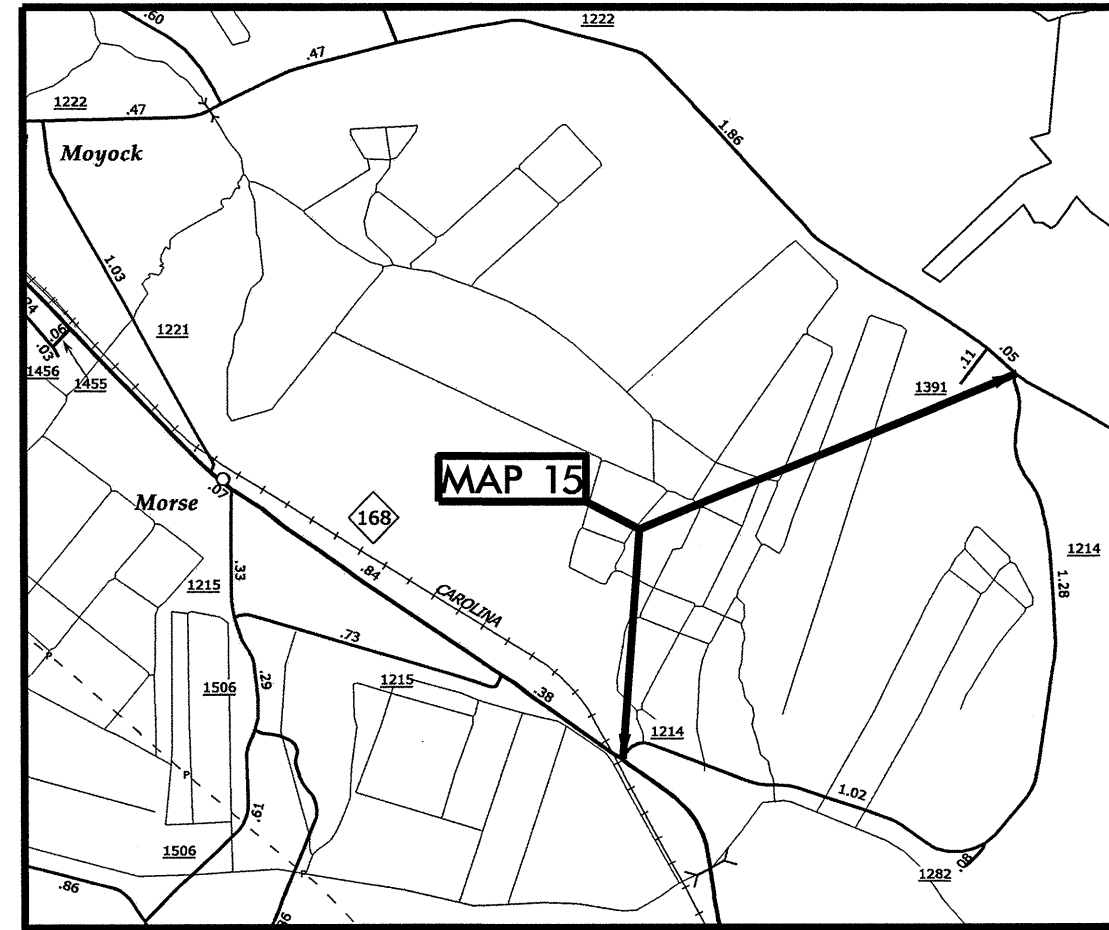
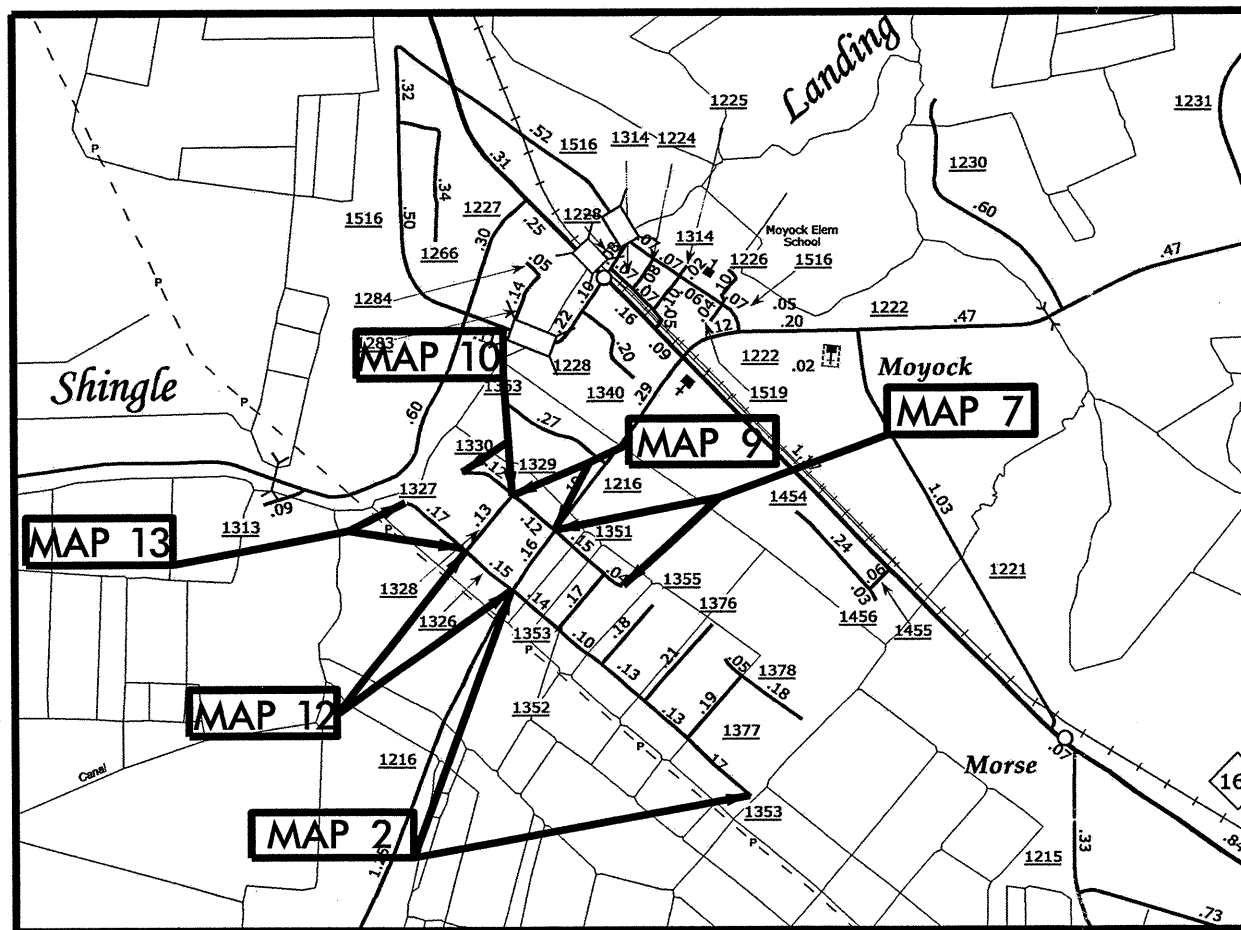

**NTS**

**PROJECT LENGTH**

- LENGTH OF ROADWAY PROJECT MAP 2 = 0.71 MI.
- LENGTH OF ROADWAY PROJECT MAP 7 = 0.20 MI.
- LENGTH OF ROADWAY PROJECT MAP 9 = 0.12 MI.
- LENGTH OF ROADWAY PROJECT MAP 10 = 0.13 MI.
- LENGTH OF ROADWAY PROJECT MAP 12 = 0.14 MI.
- LENGTH OF ROADWAY PROJECT MAP 13 = 0.17 MI.
- LENGTH OF ROADWAY PROJECT MAP 15 = 2.29 MI.

Prepared in the Office of:  
**DIVISION OF HIGHWAYS**  
113 Airport Dr., Edenton NC, 27932

2012 STANDARD SPECIFICATIONS

LETTING DATE:  
XXXXXXXXXXXXXX

**W.B. HOBBS, P.E.**  
DIVISION PROJECT MANAGER

**C.E. SLACHTA**  
DIVISION PROPOSALS ENGINEER

DIVISION OF HIGHWAYS  
STATE OF NORTH CAROLINA

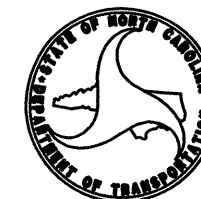

CONTRACT NO.: **WBS ELEMENT: ICR.20151.40, ETC.**

STATE OF NORTH CAROLINA  
DIVISION OF HIGHWAYS

**CURRITUCK COUNTY**

**LOCATION:** MAP 3 SR 1377 FROM SR 1353 TO SR 1378  
 MAP 4 SR 1378 FROM END TO END  
 MAP 5 SR 1376 FROM SR 1353 TO END  
 MAP 6 SR 1355 FROM SR 1353 TO END  
 MAP 8 SR 1352 FROM SR 1353 TO SR 1351  
 MAP 11 SR 1328 FROM SR 1330 TO SR 1326  
 MAP 14 SR 1363 FROM SR 1216 TO END

**TYPE OF WORK: MILLING, RESURFACING & PAVEMENT MARKINGS**

STATE	STATE PROJECT REFERENCE NO.	SHEET NO.	TOTAL SHEETS
N.C.	ICR.20151.40, ETC.	3	
STATE FORUM	P.A. FORUM	DESCRIPTION	
ICR.20271.55		MAP 3	
ICR.20271.56		MAP 4	
ICR.20271.57		MAP 5	
ICR.20271.58		MAP 6	
ICR.20271.60		MAP 8	
ICR.20271.63		MAP 11	
ICR.20271.66		MAP 14	

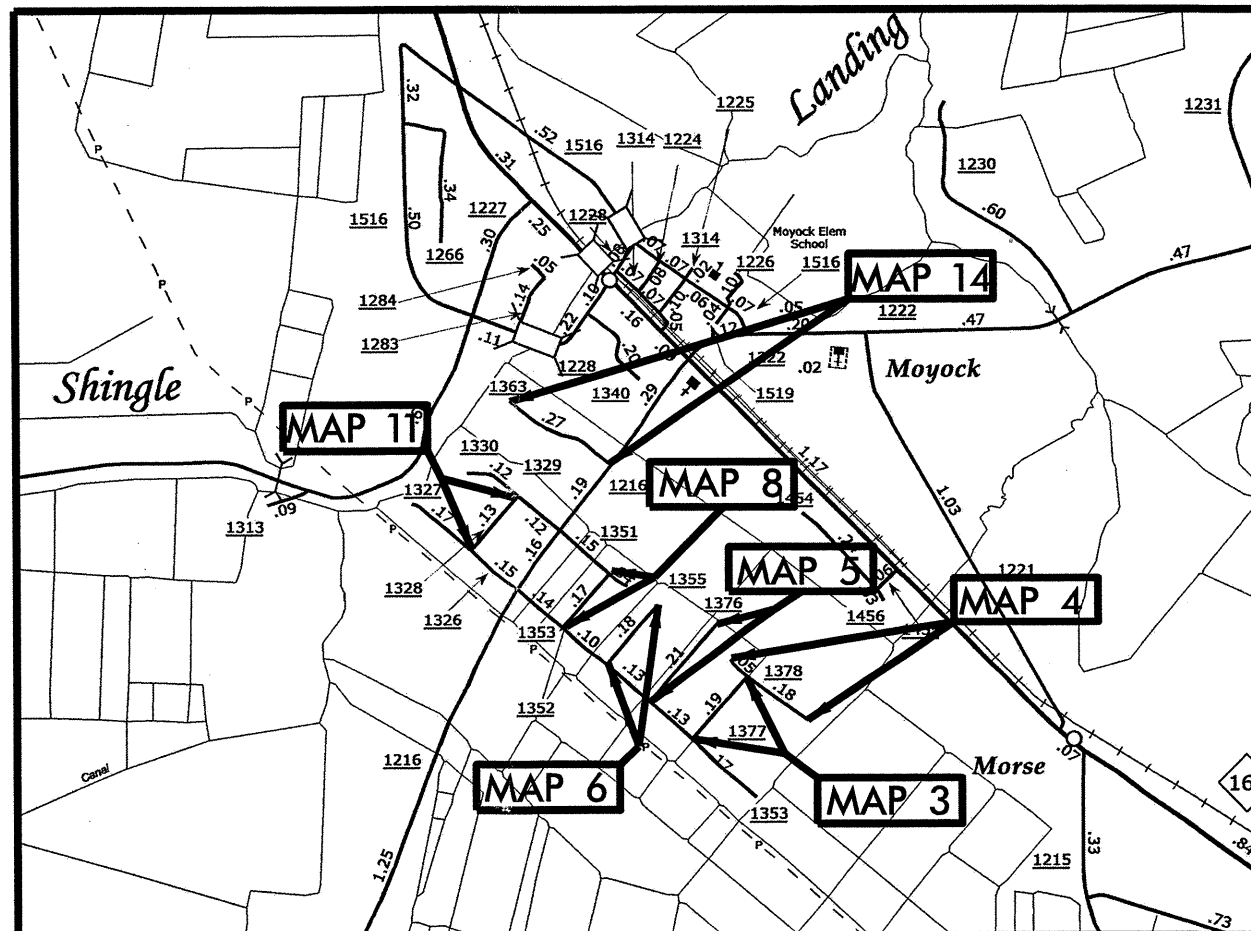

**NTS**

PROJECT LENGTH	
LENGTH OF ROADWAY PROJECT MAP 3	= 0.18 MI.
LENGTH OF ROADWAY PROJECT MAP 4	= 0.22 MI.
LENGTH OF ROADWAY PROJECT MAP 5	= 0.23 MI.
LENGTH OF ROADWAY PROJECT MAP 6	= 0.18 MI.
LENGTH OF ROADWAY PROJECT MAP 8	= 0.16 MI.
LENGTH OF ROADWAY PROJECT MAP 11	= 0.16 MI.
LENGTH OF ROADWAY PROJECT MAP 14	= 0.27 MI.

Prepared in the Office of:  
**DIVISION OF HIGHWAYS**  
 113 Airport Dr., Edenton NC, 27932  
 2012 STANDARD SPECIFICATIONS

LETTING DATE: XXXXXXXXXXXXXXXX	W.B. HOBBS, P.E. DIVISION PROJECT MANAGER
	C.E. SLACHTA DIVISION PROPOSALS ENGINEER

DIVISION OF HIGHWAYS  
 STATE OF NORTH CAROLINA

09/08/99

CONTRACT NO.: WBS ELEMENT: ICR.20151.40, ETC.

STATE OF NORTH CAROLINA  
DIVISION OF HIGHWAYS

**PASQUOTANK COUNTY**

STATE	STATE PROJECT REFERENCE NO.	SHEET NO.	TOTAL SHEETS
N.C.	ICR.20151.40, ETC.	4	
STATE PROJ. NO.	R.A. PROJ. NO.	DESCRIPTION	
ICR.20701.77		MAP 16	
ICR.20701.78		MAP 17	
ICR.20701.79		MAP 18	
ICR.20701.80		MAP 19	
ICR.20701.80		MAP 20	
ICR.20701.80		MAP 21	

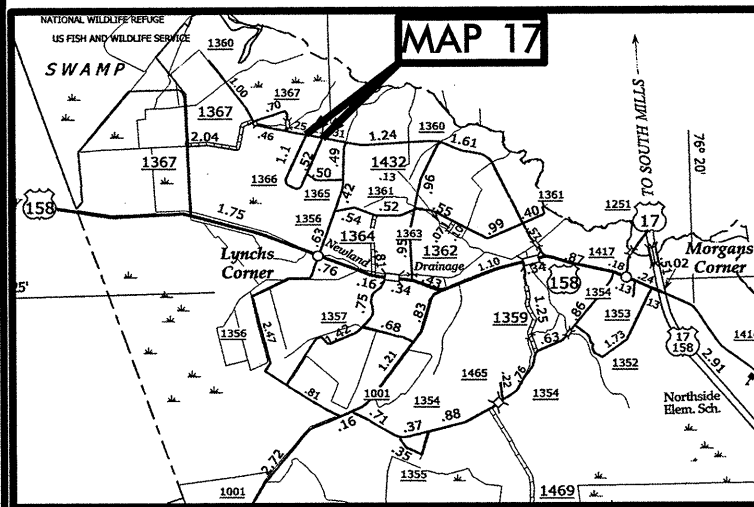

LOCATION: MAP 16 SR 1116 FROM SR 1117 TO SR 1103  
 MAP 17 SR 1366 FROM SR 1360 TO SR 1360  
 MAP 18 SR 1141 FROM SR 1142 TO SR 1140  
 MAP 19 SR 1101 FROM HALSTEAD BLVD. TO CURB & GUTTER  
 MAP 20 SR 1101 FROM CURB & GUTTER TO SINGLE CURB & GUTTER  
 MAP 21 SR 1101 FROM SINGLE CURB & GUTTER TO NEW PAVMENT

TYPE OF WORK: MILLING, RESURFACING & PAVEMENT MARKINGS

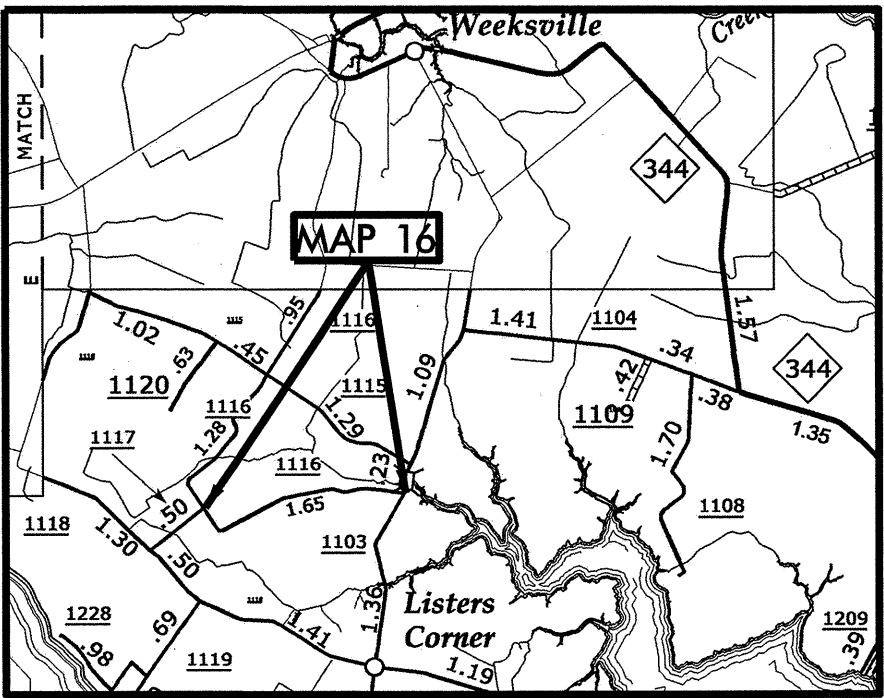
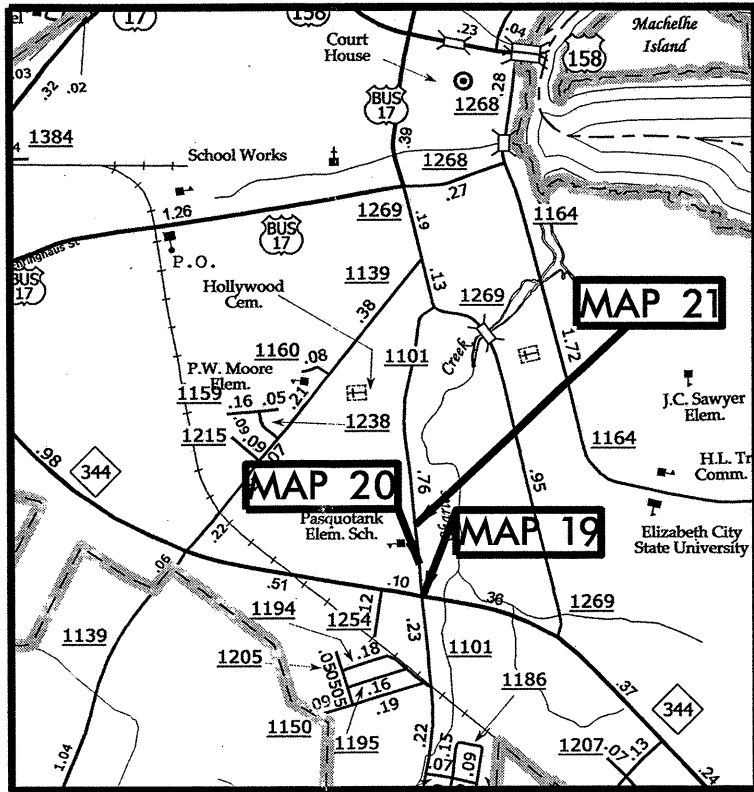
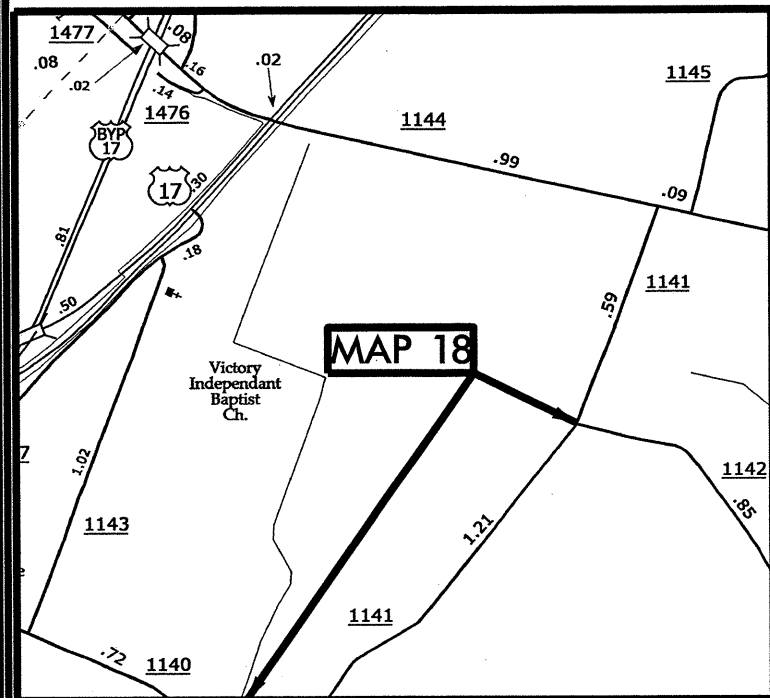

**NTS**

PROJECT LENGTH

LENGTH OF ROADWAY PROJECT MAP 16=	1.70 MI.
LENGTH OF ROADWAY PROJECT MAP 17=	1.60 MI.
LENGTH OF ROADWAY PROJECT MAP 18=	1.20 MI.
LENGTH OF ROADWAY PROJECT MAP 19=	0.09 MI.
LENGTH OF ROADWAY PROJECT MAP 20=	0.17 MI.
LENGTH OF ROADWAY PROJECT MAP 21=	0.08 MI.

Prepared in the Office of:  
**DIVISION OF HIGHWAYS**  
 113 Airport Dr., Edenton NC, 27932

2012 STANDARD SPECIFICATIONS

LETTING DATE:  
 XXXXXXXXXXXX

W.B. HOBBS, P.E.  
 DIVISION PROJECT MANAGER

C.E. SLACHTA  
 DIVISION PROPOSALS ENGINEER

DIVISION OF HIGHWAYS  
 STATE OF NORTH CAROLINA

PAVEMENT SCHEDULE

C1	PROP. APPROX. 1½" ASPHALT CONCRETE SURFACE COURSE, TYPE SF9.5A, AT AN AVERAGE RATE OF 165 LBS. PER SQ. YD.
T	EARTH MATERIAL
U	EXISTING PAVEMENT.

PROJECT REFERENCE NO.	SHEET NO.
ICR.20151.40, ETC.	5

NOTES:

\*ALL PAVED S.R. ROADS TO BE RESURFACED TO THE ENDS OF THE RADII OR AS DIRECTED BY THE ENGINEER

\*EDGES, PAVEMENT WIDENING, INTERSECTIONS, AND BRIDGE FLARES ARE INCLUDED IN THE TABLE OF QUANTITIES

\*PAVEMENT EDGE SLOPES ARE 1:1 UNLESS SHOWN OTHERWISE

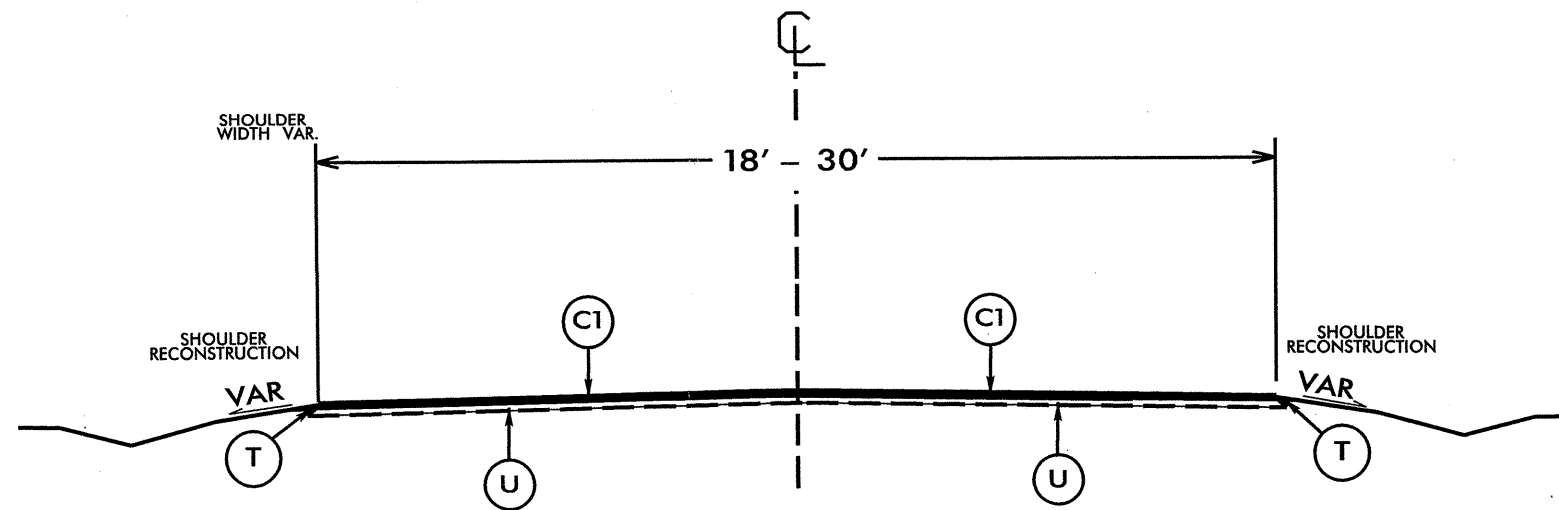

**TYPICAL SECTION NO.1**

USE WITH MAP 1-19

NTS

PAVEMENT SCHEDULE

C1	PROP. APPROX. 1½" ASPHALT CONCRETE SURFACE COURSE, TYPE SF9.5A, AT AN AVERAGE RATE OF 165 LBS. PER SQ. YD.
U	EXISTING PAVEMENT.
V1	MILLING BITUMINOUS PAVEMENT. 1.5" IN DEPTH.

NOTES:

\*ALL PAVED S.R. ROADS TO BE RESURFACED TO THE ENDS OF THE RADII OR AS DIRECTED BY THE ENGINEER

\*EDGES, PAVEMENT WIDENING, INTERSECTIONS, AND BRIDGE FLARES ARE INCLUDED IN THE TABLE OF QUANTITIES

\*PAVEMENT EDGE SLOPES ARE 1:1 UNLESS SHOWN OTHERWISE

\*CONTRACTOR SHALL MILL 1.5" BELOW EXISTING EDGE OF CONC. CURB & GUTTER

\*MILLING SHALL BE DONE AS DIRECTED BY THE ENGINEER

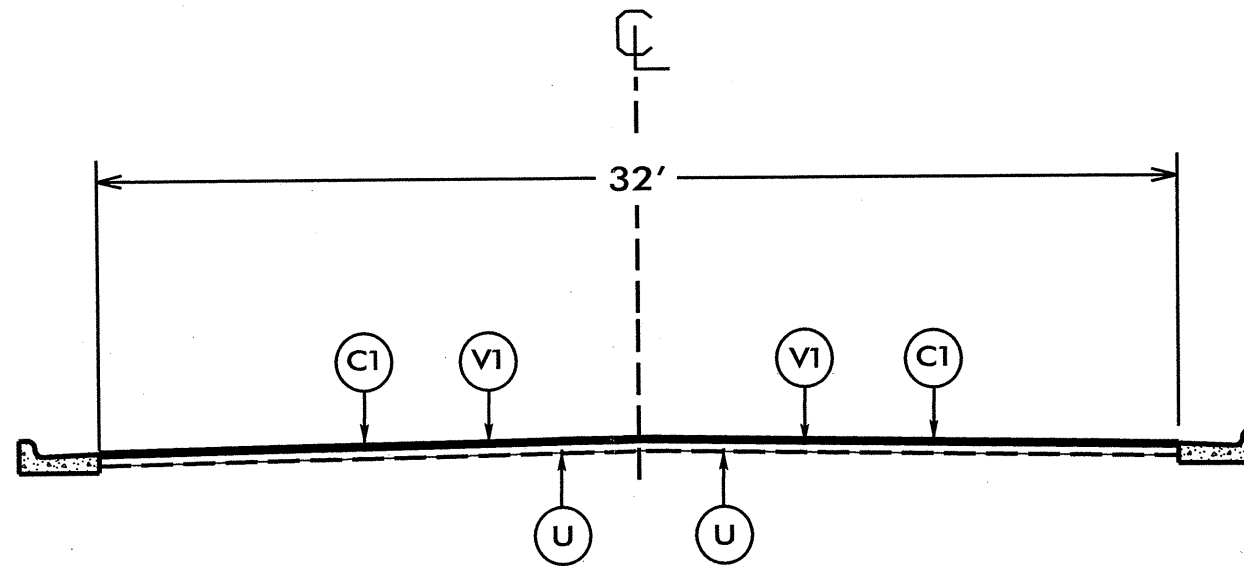

**TYPICAL SECTION NO.2**

USE WITH MAP 20

NTS

SYSTEMS

PAVEMENT SCHEDULE

C1	PROP. APPROX. 1½" ASPHALT CONCRETE SURFACE COURSE, TYPE SF9.5A, AT AN AVERAGE RATE OF 165 LBS. PER SQ. YD.
T	EARTH MATERIAL
U	EXISTING PAVEMENT.
V2	MILLING BITUMINOUS PAVEMENT. 0"-1.5" IN DEPTH.

NOTES:

\*ALL PAVED S.R. ROADS TO BE RESURFACED TO THE ENDS OF THE RADIUS OR AS DIRECTED BY THE ENGINEER

\*EDGES, PAVEMENT WIDENING, INTERSECTIONS, AND BRIDGE FLARES ARE INCLUDED IN THE TABLE OF QUANTITIES

\*PAVEMENT EDGE SLOPES ARE 1:1 UNLESS SHOWN OTHERWISE

\*CONTRACTOR SHALL MILL 1.5" BELOW EXISTING EDGE OF CONC. CURB & GUTTER

\*MILLING SHALL BE DONE AS DIRECTED BY THE ENGINEER

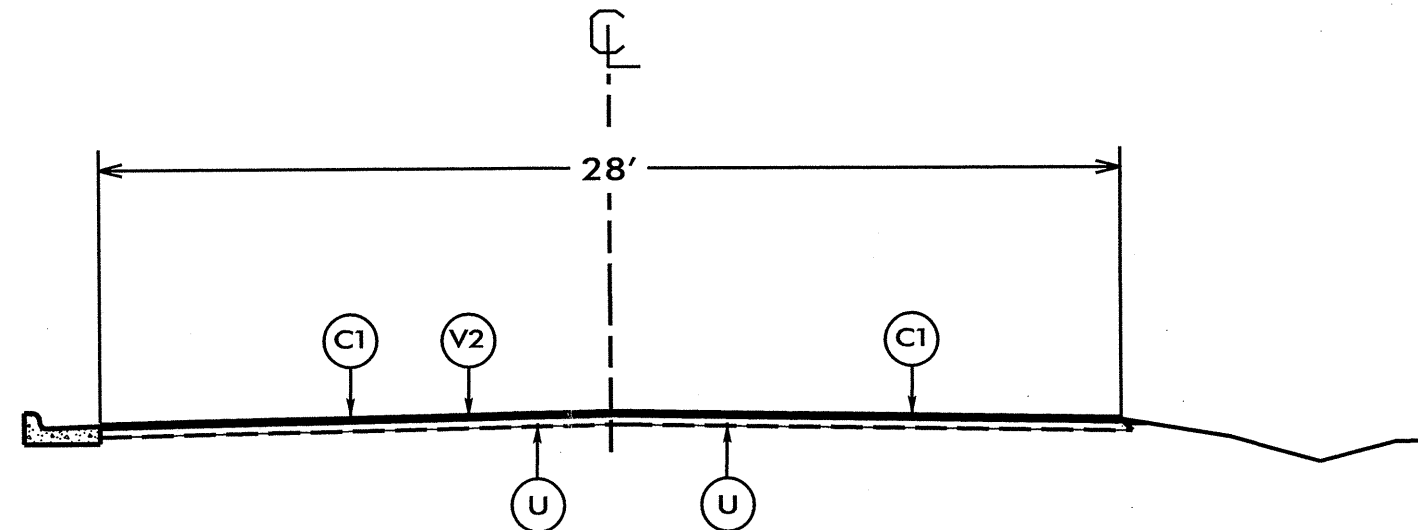

**TYPICAL SECTION NO.3**

USE WITH MAP 21

NTS

PROJECT NO.	SHEET NO.	TOTAL NO.
1CR.20151.40, ETC.	8	

### SUMMARY OF QUANTITIES

PROJECT NO	COUNTY	MAP NO	ROUTE	DESCRIPTION	TYP NO	FINAL SURFACE TESTING REQUIRED	LENGTH MI	WIDTH FT	MOBILIZATION LS	BORROW CY	INCIDENTAL STONE BASE TONS	SHOULDER RECONSTRUCTION SMI	1 1/2" MILLING SY	0" - 1 1/2" MILLING SY	SURFACE COURSE, SF9.5A TONS	ASPHALT BINDER FOR PLANT MIX TONS	ADJ. OF MANHOLES EA	ADJ. OF METER OR VALVE BOX EA	SEED & MULCHING AC
1CR.20151.40	Camden	1	SR 1225	FROM SR 1226 TO SR 1224	1	NO	3.10	20	1	125	50	6.20			3,388	227			3.10
1CR.20271.54	Currituck	2	SR 1353	FROM SR 1216 TO END	1	NO	0.71	20	*	30	5	1.42			922	62			0.71
1CR.20271.55	Currituck	3	SR 1377	FROM SR 1353 TO SR 1378	1	NO	0.18	20	*	5	5	0.36			185	12			0.18
1CR.20271.56	Currituck	4	SR 1378	FROM END TO END	1	NO	0.22	20	*	4	5	0.44			294	20			0.22
1CR.20271.57	Currituck	5	SR 1376	FROM SR 1353 TO END	1	NO	0.23	20	*	4	5	0.46			264	18			0.23
1CR.20271.58	Currituck	6	SR 1355	FROM SR 1353 TO END	1	NO	0.18	20	*	3	5	0.36			215	14			0.18
1CR.20271.59	Currituck	7	SR 1351	FROM SR 1216 TO END	1	NO	0.20	20	*	8	5	0.40			225	15			0.20
1CR.20271.60	Currituck	8	SR 1352	FROM SR 1353 TO SR 1351	1	NO	0.16	20	*	6	5	0.32			166	11			0.16
1CR.20271.61	Currituck	9	SR 1329	FROM SR 1216 TO SR 1328	1	NO	0.12	18	*	4	5	0.24			155	10			0.12
1CR.20271.62	Currituck	10	SR 1330	FROM SR 1328 TO END	1	NO	0.13	18	*	5	5	0.26			164	11			0.13
1CR.20271.63	Currituck	11	SR 1328	FROM SR 1330 TO SR 1326	1	NO	0.16	18	*	6	5	0.32			160	11			0.16
1CR.20271.64	Currituck	12	SR 1326	FROM SR 1328 TO SR1216	1	NO	0.14	18	*	5	5	0.28			148	10			0.14
1CR.20271.65	Currituck	13	SR 1327	FROM SR 1328 TO END	1	NO	0.17	18	*	7	5	0.34			189	13			0.17
1CR.20271.66	Currituck	14	SR 1363	FROM SR 1216 TO END	1	NO	0.27	20	*	11		0.54			313	21			0.27
1CR.20271.67	Currituck	15	SR 1214	FROM NC 168 TO SR 1222	1	NO	2.29	20	*	90	5	4.58			2,271	152			2.29
1CR.20701.77	Pasquotank	16	SR 1116	FROM SR 1117 TO SR 1103	1	NO	1.70	18	*	65	15	3.40			1,661	111			1.70
1CR.20701.78	Pasquotank	17	SR 1366	FROM SR 1360 TO SR 1360	1	NO	1.60	18	*	60	50	3.20			1,424	95		2	1.60
1CR.20701.79	Pasquotank	18	SR 1141	FROM SR 1142 TO SR 1140	1	NO	1.20	18	*	48	5	2.40			1,178	79			1.20
1CR.20701.80	Pasquotank	19	SR 1101	FROM HALLSTEAD BLVD TO CURB & GUTTER	1	NO	0.09	30	*						130	9	1	2	
1CR.20701.80	Pasquotank	20	SR 1101	FROM CURB & GUTTER TO SINGLE CURB & GUTTER	2	NO	0.17	32	*				1,100		264	18			
1CR.20701.80	Pasquotank	21	SR 1101	SINGLE CURB & GUTTER TO NEW PAVEMENT	3	NO	0.08	28	*					500	114	8			
<b>GRAND TOTAL</b>							<b>13.10</b>		<b>1</b>	<b>486</b>	<b>185</b>	<b>25.52</b>	<b>1,100</b>	<b>500</b>	<b>13,830</b>	<b>927</b>	<b>1</b>	<b>4</b>	<b>12.76</b>

### THERMOPLASTIC AND PAINT QUANTITIES

PROJECT NO	COUNTY	MAP NO	ROUTE	DESCRIPTION	LENGTH	WIDTH	TEMPORARY TRAFFIC CONTROL LS	4" X 90 M WHITE THERMO LF	4" X 120 M YELLOW THERMO LF	24" X 120 M WHITE THERMO LF	THERMO MSG SCHOOL 120 M EA	4" WHITE PAINT LF	4" YELLOW PAINT LF
1CR.20151.40	Camden	1	SR 1225	FROM SR 1226 TO SR 1224	3.10	20	1	33,356	20,460			33,356	20,460
1CR.20271.54	Currituck	2	SR 1353	FROM SR 1216 TO END	0.71	20	*						
1CR.20271.55	Currituck	3	SR 1377	FROM SR 1353 TO SR 1378	0.18	20	*						
1CR.20271.56	Currituck	4	SR 1378	FROM END TO END	0.22	20	*						
1CR.20271.57	Currituck	5	SR 1376	FROM SR 1353 TO END	0.23	20	*						
1CR.20271.58	Currituck	6	SR 1355	FROM SR 1353 TO END	0.18	20	*						
1CR.20271.59	Currituck	7	SR 1351	FROM SR 1216 TO END	0.20	20	*						
1CR.20271.60	Currituck	8	SR 1352	FROM SR 1353 TO SR 1351	0.16	20	*						
1CR.20271.61	Currituck	9	SR 1329	FROM SR 1216 TO SR 1328	0.12	18	*						
1CR.20271.62	Currituck	10	SR 1330	FROM SR 1328 TO END	0.13	18	*						
1CR.20271.63	Currituck	11	SR 1328	FROM SR 1330 TO SR 1326	0.16	18	*						
1CR.20271.64	Currituck	12	SR 1326	FROM SR 1328 TO SR1216	0.14	18	*						
1CR.20271.65	Currituck	13	SR 1327	FROM SR 1328 TO END	0.17	18	*						
1CR.20271.66	Currituck	14	SR 1363	FROM SR 1216 TO END	0.27	20	*						
1CR.20271.67	Currituck	15	SR 1214	FROM NC 168 TO SR 1222	2.29	20	*	24,640	15,114			24,640	15,114
1CR.20701.77	Pasquotank	16	SR 1116	FROM SR 1117 TO SR 1103	1.70	18	*	18,292	11,220			18,292	11,220
1CR.20701.78	Pasquotank	17	SR 1366	FROM SR 1360 TO SR 1360	1.60	18	*	17,216	10,560			17,216	10,560
1CR.20701.79	Pasquotank	18	SR 1141	FROM SR 1142 TO SR 1140	1.20	18	*	12,912	7,920			12,912	7,920
1CR.20701.80	Pasquotank	19	SR 1101	FROM HALLSTEAD BLVD TO CURB & GUTTER	0.09	30	*	550	940			550	940
1CR.20701.80	Pasquotank	20	SR 1101	FROM CURB & GUTTER TO SINGLE CURB & GUTTER	0.17	32	*		1,800	464	12		1,800
1CR.20701.80	Pasquotank	21	SR 1101	SINGLE CURB & GUTTER TO NEW PAVEMENT	0.08	28	*		900				900
<b>GRAND TOTAL</b>					<b>13.10</b>		<b>1</b>	<b>106,966</b>	<b>68,914</b>	<b>464</b>	<b>12</b>	<b>106,966</b>	<b>68,914</b>