

TIP NO.	SHEET NO.
B-4599	PMP-1
APPROVED: <i>[Signature]</i>	
DATE: 5/16/12	
SEAL	

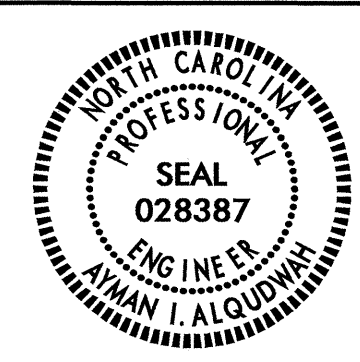

**STATE OF NORTH CAROLINA  
DEPARTMENT OF TRANSPORTATION**

**PAVEMENT MARKING PLAN  
PASQUOTANK COUNTY**

**LOCATION: BRIDGE No. 1 & 2 OVER KNOBBS CREEK ON US 17 /US 158.**

**CONTRACT: C202823 T.I.P.: B-4599**

**ROADWAY STANDARD DRAWING**

THE FOLLOWING ROADWAY STANDARDS AS APPEAR IN "ROADWAY STANDARD DRAWINGS" - PROJECT SERVICES UNIT - N.C. DEPARTMENT OF TRANSPORTATION - RALEIGH, N.C., DATED JANUARY 2012 ARE APPLICABLE TO THIS PROJECT AND BY REFERENCE HEREBY ARE CONSIDERED A PART OF THESE PLANS:

STD. NO.	TITLE
1205.01	PAVEMENT MARKINGS - LINE TYPES AND OFFSETS
1205.02	PAVEMENT MARKINGS - 2 LANE AND MULTILANE ROADWAYS
1205.04	PAVEMENT MARKINGS NON-SIGNALIZED & SIGNALIZED INTERSECTION
1205.05	PAVEMENT MARKINGS TURN LANES
1205.08	PAVEMENT MARKINGS - STANDARD ALPHABET AND SYMBOLS
1205.09	PAINTED ISLAND
1205.11	PAVEMENT MARKERS - RAILROAD CROSSINGS
1205.12	PAVEMENT MARKERS - BRIDGES
1250.01	RAISED PAVEMENT MARKERS INSTALLATION SPACING
1251.01	RAISED PAVEMENT MARKERS
1253.01	RAISED PAVEMENT MARKERS SNOWPLOWABLE
1261.01	GUARDRAIL AND BARRIER DELINEATOR SPACING
1261.02	GUARDRAIL AND BARRIER DELINEATOR TYPES
1262.01	GUARDRAIL END DELINEATION

**GENERAL NOTES**

THE FOLLOWING GENERAL NOTES APPLY AT ALL TIMES FOR THE DURATION OF THE CONSTRUCTION PROJECT, EXCEPT WHEN OTHERWISE NOTED IN THE PLAN, OR DIRECTED BY THE ENGINEER.

- A) INSTALL PAVEMENT MARKINGS AND PAVEMENT MARKERS ON THE FINAL SURFACE AS FOLLOWS:
- | ROAD NAME     | MARKING                  | MARKER         |
|---------------|--------------------------|----------------|
| US 17/ US 158 | POLYUREA & THERMOPLASTIC | RASIED MARKERS |
| BRIDGES       | POLYUREA                 | RASIED MARKERS |
| WORD MESSAGES | COLD APPLIED PLASTIC.    |                |
- B) TIE PROPOSED PAVEMENT MARKING LINES TO EXISTING PAVEMENT MARKING LINES.  
C) REMOVE/REPLACE ANY CONFLICTING/DAMAGED PAVEMENT MARKINGS AND MARKERS.  
D) PASSING ZONES WILL BE DETERMINED IN THE FIELD AND MUST BE APPROVED BY THE ENGINEER.  
E)\* USE HEATED IN PLACE THERMOPLASTIC OR EXTRUDED THERMOPLASTIC FOR SYMBOLS, CHARCTERS, DIAGONALS, STOPBARS & RR SYMBOLS.  
F)\* REMOVE ALL RESIDUE & SURFACE LATANCE BY ACCEPTABLE METHODS ON THE BRIDGE DECK PRIOR TO PLACING COLD APPLIED PLASTIC PAVEMENT MARKINGS

Pavement Marking Schedule  
TIP Project # B-4599

SYMBOL	DESCRIPTION
FINAL	
PAVEMENT MARKINGS	
POLYUREA/STD. BEADS (4")	
VA	WHITE EDGELINE
VB	YELLOW EDGELINE
VC	10FT. WHITE SKIP
VD	2FT.-9FT./SP WHITE MINISKIP
VE	WHITE SOLID LANE LINE
VF	10FT. YELLOW SKIP
VH	YELLOW SINGLE CENTER
VI	YELLOW DOUBLE CENTER
V8	2'-6'/SP MINI-SKIP LINE
COLD APPLIED PLASTIC TYPE II OR III	
C1	WHITE LINE, RR (16")
C2	WHITE STOPBAR (24")
CV	YELLOW DIAGONAL (12")

Pavement Marking Schedule

SYMBOL	DESCRIPTION
FINAL	
THERMOPLASTIC PAVEMENT MARKING SYMBOLS (90 MILS)	
UA	LEFT TURN ARROW
UB	RIGHT TURN ARROW
UC	STRAIGHT ARROW
UI	ALPHANUMERIC
PERMANENT RAISED PAVEMENT MARKERS	
MA	YELLOW & YELLOW

**PLAN PREPARED BY: N.C.D.O.T. SIGNING AND DELINEATION UNIT**

**A. ALQUODWAH, P.E.** SIGNING & DELINEATION REGIONAL ENGINEER  
**BARRY NOWLIN** SIGNING & DELINEATION DESIGN TECHNICIAN

**INDEX**

SHEET NO.	DESCRIPTION
PMP-1	PAVEMENT MARKING PLAN TITLE SHEET
PMP-2 & 3	PAVEMENT MARKING SCHEDULE & DETAIL

REFER TO RSD NOS. 1205.01, 1205.02, 1205.08, 1205.11, 1205.12, 1250.01, 1251.01 FOR PLACEMENT OF FINAL PAVEMENT MARKINGS AND MARKERS UNLESS NOTED OTHERWISE.

TIP NO. B-4599	SHEET NO. PMP-2
APPROVED: <i>[Signature]</i>	
DATE: 5/15/12	
SEAL	

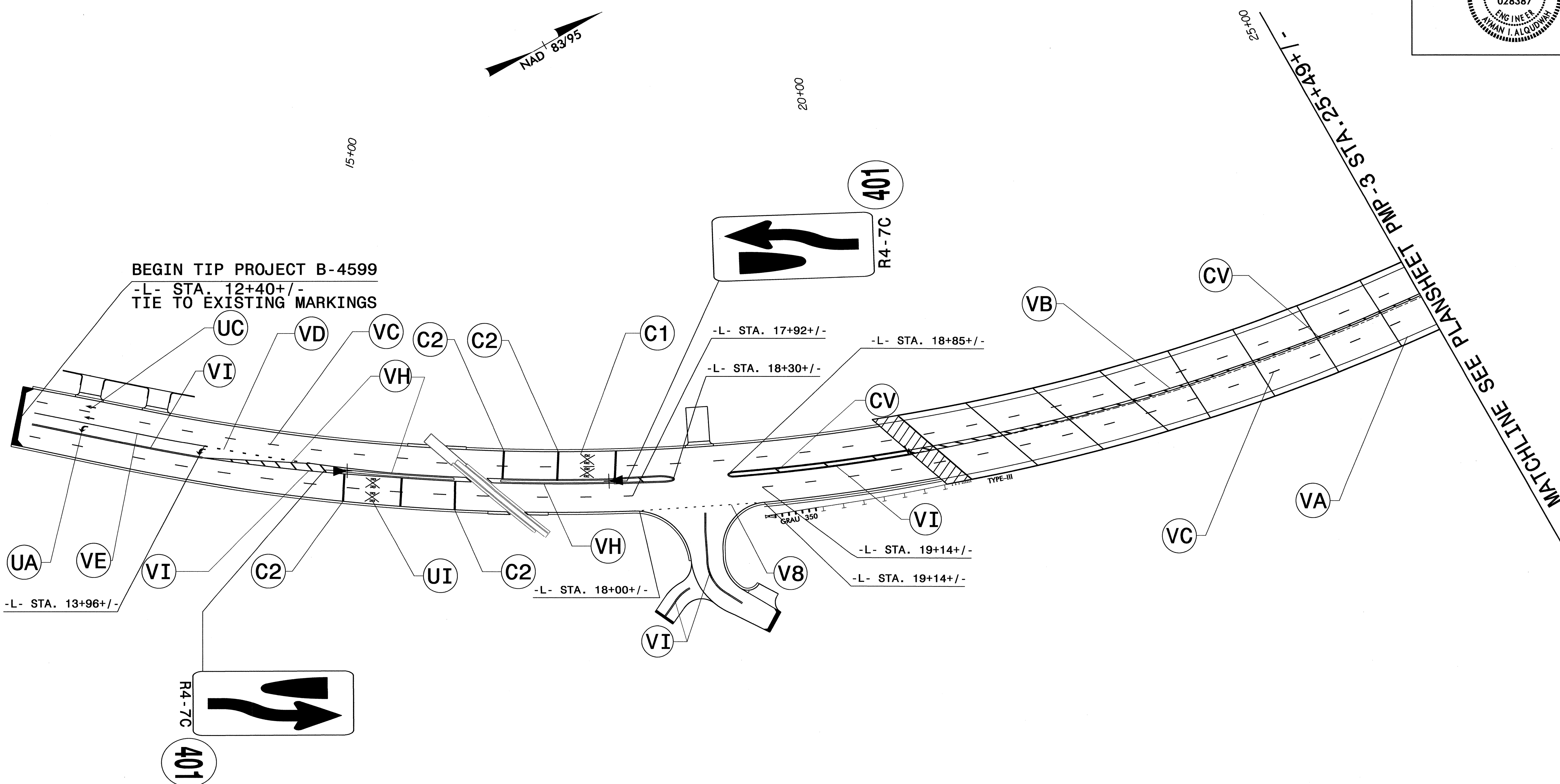

FINAL PAVEMENT MARKING

15-MAY-2012 08:02  
 H:\Projects\125101\125101\_PMP-2.dgn  
 125101\_PMP-2.dwg

REFER TO RSD NOS. 1205.01, 1205.02, 1205.08, 1205.12, 1250.01 FOR PLACEMENT OF FINAL PAVEMENT MARKINGS AND MARKERS UNLESS NOTED OTHERWISE.

TIP NO. B-4599	SHEET NO. PMP-3
APPROVED: <i>[Signature]</i>	
DATE: 5/15/12	
SEAL	

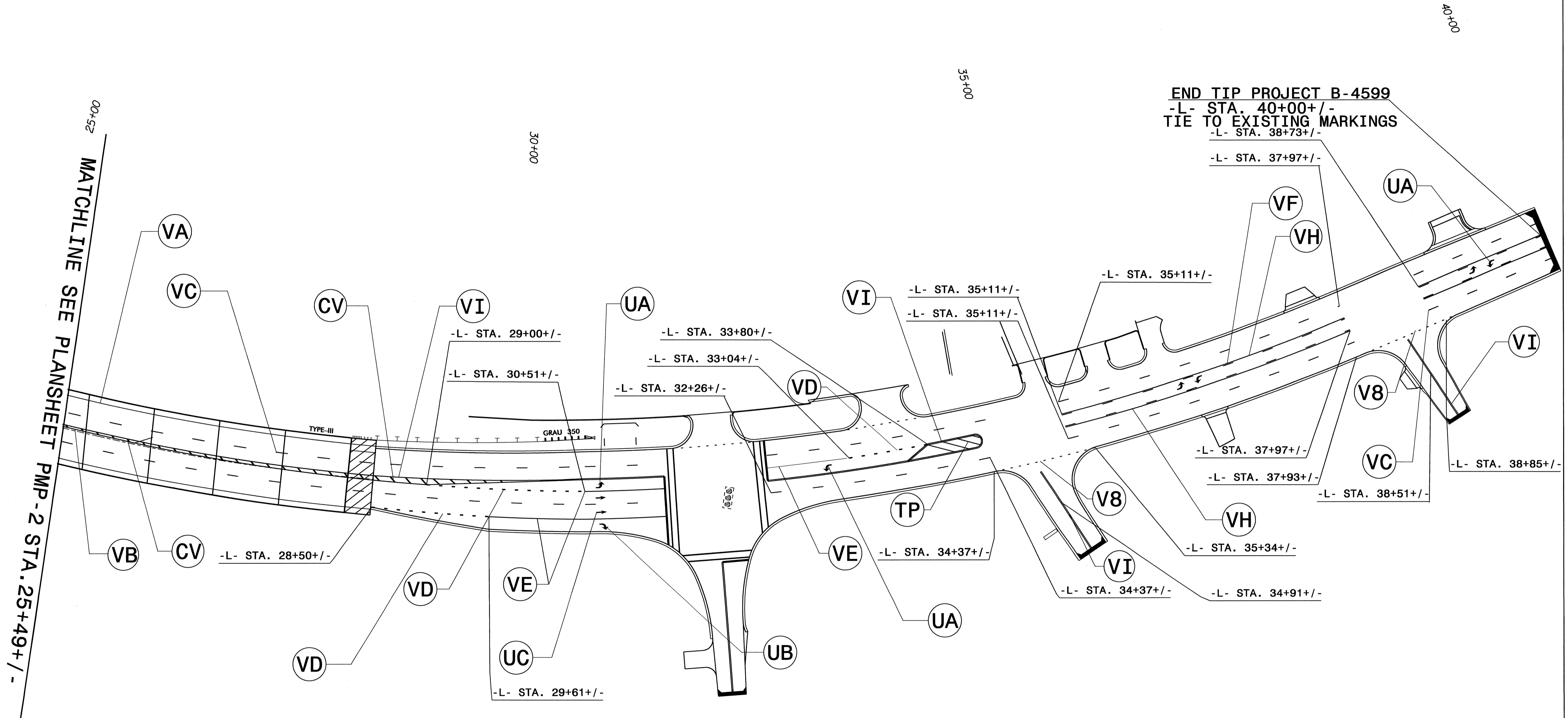
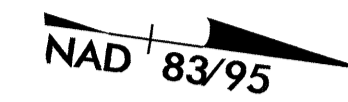

END TIP PROJECT B-4599  
-L- STA. 40+00+/-  
TIE TO EXISTING MARKINGS  
-L- STA. 38+73+/-

PAVEMENT MARKING  
SCHEDULE & DETAIL