

09/08/99

TIP PROJECT: B-4668

See Sheet I-A For Index of Sheets  
See Sheet I-B For Conventional Symbols

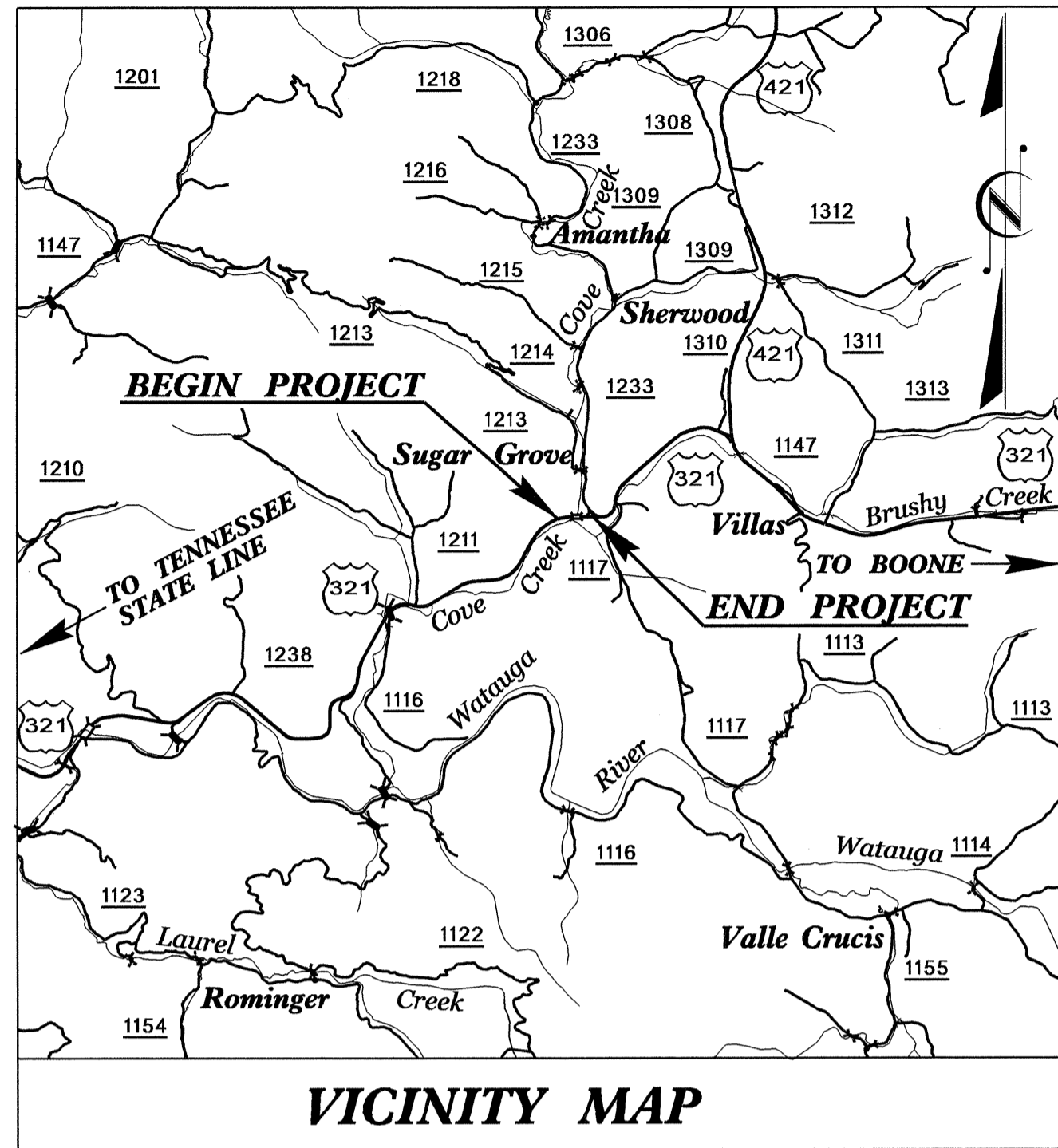

VICINITY MAP

# STATE OF NORTH CAROLINA DIVISION OF HIGHWAYS

## UTILITIES BY OTHERS PLANS WATAUGA COUNTY

LOCATION: BRIDGE NO. 29 OVER COVE CREEK ON US 321  
TYPE OF WORK: POWER, TELEPHONE AND CABLE TV RELOCATION

T.I.P. NO.	SHEET NO.
B-4668	UO-1

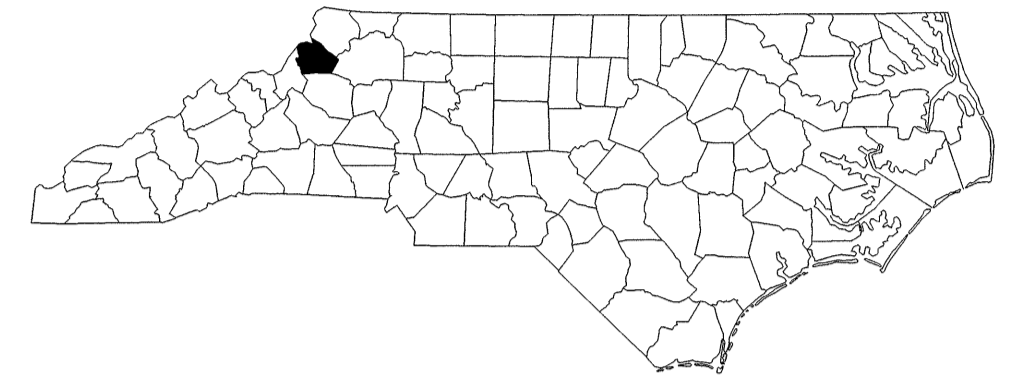
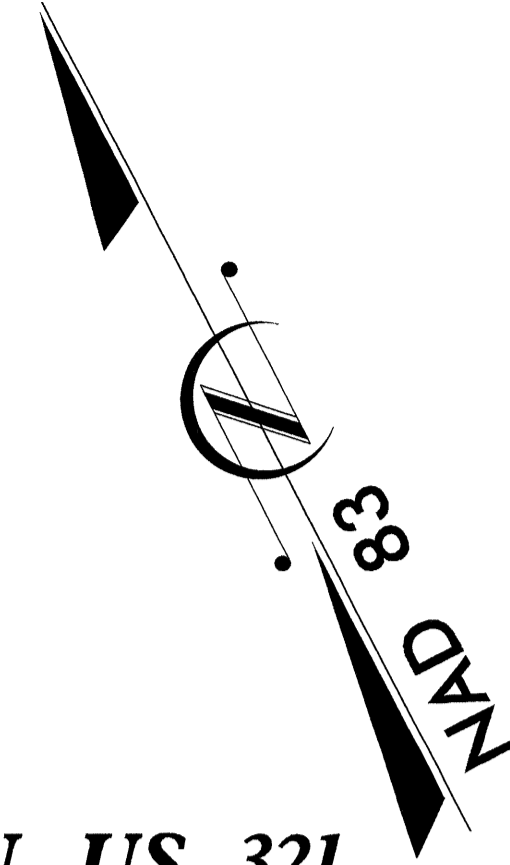

UO-2

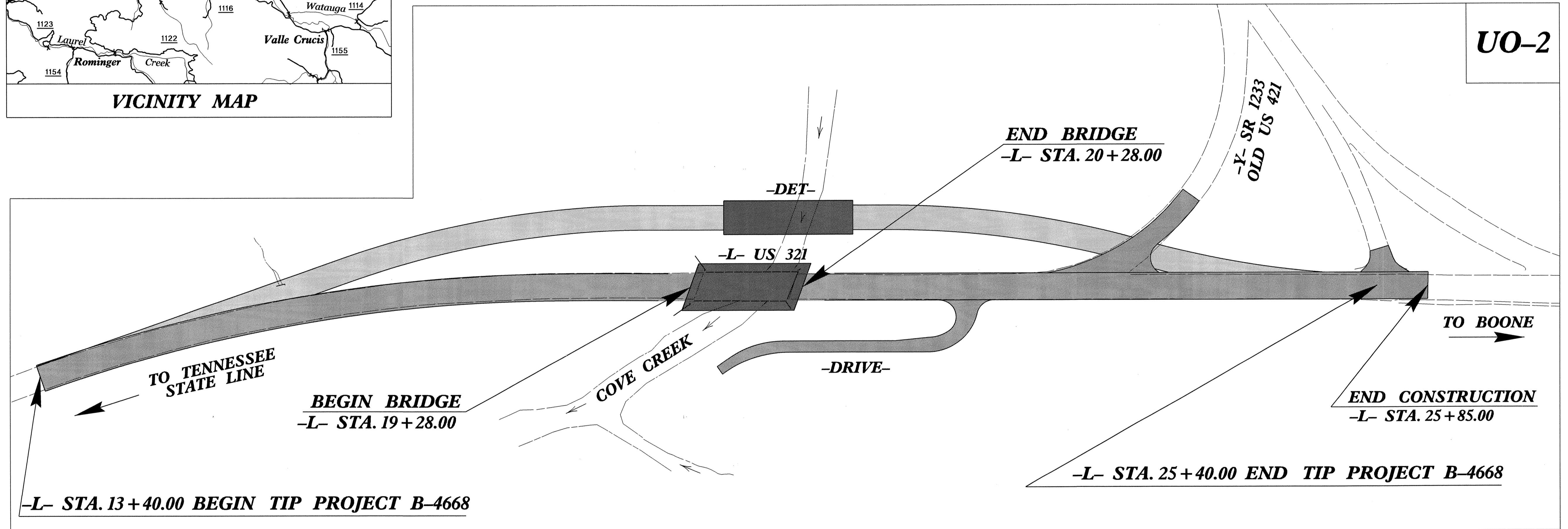

CLEARING ON THIS PROJECT SHALL BE PERFORMED TO THE LIMITS ESTABLISHED BY METHOD III.  
THIS PROJECT IS NOT WITHIN ANY MUNICIPAL BOUNDARIES.

### GRAPHIC SCALES

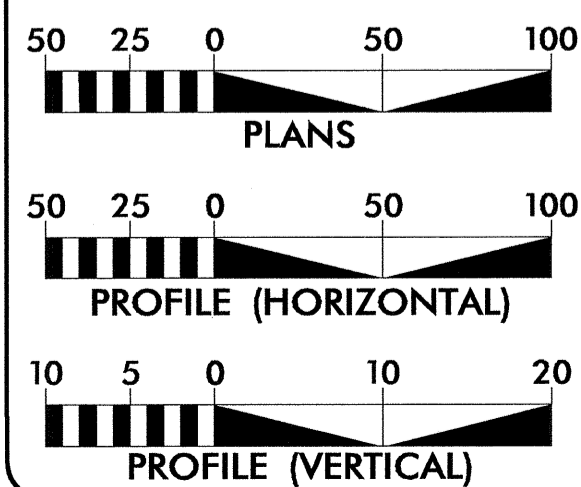

### INDEX OF SHEETS

SHEET NO.	DESCRIPTION
UO-1	TITLE SHEET
UO-2	UTILITY BY OTHERS PLAN SHEETS

### UTILITY OWNERS ON PROJECT

- (1) BLUE RIDGE EMC POWER
- (2) SKYLINE TELEPHONE
- (3) CHARTER COMMUNICATIONS CABLE TV

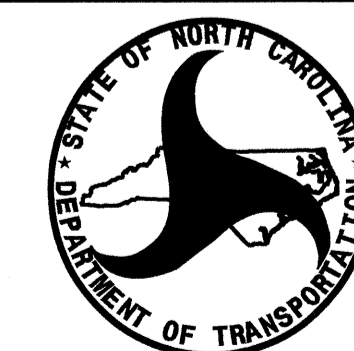

PREPARED IN THE OFFICE OF:  
DIVISION OF HIGHWAYS  
UTILITIES ENGINEERING  
SECTION

1591 MAIL SERVICES CENTER  
RALEIGH NC 27699-1591  
PHONE (919) 707-6690  
FAX (919) 250-4151

Roger Worthington, P.E. UTILITIES SECTION ENGINEER  
 Carl Barclay, P.E. UTILITIES SQUAD LEADER PROJECT ENGINEER  
 Ali Koucheki, PE UTILITIES PROJECT DESIGNER

01-FEB-2012 08:00  
P:\Utilities\rdy\UH\Proj\B4668\_rdy\_tsh.dgn  
\$\$\$\$\$USERNAME\$\$\$\$\$

UTILITIES BY OTHERS

NOTE:  
ALL PROPOSED UTILITY WORK SHOWN ON THIS SHEET WILL BE DONE BY OTHERS

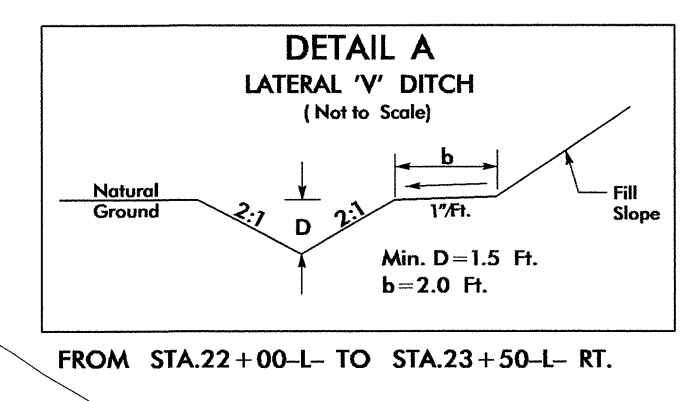
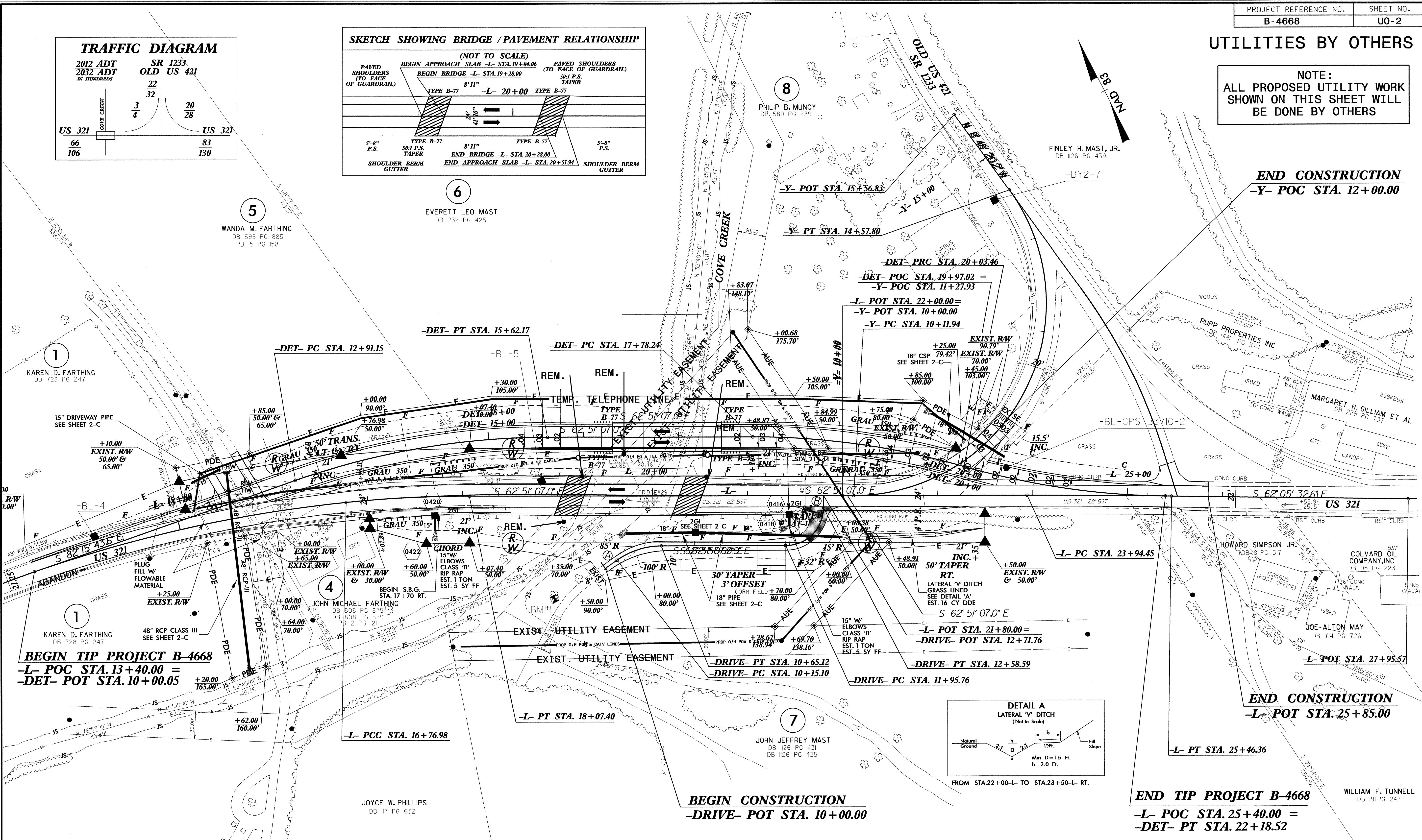
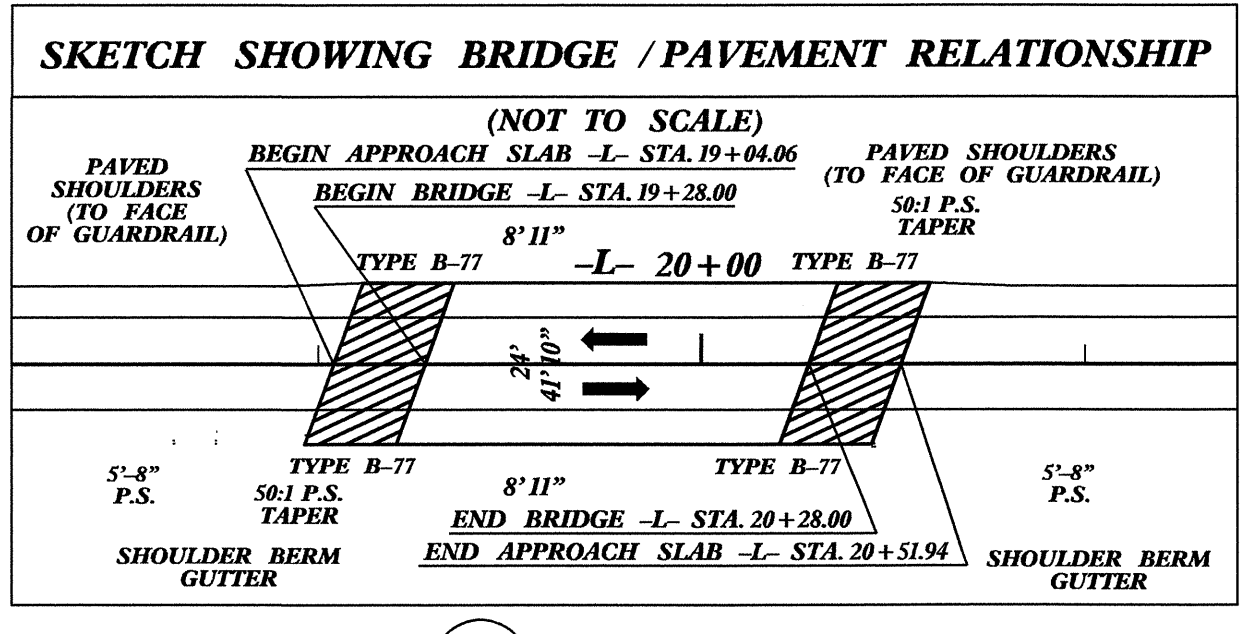
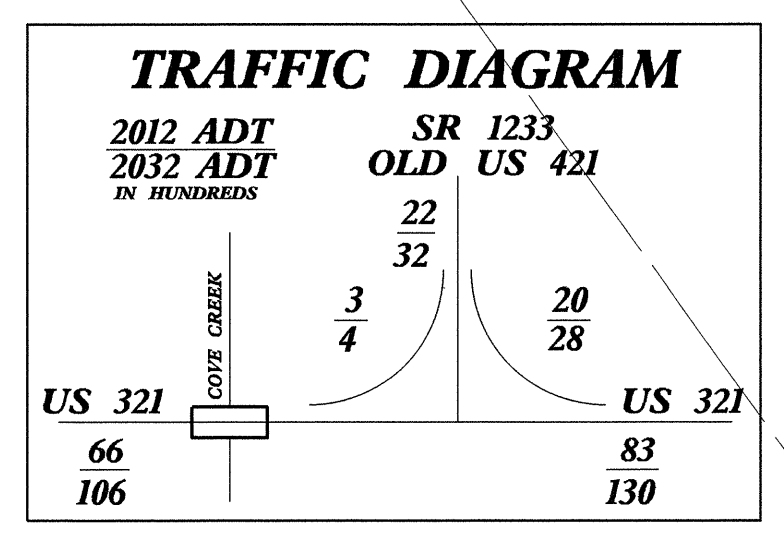

-L-			-DET-			-Y-			-DRIVE-		
PI Sta 13+53.05	PI Sta 17+42.25	PI Sta 24+70.41	PI Sta 14+27.97	PI Sta 18+91.60	PI Sta 21+11.64	PI Sta 14+09.59	PI Sta 10+40.96	PI Sta 12+35.76	PI Sta 10+40.96	PI Sta 12+35.76	PI Sta 12+35.76
PC Sta 10+17.06	$\Delta = 5' 51' 39.5''$ (RT)	$\Delta = 0' 45' 34.4''$ (RT)	$\Delta = 19' 24' 36.6''$ (RT)	$\Delta = 16' 07' 49.4''$ (RT)	$S 62' 07' 27.17''$ E (AHEAD)	$\Delta = 125' 57' 13.2''$ (LT)	$\Delta = 35' 49' 34.3''$ (RT)	$\Delta = 90' 00' 00.0''$ (LT)	$\Delta = 35' 49' 34.3''$ (RT)	$\Delta = 90' 00' 00.0''$ (LT)	$\Delta = 90' 00' 00.0''$ (LT)
$N 84' 45' 11.37''$ E (BACK)	$D = 4' 29' 37.6''$	$D = 0' 30' 00.0''$	$D = 7' 09' 43.1''$	$D = 7' 09' 43.1''$	$L = 225.22'$	$D = 28' 15' 00.0''$	$D = 7' 37' 11.0''$	$D = 143' 14' 22.0''$	$D = 7' 37' 11.0''$	$D = 143' 14' 22.0''$	$D = 143' 14' 22.0''$
$L = 130.42'$	$L = 151.91'$	$L = 151.91'$	$L = 271.02'$	$L = 225.22'$	$L = 215.06'$	$L = 445.85'$	$L = 50.02'$	$L = 62.83'$	$L = 50.02'$	$L = 62.83'$	$L = 62.83'$
$D = 4' 01' 14.7''$	$T = 65.27'$	$T = 75.96'$	$T = 136.82'$	$T = 113.36'$	$T = 202.82'$	$T = 397.65'$	$T = 25.86'$	$T = 40.00'$	$T = 25.86'$	$T = 40.00'$	$T = 40.00'$
$L = 659.92'$	$R = 1,275.00'$	$R = 1,145.916'$	$R = 800.00'$	$R = 800.00'$	$R = 108.18'$	$R = 800.00'$	$R = 800.00'$	$R = 800.00'$	$R = 800.00'$	$R = 800.00'$	$R = 800.00'$
$T = 335.99'$	$SE = 0.04$	$SE = NC$	$SE = 0.04$	$SE = 0.04$	$R = 800.00'$	$SE = SEE PLANS$	$SE = NC$	$SE = NC$	$SE = NC$	$SE = NC$	$SE = NC$
$R = 1,425.00'$	$RO = SEE PLANS$	$RO = SEE PLANS$	$RO = SEE PLANS$	$RO = SEE PLANS$	$SE = SEE PLANS$	$RO = SEE PLANS$	$SE = NC$	$SE = NC$	$SE = NC$	$SE = NC$	$SE = NC$
$SE = 0.04$					$RO = SEE PLANS$		$\textcircled{A} N 8' 19' 18.7''$ E	$\textcircled{B} N 27' 08' 53.0''$ E			
$RO = SEE PLANS$											

**NOTE: INCIDENTAL MILLING AS DIRECTED BY THE ENGINEER FOR STA. -L- 22+25.00 TO 23+15.00.**

**NOTES:**  
1.) FOR -DET- PLAN VIEW SEE SHEET 2-C.  
2.) FOR -L- AND -DET- PROFILE SEE SHEET 5.  
3.) FOR -Y- AND -DRIVE- PROFILE SEE SHEET 6.  
4.) ALL RIGHT OF WAY AND EASEMENTS ARE REFERENCED FROM -L-.  
5.) ALL DRIVEWAY RADII ARE 10' UNLESS NOTED OTHERWISE ON PLANS.  
6.) FOR STRUCTURE PLANS SEE SHEETS S-1 THRU S-XX.

5/14/99  
31-JAN-2012 15:34  
R:\Users\mrb\Projects\B-4668-rdu-psh-04.dgn