

STATE	PROJECT NO.	SHEET NO.	TOTAL SHEETS
N.C.	IOCR.10901.29	1	
F.A. PROJECT NO.			

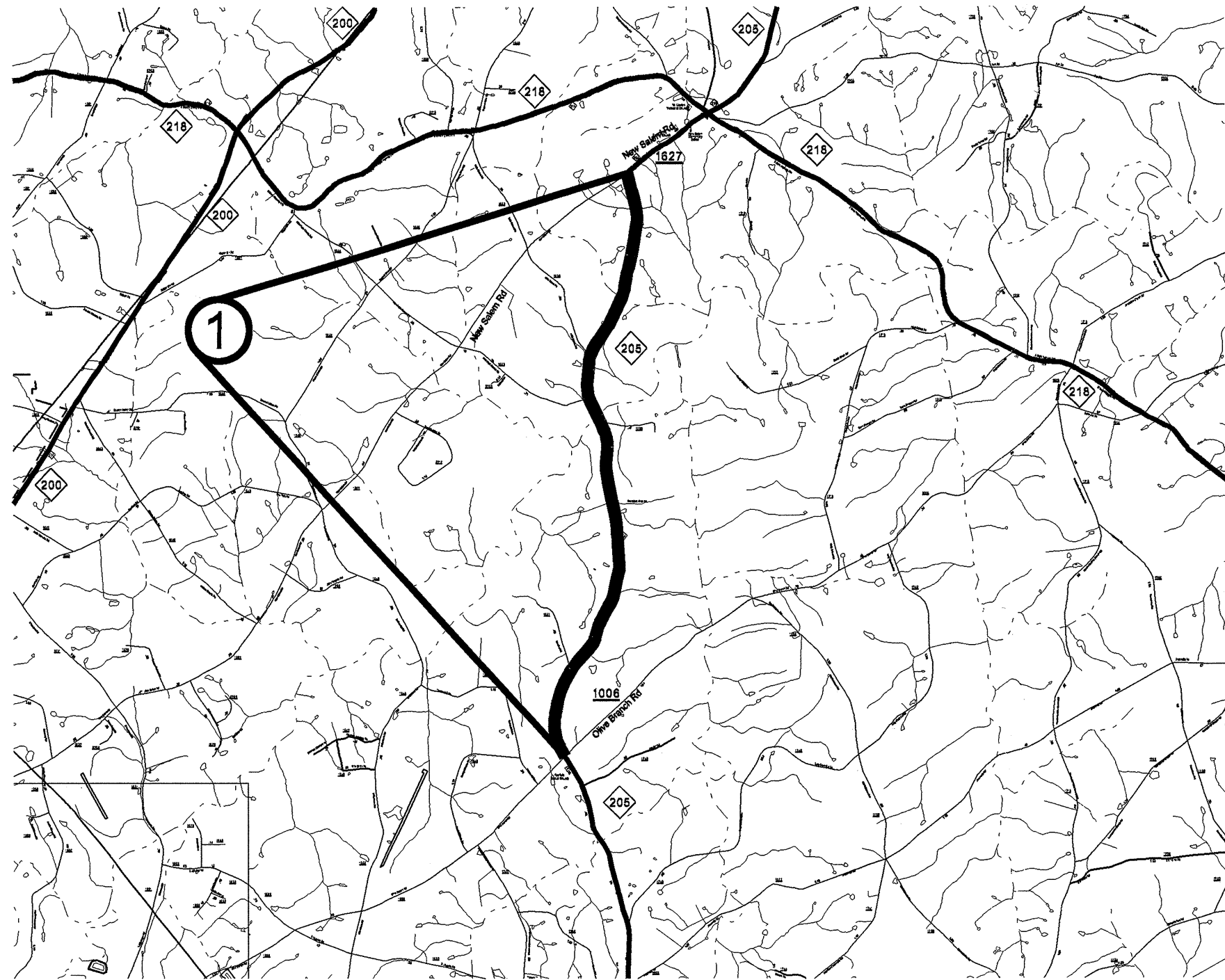

ENLARGED MUNICIPAL AND SUBURBAN AREAS
UNION COUNTY
 NORTH CAROLINA
PREPARED BY THE
 NORTH CAROLINA DEPARTMENT OF TRANSPORTATION
 DIVISION OF HIGHWAYS - DIVISION 10 DISTRICT 3

MAP #1 HWY 205
4.67 MILES

**FROM THE PAVEMENT JOINT AT SR-1006
 (OLIVE BRANCH RD) TO SR-1627 (NEW SALEM RD)**

STATE	PROJECT NO.	SHEET NO.	TOTAL SHEETS
N.C.	IOCR.I090I.30	2	
F.A. PROJECT NO.			

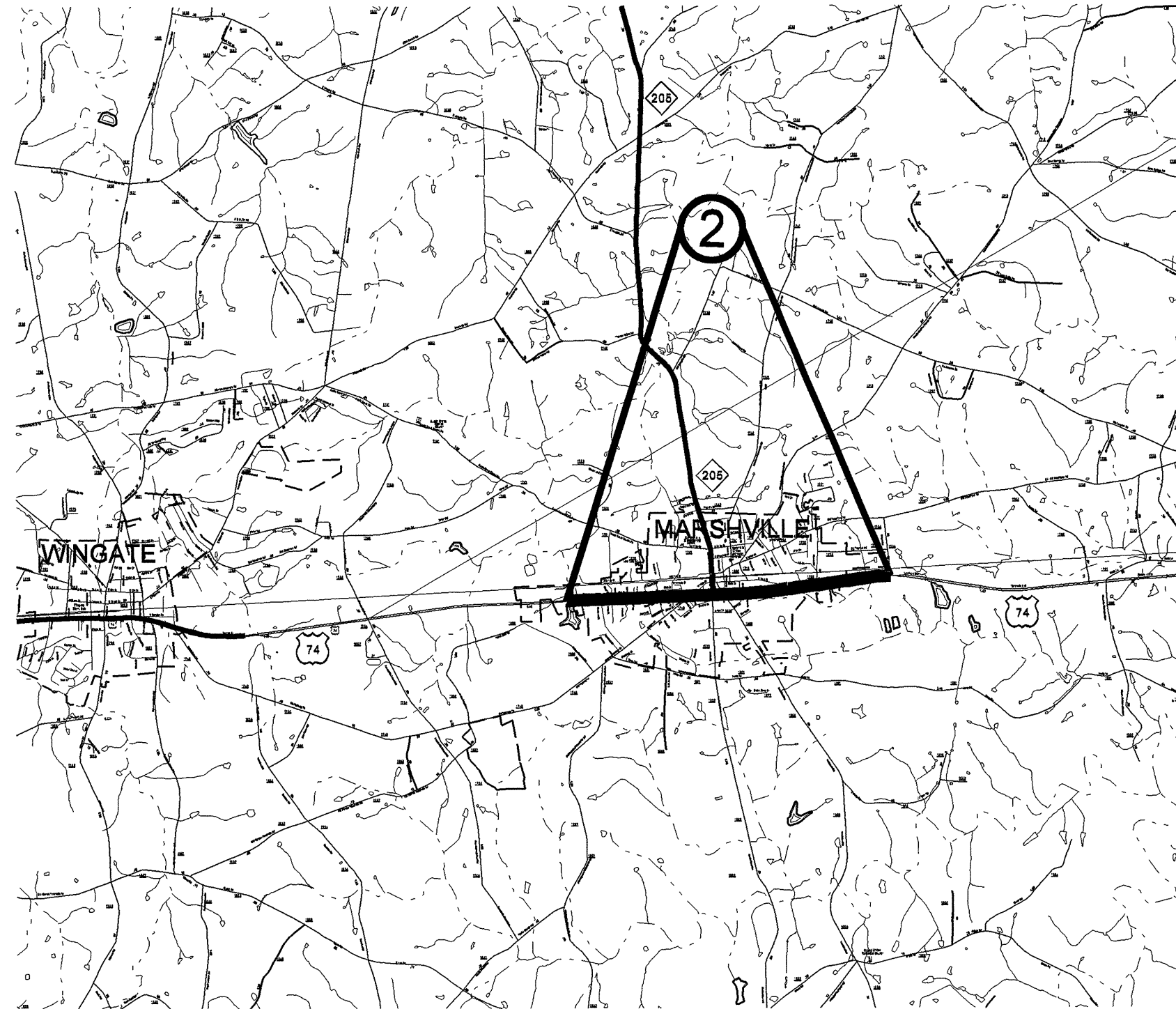



ENLARGED MUNICIPAL AND SUBURBAN AREAS
UNION COUNTY
 NORTH CAROLINA
PREPARED BY THE
 NORTH CAROLINA DEPARTMENT OF TRANSPORTATION
 DIVISION OF HIGHWAYS - DIVISION 10 DISTRICT 3

MAP #2 US 74 WBL
2.46 MILES

**FROM THE BEGINNING OF THE C&G TO THE
 END OF THE C&G IN THE CITY LIMITS OF
 MARSHVILLE**

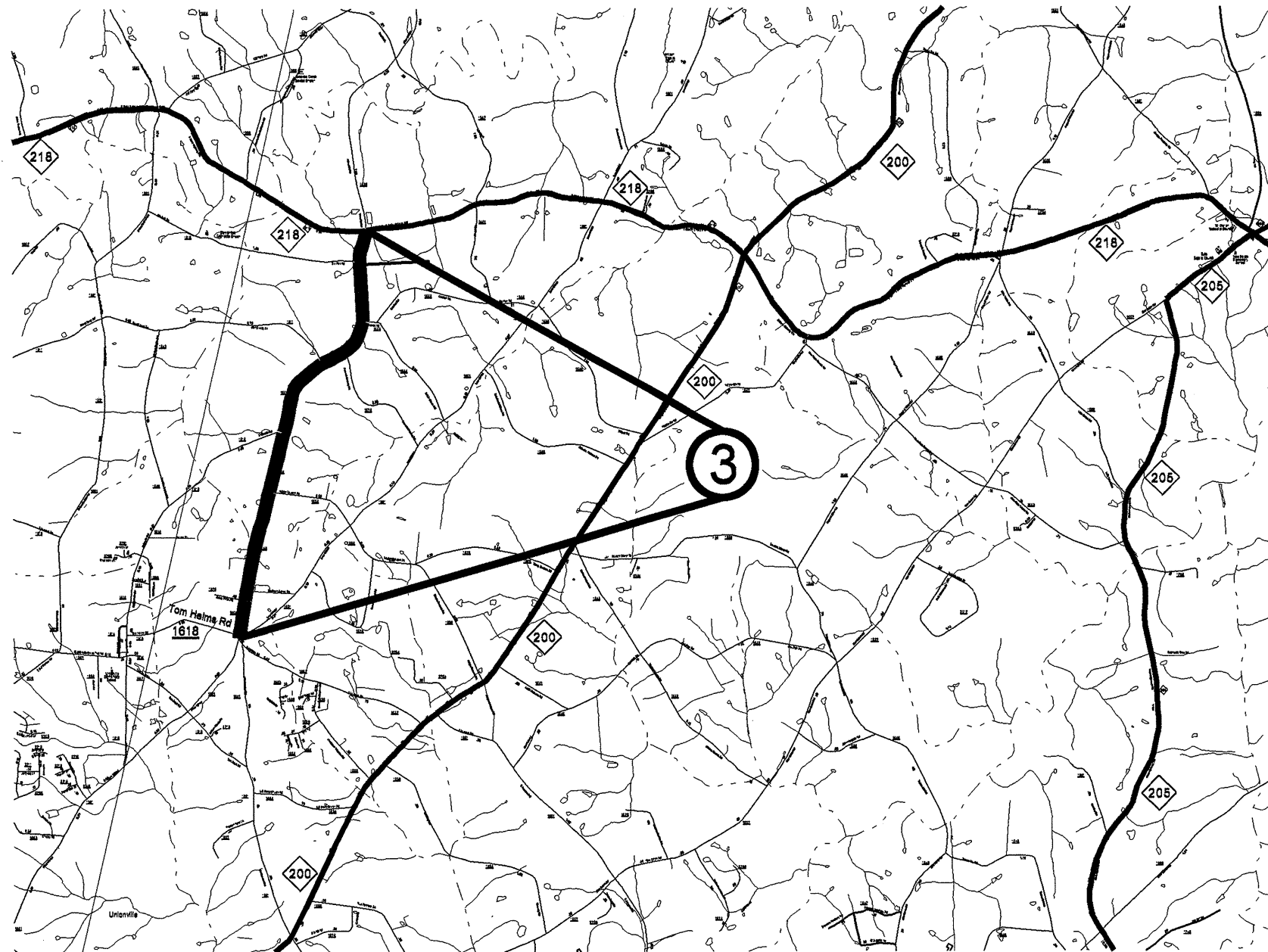
STATE	PROJECT NO.	SHEET NO.	TOTAL SHEETS
N.C.	IOCR.20901.72	3	
F.A. PROJECT NO.			





 ENLARGED MUNICIPAL AND SUBURBAN AREAS
UNION COUNTY
 NORTH CAROLINA
PREPARED BY THE
 NORTH CAROLINA DEPARTMENT OF TRANSPORTATION
 DIVISION OF HIGHWAYS - DIVISION 10 DISTRICT 3

MAP #3 SR-1606 (SIKES MILL RD)
3.14 MILES

FROM THE PAVEMENT JOINT AT HWY 218
TO THE PAVEMENT JOINT AT SR-1618
(TOM HELMS RD)

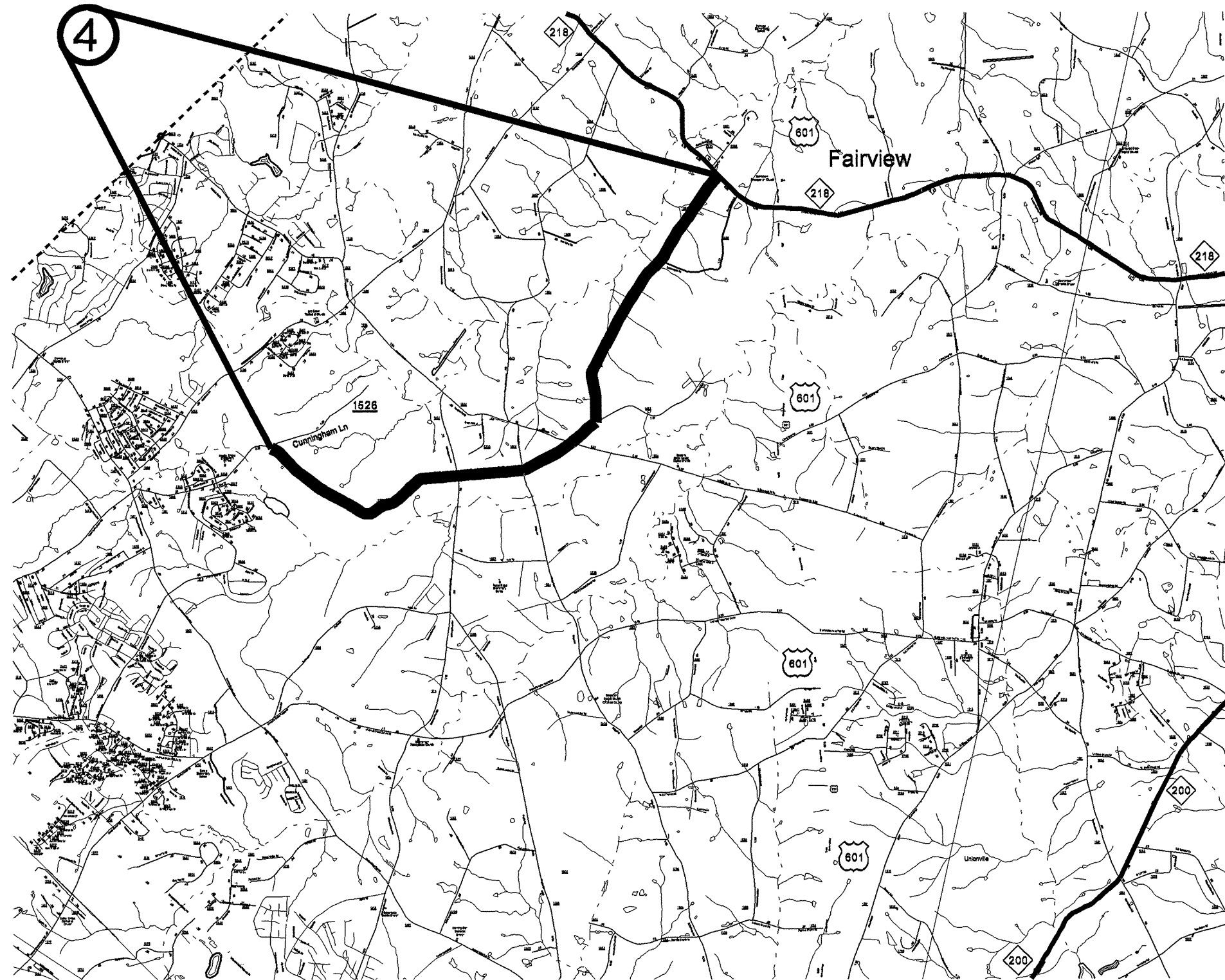
STATE	PROJECT NO.	SHEET NO.	TOTAL SHEETS
N.C.	IOCR.20901.73	4	
F.A. PROJECT NO.			



ENLARGED MUNICIPAL AND SUBURBAN AREAS
UNION COUNTY
 NORTH CAROLINA
PREPARED BY THE
 NORTH CAROLINA DEPARTMENT OF TRANSPORTATION
 DIVISION OF HIGHWAYS - DIVISION 10 DISTRICT 3

MAP #4 SR-1520
(INDIAN TRAIL / FAIRVIEW RD)
5.15 MILES

FROM THE PAVEMENT JOINT AT HWY 218
TO THE PAVEMENT JOINT AT SR-1526
(CUNNINGHAM RD)

STATE	PROJECT NO.	SHEET NO.	TOTAL SHEETS
N.C.	IOCR.20901.74	5	
F.A. PROJECT NO.			

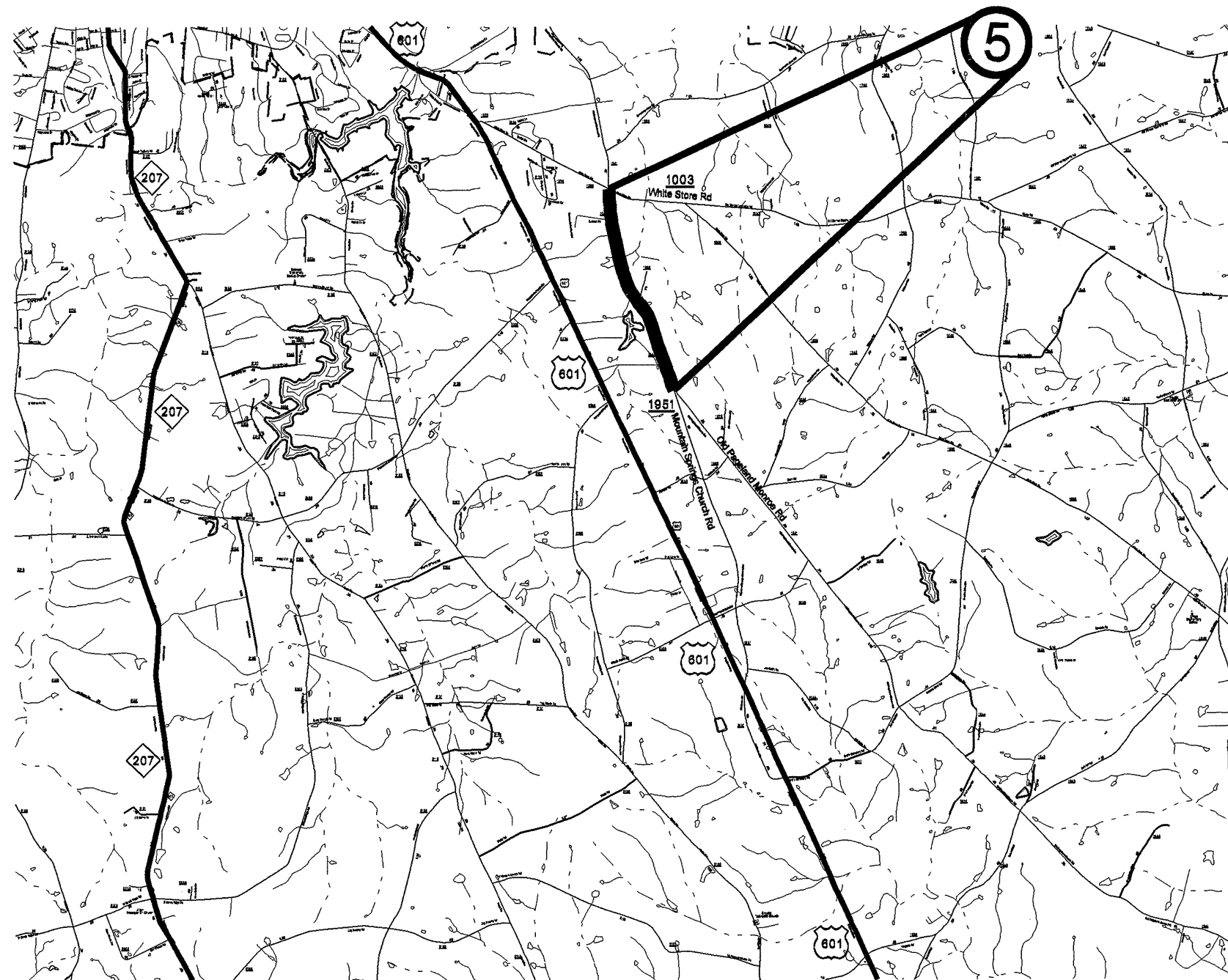

ENLARGED MUNICIPAL AND SUBURBAN AREAS
UNION COUNTY
 NORTH CAROLINA
PREPARED BY THE
 NORTH CAROLINA DEPARTMENT OF TRANSPORTATION
 DIVISION OF HIGHWAYS - DIVISION 10 DISTRICT 3

MAP #5 SR-1941
(OLD PAGELAND / MONROE RD)
 1.37 MILES

FROM THE PAVEMENT JOINT AT SR-1003
(WHITE STORE RD) TO APPROX. 200' PAST
SR-1951 (MT SPRINGS CH RD)

STATE	PROJECT NO.	SHEET NO.	TOTAL SHEETS
N.C.	IOCR.20901.75 IOCR.20901.78 IOCR.20901.80	6	
F.A. PROJECT NO.			



ENLARGED MUNICIPAL AND SUBURBAN AREAS

UNION COUNTY

NORTH CAROLINA

PREPARED BY THE
NORTH CAROLINA DEPARTMENT OF TRANSPORTATION
DIVISION OF HIGHWAYS - DIVISION 10 DISTRICT 3

**MAP #6 SR-1329 (BILLY HOWIE RD)
2.16 MILES**

**FROM SR-1327 (PLEASANT GROVE RD)
TO THE PAVEMENT JOINT AT SR-1008
(WAXHAW / INDIAN TRAIL RD)**

**MAP #9 SR-1008
(WAXHAW / INDIAN TRAIL RD)
0.75 MILES**

**FROM THE PAVEMENT JOINT NORTH
OF HWY 84 TO THE PAVEMENT JOINT
SOUTH OF SR-1346 (BEULAH CH RD)**

**MAP #11 SR-1008
(WAXHAW / INDIAN TRAIL RD)
0.78 MILES**

**FROM THE PAVEMENT JOINT AT HWY 16
TO SR-2677 (DEER CREEK DR)**

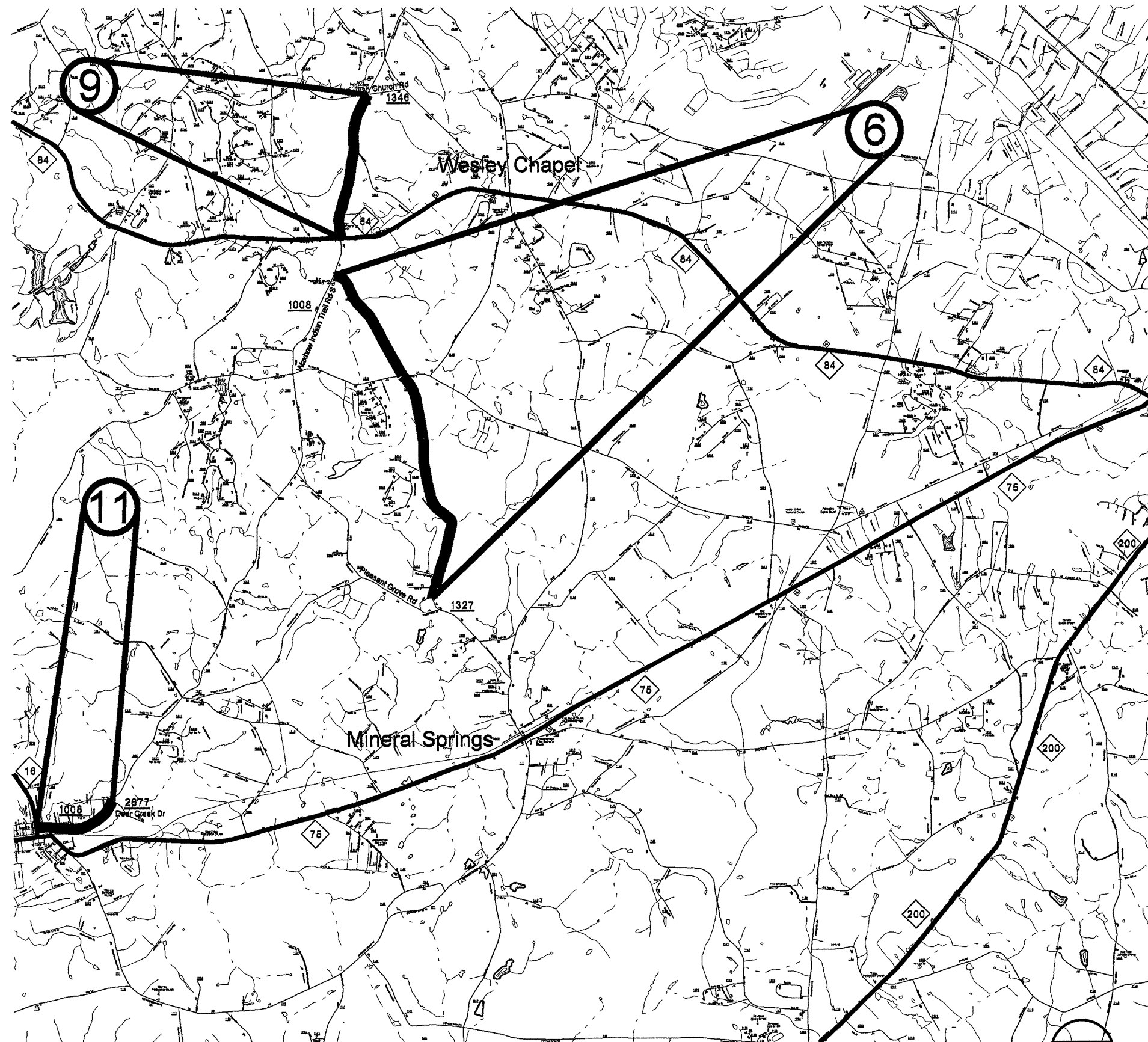

STATE	PROJECT NO.	SHEET NO.	TOTAL SHEETS
N.C.	IOCR.2090I.76 IOCR.2090I.77 IOCR.2090I.79	7	
F.A. PROJECT NO.			



ENLARGED MUNICIPAL AND SUBURBAN AREAS

UNION COUNTY

NORTH CAROLINA

PREPARED BY THE
NORTH CAROLINA DEPARTMENT OF TRANSPORTATION
DIVISION OF HIGHWAYS - DIVISION 10 DISTRICT 3

MAP #7 SR-1344
(MATTHEWS / WEDDINGTON RD)
2.55 MILES

**FROM APPROX 500' FROM HWY 84 TO THE
PAVEMENT JOINT NEAR SR-1498 (AMANDA DR)**

MAP #8 SR-1344
(MATTHEWS / WEDDINGTON RD)
0.53 MILES

**FROM THE PAVEMENT JOINT AT SR-1362 (CHESTNUT LN)
TO THE PAVEMENT JOINT PAST SR-1345
(TILLEY MORRIS RD) ON SR-1344
(MATTHEWS / WEDDINGTON RD)**

MAP #10 SR-1345
(TILLEY MORRIS RD)
0.48 MILES

**FROM SR-1344 (MATTHEWS / WEDDINGTON RD)
TO THE MECKLENBURG COUNTY LINE**

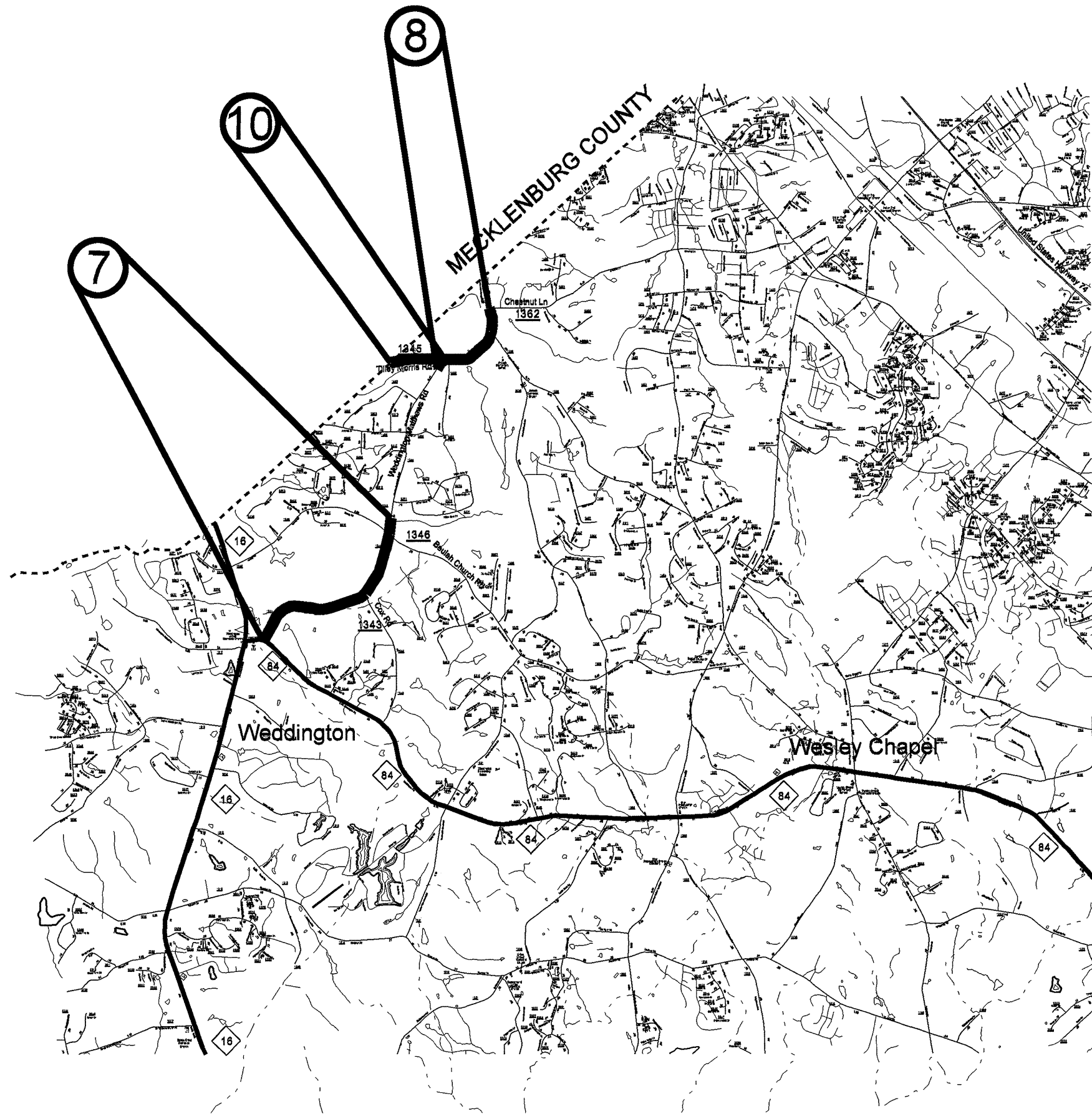

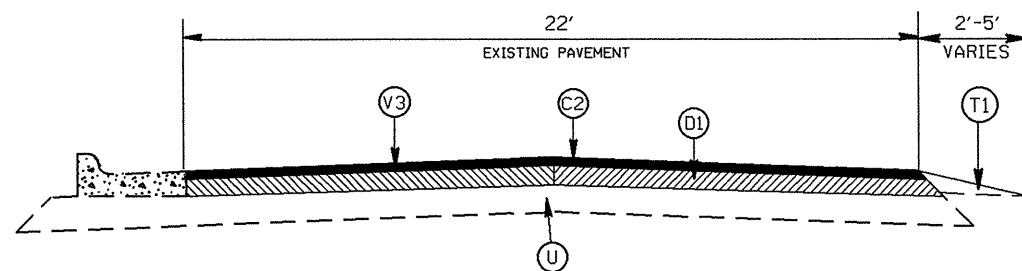

TYPICAL SECTION NO. 3
SR-1008

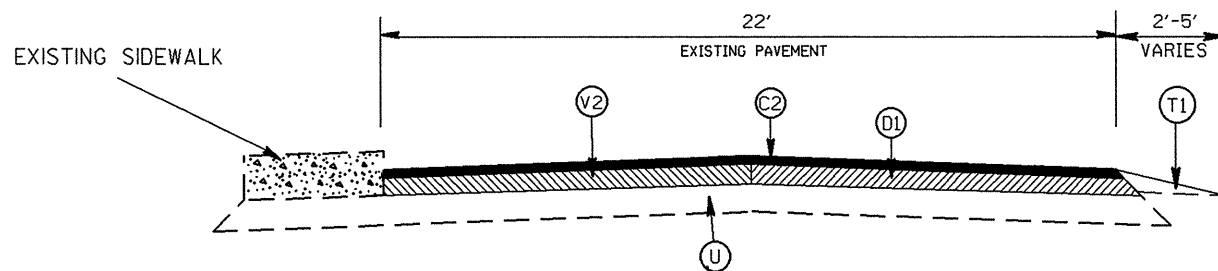

TYPICAL SECTION NO. 2
SR-1008

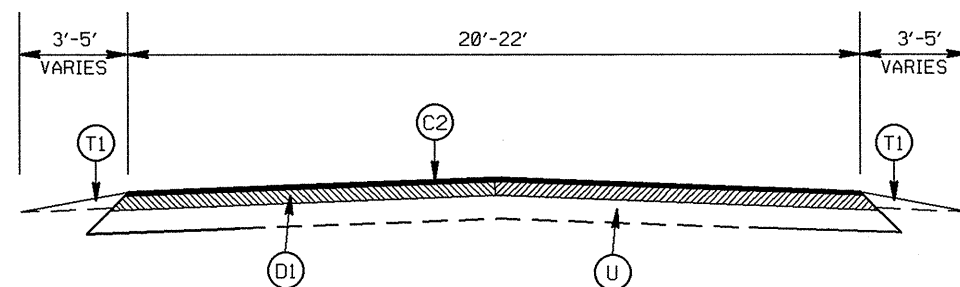

TYPICAL SECTION NO. 1
SR-1941
SR-1008
SR-1606

PATCHING DETAIL

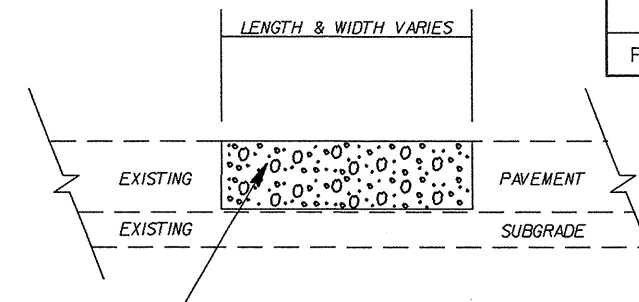

RATE IS VARIABLE AND SHALL BE AS DIRECTED BY THE ENGINEER. ASPHALT TYPE 119.0C SHALL BE PLACED.

STATE	PROJECT NO.	SHEET NO.	TOTAL SHEETS
N.C.	10CR.10901.29-10CR.20901.80	8	
F.A. PROJECT NO.			

PAVEMENT SCHEDULE

(C1)	PROP. APPROX. 1.5" ASPHALT CONC. SURFACE COURSE, TYPE S9.5C, AT AN AVERAGE RATE OF 168 LBS. PER SQ. YD.
(C2)	PROP. APPROX. 1.5" ASPHALT CONC. SURFACE COURSE, TYPE S9.5B, AT AN AVERAGE RATE OF 168 LBS. PER SQ. YD.
(D1)	PROP. APPROX. 2.5" ASPHALT CONC. INTERMEDIATE COURSE, TYPE I19.0B, AT AN AVERAGE RATE OF 285 LBS. PER SQ. YD.
(E1)	PROP. APPROX. 5.0" ASPHALT CONC. BASE COURSE, TYPE B25.0B, AT AN AVERAGE RATE OF 570 LBS. PER SQ. YD.
(E2)	PROP. APPROX. 8.0" ASPHALT CONC. BASE COURSE, TYPE B25.0B, AT AN AVERAGE RATE OF 456 LBS. PER SQ. YD. IN EACH OF TWO LAYERS.
(T1)	SHOULDER RECONSTRUCTION
(T2)	SHOULDER CONSTRUCTION
(U)	EXISTING PAVEMENT
(V1)	MILLING OF EXISTING PAVEMENT, 1.5" IN DEPTH
(V2)	MILLING OF EXISTING PAVEMENT, 2.5" IN DEPTH
(V3)	MILLING OF EXISTING PAVEMENT, 4" IN DEPTH
(V4)	MILLING 6" OF EXISTING PAVEMENT, 5" IN DEPTH. (SEE S.P. FOR "TRENCHING FOR BASE COURSE BY MILLING.")
(V5)	MILLING 6" OF EXISTING PAVEMENT, 8" IN DEPTH. (SEE S.P. FOR "TRENCHING FOR BASE COURSE BY MILLING.")

- NOTES: 1: LEVELING COURSE TO BE PLACED AT LOCATIONS AS DIRECTED BY THE ENGINEER.
 2: DO NOT RESURFACE OVER AREAS WITH NEW ASPHALT ON MAPS #4, #5, #6, #7, AND #8
 3: MAPS #2 AND #6 CONTAIN TRAFFIC LOOPS. CONTACT DIVISION TRAFFIC SERVICES.
 4: ON MAP #8, RESURFACE AROUND THE EXISTING CONCRETE ISLANDS TO THE PAVEMENT JOINT ON SR-1344 (WAXHAW/INDIAN TRAIL RD)
 5: ON MAP #10, DO NOT WIDEN THROUGH THE TURN LANE.

2012-2013 UNION COUNTY
RESURFACING

SCALE	-NA-		REVISIONS
DATE	1/12		
DWG. BY	JAB		
DESIGN BY	JAB		
APPROVED	JWU		

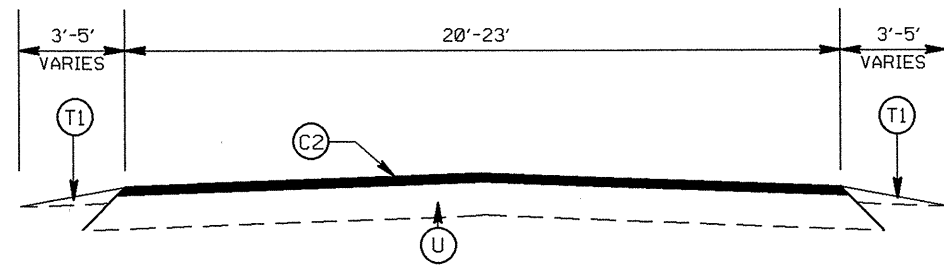

TYPICAL SECTION NO. 6
SR-1520
SR-1344

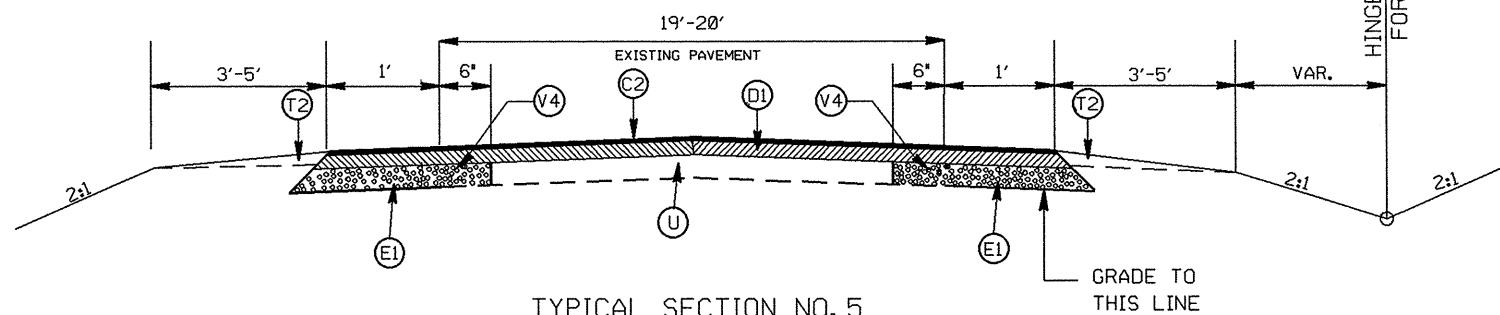

TYPICAL SECTION NO. 5
SR-1329

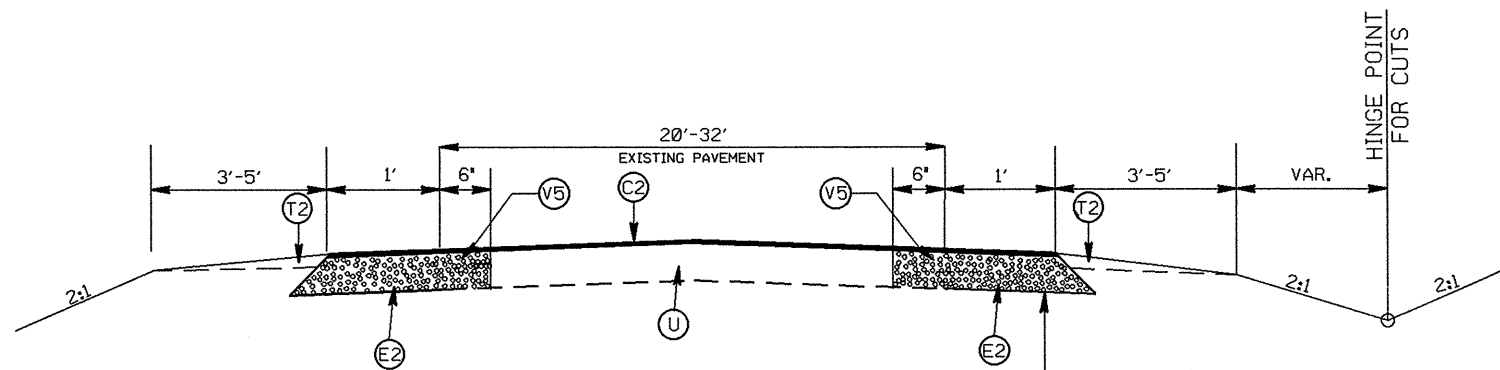

TYPICAL SECTION NO. 4
SR-1345

PATCHING DETAIL

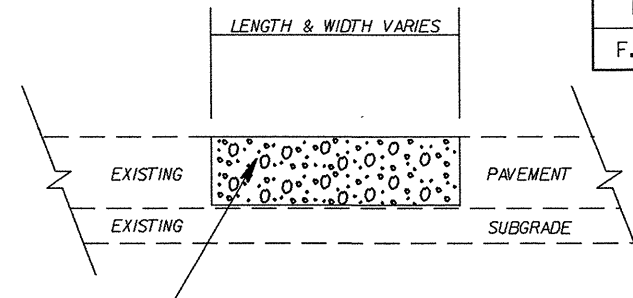

RATE IS VARIABLE AND SHALL BE AS DIRECTED BY THE ENGINEER. ASPHALT TYPE 119.0C SHALL BE PLACED.

STATE	PROJECT NO.	SHEET NO.	TOTAL SHEETS
N.C.	10CR.10901.29-10CR.20901.80	9	
F.A. PROJECT NO.			

PAVEMENT SCHEDULE

(C1)	PROP. APPROX. 1.5" ASPHALT CONC. SURFACE COURSE, TYPE S9.5C, AT AN AVERAGE RATE OF 168 LBS. PER SQ. YD.
(C2)	PROP. APPROX. 1.5" ASPHALT CONC. SURFACE COURSE, TYPE S9.5B, AT AN AVERAGE RATE OF 168 LBS. PER SQ. YD.
(D1)	PROP. APPROX. 2.5" ASPHALT CONC. INTERMEDIATE COURSE, TYPE 119.0B, AT AN AVERAGE RATE OF 285 LBS. PER SQ. YD.
(E1)	PROP. APPROX. 5.0" ASPHALT CONC. BASE COURSE, TYPE B25.0B, AT AN AVERAGE RATE OF 570 LBS. PER SQ. YD.
(E2)	PROP. APPROX. 8.0" ASPHALT CONC. BASE COURSE, TYPE B25.0B, AT AN AVERAGE RATE OF 456 LBS. PER SQ. YD. IN EACH OF TWO LAYERS.
(T1)	SHOULDER RECONSTRUCTION
(T2)	SHOULDER CONSTRUCTION
(U)	EXISTING PAVEMENT
(V1)	MILLING OF EXISTING PAVEMENT, 1.5" IN DEPTH
(V2)	MILLING OF EXISTING PAVEMENT, 2.5" IN DEPTH
(V3)	MILLING OF EXISTING PAVEMENT, 4" IN DEPTH
(V4)	MILLING 6" OF EXISTING PAVEMENT, 5" IN DEPTH. (SEE S.P. FOR "TRENCHING FOR BASE COURSE BY MILLING.")
(V5)	MILLING 6" OF EXISTING PAVEMENT, 8" IN DEPTH. (SEE S.P. FOR "TRENCHING FOR BASE COURSE BY MILLING.")

- NOTES: 1: LEVELING COURSE TO BE PLACED AT LOCATIONS AS DIRECTED BY THE ENGINEER.
 2: DO NOT RESURFACE OVER AREAS WITH NEW ASPHALT ON MAPS #4, #5, #6, #7, AND #8
 3: MAPS #2 AND #6 CONTAIN TRAFFIC LOOPS. CONTACT DIVISION TRAFFIC SERVICES.
 4: ON MAP #8, RESURFACE AROUND THE EXISTING CONCRETE ISLANDS TO THE PAVEMENT JOINT ON SR-1344 (WAXHAW/INDIAN TRAIL RD)
 5: ON MAP #10, DO NOT WIDEN THROUGH THE TURN LANE.

2012-2013 UNION COUNTY RESURFACING

SCALE	-NA-
DATE	1/12
DWG. BY	JAB
DESIGN BY	JAB
APPROVED	JWJ



REVISIONS	

STATE	PROJECT NO.	SHEET NO.	TOTAL SHEETS
N.C.	10CR.10901.29-10CR.20901.80	10	
F.A. PROJECT NO.			

PATCHING DETAIL

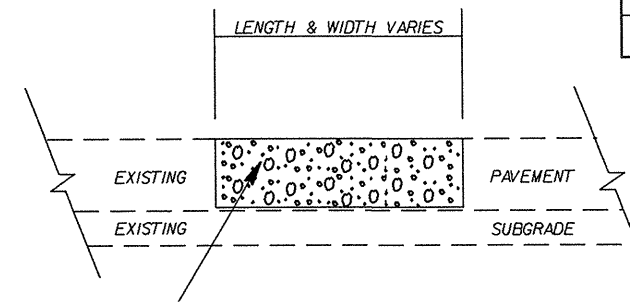

RATE IS VARIABLE AND SHALL BE AS DIRECTED BY THE ENGINEER. ASPHALT TYPE 119.0C SHALL BE PLACED.

PAVEMENT SCHEDULE

(C1)	PROP. APPROX. 1.5" ASPHALT CONC. SURFACE COURSE, TYPE S9.5C, AT AN AVERAGE RATE OF 168 LBS. PER SQ. YD.
(C2)	PROP. APPROX. 1.5" ASPHALT CONC. SURFACE COURSE, TYPE S9.5B, AT AN AVERAGE RATE OF 168 LBS. PER SQ. YD.
(D1)	PROP. APPROX. 2.5" ASPHALT CONC. INTERMEDIATE COURSE, TYPE I19.0B, AT AN AVERAGE RATE OF 285 LBS. PER SQ. YD.
(E1)	PROP. APPROX. 5.0" ASPHALT CONC. BASE COURSE, TYPE B25.0B, AT AN AVERAGE RATE OF 570 LBS. PER SQ. YD.
(E2)	PROP. APPROX. 8.0" ASPHALT CONC. BASE COURSE, TYPE B25.0B, AT AN AVERAGE RATE OF 456 LBS. PER SQ. YD. IN EACH OF TWO LAYERS.
(T1)	SHOULDER RECONSTRUCTION
(T2)	SHOULDER CONSTRUCTION
(U)	EXISTING PAVEMENT
(V1)	MILLING OF EXISTING PAVEMENT, 1.5" IN DEPTH
(V2)	MILLING OF EXISTING PAVEMENT, 2.5" IN DEPTH
(V3)	MILLING OF EXISTING PAVEMENT, 4" IN DEPTH
(V4)	MILLING 6" OF EXISTING PAVEMENT, 5" IN DEPTH. (SEE S.P. FOR "TRENCHING FOR BASE COURSE BY MILLING.")
(V5)	MILLING 6" OF EXISTING PAVEMENT, 8" IN DEPTH. (SEE S.P. FOR "TRENCHING FOR BASE COURSE BY MILLING.")

- NOTES: 1: LEVELING COURSE TO BE PLACED AT LOCATIONS AS DIRECTED BY THE ENGINEER.
 2: DO NOT RESURFACE OVER AREAS WITH NEW ASPHALT ON MAPS #4, #5, #6, #7, AND #8
 3: MAPS #2 AND #6 CONTAIN TRAFFIC LOOPS. CONTACT DIVISION TRAFFIC SERVICES.
 4: ON MAP #8, RESURFACE AROUND THE EXISTING CONCRETE ISLANDS TO THE PAVEMENT JOINT ON SR-1344 (WAXHAW/INDIAN TRAIL RD)
 5: ON MAP #10, DO NOT WIDEN THROUGH THE TURN LANE.

2012-2013 UNION COUNTY RESURFACING		
SCALE	-NA-	REVISIONS
DATE	1/12	
DWG. BY	JAB	
DESIGN BY	JAB	
APPROVED	JWU	

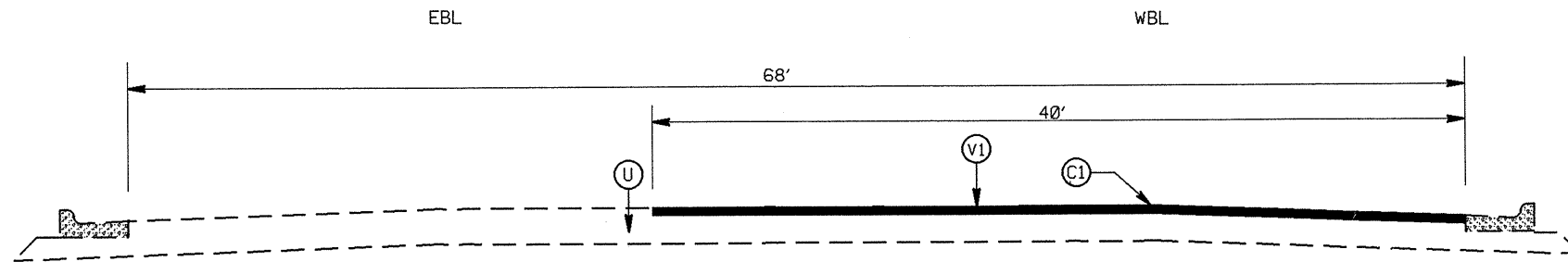

TYPICAL SECTION NO. 8
HWY 74 WBL

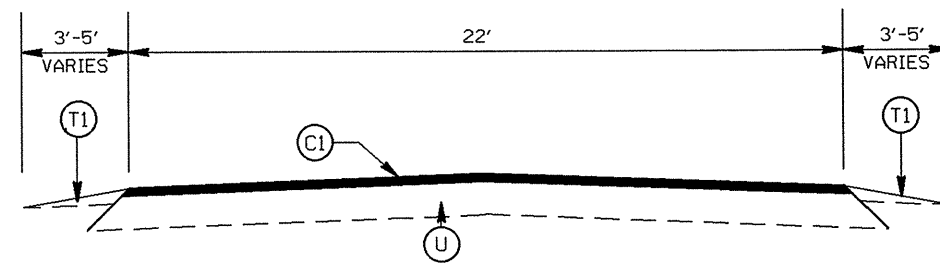

TYPICAL SECTION NO. 7
HWY 205

PROJECT NO. 10CR.10901.29 - 10CR.20901.80, ETC.	SHEET NO. 11	TOTAL NO.
---	-----------------	-----------

SUMMARY OF QUANTITIES

PROJECT NO	COUNTY	MAP NO	ROUTE	DESCRIPTION	TYP NO	FINAL SURFACE TESTING REQUIRED	AGGREGATE SHOULDER BORROW ALLOWED	LENGTH MI	FINAL WIDTH FT	BORROW CY	STABILIZER AGGREGATE TONS	INCIDENTAL STONE BASE TONS	SHOULDER CONSTRUCTION SMI	SHOULDER RECONSTRUCTION SMI	1 1/2" MILLING SY	4" MILLING SY	2.5" MILLING SY	INCIDENTAL MILLING SY	BASE COURSE, B25.0B TONS	INTERMEDIATE COURSE, I19.0B TONS
10CR.10901.29	Union	1	NC 205	FROM THE PAVEMENT JOINT AT SR-1006 (OLIVE BRANCH RD) TO SR-1627 (NEW SALEM RD)	7	NO	NO	4.67	22	500	90	240		9.34				75		
10CR.10901.30	Union	2	US 74 WBL	FROM THE BEGINNING OF THE C&G TO THE END OF C&G IN THE CITY LIMITS OF MARSHVILLE. MILEPOST 20.4 - 22.9	8	NO	NO	2.46	40	240	75				57,800					
10CR.20901.72	Union	3	SR-1606 (SIKES MILL RD)	FROM THE PAVEMENT JOINT AT HWY 218 TO THE PAVEMENT JOINT AT SR-1618 (TOM HELMS RD) MILEPOST 4.0 - 7.0	1	YES	NO	3.14	20	1,025	100	190		6.30				50		5,775
10CR.20901.73	Union	4	SR-1520 (INDIAN TRAIL/ FAIRVIEW RD)	FROM THE PAVEMENT JOINT AT HWY 218 TO THE PAVEMENT JOINT AT SR-1526 (CUNNINGHAM RD) MILEPOST 0 - 5.2	6	NO	NO	5.15	20	500	200	340		10.30				150		
10CR.20901.74	Union	5	SR-1941 (OLD PAGELAND/ MONROE RD)	FROM THE PAVEMENT JOINT AT SR-1003 (WHITE STORE RD) TO APPROX 200' PAST SR-1951 (MT SPRINGS CH RD) MILEPOST 7.5 - 6.0	1	YES	NO	1.37	22	500	50	84		2.74				75		2,775
10CR.20901.75	Union	6	SR-1329 (BILLY HOWIE RD)	FROM SR-1327 (PLEASANT GROVE RD) TO THE PAVEMENT JOINT AT SR-1008 (WAXHAW/ INDIAN TRAIL RD). MILEPOST 0 - 3.3	5	YES	NO	2.16	22	720	50	162	4.3					150	1,225	4,375
10CR.20901.76	Union	7	SR-1344 (MATTHEWS/WEDDINGTON RD)	FROM APPROX 500' FROM HWY 84 TO THE PAVEMENT JOINT AT MICHELLE CT. MILEPOST 3.9 - 0.5	6	NO	NO	2.55	20	275	50	200		5.10				100		
10CR.20901.77	Union	8	SR-1344 (MATTHEWS/WEDDINGTON RD)	FROM THE PAVEMENT JOINT AT SR-1362 (CHESTNUT LN) TO THE PAVEMENT JOINT PAST SR-1345 (TILLEY MORRIS RD) ON SR-1344 (MATTHEW/ WED. RD).	6	NO	NO	0.53	23	60		26		1.10				400		
10CR.20901.78	Union	9	SR-1008 (WAXHAW/INDIAN TRAIL RD)	FROM THE PAVEMENT JOINT NORTH OF HWY 84 TO THE PAVEMENT JOINT SOUTH OF SR-1346 (BEULAH CHURCH RD)	1	YES	NO	0.75	22	300	20	50		1.50				40		1,550
10CR.20901.79	Union	10	SR-1345 (TILLEY MORRIS RD)	FROM SR-1344 (MATTHEWS/ WEDDINGTON RD) TO THE MECKLENBURG CO LINE. MILEPOST 0 - 0.5	4	NO	NO	0.48	22-32	50	15	12	1.0					75	400	
10CR.20901.80	Union	11	SR-1008 (WAXHAW/ INDIAN TRAIL RD)	FROM THE PAVEMENT JOINT AT HWY 16 TO SR-2677 (DEER CREEK DR) MILEPOST 0.0 - 0.78	1,2,3	YES	NO	0.78	22	100		30		0.60		500	6,500			1,580
GRAND TOTAL								24.04		4,270	650	1,334	5.3	36.98	57,800	500	6,500	1,115	1,625	16,055

PROJECT NO	COUNTY	MAP NO	ROUTE	DESCRIPTION	SURFACE COURSE, S9.5B TONS	SURFACE COURSE, S9.5C TONS	LEVELING COURSE, S9.5B TONS	LEVELING COURSE, S9.5C TONS	ASPHALT BINDER FOR PLANT MIX TONS	PATCHING EXISTING PAVEMENT TONS	6" DRIVEWAYS SY	ADJ. OF MANHOLES EA	ADJ. OF METER OR VALVE BOX EA	PORTABLE LIGHTING LS	TEMPORARY SILT FENCE LF	STONE FOR EROSION CONTROL, CLASS B TN	SEDIMENT CONTROL STONE TN	WATTLE LF	POLY-ACRYLAMIDE (PAM) LB	SEED & MULCHING AC
10CR.10901.29	Union	1	NC 205	FROM THE PAVEMENT JOINT AT SR-1006 (OLIVE BRANCH RD) TO SR-1627 (NEW SALEM RD)		5,680		2,800	517	1,200	36				350	94	47	350	0.9	
10CR.10901.30	Union	2	US 74 WBL	FROM THE BEGINNING OF THE C&G TO THE END OF C&G IN THE CITY LIMITS OF MARSHVILLE. MILEPOST 20.4 - 22.9		5,500			325	525		1	1							
10CR.20901.72	Union	3	SR-1606 (SIKES MILL RD)	FROM THE PAVEMENT JOINT AT HWY 218 TO THE PAVEMENT JOINT AT SR-1618 (TOM HELMS RD) MILEPOST 4.0 - 7.0	3,700				499	650	130			*	200	64	32	200	0.5	
10CR.20901.73	Union	4	SR-1520 (INDIAN TRAIL/ FAIRVIEW RD)	FROM THE PAVEMENT JOINT AT HWY 218 TO THE PAVEMENT JOINT AT SR-1526 (CUNNINGHAM RD) MILEPOST 0 - 5.2	5,675		2,973		534	1,950	36				300	104	52	300	0.8	
10CR.20901.74	Union	5	SR-1941 (OLD PAGELAND/ MONROE RD)	FROM THE PAVEMENT JOINT AT SR-1003 (WHITE STORE RD) TO APPROX 200' PAST SR-1951 (MT SPRINGS CH RD) MILEPOST 7.5 - 6.0	1,610				230	575					200	28	14	200	0.5	
10CR.20901.75	Union	6	SR-1329 (BILLY HOWIE RD)	FROM SR-1327 (PLEASANT GROVE RD) TO THE PAVEMENT JOINT AT SR-1008 (WAXHAW/ INDIAN TRAIL RD). MILEPOST 0 - 3.3	2,690				425	500	54				150	44	22	150	0.4	2.1
10CR.20901.76	Union	7	SR-1344 (MATTHEWS/WEDDINGTON RD)	FROM APPROX 500' FROM HWY 84 TO THE PAVEMENT JOINT AT MICHELLE CT. MILEPOST 3.9 - 0.5	2,950		1,400		268	550	180			*	150	52	26	150	0.4	
10CR.20901.77	Union	8	SR-1344 (MATTHEWS/WEDDINGTON RD)	FROM THE PAVEMENT JOINT AT SR-1362 (CHESTNUT LN) TO THE PAVEMENT JOINT PAST SR-1345 (TILLEY MORRIS RD) ON SR-1344 (MATTHEW/ WED. RD).	840		230		65	75			2	*	40	12	6	40	0.1	
10CR.20901.78	Union	9	SR-1008 (WAXHAW/INDIAN TRAIL RD)	FROM THE PAVEMENT JOINT NORTH OF HWY 84 TO THE PAVEMENT JOINT SOUTH OF SR-1346 (BEULAH CHURCH RD)	960				132	300	80				50	16	8	50	0.2	
10CR.20901.79	Union	10	SR-1345 (TILLEY MORRIS RD)	FROM SR-1344 (MATTHEWS/ WEDDINGTON RD) TO THE MECKLENBURG CO LINE. MILEPOST 0 - 0.5	750		220		77	170	36			*	30	10	5	30	0.1	0.3
10CR.20901.80	Union	11	SR-1008 (WAXHAW/ INDIAN TRAIL RD)	FROM THE PAVEMENT JOINT AT HWY 16 TO SR-2677 (DEER CREEK DR) MILEPOST 0.0 - 0.78	975				134	300		6	9			6	3	20	0.1	
GRAND TOTAL					20,150	11,180	4,823	2,800	3,206	6,795	552	7	12	1	1,470	430	215	1,490	4	2.4

STATE	PROJECT NO.	SHEET NO.	TOTAL SHEETS
N.C.	IOCR.20901.74	PM-1	
F.A. PROJECT NO.			

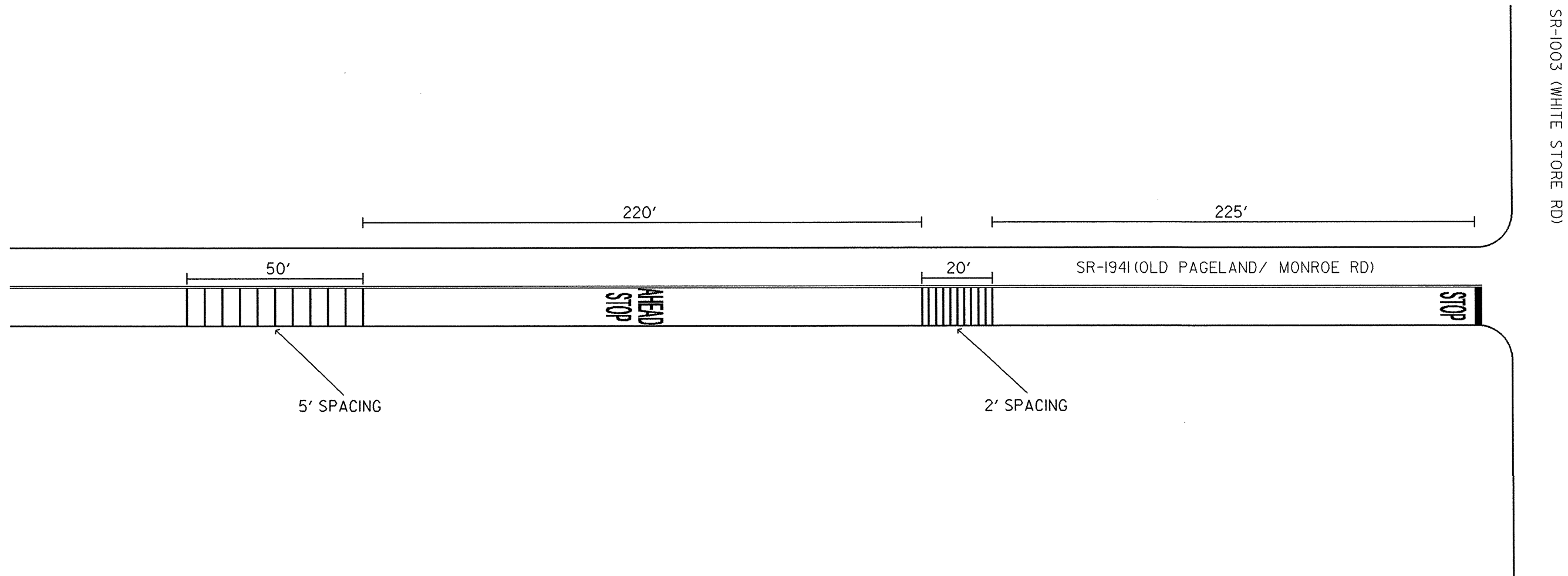

THERMO CHARACTERS SHALL BE PLACED PER SECTION I205.08 OF THE 2012 NCDOT ROADWAY STANDARD DRAWINGS.

SR-1941 (OLD PAGELAND / MONROE RD)
4" X 240 MIL WHITE THERMO
RUMBLE STRIP DETAIL

SCALE	-NA-		REVISIONS
DATE	1/12		
DWG. BY	JAB		
DESIGN BY	SME		
APPROVED	MU		

NOTES: Less than 5' - 10' undisturbed buffer from ROW, ditchline, water feature, or drainage inlet, add BMP.

BMP Options: Wattle or Silt Fence

EROSION CONTROL DETAIL

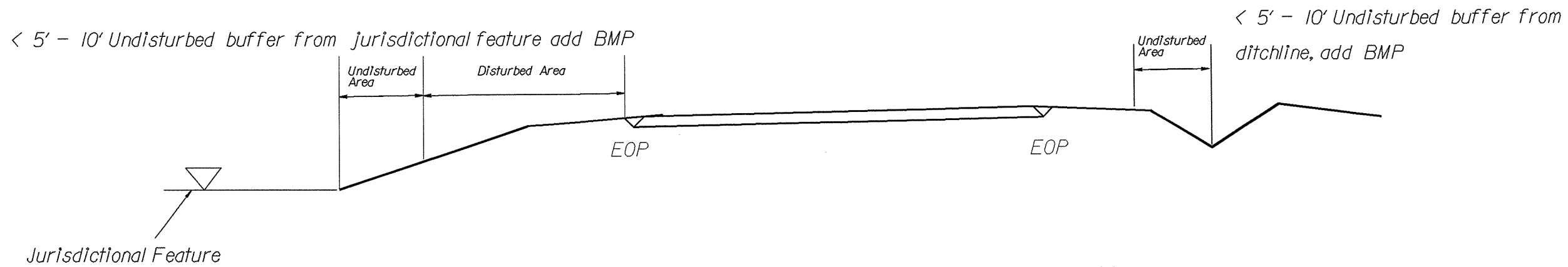
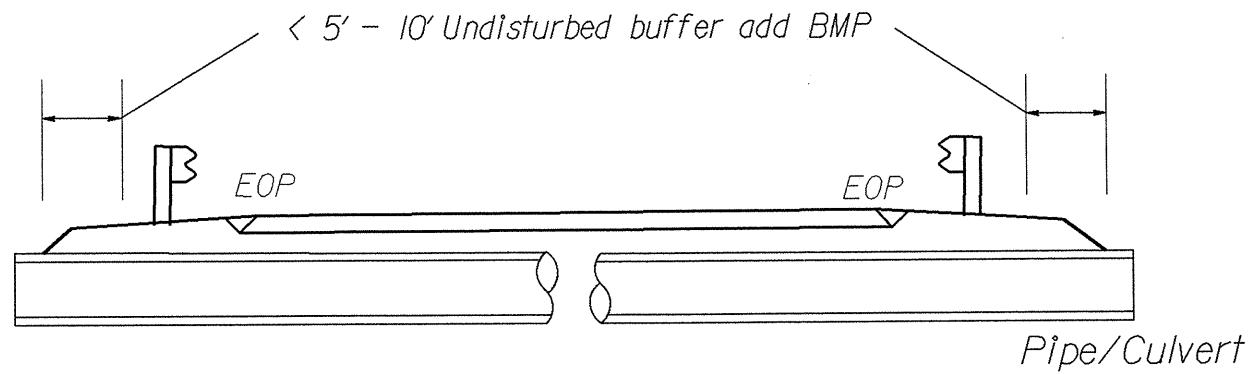

Use BMP's if shoulders and/or frontslopes and/or ditchline and/or backslopes are disturbed

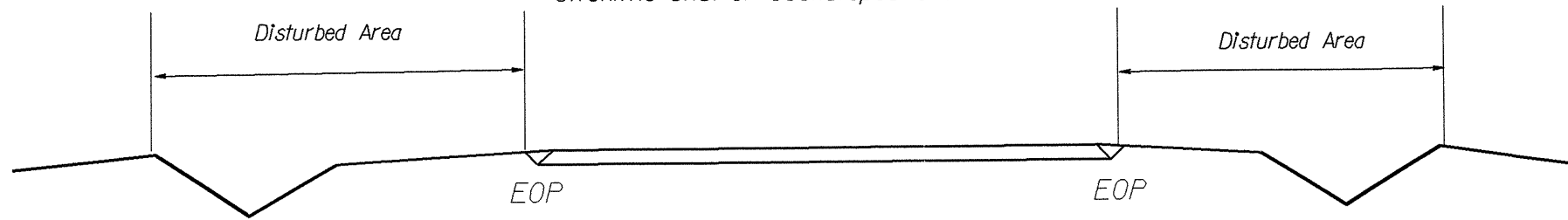

< 5' - 10' Undisturbed buffer from inlet, add wattle

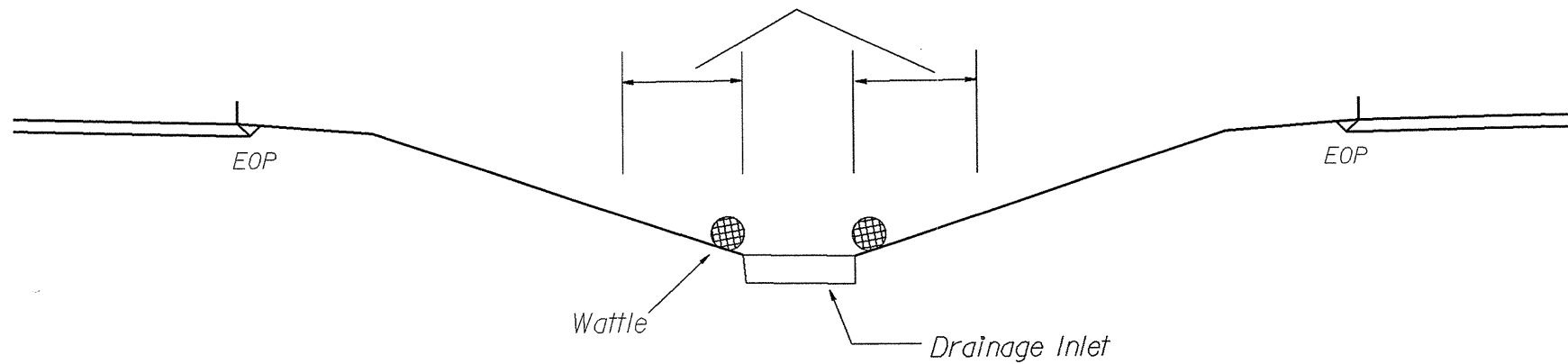

NOT TO SCALE

WATTLE WITH POLYACRYLAMIDE DETAIL

NOTES:

- USE MINIMUM 12 IN. DIAMETER EXCELSIOR WATTLE.
- USE 2 FT. WOODEN STAKES WITH A 2 IN. BY 2 IN. CROSS SECTION.
- INSTALL A MINIMUM OF 2 UPSLOPE STAKES AND 4 DOWNSLOPE STAKES AT AN ANGLE TO WEDGE WATTLE TO BOTTOM OF DITCH.
- PROVIDE STAPLES MADE OF 0.125 IN. DIAMETER STEEL WIRE FORMED INTO A U SHAPE NOT LESS THAN 12" IN LENGTH.
- INSTALL STAPLES APPROXIMATELY EVERY 1 LINEAR FOOT ON BOTH SIDES OF WATTLE AND AT EACH END TO SECURE IT TO THE SOIL.
- INSTALL MATTING IN ACCORDANCE WITH SECTION 1631 OF THE STANDARD SPECIFICATIONS.
- PRIOR TO POLYACRYLAMIDE (PAM) APPLICATION, OBTAIN A SOIL SAMPLE FROM PROJECT LOCATION, AND FROM OFFSITE MATERIAL, AND ANALYZE FOR APPROPRIATE PAM FLOCCULANT TO BE APPLIED TO EACH WATTLE.
- INITIALLY APPLY 3.5 OUNCES OF ANIONIC OR NEUTRALLY CHARGED POLYACRYLAMIDE (PAM) OVER WATTLE WHERE WATER WILL FLOW AND AFTER EVERY RAINFALL EVENT THAT IS EQUAL TO OR EXCEEDS 0.50 IN.

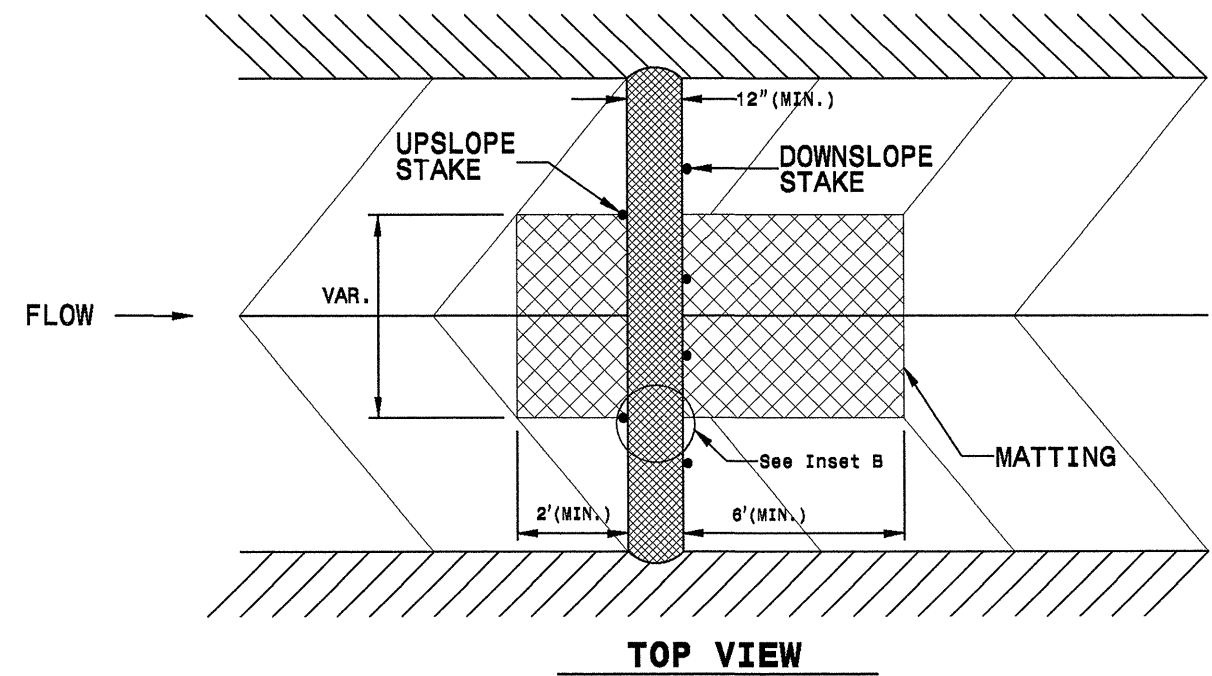
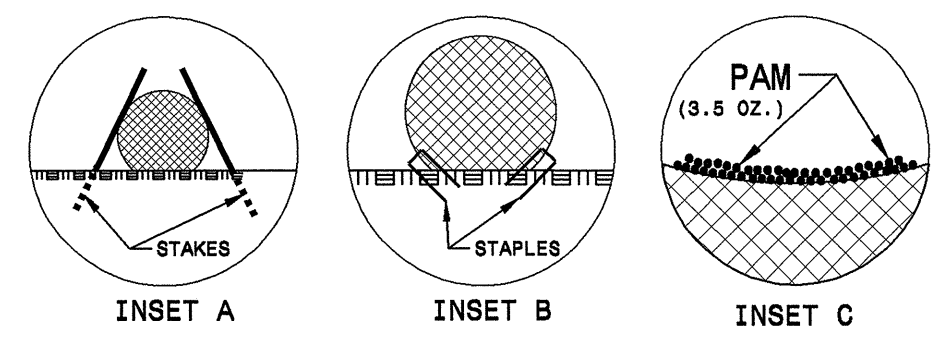
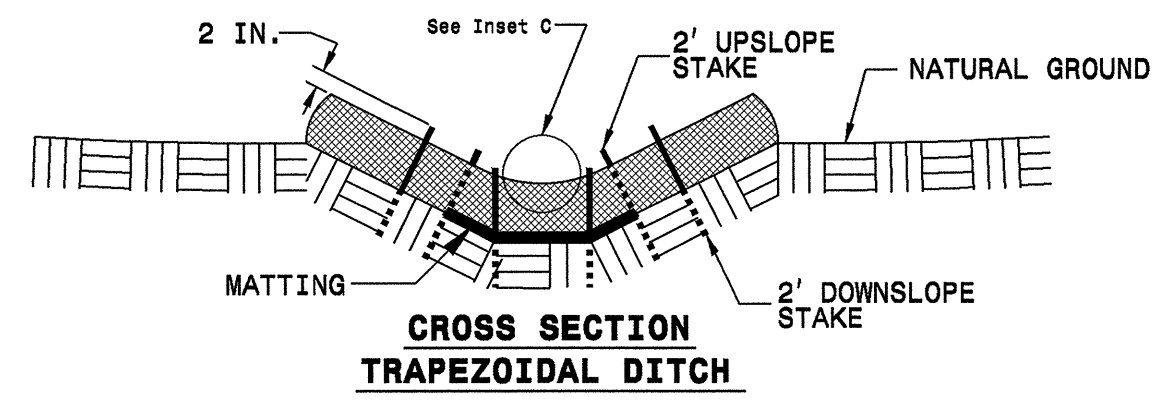
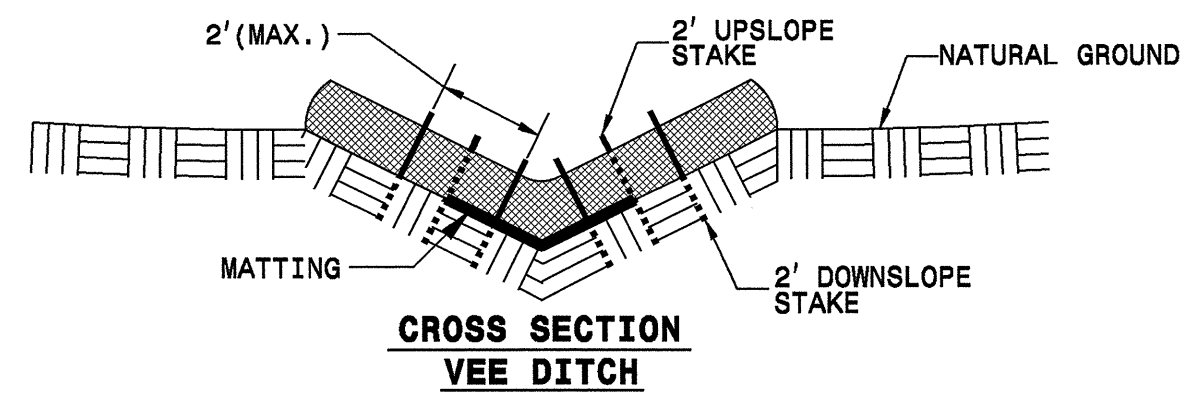
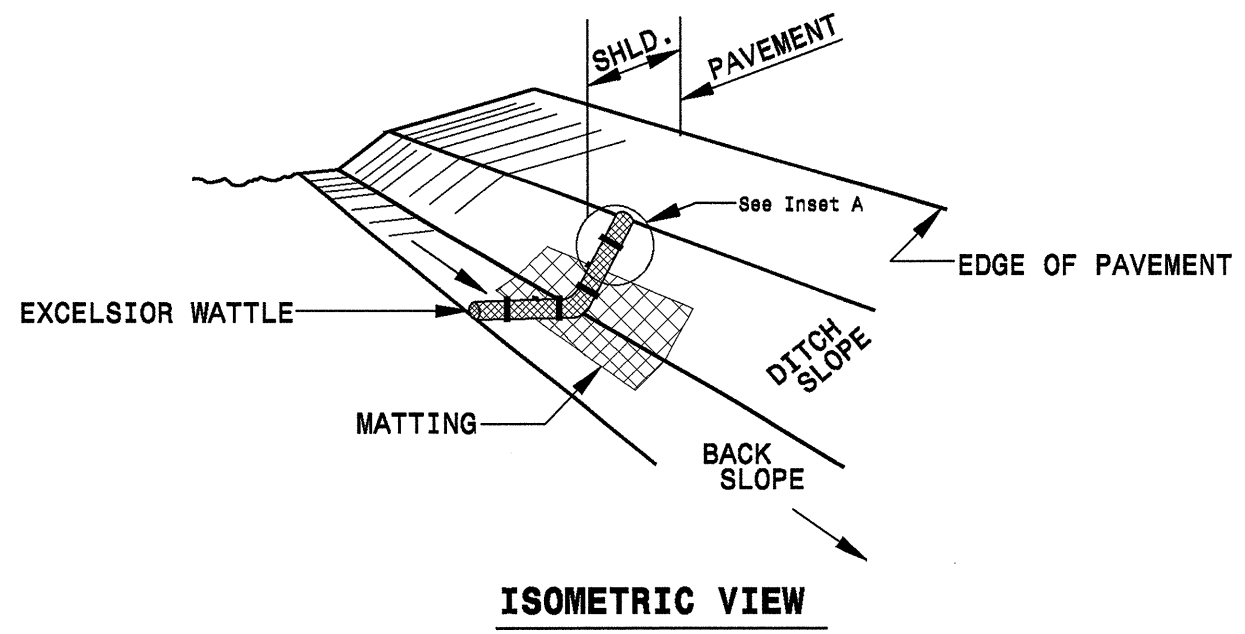

WATTLE DETAIL

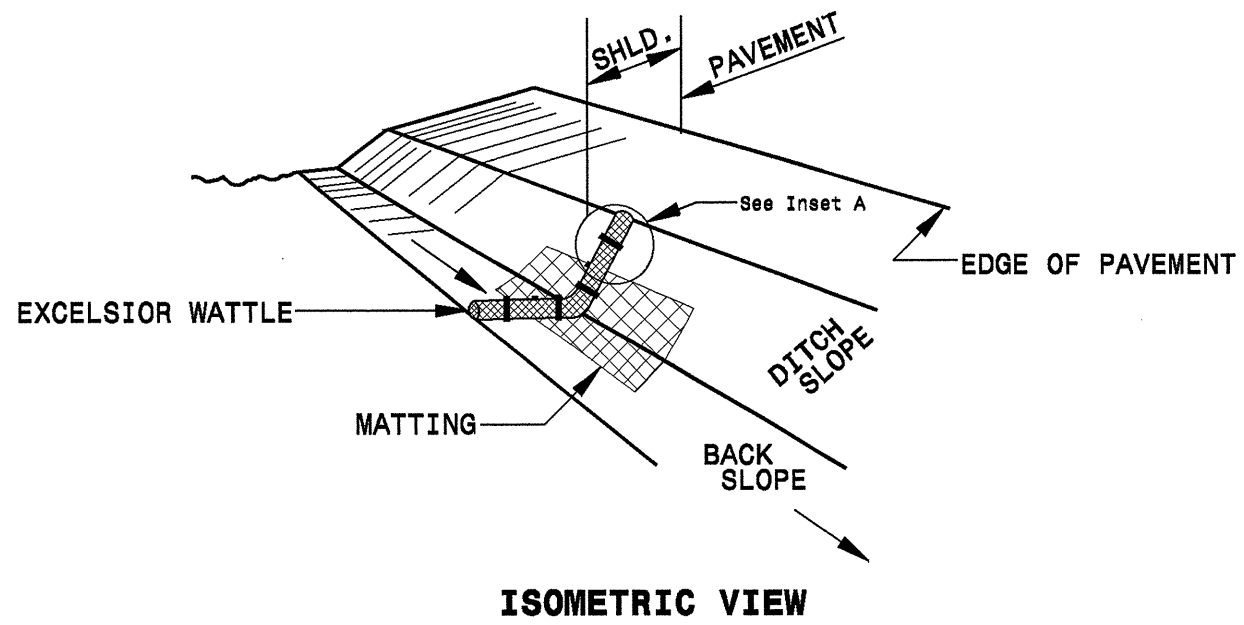

NOTES:

USE MINIMUM 12 IN. DIAMETER EXCELSIOR WATTLE.

USE 2 FT. WOODEN STAKES WITH A 2 IN. BY 2 IN. CROSS SECTION.

INSTALL A MINIMUM OF 2 UPSLOPE STAKES AND 4 DOWNSLOPE STAKES AT AN ANGLE TO WEDGE WATTLE TO BOTTOM OF DITCH.

PROVIDE STAPLES MADE OF 0.125 IN. DIAMETER STEEL WIRE FORMED INTO A U SHAPE NOT LESS THAN 12" IN LENGTH.

INSTALL STAPLES APPROXIMATELY EVERY 1 LINEAR FOOT ON BOTH SIDES OF WATTLE AND AT EACH END TO SECURE IT TO THE SOIL.

INSTALL MATTING IN ACCORDANCE WITH SECTION 1631 OF THE STANDARD SPECIFICATIONS.

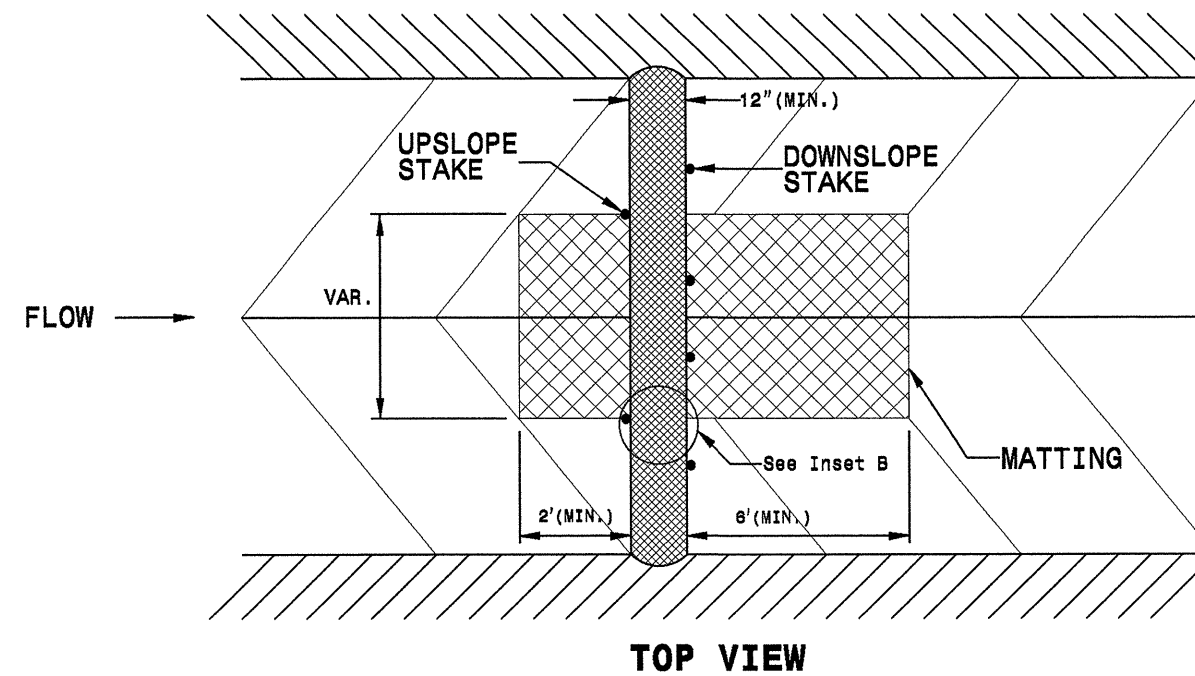
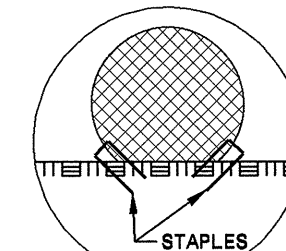
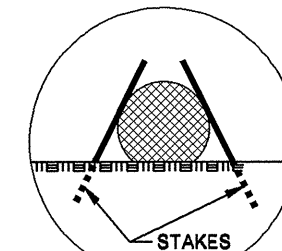
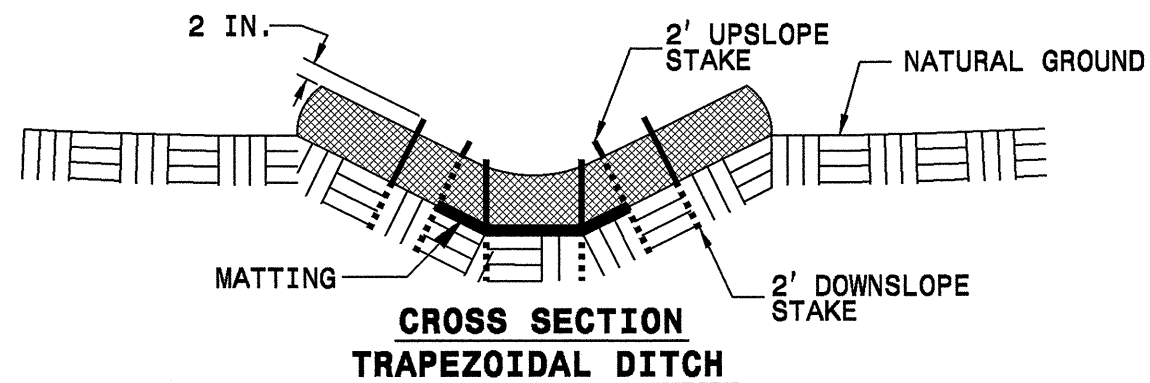
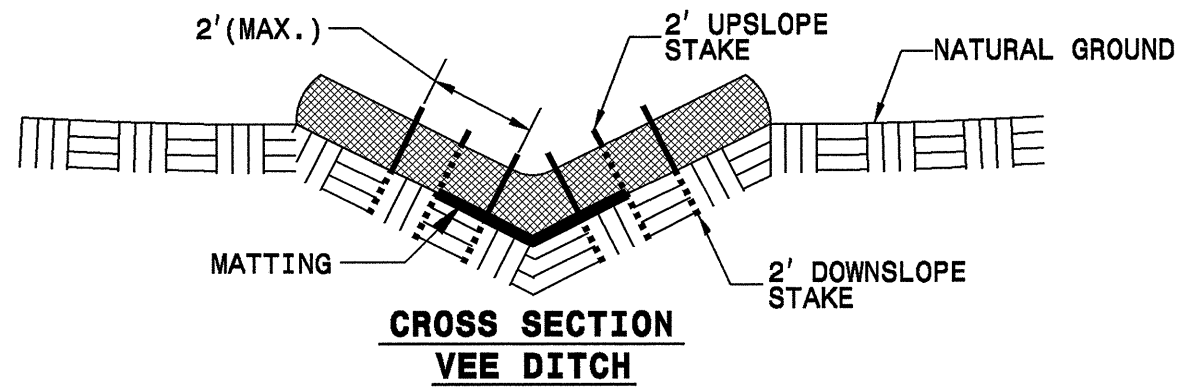

GENERAL EROSION DETAILS

STATE	PROJECT NO.	SHEET NO.	TOTAL SHEETS
N.C.	10CR.10901.29, ETC	EC-4	
F.A. PROJECT NO.			

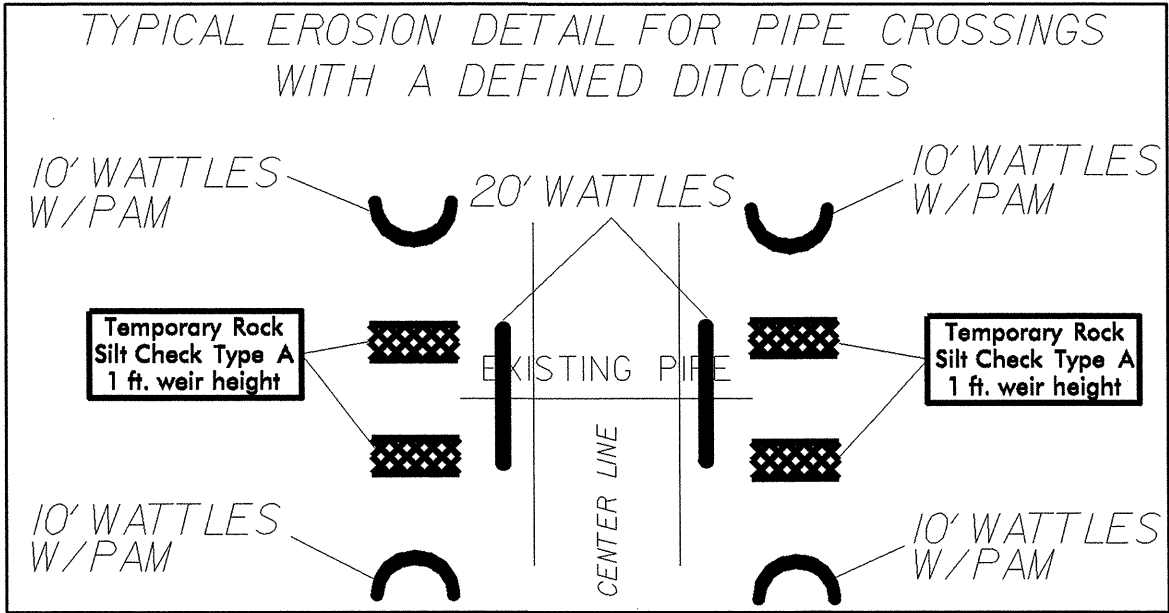
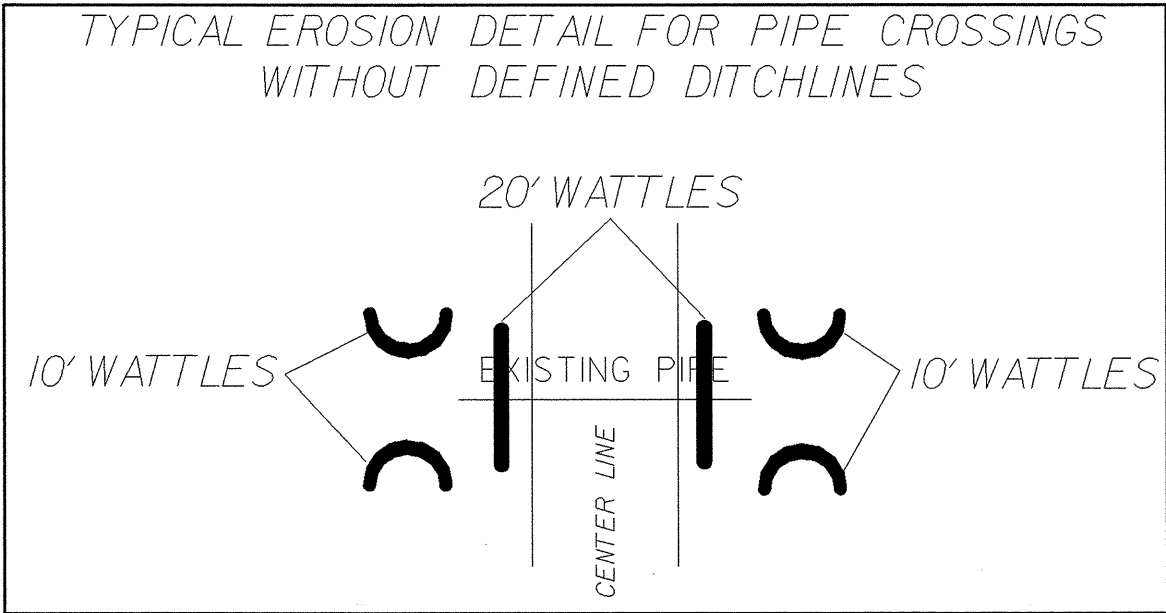

2012 ROADWAY ENGLISH STANDARD DRAWINGS

The following Roadway Standards as appear in "Roadway Standard Drawings" Highway Design Branch
N. C. Department of Transportation - Raleigh, N. C., Dated January, 2012 are applicable to this project
and by reference hereby are considered a part of these plans:

STD.NO.	TITLE
DIVISION 16 - EROSION CONTROL AND ROADSIDE DEVELOPMENT	
1633.01	Temporary Rock Silt Check Type A

NOTES: FIELD MODIFICATIONS MAY BE NECESSARY AS DIRECTED BY THE ENGINEER.
WATTLE LENGTHS MAY BE ADJUSTED IN THE FIELD BY THE ENGINEER.
EROSION CONTROL MATTING SHALL BE USED IN THE CONSTRUCTION OF
DITCHLINE WATTLES. SEE SHEET EC-2
POLYACRYLAMIDE (PAM) SHOULD NOT BE USED ON WATTLES
THAT WILL OUTLET DIRECTLY TO JURISDICTIONAL STREAMS.

GENERAL EROSION DETAILS		
SCALE	-NA-	REVISIONS
DATE	12/10	
DWG. BY	JAB	
DESIGN BY	JAB	
APPROVED	JWU	