

STATE OF NORTH CAROLINA
DIVISION OF HIGHWAYS

TRANSPORTATION MANAGEMENT PLAN

UNION COUNTY

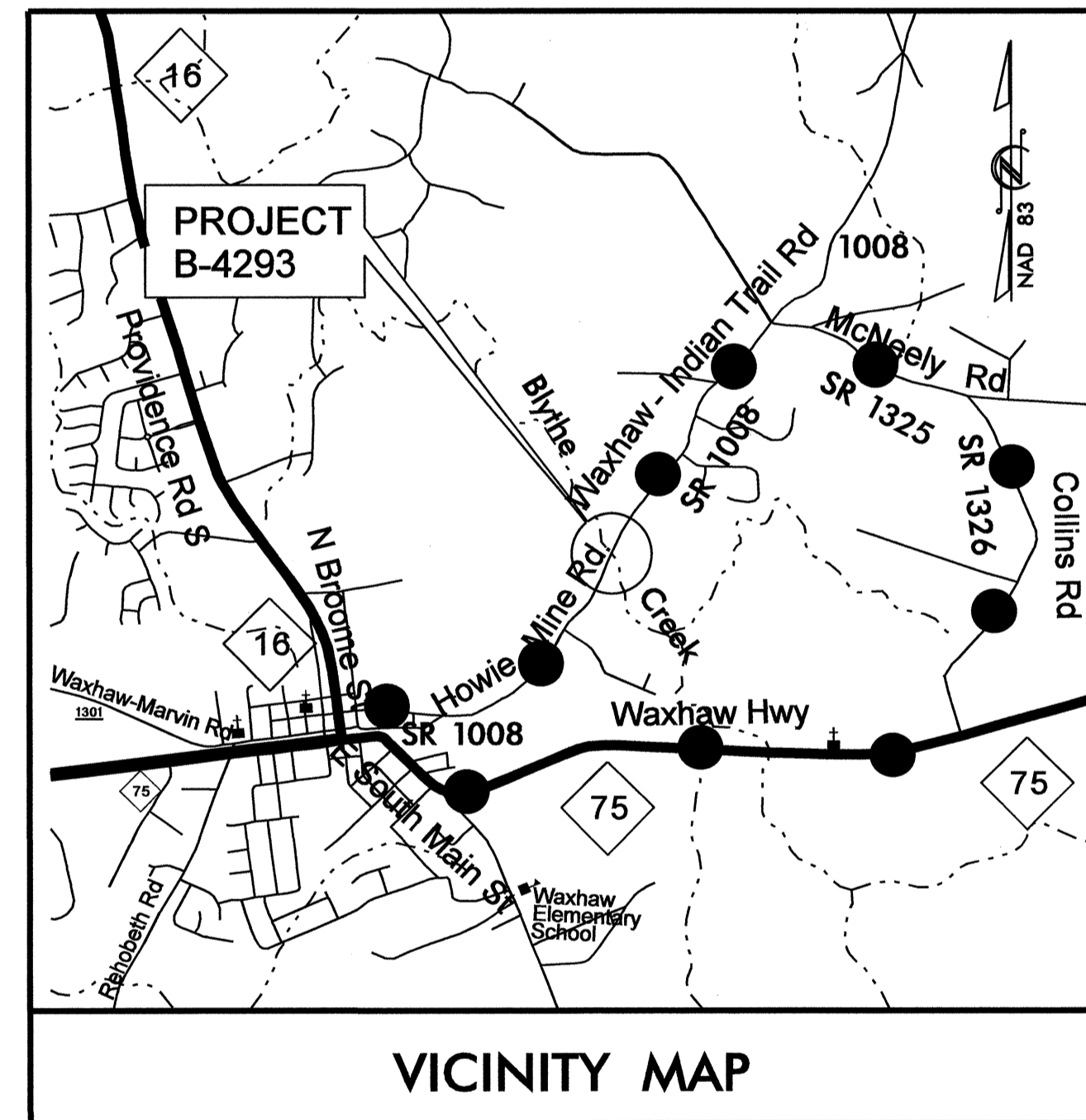
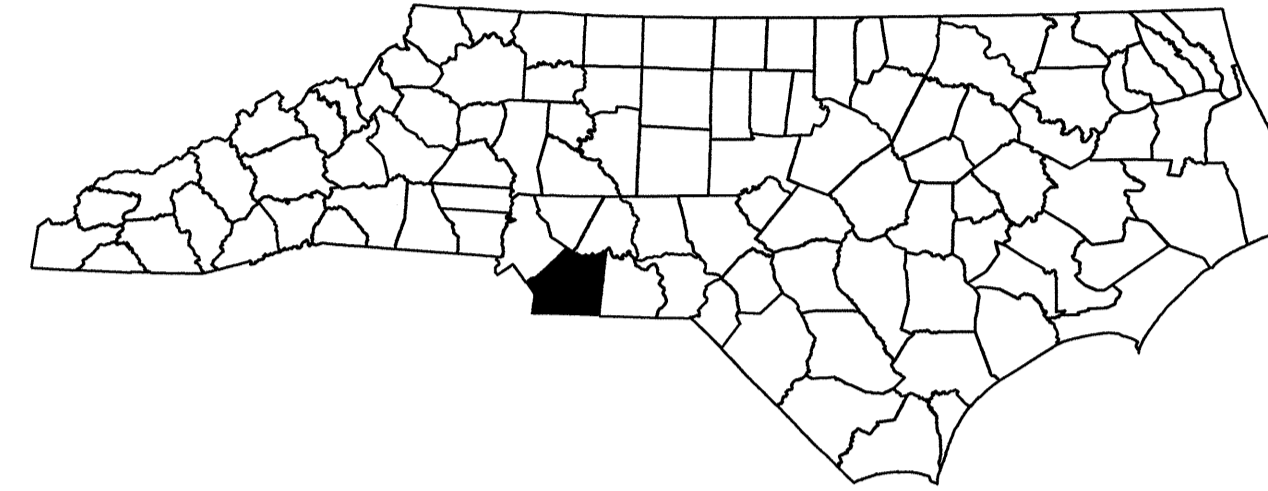

VICINITY MAP
OFF-SITE DETOUR ROUTE ●●●●

LOCATION: BRIDGE NO. 219 OVER BLYTHE CREEK AND APPROACHES ON SR 1008 (WAXHAW-INDIAN TRAIL ROAD)

INDEX OF SHEETS

SHEET NO.	TITLE
TMP-1	TITLE SHEET, AND INDEX OF SHEETS
TMP-1A	LIST OF APPLICABLE ROADWAY STANDARD DRAWINGS, LEGEND AND TEMPORARY PAVEMENT MARKING
TMP-1B	TRANSPORTATION OPERATIONS PLAN AND PROJECT NOTES
TMP-2	TEMPORARY TRAFFIC CONTROL PHASING AND DETAIL

SHEET NO.

TMP-1

B-4293

TIP PROJECT:

21-OCT-2011 09:04 \\dot\dfsroot\01\proj\TIP\Projects-B\B4293\TrafficControl\TCP\B-4293_TC-TMP-1.dgn sngreen AT TE24733

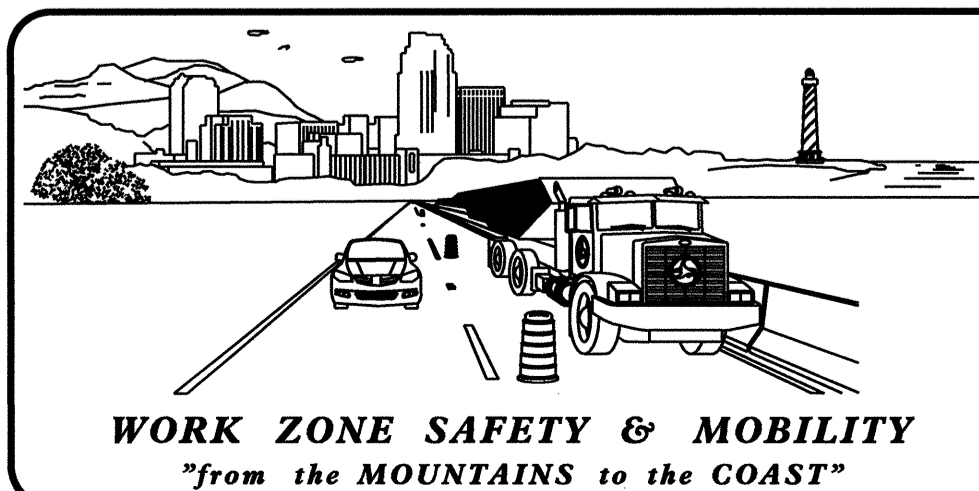

N.C.D.O.T. WORK ZONE TRAFFIC CONTROL
1580 MAIL SERVICE CENTER (MSC) RALEIGH, NC 27699-1580
1020 BIRCH RIDGE DRIVE, RALEIGH, NC 27610 (DELIVERY)
PHONE: (919) 250-4094 FAX: (919) 250-4098

J. S. BOURNE, P.E. STATE TRAFFIC MANAGEMENT ENGINEER
G. L. GETTIER, P.E. TRAFFIC CONTROL PROJECT ENGINEER
J. W. GILSTRAP TRAFFIC CONTROL PROJECT DESIGN ENGINEER
S. N. GREEN TRAFFIC CONTROL DESIGN ENGINEER

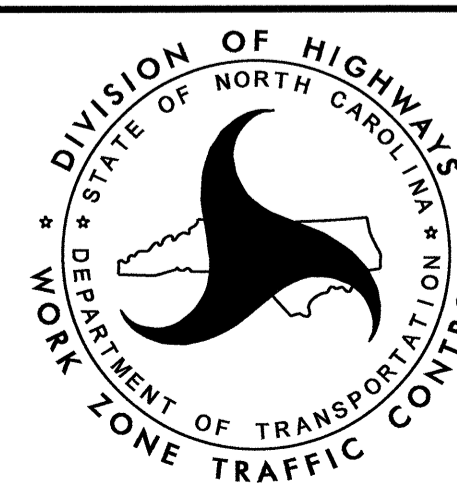

APPROVED: _____
DATE: _____

SEAL

ROADWAY STANDARD DRAWINGS

THE FOLLOWING ROADWAY STANDARDS AS SHOWN IN "ROADWAY STANDARD DRAWINGS" - PROJECT SERVICES UNIT - N.C. DEPARTMENT OF TRANSPORTATION - RALEIGH, N.C., DATED JANUARY 2012 ARE APPLICABLE TO THIS PROJECT AND BY REFERENCE HEREBY ARE CONSIDERED A PART OF THESE PLANS:

<u>STD. NO.</u>	<u>TITLE</u>
1101.03	TEMPORARY ROAD CLOSURES
1101.05	WORK ZONE VEHICLE ACCESSES
1101.11	TRAFFIC CONTROL DESIGN TABLES
1110.01	STATIONARY WORK ZONE SIGNS
1145.01	BARRICADES - TYPE III

LEGEND

GENERAL

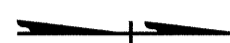
-  DIRECTION OF TRAFFIC FLOW
-  NORTH ARROW

TRAFFIC CONTROL DEVICES

-  BARRICADE (TYPE III)

TEMPORARY SIGNING

-  STATIONARY SIGN

TEMPORARY PAVEMENT MARKING

NONE

21-OCT-2011 09:45
 \\dot\dfsroot\proj\TIP\Projects-B\B4293\TrafficControl\TCP\B-4293_TC-TMP-1A.dgn
 AT TE24733
 sngreen

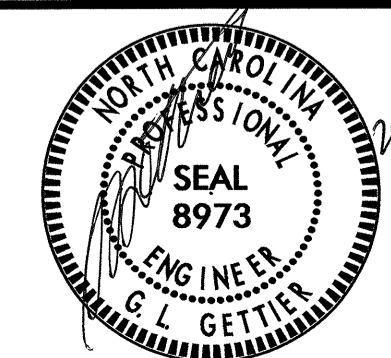
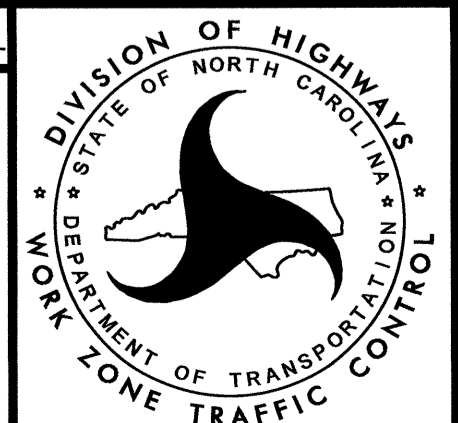
APPROVED: _____	DATE: _____			<p>ROADWAY STANDARD DRAWINGS, LEGEND & TEMPORARY PAVEMENT MARKING</p>
-----------------	-------------	---	---	--

TRANSPORTATION OPERATIONS

CONSTRUCTION

REMOVE AND REPLACE EXISTING STRUCTURE AND APPROACHES ALONG THE EXISTING ROADWAY ALIGNMENT AS SHOWN IN THE CONSTRUCTION PLANS.

TMP DESIGN PARAMETERS

TRAFFIC WILL BE DETOURED OFF-SITE DURING THE CONSTRUCTION PERIOD.

THE OFF-SITE DETOUR WILL INCLUDE SR 1325, SR 1326, NC 75 AND NC 16. (SEE SHEET TMP-2).

GENERAL NOTES

CHANGES MAY BE REQUIRED WHEN PHYSICAL DIMENSIONS IN THE DETAIL DRAWINGS, STANDARD DETAILS AND ROADWAY DETAILS ARE NOT ATTAINABLE TO MEET FIELD CONDITIONS, OR RESULT IN DUPLICATE, OR UNDESIRED OVERLAPPING OF DEVICES. MODIFICATION MAY INCLUDE: MOVING, SUPPLEMENTING, COVERING, OF REMOVAL OF DEVICES, AS DIRECTED BY THE ENGINEER.

THE FOLLOWING GENERAL NOTES APPLY AT ALL TIMES FOR THE DURATION OF THE CONSTRUCTION PROJECT EXCEPT WHEN OTHERWISE NOTED IN THE PLAN OR AS DIRECTED BY THE ENGINEER.

TRAFFIC PATTERN ALTERATIONS

- A) NOTIFY THE ENGINEER TWENTY ONE (21) CALENDAR DAYS PRIOR TO ANY TRAFFIC PATTERN ALTERATION.

SIGNING

- B) STATE FORCES WILL BE RESPONSIBLE FOR PROVIDING PERMANENT SIGNING.
- C) PROVIDE SIGNING AND DEVICES REQUIRED TO CLOSE THE ROAD ACCORDING TO THE ROADWAY STANDARD DRAWINGS AND TRAFFIC CONTROL PLANS.

STATE FORCES WILL BE RESPONSIBLE FOR PROVIDING SIGNING REQUIRED FOR THE OFF-SITE DETOUR ROUTE AS SHOWN IN THE TRAFFIC CONTROL PLANS.

- D) COVER OR REMOVE ALL SIGNS AND DEVICES REQUIRED TO CLOSE THE ROAD WHEN ROAD CLOSURE IS NOT IN OPERATION.

STATE FORCES WILL COVER OR REMOVE ALL SIGNS REQUIRED FOR THE OFF-SITE DETOUR WHEN THE DETOUR IS NOT IN OPERATION.

- E) ENSURE ALL NECESSARY SIGNING IS IN PLACE PRIOR TO ALTERING ANY TRAFFIC PATTERN.

TRAFFIC CONTROL DEVICES

- F) PLACE TYPE III BARRICADES WITH "ROAD CLOSED" SIGN R-11-2 ATTACHED OF SUFFICIENT LENGTH TO CLOSE ENTIRE ROADWAY.

PAVEMENT MARKINGS AND MARKERS

- G) STATE FORCES WILL INSTALL PAVEMENT MARKINGS AND PAVEMENT MARKERS ON THE FINAL SURFACE AS DIRECTED BY THE ENGINEER.

21-OCT-2011 09:06
 \dot\dfsroot\proj\TIPProjects\B\B4293\TrafficControl\TCP\B-4293-TC-TMP-1B.dgn
 sngreen AT 11244133

APPROVED: _____ DATE: _____			<h2>TRANSPORTATION OPERATIONS & PROJECT NOTES</h2>

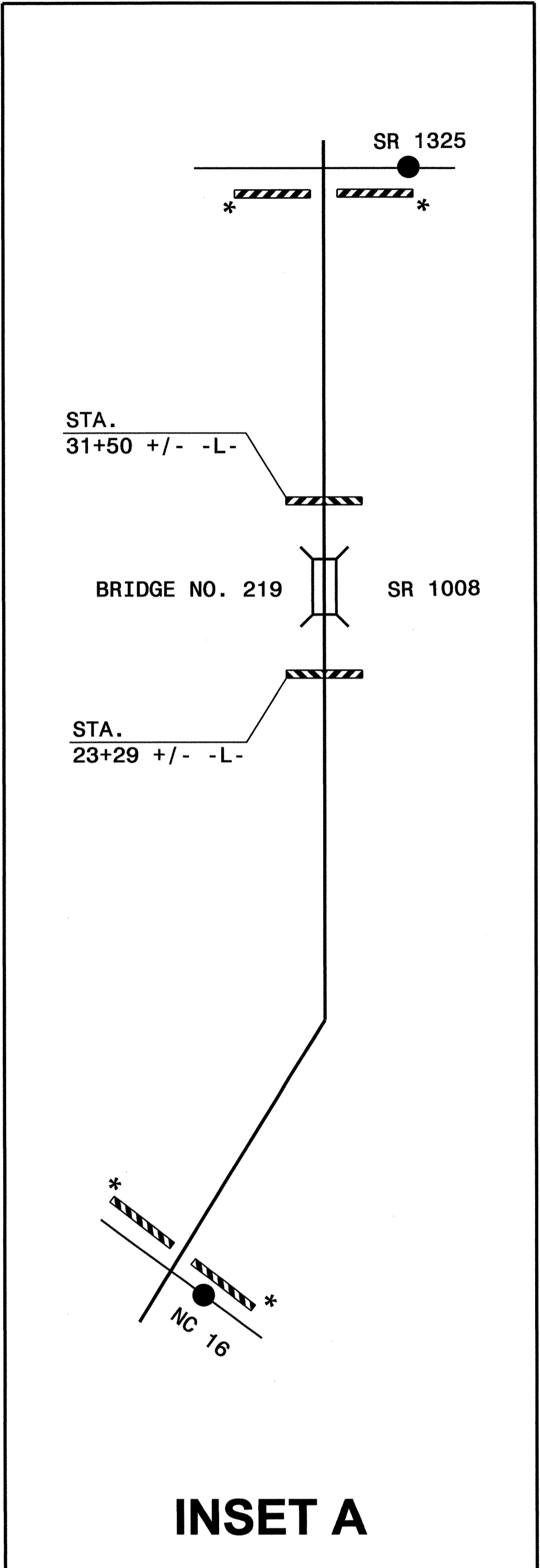
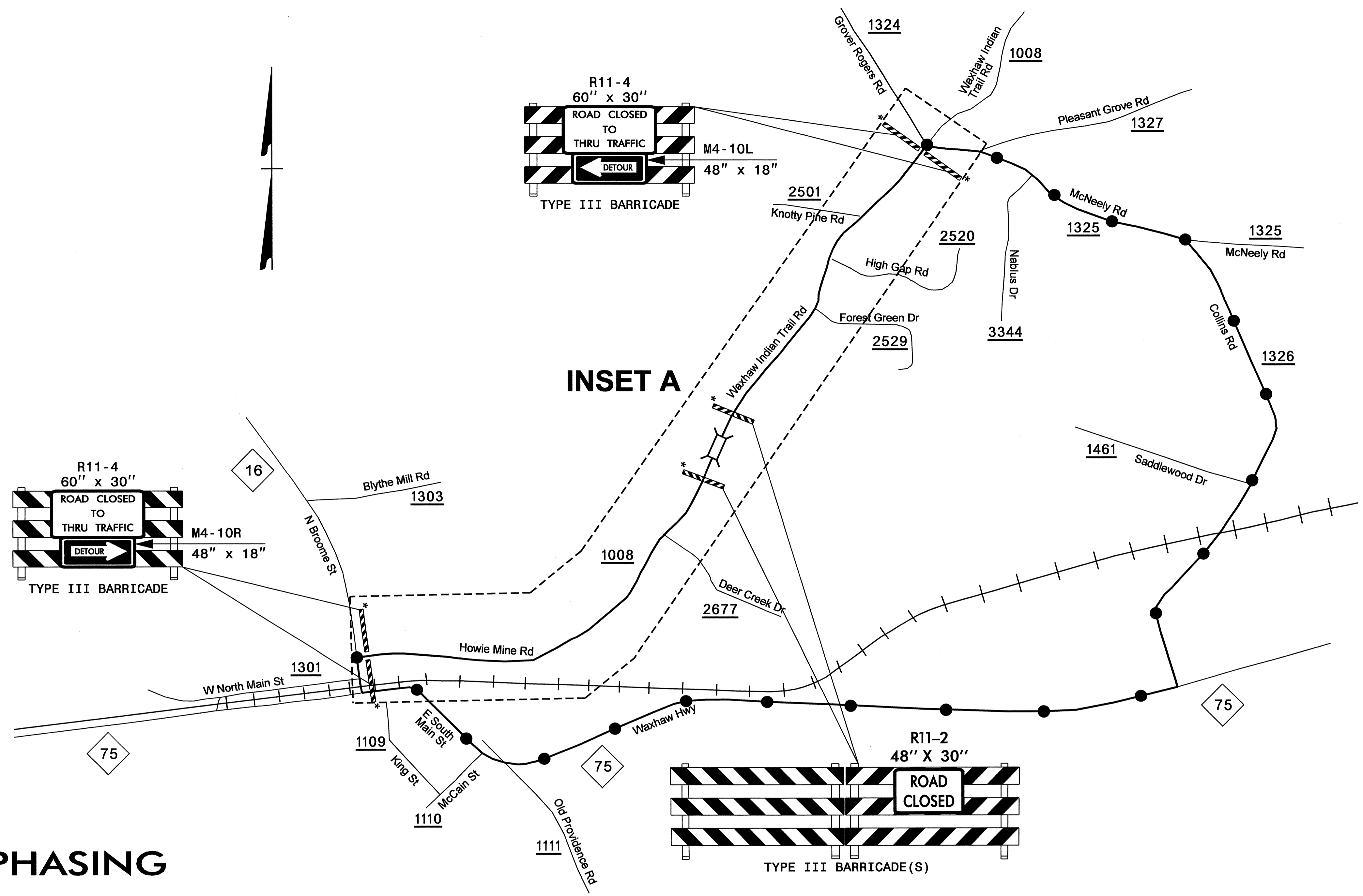

PHASING

- STEP 1: - USING ROADWAY STANDARD DRAWING NO. 1101.03, SHEET 1 OF 9, CLOSE SR 1008 (WAXHAW-INDIAN TRAIL ROAD, -L-) TO THRU TRAFFIC.
- NOTE: STATE FORCES WILL INSTALL OFF-SITE DETOUR ROUTE SIGN ASSEMBLIES FOR THE CLOSING OF SR 1008 (WAXHAW-INDIAN TRAIL ROAD, -L-), AS DIRECTED BY THE ENGINEER.
- STEP 2: - REMOVE THE EXISTING STRUCTURE AND CONSTRUCT THE PROPOSED STRUCTURE AND ROADWAY UP TO AND INCLUDING THE FINAL LAYER OF SURFACE COURSE FROM STATION 23+29 +/- -L- TO STATION 31+50 +/- -L-. (SEE CONSTRUCTION PLANS).
- NOTE: STATE FORCES WILL PLACE FINAL PAVEMENT MARKINGS AND MARKERS ON SR 1008 (WAXHAW-INDIAN TRAIL ROAD, -L-) AS DIRECTED BY THE ENGINEER.
- STEP 3: - REMOVE ALL TRAFFIC CONTROL DEVICES
- OPEN TO FINAL TRAFFIC PATTERN.

NOTES:

* SEE ROADWAY STANDARD DRAWING NO. 1101.03, SHEET 1 OF 9, FOR ADDITIONAL WORK ZONE SIGNS, DEVICES AND LOCATIONS.

21-OCT-2010 09:06 \\dot\dfs\001\proj\TIP\Projects-B\B4293\TrafficControl\B-4293-TC-TMP-2.dgn sngreen AT 12:47:33

APPROVED: _____ DATE: _____

SEAL

TEMPORARY TRAFFIC CONTROL PHASING AND DETAIL