



CROSS SECTION SUMMARY

NOTE: EMBANKMENT COLUMN DOES NOT INCLUDE BACKFILL FOR UNDERCUT

STATION L	UNCL. EXC. (CU. YD.)	EMBT. (CU. YD.)
20+00.00	-	-
20+50.00	30	3
20+60.00	11	4
21+00.00	31	44
21+40.00	15	82
21+60.00	5	57
22+00.00	12	143
22+50.00	22	211
23+00.00	21	253
23+50.00	31	216
23+72.75	15	65
23+83.75	3	30
25+16.25	-	-
25+27.25	0	13
25+50.00	1	25
26+00.00	16	44
26+50.00	27	47
27+00.00	26	59
27+53.50	14	34

CROSS SECTION INDEX

SHEET	BEGIN STATION	END STATION
X-2	20+00.00	22+00.00
X-3	22+50.00	25+16.25
X-4	25+27.25	27+53.50

Note:
Approximate quantities only. Fine Grading, Clearing and Grubbing, Unclassified Excavation, Borrow Excavation, Breaking of Existing Pavement, and Removal of Existing Pavement will be paid for at the contract lump sum price for "Grading."

Earthwork quantities are calculated by the Roadway Design Unit. These earthwork quantities are based in part on subsurface data provided by the Geotechnical Engineering Unit.

8/17/99

REVISIONS

\\11/201\B4661.RDY_PLANS\SHEETS.dgn

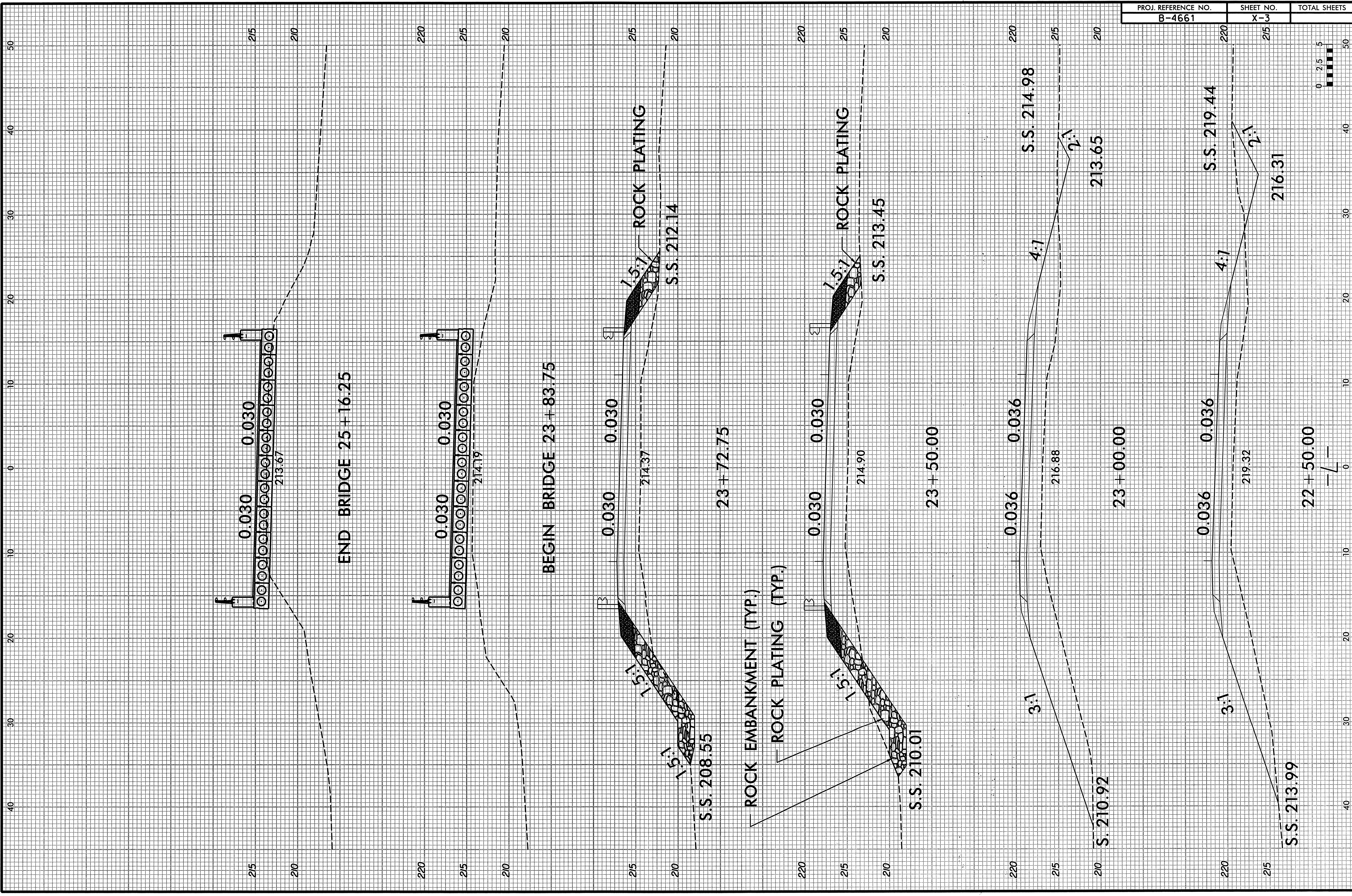

PROJ. REFERENCE NO.	SHEET NO.	TOTAL SHEETS
B-4661	X-3	

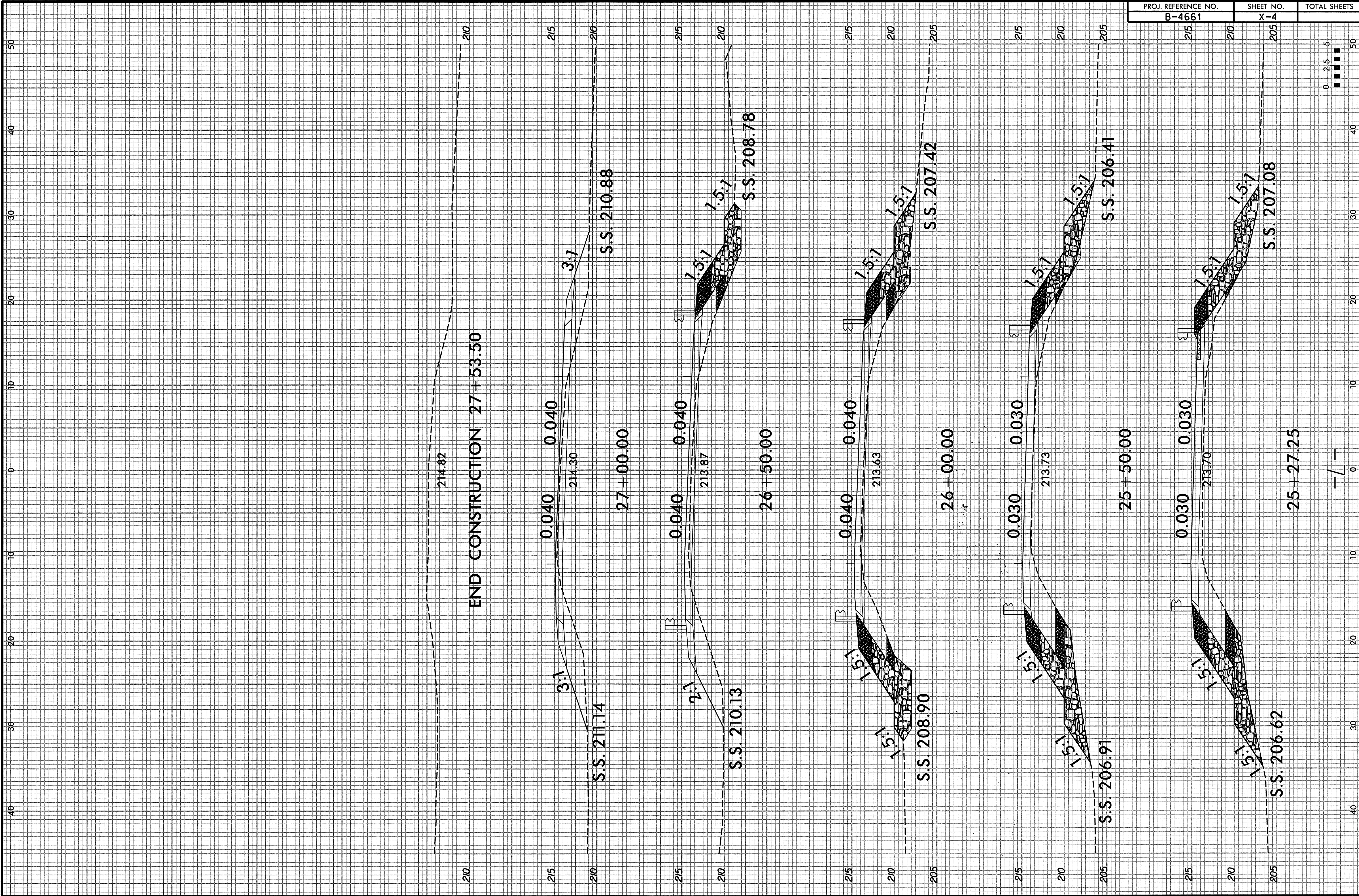

PROJ. REFERENCE NO.	SHEET NO.	TOTAL SHEETS
B-4661	X-4	5

